

INDEX TO DRAWINGS	
SHEET NO.	DESCRIPTION
1	TITLE SHEET
2	STANDARD PLANS SUMMARY
3	GENERAL NOTES AND LEGEND
4 - 5	TYPICAL SECTIONS & DETAILS
6	DRAINAGE DETAILS
7	SRT-350 DETAILS
8 - 12	ROADWAY PLANS
13	PAVEMENT MARKINGS LEGEND, DETAILS AND NOTES
14	SIGN PANEL LAYOUT AND MISCELLANEOUS DETAILS
15 - 19	SIGNING AND PAVEMENT MARKING PLANS
20 - 22	MISCELLANEOUS SUMMARIES

STATE OF HAWAII
DEPARTMENT OF TRANSPORTATION
HIGHWAYS DIVISION
HONOLULU, HAWAII

PLANS FOR
WAIEHU BEACH ROAD RESURFACING
KAHEKILI HIGHWAY TO KAHULUI BEACH ROAD
PROJECT NO. 3400B-01-97M
DISTRICT OF WAILUKU
ISLAND OF MAUI

FED. ROAD DIST. NO.	STATE	PROJ. NO.	FISCAL YEAR	SHEET NO.	TOTAL SHEETS
HAWAII	HAW.	3400B-01-97M	1997	1	22

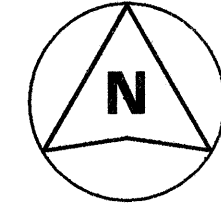
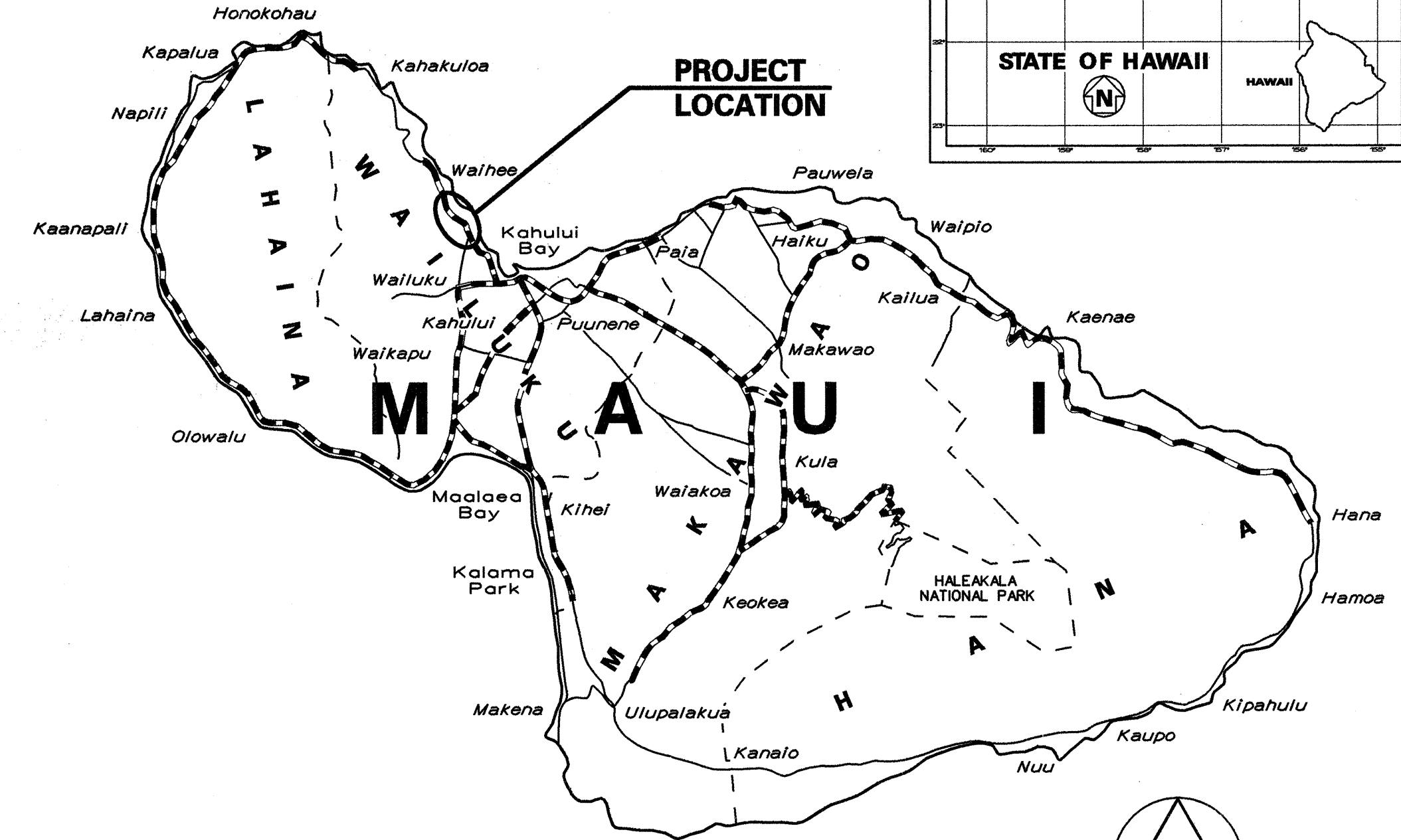
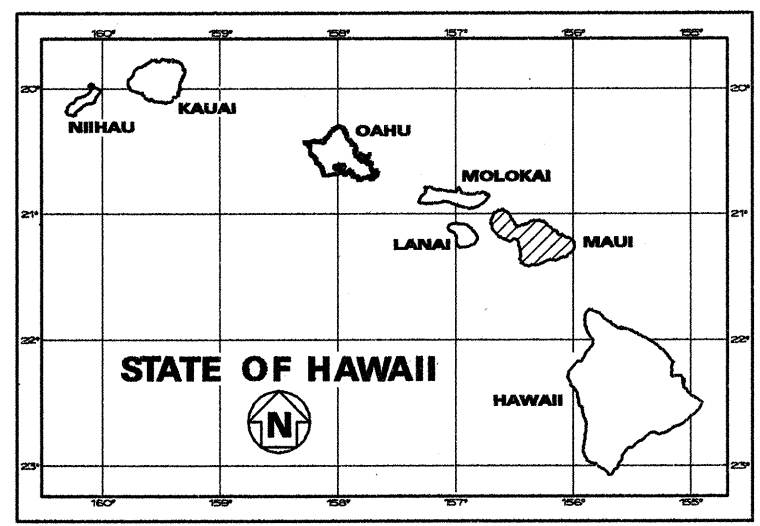
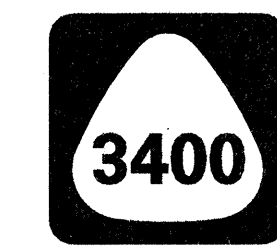

SCALE IN MILES

FEDERAL AID PROJECTS PREVIOUSLY CONSTRUCTED OR UNDER CONSTRUCTION

WAIEHU BEACH RD. MILE POST 1.13 TO MILE POST 2.62
KAHEKILI HWY. MILE POST 1.95 TO MILE POST 2.26

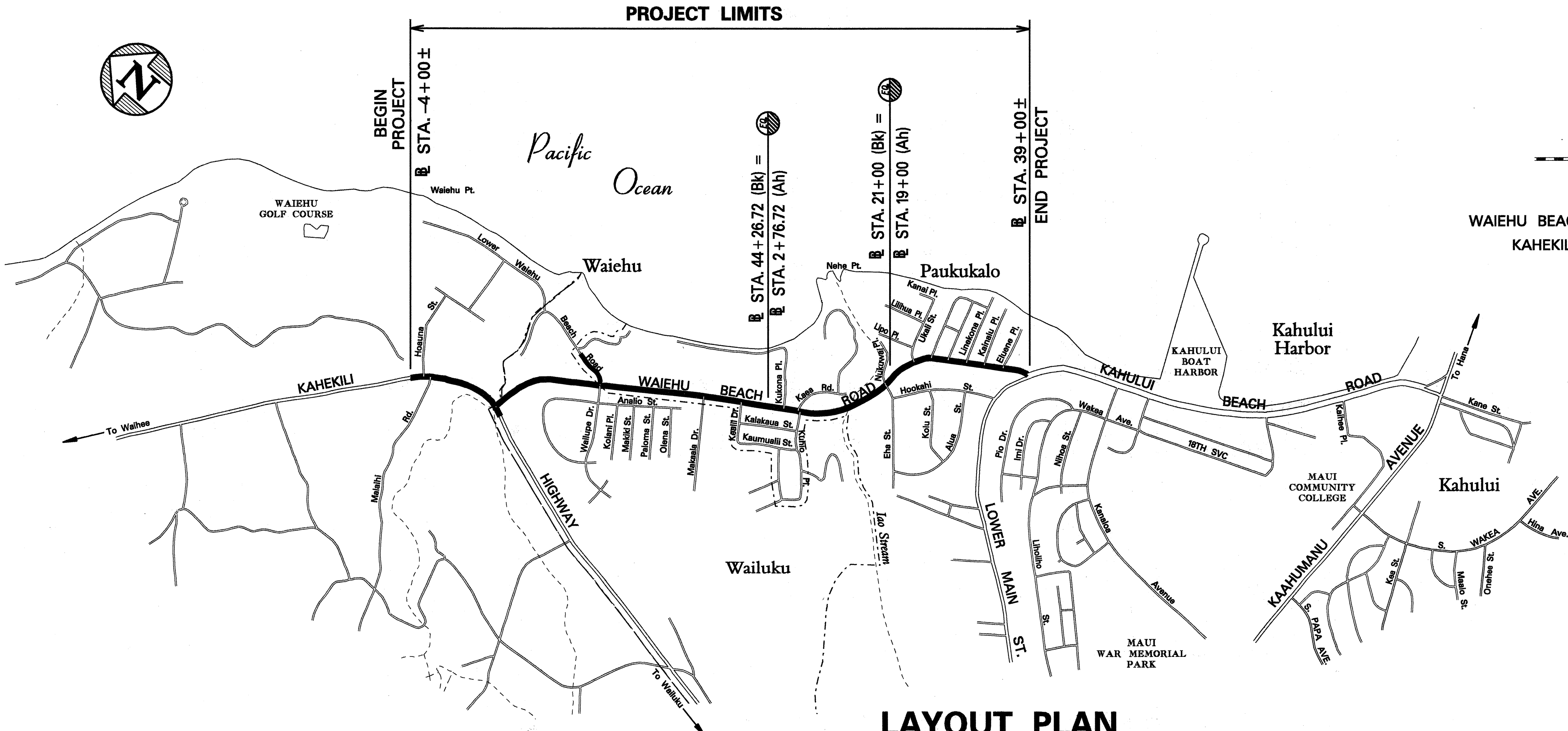

SCALE IN THOUSAND FEET

LAYOUT PLAN

GROSS LENGTH OF PROJECT.....1.80 MILES
NET LENGTH OF PROJECT.....1.80 MILES

DEPARTMENT OF TRANSPORTATION
STATE OF HAWAII
APPROVED: *[Signature]* 4-18-97
DIR. OF TRANSPORTATION DATE

DESIGNED BY K. ITO P. S. & E. BY DATE APRIL 1997 PHONE 587-2244

twainishidgr/fred