

FED. ROAD DIST. NO.	STATE	PROJ. NO.	FISCAL YEAR	SHEET NO.	TOTAL SHEETS
HAWAII	HAW.	3400B-01-97M	1997	6	22

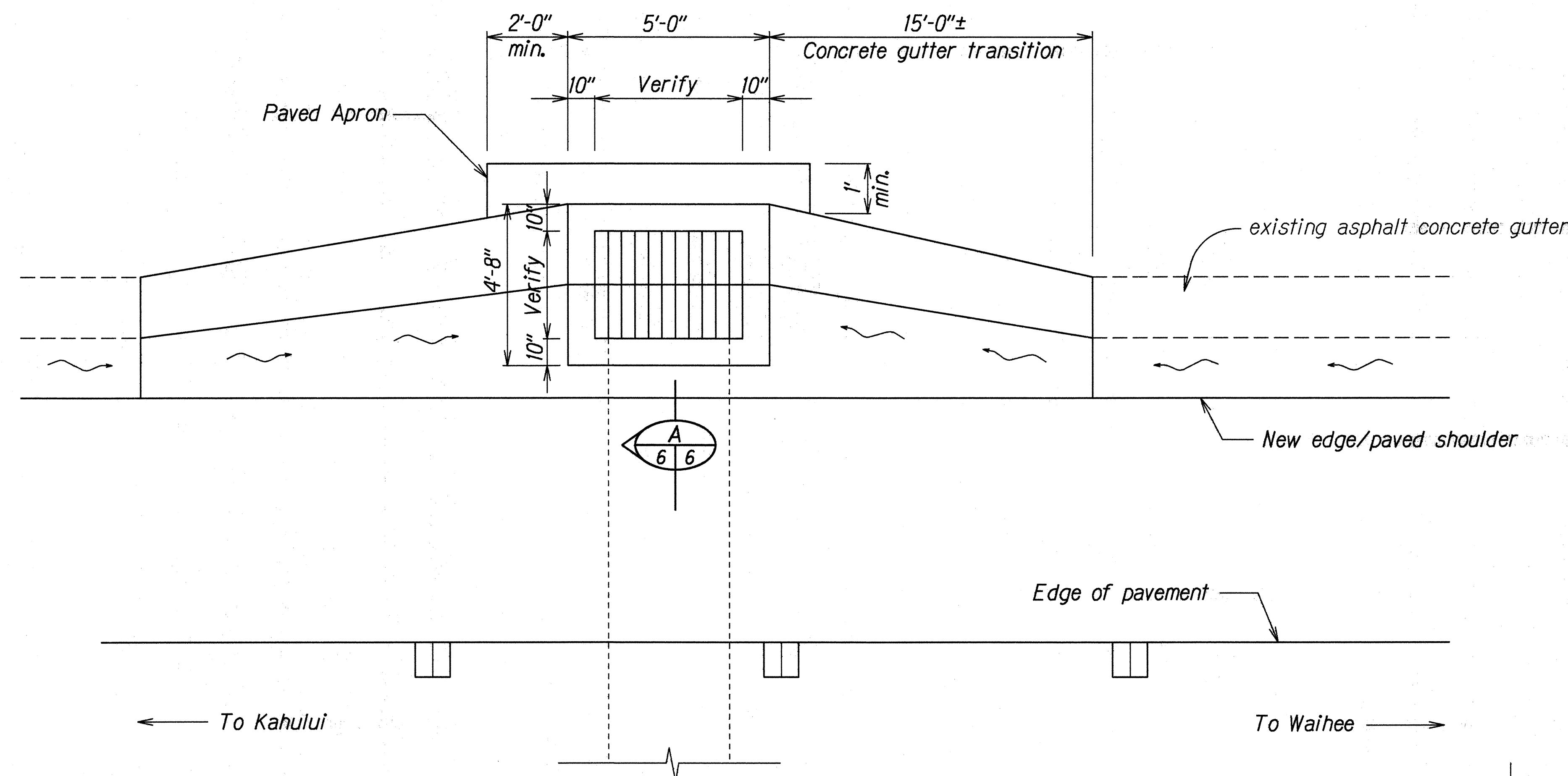

**WAIEHU BEACH ROAD
DETAIL OF INLET STRUCTURE**
Not To Scale

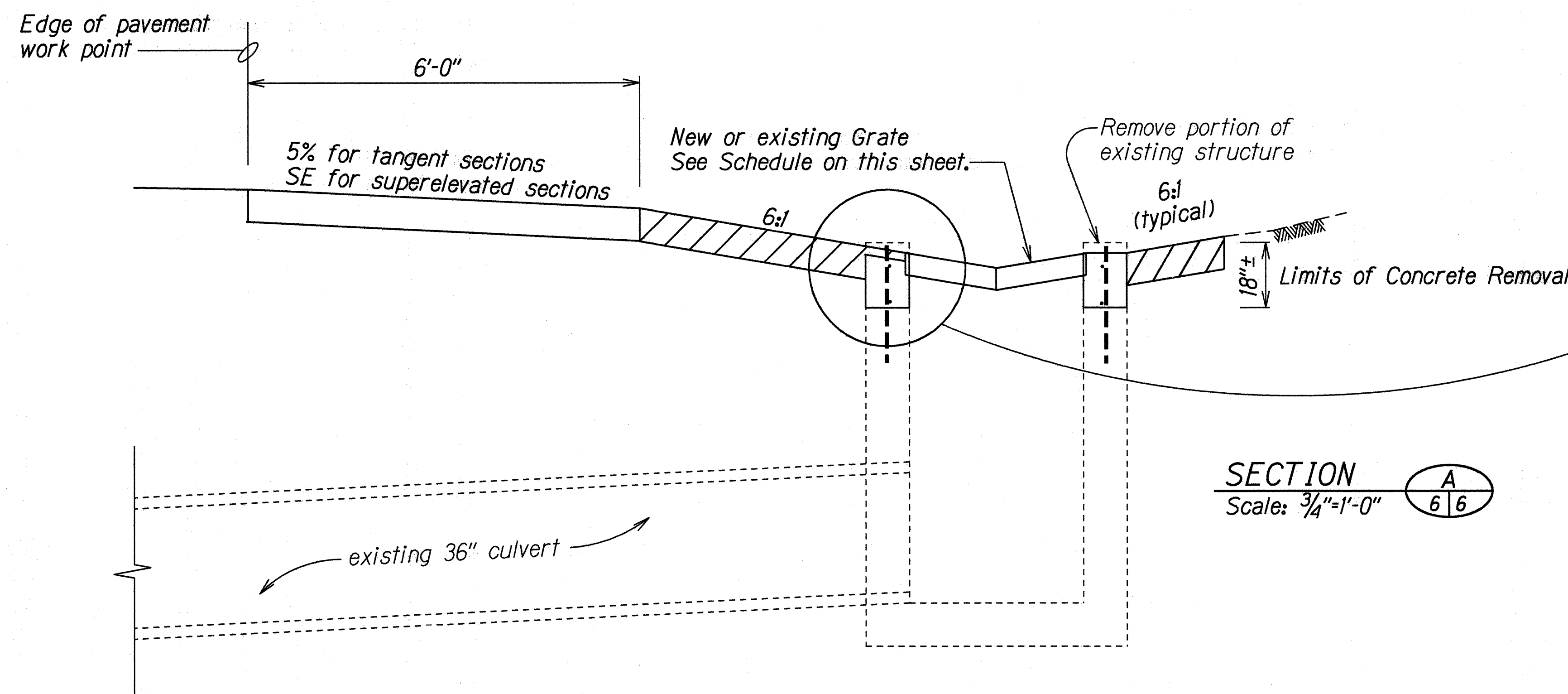

SECTION
Scale: 3/4"=1'-0" **A**
6/6

WAIEHU BEACH ROAD DRAINAGE SUMMARY			
# STATION	TYPE	GRATE SIZE	COMMENTS
21+27± Rt.	Type "A" 12P Grated Drop Inlet	2'-0" x 3'-0"	Raise existing grate to New Finished Grade.
22+63± Rt.	Type "A" 12P Grated Drop Inlet	2'-0" x 3'-0"	Raise existing grate to New Finished Grade.
23+46± Rt.	Type "A" 12P Grated Drop Inlet	2'-0" x 3'-0"	Raise existing grate to New Finished Grade.
27+20± Rt.	Modified 61614B	3'-4" x 3'-0"	Install New Grate on existing concrete drop intake

GENERAL NOTES:

- Contractor shall verify measurement of existing inlet structures.
- Shop drawings for steel frame and grate shall be submitted to Engineer upon verification of field measurement. Fabrication of these frame and grates shall commence only upon receipt of approved Shop drawings. Refer to Standard Plan Sht. H-15 for additional frame and grate details.
- Concrete for modified drainage structure will not be paid for separately but shall be considered incidental to "Modified Type 61614B Steel Frame and Grate" pay item.
- Concrete gutter transition will not be paid for separately but shall be considered incidental to various items.

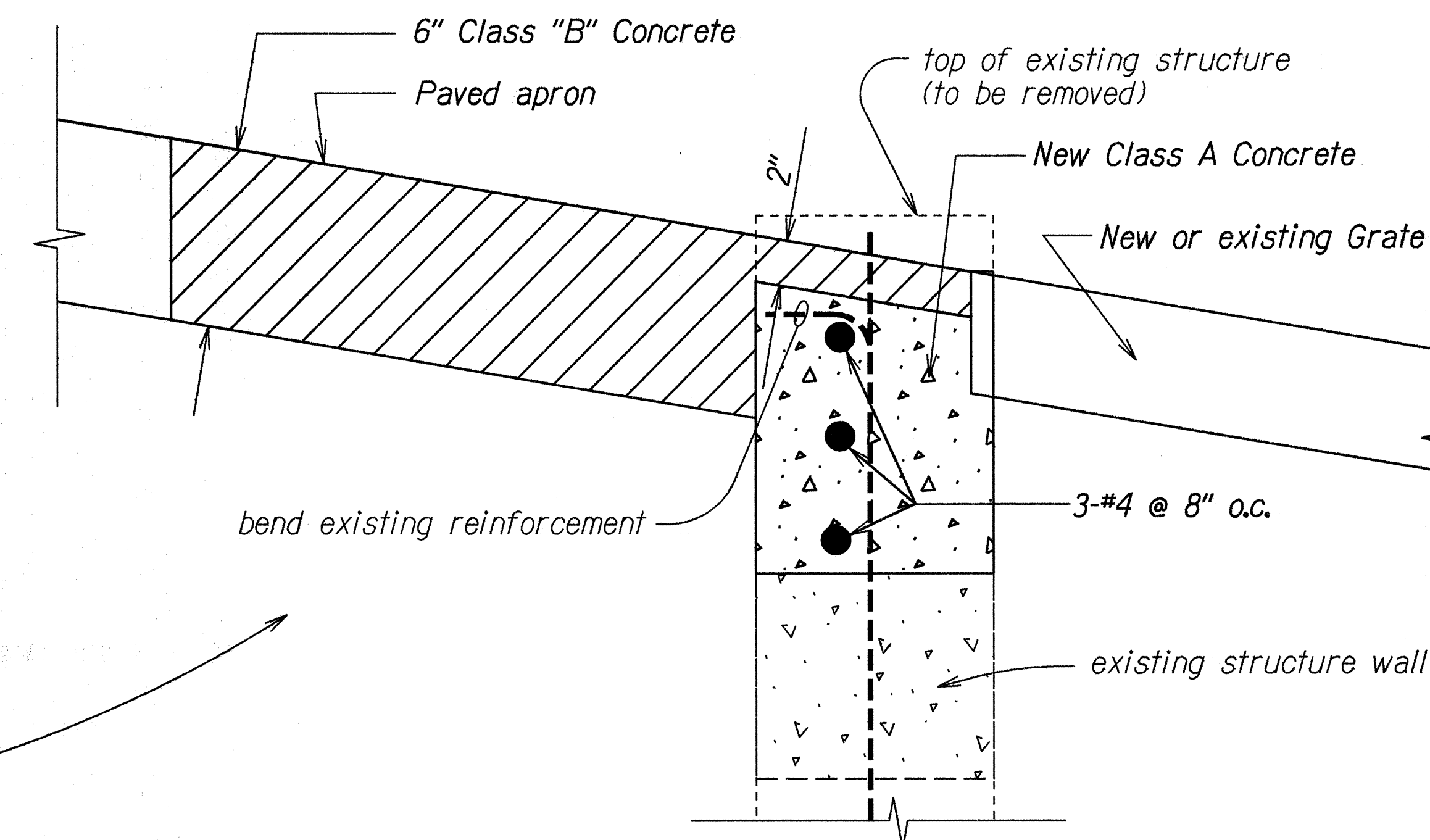

DESIGNED BY	DATE
DRAWN BY	4/97
CHECKED BY	
APPROVED BY	
NOTED BY	
QUANTITIES BY	
REVISIONS	

STATE OF HAWAII
DEPARTMENT OF TRANSPORTATION
HIGHWAYS DIVISION

DRAINAGE DETAILS

WAIEHU BEACH ROAD RESURFACING
Kahekili Highway to Kahului Beach Road
Project No. 3400B-01-97M

Scale: As Shown Date: April 1997

SHEET No. 1 OF 1 SHEETS