

Match Line
See dwg no. V25

NOTES:

1. Work on existing Honoapiilani Highway shall occur during night hours.
2. See U32 for Detour Roadway Plan.

LEGEND:

- Sign
- Work Area
- Direction of Traffic
- Concrete Barrier
- Intertial Barrier System, TL-3
- Type II Barrier

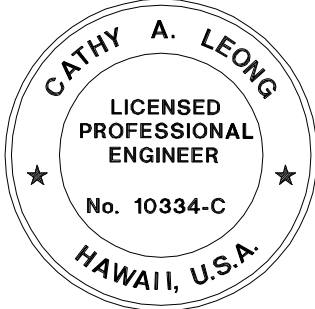

THIS WORK WAS PREPARED BY ME
OR UNDER MY SUPERVISION.

WILSON OKAMOTO CORPORATION
APRIL 30, 2020
LIC. EXP. DATE

U.S. DEPARTMENT OF TRANSPORTATION
FEDERAL HIGHWAY ADMINISTRATION
CENTRAL FEDERAL LANDS HIGHWAY DIVISION

U.S. CUSTOMARY

**SOUTHERN TERMINUS
TRAFFIC CONTROL PLAN
PHASE 1**

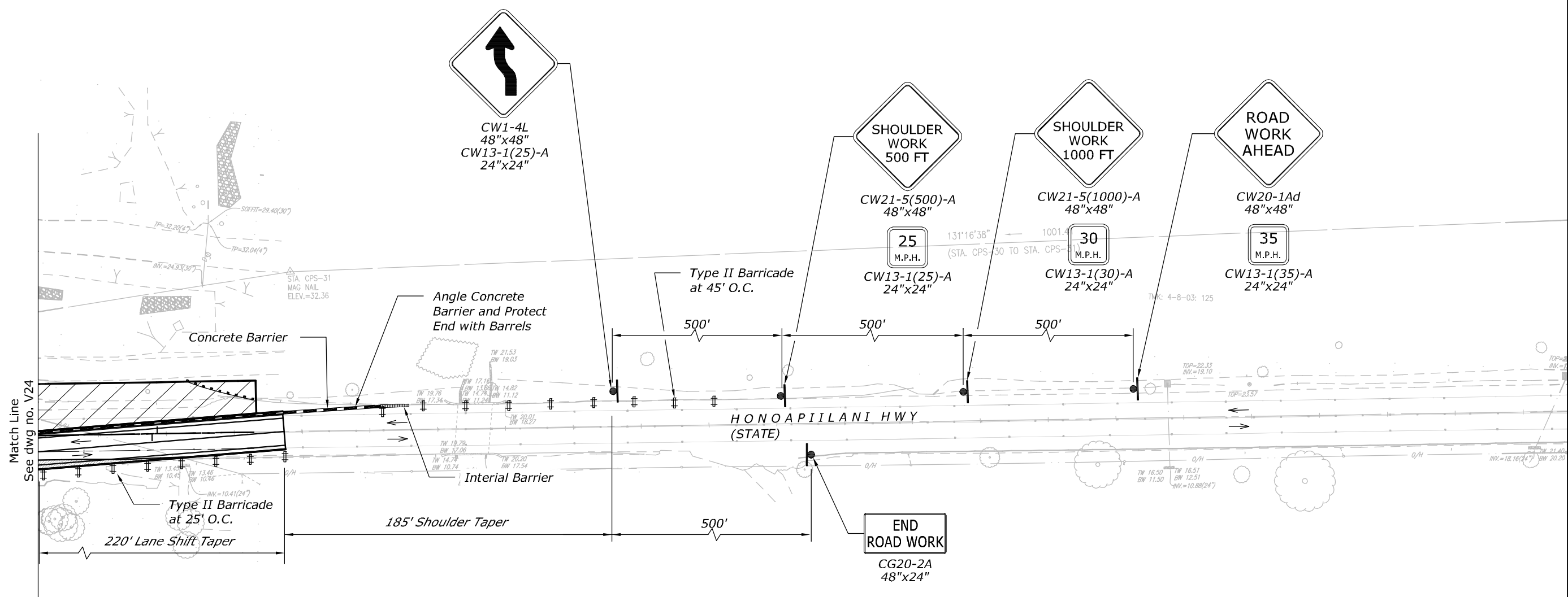
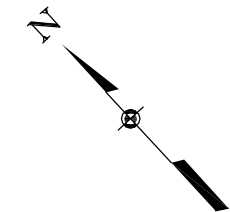

LEGEND:

- Sign
- Work Area
- Direction of Traffic
- Concrete Barrier
- Interior Barrier System, TL-3
- Type II Barrier

- NOTES:
- Work on existing Honoapiilani Highway shall occur during night hours.
 - See U32 for Detour Roadway Plan.

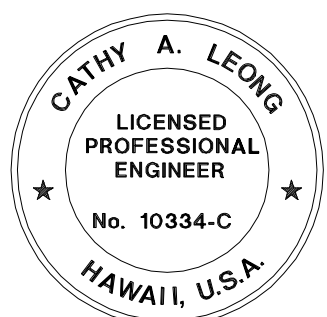
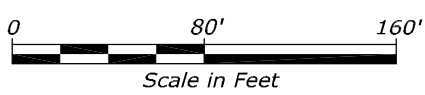

THIS WORK WAS PREPARED BY ME
OR UNDER MY SUPERVISION.

WILSON OKAMOTO CORPORATION APRIL 30, 2020
LIC. EXP. DATE

U.S. DEPARTMENT OF TRANSPORTATION
FEDERAL HIGHWAY ADMINISTRATION
CENTRAL FEDERAL LANDS HIGHWAY DIVISION

U.S. CUSTOMARY

**SOUTHERN TERMINUS
TRAFFIC CONTROL PLAN
PHASE 1**

STATE	PROJECT	SHEET NO.
HI	HI STP SR 30(1)	V26

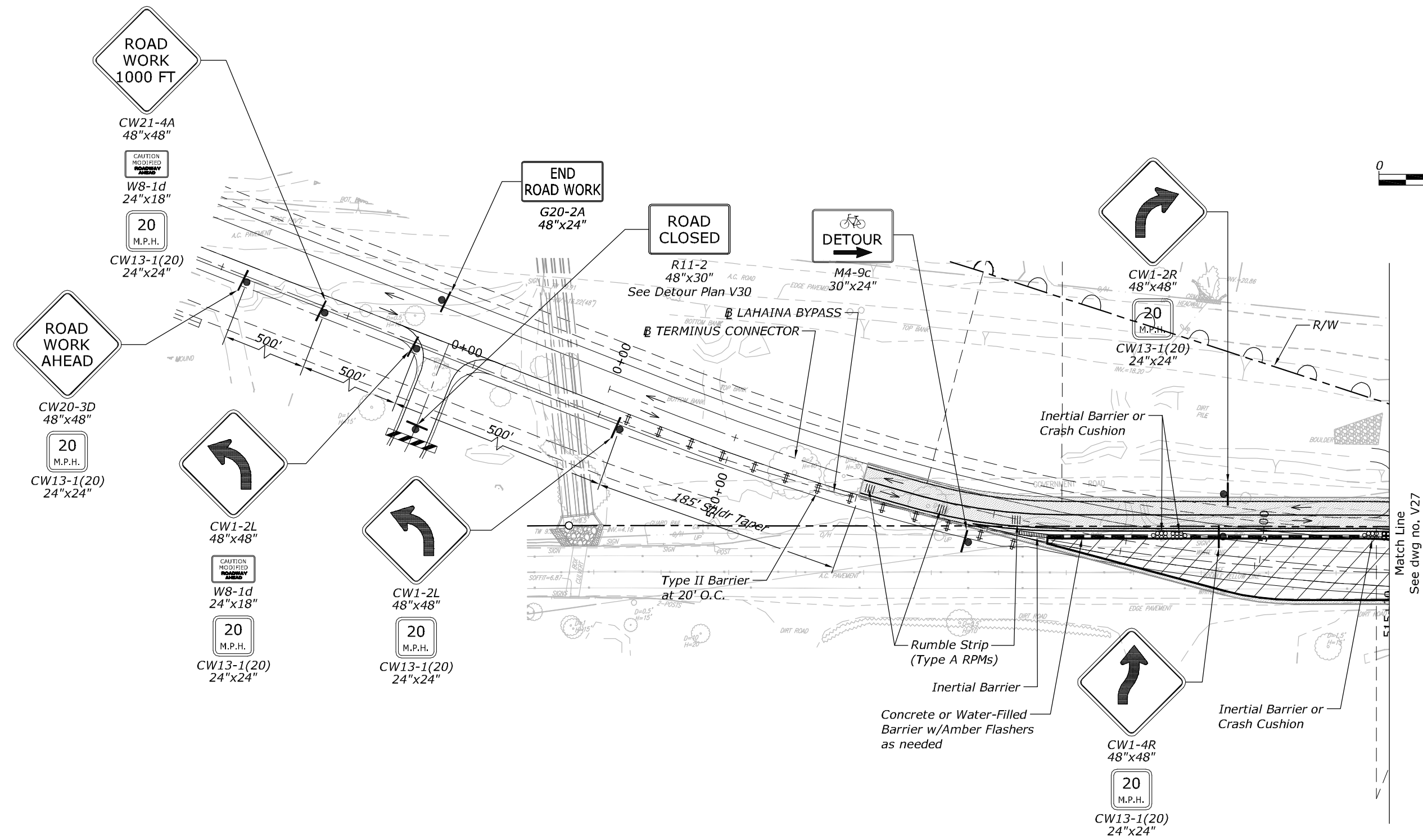
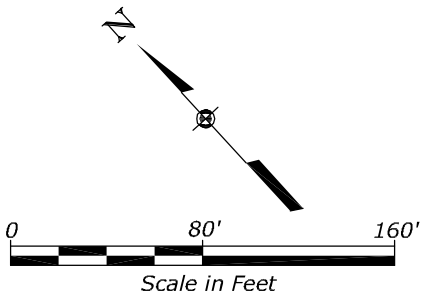

LEGEND:

- Sign
- Work Area
- Direction of Traffic
- Concrete Barrier
- Interior Barrier System, TL-3
- Type II Barrier

NOTES:

- See U33 for Detour Roadway Plan.

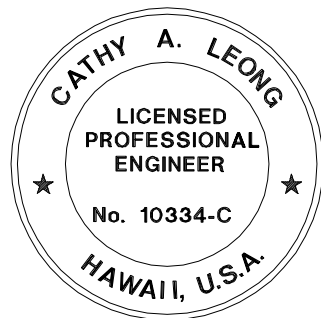

THIS WORK WAS PREPARED BY ME
OR UNDER MY SUPERVISION.
WILSON OKAMOTO CORPORATION APRIL 30, 2020
LIC. EXP. DATE

U.S. DEPARTMENT OF TRANSPORTATION
FEDERAL HIGHWAY ADMINISTRATION
CENTRAL FEDERAL LANDS HIGHWAY DIVISION
U.S. CUSTOMARY
**TRAFFIC CONTROL PLAN
SOUTHERN TERMINUS
PHASE 2**

STATE	PROJECT	SHEET NO.
HI	HI STP SR 30(1)	V27

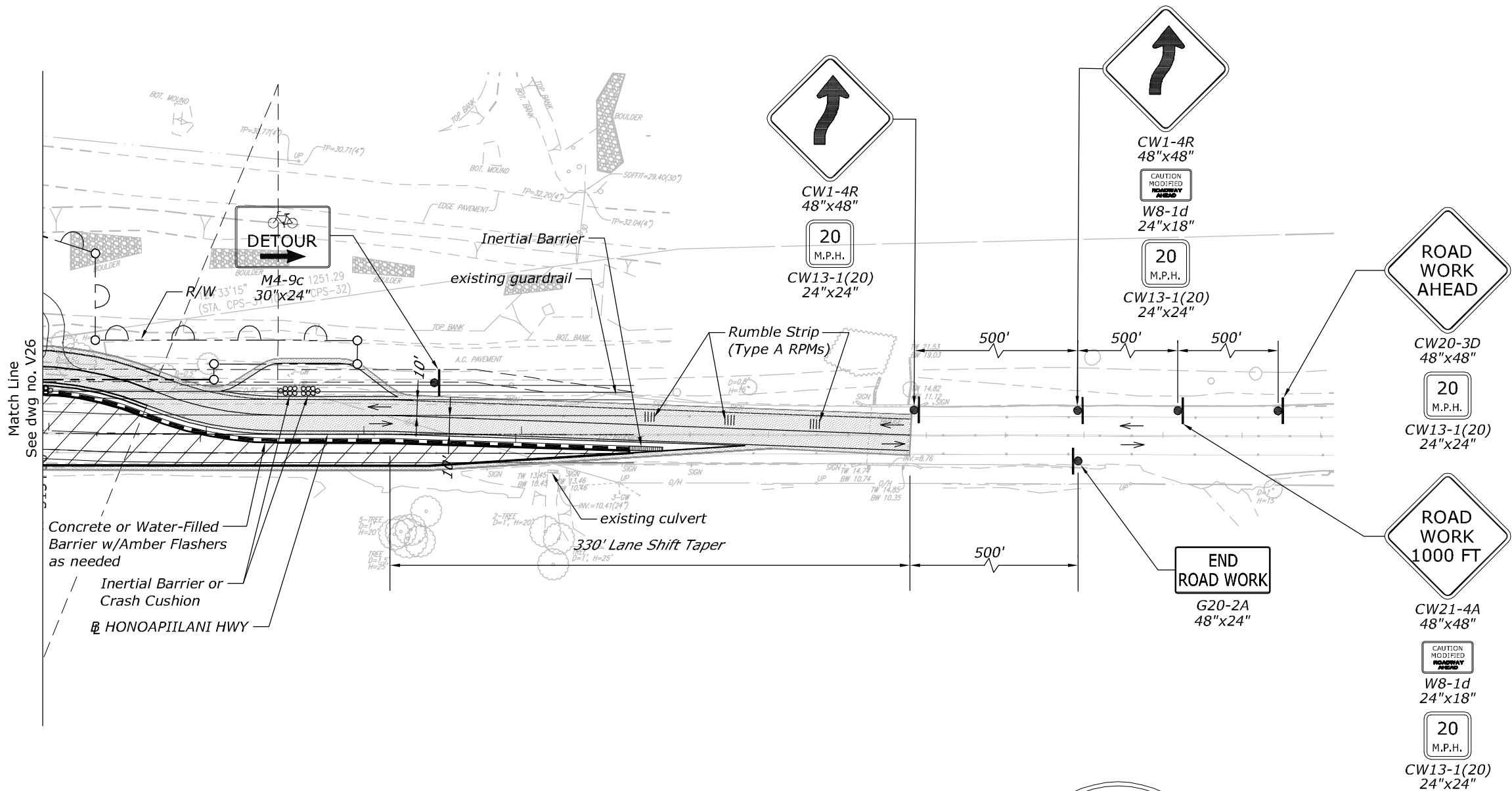
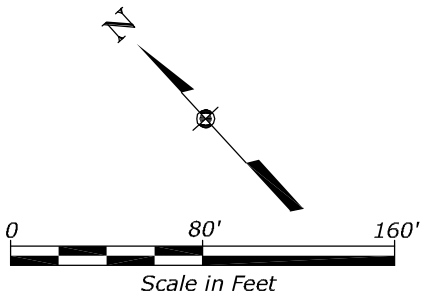

LEGEND:

- Sign
- Work Area
- Direction of Traffic
- Concrete Barrier
- Interior Barrier System, TL-3
- Type II Barrier

NOTES:

- See U33 for Detour Roadway Plan.

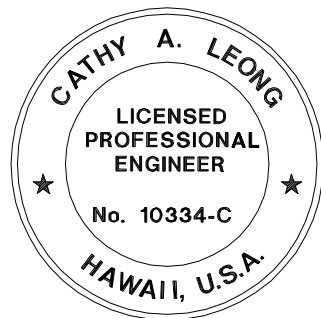

THIS WORK WAS PREPARED BY ME
OR UNDER MY SUPERVISION.
WILSON OKAMOTO CORPORATION APRIL 30, 2020
LIC. EXP. DATE

U.S. DEPARTMENT OF TRANSPORTATION
FEDERAL HIGHWAY ADMINISTRATION
CENTRAL FEDERAL LANDS HIGHWAY DIVISION

U.S. CUSTOMARY

TRAFFIC CONTROL PLAN
SOUTHERN TERMINUS
PHASE 2

STATE	PROJECT	SHEET NO.
HI	HI STP SR 30(1)	V28

LEGEND:

- Sign
- Work Area
- Direction of Traffic
- Cone or Delineator
- Police Officer/Flagger

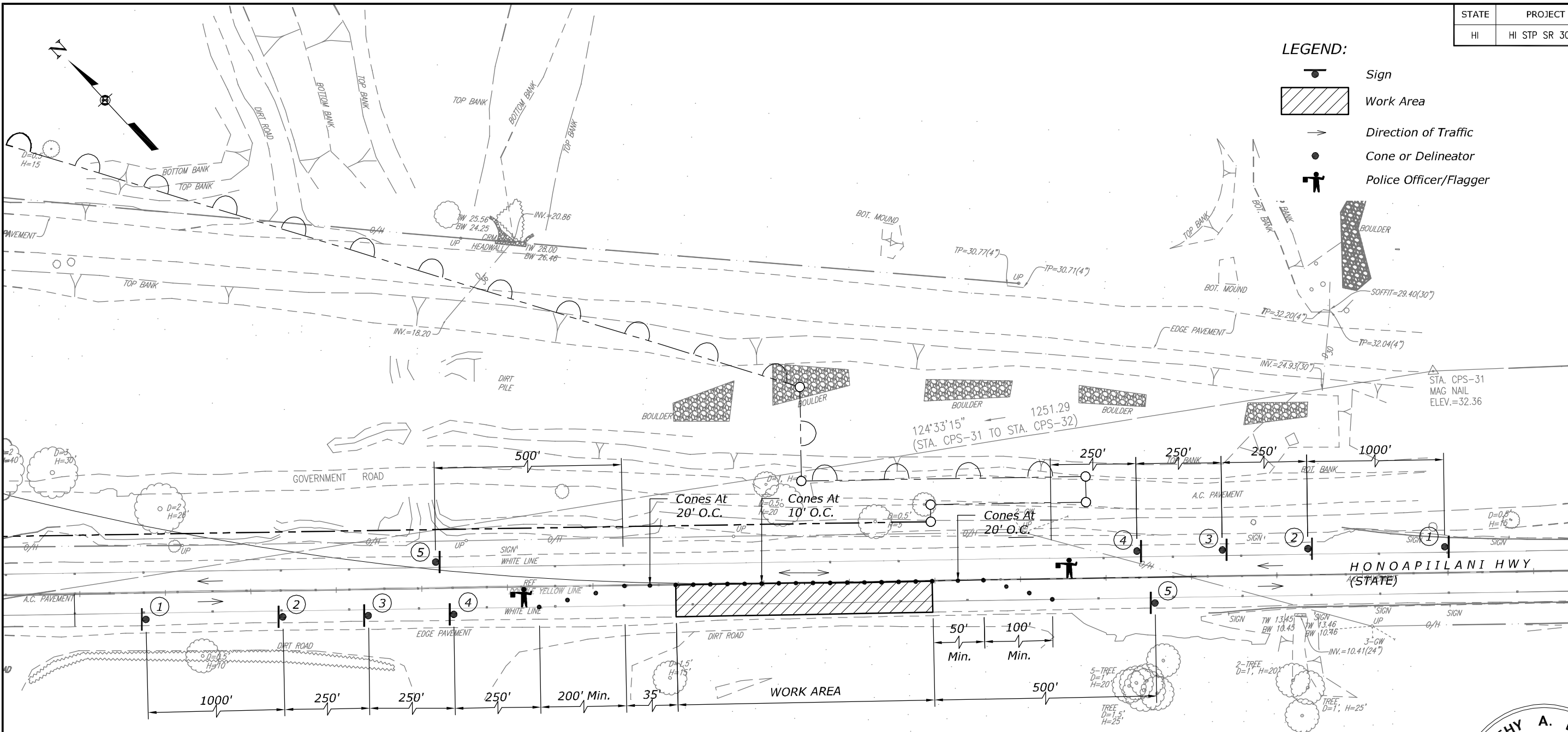

- 1. ROAD WORK AHEAD
CW21-4D
48"x48"
- 2. ROAD WORK 750 FT
CW20-1A(750)
48"x48"
- 3. ONE LANE ROAD 500 FT
CW20-4C
48"x48"
- 4. 20 M.P.H.
CW13-1(20)
24"x24"
- 5. 250 FEET
Z250FT
24"x18"
- END ROAD WORK
CG20-2A
48"x24"

NOTES:

1. Work on existing Honoapiilani Highway shall occur during night hours.

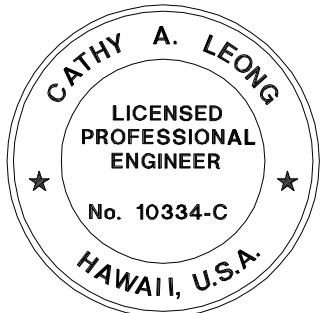

THIS WORK WAS PREPARED BY ME
OR UNDER MY SUPERVISION.

WILSON OKAMOTO CORPORATION APRIL 30, 2020
LTC. EXP. DATE

U.S. DEPARTMENT OF TRANSPORTATION
FEDERAL HIGHWAY ADMINISTRATION
CENTRAL FEDERAL LANDS HIGHWAY DIVISION

U.S. CUSTOMARY

SOUTHERN TERMINUS
TRAFFIC CONTROL PLAN
PHASE 3

STATE	PROJECT	SHEET NO.
HI	HI STP SR 30(1)	V29

LEGEND:

- Sign
- Work Area
- Direction of Traffic
- Cone or Delineator
- Police Officer/Flagger

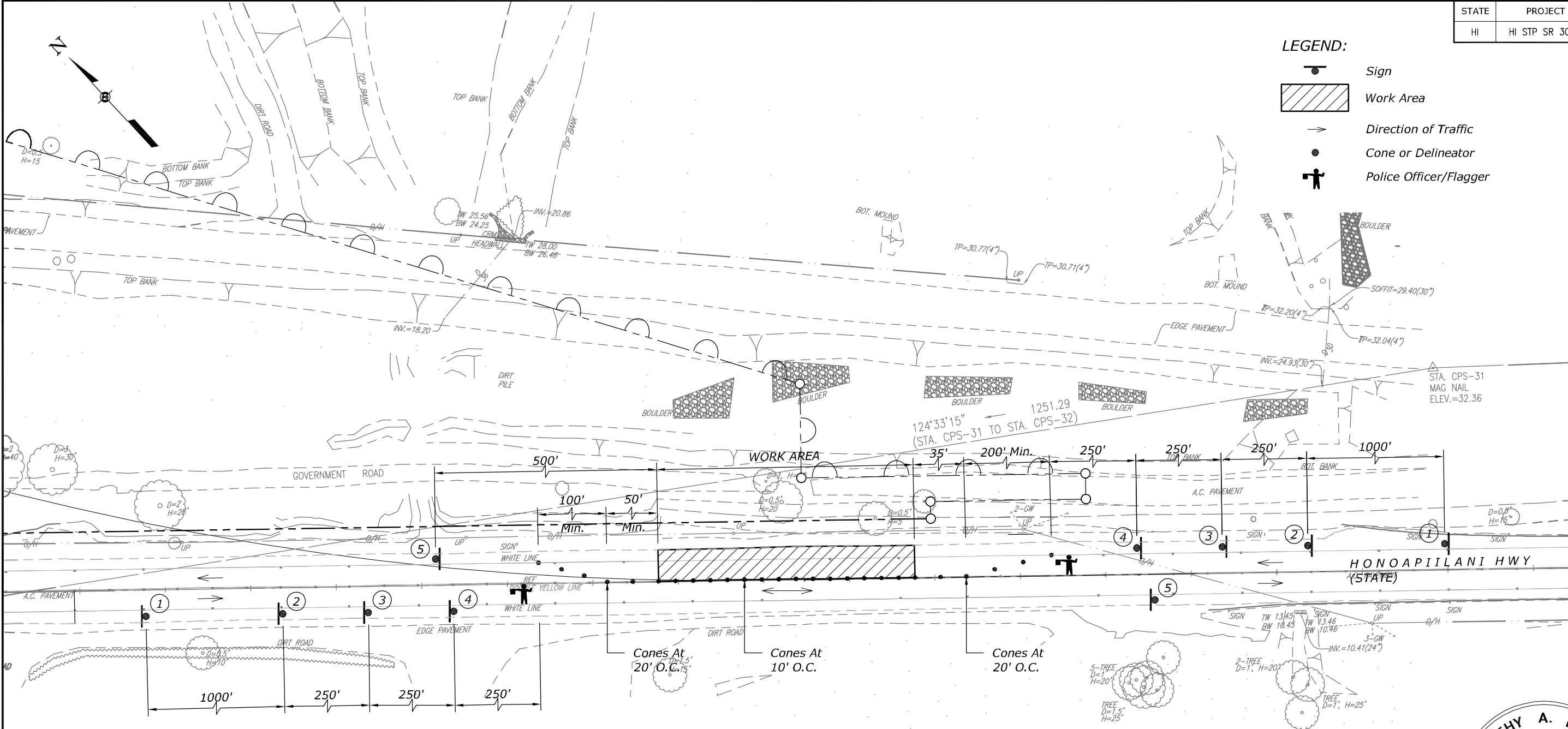

- 1

ROAD WORK AHEAD

CW21-4D
48"x48"

20
M.P.H.

CW13-1(20)
24"x24"
- 2

ROAD WORK 750 FT

CW20-1A(750)
48"x48"

20
M.P.H.

CW13-1(20)
24"x24"
- 3

ONE LANE ROAD 500 FT

CW20-4C
48"x48"
- 4

POLICE OFFICER/FLAGGER

CW20-7A
48"x48"

250
FEET

Z250FT
24"x18"
- 5

END ROAD WORK

CG20-2A
48"x24"

NOTES:

1. Work on existing Honoapiilani Highway shall occur during night hours.



THIS WORK WAS PREPARED BY ME
OR UNDER MY SUPERVISION.

WILSON OKAMOTO CORPORATION APRIL 30, 2020
LIC. EXP. DATE

U.S. DEPARTMENT OF TRANSPORTATION
FEDERAL HIGHWAY ADMINISTRATION
CENTRAL FEDERAL LANDS HIGHWAY DIVISION

U.S. CUSTOMARY

SOUTHERN TERMINUS
TRAFFIC CONTROL PLAN
PHASE 4

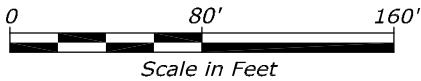

STATE	PROJECT	SHEET NO.
HI	HI STP SR 30(1)	V30

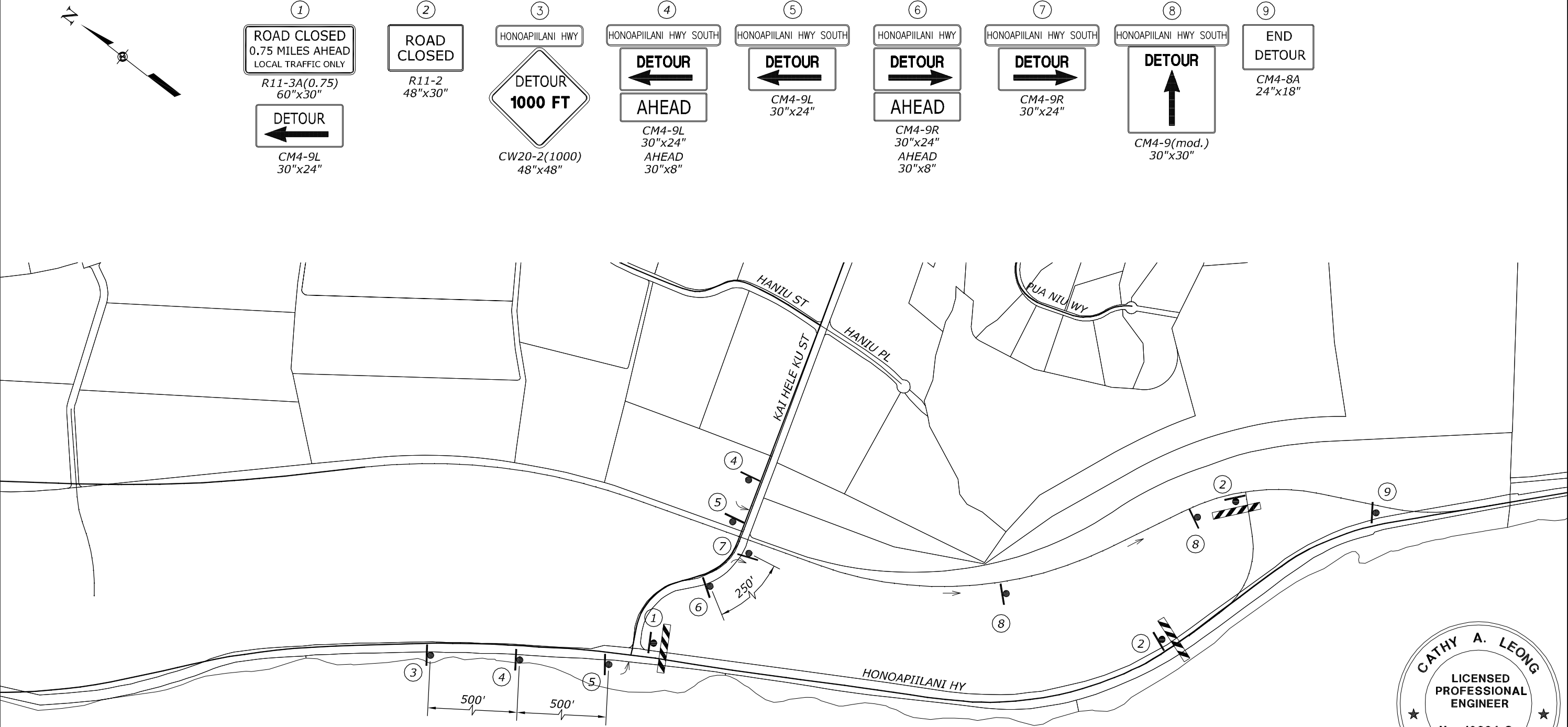

LEGEND:

- Sign
- Type III Barricade
- Detour Route

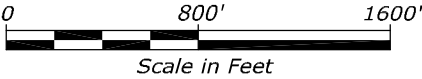

NOTES:

1. Work on existing Honoapiilani Highway shall occur during night hours.

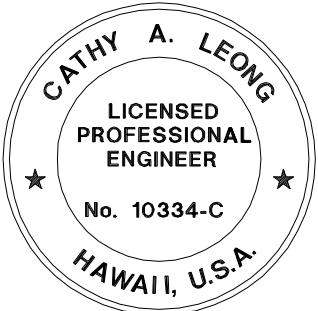

THIS WORK WAS PREPARED BY ME
OR UNDER MY SUPERVISION.

WILSON OKAMOTO CORPORATION APRIL 30, 2020
L.I.C. EXP. DATE

U.S. DEPARTMENT OF TRANSPORTATION
FEDERAL HIGHWAY ADMINISTRATION
CENTRAL FEDERAL LANDS HIGHWAY DIVISION

U.S. CUSTOMARY

HONOAPIILANI HIGHWAY
DETOUR