

INDEX TO DRAWINGS	
SHEET NO.	DESCRIPTION
1	TITLE SHEET
2	STANDARD PLANS SUMMARY
3	GENERAL NOTES AND LEGEND
4	TYPICAL SECTIONS & DETAILS
5 - 6	WATER POLLUTION & EROSION CONTROL NOTES
7 - 28	ROADWAY PLANS
29 - 30	DRAINAGE DETAILS
31 - 33	MISCELLANEOUS SUMMARIES
34	WORK ZONE SIGNING PLAN, NOTES & DETAILS
35	PAVEMENT MARKING LEGEND, DETAILS, NOTES & SIGN PANEL LAYOUT
36 - 57	SIGNING & PAVEMENT MARKING PLANS
58 - 66	GUARDRAIL DETAILS & NOTES
67 - 84	BRIDGE DETAILS
85 - 88	CATTLE GUARD SECTIONS & DETAILS

STATE OF HAWAII

DEPARTMENT OF TRANSPORTATION

HIGHWAYS DIVISION

HONOLULU, HAWAII

"AS-BUILT"

PLANS FOR

HALEAKALA CRATER ROAD

RESURFACING

KEKAULIKE AVENUE TO HALEAKALA NATIONAL PARK

PROJECT NO. 378A-01-04M

DISTRICT OF MAKAWAO

ISLAND OF MAUI

FED. ROAD DIST. NO.	STATE	PROJ. NO.	FISCAL YEAR	SHEET NO.	TOTAL SHEETS
HAWAII	HAW.	378A-01-04M	2004	1	88

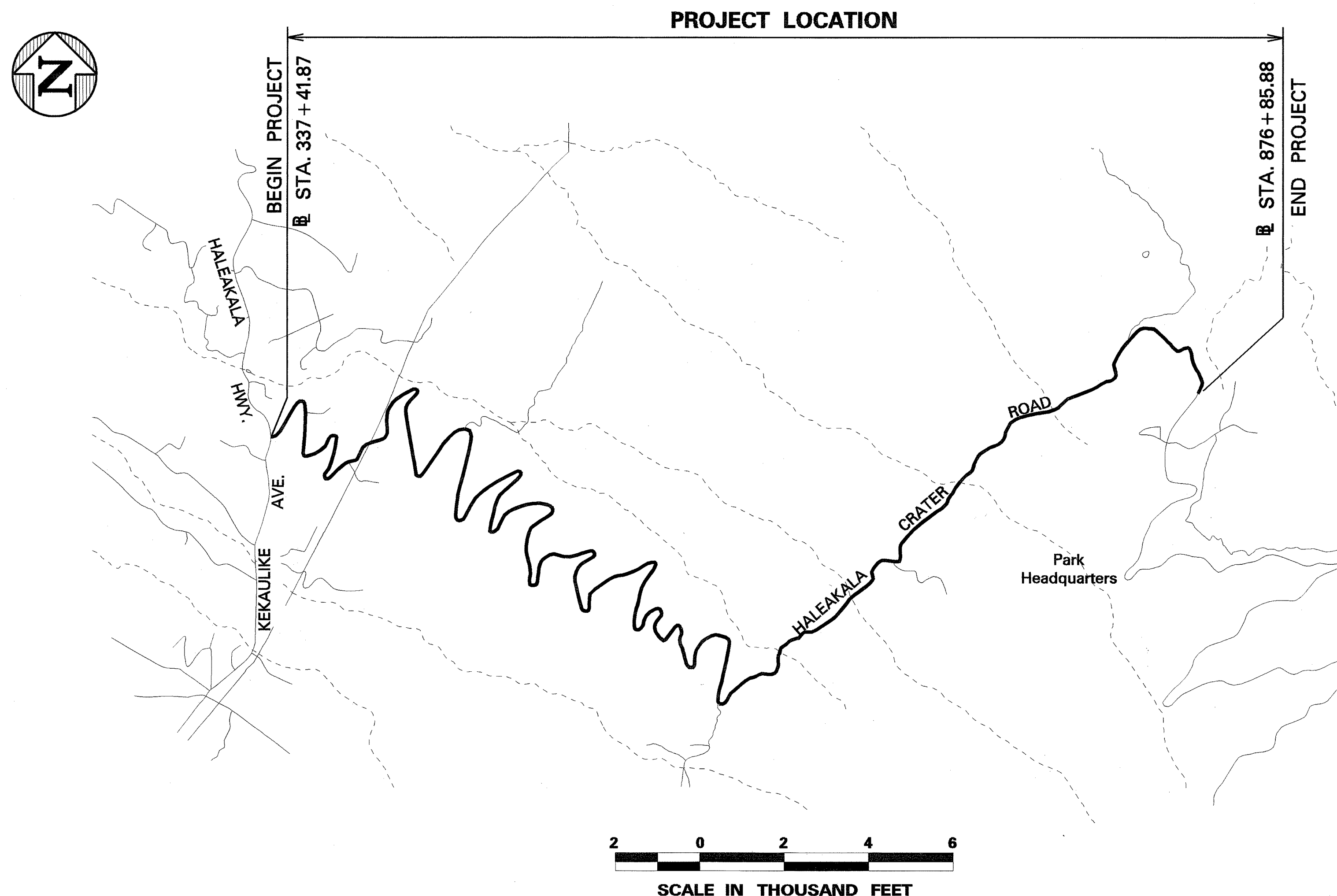
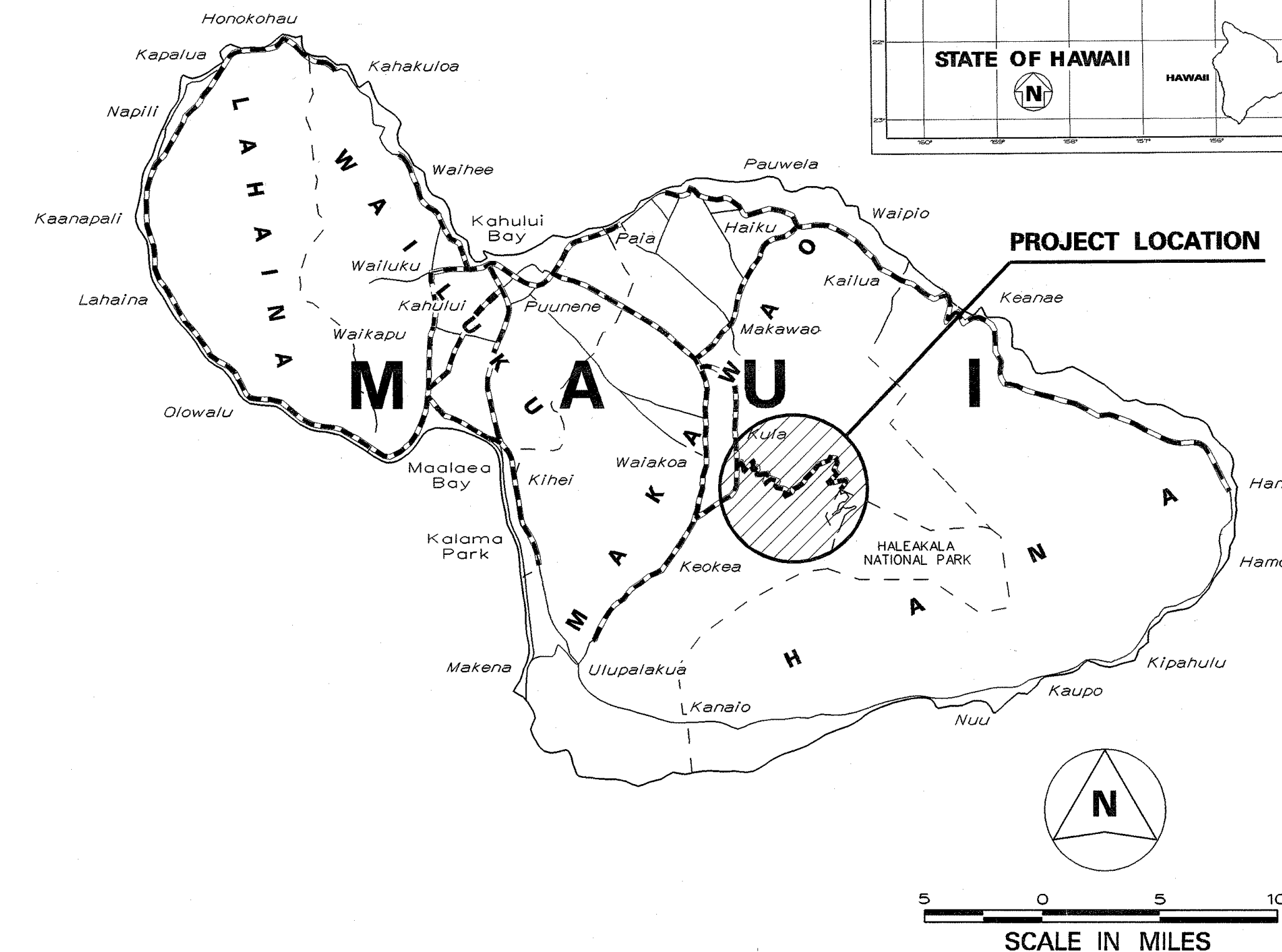
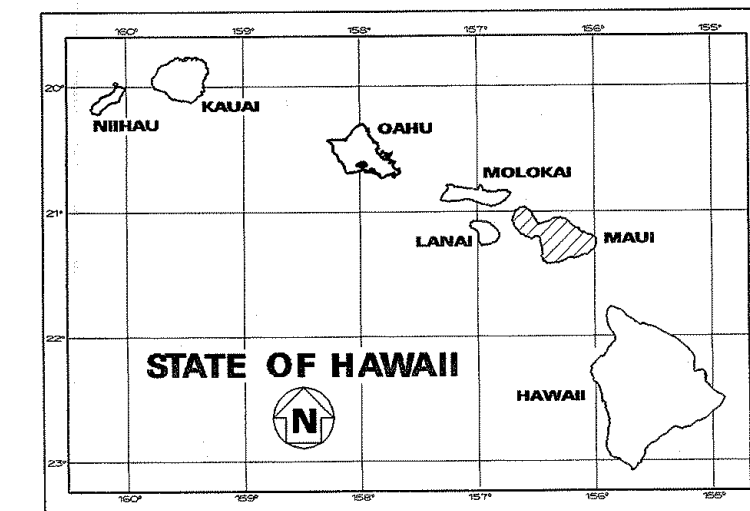

----- FEDERAL AID PROJECTS PREVIOUSLY CONSTRUCTED OR UNDER CONSTRUCTION

MILE POST 0 TO MILE POST 10.15

CHANGES MADE DURING CONSTRUCTION HAVE BEEN INCORPORATED ON THESE PLANS EXCEPT CHANGES IN THE ORIGINAL THEORETICAL QUANTITIES. FOR ACTUAL QUANTITIES, REFER TO PROJECT LEDGER AND/OR COMPUTATION BOOK.

Charles R. Brown *CRB* *10/2/08*
for RESIDENT ENGINEER DATE

DEPARTMENT OF TRANSPORTATION
STATE OF HAWAII

APPROVED:

Shawn M. Goss *SMG* *5/4/04*
for DIR. OF TRANSPORTATION DATE

DESIGNED BY HWY-M 873-3535 January, 2004
P. S. & E. BY HWY-ME PHONE DATE