

| FED. ROAD DIST. NO. | STATE | PROJ. NO. | FISCAL YEAR | SHEET NO. | TOTAL SHEETS |
|---------------------|-------|-------------|-------------|-----------|--------------|
| HAWAII | HAW. | 377B-01-96M | 1996 | 20 | 28 |

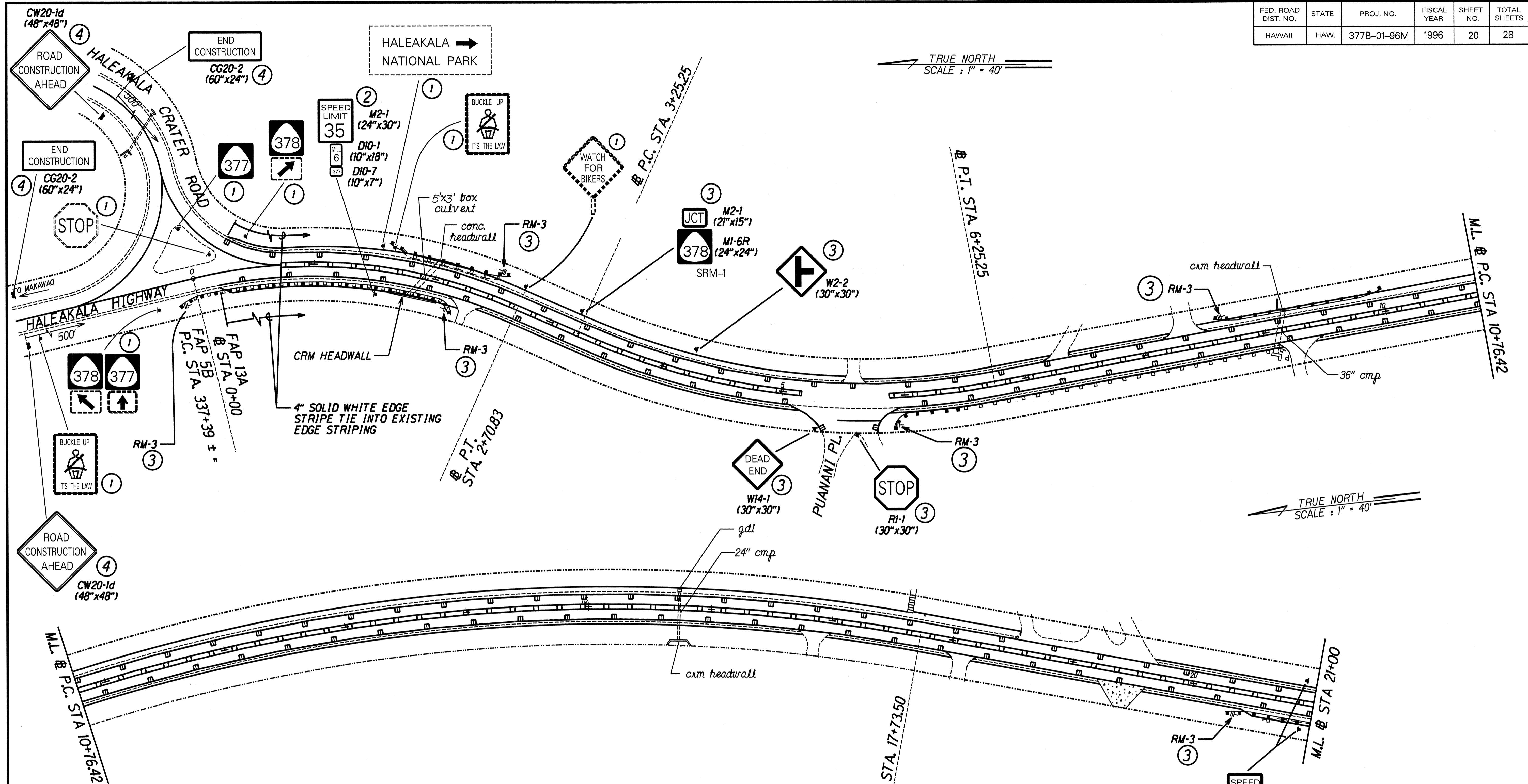

TRUE NORTH
SCALE: 1" = 40'

TRUE NORTH
SCALE: 1" = 40'

- KEY TO SIGNAGE:**
- ① Existing Sign (s) and Post (s) to remain.
 - ② Relocated Existing Sign (s) and Post (s)
 - ③ Remove Existing and Install New Sign (s) and Post (s).
 - ④ Install New Sign (s) and Post (s).

| | |
|-------------------|------|
| SURVEY PLOTTED BY | DATE |
| DRAWN BY | |
| DESIGNED BY | |
| QUANTITIES BY | |
| CHECKED BY | |
| ORIGINAL PLAN | |
| NOTE BOOK | |
| N. | |

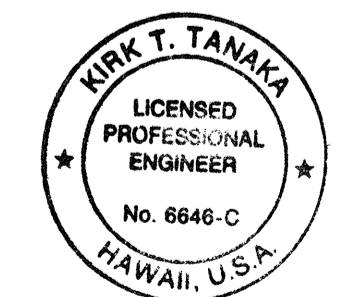

THIS WORK WAS PREPARED BY ME OR UNDER MY SUPERVISION
Kirk T. Tanaka

R. T. TANAKA ENGINEERS, INC.
CIVIL ENGINEERING - LAND SURVEYING

STATE OF HAWAII
DEPARTMENT OF TRANSPORTATION
HIGHWAYS DIVISION

SIGNING AND PAVEMENT MARKING PLAN

KEKAULIKE AVENUE RESURFACING
HALEAKALA CRATER ROAD
TO KULA HIGHWAY
PROJECT NO. 377B-01-96M

Scale: 1" = 40' Date: APRIL, 1996

SHEET No. 1 OF 8 SHEETS

| FED. ROAD DIST. NO. | STATE | PROJ. NO. | FISCAL YEAR | SHEET NO. | TOTAL SHEETS |
|---------------------|-------|-------------|-------------|-----------|--------------|
| HAWAII | HAW. | 377B-01-96M | 1996 | 21 | 28 |

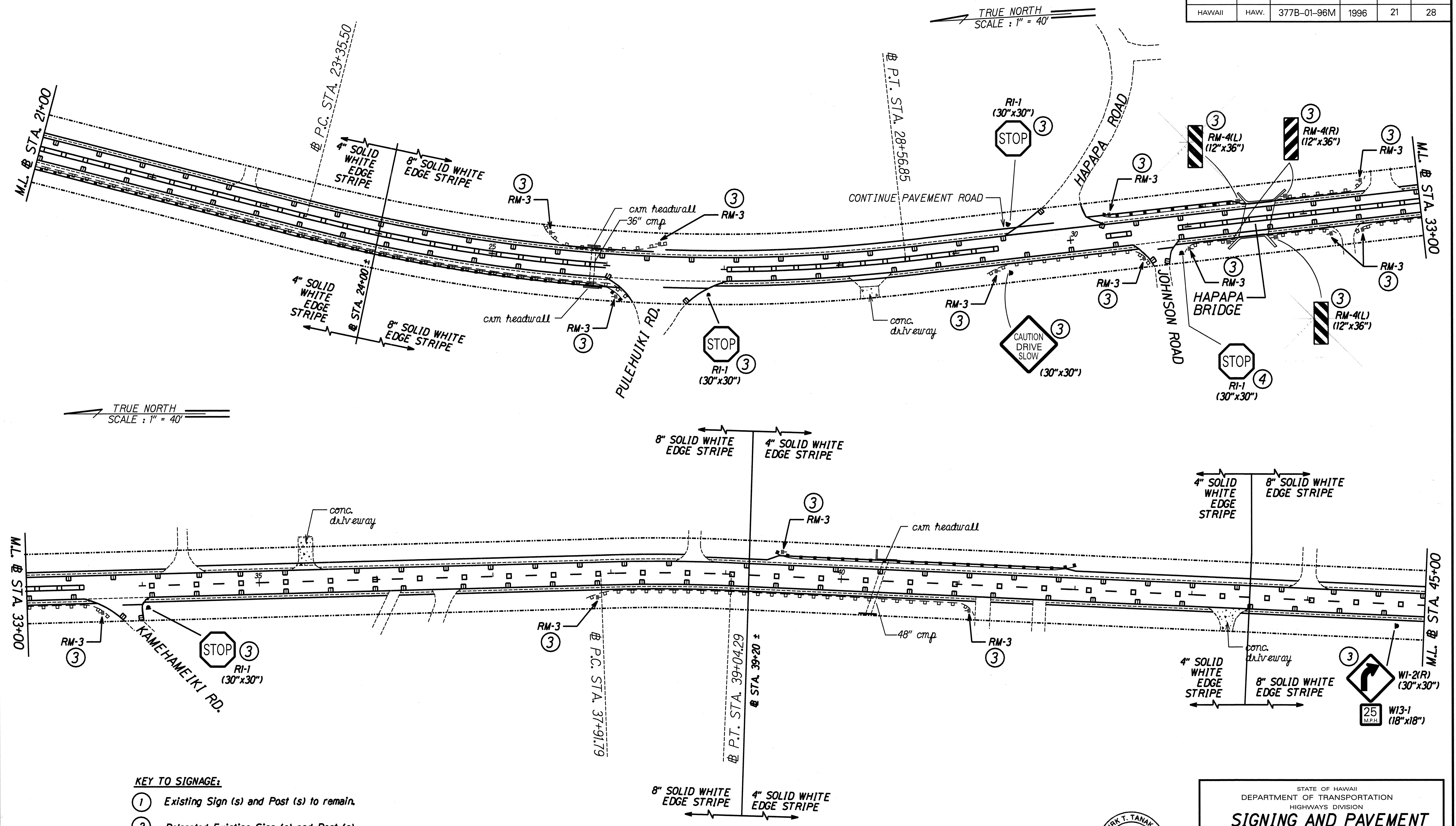

TRUE NORTH
SCALE : 1" = 40'

- KEY TO SIGNAGE:**
- ① Existing Sign (s) and Post (s) to remain.
 - ② Relocated Existing Sign (s) and Post (s)
 - ③ Remove Existing and Install New Sign (s) and Post (s).
 - ④ Install New Sign (s) and Post (s).

| | |
|-------------------|------|
| SURVEY PLOTTED BY | DATE |
| DRAWN BY | |
| DESIGNED BY | |
| QUANTITIES BY | |
| CHECKED BY | |
| ORIGINAL PLAN | |
| NOTE BOOK | |
| | |

KIRK T. TANAKA
LICENSED PROFESSIONAL ENGINEER
No. 8848-C
HAWAII, U.S.A.

THIS WORK WAS PREPARED BY ME OR UNDER MY SUPERVISION
K. J. Jank
R. T. TANAKA ENGINEERS, INC.
CIVIL ENGINEERING - LAND SURVEYING

STATE OF HAWAII
DEPARTMENT OF TRANSPORTATION
HIGHWAYS DIVISION

SIGNING AND PAVEMENT MARKING PLAN

KEKAULIKE AVENUE RESURFACING
HALEAKALA CRATER ROAD
TO KULA HIGHWAY
PROJECT NO. 377B-01-96M

Scale: 1" = 40' Date: APRIL, 1996

| FED. ROAD DIST. NO. | STATE | PROJ. NO. | FISCAL YEAR | SHEET NO. | TOTAL SHEETS |
|---------------------|-------|-------------|-------------|-----------|--------------|
| HAWAII | HAW. | 377B-01-96M | 1996 | 22 | 28 |

TRUE NORTH
SCALE: 1" = 40'

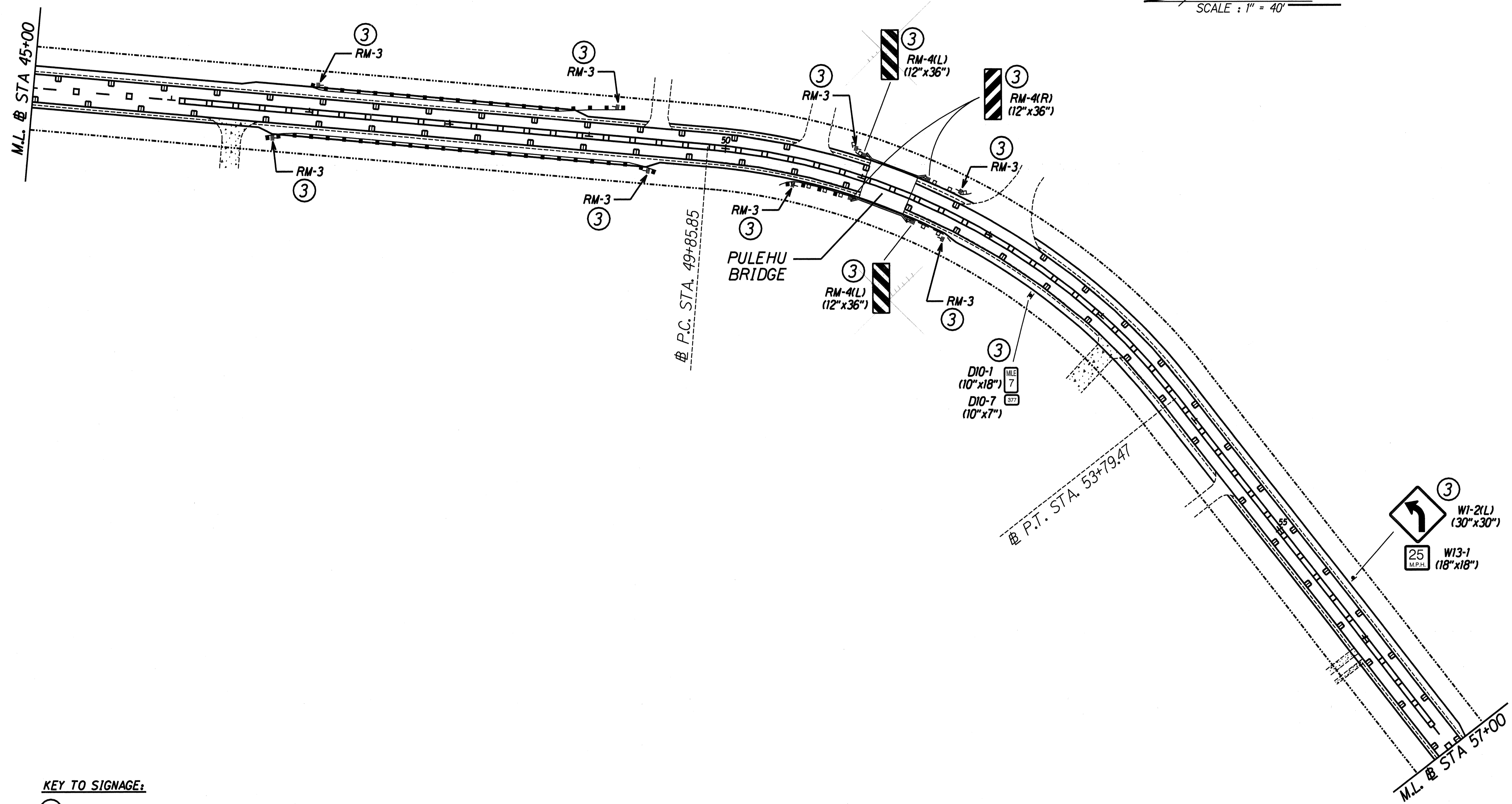

- KEY TO SIGNAGE:**
- ① Existing Sign (s) and Post (s) to remain.
 - ② Relocated Existing Sign (s) and Post (s)
 - ③ Remove Existing and Install New Sign (s) and Post (s).
 - ④ Install New Sign (s) and Post (s).

| | |
|-------------------|------|
| SURVEY PLATTER BY | DATE |
| DRAWN BY | |
| TRACED BY | |
| QUANTITIES BY | |
| CHECKED BY | |
| ORIGINAL PLAN | |
| NOTE BOOK | |
| No. | |

KIRK T. TANAKA
LICENSED PROFESSIONAL ENGINEER
No. 6648-C
HAWAII, U.S.A.

THIS WORK WAS PREPARED BY ME OR UNDER MY SUPERVISION
K. J. Jamila
K. T. TANAKA ENGINEERS, INC.
CIVIL ENGINEERING - LAND SURVEYING

STATE OF HAWAII
DEPARTMENT OF TRANSPORTATION
HIGHWAYS DIVISION

SIGNING AND PAVEMENT MARKING PLAN

KEKAULIKE AVENUE RESURFACING
HALEAKALA CRATER ROAD
TO KULA HIGHWAY

PROJECT NO. 377B-01-96M
Scale: 1" = 40' Date: APRIL, 1996

SHEET No. 3 OF 8 SHEETS

| FED. ROAD DIST. NO. | STATE | PROJ. NO. | FISCAL YEAR | SHEET NO. | TOTAL SHEETS |
|---------------------|-------|-------------|-------------|-----------|--------------|
| HAWAII | HAW. | 377B-01-96M | 1996 | 23 | 28 |

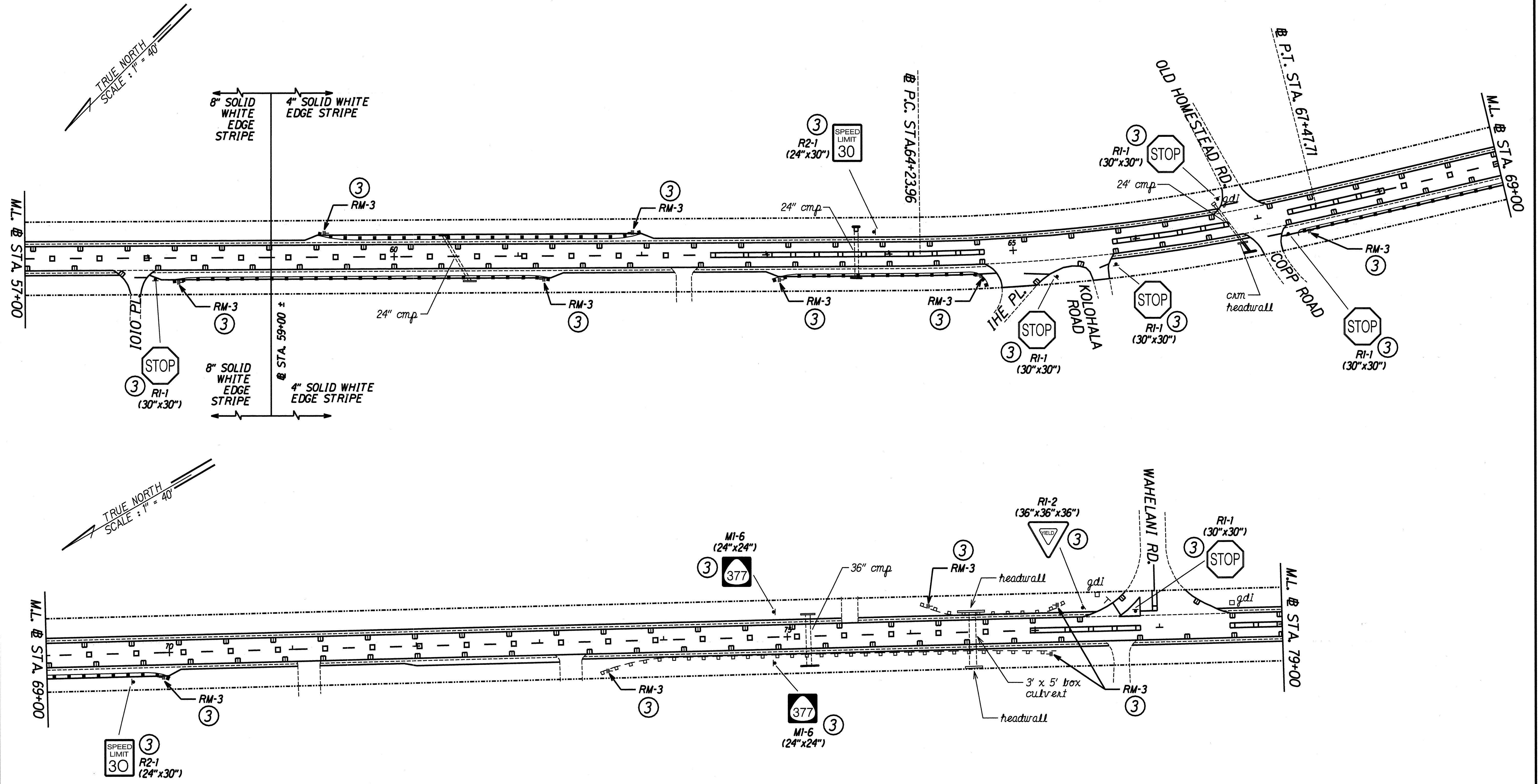

- KEY TO SIGNAGE:**
- ① Existing Sign (s) and Post (s) to remain.
 - ② Relocated Existing Sign (s) and Post (s)
 - ③ Remove Existing and Install New Sign (s) and Post (s).
 - ④ Install New Sign (s) and Post (s).

| | |
|-------------------|------|
| SURVEY PLOTTED BY | DATE |
| DRAWN BY | |
| DESIGNED BY | |
| QUANTITIES BY | |
| CHECKED BY | |
| ORIGINAL PLAN | |
| NOTE BOOK | |
| No. | |

THIS WORK WAS PREPARED BY
 ME OR UNDER MY SUPERVISION
Kirk T. Tanaka
R. T. TANAKA ENGINEERS, INC.
 CIVIL ENGINEERING - LAND SURVEYING

STATE OF HAWAII
 DEPARTMENT OF TRANSPORTATION
 HIGHWAYS DIVISION
SIGNING AND PAVEMENT MARKING PLAN
**KEKAULIKE AVENUE RESURFACING
 HALEAKALA CRATER ROAD
 TO KULA HIGHWAY**
PROJECT NO. 377B-01-96M
 Scale: 1" = 40' Date: APRIL, 1996
 SHEET No. 4 OF 8 SHEETS

| FED. ROAD DIST. NO. | STATE | PROJ. NO. | FISCAL YEAR | SHEET NO. | TOTAL SHEETS |
|---------------------|-------|-------------|-------------|-----------|--------------|
| HAWAII | HAW. | 377B-01-96M | 1996 | 24 | 28 |

TRUE NORTH
SCALE: 1" = 40'

TRUE NORTH
SCALE: 1" = 40'

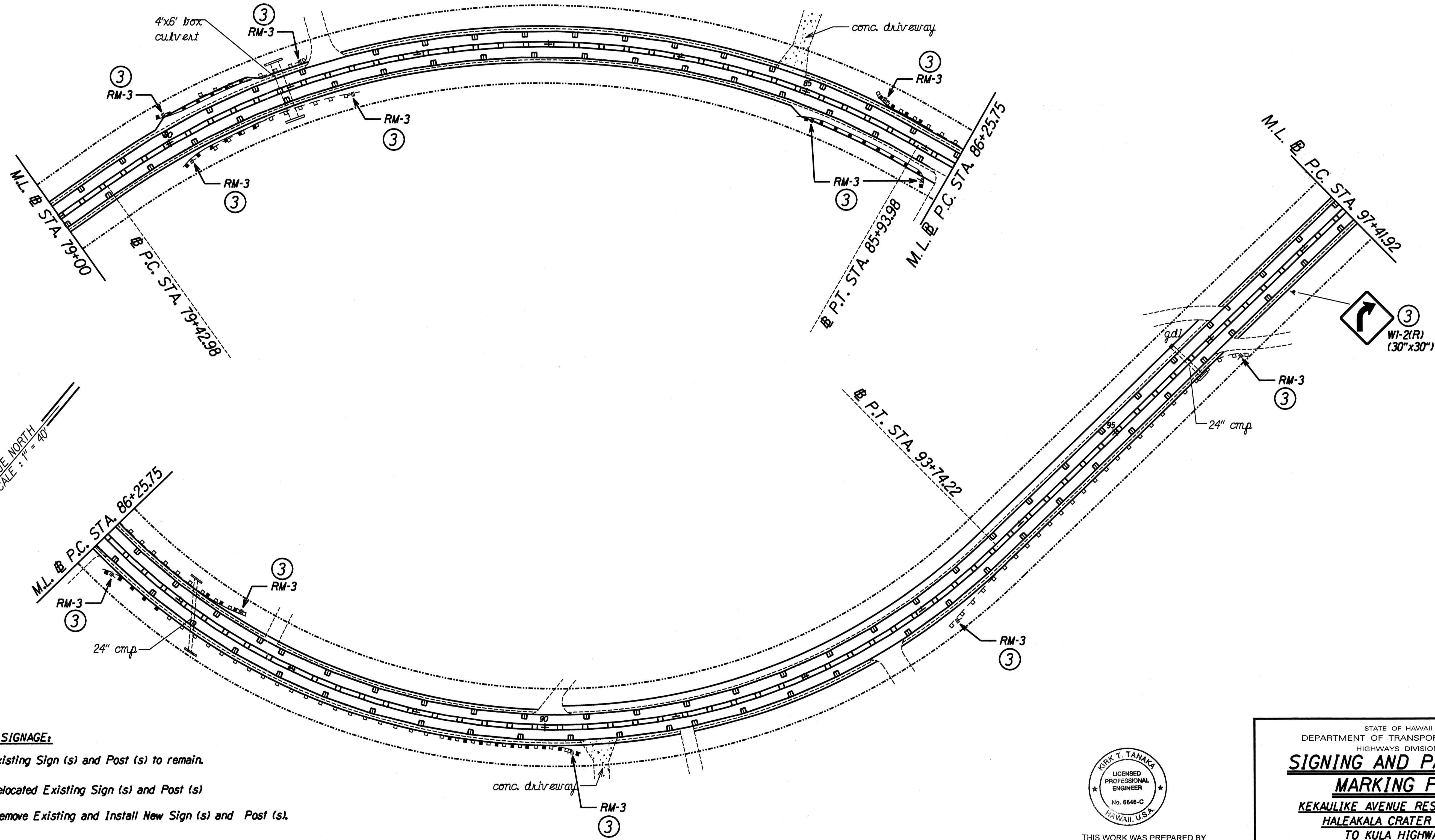

KEY TO SIGNAGE:

- ① Existing Sign (s) and Post (s) to remain.
- ② Relocated Existing Sign (s) and Post (s)
- ③ Remove Existing and Install New Sign (s) and Post (s).
- ④ Install New Sign (s) and Post (s).

| | |
|-------------------|------|
| SURVEY PLOTTED BY | DATE |
| DRAWN BY | |
| DESIGNED BY | |
| CHECKED BY | |
| ORIGINAL PLAN | |
| NOTE BOOK | |
| NO. | |

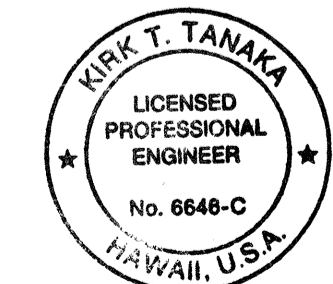

THIS WORK WAS PREPARED BY ME OR UNDER MY SUPERVISION
K. T. Tanaka
K. T. TANAKA ENGINEERS, INC.
CIVIL ENGINEERING - LAND SURVEYING

STATE OF HAWAII
DEPARTMENT OF TRANSPORTATION
HIGHWAYS DIVISION

SIGNING AND PAVEMENT MARKING PLAN

**KEKAULIKE AVENUE RESURFACING
HALEAKALA CRATER ROAD
TO KULA HIGHWAY**

PROJECT NO. 377B-01-96M

Scale: 1" = 40' Date: APRIL, 1996

| FED. ROAD DIST. NO. | STATE | PROJ. NO. | FISCAL YEAR | SHEET NO. | TOTAL SHEETS |
|---------------------|-------|-------------|-------------|-----------|--------------|
| HAWAII | HAW. | 377B-01-96M | 1996 | 25 | 28 |

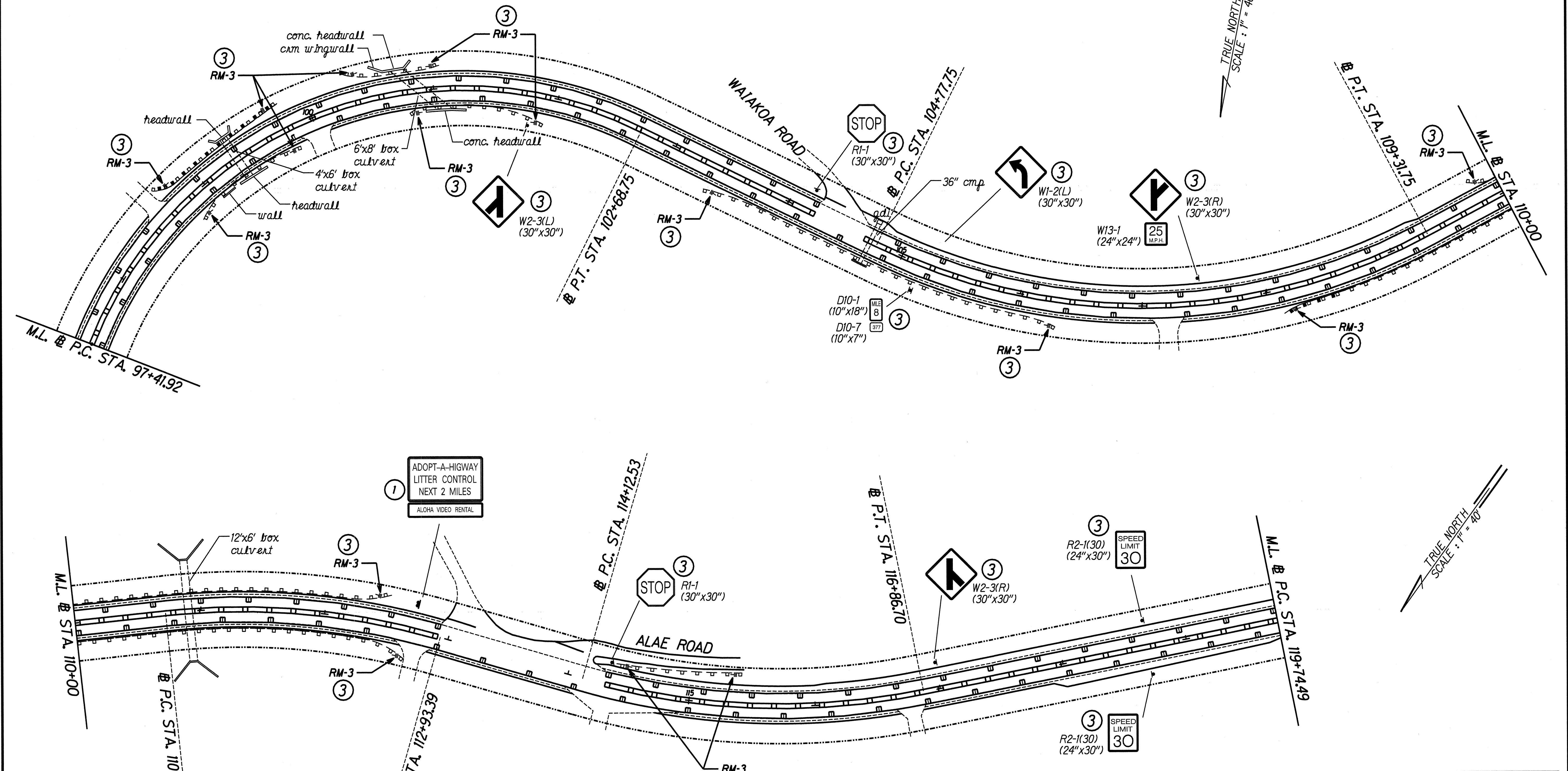

| | |
|-------------------|------|
| SURVEY PLOTTED BY | DATE |
| DRAWN BY | |
| DESIGNED BY | |
| CHECKED BY | |
| ORIGINAL PLAN | |
| NOTE BOOK | |

- KEY TO SIGNAGE:**
- ① Existing Sign (s) and Post (s) to remain.
 - ② Relocated Existing Sign (s) and Post (s)
 - ③ Remove Existing and Install New Sign (s) and Post (s).
 - ④ Install New Sign (s) and Post (s).

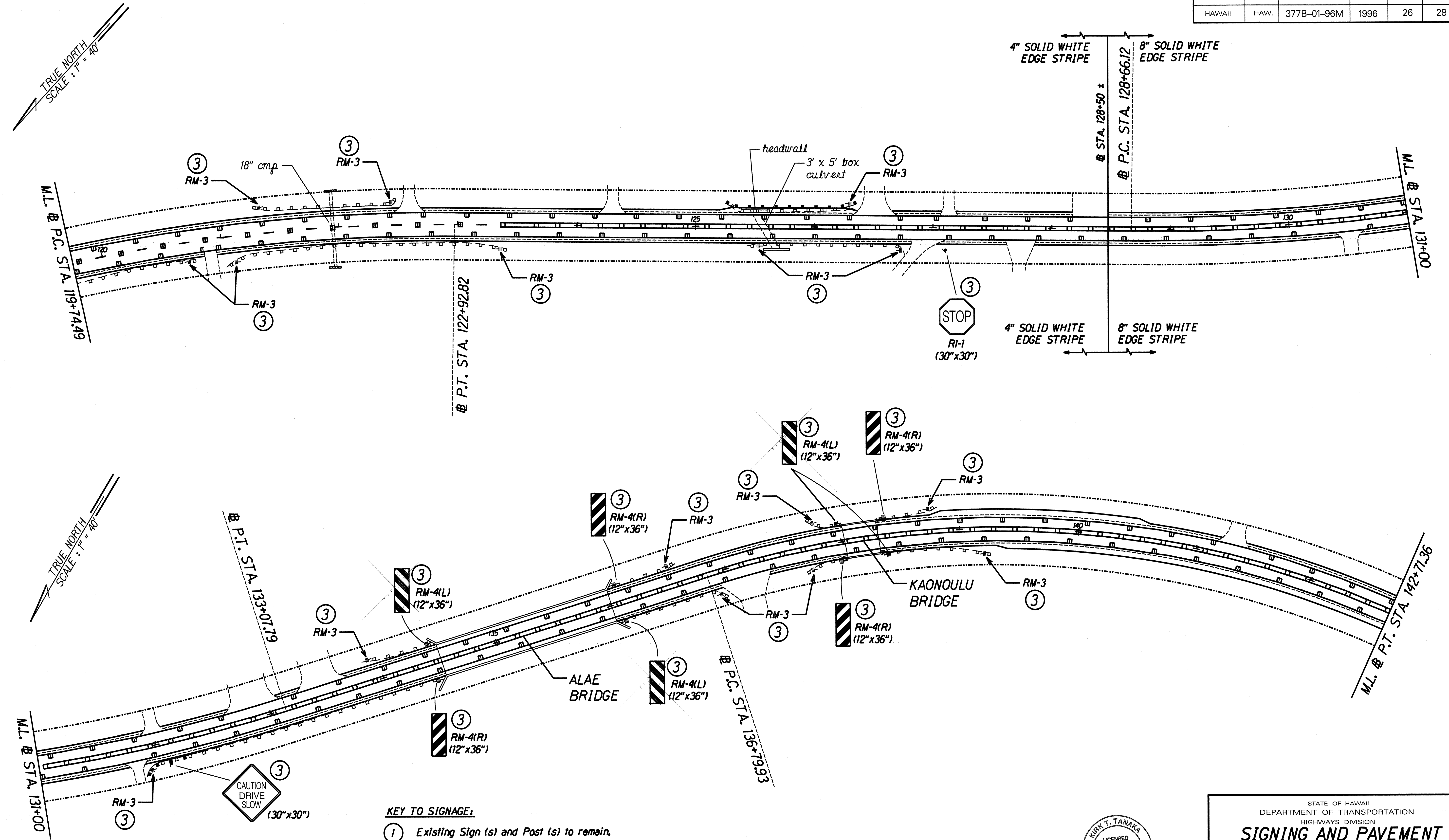

 THIS WORK WAS PREPARED BY
 ME OR UNDER MY SUPERVISION
R. T. Tanaka
R. T. TANAKA ENGINEERS, INC.
 CIVIL ENGINEERING - LAND SURVEYING

STATE OF HAWAII
 DEPARTMENT OF TRANSPORTATION
 HIGHWAYS DIVISION
ROADWAY PLAN
KEKAULIKE AVENUE RESURFACING
HALEAKALA CRATER ROAD
TO KULA HIGHWAY
PROJECT NO. 377B-01-96M
 Scale: 1" = 40' Date: APRIL, 1996
 SHEET No. 6 OF 8 SHEETS

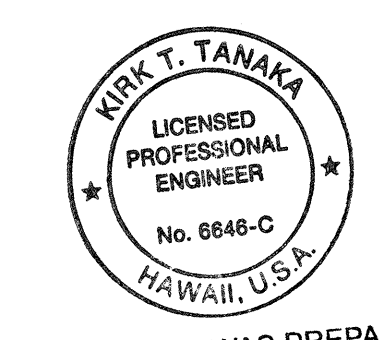

| | |
|-------------------|------|
| SURVEY PLOTTED BY | DATE |
| DRAWN BY | |
| DESIGNED BY | |
| CHECKED BY | |
| ORIGINAL PLAN | |
| NOTE BOOK | |

- KEY TO SIGNAGE:**
- ① Existing Sign (s) and Post (s) to remain.
 - ② Relocated Existing Sign (s) and Post (s)
 - ③ Remove Existing and Install New Sign (s) and Post (s).
 - ④ Install New Sign (s) and Post (s).



THIS WORK WAS PREPARED BY ME OR UNDER MY SUPERVISION
R. T. Tanaka
R. T. TANAKA ENGINEERS, INC.
 CIVIL ENGINEERING - LAND SURVEYING

STATE OF HAWAII
 DEPARTMENT OF TRANSPORTATION
 HIGHWAYS DIVISION
SIGNING AND PAVEMENT MARKING PLAN
 KEKAULIKE AVENUE RESURFACING
 HALEAKALA CRATER ROAD
 TO KULA HIGHWAY
 PROJECT NO. 377B-01-96M
 Scale: 1" = 40' Date: APRIL, 1996
 SHEET No. 7 OF 8 SHEETS

| FED. ROAD DIST. NO. | STATE | PROJ. NO. | FISCAL YEAR | SHEET NO. | TOTAL SHEETS |
|---------------------|-------|-------------|-------------|-----------|--------------|
| HAWAII | HAW. | 377B-01-96M | 1996 | 27 | 28 |

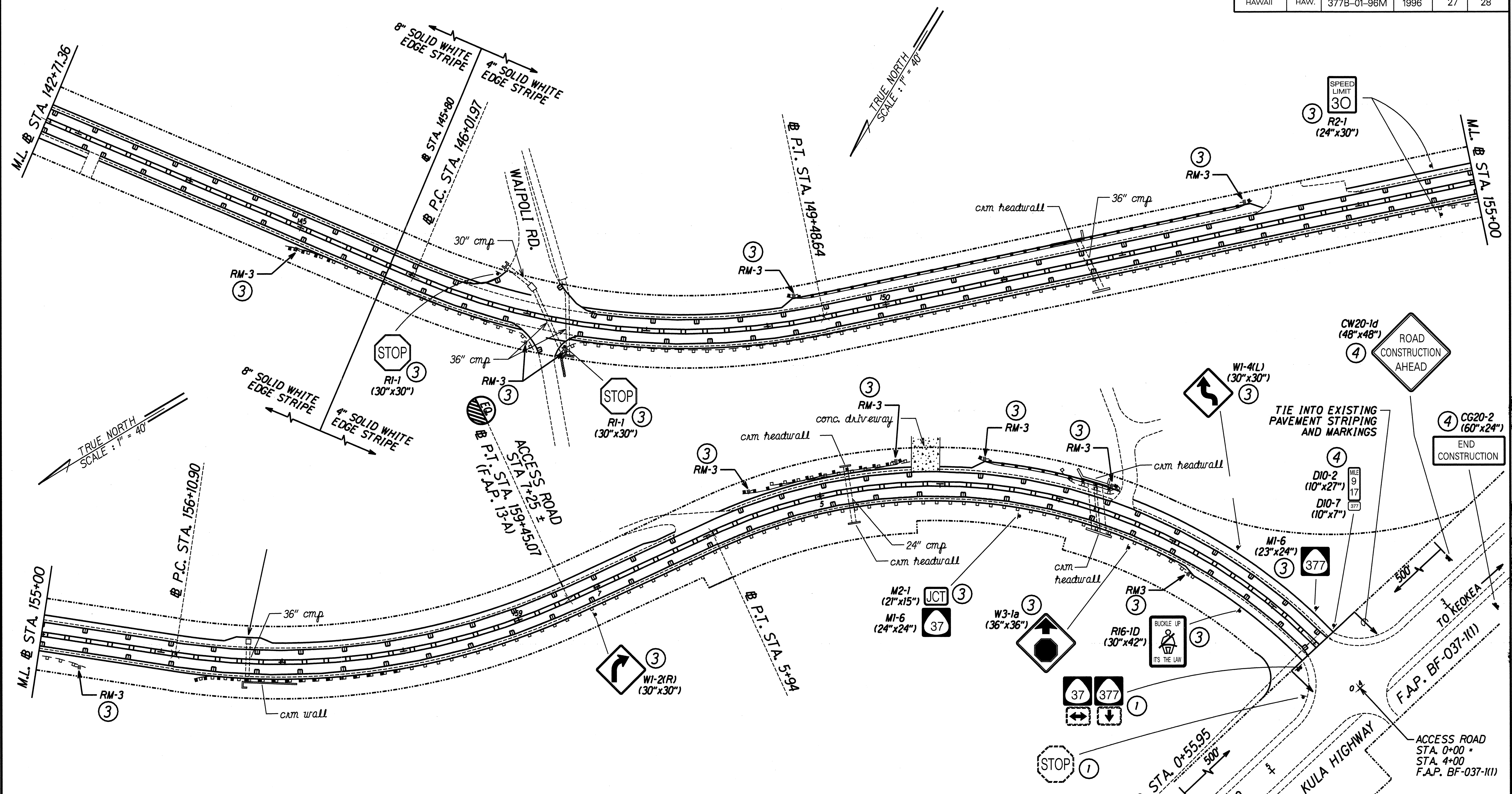

- KEY TO SIGNAGE:**
- ① Existing Sign (s) and Post (s) to remain.
 - ② Relocated Existing Sign (s) and Post (s)
 - ③ Remove Existing and Install New Sign (s) and Post (s).
 - ④ Install New Sign (s) and Post (s).

| | |
|-------------------|------|
| SURVEY PLOTTED BY | DATE |
| DRAWN BY | |
| CHECKED BY | |
| ORIGINAL PLAN | |
| NOTE BOOK | |
| NO. | |

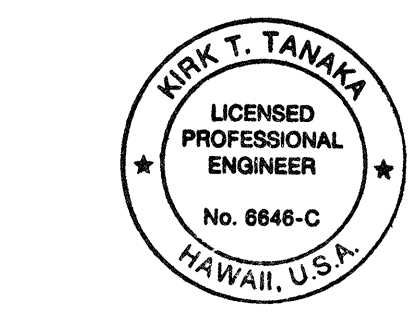

THIS WORK WAS PREPARED BY ME OR UNDER MY SUPERVISION
Kirk T. Tanaka
R. T. TANAKA ENGINEERS, INC.
 CIVIL ENGINEERING - LAND SURVEYING

STATE OF HAWAII
 DEPARTMENT OF TRANSPORTATION
 HIGHWAYS DIVISION

SIGNING AND PAVEMENT MARKING PLAN

**KEKAULIKE AVENUE RESURFACING
 HALEAKALA CRATER ROAD
 TO KULA HIGHWAY**

PROJECT NO. 377B-01-96M
 Scale: 1" = 40' Date: APRIL, 1996

SHEET No. 8 OF 8 SHEETS