

FED. ROAD DIST. NO.	STATE	FED. AID PROJ. NO.	FISCAL YEAR	SHEET NO.	TOTAL SHEETS
HAWAII	HAW.	STP-0360(9)	2006	2	16

LOCATION SUMMARY				
SITE ID	PHONE TYPE	MILE POST	APPROXIMATE GPS COORDINATES	
			NORTH	EAST
1	CELLULAR	0	212033	1777534
2	CELLULAR	2.21	210423	1785085
3	NONE	3.76	207262	1790508
4	NONE	5.87	202295	1795150
5	CELLULAR	8.07	198459	1800333
6	CELLULAR	9.9	196065	1804226
7	CELLULAR	13.2	192610	1810539
8	CELLULAR	15.8	191233	1815830
9	CELLULAR	18	188575	1820878
10	HARDWIRE	20.5	180013	1822047
11	NONE	22.5	176025	182545
12	HARDWIRE	24.5	173695	1832318
13	HARDWIRE	26.4	170942	1840626
14	HARDWIRE	28.9	167644	1850565
15	HARDWIRE	30.5	163840	1858648
16	CELLULAR	32.6	161568	1867716
17	NONE	33.7	156774	1870276

NOTE:
PHONE TYPE OF NONE INDICATES EXISTING PAY PHONE AT THE SITE.

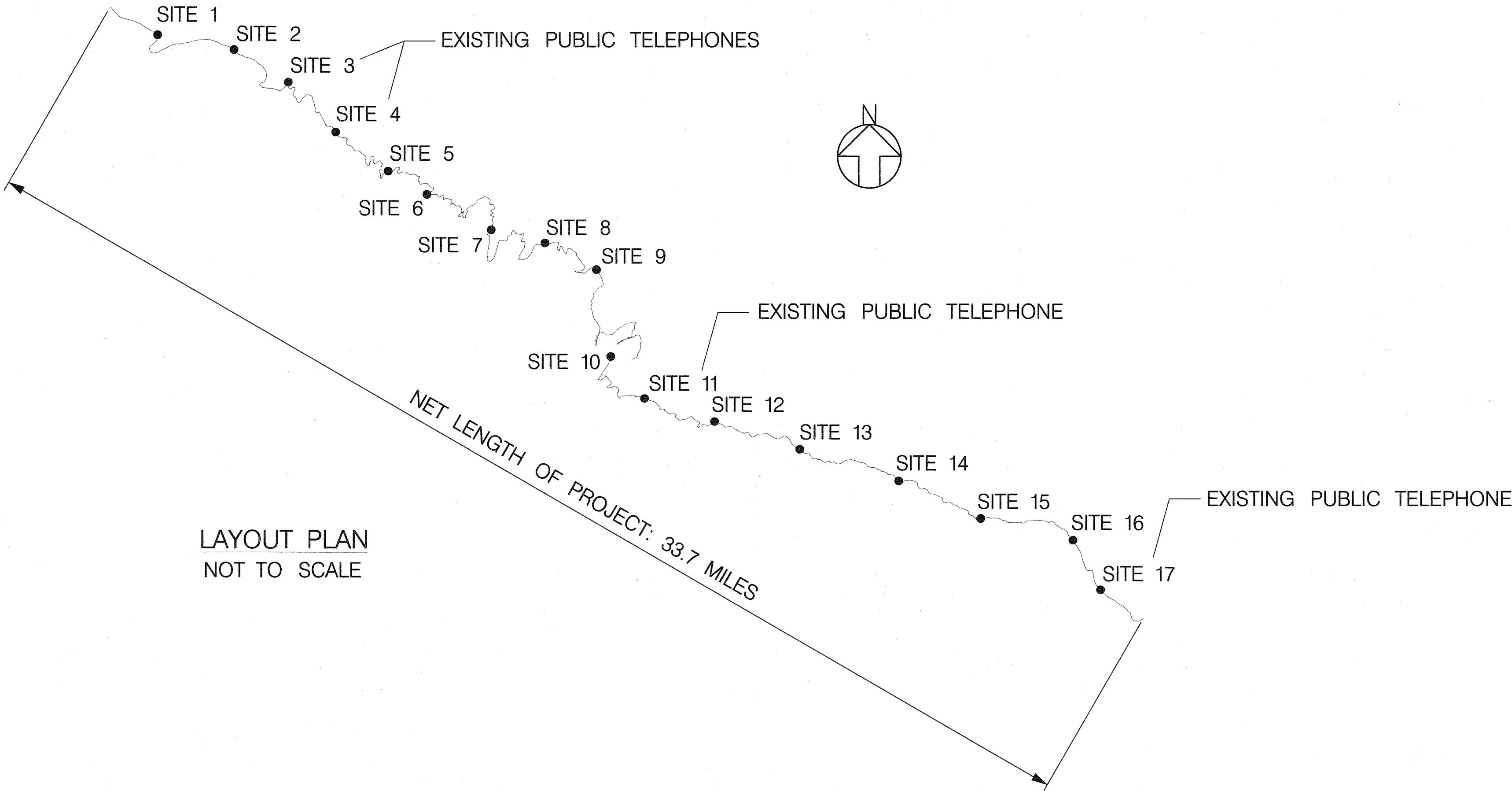

ORIGINAL PLAN	SURVEY PLOTTED BY	DATE
NOTE BOOK	DRAWN BY	
	TRACED BY	
	QUANTITIES BY	
	CHECKED BY	

\\HAWAII\HIGHWAY\MICROSTATION\HANA\LOC\SUMMARY.dgn

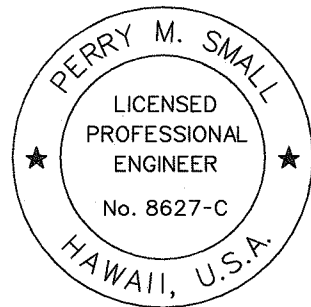

THIS WORK WAS PREPARED BY ME
OR UNDER MY SUPERVISION.

Perry M. Small

STATE OF HAWAII
DEPARTMENT OF TRANSPORTATION
HIGHWAYS DIVISION

LOCATION SUMMARY

HANA HIGHWAY
INSTALLATION OF EMERGENCY TELEPHONES
KAUPAKALUA ROAD TO UA KEA ROAD
FEDERAL-AID PROJECT STP-0360(9)

SCALE: None DATE: October, 2005

SHEET No. 1 OF 1 SHEETS