

FED. ROAD DIST. NO.	STATE	PROJ. NO.	FISCAL YEAR	SHEET NO.	TOTAL SHEETS
MAUI	HAW.	ER-20(006)	2018	10	16

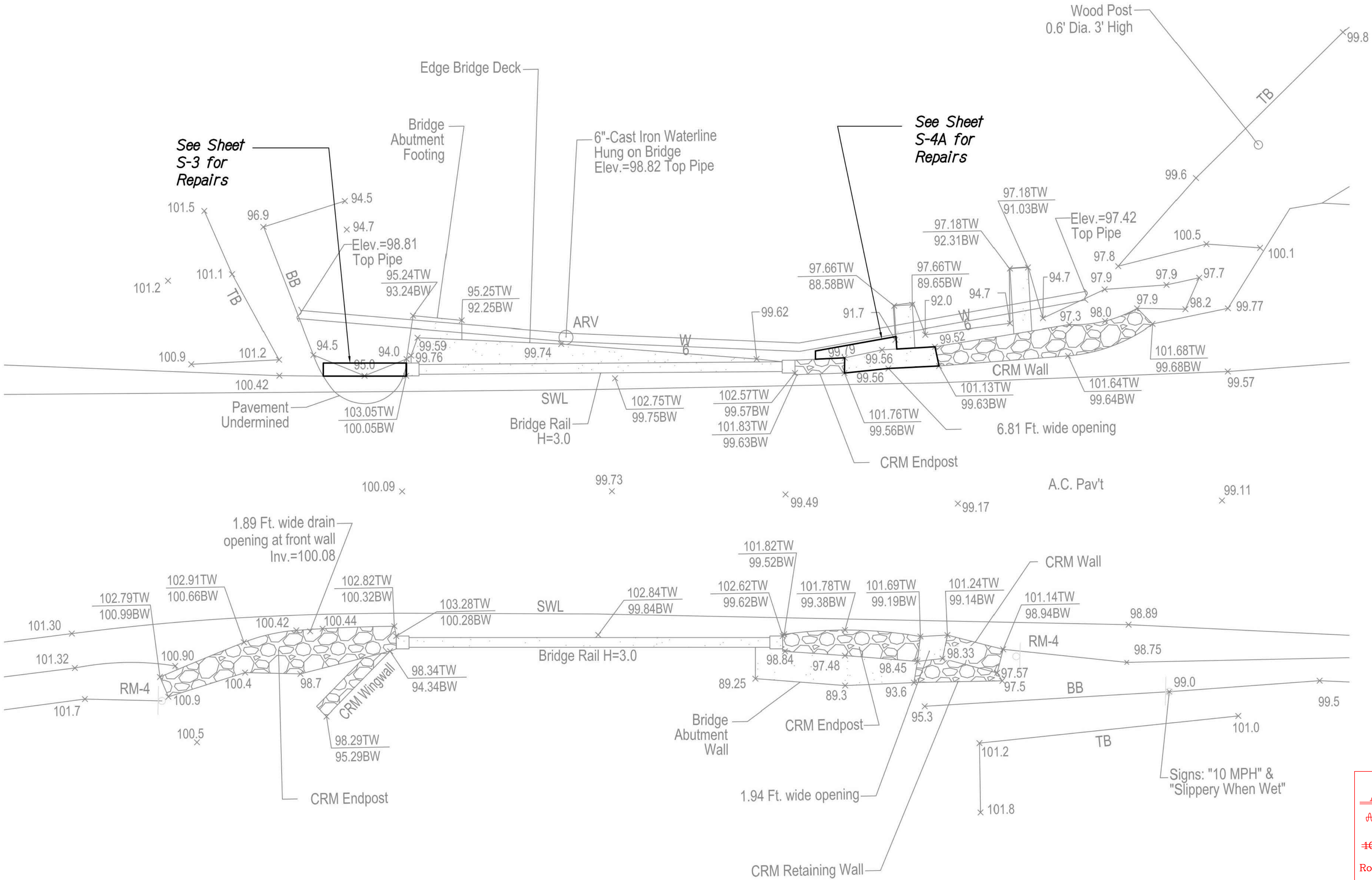

LEGEND FOR AS-BUILT POSTINGS	
	Squiggly line for as-built deletion
	Double line for as-built deletion
	Text for as-built posting

STATE OF HAWAII
DEPARTMENT OF TRANSPORTATION
HIGHWAYS DIVISION

Bridge Plan View

EMERGENCY REPAIRS AT PIINAU BRIDGE
HANA HIGHWAY, NEAR MILEPOST 17.0
PROJECT NO. ER-20(006), UNIT 1
Scale: As Noted Date: September 2018

SHEET No. S-2 OF 16 SHEETS

ORIGINAL PLAN	DATE
DRAWN BY	
DESIGNED BY	
CHECKED BY	
NOTE BOOK	
No.	

Bridge Plan View 1
 Scale: 1/4" = 1'-0" S-2 | S-2

"AS-BUILT"