

FED. ROAD DIST. NO.	STATE	PROJ. NO.	FISCAL YEAR	SHEET NO.	TOTAL SHEETS
HAWAII	HAW.	360A-02-10	2012	11	14

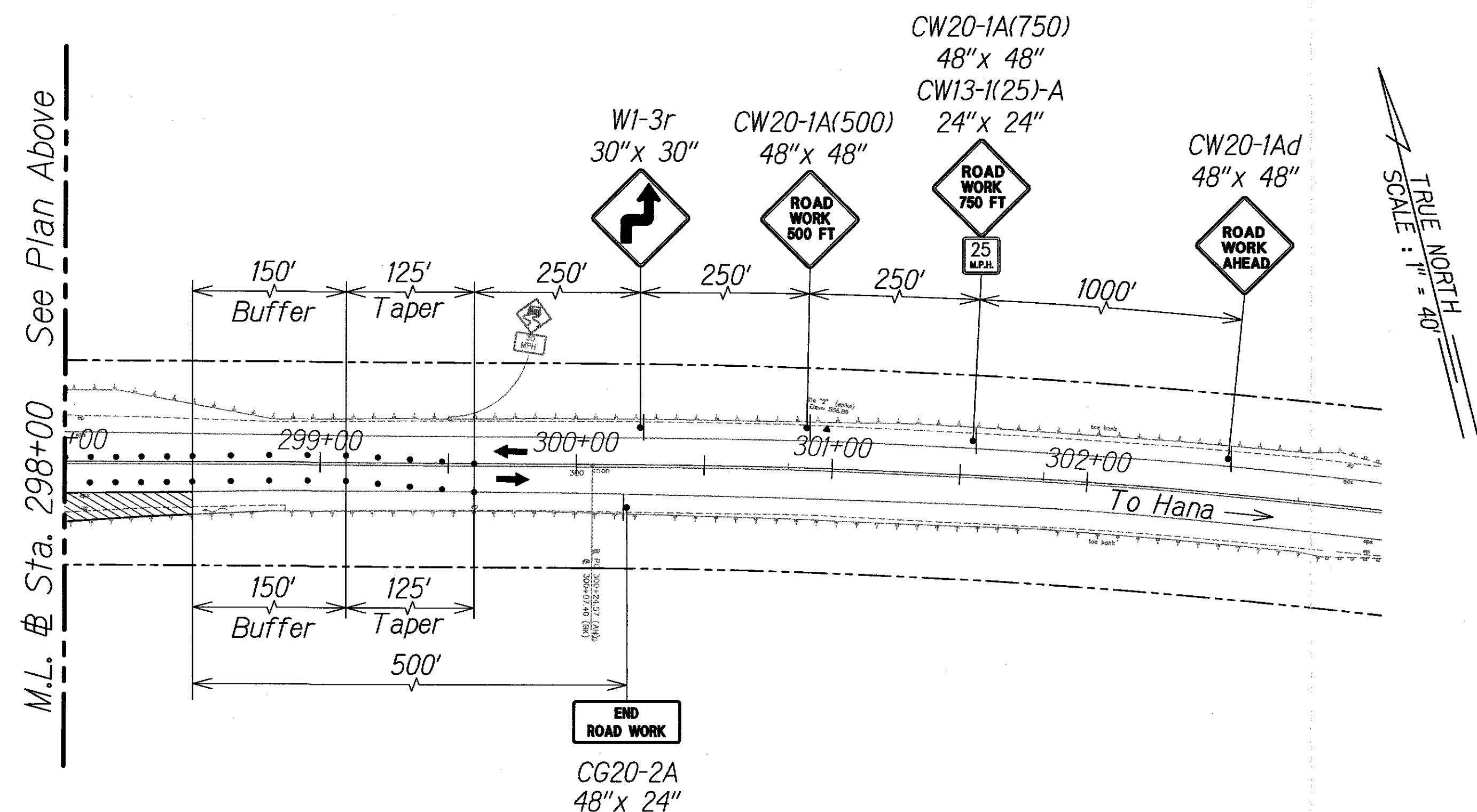
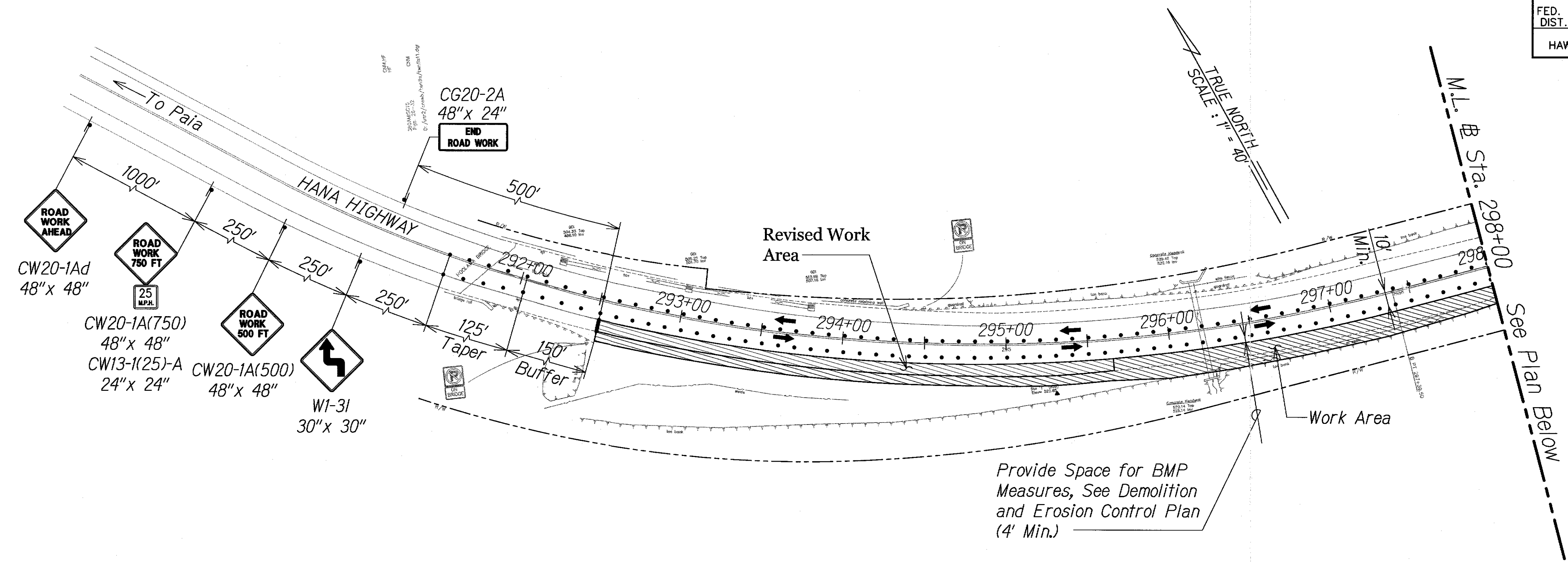

NOTES:

1. The Contractor shall coordinate all work with businesses and homeowners when doing work that may affect vehicular access.
2. See Plan Sheet No. 3 for Traffic Control notes and additional dimensions.
3. Install Type II Barricades Along Shoulder Excavation.

LEGEND:

- └ Sign
- Cone Or Delineator
- ← Direction of Traffic

LEGEND FOR AS-BUILT POSTINGS

Squiggly line for as-built deletion

Double line for as-built deletion

Roadway Text for as-built posting

GRAPHICAL SCALE:

40' 20' 0 40' 80'

SCALE: 1" = 40'

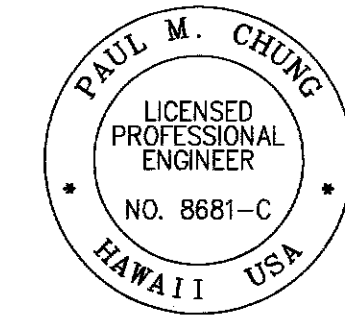

THIS WORK WAS PREPARED BY ME OR UNDER MY SUPERVISION

SIGNATURE

04/30/12
EXPIRATION DATE OF THE LICENSE

STATE OF HAWAII
DEPARTMENT OF TRANSPORTATION
HIGHWAYS DIVISION

TRAFFIC CONTROL PLAN

HANA HIGHWAY DRAINAGE IMPROVEMENTS
Vicinity of Hoolawa Bridge
Project No. 360A-02-10

Scale: 1" = 40' Date: May 10, 2012

SHEET No. 1 OF 1 SHEETS

Traffic Control Plan - Shoulder Work

"AS-BUILT"

DATE	____
DRAWN BY	____
DESIGNED BY	____
QUANTITIES BY	____
CHECKED BY	____
ORIGINAL PLAN	____
NOTE BOOK	____
No.	____

W:\CIVIL 3D PROJECTS\2006_173_001_S04 HANA HWY DRAINAGE IMPROVEMENTS\AS-BUILT DRAWINGS\11 TRAFFIC CONTROL PLAN.DWG 3/17/2014 4:46 PM