

FED. ROAD DIST. NO.	STATE	FED. AID PROJ. NO.	FISCAL YEAR	SHEET NO.	TOTAL SHEETS
HAWAII	HAW.	360AB-01-18	2018	38	59

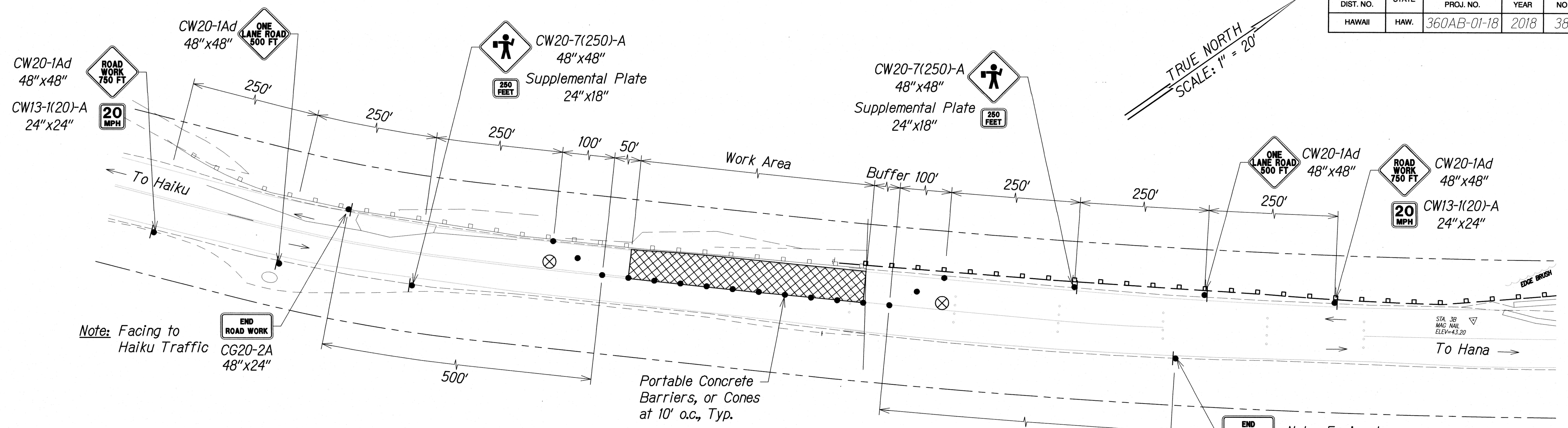

**TYPICAL TRAFFIC CONTROL PLAN FOR  
WORK ON HAIKU BOUND LANE**

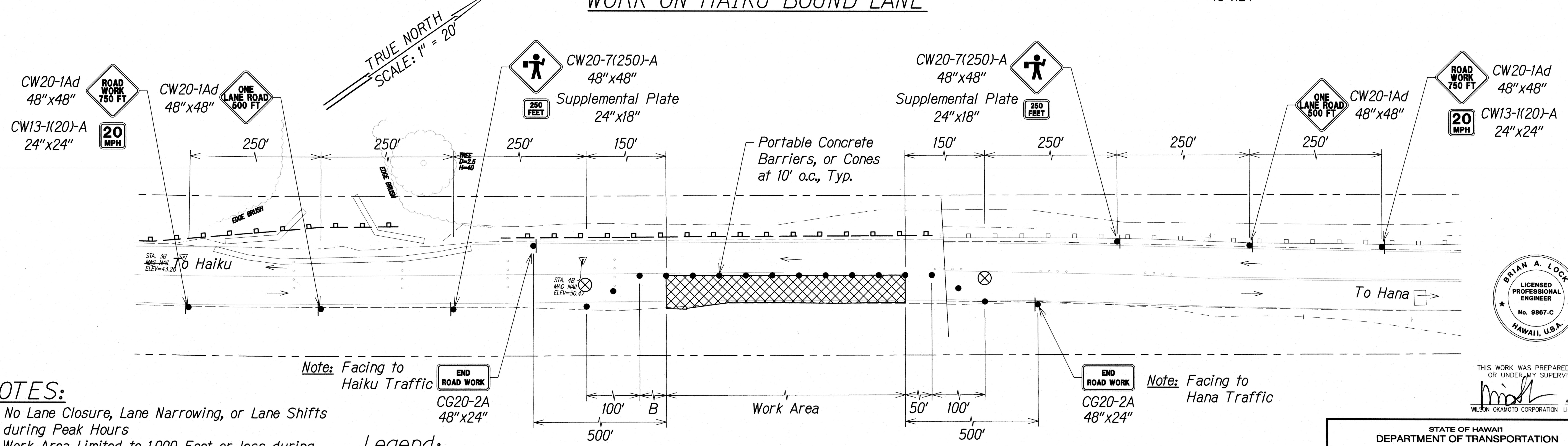

**TYPICAL TRAFFIC CONTROL PLAN FOR  
WORK ON HANA BOUND LANE**

**NOTES:**

1. No Lane Closure, Lane Narrowing, or Lane Shifts during Peak Hours
2. Work Area Limited to 1,000 Feet or less during working hours
3. Place Signs on Makai Side of Road if no Room on Mauka Side
4. Install Advisory Signs According to Section 645 - Work Zone Traffic Control, a Minimum of 500 Feet Before and After the Extents of the Traffic Control.
5. For Portable Concrete Barrier Details See Standard Plans TE-42, TE-42, and Sht. GRD-11

**Legend:**

- Work Area
- Police Officer
- Cones and Delineators
- Sign
- Direction of Traffic

SURVEY PLOTTED BY	DATE
DESIGNED BY	
TRACED BY	
NOTE BOOK	
QUANTITIES BY	
CHECKED BY	
No.	

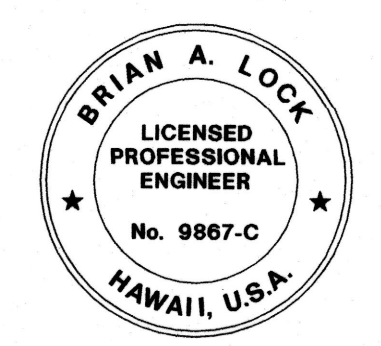

THIS WORK WAS PREPARED BY ME OR UNDER MY SUPERVISION.  
  
 APRIL 30, 2020  
 WILSON OKAMOTO CORPORATION LIC. EXP. DATE

STATE OF HAWAII  
 DEPARTMENT OF TRANSPORTATION  
 HIGHWAYS DIVISION

**TRAFFIC CONTROL PLANS**

HANA HIGHWAY  
 IMPROVEMENTS, PHASE 2C  
 Huelo to Hana  
 Project No. 360AB-01-18  
 Scale: 1" = 20' Date: March 2018

SHEET No. TCP-1 OF 1 SHEETS