

FED. ROAD DIST. NO.	STATE	PROJ. NO.	FISCAL YEAR	SHEET NO.	TOTAL SHEETS
HAWAII	HAW.	360B-01-95M	1995	15	43

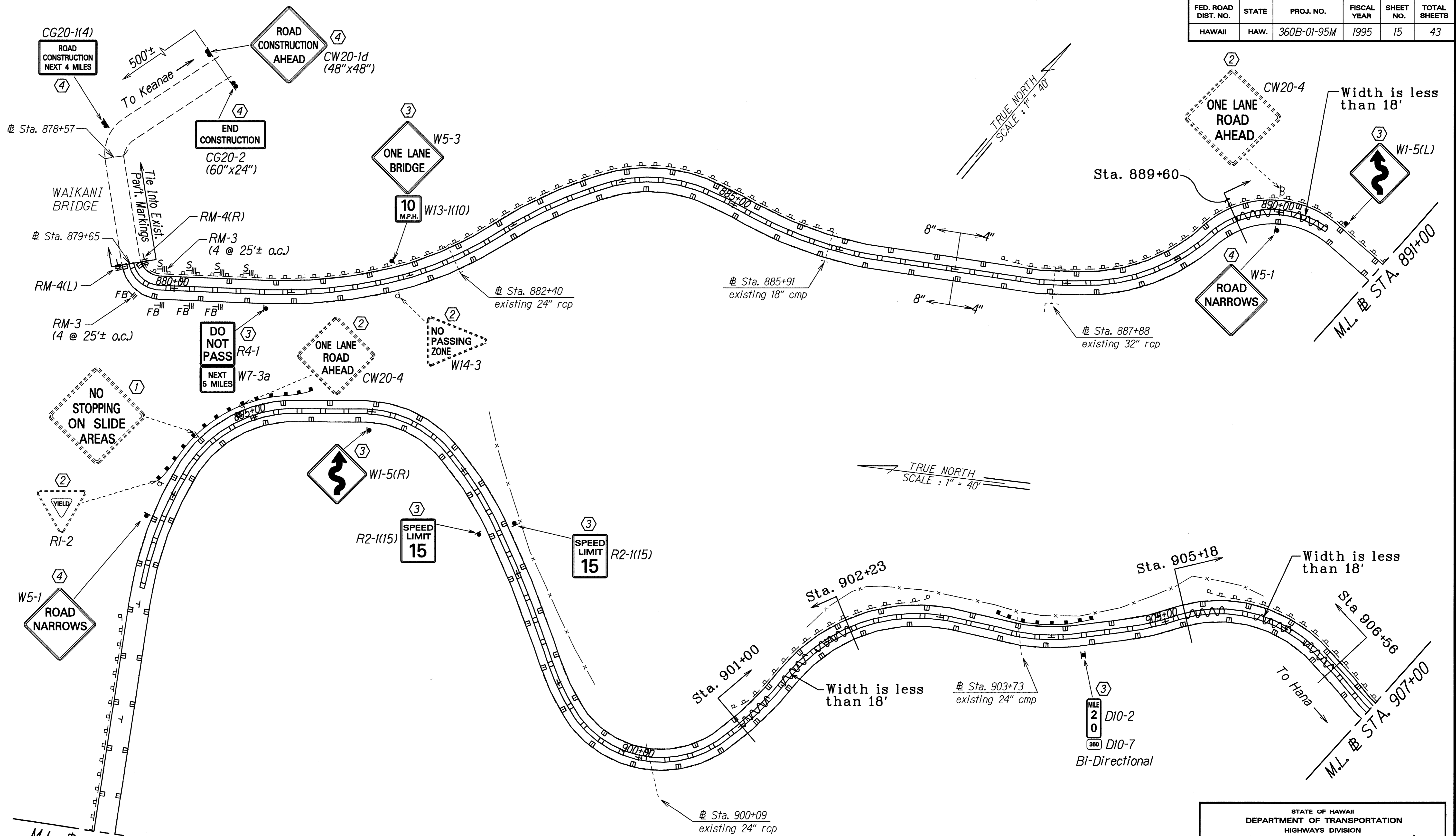

SURVEY PLOTTED BY	DATE
DRAWN BY	12/9/94
TRACED BY	
NOTES	
QUANTITIES BY	
CHECKED BY	
ORIGINAL PLAN	
DATE	
NOTES	
QUANTITIES BY	
CHECKED BY	

- KEY:**
- ① Exist. Sign(s) & Post(s) to Remain
 - ② Remove Exist. Sign(s) w/Post(s)
 - ③ Remove Exist. Sign(s) w/Post(s) & Install New Sign(s) w/Post(s)
 - ④ Install New Sign(s) w/Post(s)

LEGEND FOR AS-BUILT POSTINGS

	Squiggly line for as-built deletion
	Double line for as-built deletion
Roadway	Text for as-built posting

STATE OF HAWAII
DEPARTMENT OF TRANSPORTATION
HIGHWAYS DIVISION
PAVEMENT MARKING & SIGNING PLAN
HANA HIGHWAY RESURFACING
Waikani Bridge to Kapaula Bridge
Project No. 360B-01-95M
Scale: 1"=40' Date: Dec., 1994
SHEET No. T2 OF 10 SHEETS

FED. ROAD DIST. NO.	STATE	PROJ. NO.	FISCAL YEAR	SHEET NO.	TOTAL SHEETS
HAWAII	HAW.	360B-01-95M	1995	16	43

TRUE NORTH
SCALE : 1" = 40'

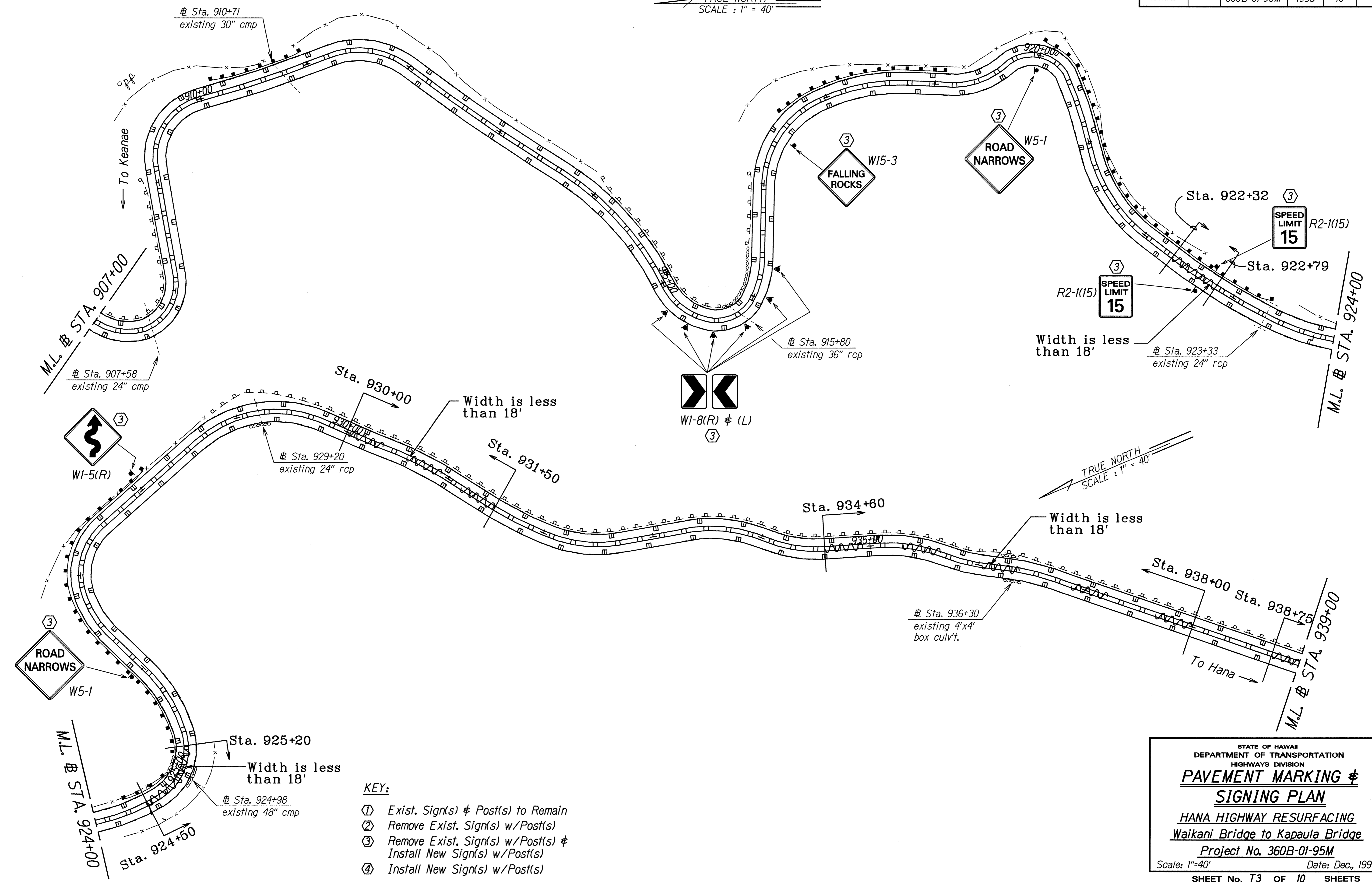

SURVEY PLOTTED BY	DATE
DRAWN BY	12/22/94
TRACED BY	
NOTED BY	
QUANTITIES BY	
CHECKED BY	

- KEY:**
- ① Exist. Sign(s) & Post(s) to Remain
 - ② Remove Exist. Sign(s) w/Post(s)
 - ③ Remove Exist. Sign(s) w/Post(s) & Install New Sign(s) w/Post(s)
 - ④ Install New Sign(s) w/Post(s)

STATE OF HAWAII
DEPARTMENT OF TRANSPORTATION
HIGHWAYS DIVISION

PAVEMENT MARKING & SIGNING PLAN

HANA HIGHWAY RESURFACING
Waikani Bridge to Kapaula Bridge
Project No. 360B-01-95M
Scale: 1"=40' Date: Dec., 1994

SHEET No. T3 OF 10 SHEETS

FED. ROAD DIST. NO.	STATE	PROJ. NO.	FISCAL YEAR	SHEET NO.	TOTAL SHEETS
HAWAII	HAW.	360B-01-95M	1995	17	43

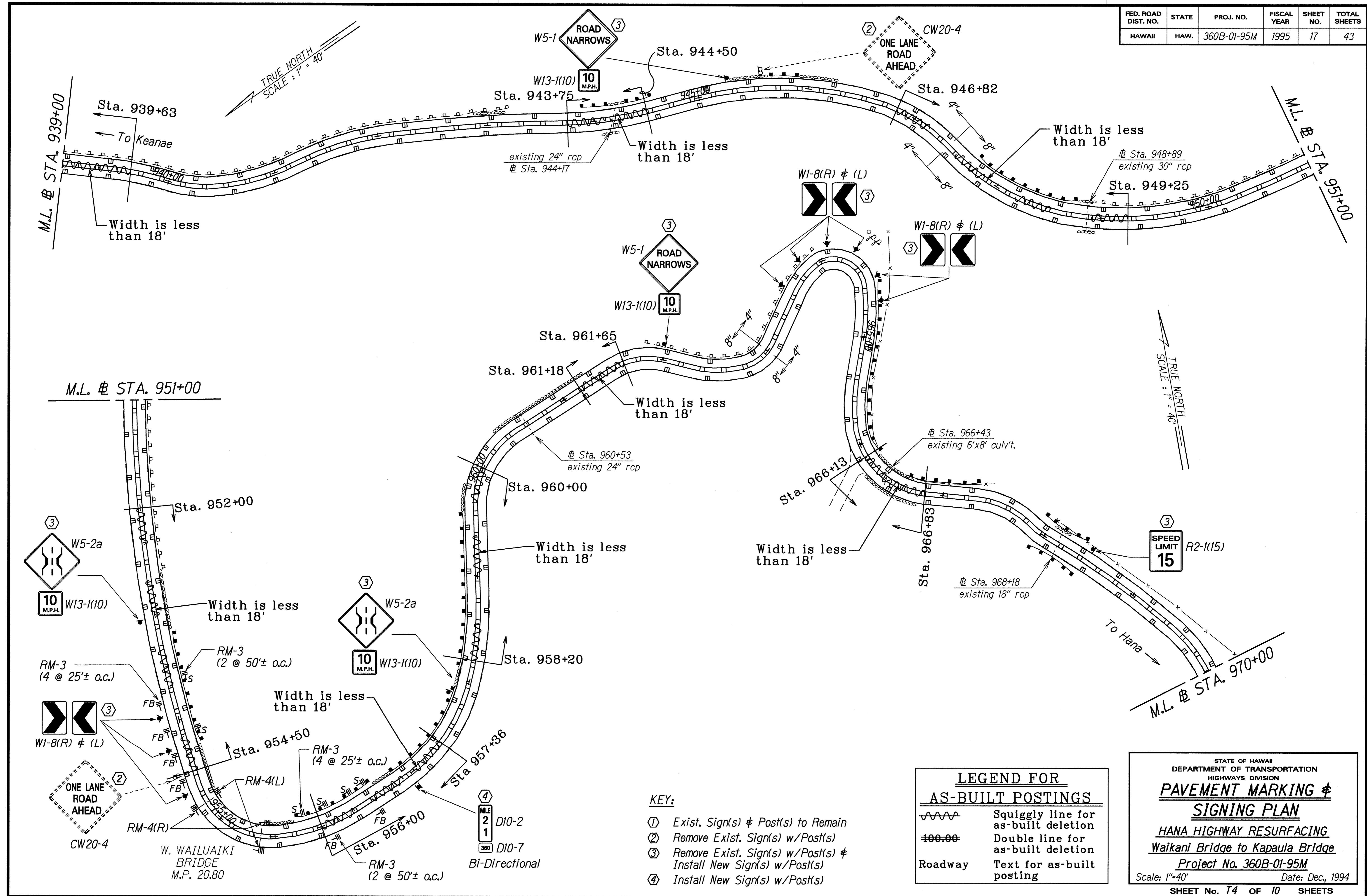

DATE	12/9/94
SURVEY PLOTTED BY	
DRAWN BY	H. Achi
TRACED BY	K. Kamoharui
NOTED BY	Red Ruby
QUANTITIES BY	
CHECKED BY	N. Shantip
ORIGINAL PLAN	

- KEY:**
- ① Exist. Sign(s) & Post(s) to Remain
 - ② Remove Exist. Sign(s) w/Post(s)
 - ③ Remove Exist. Sign(s) w/Post(s) & Install New Sign(s) w/Post(s)
 - ④ Install New Sign(s) w/Post(s)

LEGEND FOR AS-BUILT POSTINGS

	Squiggly line for as-built deletion
	Double line for as-built deletion
Roadway	Text for as-built posting

STATE OF HAWAII
DEPARTMENT OF TRANSPORTATION
HIGHWAYS DIVISION

PAVEMENT MARKING & SIGNING PLAN

HANA HIGHWAY RESURFACING
Waikani Bridge to Kapaula Bridge

Project No. 360B-01-95M
Scale: 1"=40' Date: Dec., 1994
SHEET No. T4 OF 10 SHEETS

FED. ROAD DIST. NO.	STATE	PROJ. NO.	FISCAL YEAR	SHEET NO.	TOTAL SHEETS
HAWAII	HAW.	360B-01-95M	1995	18	43

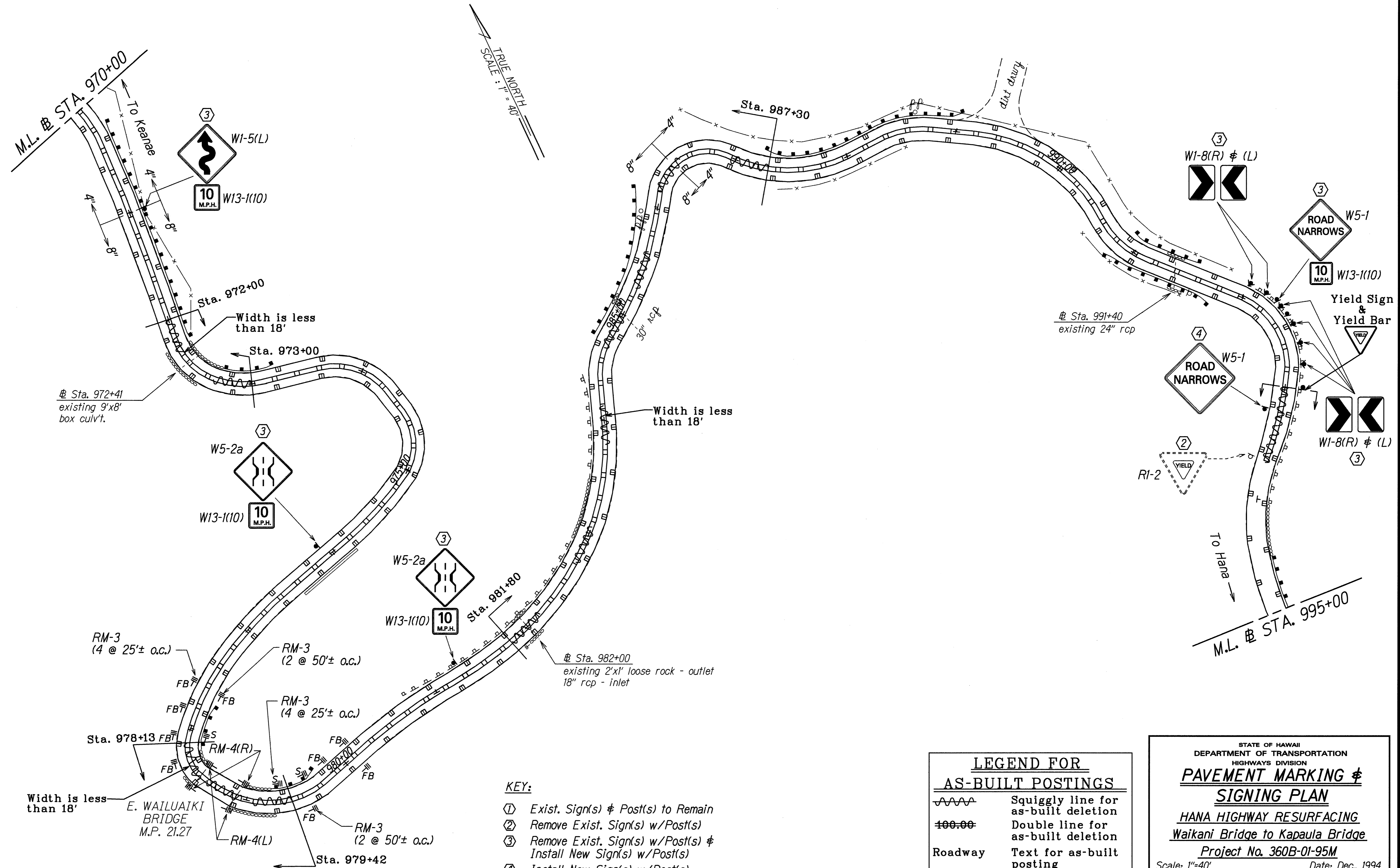

SURVEY PLOTTED BY: DATE: 12/19/94
 DRAWN BY: G. Achil
 CHECKED BY: K. Kishimoto
 NOTE BOOK: 162-104
 QUANTITIES BY: N. Shamp
 CHECKED BY:

- KEY:**
- ① Exist. Sign(s) & Post(s) to Remain
 - ② Remove Exist. Sign(s) w/Post(s)
 - ③ Remove Exist. Sign(s) w/Post(s) & Install New Sign(s) w/Post(s)
 - ④ Install New Sign(s) w/Post(s)

LEGEND FOR AS-BUILT POSTINGS

Squiggly line for as-built deletion
 Double line for as-built deletion
 Roadway Text for as-built posting

STATE OF HAWAII
 DEPARTMENT OF TRANSPORTATION
 HIGHWAYS DIVISION
PAVEMENT MARKING & SIGNING PLAN
 HANA HIGHWAY RESURFACING
 Waikani Bridge to Kapaula Bridge
 Project No. 360B-01-95M
 Scale: 1"=40' Date: Dec., 1994
 SHEET No. T5 OF 10 SHEETS

FED. ROAD DIST. NO.	STATE	PROJ. NO.	FISCAL YEAR	SHEET NO.	TOTAL SHEETS
HAWAII	HAW.	360B-01-95M	1995	19	43

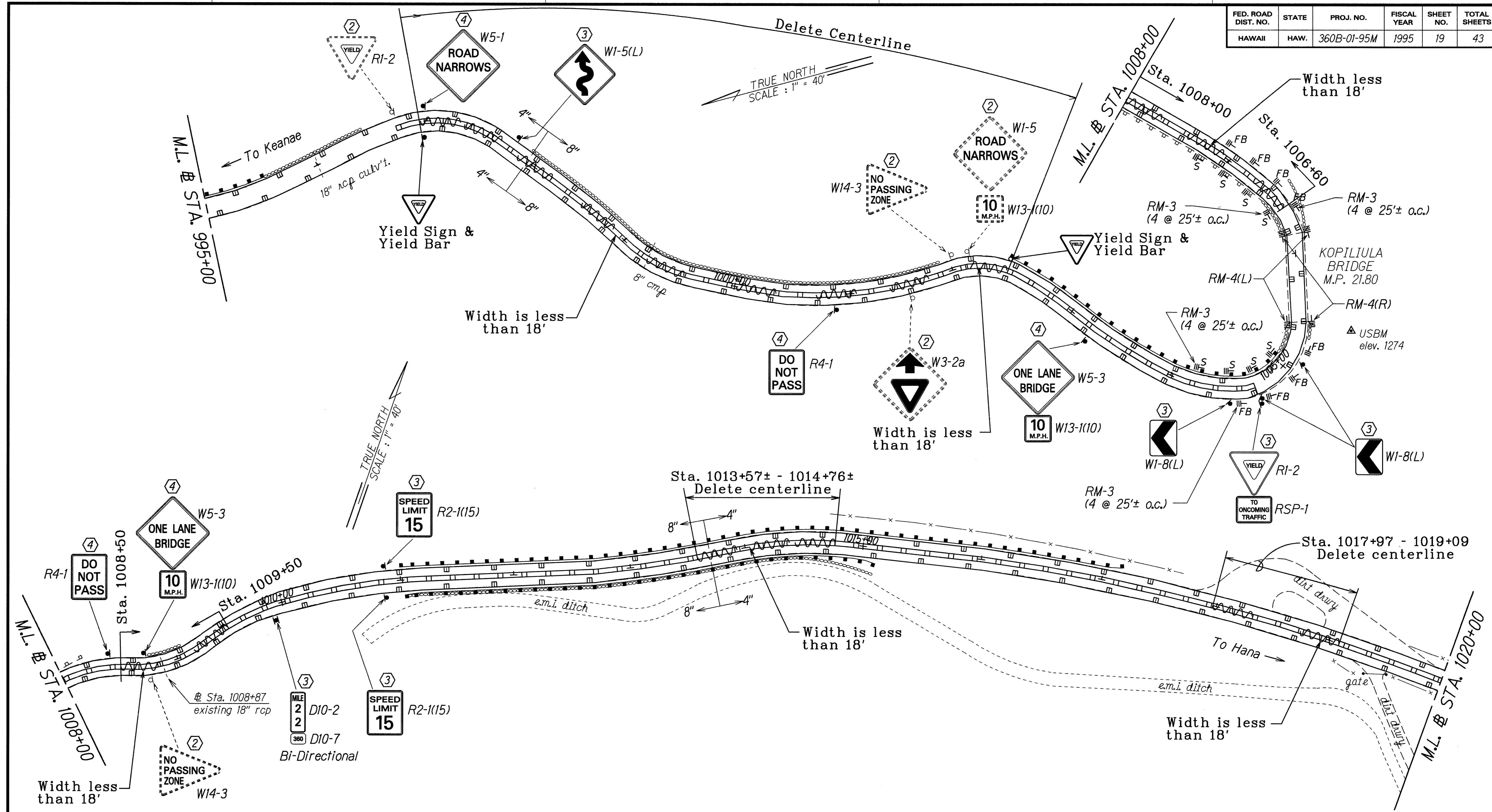

SURVEY PLOTTED BY: _____ DATE: 12/29/94
 DRAWN BY: E. Acil
 CHECKED BY: K. Kunihiro
 NOTE BOOK NO. _____
 QUANTITIES BY: _____
 CHECKED BY: _____

- KEY:**
- ① Exist. Sign(s) & Post(s) to Remain
 - ② Remove Exist. Sign(s) w/Post(s)
 - ③ Remove Exist. Sign(s) w/Post(s) & Install New Sign(s) w/Post(s)
 - ④ Install New Sign(s) w/Post(s)

LEGEND FOR AS-BUILT POSTINGS

	Squiggly line for as-built deletion
	Double line for as-built deletion
Roadway	Text for as-built posting

STATE OF HAWAII
 DEPARTMENT OF TRANSPORTATION
 HIGHWAYS DIVISION
PAVEMENT MARKING & SIGNING PLAN
 HANA HIGHWAY RESURFACING
 Waikani Bridge to Kapaula Bridge
 Project No. 360B-01-95M
 Scale: 1"=40' Date: Dec., 1994
 SHEET No. 19 OF 10 SHEETS

FED. ROAD DIST. NO.	STATE	PROJ. NO.	FISCAL YEAR	SHEET NO.	TOTAL SHEETS
HAWAII	HAW.	360B-01-95M	1995	20	43

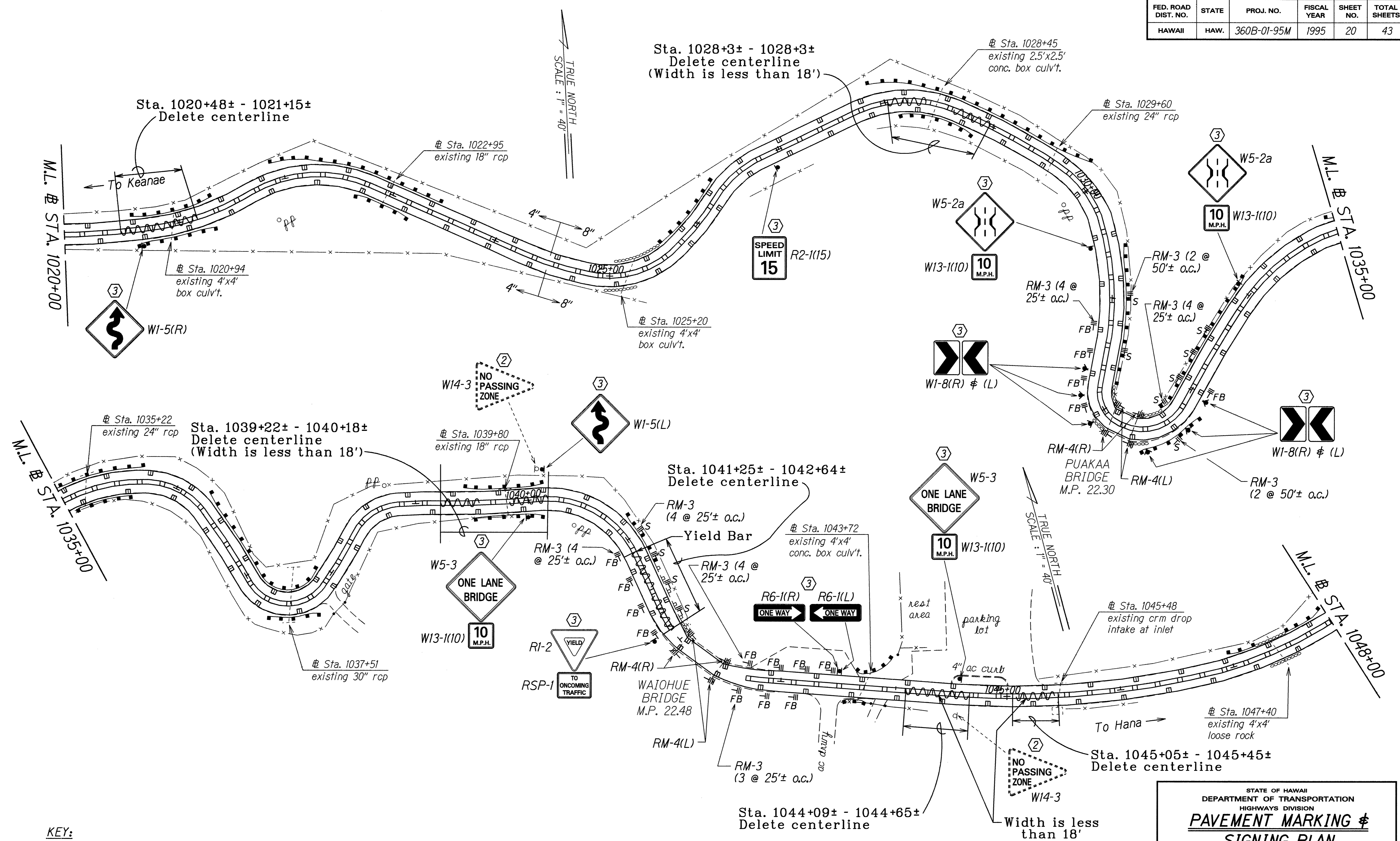

- KEY:**
- ① Exist. Sign(s) & Post(s) to Remain
 - ② Remove Exist. Sign(s) w/Post(s)
 - ③ Remove Exist. Sign(s) w/Post(s) & Install New Sign(s) w/Post(s)
 - ④ Install New Sign(s) w/Post(s)

LEGEND FOR AS-BUILT POSTINGS

	Squiggly line for as-built deletion
	Double line for as-built deletion
Roadway	Text for as-built posting

STATE OF HAWAII
DEPARTMENT OF TRANSPORTATION
HIGHWAYS DIVISION

**PAVEMENT MARKING &
SIGNING PLAN**

HANA HIGHWAY RESURFACING
Waikani Bridge to Kapaula Bridge
Project No. 360B-01-95M

Scale: 1"=40' Date: Dec., 1994
SHEET No. 77 OF 10 SHEETS

SURVEY PLOTTED BY	DATE	12/29/94
DRAWN BY		H. JACI
DESIGNED BY		K. KUNISHIRO
QUANTITIES BY		
CHECKED BY		
ORIGINAL PLAN		
NOTE BOOK		1021.00
No. 1021.00		

FED. ROAD DIST. NO.	STATE	PROJ. NO.	FISCAL YEAR	SHEET NO.	TOTAL SHEETS
HAWAII	HAW.	360B-01-95M	1995	21	43

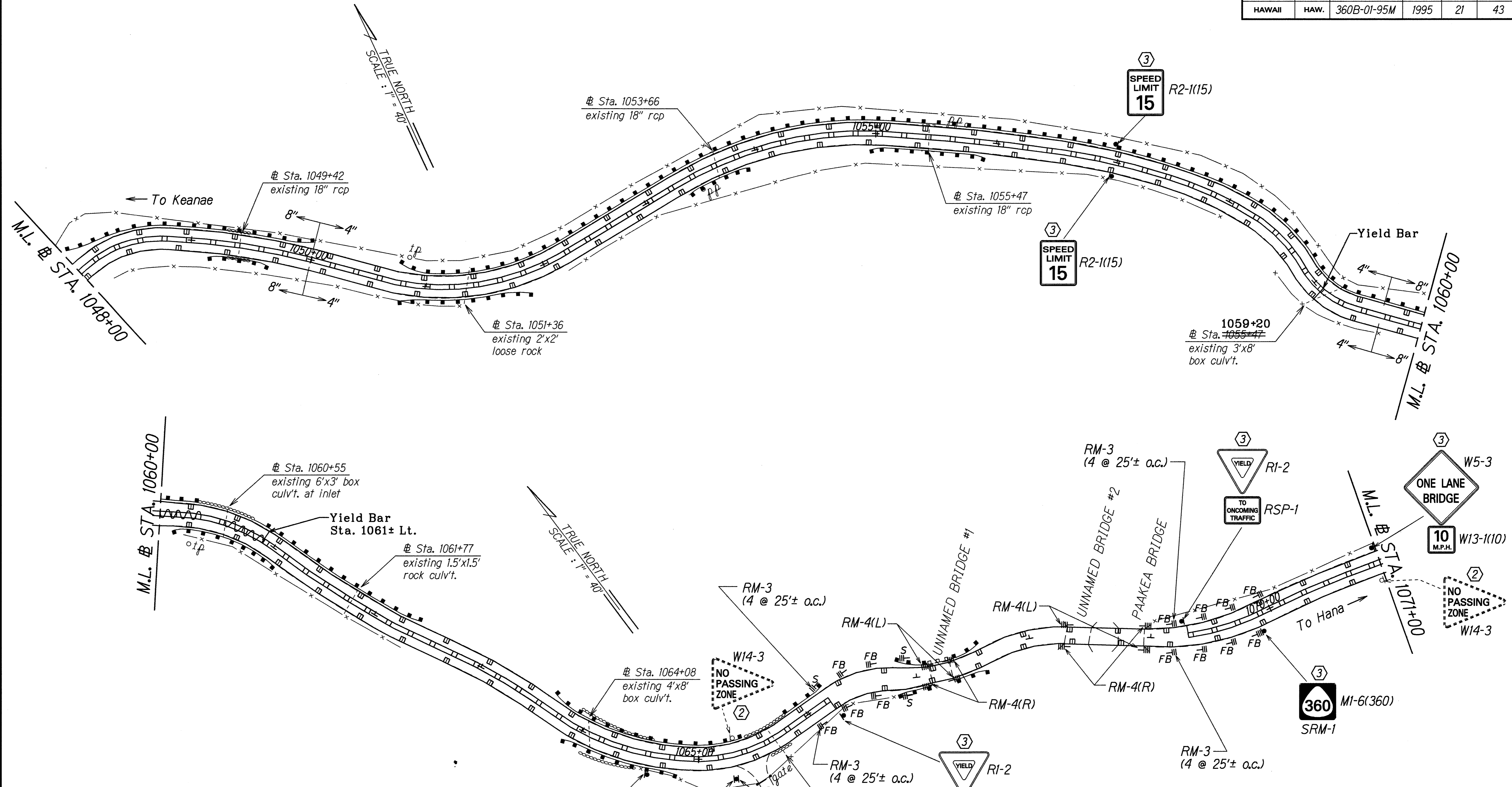

LEGEND FOR AS-BUILT POSTINGS

~~~~~ Squiggly line for as-built deletion

~~100.00~~ Double line for as-built deletion

Roadway Text for as-built posting

- KEY:**
- ① Exist. Sign(s) & Post(s) to Remain
  - ② Remove Exist. Sign(s) w/Post(s)
  - ③ Remove Exist. Sign(s) w/Post(s) & Install New Sign(s) w/Post(s)
  - ④ Install New Sign(s) w/Post(s)

W3-2a

W5-3

ONE LANE BRIDGE

W13-1(10)

D10-2

D10-7

MILE 2 3

360 D10-7

Install New Signs

STATE OF HAWAII  
DEPARTMENT OF TRANSPORTATION  
HIGHWAYS DIVISION

**PAVEMENT MARKING & SIGNING PLAN**

HANA HIGHWAY RESURFACING  
Waikani Bridge to Kapaula Bridge  
Project No. 360B-01-95M

Scale: 1"=40' Date: Dec., 1994

SHEET No. 18 OF 10 SHEETS

|                   |         |
|-------------------|---------|
| SURVEY PLOTTED BY | DATE    |
| DRAWN BY          | 12/3/94 |
| TRACED BY         |         |
| NOTE BOOK         |         |
| QUANTITIES BY     |         |
| CHECKED BY        |         |

| FED. ROAD DIST. NO. | STATE | PROJ. NO.   | FISCAL YEAR | SHEET NO. | TOTAL SHEETS |
|---------------------|-------|-------------|-------------|-----------|--------------|
| HAWAII              | HAW.  | 360B-01-95M | 1995        | 22        | 43           |

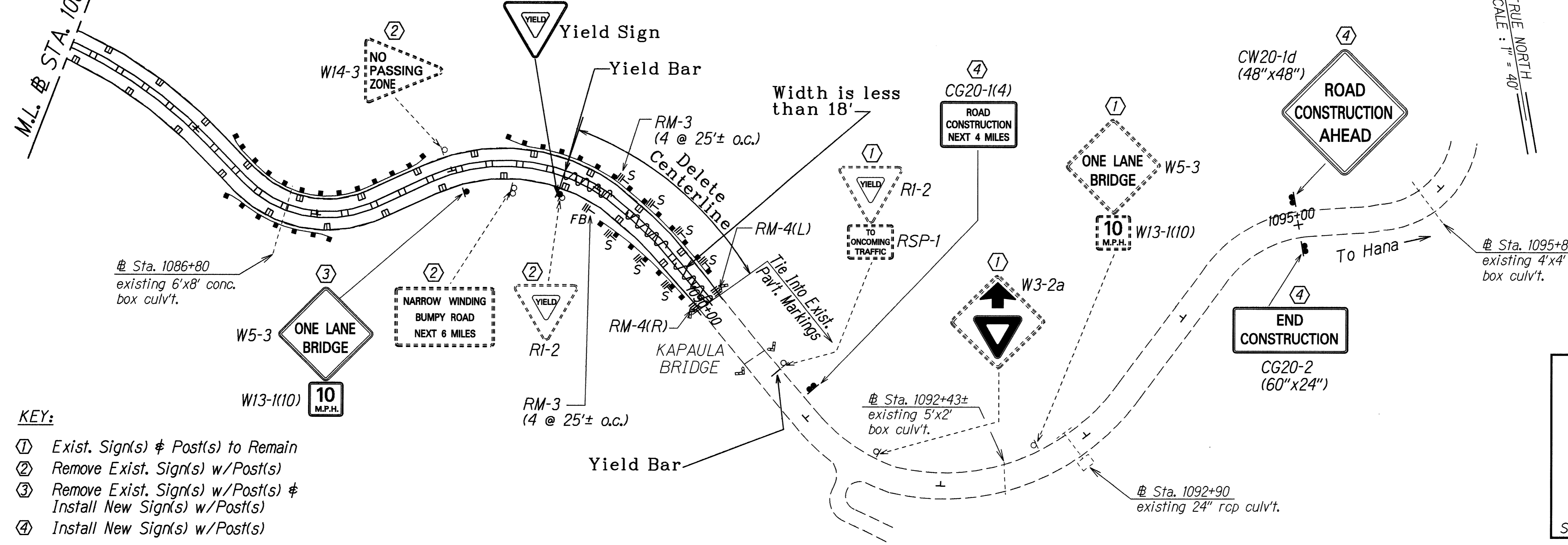
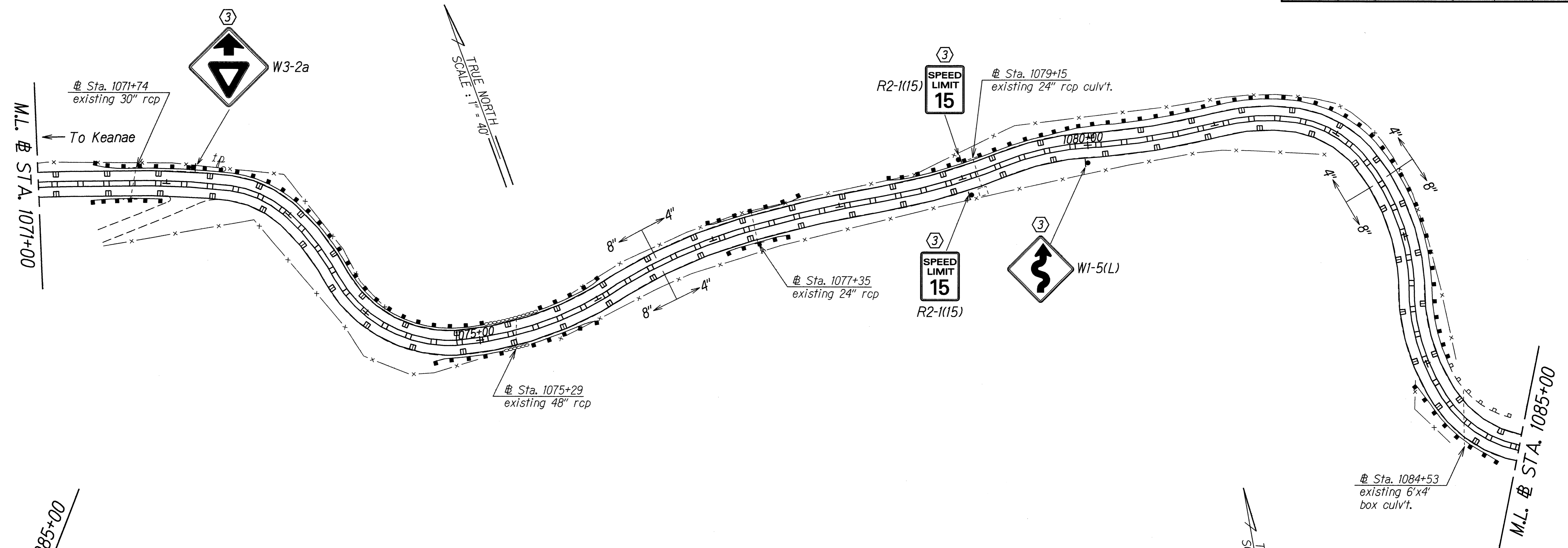

- KEY:**
- ① Exist. Sign(s) & Post(s) to Remain
  - ② Remove Exist. Sign(s) w/Post(s)
  - ③ Remove Exist. Sign(s) w/Post(s) & Install New Sign(s) w/Post(s)
  - ④ Install New Sign(s) w/Post(s)

**LEGEND FOR AS-BUILT POSTINGS**

|         |                                     |
|---------|-------------------------------------|
|         | Squiggly line for as-built deletion |
|         | Double line for as-built deletion   |
| Roadway | Text for as-built posting           |

STATE OF HAWAII  
DEPARTMENT OF TRANSPORTATION  
HIGHWAYS DIVISION  
**PAVEMENT MARKING & SIGNING PLAN**  
HANA HIGHWAY RESURFACING  
Waikani Bridge to Kapaula Bridge  
Project No. 360B-01-95M  
Scale: 1"=40' Date: Dec, 1994  
SHEET No. 19 OF 10 SHEETS

|                   |                |
|-------------------|----------------|
| ORIGINAL PLAN     | DATE: 12/19/94 |
| SURVEY PLANNED BY |                |
| DRAWN BY: B. Ach  |                |
| NOTE BOOK         |                |
| 142-1-10          |                |
| QUANTITIES BY     |                |
| N. Shampine       |                |
| CHECKED BY        |                |