

FED. ROAD DIST. NO.	STATE	FED. AID PROJ. NO.	FISCAL YEAR	SHEET NO.	TOTAL SHEETS
HAWAII	HAW.	BR-RS-0360(6)	1992	12	75

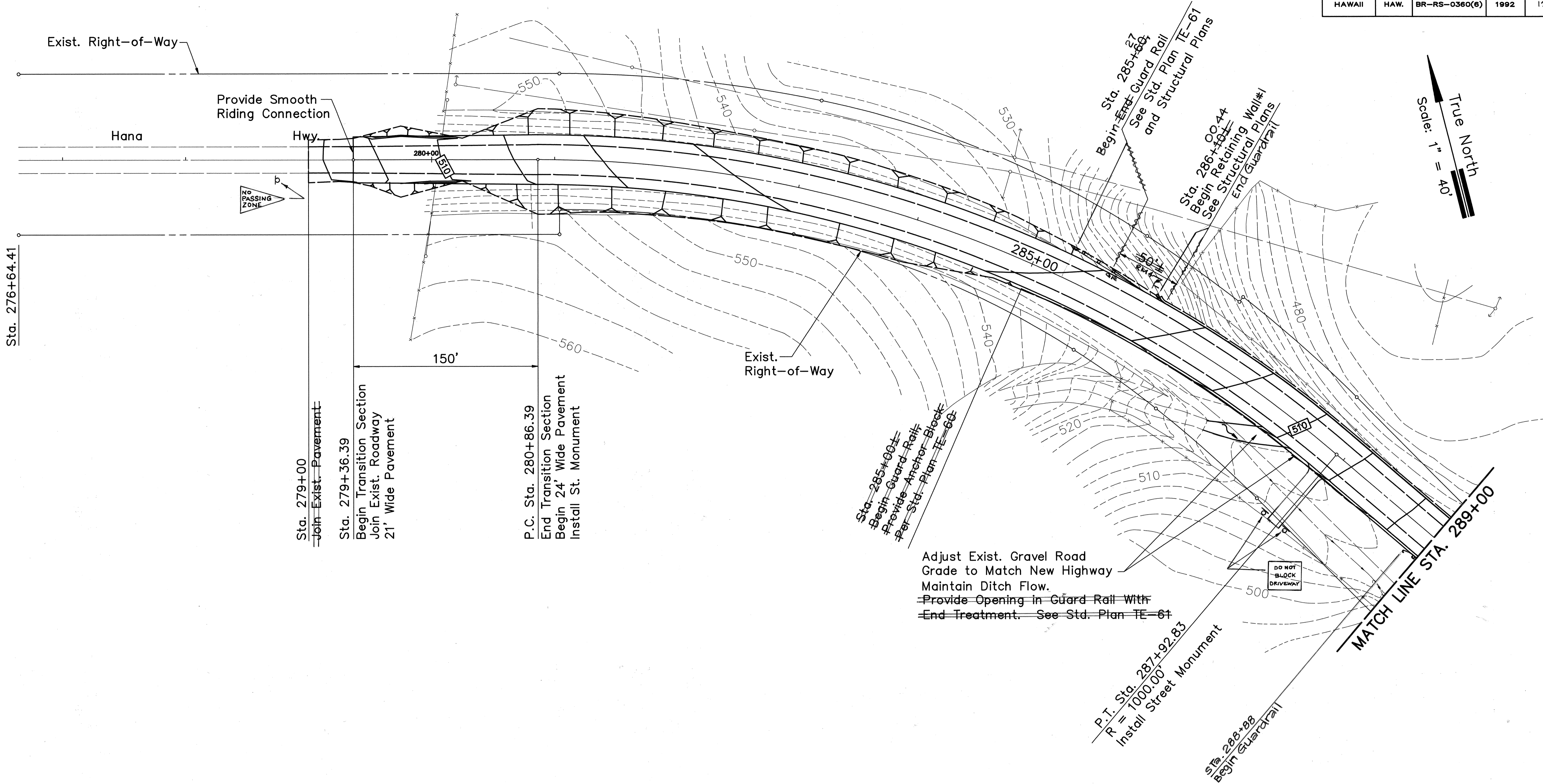

ORIGINAL PLAN	SURVEY PLOTTED BY	DATE
NOTEBOOK	DRAWN BY	
No.	DESIGNED BY	
	QUANTITIES BY	
	CHECKED BY	

FILE: HTM0452
SCALE: 1"=40'
BEG: 9/10/91

PM: STY
OPR: STY,TML,DHY,*CKM
REVIEWED BY: 10/14/91

WORKSHEET:
REVIEWED BY:

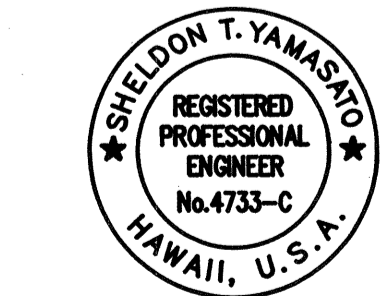

THIS WORK WAS PREPARED BY
ME OR UNDER MY SUPERVISION

Sheldon T. Yamashiro

STATE OF HAWAII
DEPARTMENT OF TRANSPORTATION
HIGHWAYS DIVISION

HIGHWAY IMPROVEMENTS PLAN
STA. 279+36.39 TO 289+00

HOOLAWA BRIDGE REPLACEMENT
HANA HWY., HOOLAWA, MAUI
PROJECT NO. BR-RS-0360(6)

SCALE: 1" = 40' DATE: SEPT. 17, 1991
SHEET NO. OF SHEETS

FED. ROAD DIST. NO.	STATE	FED. AID PROJ. NO.	FISCAL YEAR	SHEET NO.	TOTAL SHEETS
HAWAII	HAW.	BR-RS-0360(6)	1992	13	75

True North
Scale: 1" = 40'

WORKSHEET:
REVIEWED BY:
REVIEWED BY:

PM: STY
OPR: *STY
REVISED: 01/16/93

FILE: PCD2C13
SCALE: 1"=40'
BEG: 9/10/91

ORIGINAL PLAN	SURVEY PLOTTED BY	DATE
NOTED	DESIGNED BY	
NOTED	CHECKED BY	
NOTED	APPROVED BY	

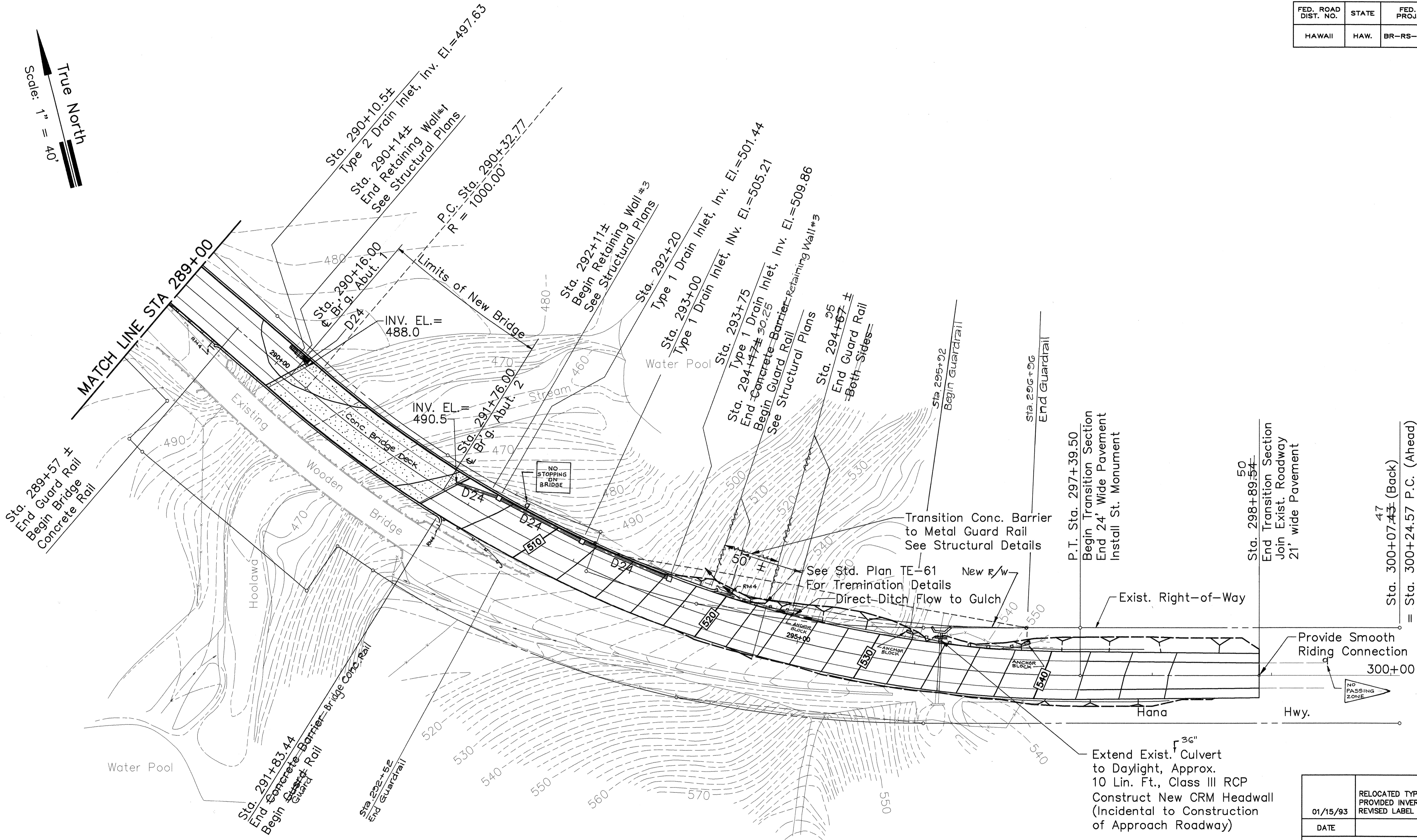

Extend Exist. Culvert to Daylight, Approx. 10 Lin. Ft., Class III RCP Construct New CRM Headwall (Incidental to Construction of Approach Roadway)



THIS WORK WAS PREPARED BY ME OR UNDER MY SUPERVISION

Sheldon T. Yamashita

01/15/93	RELOCATED TYPE 2 D.I. TO STA. 290+10.5 ± PROVIDED INVERT ELEVATIONS AT DRAIN INLETS REVISED LABEL OF DRAINLINE FROM D18 TO D24
----------	--

DATE	REVISION
------	----------

STATE OF HAWAII DEPARTMENT OF TRANSPORTATION HIGHWAYS DIVISION	
HIGHWAY IMPROVEMENTS PLAN STA. 289+00 TO 298+89.54	
HOOLAWA BRIDGE REPLACEMENT HANA HWY., HOOLAWA, MAUI PROJECT NO. BR-RS-0360(6)	
SCALE: 1" = 40'	DATE: SEPT. 17, 1991
SHEET NO.	OF SHEETS