

FED. ROAD DIST. NO.	STATE	FED. AID PROJ. NO.	FISCAL YEAR	SHEET NO.	TOTAL SHEETS
HAWAII	HAW.	BR-RS-0360(6)	1992	15	75

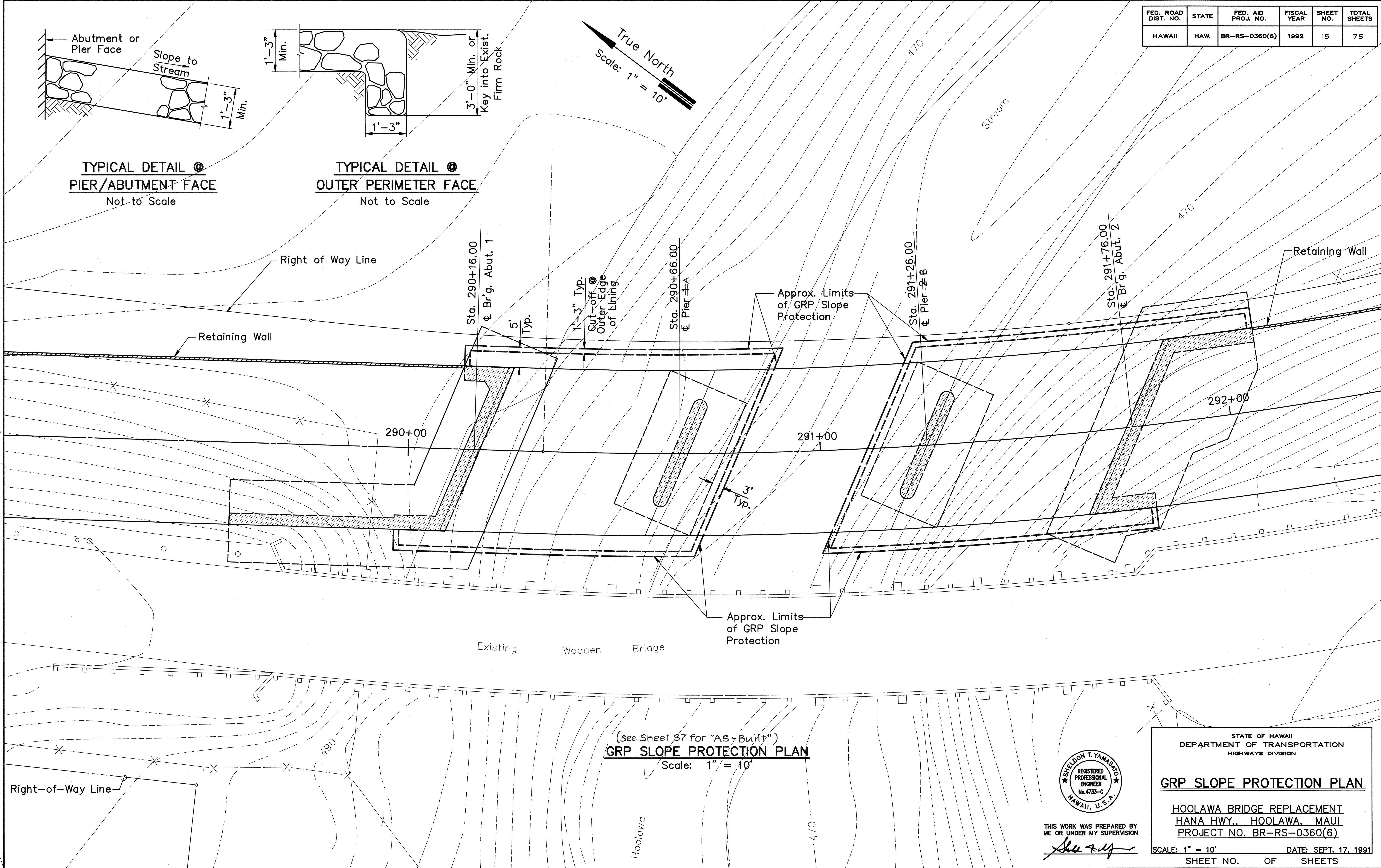

**TYPICAL DETAIL @
PIER/ABUTMENT FACE**
Not to Scale

**TYPICAL DETAIL @
OUTER PERIMETER FACE**
Not to Scale

(See Sheet 37 for "AS-Built")
GRP SLOPE PROTECTION PLAN
Scale: 1" = 10'

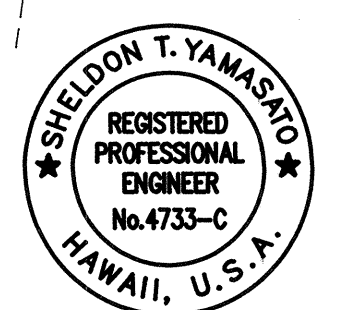

THIS WORK WAS PREPARED BY
ME OR UNDER MY SUPERVISION
Sheldon T. Yamashiro

STATE OF HAWAII
DEPARTMENT OF TRANSPORTATION
HIGHWAYS DIVISION

GRP SLOPE PROTECTION PLAN

HOOLAWA BRIDGE REPLACEMENT
HANA HWY., HOOLAWA, MAUI
PROJECT NO. BR-RS-0360(6)

SCALE: 1" = 10' DATE: SEPT. 17, 1991
SHEET NO. OF SHEETS

ORIGINAL PLAN	DATE
SURVEY PLOTTED BY	
DRAWN BY	
DESIGNED BY	
QUANTITIES BY	
CHECKED BY	

FILE: HTM0455
SCALE: 1"=10'
BEG: 9/17/91

PM: STY
OPR: STY, #DHY
REVIS: 9/20/91

WORKSHEET:
REVIEWED BY:
REVIEWED BY:

ROTATE -38.7117D