

PLAN
Scale: 1/4" = 1'-0"

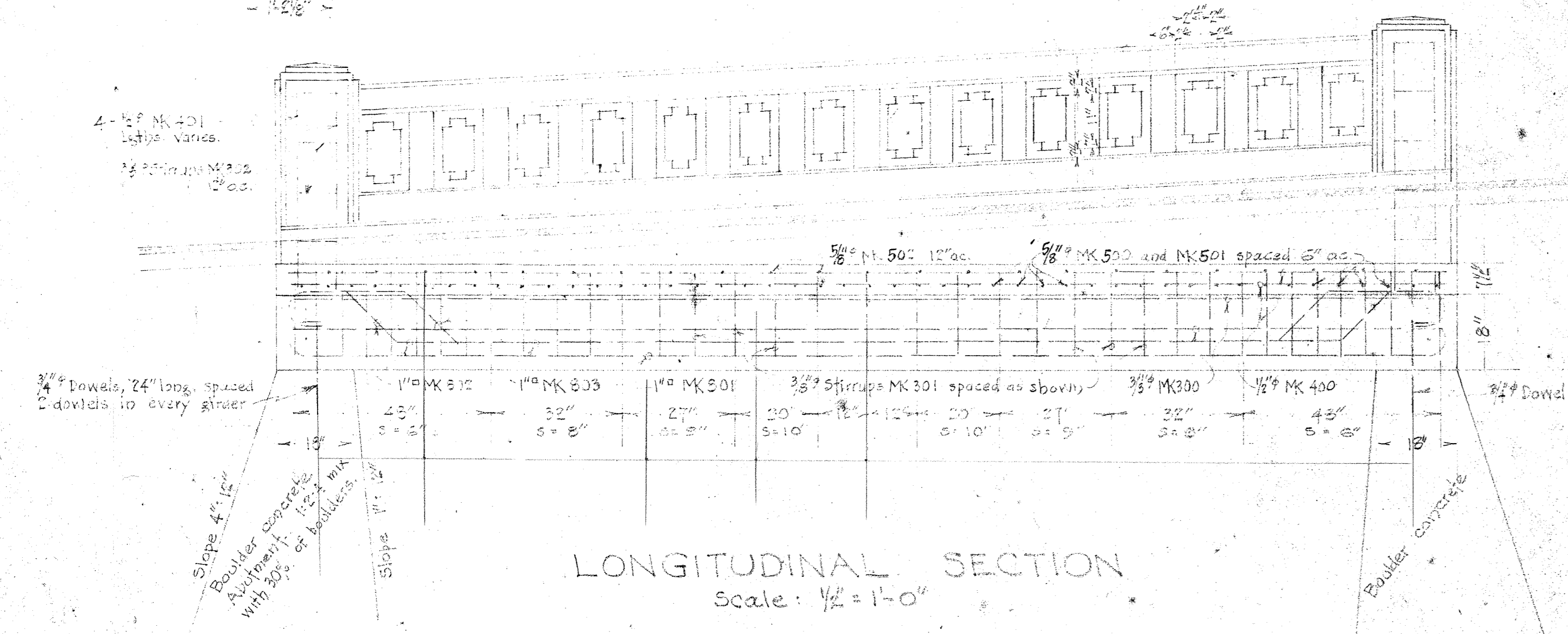

LONGITUDINAL SECTION
Scale: 1/2" = 1'-0"

GENERAL NOTES
DEAD LOAD: Concrete at 150# per cubic foot.
LIVE LOAD: One 25 ton truck with 30% allowable for impact.
CONCRETE: Class "A" (12,000 psi) with all exposed edges chamfered 3/4" unless otherwise noted.
ALLOWABLE COMPRESSION: 650# per square inch.
REINFORCING STEEL: Allowable tensile stress 16,000# per square inch. All steel to be round or square deformed bars of approved design. All dimensions relating to reinforcement are to centers of bars unless otherwise noted. Main longitudinal bars are not to be spliced. Unless otherwise noted the minimum covering measured from the surface of the concrete to the face of any steel shall be not less than 2" in beams, girders, and band rails; and 1 1/2" in slab. Steel to be held rigidly and accurately in place before and during placing of concrete.

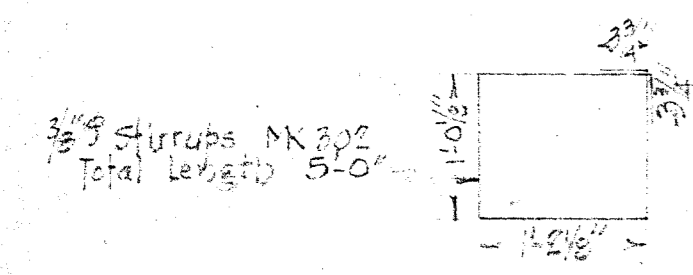
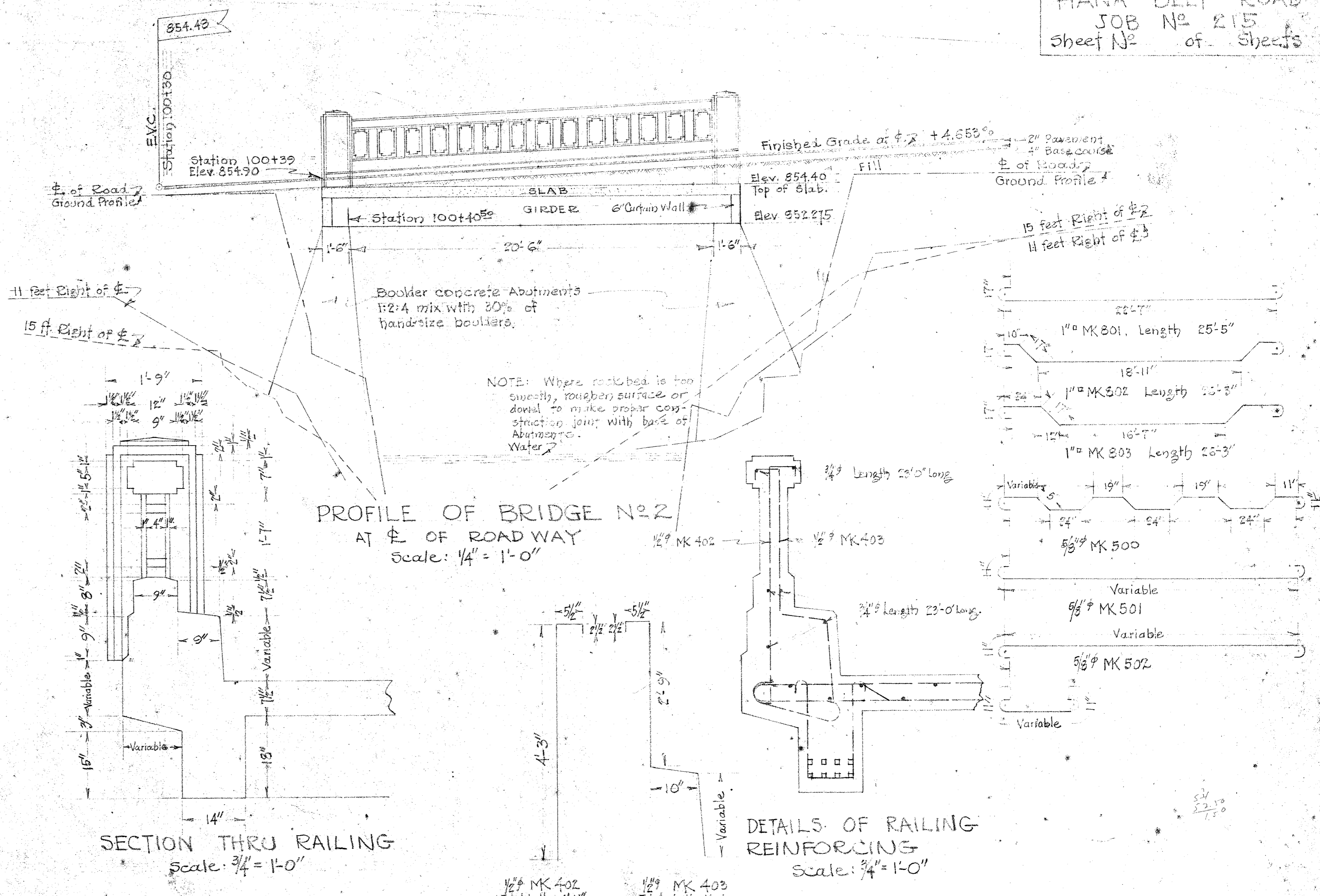

PROFILE OF BRIDGE No 2
AT E OF ROAD WAY
Scale: 1/4" = 1'-0"

SECTION THRU RAILING
Scale: 3/4" = 1'-0"

DETAILS OF RAILING REINFORCING
Scale: 3/4" = 1'-0"

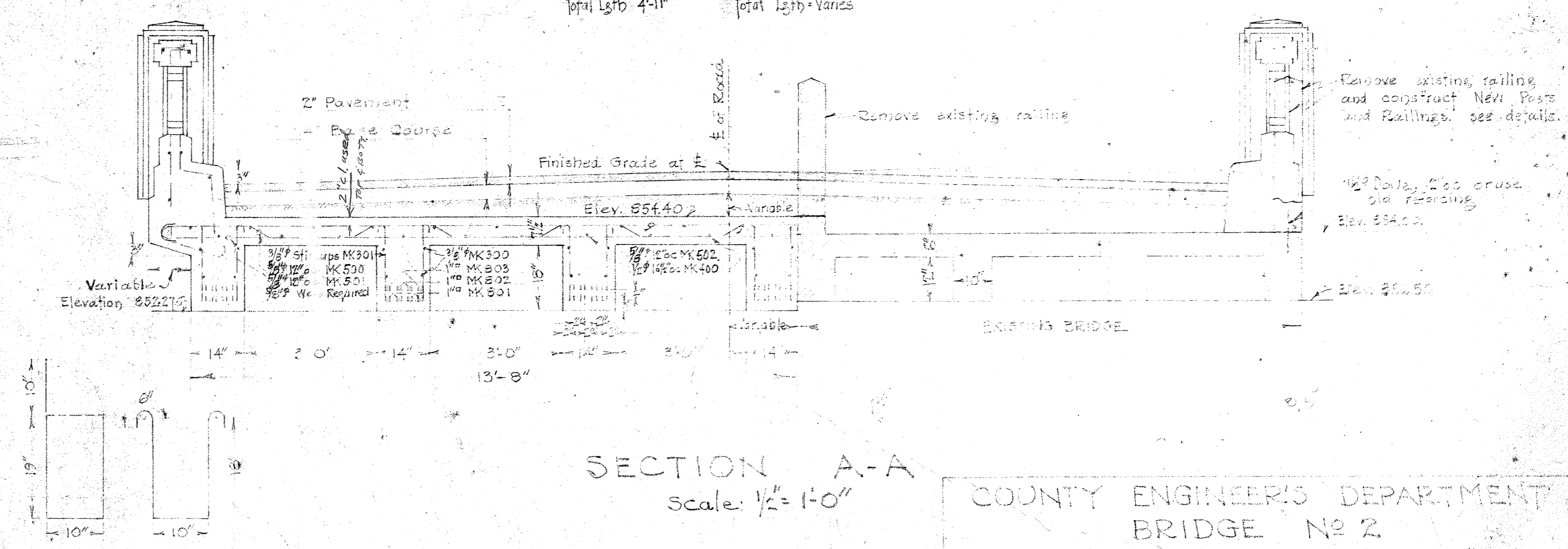

SECTION A-A
Scale: 1/2" = 1'-0"

Waikamilo Stream Bridge
009 00360 05 01811
Hana Highway (Route 360)
Milepost 18.07

COUNTY ENGINEER'S DEPARTMENT
BRIDGE No 2
WAIKAMILLO STREAM 360014
HANA BELT ROAD WAIKANI SECTION
NOVEMBER 1937
DESIGNED BY DKKAROHAKIMOHEHA
DRAWING BASED BY AKI LEONG
CHECKED BY DKK
APPROVED
COUNTY ENGINEER

Waiokamilo Stream Bridge
 009 00360 05 01811
 Hana Highway (Route 360)
 Milepost 18.07

HANA BELT ROAD
 JOB No 215
 Sheet No of Sheets

M-8: Sht. 12 of 21

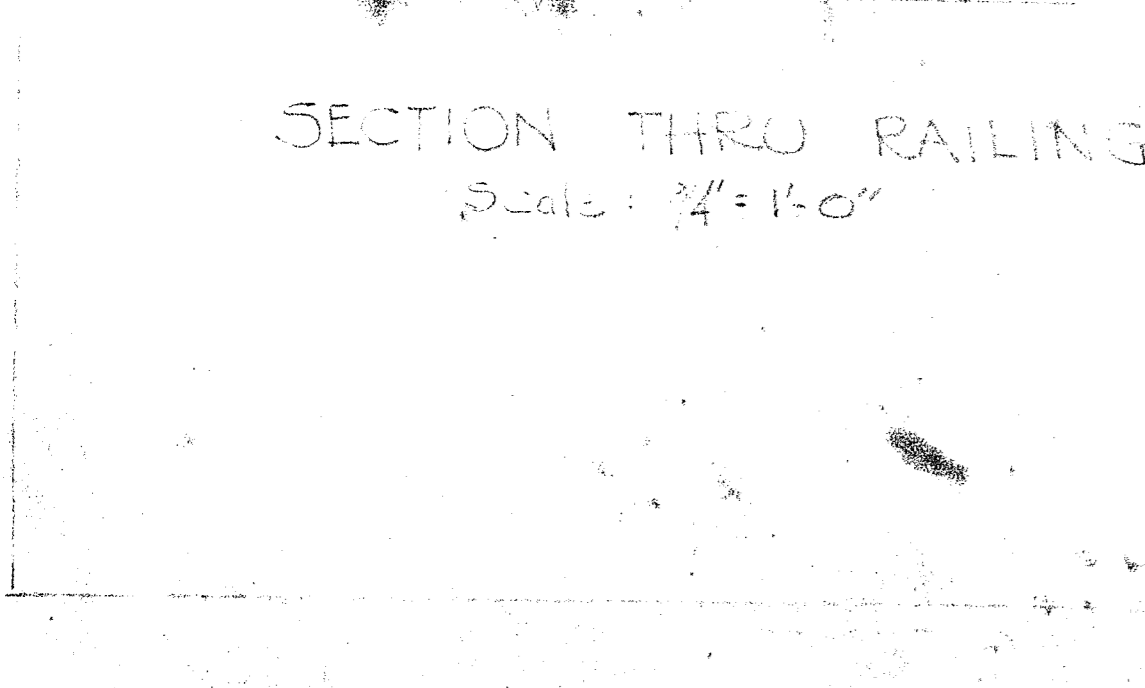
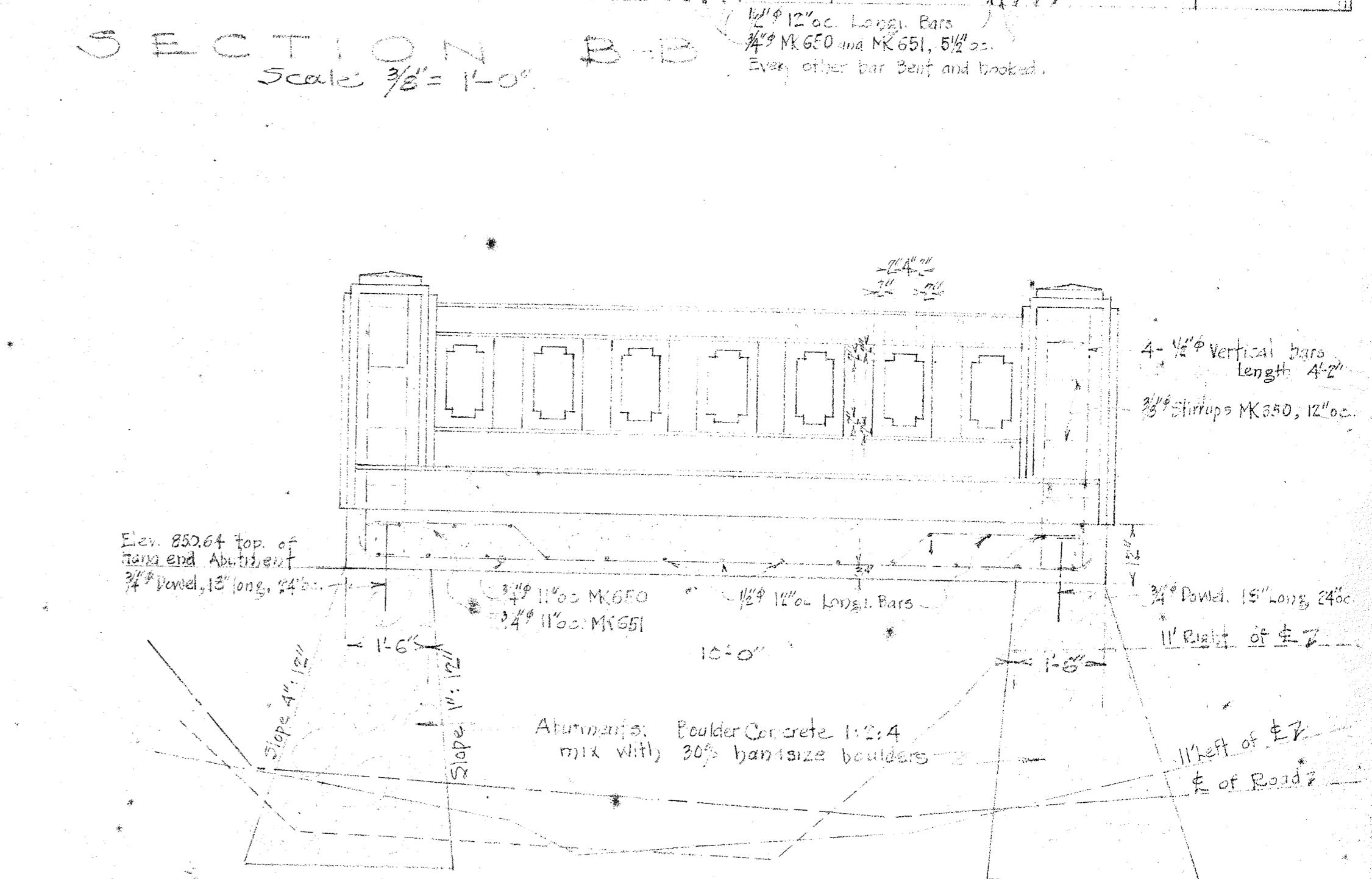
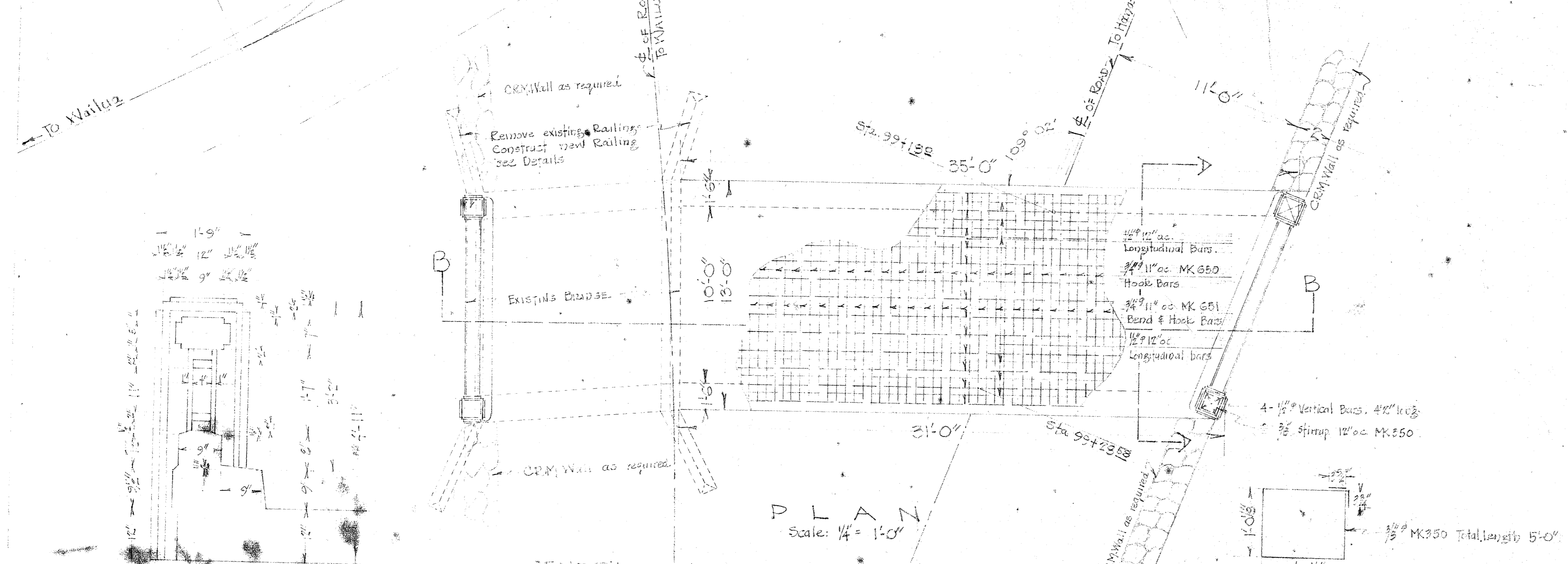
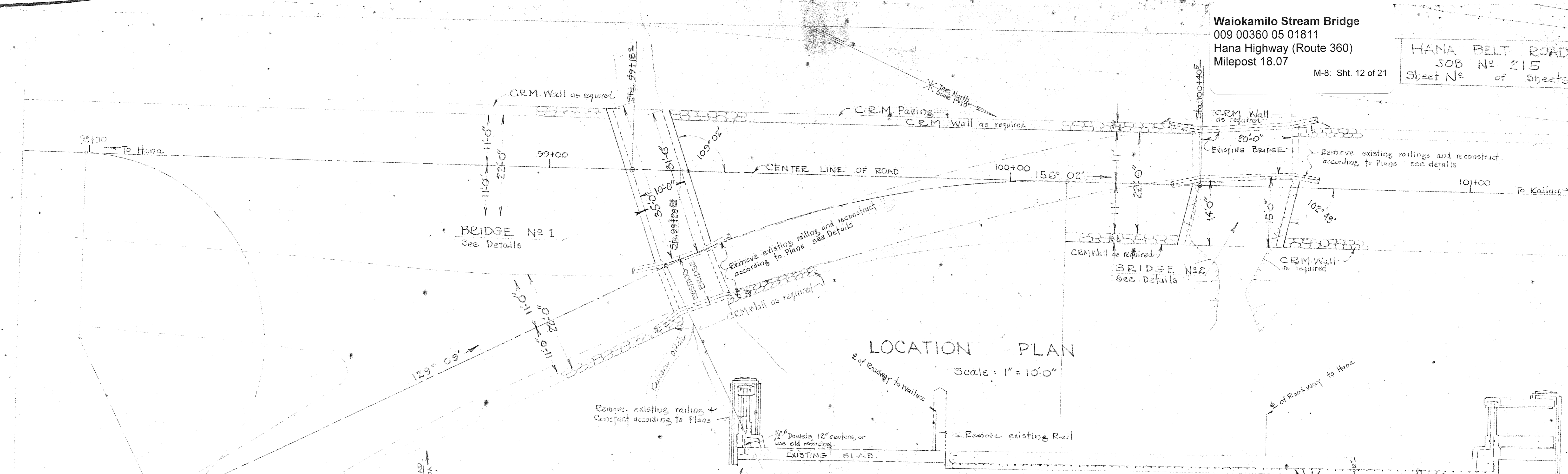

GENERAL NOTES

DEAD LOAD: Concrete at 150# per cubic foot.
 LIVE LOAD: 25 ton truck, with 30% allowance for impact.

CONCRETE: Class 'A' (1:2:4 mix) with all exposed edges chamfered 3/4" unless otherwise noted. Allowable compression 650# per square inch. Allowable tensile stress 16,000# per square inch. All steel to be round, or square, or rectangular bars of approved design. All dimensions relating to reinforcement are to center of bars unless otherwise noted. Main longitudinal bars are to be spliced. Unless otherwise noted, the minimum covering measured from the surface of the concrete to the face of any steel shall be not less than 2" in beams, girders, and band rails; and 1 1/2" in slabs. Steel to be held rigidly and accurately in place before and during placing of concrete.

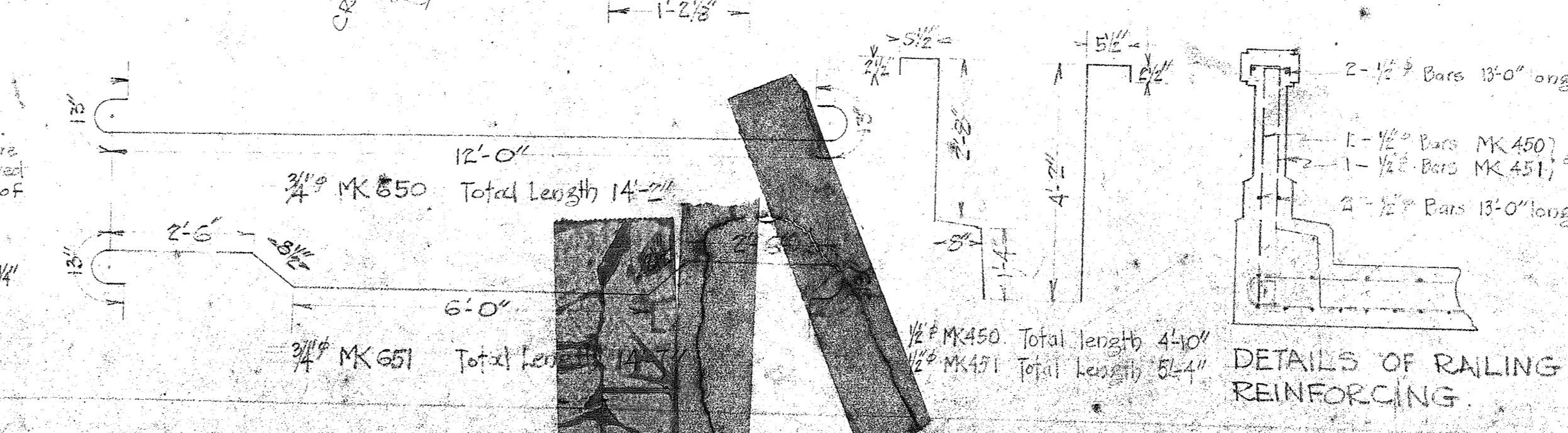

COUNTY ENGINEER'S DEPARTMENT
 BRIDGE No 1
 WAIOKAMILLO STREAM
 HANA BELT ROAD - WAIKANI SECTION

NOVEMBER 1937.

DESIGNED BY: R.K. KAPAHAKIMOHIA
 DRAWN AND BASED BY: AKI LEONG
 CHECKED BY: D.A.K.

APPROVED
 COUNTY ENGINEER