

FED. ROAD DIST. NO.	STATE	FED. AID PROJ. NO.	FISCAL YEAR	SHEET NO.	TOTAL SHEETS
HAWAII	HAW.	STP-0340(005)	2020	ADD.7	44

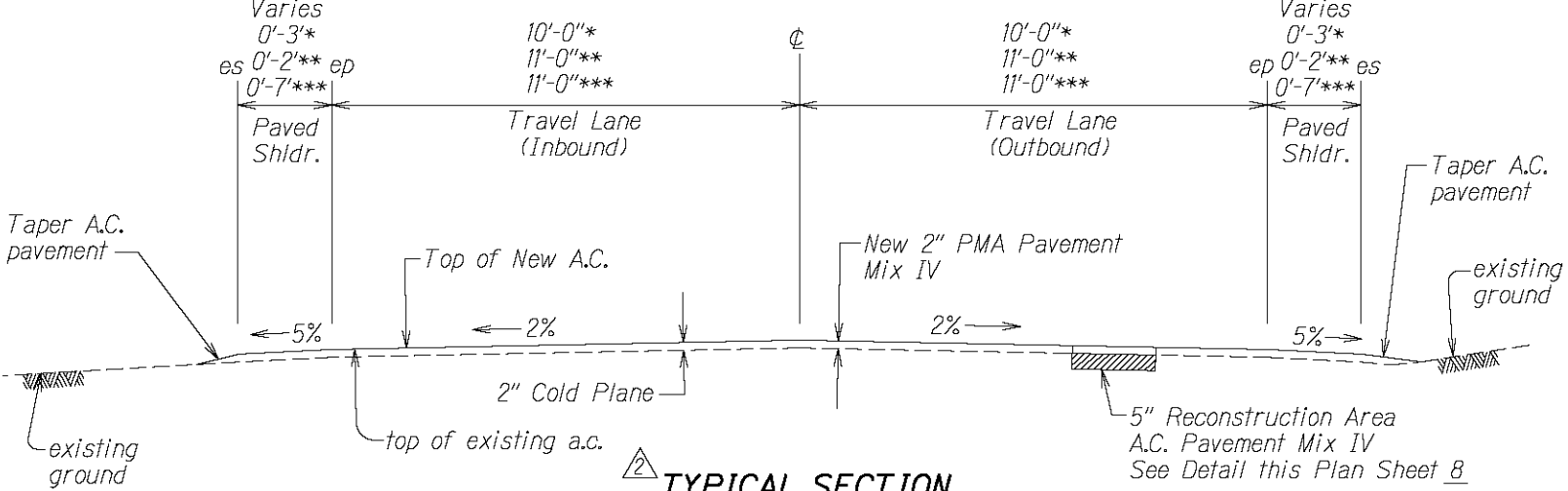

**TYPICAL SECTION**  
\*STA. 85+00± - STA. 115+00±  
\*\*STA. 23+00± - STA. 85+00±  
\*\*\*STA. 0+00 - STA. 23+00, STA. 0+00 - STA. -3+41.16  
Scale: 1/2" = 1'-0"

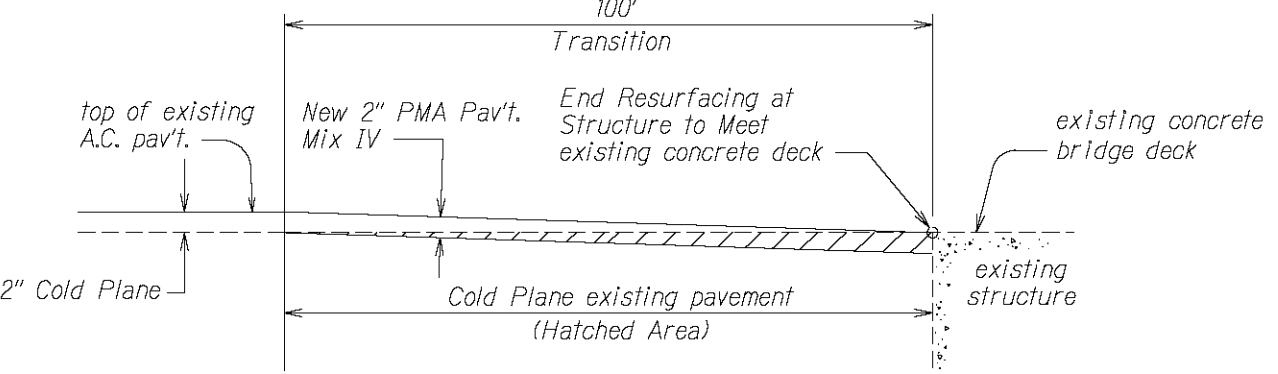

**WAIHEE BRIDGE**  
**COLD PLANED TRANSITION AT STRUCTURE**  
Not to Scale

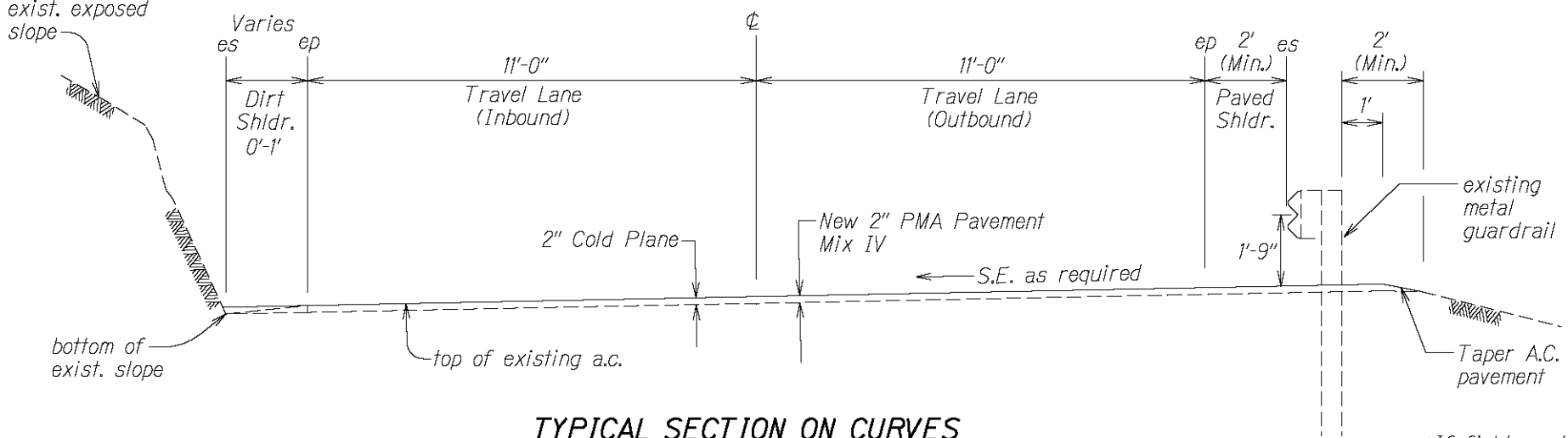

**TYPICAL SECTION ON CURVES**  
STA. 115+00± - STA. 140+00±  
Scale: 1/2" = 1'-0"

\*If field conditions restrict, cold planing and paving should be at least to face of guardrail

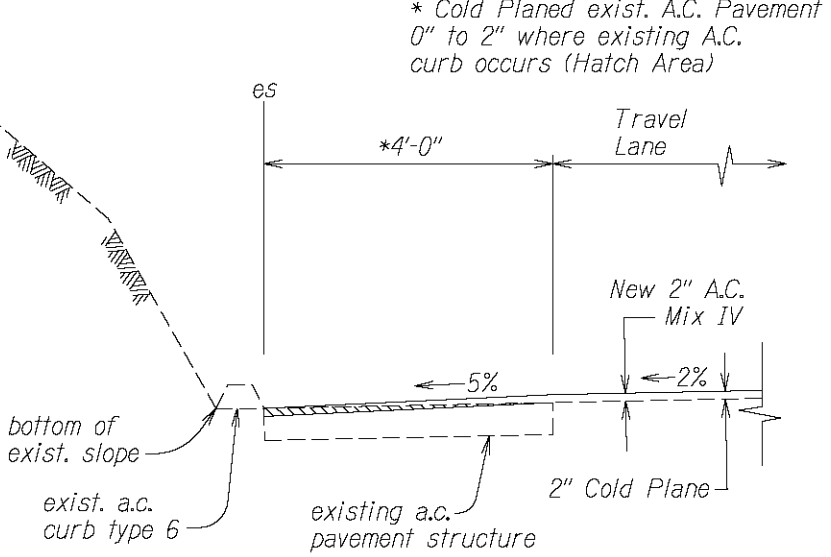

**DETAIL FOR COLD PLANE**  
STA. 140+00± LT. - STA. 223+93± LT.  
Not to Scale

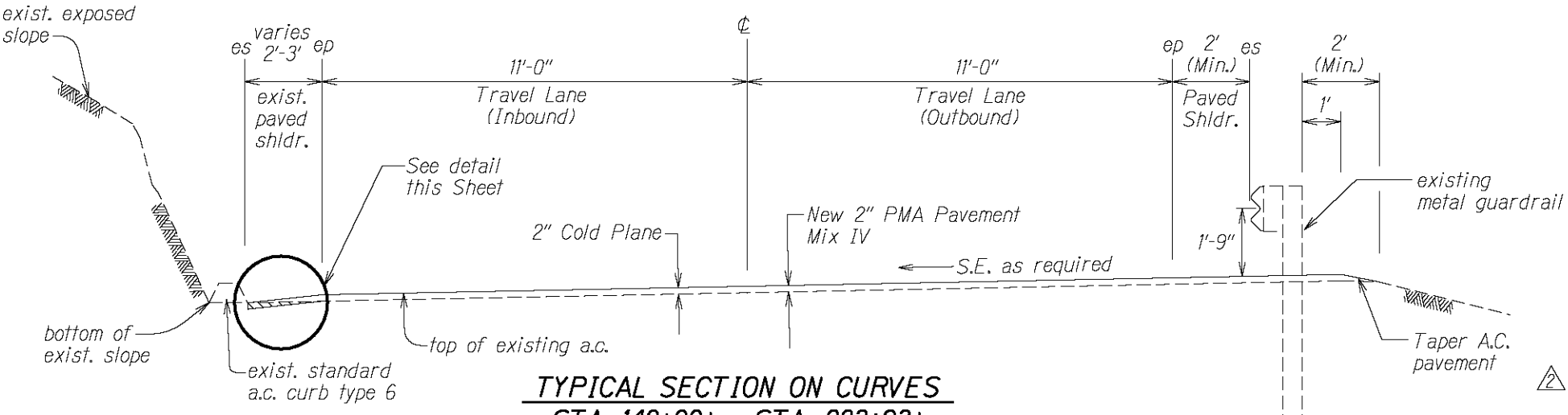

**TYPICAL SECTION ON CURVES**  
STA. 140+00± - STA. 223+93±  
Scale: 1/2" = 1'-0"

3-19-21 Revised Width of Travel Lane.

DATE REVISION

STATE OF HAWAII  
DEPARTMENT OF TRANSPORTATION  
HIGHWAYS DIVISION

**TYPICAL SECTIONS & DETAILS**

KAHEKILI HIGHWAY RESURFACING  
Waiehu Beach Road to Camp Maluhia  
Federal-Aid Project No. STP-0340(005)

Scale: As Shown Date: May, 2020

SHEET No. 1 OF 3 SHEETS

SURVEY PLOTTED BY	DATE
2/28	
DESIGNED BY	
NOTED BY	
QUANTITIES BY	
CHECKED BY	

FED. ROAD DIST. NO.	STATE	FED. AID PROJ. NO.	FISCAL YEAR	SHEET NO.	TOTAL SHEETS
HAWAII	HAW.	STP-0340(005)	2020	8	44

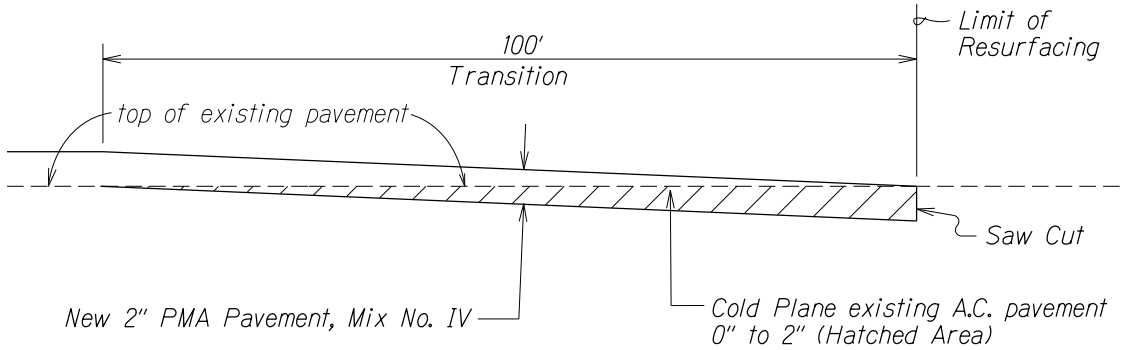

COLD PLANED TRANSITION  
TO EXISTING A.C. PAVEMENT  
Not To Scale

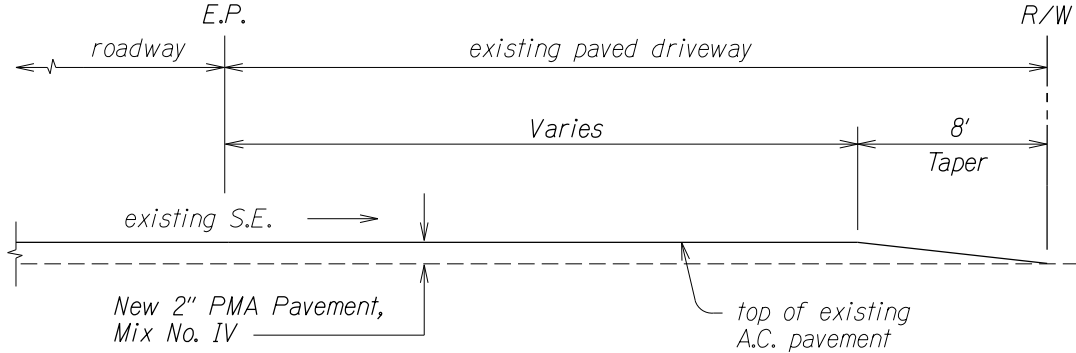

PAVED DRIVEWAY DETAIL  
Not To Scale

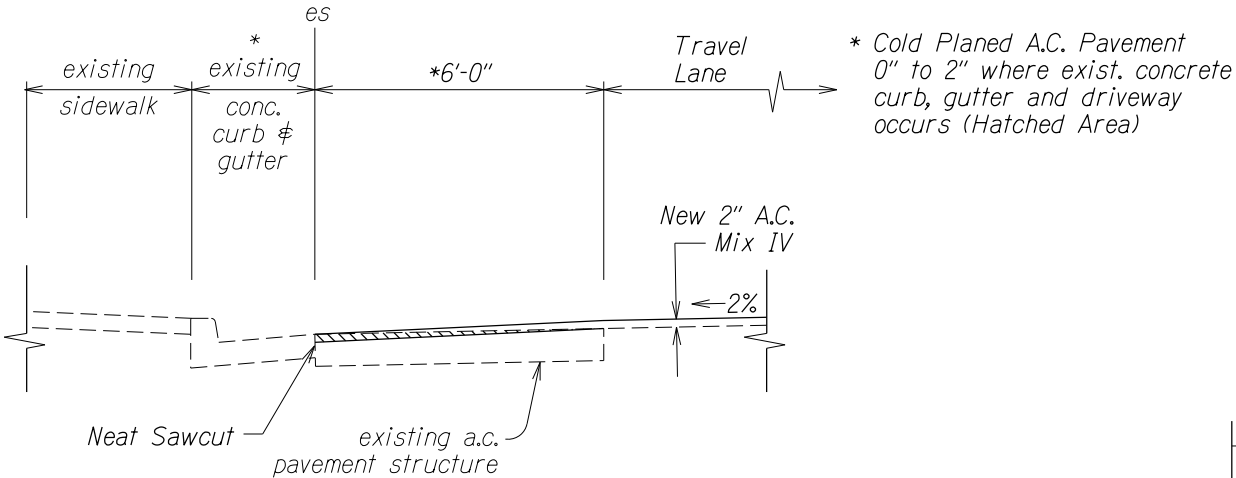

DETAIL FOR COLD PLANE  
STA. 60+70± LT. - STA. 80+80± LT. (CONCRETE CURB)  
STA. 31+10± RT. - STA. 37+10± RT. (CONCRETE CURB & GUTTER)  
STA. 80+80± LT. - STA. 85+00± LT. (CONCRETE CURB & GUTTER)  
STA. 117+00± LT. & RT. - STA. 120+30± LT. & RT. (CONCRETE GUTTER)  
Scale: 1/2" = 1'-0"

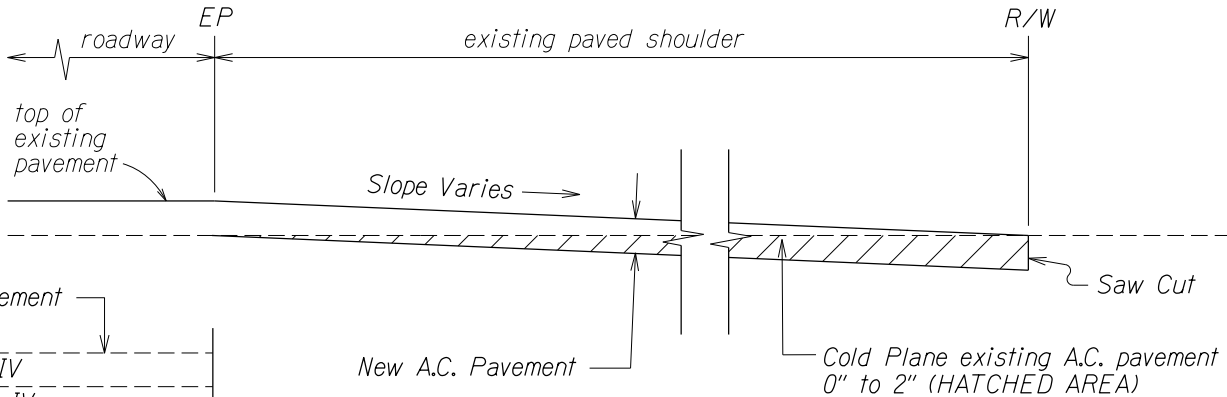

PAVED SIDE ROAD DETAIL  
Not To Scale

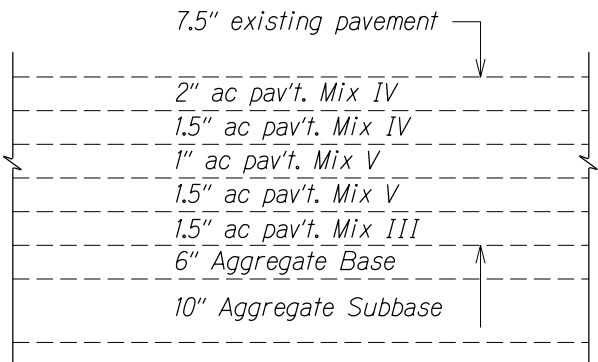

EXISTING PAVEMENT  
Not To Scale

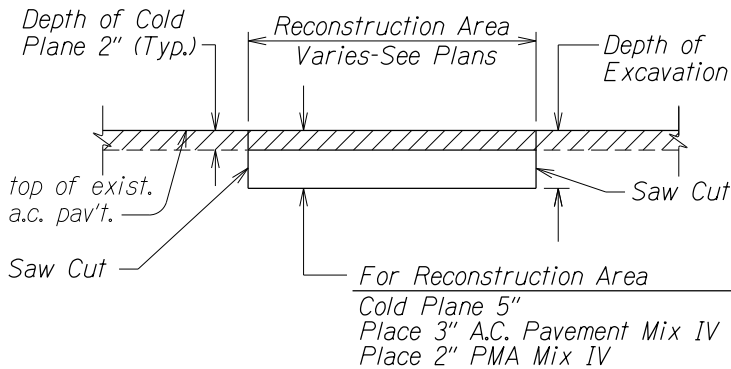

A.C. PAVEMENT RECONSTRUCTION DETAIL  
Not To Scale

NOTES FOR RECONSTRUCTION AREAS

1. Reconstruct Weakened Pavement Areas prior to cold plane.
2. The exposed remaining base course or subbase materials should be properly recompacted to dense and unyielding conditions prior to placement of the asphalt base course.

STATE OF HAWAII  
DEPARTMENT OF TRANSPORTATION  
HIGHWAYS DIVISION

TYPICAL SECTIONS & DETAILS

KAHEKILI HIGHWAY RESURFACING  
Waiehu Beach Road to Camp Maluhia  
Federal-Aid Project No. STP-0340(005)

Scale: As Shown Date: May, 2020

SHEET No. 2 OF 3 SHEETS

SURVEY PLOTTED BY	DATE
DRAWN BY	2/18
DESIGNED BY	
NOTED BY	
QUANTITIES BY	
CHECKED BY	
ORIGINAL PLAN	
NOTE BOOK	
me Jay	
Thimisch	

COLD PLANING AT EXISTING  
GRATED DROP INTAKE DETAIL  
Not to Scale

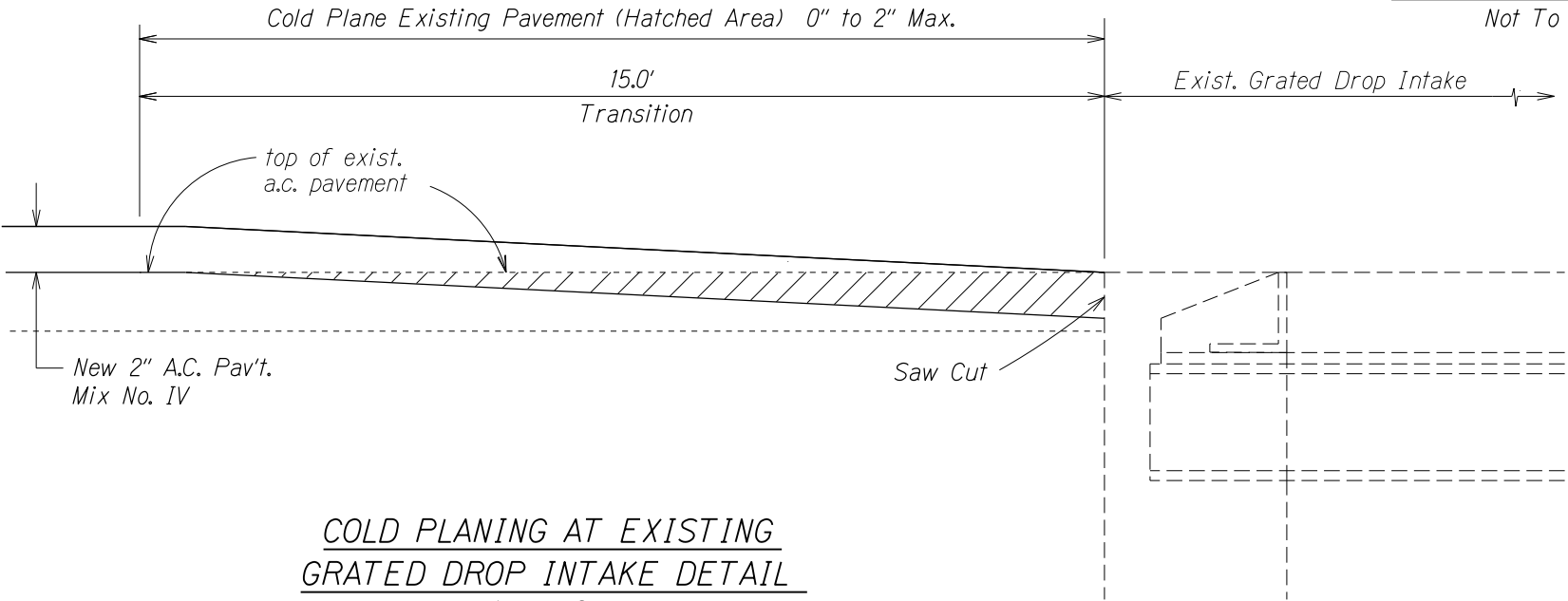

FED. ROAD DIST. NO.	STATE	FED. AID PROJ. NO.	FISCAL YEAR	SHEET NO.	TOTAL SHEETS
HAWAII	HAW.	STP-0340(005)	2020	9	44

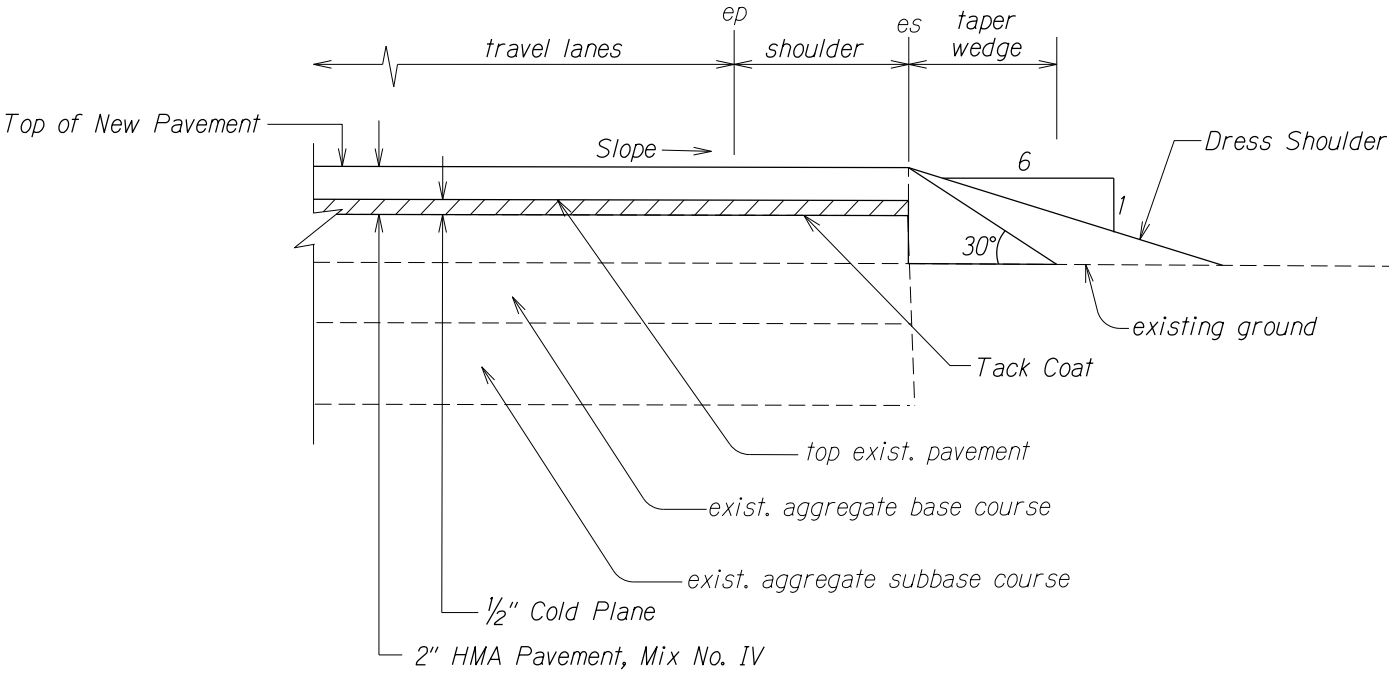

Note: Contractor shall mount a device directly on the paver screed extension to provide a 30° beveled shoulder edge.

TYPICAL PAVEMENT EDGE DETAIL  
Not To Scale

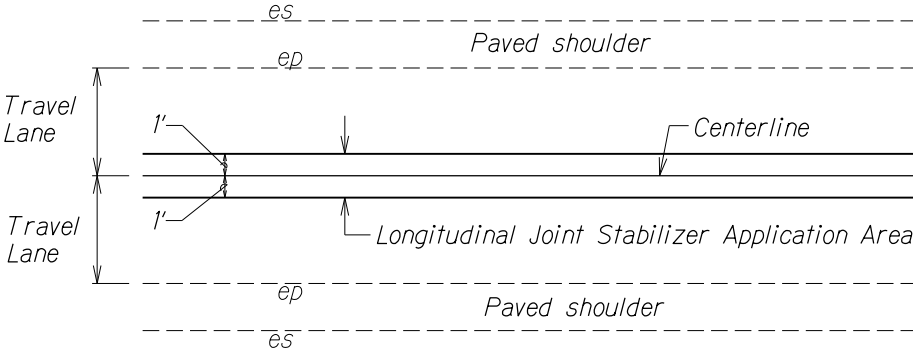

TYPICAL SECTION FOR LONGITUDINAL JOINT STABILIZER  
Not To Scale

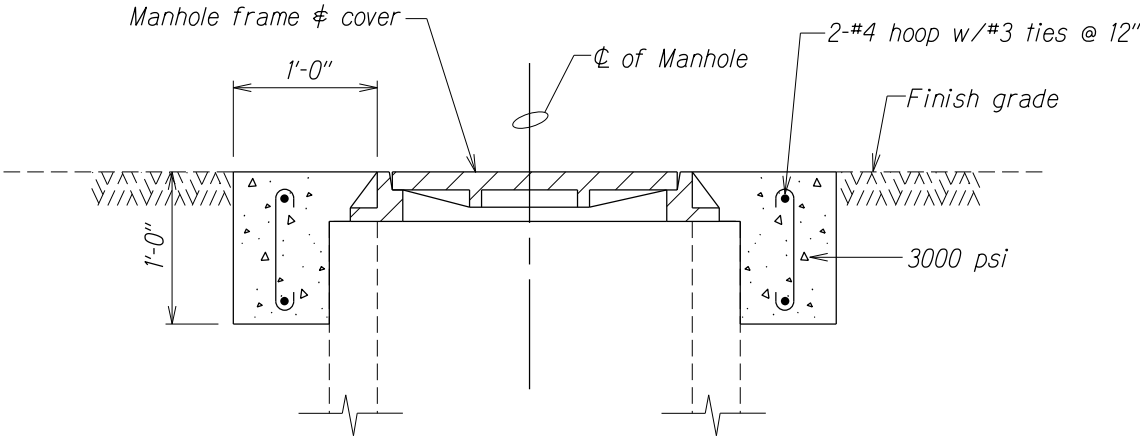

DETAIL - CONCRETE COLLAR FOR AJUSTMENTS OF MANHOLES AND VALVE BOX  
Not To Scale

STATE OF HAWAII  
DEPARTMENT OF TRANSPORTATION  
HIGHWAYS DIVISION

**TYPICAL SECTIONS & DETAILS**

KAHEKILI HIGHWAY RESURFACING  
Waiehu Beach Road to Camp Maluhia  
Federal-Aid Project No. STP-0340(005)

Scale: As Shown      Date: May, 2020

SHEET No. 3 OF 3 SHEETS

SURVEY PLOTTED BY	DATE
DRAWN BY	2/18
DESIGNED BY	
NOTED BY	
QUANTITIES BY	
CHECKED BY	
ORIGINAL PLAN	
NOTE BOOK	
ddxx	
N. Y. dgn	