

FED. ROAD DIST. NO.	STATE	FEDERAL - AID PROJ. NO.	FISCAL YEAR	SHEET NO.	TOTAL SHEETS
HAWAII	HAW.	NH-0311(5)	2003	120	189

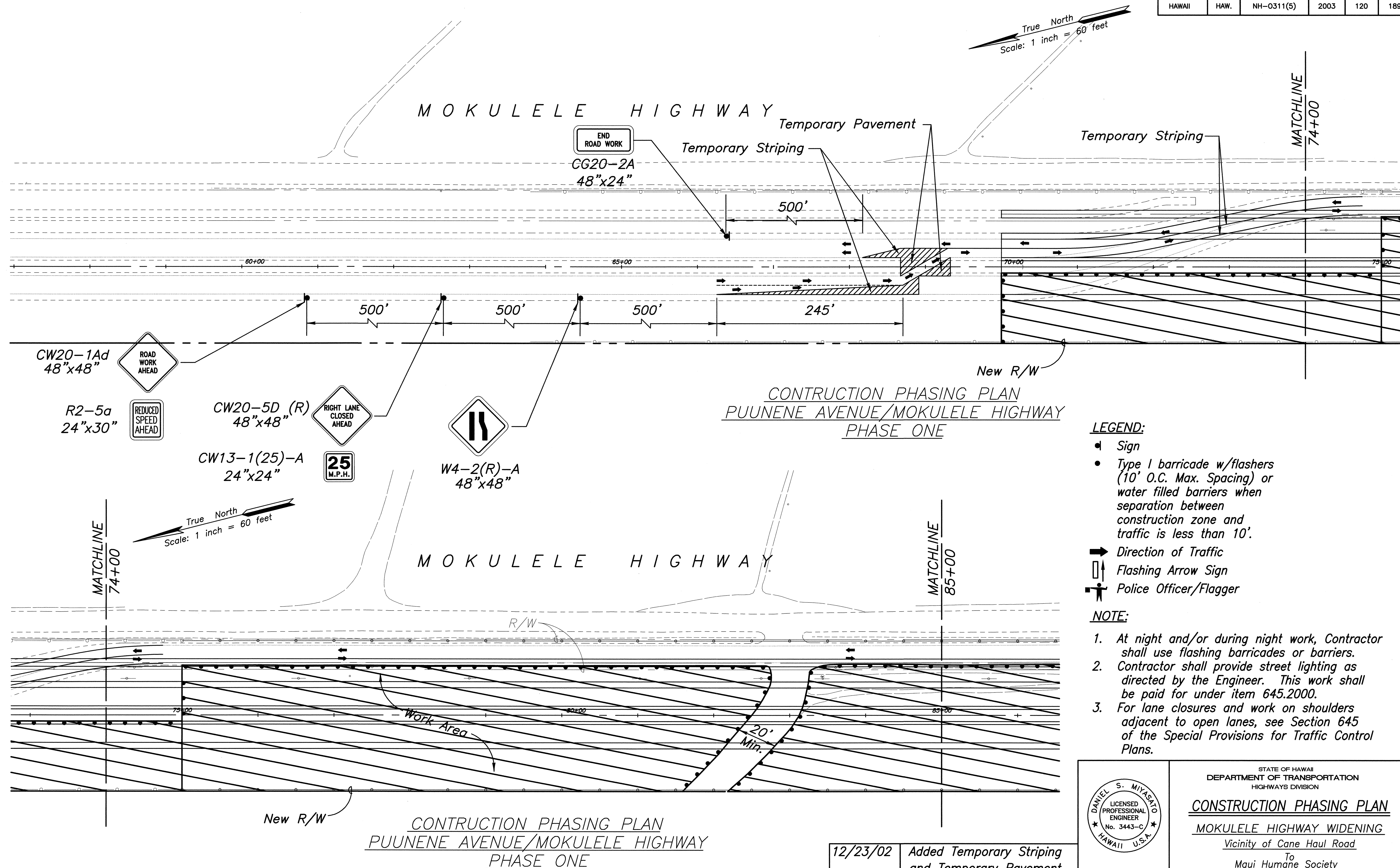

**LEGEND:**

- Sign
- Type I barricade w/flashers (10' O.C. Max. Spacing) or water filled barriers when separation between construction zone and traffic is less than 10'.
- Direction of Traffic
- Flashing Arrow Sign
- Police Officer/Flagger

**NOTE:**

- At night and/or during night work, Contractor shall use flashing barricades or barriers.
- Contractor shall provide street lighting as directed by the Engineer. This work shall be paid for under item 645.2000.
- For lane closures and work on shoulders adjacent to open lanes, see Section 645 of the Special Provisions for Traffic Control Plans.

STATE OF HAWAII  
DEPARTMENT OF TRANSPORTATION  
HIGHWAYS DIVISION

**CONSTRUCTION PHASING PLAN**  
**MOKULELE HIGHWAY WIDENING**  
Vicinity of Cane Haul Road  
To  
Maui Humane Society  
Federal - Aid Project No. NH-0311(5)  
Scale: 1"=60' Date: JUNE 2002

DANIEL S. MIYASATO  
LICENSED PROFESSIONAL ENGINEER  
No. 3443-C  
HAWAII U.S.A.

12/23/02 Added Temporary Striping and Temporary Pavement with Signage

DATE	REVISION

ORIGINAL PLAN	SURVEY PLOTTED BY	DATE
NOTE BOOK	DRAWN BY	
	DESIGNED BY	
	QUANTITIES BY	
	CHECKED BY	

PROJ. NO.: M8901.00  
 2/28/02  
 R:\moku\_ph325\top\PHASE1.dwg

FED. ROAD DIST. NO.	STATE	FEDERAL - AID PROJ. NO.	FISCAL YEAR	SHEET NO.	TOTAL SHEETS
HAWAII	HAW.	NH-0311(5)	2003	121	189

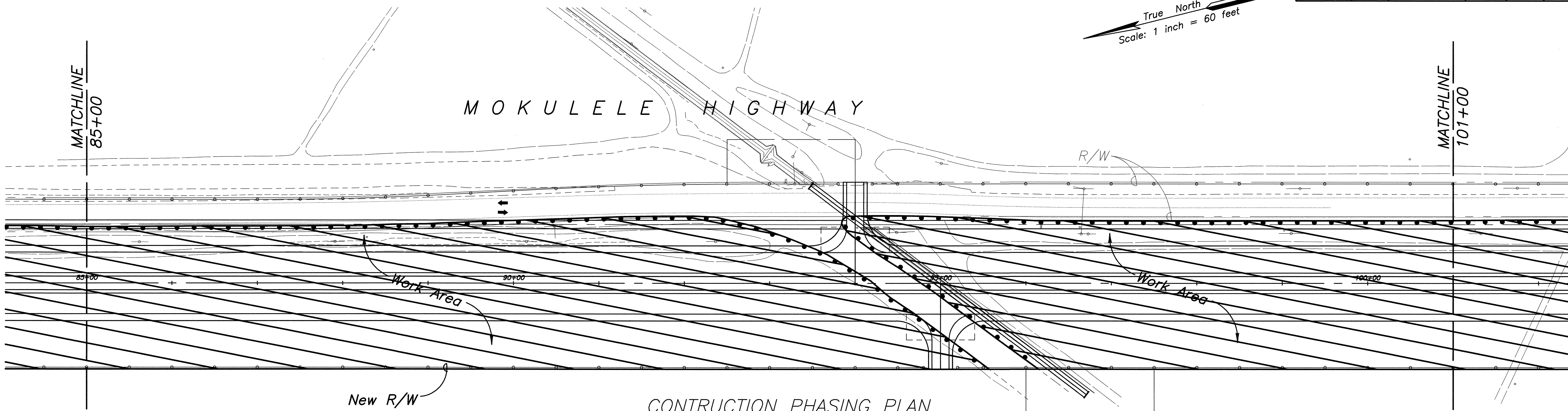

CONSTRUCTION PHASING PLAN  
PUUNENE AVENUE/MOKULELE HIGHWAY  
PHASE ONE

**LEGEND:**

- Sign
- Type I barricade w/flashers (10' O.C. Max. Spacing) or water filled barriers when separation between construction zone and traffic is less than 10'.
- ➔ Direction of Traffic
- ⬆ Flashing Arrow Sign
- 👮 Police Officer/Flagger

**NOTE:**

1. At night and/or during night work, Contractor shall use flashing barricades or barriers.
2. Contractor shall provide street lighting as directed by the Engineer. This work shall be paid for under item 645.2000.
3. For lane closures and work on shoulders adjacent to open lanes, see Section 645 of the Special Provisions for Traffic Control Plans.

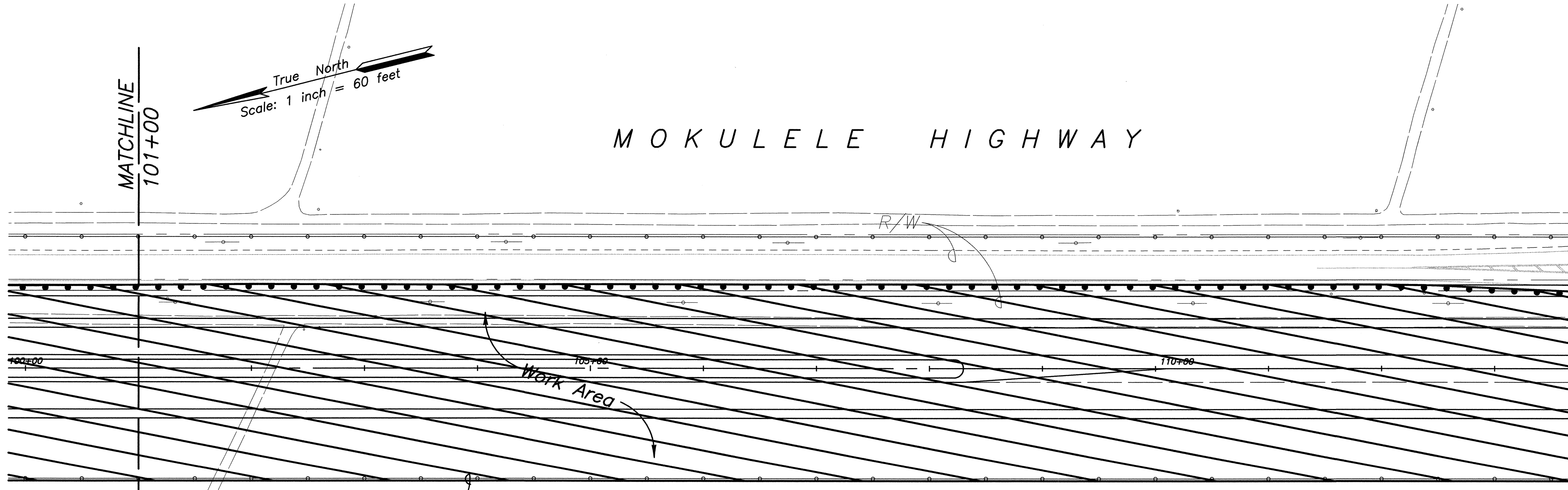

CONSTRUCTION PHASING PLAN  
PUUNENE AVENUE/MOKULELE HIGHWAY  
PHASE ONE

12/23/02	Revised Irrigation Ditch, Added Access Road at Baseline Station 94+00 and 95+00
DATE	REVISION

STATE OF HAWAII  
DEPARTMENT OF TRANSPORTATION  
HIGHWAYS DIVISION

**CONSTRUCTION PHASING PLAN**

MOKULELE HIGHWAY WIDENING

Vicinity of Cane Haul Road

To

Maui Humane Society

Federal - Aid Project No. NH-0311(5)

Scale: 1"=60'      Date: JUNE 2002

SHEET No. 2 OF 11 SHEETS

**ADD. 121**

ORIGINAL PLAN	SURVEY PLOTTED BY	DATE
NOTE BOOK	DRAWN BY	
	DESIGNED BY	
	QUANTITIES BY	
	CHECKED BY	
No.		



FED. ROAD DIST. NO.	STATE	FEDERAL - AID PROJ. NO.	FISCAL YEAR	SHEET NO.	TOTAL SHEETS
HAWAII	HAW.	NH-0311(5)	2003	122	189

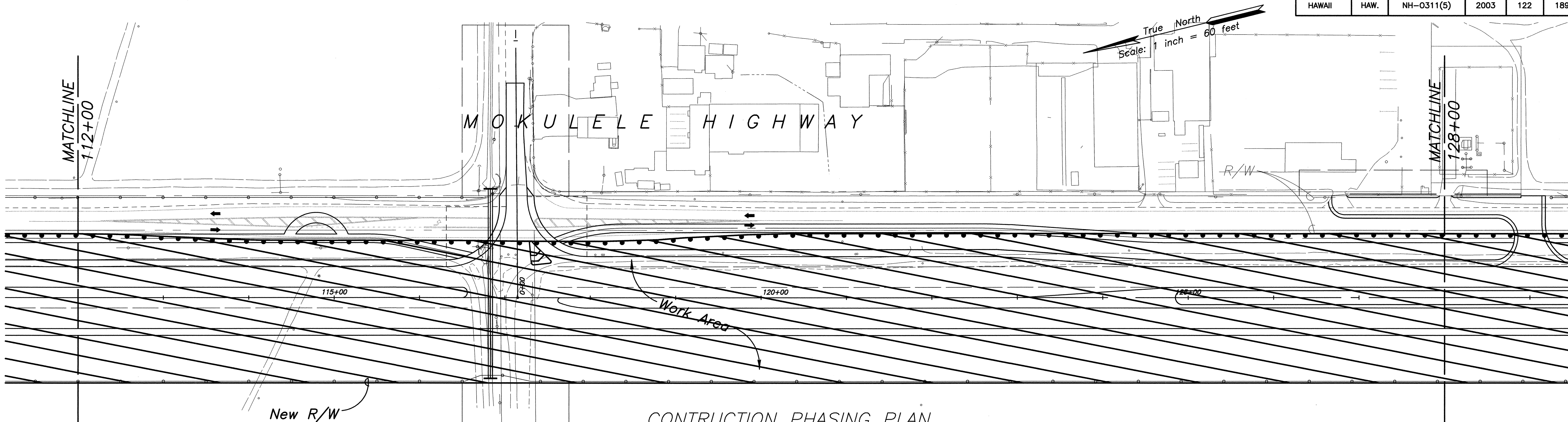

CONSTRUCTION PHASING PLAN  
PUUNENE AVENUE/MOKULELE HIGHWAY  
PHASE ONE

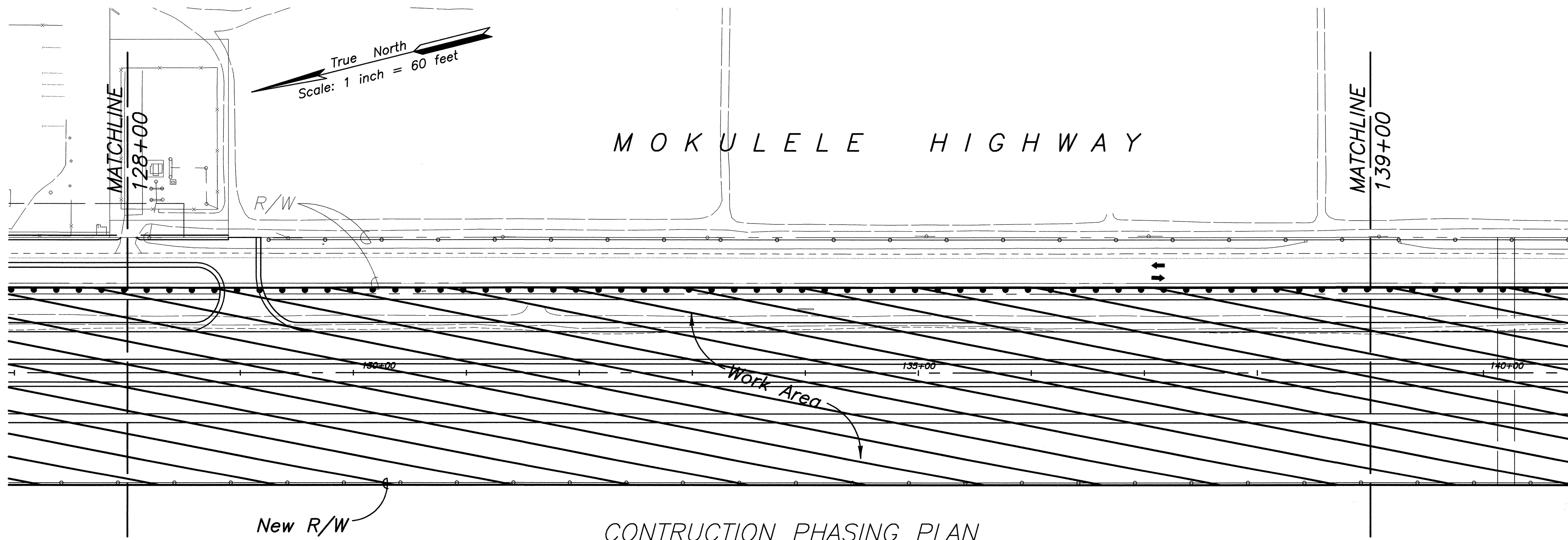

CONSTRUCTION PHASING PLAN  
PUUNENE AVENUE/MOKULELE HIGHWAY  
PHASE ONE

**LEGEND:**

- Sign
- Type I barricade w/flashers (10' O.C. Max. Spacing) or water filled barriers when separation between construction zone and traffic is less than 10'.
- ➔ Direction of Traffic
- ⬆ Flashing Arrow Sign
- 👮 Police Officer/Flagger

**NOTE:**

1. At night and/or during night work, Contractor shall use flashing barricades or barriers.
2. Contractor shall provide street lighting as directed by the Engineer. This work shall be paid for under item 645.2000.
3. For lane closures and work on shoulders adjacent to open lanes, see Section 645 of the Special Provisions for Traffic Control Plans.

ORIGINAL PLAN	SURVEY PLOTTED BY	DATE
NO.	DRAWN BY	
	TRACED BY	
	QUANTITIES BY	
	CHECKED BY	

STATE OF HAWAII  
DEPARTMENT OF TRANSPORTATION  
HIGHWAYS DIVISION

**CONSTRUCTION PHASING PLAN**

**MOKULELE HIGHWAY WIDENING**

Vicinity of Cane Haul Road  
To  
Maui Humane Society  
Federal - Aid Project No. NH-0311(5)  
Scale: 1"=60' Date: JUNE 2002

SHEET No. 3 OF 11 SHEETS

12/23/02	Revised Frontage Road
DATE	REVISION

*Daniel S. Miyasato*  
SATO & ASSOCIATES, INC.  
THIS WORK WAS PREPARED BY ME OR UNDER MY SUPERVISION



FED. ROAD DIST. NO.	STATE	FEDERAL - AID PROJ. NO.	FISCAL YEAR	SHEET NO.	TOTAL SHEETS
HAWAII	HAW.	NH-0311(5)	2003	123	189

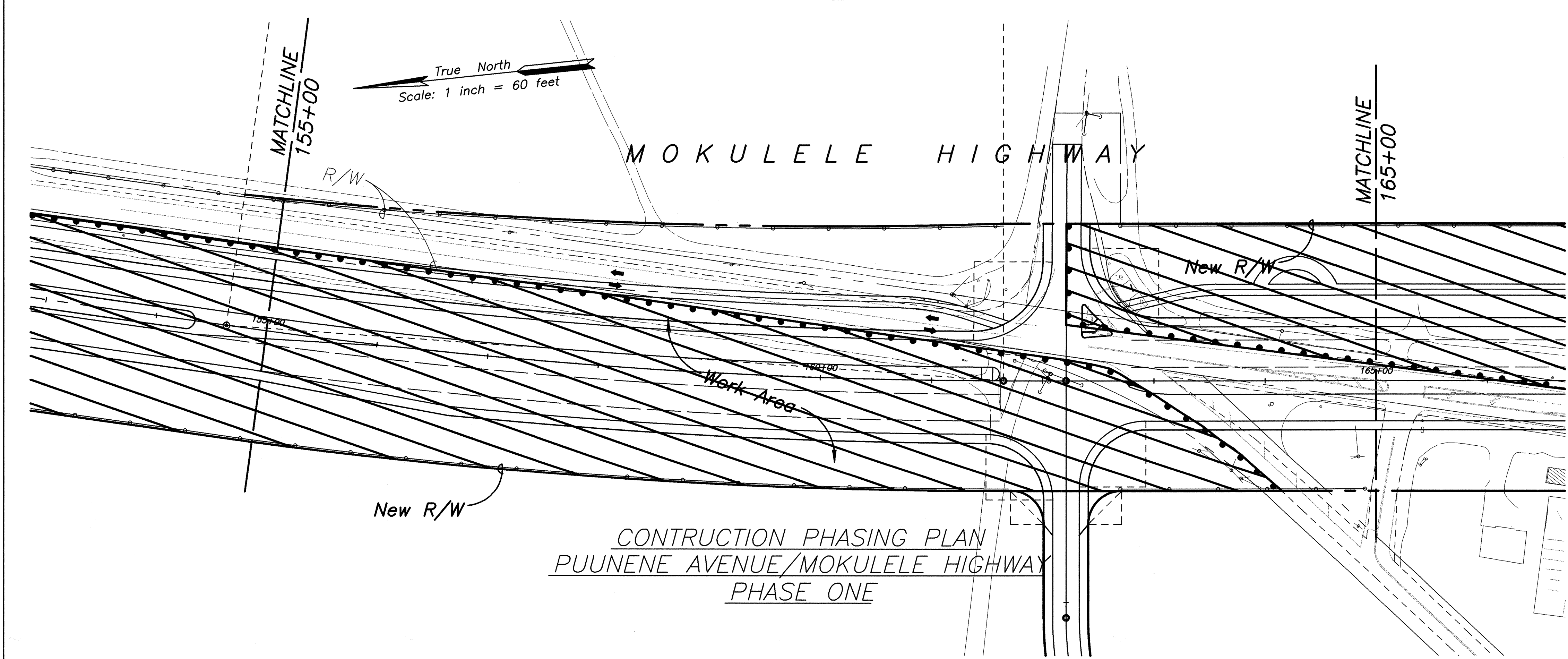
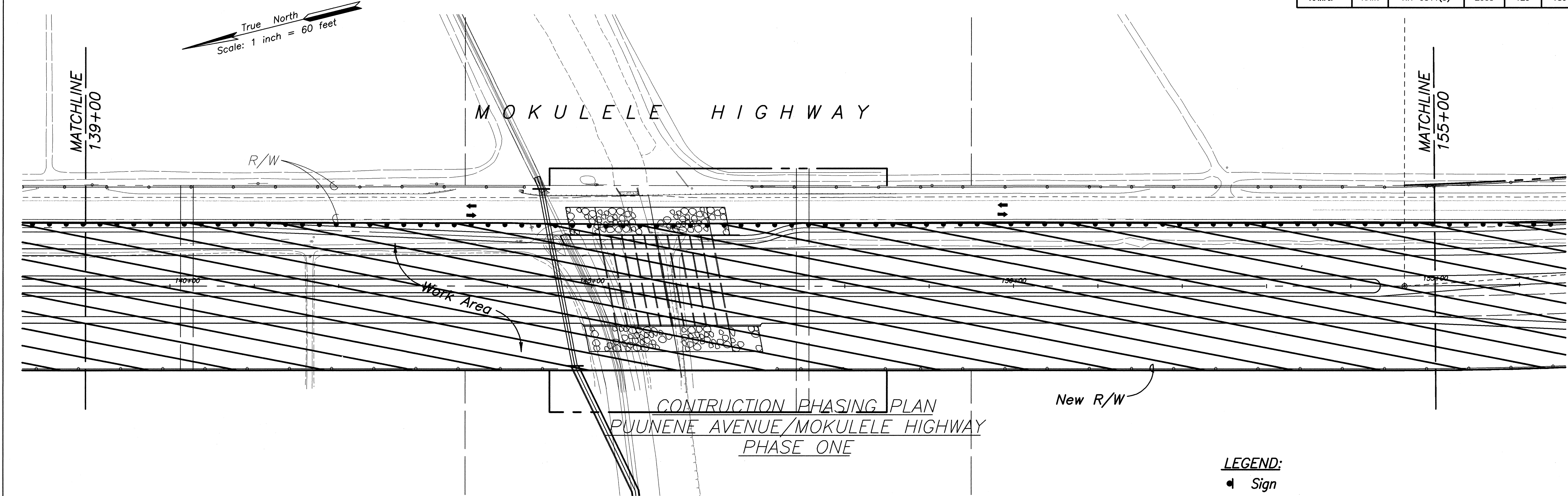

**LEGEND:**

- Sign
- Type I barricade w/flashers (10' O.C. Max. Spacing) or water filled barriers when separation between construction zone and traffic is less than 10'.
- Direction of Traffic
- Flashing Arrow Sign
- Police Officer/Flagger

**NOTE:**

- At night and/or during night work, Contractor shall use flashing barricades or barriers.
- Contractor shall provide street lighting as directed by the Engineer. This work shall be paid for under item 645.2000.
- For lane closures and work on shoulders adjacent to open lanes, see Section 645 of the Special Provisions for Traffic Control Plans.

DANIEL S. MIYASATO  
LICENSED PROFESSIONAL ENGINEER  
No. 3443-C  
HAWAII U.S.A.

STATE OF HAWAII  
DEPARTMENT OF TRANSPORTATION  
HIGHWAYS DIVISION

**CONSTRUCTION PHASING PLAN**

**MOKULELE HIGHWAY WIDENING**

Vicinity of Cane Haul Road

To  
Maui Humane Society

Federal - Aid Project No. NH-0311(5)

Scale: 1"=60' Date: JUNE 2002

SHEET No. 4 OF 11 SHEETS

ORIGINAL PLAN	SURVEY PLOTTED BY	DATE
NOTE BOOK	DRAWN BY	
	DESIGNED BY	
	CHECKED BY	
No.		



FED. ROAD DIST. NO.	STATE	FEDERAL - AID PROJ. NO.	FISCAL YEAR	SHEET NO.	TOTAL SHEETS
HAWAII	HAW.	NH-0311(5)	2003	124	189

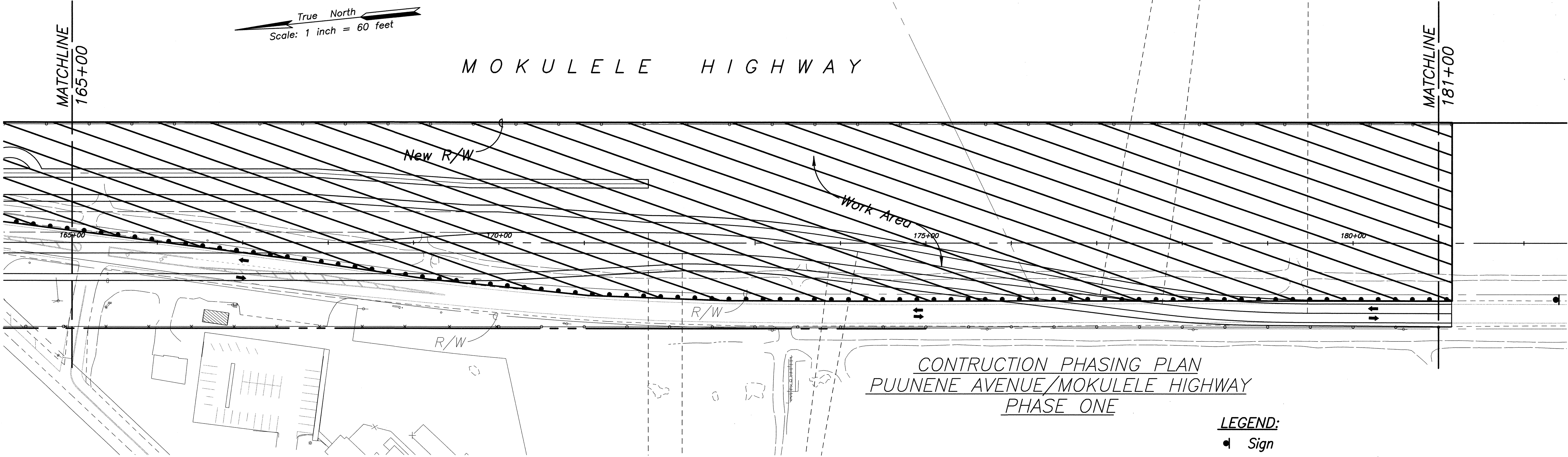

CONSTRUCTION PHASING PLAN  
PUUNENE AVENUE/MOKULELE HIGHWAY  
PHASE ONE

**LEGEND:**

- Sign
- Type I barricade w/flashers (10' O.C. Max. Spacing) or water filled barriers when separation between construction zone and traffic is less than 10'.
- Direction of Traffic
- Flashing Arrow Sign
- Police Officer/Flagger

**NOTE:**

- At night and/or during night work, Contractor shall use flashing barricades or barriers.
- Contractor shall provide street lighting as directed by the Engineer. This work shall be paid for under item 645.2000.
- For lane closures and work on shoulders adjacent to open lanes, see Section 645 of the Special Provisions for Traffic Control Plans.

ORIGINAL PLAN	SURVEY PLOTTED BY	DATE
DESIGNED BY	DRAWN BY	
QUANTITIES BY	CHECKED BY	
NO.		

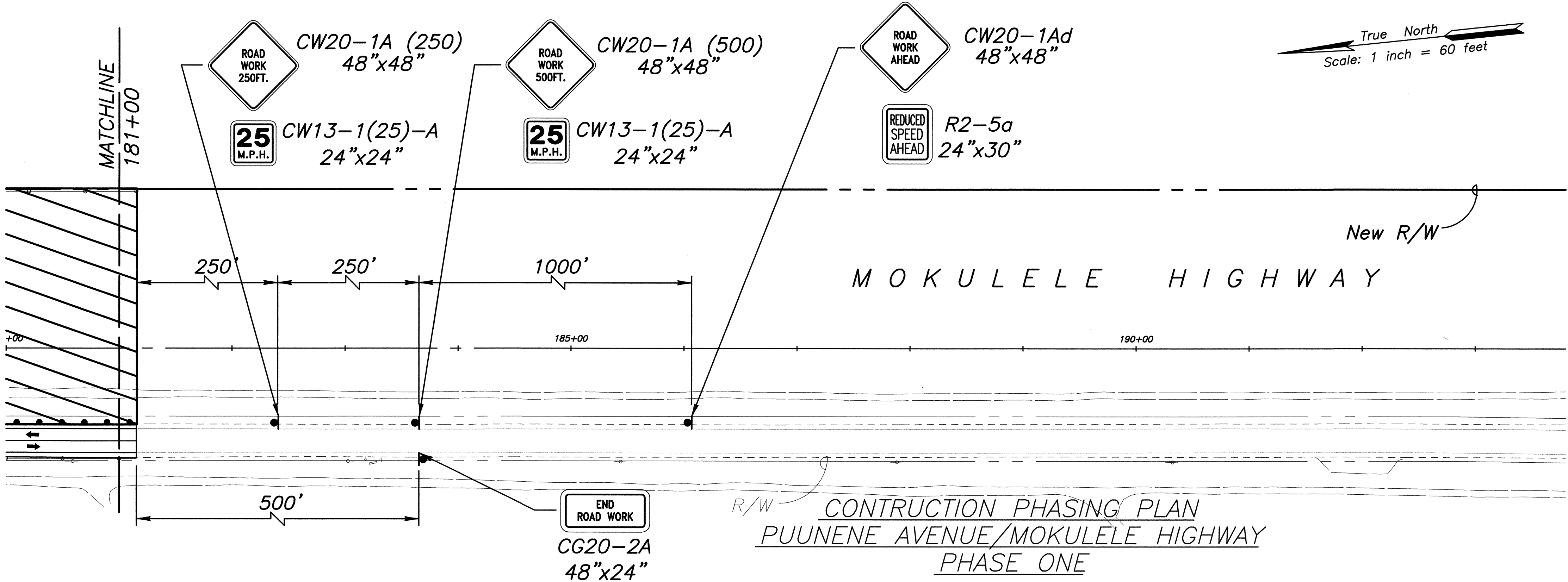

CONSTRUCTION PHASING PLAN  
PUUNENE AVENUE/MOKULELE HIGHWAY  
PHASE ONE

12/23/02	Added Signage
DATE	REVISION

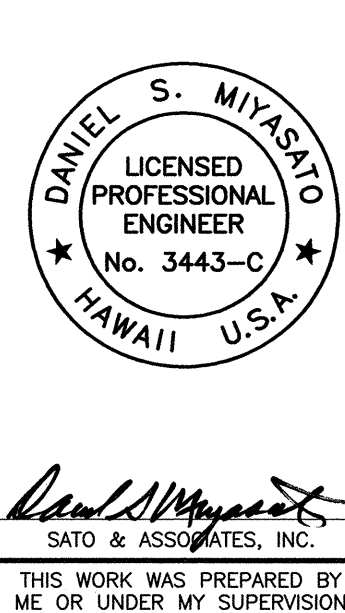

STATE OF HAWAII DEPARTMENT OF TRANSPORTATION HIGHWAYS DIVISION
<b>CONSTRUCTION PHASING PLAN</b>
MOKULELE HIGHWAY WIDENING
Vicinity of Cane Haul Road
To Maui Humane Society
Federal - Aid Project No. NH-0311(5)
Scale: 1"=60' Date: JUNE 2002
SHEET NO. 5 OF 11 SHEETS

FED. ROAD DIST. NO.	STATE	FEDERAL - AID PROJ. NO.	FISCAL YEAR	SHEET NO.	TOTAL SHEETS
HAWAII	HAW.	NH-0311(5)	2003	125	189

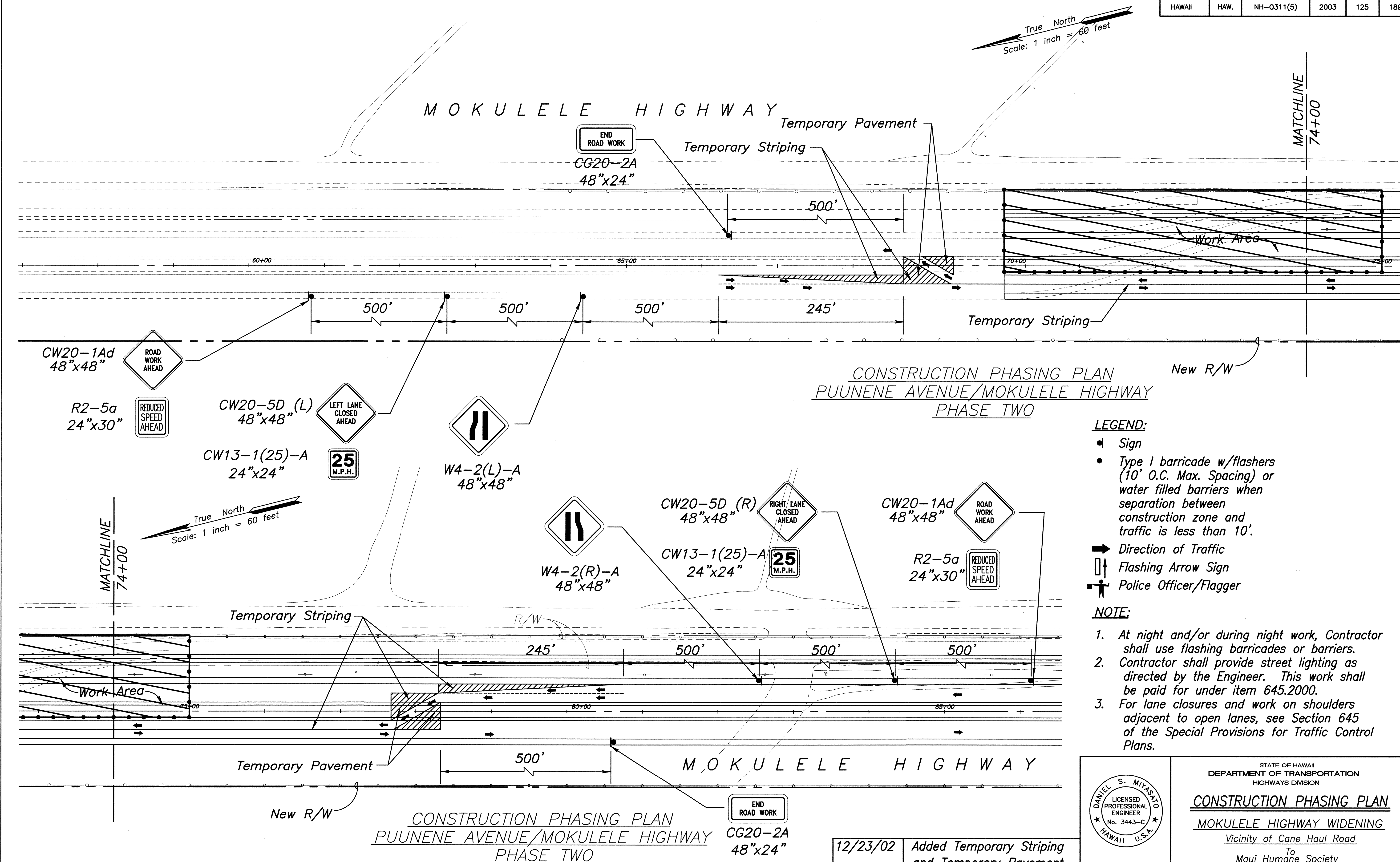

**LEGEND:**

- Sign
- Type I barricade w/flashers (10' O.C. Max. Spacing) or water filled barriers when separation between construction zone and traffic is less than 10'.
- Direction of Traffic
- Flashing Arrow Sign
- Police Officer/Flagger

**NOTE:**

- At night and/or during night work, Contractor shall use flashing barricades or barriers.
- Contractor shall provide street lighting as directed by the Engineer. This work shall be paid for under item 645.2000.
- For lane closures and work on shoulders adjacent to open lanes, see Section 645 of the Special Provisions for Traffic Control Plans.

ORIGINAL PLAN	DATE
SURVEY PLOTTED BY	
DRAWN BY	
CHECKED BY	
NOTED BY	
QUANTITIES BY	
CHECKED BY	
No.	

12/23/02	Added Temporary Striping and Temporary Pavement with Signage
DATE	REVISION

STATE OF HAWAII  
DEPARTMENT OF TRANSPORTATION  
HIGHWAYS DIVISION

**CONSTRUCTION PHASING PLAN**  
**MOKULELE HIGHWAY WIDENING**  
Vicinity of Cane Haul Road  
To  
Maui Humane Society  
Federal - Aid Project No. NH-0311(5)  
Scale: 1"=60' Date: JUNE 2002

SHEET NO. 6 OF 11 SHEETS



FED. ROAD DIST. NO.	STATE	FEDERAL - AID PROJ. NO.	FISCAL YEAR	SHEET NO.	TOTAL SHEETS
HAWAII	HAW.	NH-0311(5)	2003	126	189

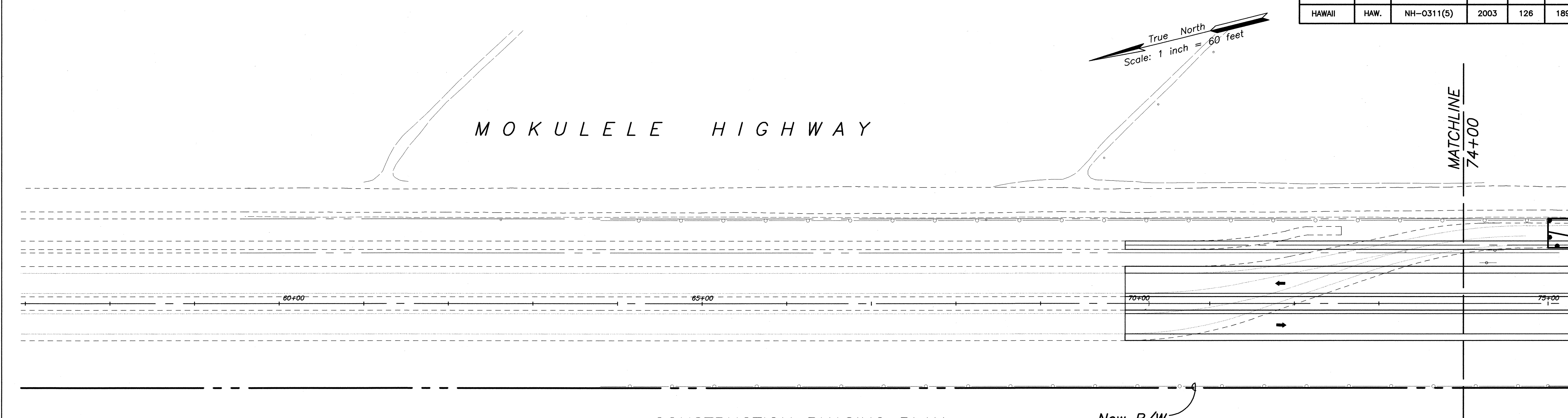

CONSTRUCTION PHASING PLAN  
PUUNENE AVENUE/MOKULELE HIGHWAY  
PHASE THREE

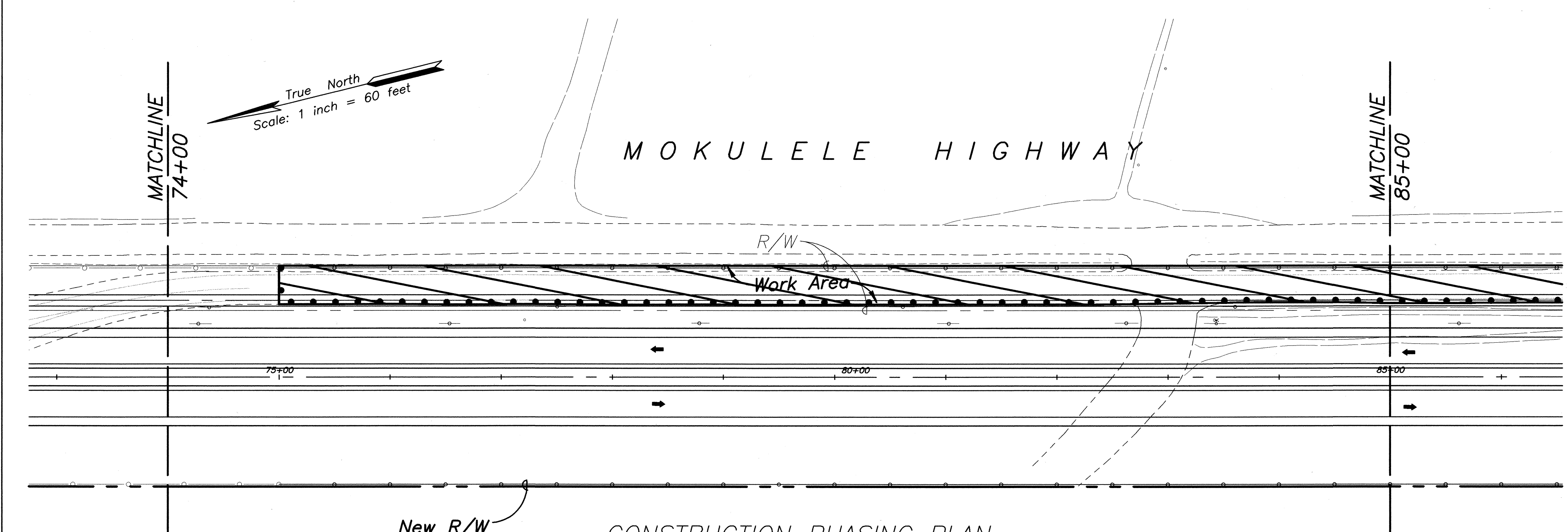

CONSTRUCTION PHASING PLAN  
PUUNENE AVENUE/MOKULELE HIGHWAY  
PHASE THREE

**LEGEND:**

- ◆ Sign
- Type I barricade w/flashers (10' O.C. Max. Spacing) or water filled barriers when separation between construction zone and traffic is less than 10'.
- ➔ Direction of Traffic
- ⬆ Flashing Arrow Sign
- 👤 Police Officer/Flagger

**NOTE:**

1. At night and/or during night work, Contractor shall use flashing barricades or barriers.
2. Contractor shall provide street lighting as directed by the Engineer. This work shall be paid for under item 645.2000.
3. For lane closures and work on shoulders adjacent to open lanes, see Section 645 of the Special Provisions for Traffic Control Plans.

	STATE OF HAWAII DEPARTMENT OF TRANSPORTATION HIGHWAYS DIVISION
	<b>CONSTRUCTION PHASING PLAN</b>
	<b>MOKULELE HIGHWAY WIDENING</b>
	Vicinity of Cane Haul Road To Maui Humane Society Federal - Aid Project No. NH-0311(5)
	Scale: 1"=60' Date: JUNE 2002
THIS WORK WAS PREPARED BY ME OR UNDER MY SUPERVISION	SHEET No. 7 OF 11 SHEETS

ORIGINAL PLAN	SURVEY PLOTTED BY	DATE
NOTE BOOK	DRAWN BY	
	REVIEWED BY	
	QUANTITIES BY	
	CHECKED BY	

FED. ROAD DIST. NO.	STATE	FEDERAL - AID PROJ. NO.	FISCAL YEAR	SHEET NO.	TOTAL SHEETS
HAWAII	HAW.	NH-0311(5)	2003	127	189

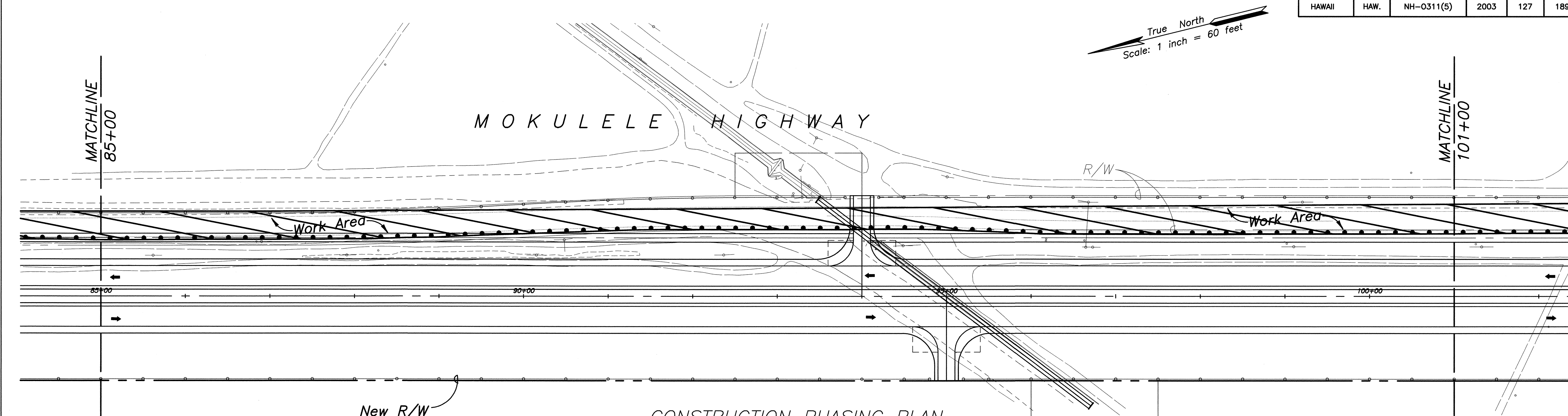

CONSTRUCTION PHASING PLAN  
PUUNENE AVENUE/MOKULELE HIGHWAY  
PHASE THREE

**LEGEND:**

- Sign
- Type I barricade w/flashers (10' O.C. Max. Spacing) or water filled barriers when separation between construction zone and traffic is less than 10'.
- ➡ Direction of Traffic
- ⬆ Flashing Arrow Sign
- 👮 Police Officer/Flagger

**NOTE:**

1. At night and/or during night work, Contractor shall use flashing barricades or barriers.
2. Contractor shall provide street lighting as directed by the Engineer. This work shall be paid for under item 645.2000.
3. For lane closures and work on shoulders adjacent to open lanes, see Section 645 of the Special Provisions for Traffic Control Plans.

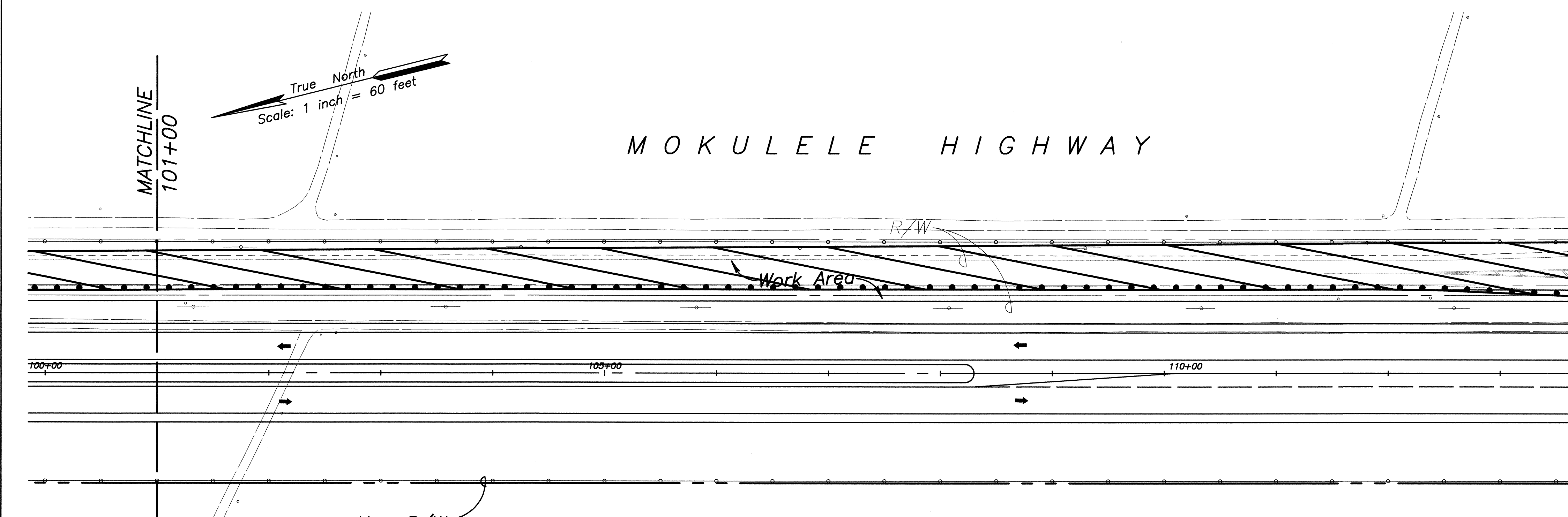

CONSTRUCTION PHASING PLAN  
PUUNENE AVENUE/MOKULELE HIGHWAY  
PHASE THREE

12/23/02	Revised Irrigation Ditch, Added Access Road at Baseline Station 94+00 and 95+00
DATE	REVISION

**DANIEL S. MIYASATO**  
LICENSED PROFESSIONAL ENGINEER  
No. 3443-C  
HAWAII U.S.A.

STATE OF HAWAII  
DEPARTMENT OF TRANSPORTATION  
HIGHWAYS DIVISION

**CONSTRUCTION PHASING PLAN**

MOKULELE HIGHWAY WIDENING  
Vicinity of Cane Haul Road  
To  
Maui Humane Society  
Federal - Aid Project No. NH-0311(5)  
Scale: 1"=60' Date: JUNE 2002

SHEET No. 8 OF 11 SHEETS

ORIGINAL PLAN	SURVEY PLOTTED BY	DATE
NOTE BOOK	DRAWN BY	
	DESIGNED BY	
	QUANTITIES BY	
	CHECKED BY	
No.		



FED. ROAD DIST. NO.	STATE	FEDERAL - AID PROJ. NO.	FISCAL YEAR	SHEET NO.	TOTAL SHEETS
HAWAII	HAW.	NH-0311(5)	2003	128	189

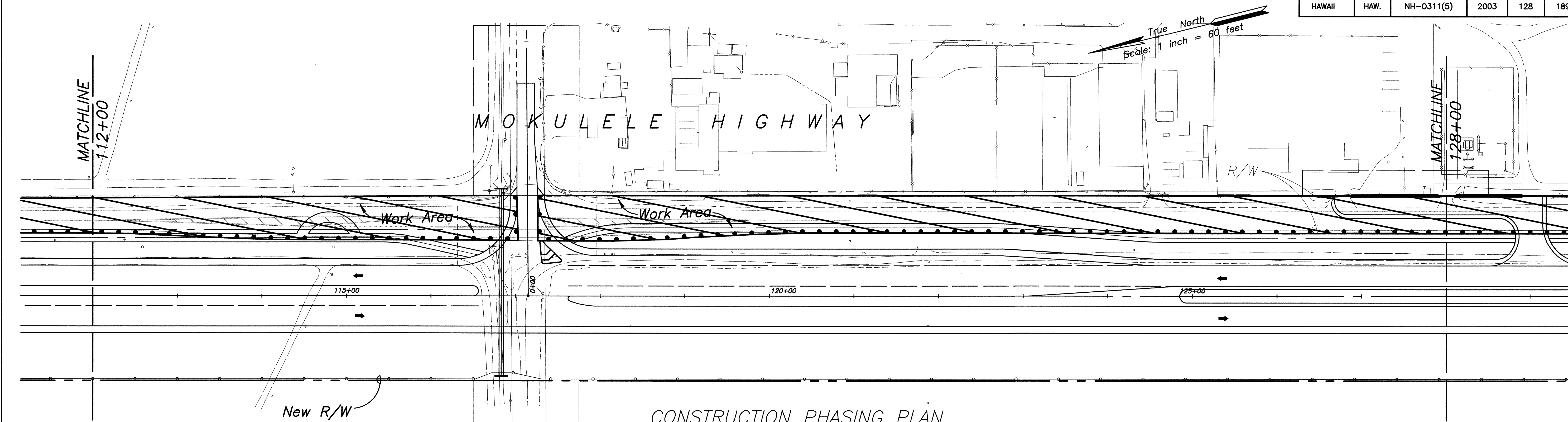

CONSTRUCTION PHASING PLAN  
PUUNENE AVENUE/MOKULELE HIGHWAY  
PHASE THREE

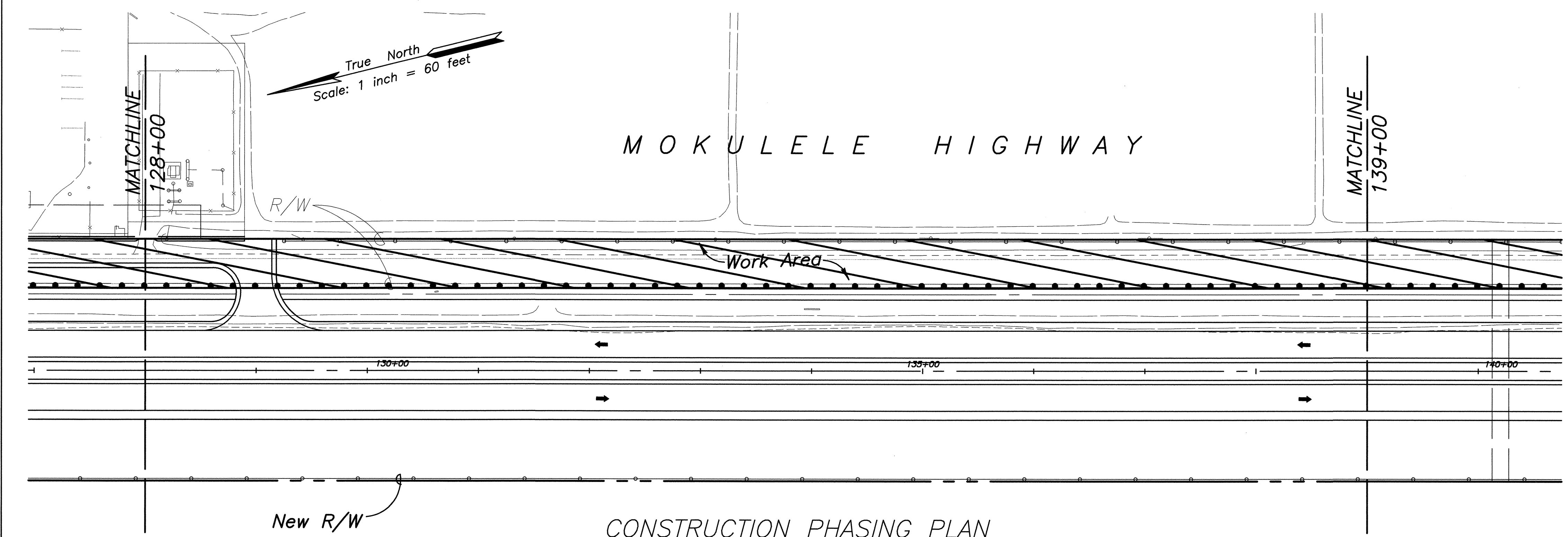

CONSTRUCTION PHASING PLAN  
PUUNENE AVENUE/MOKULELE HIGHWAY  
PHASE THREE

LEGEND:

- Sign
- Type I barricade w/flashers (10' O.C. Max. Spacing) or water filled barriers when separation between construction zone and traffic is less than 10'.
- Direction of Traffic
- Flashing Arrow Sign
- Police Officer/Flagger

NOTE:

- At night and/or during night work, Contractor shall use flashing barricades or barriers.
- Contractor shall provide street lighting as directed by the Engineer. This work shall be paid for under item 645.2000.
- For lane closures and work on shoulders adjacent to open lanes, see Section 645 of the Special Provisions for Traffic Control Plans.

DANIEL S. MIYASATO  
LICENSED PROFESSIONAL ENGINEER  
No. 3443-C  
HAWAII U.S.A.

STATE OF HAWAII  
DEPARTMENT OF TRANSPORTATION  
HIGHWAYS DIVISION

**CONSTRUCTION PHASING PLAN**  
**MOKULELE HIGHWAY WIDENING**  
Vicinity of Cane Haul Road  
To  
Maui Humane Society  
Federal - Aid Project No. NH-0311(5)  
Scale: 1"=60' Date: JUNE 2002

SHEET No. 9 OF 11 SHEETS

12/23/02	Revised Frontage Road
DATE	REVISION

SATO & ASSOCIATES, INC.  
THIS WORK WAS PREPARED BY ME OR UNDER MY SUPERVISION

SURVEY PLOTTED BY	DATE
DRAWN BY	
TRACED BY	
QUANTITIES BY	
CHECKED BY	
No.	



FED. ROAD DIST. NO.	STATE	FEDERAL - AID PROJ. NO.	FISCAL YEAR	SHEET NO.	TOTAL SHEETS
HAWAII	HAW.	NH-0311(5)	2003	129	189

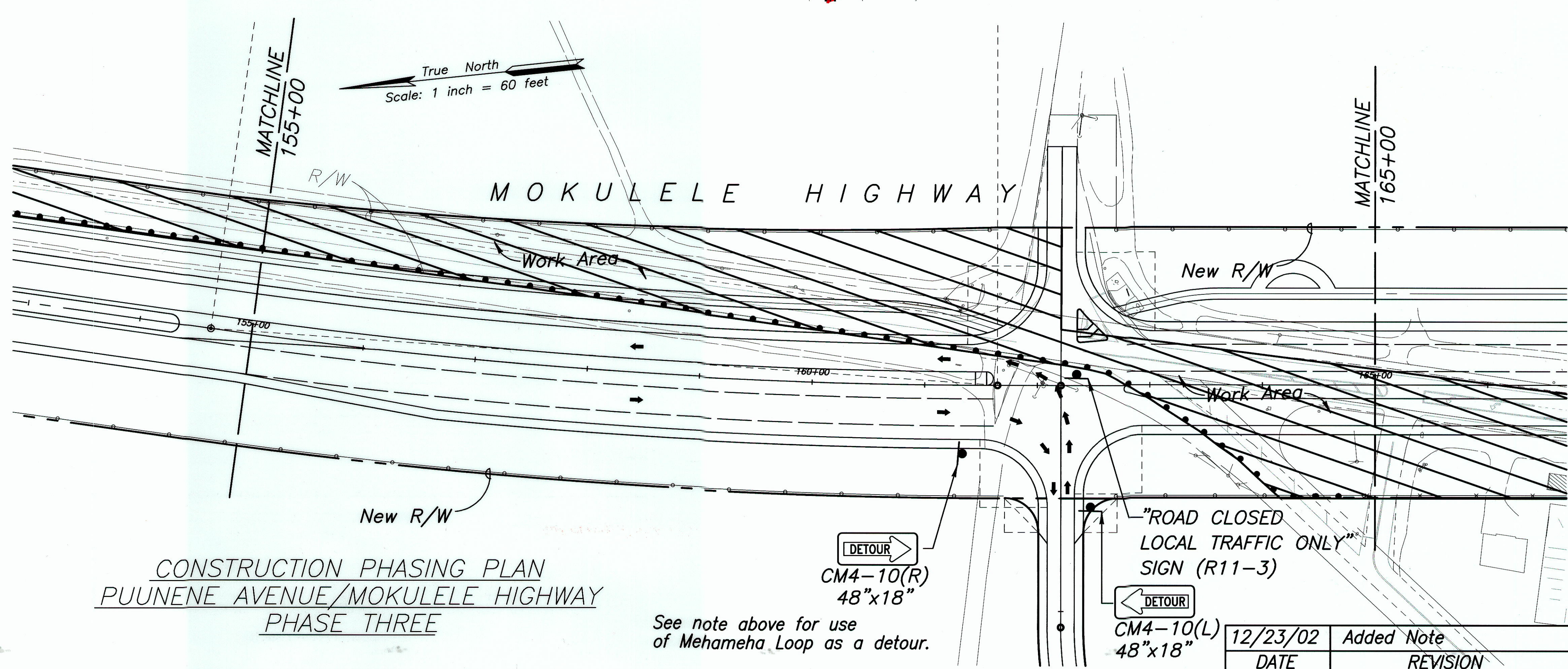
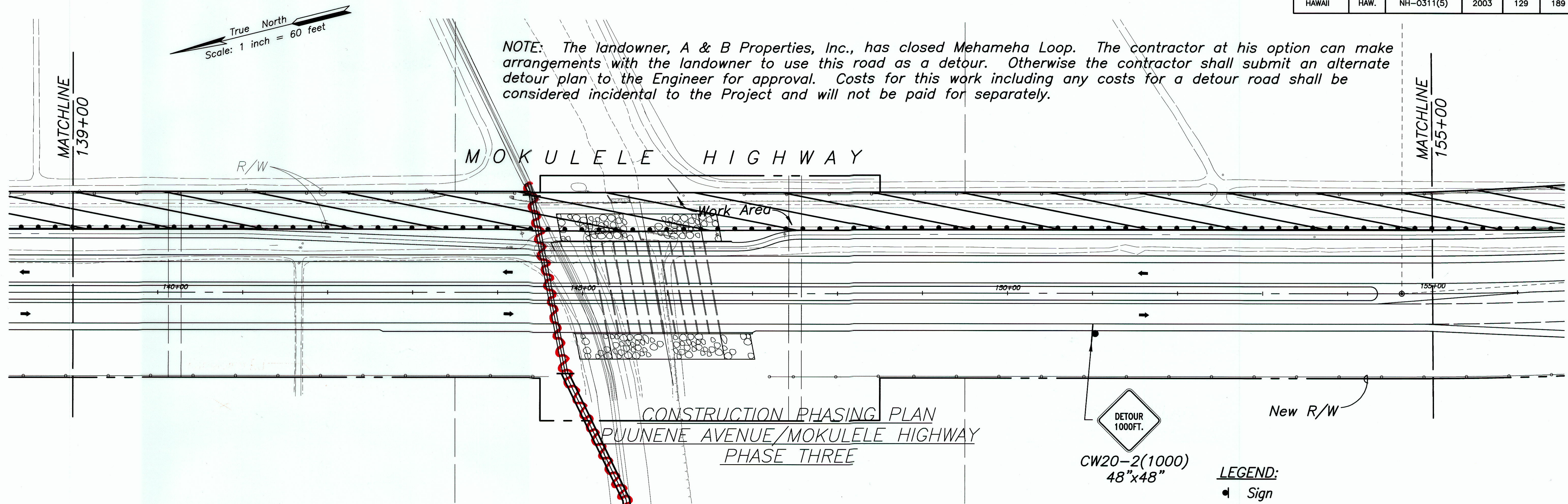

**LEGEND:**

- Sign
- Type I barricade w/flashers (10' O.C. Max. Spacing) or water filled barriers when separation between construction zone and traffic is less than 10'.
- Direction of Traffic
- Flashing Arrow Sign
- Police Officer/Flagger

**NOTE:**

- At night and/or during night work, Contractor shall use flashing barricades or barriers.
- Contractor shall provide street lighting as directed by the Engineer. This work shall be paid for under item 645.2000.
- For lane closures and work on shoulders adjacent to open lanes, see Section 645 of the Special Provisions for Traffic Control Plans.

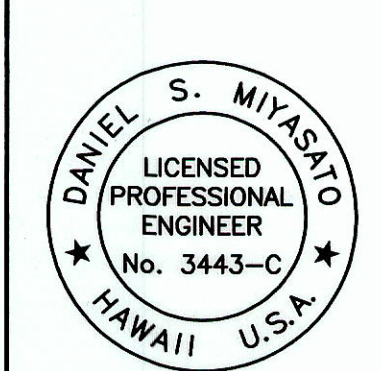

STATE OF HAWAII  
DEPARTMENT OF TRANSPORTATION  
HIGHWAYS DIVISION

**CONSTRUCTION PHASING PLAN**  
MOKULELE HIGHWAY WIDENING  
Vicinity of Cane Haul Road

To  
Maui Humane Society  
Federal - Aid Project No. NH-0311(5)  
Scale: 1"=60' Date: JUNE 2002

SHEET No. 10 OF 11 SHEETS

12/23/02	Added Note
DATE	REVISION

**"AS-BUILT"**

**ADD. 129**

ORIGINAL PLAN	DATE
DESIGNED BY	
TRACED BY	
QUANTITIES BY	
CHECKED BY	
No.	

PROJ. NO.: MB901.00  
2/28/02  
R:\moku\_ph3\p3\PHASE3.dwg



FED. ROAD DIST. NO.	STATE	FEDERAL - AID PROJ. NO.	FISCAL YEAR	SHEET NO.	TOTAL SHEETS
HAWAII	HAW.	NH-0311(5)	2003	130	189

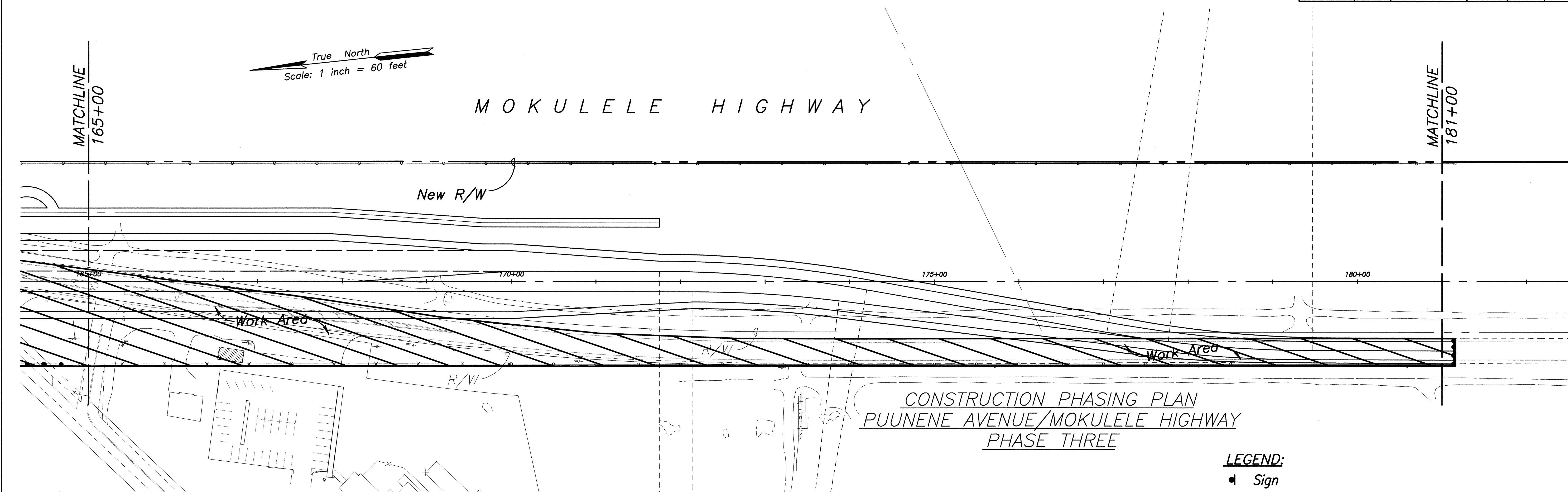

**LEGEND:**

- Sign
- Type I barricade w/flashers (10' O.C. Max. Spacing) or water filled barriers when separation between construction zone and traffic is less than 10'.
- Direction of Traffic
- Flashing Arrow Sign
- Police Officer/Flagger

**NOTE:**

- At night and/or during night work, Contractor shall use flashing barricades or barriers.
- Contractor shall provide street lighting as directed by the Engineer. This work shall be paid for under item 645.2000.
- For lane closures and work on shoulders adjacent to open lanes, see Section 645 of the Special Provisions for Traffic Control Plans.

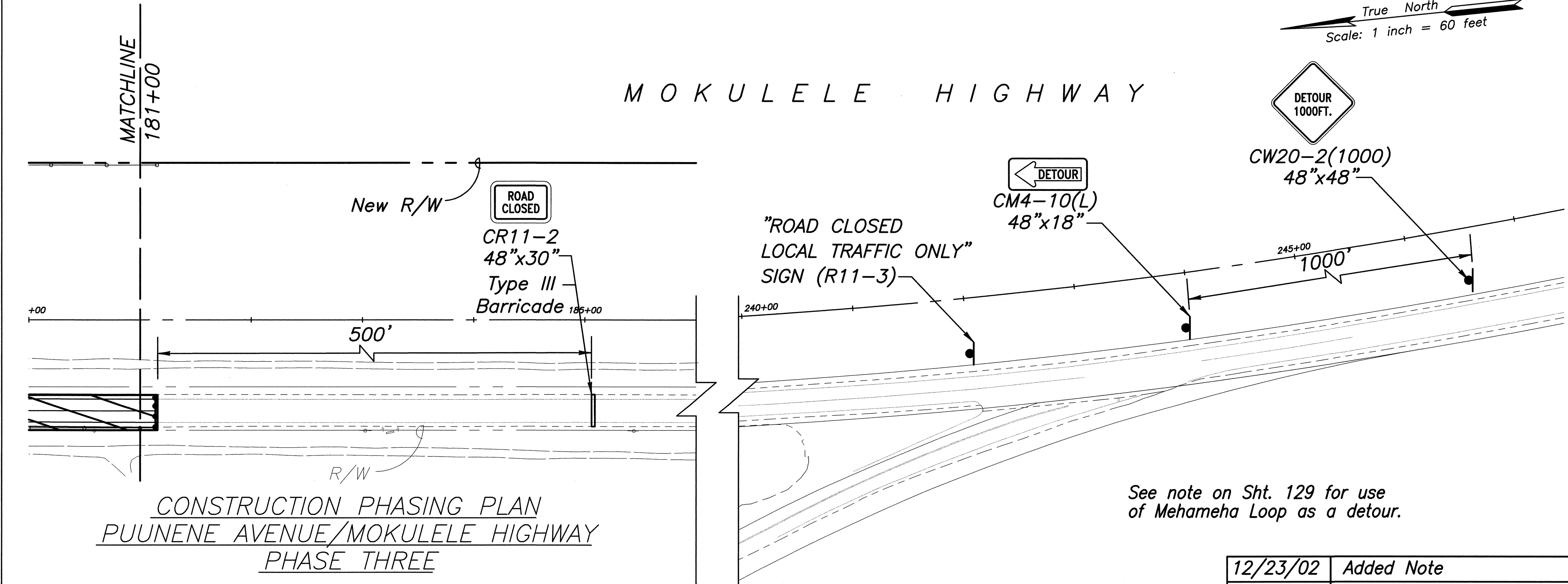

ORIGINAL PLAN	SURVEY PLOTTED BY	DATE
TRACED BY		
NOTES BY		
CHECKED BY		
No.		

See note on Sht. 129 for use of Mehamaha Loop as a detour.

12/23/02	Added Note
DATE	REVISION

DANIEL S. MIYASATO  
LICENSED PROFESSIONAL ENGINEER  
No. 3443-C  
HAWAII U.S.A.

STATE OF HAWAII  
DEPARTMENT OF TRANSPORTATION  
HIGHWAYS DIVISION

**CONSTRUCTION PHASING PLAN**  
**MOKULELE HIGHWAY WIDENING**  
Vicinity of Cane Haul Road  
To  
Maui Humane Society  
Federal - Aid Project No. NH-0311(5)  
Scale: 1"=60' Date: JUNE 2002

SHEET No. 11 OF 11 SHEETS