

FED. ROAD DIST. NO.	STATE	PROJ. NO.	FISCAL YEAR	SHEET NO.	TOTAL SHEETS
HAWAII	HAW.	310A-01-13M	2013	22	30

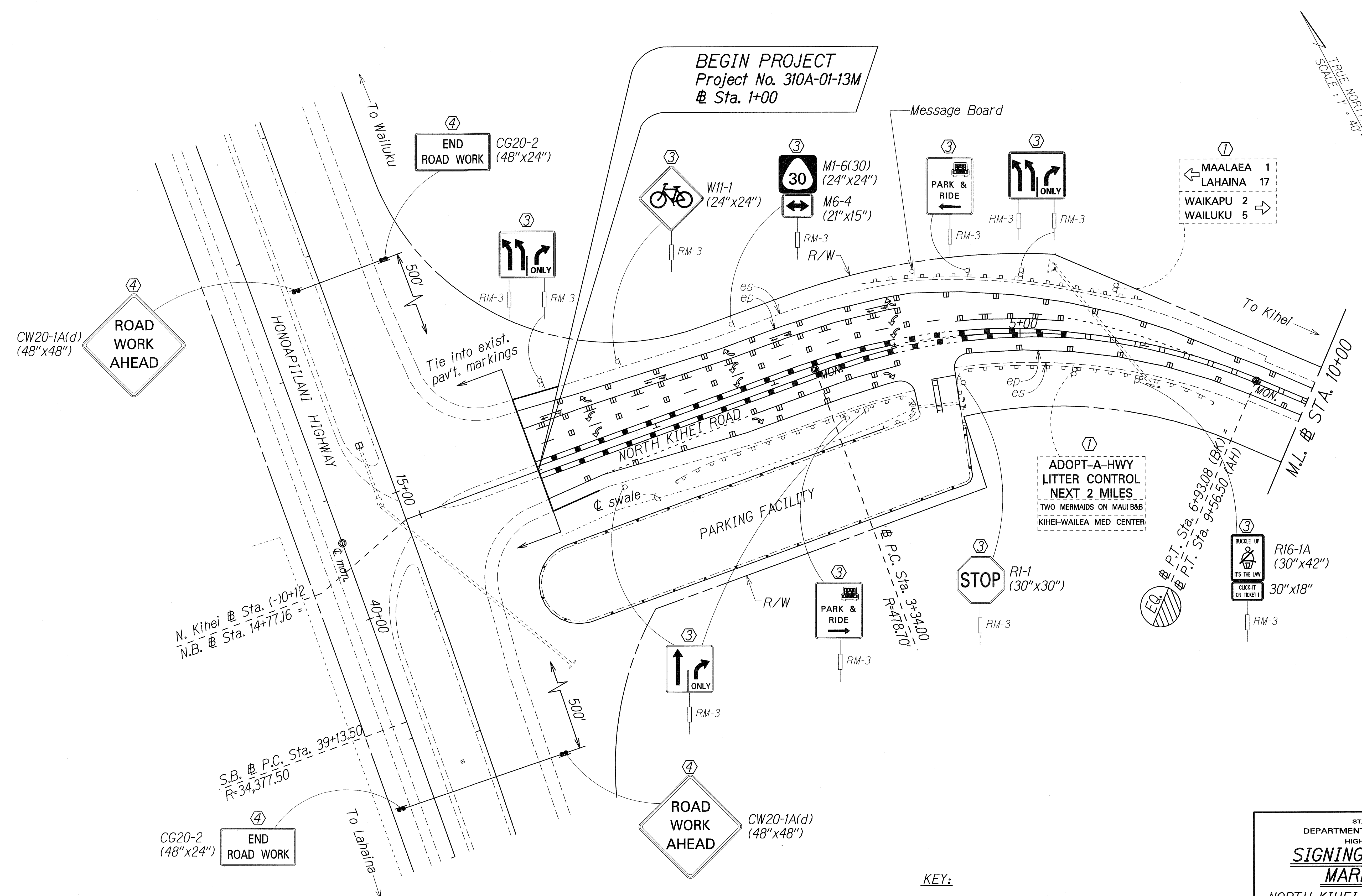

SURVEY PLOTTED BY \_\_\_\_\_ DATE \_\_\_\_\_  
 DRAWN BY \_\_\_\_\_  
 CHECKED BY \_\_\_\_\_  
 QUANTITIES BY \_\_\_\_\_  
 ORIGINAL PLAN \_\_\_\_\_  
 NOTE BOOK \_\_\_\_\_  
 CHECKED BY \_\_\_\_\_  
 N. \_\_\_\_\_

- KEY:**
- ① Exist. Sign(s) & Post(s) to Remain
  - ② Remove Exist. Sign(s) & Post(s)
  - ③ Remove Exist. & Install New Sign(s) & Post(s)
  - ④ Install New Sign(s) & Post(s)

STATE OF HAWAII  
 DEPARTMENT OF TRANSPORTATION  
 HIGHWAYS DIVISION  
**SIGNING & PAVEMENT MARKING PLAN**  
 NORTH KIHAI ROAD RESURFACING  
 Honopitilani Highway to Piilani Highway  
 Project No. 310A-01-13M  
 Scale: 1" = 40' Date: October, 2012  
 SHEET No. 1 OF 9 SHEETS

FED. ROAD DIST. NO.	STATE	PROJ. NO.	FISCAL YEAR	SHEET NO.	TOTAL SHEETS
HAWAII	HAW.	310A-01-13M	2013	23	30

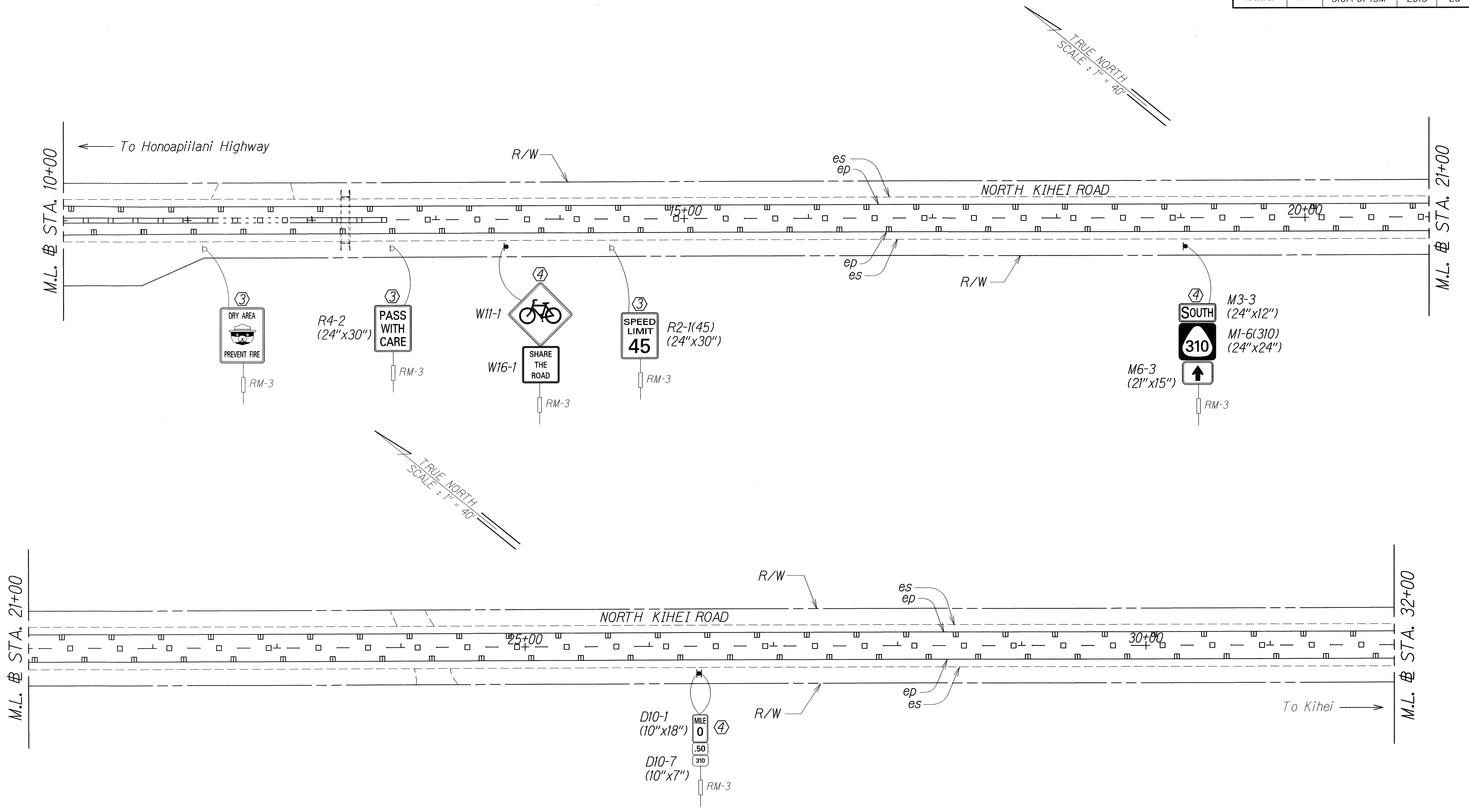

SURVEY PLOTTED BY	DATE
DRAWN BY	10/11/12
DESIGNED BY	
QUANTITIES BY	
CHECKED BY	

- KEY:**
- ① Exist. Sign(s) & Post(s) to Remain
  - ② Remove Exist. Sign(s) & Post(s)
  - ③ Remove Exist. & Install New Sign(s) & Post(s)
  - ④ Install New Sign(s) & Post(s)

STATE OF HAWAII  
DEPARTMENT OF TRANSPORTATION  
HIGHWAYS DIVISION

**SIGNING & PAVEMENT  
MARKING PLAN**

NORTH KIHEI ROAD RESURFACING  
Honoapiilani Highway to Piilani Highway  
Project No. 310A-01-13M

Scale: 1" = 40'      Date: October, 2012

SHEET No. 2 OF 9 SHEETS

FED. ROAD DIST. NO.	STATE	PROJ. NO.	FISCAL YEAR	SHEET NO.	TOTAL SHEETS
HAWAII	HAW.	310A-01-13M	2013	24	30

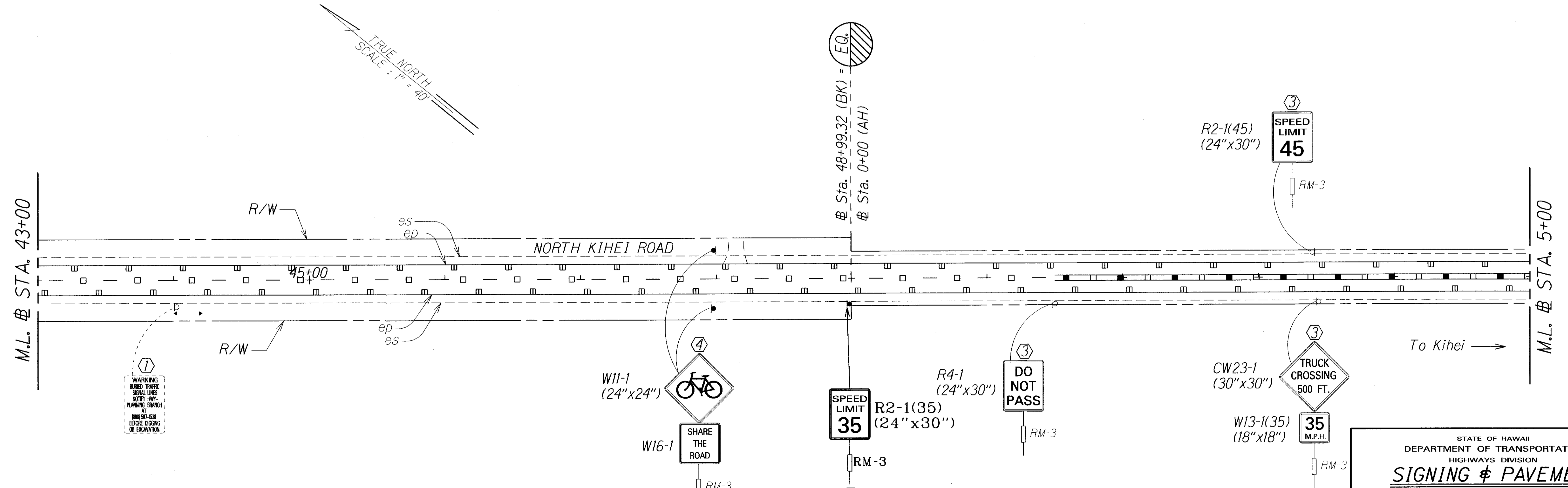
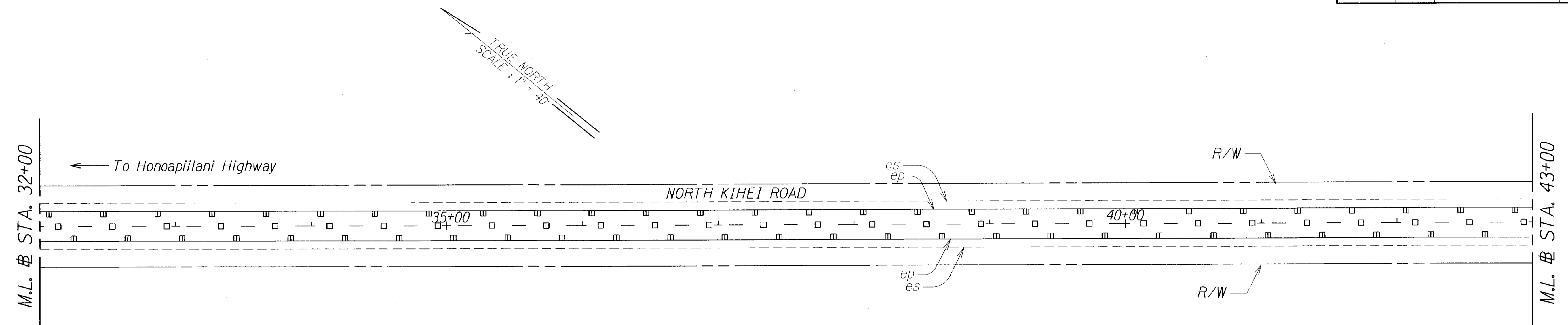

SURVEY PLOTTED BY	DATE
DRAWN BY	
DESIGNED BY	
QUANTITIES BY	
CHECKED BY	

LEGEND FOR AS-BUILT POSTINGS	
	Squiggly line for as-built deletion
	Double line for as-built deletion
Roadway	Text for as-built posting

- KEY:
- ① Exist. Sign(s) & Post(s) to Remain
  - ② Remove Exist. Sign(s) & Post(s)
  - ③ Remove Exist. & Install New Sign(s) & Post(s)
  - ④ Install New Sign(s) & Post(s)

STATE OF HAWAII  
DEPARTMENT OF TRANSPORTATION  
HIGHWAYS DIVISION

**SIGNING & PAVEMENT  
MARKING PLAN**

NORTH KIHEI ROAD RESURFACING  
Honoapiilani Highway to Piilani Highway  
Project No. 310A-01-13M

Scale: 1" = 40'      Date: October, 2012

SHEET No. 3 OF 9 SHEETS

FED. ROAD DIST. NO.	STATE	PROJ. NO.	FISCAL YEAR	SHEET NO.	TOTAL SHEETS
HAWAII	HAW.	310A-01-13M	2013	25	30

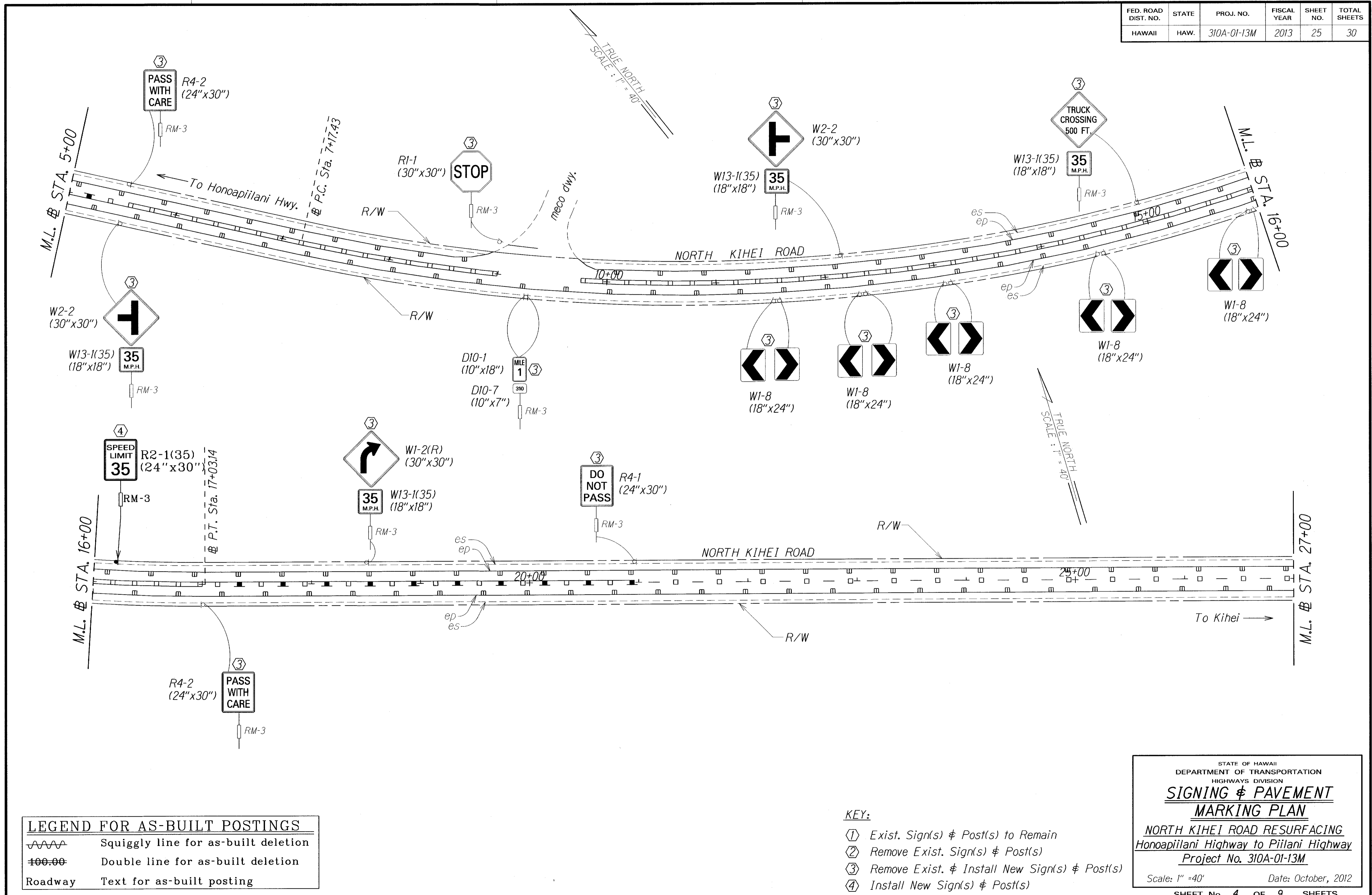

DATE	_____
SURVEY PLOTTED BY	_____
DRAWN BY	_____
TRACED BY	_____
DESIGNED BY	_____
CHECKED BY	_____

	Squiggly line for as-built deletion
	Double line for as-built deletion
Roadway	Text for as-built posting

- KEY:
- ① Exist. Sign(s) & Post(s) to Remain
  - ② Remove Exist. Sign(s) & Post(s)
  - ③ Remove Exist. & Install New Sign(s) & Post(s)
  - ④ Install New Sign(s) & Post(s)

STATE OF HAWAII  
DEPARTMENT OF TRANSPORTATION  
HIGHWAYS DIVISION

**SIGNING & PAVEMENT  
MARKING PLAN**

NORTH KIHEI ROAD RESURFACING  
Honoapiilani Highway to Piilani Highway  
Project No. 310A-01-13M

Scale: 1" = 40'      Date: October, 2012

SHEET No. 4 OF 9 SHEETS

FED. ROAD DIST. NO.	STATE	PROJ. NO.	FISCAL YEAR	SHEET NO.	TOTAL SHEETS
HAWAII	HAW.	310A-01-13M	2013	26	30

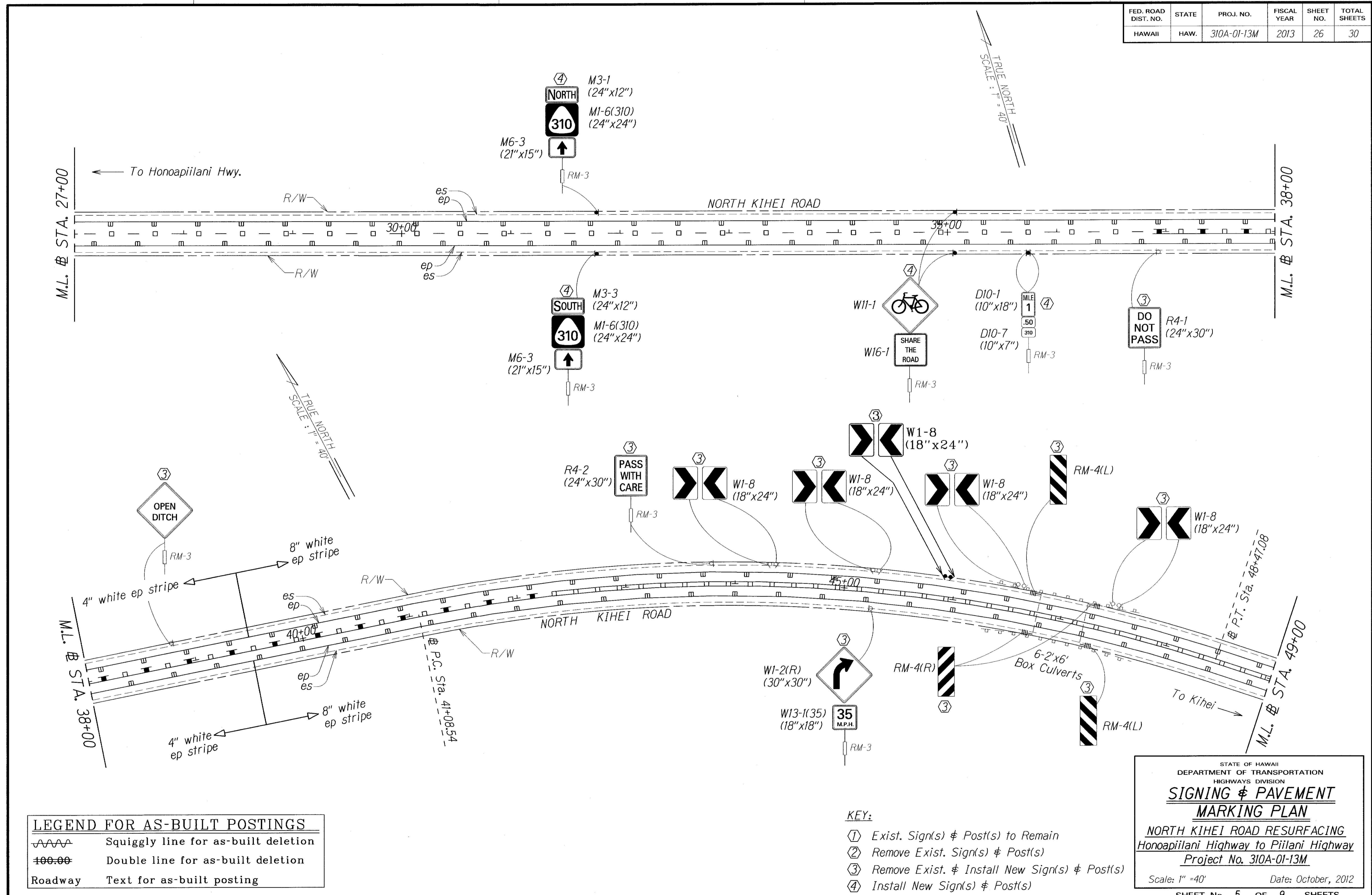

DATE	10/1/13
SURVEY PLOTTED BY	
DRAWN BY	
DESIGNED BY	
QUANTITIES BY	
CHECKED BY	

LEGEND FOR AS-BUILT POSTINGS	
	Squiggly line for as-built deletion
	Double line for as-built deletion
Roadway	Text for as-built posting

- KEY:
- ① Exist. Sign(s) & Post(s) to Remain
  - ② Remove Exist. Sign(s) & Post(s)
  - ③ Remove Exist. & Install New Sign(s) & Post(s)
  - ④ Install New Sign(s) & Post(s)

STATE OF HAWAII  
DEPARTMENT OF TRANSPORTATION  
HIGHWAYS DIVISION

### SIGNING & PAVEMENT MARKING PLAN

NORTH KIHEI ROAD RESURFACING  
Honoapiilani Highway to Piilani Highway  
Project No. 310A-01-13M

Scale: 1" = 40'      Date: October, 2012

SHEET No. 5 OF 9 SHEETS

FED. ROAD DIST. NO.	STATE	PROJ. NO.	FISCAL YEAR	SHEET NO.	TOTAL SHEETS
HAWAII	HAW.	310A-01-13M	2013	27	30

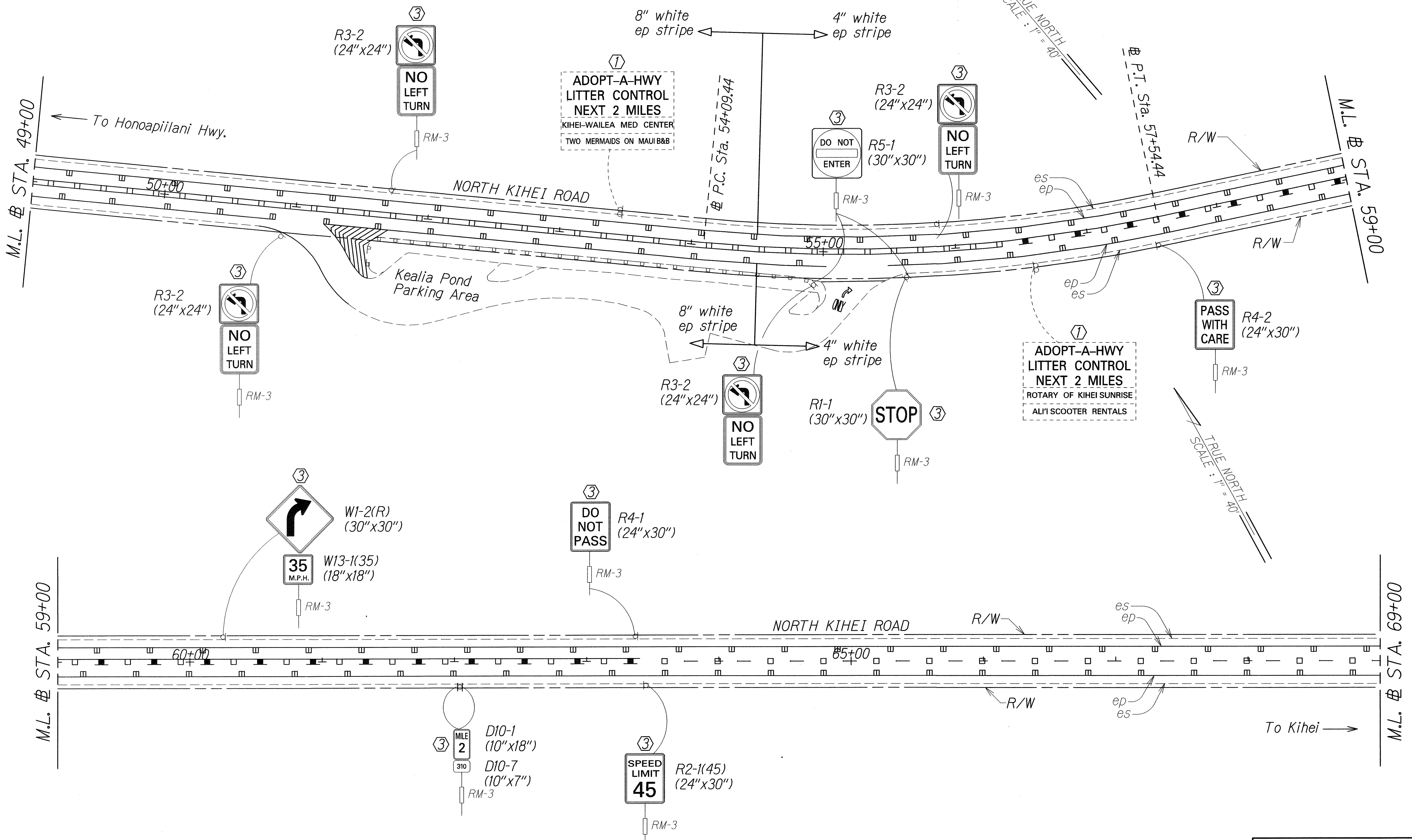

SURVEY PLOTTED BY	DATE
DRAWN BY	SCALE
TRACED BY	
NOTED BY	
QUANTITIES BY	
CHECKED BY	
ORIGINAL PLAN	
NOTE BOOK	
DATE	
CHECKED BY	

- KEY:**
- ① Exist. Sign(s) & Post(s) to Remain
  - ② Remove Exist. Sign(s) & Post(s)
  - ③ Remove Exist. & Install New Sign(s) & Post(s)
  - ④ Install New Sign(s) & Post(s)

STATE OF HAWAII  
DEPARTMENT OF TRANSPORTATION  
HIGHWAYS DIVISION

**SIGNING & PAVEMENT  
MARKING PLAN**

NORTH KIHEI ROAD RESURFACING  
Honoapiilani Highway to Piilani Highway  
Project No. 310A-01-13M

Scale: 1" = 40'      Date: October, 2012

SHEET No. 6 OF 9 SHEETS

FED. ROAD DIST. NO.	STATE	PROJ. NO.	FISCAL YEAR	SHEET NO.	TOTAL SHEETS
HAWAII	HAW.	310A-01-13M	2013	28	30

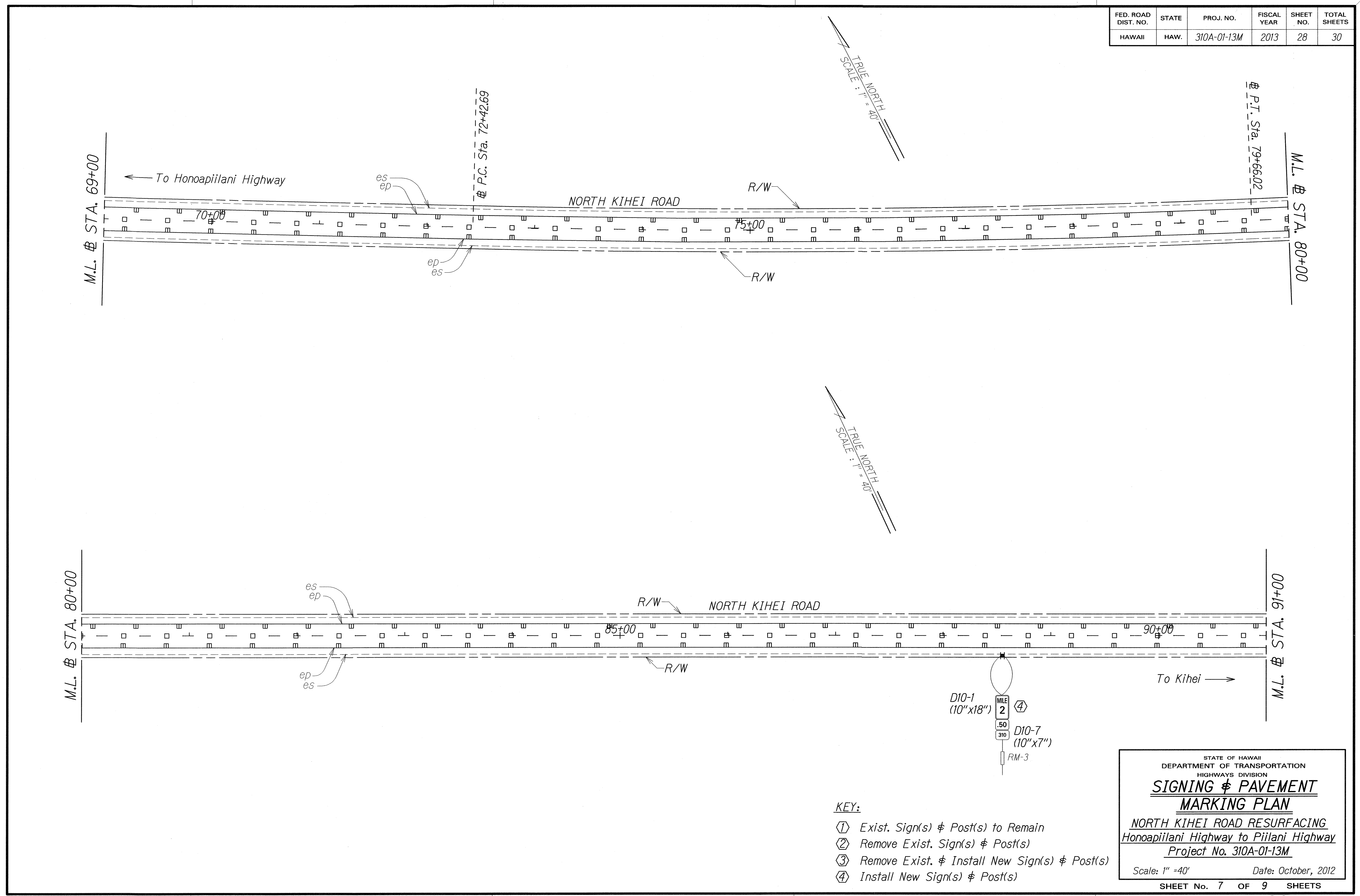

ORIGINAL PLAN	SURVEY PLOTTED BY	DATE
NOTE BOOK	DRAWN BY	10/12
DESIGNED BY	DESIGNED BY	
QUANTITIES BY	QUANTITIES BY	
CHECKED BY	CHECKED BY	

- KEY:**
- ① Exist. Sign(s) & Post(s) to Remain
  - ② Remove Exist. Sign(s) & Post(s)
  - ③ Remove Exist. & Install New Sign(s) & Post(s)
  - ④ Install New Sign(s) & Post(s)

STATE OF HAWAII  
DEPARTMENT OF TRANSPORTATION  
HIGHWAYS DIVISION

**SIGNING & PAVEMENT  
MARKING PLAN**

NORTH KIHEI ROAD RESURFACING  
Honoapiilani Highway to Piilani Highway  
Project No. 310A-01-13M

Scale: 1" = 40'      Date: October, 2012

SHEET No. 7 OF 9 SHEETS

FED. ROAD DIST. NO.	STATE	PROJ. NO.	FISCAL YEAR	SHEET NO.	TOTAL SHEETS
HAWAII	HAW.	310A-01-13M	2013	29	30

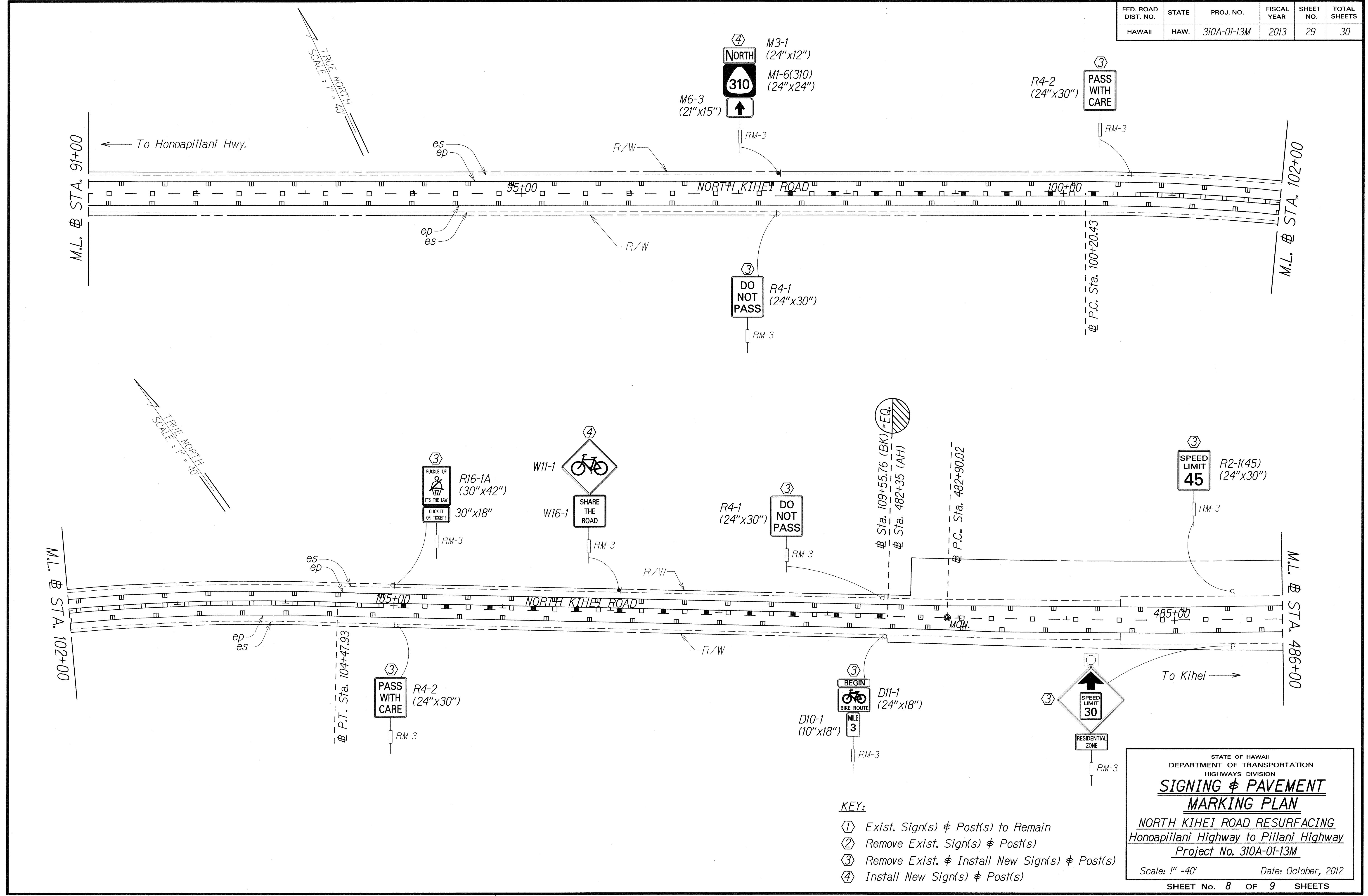



SURVEY PLOTTED BY: \_\_\_\_\_ DATE: 08/12  
 DRAWN BY: \_\_\_\_\_  
 NOTE BOOK: \_\_\_\_\_  
 DESIGNED BY: \_\_\_\_\_  
 QUANTITIES BY: \_\_\_\_\_  
 CHECKED BY: \_\_\_\_\_

- KEY:**
- ① Exist. Sign(s) & Post(s) to Remain
  - ② Remove Exist. Sign(s) & Post(s)
  - ③ Remove Exist. & Install New Sign(s) & Post(s)
  - ④ Install New Sign(s) & Post(s)

STATE OF HAWAII  
 DEPARTMENT OF TRANSPORTATION  
 HIGHWAYS DIVISION  
**SIGNING & PAVEMENT MARKING PLAN**  
 NORTH KIHEI ROAD RESURFACING  
 Honoapiilani Highway to Piilani Highway  
 Project No. 310A-01-13M  
 Scale: 1" = 40'      Date: October, 2012  
 SHEET No. 8 OF 9 SHEETS

FED. ROAD DIST. NO.	STATE	PROJ. NO.	FISCAL YEAR	SHEET NO.	TOTAL SHEETS
HAWAII	HAW.	310A-01-13M	2013	30	30

**LEGEND FOR AS-BUILT POSTINGS**

-  Squiggly line for as-built deletion
-  Double line for as-built deletion
- Roadway Text for as-built posting

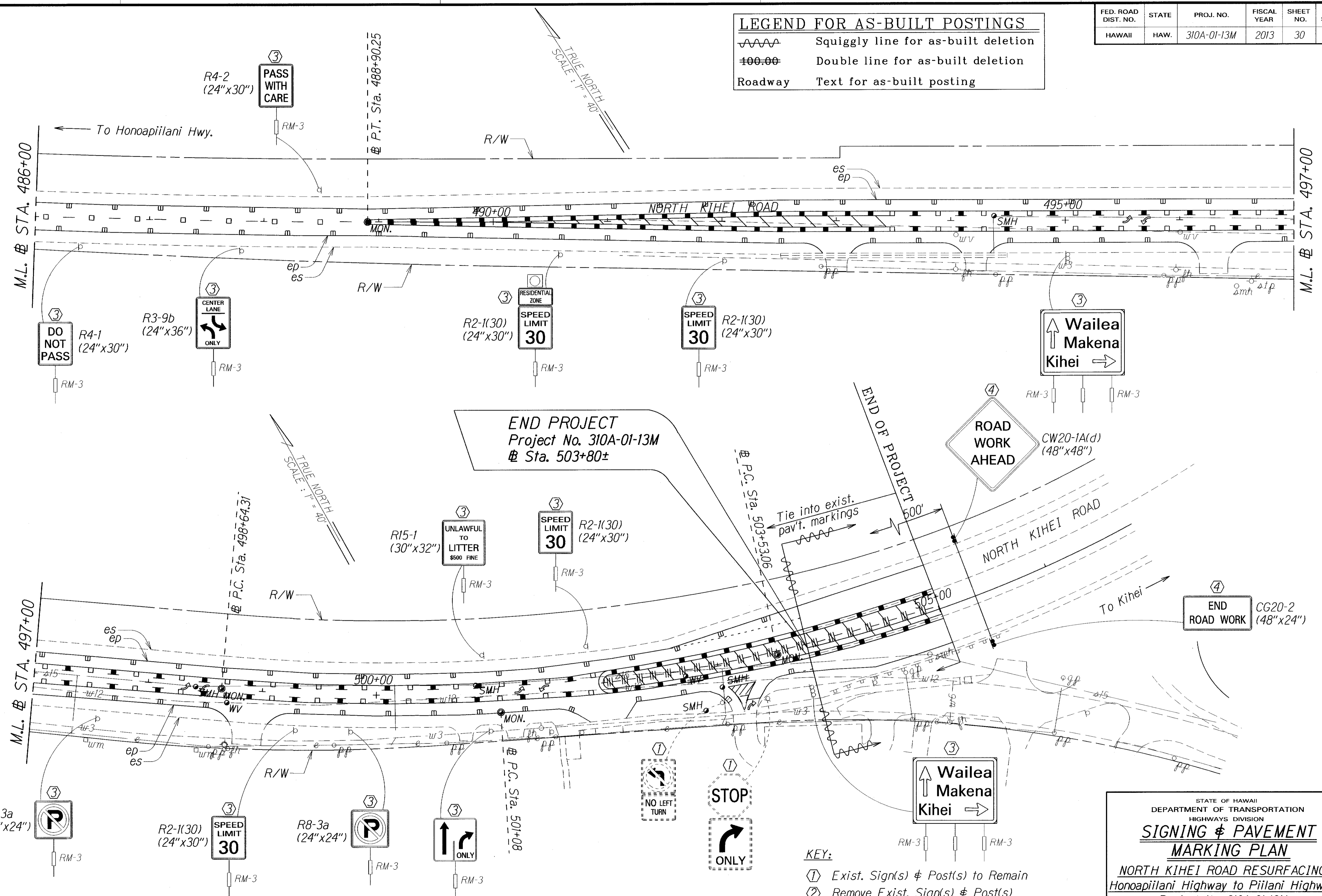

**END PROJECT**  
Project No. 310A-01-13M  
@ Sta. 503+80±

**END OF PROJECT**  
500'

**NOTE:**  
||| RM-3 w/ Fixed Base

- KEY:**
- ① Exist. Sign(s) & Post(s) to Remain
  - ② Remove Exist. Sign(s) & Post(s)
  - ③ Remove Exist. & Install New Sign(s) & Post(s)
  - ④ Install New Sign(s) & Post(s)

DATE	6/21/12
DESIGNED BY	
CHECKED BY	
QUANTITIES BY	
TRACED BY	
DRAWN BY	
ORIGINAL PLAN	

STATE OF HAWAII  
DEPARTMENT OF TRANSPORTATION  
HIGHWAYS DIVISION  
**SIGNING & PAVEMENT MARKING PLAN**  
NORTH KIHEI ROAD RESURFACING  
Honoapiilani Highway to Piilani Highway  
Project No. 310A-01-13M  
Scale: 1" = 40' Date: October, 2012  
SHEET No. 9 OF 9 SHEETS