





FED. ROAD DIST. NO.	STATE	FED. AID PROJ. NO.	FISCAL YEAR	SHEET NO.	TOTAL SHEETS
HAWAII	HAW.	STP-037-1(23)R	2005	12	22

TRAFFIC SIGN SUMMARY					
SIGN NO.	MESSAGE	QUANTITY			
		10 SQ. FT. OR LESS		GREATER THAN 10 SQ. FT.	
		W/POST	W/O POST	W/POSTS	W/O POSTS
R1-2	"YIELD"	4	-	-	-
R2-1(45)-B	"SPEED LIMIT 45"	-	-	2	-
R3-13-D	 INTERSECTION LANE CONTROL	2	-	-	-
R3-44	 INTERSECTION LANE CONTROL	-	-	2	-
R4-4	"BEGIN RIGHT TURN LANE  YIELD TO BIKES"	1	-	-	-
R10-5	"LEFT ON GREEN ARROW ONLY"	2	-	-	-
W3-3		2	-	2	-
TOTAL		11	-	6	-

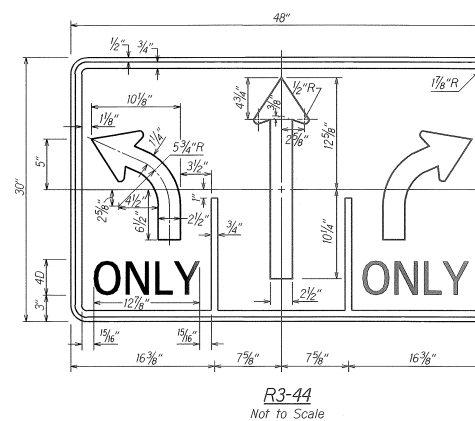
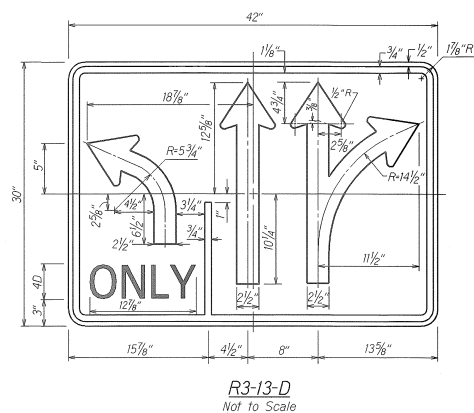

STATE OF HAWAII
DEPARTMENT OF TRANSPORTATION
HIGHWAYS DIVISION

TRAFFIC SUMMARIES & DETAILS

HALEAKALA HIGHWAY
Intersection Improvements at Makani Road
F.A. Project No. STP-037-1(23)R

Date: Oct. 2003 Date: May 2005

SHEET No. 16 OF 7 SHEETS