

FED. ROAD DIST. NO.	STATE	FED. AID PROJ. NO.	FISCAL YEAR	SHEET NO.	TOTAL SHEETS
HAWAII	HAW.	NH-037-1(24)	2005	161	288

GENERAL NOTES FOR TRAFFIC CONTROL PLAN

- ALL TRAFFIC CONTROL WORK, SIGNS AND DEVICES SHALL CONFORM TO U.S. FEDERAL HIGHWAY ADMINISTRATION MANUAL ON UNIFORM TRAFFIC CONTROL DEVICES FOR STREETS AND HIGHWAYS, PART VI—STANDARDS AND GUIDES FOR TRAFFIC CONTROLS FOR STREET AND HIGHWAY CONSTRUCTION, MAINTENANCE, UTILITY, AND INCIDENT MANAGEMENT OPERATIONS.
- CONTRACTOR SHALL MAKE MINOR ADJUSTMENTS AT INTERSECTIONS, DRIVEWAYS, BRIDGES, STRUCTURES, ETC., TO FIT FIELD CONDITIONS.
- CONES OR DELINEATORS SHALL BE EXTENDED TO A POINT WHERE THEY ARE VISIBLE TO APPROACHING TRAFFIC.
- TRAFFIC CONTROL DEVICES SHALL BE INSTALLED SUCH THAT THE SIGN OR DEVICE FARTHEST FROM THE WORK AREA SHALL BE PLACED FIRST. OTHERS SHALL THEN BE PLACED PROGRESSIVELY TOWARD THE WORK AREA.
- REGULATORY AND WARNING SIGNS WITHIN THE CONSTRUCTION ZONE THAT ARE IN CONFLICT WITH THE TRAFFIC CONTROL PLANS SHALL BE REMOVED OR COVERED. UNLESS OTHERWISE NOTED, SIGNS SHALL BE RESTORED UPON COMPLETION OF THE WORK.
- THE TERM, "FLAGGER," REFERS TO FIELD TRAFFIC CONTROL PERSONNEL WHO IS TRAINED AND FIT TO CARRY OUT SAFE TRAFFIC CONTROL PRACTICES. FLAGGER SHALL BE EQUIPPED WITH A STOP/SLOW PADDLE TO DIRECT TRAFFIC AND IN DIRECT COMMUNICATION AT ALL TIMES WITH ALL OTHER FLAGGER(S) THROUGH A RELIABLE AND CONVENIENT MEAN, E.G., TWO-WAY RADIO.
- CONTRACTOR SHALL INSTALL ADDITIONAL PORTABLE CHANGEABLE MESSAGE SIGNS OR FLASHING ARROW SIGNALS AS DIRECTED BY THE ENGINEER TO ACCOMMODATE UNEXPECTED TRAFFIC AND ROUTING SITUATIONS.
- ALL TRAFFIC LANES SHALL BE A MINIMUM OF 10 FEET WIDE.
- ALL CONSTRUCTION WARNING SIGNS SHALL BE PROMPTLY REMOVED OR COVERED WHENEVER THE MESSAGE IS NOT APPLICABLE OR NOT IN USE.
- THE BACKS OF ALL SIGNS USED FOR TRAFFIC CONTROL SHALL BE APPROPRIATELY COVERED TO PRECLUDE THE DISPLAY OF INAPPLICABLE SIGN MESSAGES (I.E., WHEN SIGNS HAVE MESSAGES ON BOTH FACES).
- AT THE END OF EACH SHIFT'S WORK OR AS SOON AS THE WORK IS COMPLETED, CONTRACTOR SHALL REMOVE ALL TRAFFIC CONTROL DEVICES NO LONGER NEEDED TO PERMIT FREE AND SAFE PASSAGE OF PUBLIC TRAFFIC. REMOVAL SHALL BE IN THE REVERSE ORDER OF INSTALLATION. REPLACE EXISTING FADED OR OBLITERATED PAVEMENT MARKINGS THAT ARE NECESSARY FOR SAFE TRAFFIC FLOW IN THE CONSTRUCTION AREA WITH TEMPORARY OR PERMANENT MARKINGS BEFORE OPENING THE ROADWAY TO PUBLIC TRAFFIC EACH SHIFT.
- REPLACE PERMANENT PAVEMENT MARKINGS AND TRAFFIC SIGNS UPON COMPLETION OF EACH PHASE OF WORK.
- SIGN SPACING, BUFFER LENGTH, AND TAPER LENGTH SHALL BE AS SHOWN ON THE TRAFFIC CONTROL PLAN OR AS REFERENCED ON TABLE 1 OF THIS SHEET.
- CONES AND DELINEATORS SHALL BE SPACED AT 20' MAXIMUM ON CENTER. (10' WITHIN THE WORK AREA).
- CONTRA-LANE CONING IS CURRENTLY BEING MAINTAINED BY THE DEPARTMENT OF TRANSPORTATION ON HALEAKALA HIGHWAY.

MORNING (5:00AM TO 8:30AM)
2—INBOUND LANES, 1—OUTBOUND LANE

CONTRACTOR SHALL COORDINATE HIS WORK WITH DOT AND MAKE ANY NECESSARY TRAFFIC STRIPING AND SIGN AND ADJUSTMENTS TO ACCOMMODATE THE DAILY CONING OPERATION THROUGHOUT THE ENTIRE DURATION OF THE PROJECT.

- CONSTRUCT, INSTALL, MAINTAIN AND REMOVE TWO ADVISORY SIGNS AS SPECIFIED BY THE ENGINEER. PLACE THE SIGNS WITHIN THE PROJECT LIMITS. THE SIGNS SHALL HAVE BLACK LETTERS ON ORANGE BACKGROUND. THE MINIMUM SIZE OF THE SIGNS SHALL BE FOUR FEET HIGH BY EIGHT FEET WIDE.

THE SIGN MESSAGE SHALL INCLUDE THE STARTING DATE, HOURS, LIMITS AND DURATION OF CONSTRUCTION. THE HEIGHT OF THE LETTERS SHALL BE 8 INCHES, SERIES D. IF ACCEPTED BY THE ENGINEER, THE CONTRACTOR MAY USE A MINIMUM HEIGHT OF 6 INCHES, SERIES D. THE ENGINEER WILL REVIEW AND ACCEPT THE ADVISORY SIGN WORDING BEFORE INSTALLING. INSTALL THE ADVISORY SIGN TWO WEEKS BEFORE THE START OF CONSTRUCTION.

- THE CONTRACTOR SHALL PLACE AN ADVERTISEMENT IN THE NEWSPAPER FOR THE FOLLOWING TRAFFIC PATTERN CHANGES IN OPERATION:
 - TEMPORARY ROAD OR LANE CLOSURE;
 - TEMPORARY NEW ROUTE THAT CHANGES A PREVIOUS ROUTE.
 THE ADVERTISEMENT SHALL CONTAIN THE FOLLOWING INFORMATION:
 - MAP OF TRAFFIC PATTERN CHANGE LIMITS;
 - MAP SHOWING ROAD OR LANE CLOSURE AND DETOUR PATTERN;
 - NOTICE OF STARTING AND ENDING DATES AND DURATION; AND
 - EXPLANATION OF THE LANE(S) CLOSURE OR DETOURS "NOTICE TO MOTORIST".
 THE QUALITY OF THE MAP SHALL BE AS FOLLOWS:
 - THE DEPARTMENT WILL NOT ALLOW FREE HAND PRINTING OR PENCIL;
 - HIGHLIGHT IMPORTANT FEATURE IN BOLD LETTERS BY DARKENING, CROSS-HATCHING, CROSSING-OUT OR COLORING;
 - MINIMUM SIZE SHALL BE FIVE COLUMNS WIDE AND FOUR COLUMNS DEEP. LESSER WIDTH COLUMNS MAY BE CONSIDERED TO BALANCE AGAINST THE SIZE OF THE DRAWING.;
 - TEXT SPECIFICATIONS.
 - WORK BEING FEATURED — 3/16 INCH TEXT
 - MAJOR ROADS AND FEATURES — 1/8 INCH TEXT
 - OTHER ROADS AND FEATURES — FIRST LETTER UPPER CASE
 - "NOTICE TO MOTORISTS" IN UPPER CASE
 - MESSAGE — FIRST LETTER UPPER CASE
 (e) LINE THICKNESS.
 - IMPORTANT FEATURE BEING ADVERTISED — THICKER THAN THE REST OF MAP
 - DIRECTIONAL ARROW — BOLDER THAN THE REST OF THE LINES SHOWN ON THE MAP, WHEN IMPORTANT, TO SHOW THE ROUTE TRAFFIC SHOULD USE.
 (f) SHOW REFERENCE DIRECTION SUCH AS "TO KAHULUI" WITH ARROW.
- THE CONTRACTOR SHALL SUBMIT:
 - THE "NOTICE TO MOTORISTS" FOR REVIEW AND ACCEPTANCE BEFORE PLACEMENT IN THE NEWSPAPER 6 WEEKS BEFORE THE START OF WORK.
 - THE ACTUAL SIZE OF THE NOTICE TO BE PUBLISHED IN THE NEWSPAPER FOR REVIEW AND ACCEPTANCE. THE ENGINEER WILL NOT ALLOW REDUCTION OF THE NOTICES ONCE ACCEPTED. THE FINAL "NOTICE TO MOTORISTS" SUBMITTAL SHALL BE A GOOD COPY OF THE CAMERA READY ADVERTISEMENT.
 PLACE THE ADVERTISEMENT FOR THREE CONSECUTIVE DAYS AND WITHIN ONE WEEK BEFORE THE TRAFFIC PATTERN CHANGES IN A WIDELY CIRCULATED NEWSPAPER OF THE AFFECTED MOTORIST POPULATION.
- END ROAD WORK SIGN FOR A TEMPORARY TRAFFIC CONTROL ZONE SHALL BE OMITTED IF ANOTHER TEMPORARY TRAFFIC CONTROL ZONE BEGINS WITHIN ONE MILE OF THE END WORK AREA.
- DUE TO THE HIGH TRAVEL SPEED ON THE HIGHWAY, USE OF METAL PLATE TO BRIDGE OVER OPEN TRENCH ON THE TRAVEL WAY WILL NOT BE ALLOWED UNLESS IN EMERGENCY SITUATIONS AND WITH APPROVAL FROM THE ENGINEER.
- UNLESS OTHERWISE SPECIFIED, ALL WORK IN THESE TRAFFIC CONTROL PLANS SHALL BE CONSIDERED AS INCLUDED IN THE LUMP SUM CONTRACT PRICE OF ITEM NO. 645.1000 TRAFFIC CONTROL ITEMS. ONLY ADDITIONAL TRAFFIC CONTROL ITEMS NOT IN THESE PLANS WILL BE CONSIDERED FOR PAYMENT UNDER ITEM NO. 645.0100 "ADDITIONAL POLICE OFFICERS AND/OR ADDITIONAL TRAFFIC CONTROL DEVICES," PER FORCE ACCOUNT.

MESSAGE SIGN NOTE

- CONTRACTOR SHALL INSTALL TWO FIXED AND TWO PORTABLE VARIABLE MESSAGE SIGNS AT LOCATIONS TO BE DETERMINED BY THE ENGINEER. THIS WORK SHALL BE CONSIDERED AS INCLUDED IN THE LUMP SUM CONTRACT PRICE OF ITEM NO. 645.1000 TRAFFIC CONTROL.

POSTED SPEED LIMIT (M.P.H.)	SIGN SPACING (D) (FEET)	TAPER LENGTH (T) (FEET)		LONGITUDINAL BUFFER SPACE (B) (FEET)	SPACING OF CONES OR DELINEATORS (FEET)		
		W = 12' OR LESS ①	W = GREATER THAN 12' ①		TAPER	TANGENT	WORK AREA
20	250	200	W x 17	35	20	20	10
25	250	200	W x 17	55	20	20	10
30	250	250	W x 20	85	20	20	10
35	250	250	W x 20	120	20	20	10
40	500	350	W x 30	170	20	20	10
45	500	550	W x 45	220	20	20	10
50	500	600	W x 50	280	20	20	10
55	500	700	W x 55	335	20	20	10

NOTES:

① W = WIDTH OF LANE, SHOULDER, OR OFFSET

LEGEND

- ◄ SIGN
- CONE OR DELINEATOR
- ➔ DIRECTION OF TRAFFIC
- ◻ FLASHING ARROW SIGNAL
- ⚠ POLICE OFFICER/FLAGMAN
- ▨ WORK AREA

ORIGINAL PLAN	DATE
DRAWN BY	
DESIGNED BY	
QUANTITIES BY	
CHECKED BY	
No.	

11/15/04 Engineering Projects 1994-1995 Honolulu Hwy Phase 2 (Haleakala Hwy) 10/20/04 2005 - 8:08am



THIS WORK WAS PREPARED BY ME OR UNDER MY SUPERVISION.
Eric N. S. HEE
 ENGINEERS SURVEYORS HAWAII, INC.
 LICENSE EXPIRATION DATE: 4/30/06

STATE OF HAWAII
 DEPARTMENT OF TRANSPORTATION
 HIGHWAYS DIVISION

TRAFFIC CONTROL

**HALEAKALA HIGHWAY WIDENING, PHASE 2
 HANA HIGHWAY TO PUKALANI BYPASS
 FED. AID PROJ. NO. NH-037-1(24)**

SCALE: AS NOTED DATE: SEP., 2005

FED. ROAD DIST. NO.	STATE	FED. AID PROJ. NO.	FISCAL YEAR	SHEET NO.	TOTAL SHEETS
HAWAII	HAW.	NH-037-1(24)	2005	162	288

NOTE:
THIS PLAN MAY BE USED ONLY IF ALL ROAD WORK, INCLUDING EQUIPMENT AND WORKERS ARE OFF THE TRAVEL WAY AND PAVED SHOULDER.

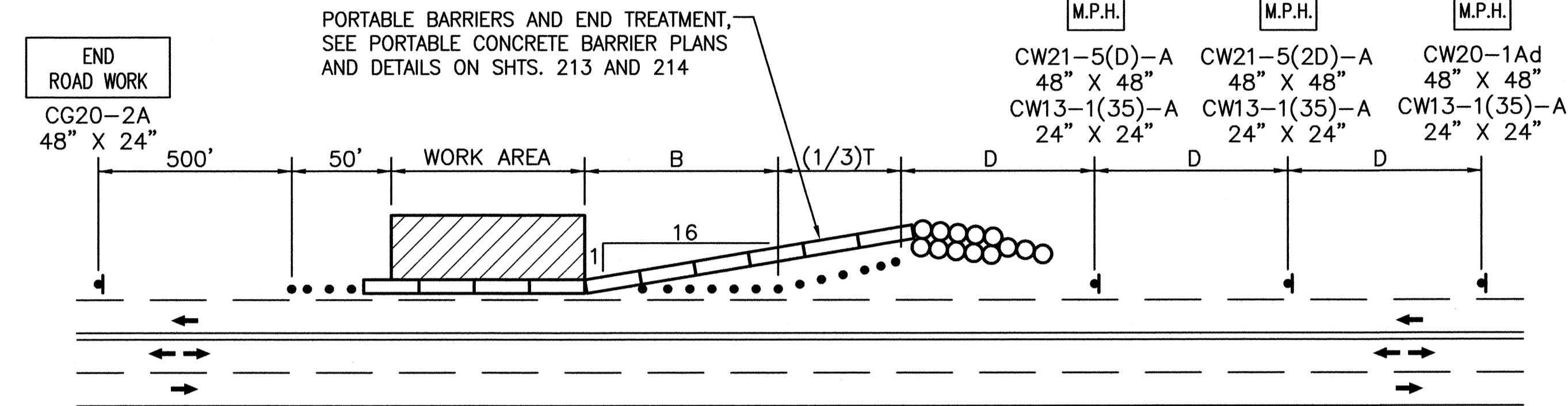

SHOULDER WORK WITH PORTABLE BARRIERS

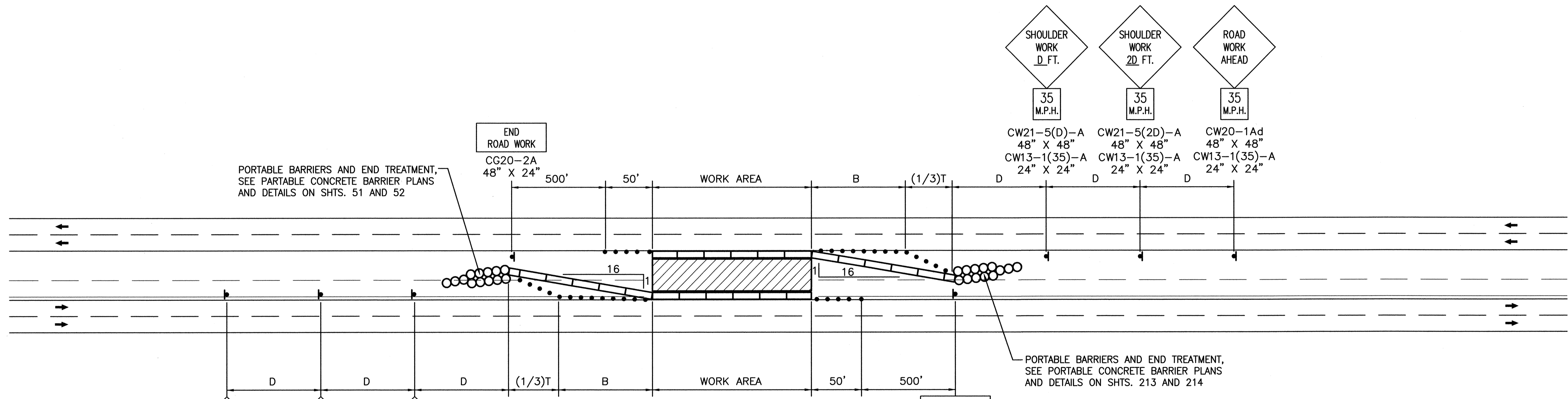

NOTE:
1. THIS PLAN IS BASED ON THE CONDITIONS THAT NEW INBOUND LANES AND SHOULDER IN THE VICINITY ARE CONSTRUCTED AND IN OPERATION, AND THAT THE EXISTING INBOUND LANE IS TEMPORARILY DETOURED UPSTREAM AND DOWNSTREAM OF WORK AREA PER PHASING REQUIREMENTS OF THIS PROJECT.
2. THIS PLAN MAY BE USED ONLY IF ALL ROAD WORK, INCLUDING EQUIPMENT AND WORKERS ARE OFF THE TRAVEL WAY.

MEDIAN WORK

ORIGINAL PLAN	DATE
NOTE BOOK	DESIGNED BY
No.	CHECKED BY

11-Esh-1 (esh/Engineering) Projects | 894 | 94-056, Haleakala Hwy | PHASE 2 | WORKING SHOULDER PH2-TCP.dwg | Sct. Oct 01, 2005 - 8:06am AMR

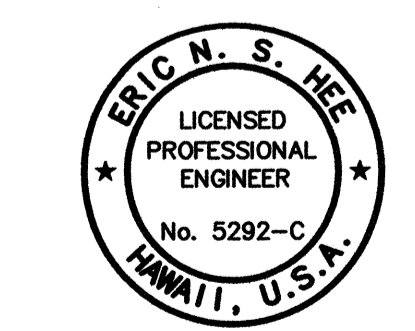

THIS WORK WAS PREPARED BY ME OR UNDER MY SUPERVISION.
Eric N. S. Hee
ENGINEERS SURVEYORS HAWAII, INC.
LICENSE EXPIRATION DATE: 4/30/06

STATE OF HAWAII
DEPARTMENT OF TRANSPORTATION
HIGHWAYS DIVISION

TRAFFIC CONTROL

HALEAKALA HIGHWAY WIDENING, PHASE 2
HANA HIGHWAY TO PUKALANI BYPASS
FED. AID PROJ. NO. NH-037-1(24)

SCALE: AS NOTED DATE: MAY, 2005

SHEET No. 2 OF 14 SHEETS

FED. ROAD DIST. NO.	STATE	FED. AID PROJ. NO.	FISCAL YEAR	SHEET NO.	TOTAL SHEETS
HAWAII	HAW.	NH-037-1(24)	2005	163	288

NOTE:

1. THIS PLAN IS BASED ON THE CONSTRUCTION PHASING THAT NEW INBOUND LANES AND TRAFFIC SIGNAL SYSTEM IN THE VICINITY ARE CONSTRUCTED AND IN OPERATION.
2. CONTRACTOR SHALL TEMPORARILY PROGRAM THE TRAFFIC SIGNAL SYSTEM OR PROVIDE ADDITIONAL TRAFFIC CONTROL BY POLICEMEN TO ALLOW LEFT TURNS AND HIGHWAY CROSSING IN THE EVENT THAT THE NEW TRAFFIC SIGNAL SYSTEM DOES NOT DETECT VEHICLES' WAITING POSITIONS DUE TO THE CHANGED LANE PATTERN OF THIS PLAN.
3. INSTALL TWO VARIABLE MESSAGE SIGNS; ONE FOR EACH DIRECTION, ON HALEAKALA HIGHWAY INFORMING THE PUBLIC OF ROADWORK (TYPICAL).

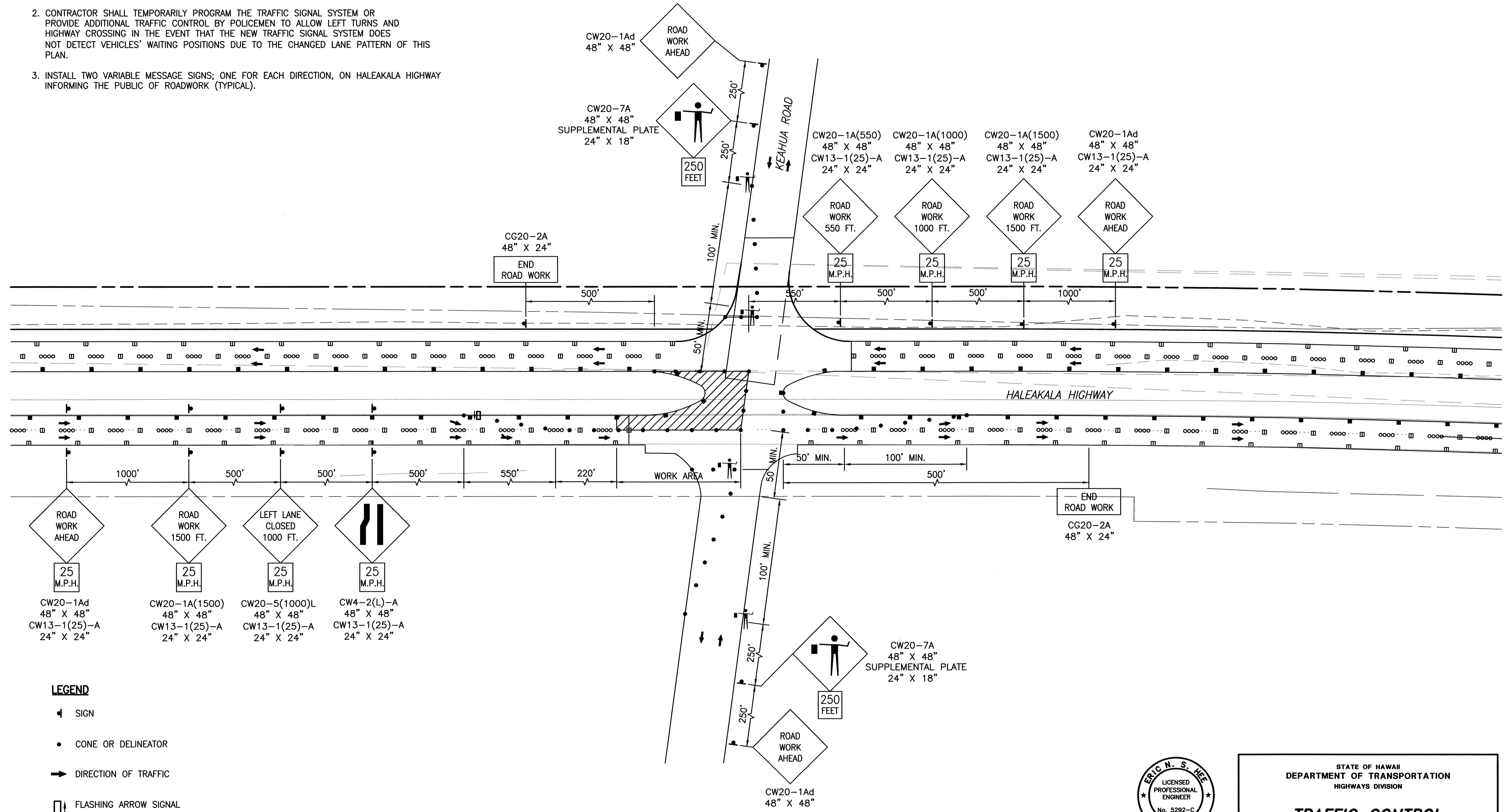

- LEGEND**
- ◄ SIGN
 - CONE OR DELINEATOR
 - ➔ DIRECTION OF TRAFFIC
 - ◻ FLASHING ARROW SIGNAL
 - ⚓ POLICE OFFICER/FLAGMAN
 - ▨ WORK AREA

**KEAHUA ROAD INTERSECTION PARTIAL CLOSURE
PART ONE OF FOUR
Not to Scale**

ORIGINAL PLAN	DATE
DESIGNED BY	
DESIGNED BY	
QUANTITIES BY	
CHECKED BY	
NO.	

\\Esh-1\esh\Engineering\Projects\1894\94-056 Haleakala Hwy\PHASE 2\WORKING\OLDER\Pr2-TCF.dwg Sat, Oct 01, 2005 - 8:07am AMR

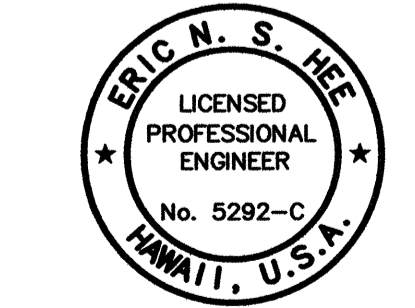

THIS WORK WAS PREPARED BY ME OR UNDER MY SUPERVISION.
Eric N. S. Hee
 ENGINEERS SURVEYORS HAWAII, INC.
 LICENSE EXPIRATION DATE: 4/30/06

STATE OF HAWAII
DEPARTMENT OF TRANSPORTATION
HIGHWAYS DIVISION

TRAFFIC CONTROL

**HALEAKALA HIGHWAY WIDENING, PHASE 2
HANA HIGHWAY TO PUKALANI BYPASS
FED. AID PROJ. NO. NH-037-1(24)**

SCALE: AS NOTED DATE: MAY, 2005

SHEET No. 3 OF 14 SHEETS

FED. ROAD DIST. NO.	STATE	FED. AID PROJ. NO.	FISCAL YEAR	SHEET NO.	TOTAL SHEETS
HAWAII	HAW.	NH-037-1(24)	2005	161	288

NOTE:

- THIS PLAN IS BASED ON THE CONSTRUCTION PHASING THAT NEW INBOUND LANES AND TRAFFIC SIGNAL SYSTEM IN THE VICINITY ARE CONSTRUCTED AND IN OPERATION.
- CONTRACTOR SHALL TEMPORARILY PROGRAM THE TRAFFIC SIGNAL SYSTEM OR PROVIDE ADDITIONAL TRAFFIC CONTROL BY POLICEMEN TO ALLOW LEFT TURNS AND HIGHWAY CROSSING IN THE EVENT THAT THE NEW TRAFFIC SIGNAL SYSTEM DOES NOT DETECT VEHICLES' WAITING POSITIONS DUE TO THE CHANGED LANE PATTERN OF THIS PLAN.

LEGEND

- ◆ SIGN
- CONE OR DELINEATOR
- DIRECTION OF TRAFFIC
- ⬮ FLASHING ARROW SIGNAL
- 👮 POLICE OFFICER/FLAGMAN
- ▨ WORK AREA

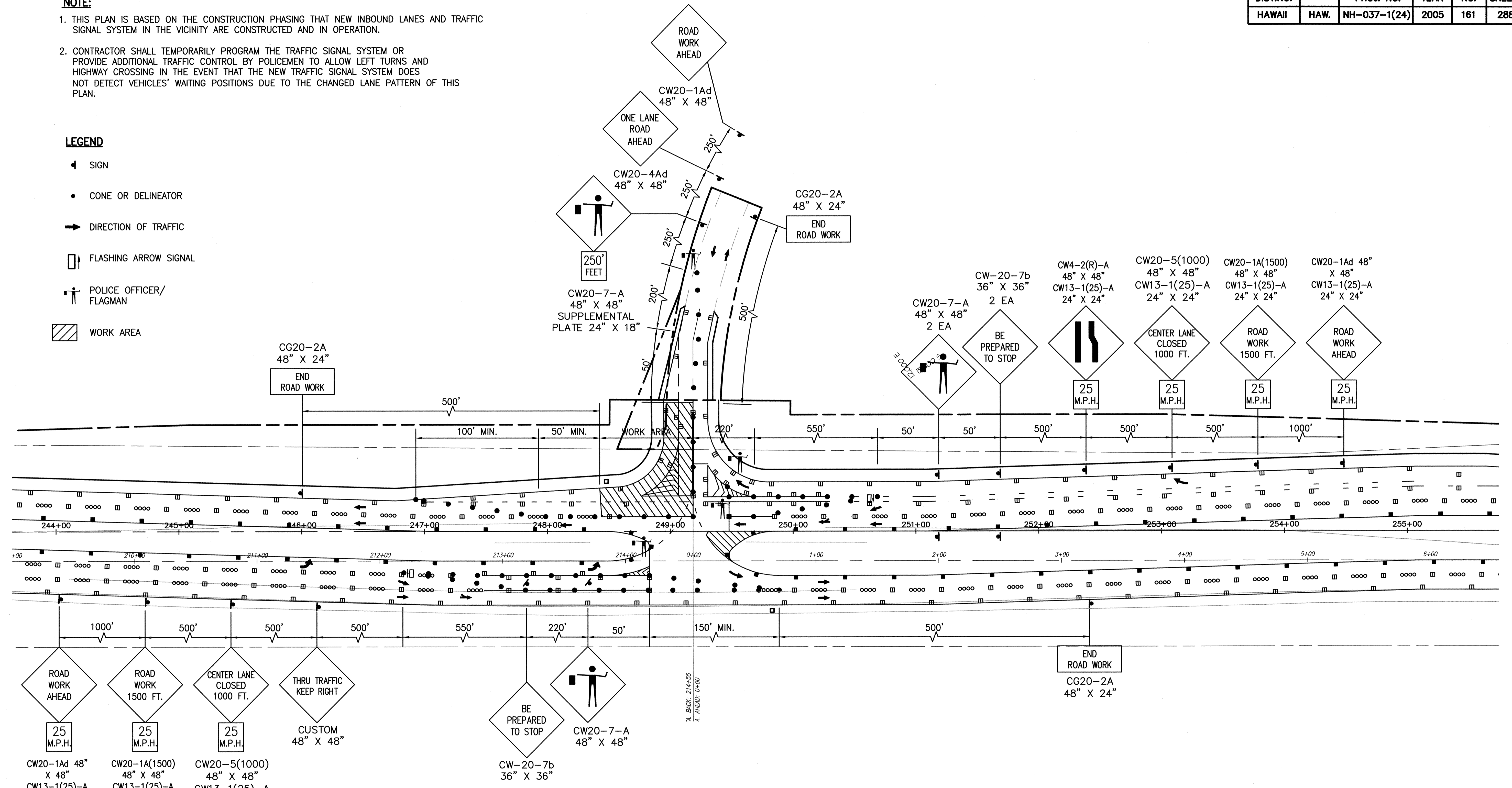

NOTE:

IF TRAFFIC LIGHTS ARE PRESENT AT THE INTERSECTION, SWITCH LIGHTS TO FLASHING RED FOR ALL WAYS DURING THE USE OF THIS TRAFFIC CONTROL PLAN.

**HAILIMAILE ROAD INTERSECTION PARTIAL CLOSURE
PART 1 OF 4
NOT TO SCALE**

SURVEY PLOTTED BY	DATE
DRAWN BY	
DESIGNED BY	
QUANTITIES BY	
CHECKED BY	
ORIGINAL PLAN	
NOTE BOOK	
No.	

11 East - 1 East Engineering Projects | 1994-94-055 Hialeah Hwy PHASE 2 WORKING ORDER P12-TCP-HAILIMAILE.dwg, Sat, Oct 01 2005 - 8:02am AMR

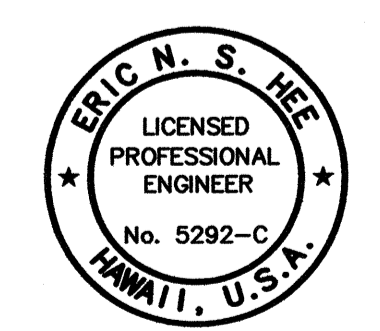

THIS WORK WAS PREPARED BY ME OR UNDER MY SUPERVISION.
Eric N. S. Hee
ENGINEERS SURVEYORS HAWAII, INC.
LICENSE EXPIRATION DATE: 4/30/06

STATE OF HAWAII
DEPARTMENT OF TRANSPORTATION
HIGHWAYS DIVISION

TRAFFIC CONTROL

**HALEAKALA HIGHWAY WIDENING, PHASE 2
HANA HIGHWAY TO PUKALANI BYPASS
FED. AID PROJ. NO. NH-037-1(24)**

SCALE: AS NOTED DATE: MAY, 2005

SHEET No. 7 OF 14 SHEETS

FED. ROAD DIST. NO.	STATE	FED. AID PROJ. NO.	FISCAL YEAR	SHEET NO.	TOTAL SHEETS
HAWAII	HAW.	NH-037-1(24)	2005	169	288

NOTE:

- THIS PLAN IS BASED ON THE CONSTRUCTION PHASING THAT NEW INBOUND LANES AND TRAFFIC SIGNAL SYSTEM IN THE VICINITY ARE CONSTRUCTED AND IN OPERATION.
- CONTRACTOR SHALL TEMPORARILY PROGRAM THE TRAFFIC SIGNAL SYSTEM OR PROVIDE ADDITIONAL TRAFFIC CONTROL BY POLICEMEN TO ALLOW LEFT TURNS AND HIGHWAY CROSSING IN THE EVENT THAT THE NEW TRAFFIC SIGNAL SYSTEM DOES NOT DETECT VEHICLES' WAITING POSITIONS DUE TO THE CHANGED LANE PATTERN OF THIS PLAN.

LEGEND

- ◆ SIGN
- CONE OR DELINEATOR
- ➔ DIRECTION OF TRAFFIC
- ⬮ FLASHING ARROW SIGNAL
- 👮 POLICE OFFICER/FLAGMAN
- ▨ WORK AREA

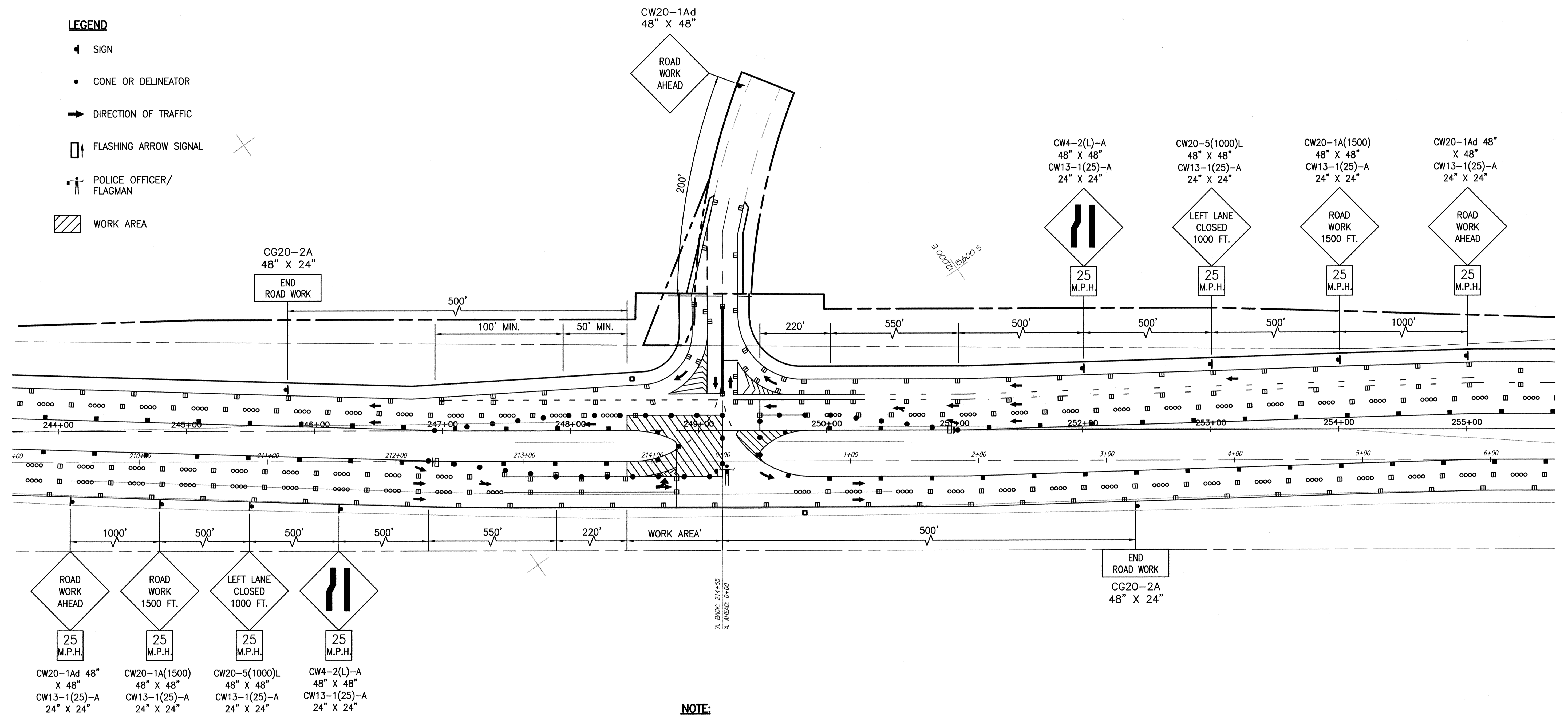

NOTE:

IF TRAFFIC LIGHTS ARE PRESENT AT THE INTERSECTION, SWITCH LIGHTS TO FLASHING RED FOR ALL WAYS DURING THE USE OF THIS TRAFFIC CONTROL PLAN.

SURVEY PLOTTED BY	DATE
DESIGNED BY	
NOTED BY	
QUANTITIES BY	
CHECKED BY	
NO.	

\\esh-1\esh\Engineering\Projects\1994\94-056 Hialeakala Hwy\PHASE 2\WORKING\DRAWING\PH2-TCP-HAILIMAILE.dwg, Sat, Oct 01 2005 - 7:57am, AMR

HAILIMAILE ROAD INTERSECTION PARTIAL CLOSURE
PART 3 OF 4
NOT TO SCALE

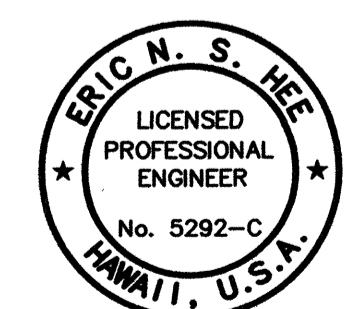

THIS WORK WAS PREPARED BY ME OR UNDER MY SUPERVISION.
Eric N. S. Hee
 ENGINEERS SURVEYORS HAWAII, INC.
 LICENSE EXPIRATION DATE: 4/30/06

STATE OF HAWAII
 DEPARTMENT OF TRANSPORTATION
 HIGHWAYS DIVISION

TRAFFIC CONTROL

HALEAKALA HIGHWAY WIDENING, PHASE 2
HANA HIGHWAY TO PUKALANI BYPASS
FED. AID PROJ. NO. NH-037-1(24)

SCALE: AS NOTED DATE: MAY, 2005

SHEET No. 9 OF 14 SHEETS

FED. ROAD DIST. NO.	STATE	FED. AID PROJ. NO.	FISCAL YEAR	SHEET NO.	TOTAL SHEETS
HAWAII	HAW.	NH-037-1(24)	2005	170	288

NOTE:

- THIS PLAN IS BASED ON THE CONSTRUCTION PHASING THAT NEW INBOUND LANES AND TRAFFIC SIGNAL SYSTEM IN THE VICINITY ARE CONSTRUCTED AND IN OPERATION.
- CONTRACTOR SHALL TEMPORARILY PROGRAM THE TRAFFIC SIGNAL SYSTEM OR PROVIDE ADDITIONAL TRAFFIC CONTROL BY POLICEMEN TO ALLOW LEFT TURNS AND HIGHWAY CROSSING IN THE EVENT THAT THE NEW TRAFFIC SIGNAL SYSTEM DOES NOT DETECT VEHICLES' WAITING POSITIONS DUE TO THE CHANGED LANE PATTERN OF THIS PLAN.

LEGEND

- ◀ SIGN
- CONE OR DELINEATOR
- ➔ DIRECTION OF TRAFFIC
- ⬆ FLASHING ARROW SIGNAL
- 👮 POLICE OFFICER/FLAGMAN
- ▨ WORK AREA

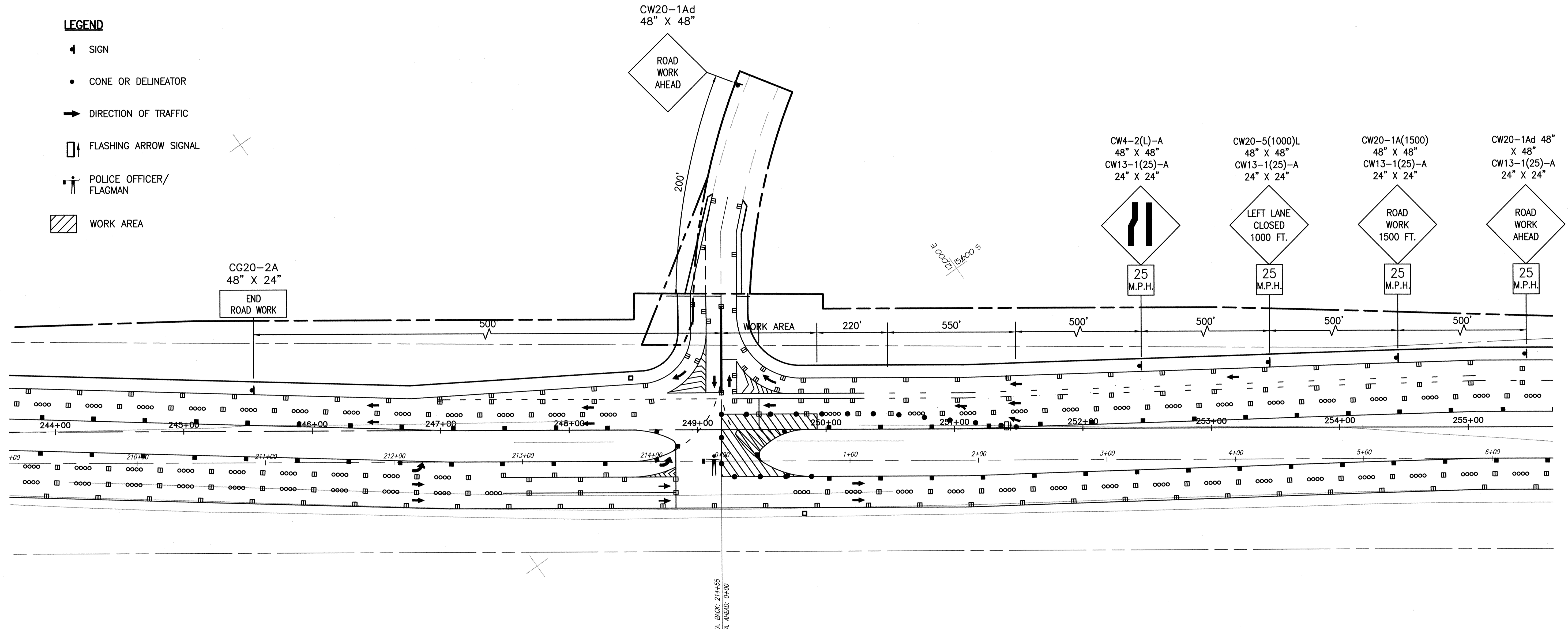

NOTE:

IF TRAFFIC LIGHTS ARE PRESENT AT THE INTERSECTION, SWITCH LIGHTS TO FLASHING RED FOR ALL WAYS DURING THE USE OF THIS TRAFFIC CONTROL PLAN.

**HAILIMAILE ROAD INTERSECTION PARTIAL CLOSURE
PART 4 OF 4
NOT TO SCALE**

ORIGINAL PLAN	DATE
SURVEY PLOTTED BY	
DRAWN BY	
DESIGNED BY	
QUANTITIES BY	
CHECKED BY	
No.	

Esh-1 (esh) Engineering Projects | 1994 | 94-155 Haleakala Hwy | PHASE 2 | WORKING FOLDER | P12-TCP-HAILIMAILE.dwg | Sat, Oct 01 2005 - 7:50am | AMF

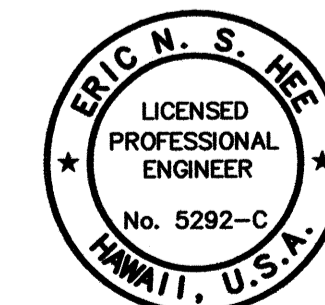

THIS WORK WAS PREPARED BY ME OR UNDER MY SUPERVISION.
Eric N. S. Hee
ENGINEERS SURVEYORS HAWAII, INC.
LICENSE EXPIRATION DATE: 4/30/06

STATE OF HAWAII
DEPARTMENT OF TRANSPORTATION
HIGHWAYS DIVISION

TRAFFIC CONTROL

**HALEAKALA HIGHWAY WIDENING, PHASE 2
HANA HIGHWAY TO PUKALANI BYPASS
FED. AID PROJ. NO. NH-037-1(24)**

SCALE: AS NOTED DATE: MAY, 2005

SHEET No. 10 OF 14 SHEETS

FED. ROAD DIST. NO.	STATE	FED. AID PROJ. NO.	FISCAL YEAR	SHEET NO.	TOTAL SHEETS
HAWAII	HAW.	NH-037-1(24)	2005	171	288

NOTE:

1. THIS PLAN IS BASED ON THE CONSTRUCTION PHASING THAT NEW INBOUND LANES AND TRAFFIC SIGNAL SYSTEM IN THE VICINITY ARE CONSTRUCTED AND IN OPERATION.
2. CONTRACTOR SHALL TEMPORARILY PROGRAM THE TRAFFIC SIGNAL SYSTEM OR PROVIDE ADDITIONAL TRAFFIC CONTROL BY POLICEMEN TO ALLOW LEFT TURNS AND HIGHWAY CROSSING IN THE EVENT THAT THE NEW TRAFFIC SIGNAL SYSTEM DOES NOT DETECT VEHICLES' WAITING POSITIONS DUE TO THE CHANGED LANE PATTERN OF THIS PLAN.

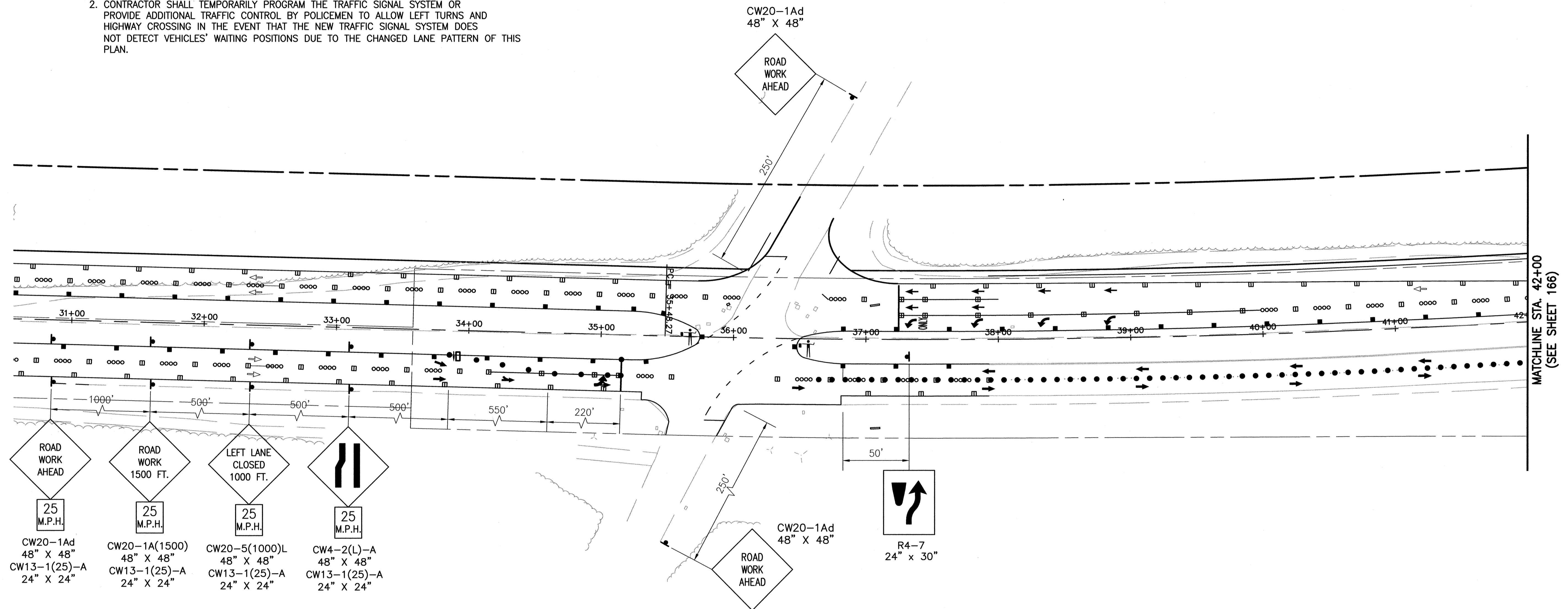

TRAFFIC CONTROL PLAN
NOT TO SCALE

ORIGINAL PLAN	DATE
DRAWN BY	
DESIGNED BY	
QUANTITIES BY	
CHECKED BY	
No.	

1. Estb-1 (est) Engineering Projects | 1994-04-06 Haleakala Hwy | PHASE 2 | WORKING UNDER THE CONTRACT | Sep 30 2005 - 2:33pm AMP

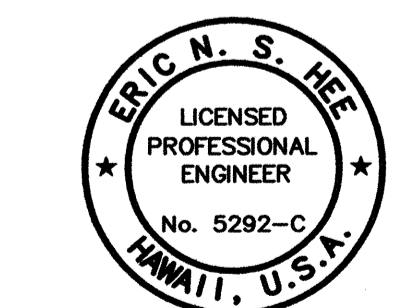

THIS WORK WAS PREPARED BY ME OR UNDER MY SUPERVISION.
Eric N. S. Hee
ENGINEERS SURVEYORS HAWAII, INC.
LICENSE EXPIRATION DATE: 4/30/06

STATE OF HAWAII
DEPARTMENT OF TRANSPORTATION
HIGHWAYS DIVISION

TRAFFIC CONTROL

**HALEAKALA HIGHWAY WIDENING, PHASE 2
HANA HIGHWAY TO PUKALANI BYPASS
FED. AID PROJ. NO. NH-037-1(24)**

SCALE: AS NOTED DATE: MAY, 2005

SHEET No. 11 OF 14 SHEETS

FED. ROAD DIST. NO.	STATE	FED. AID PROJ. NO.	FISCAL YEAR	SHEET NO.	TOTAL SHEETS
HAWAII	HAW.	NH-037-1(24)	2005	172	288

NOTE:

1. THIS PLAN IS BASED ON THE CONSTRUCTION PHASING THAT NEW INBOUND LANES AND TRAFFIC SIGNAL SYSTEM IN THE VICINITY ARE CONSTRUCTED AND IN OPERATION.
2. CONTRACTOR SHALL TEMPORARILY PROGRAM THE TRAFFIC SIGNAL SYSTEM OR PROVIDE ADDITIONAL TRAFFIC CONTROL BY POLICEMEN TO ALLOW LEFT TURNS AND HIGHWAY CROSSING IN THE EVENT THAT THE NEW TRAFFIC SIGNAL SYSTEM DOES NOT DETECT VEHICLES' WAITING POSITIONS DUE TO THE CHANGED LANE PATTERN OF THIS PLAN.

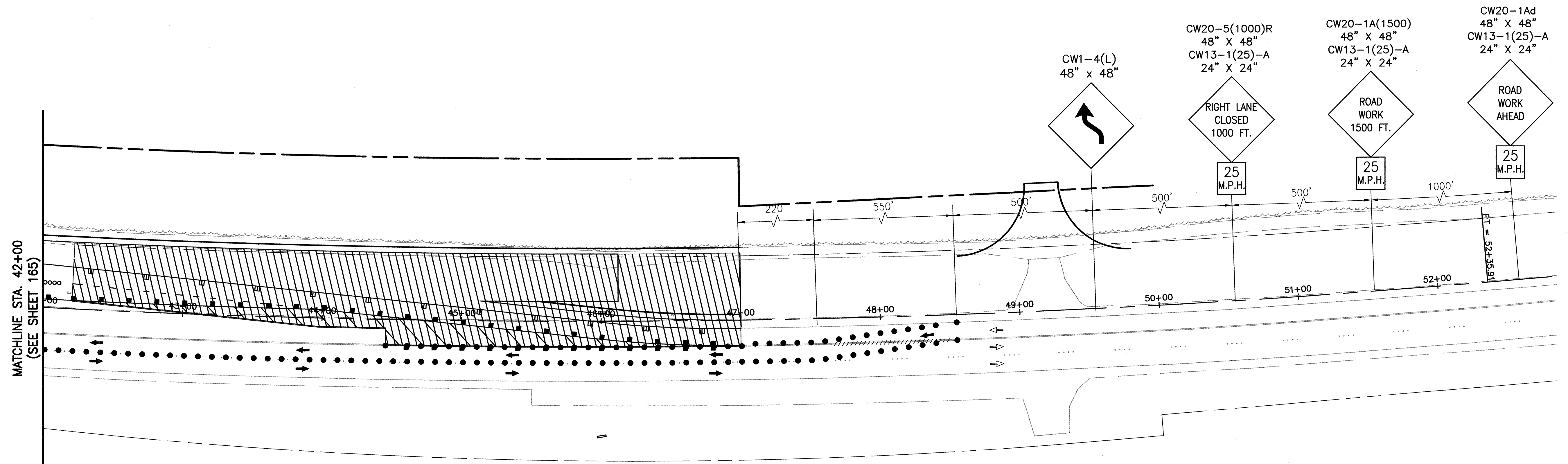

NOTE:

IF TRAFFIC LIGHTS ARE PRESENT AT THE INTERSECTION, SWITCH LIGHTS TO FLASHING RED FOR ALL WAYS DURING THE USE OF THIS TRAFFIC CONTROL PLAN.

LEGEND

- ◄ SIGN
- CONE OR DELINEATOR
- ➔ DIRECTION OF TRAFFIC
- ◻ FLASHING ARROW SIGNAL
- ⚠ POLICE OFFICER/FLAGMAN
- ▨ WORK AREA

TRAFFIC CONTROL PLAN
NOT TO SCALE

ORIGINAL PLAN	SURVEY PLOTTED BY	DATE
NOTE BOOK	DESIGNED BY	
	QUANTITIES BY	
	CHECKED BY	
No.		

1. Est-1.esh (Engineering) Projects 1994-04-056 Haleakala Hwy Phase 2 WORKING DRAFT (P2-TCP-04) NORTH.dwg Fri, Sep 30, 2005 - 1:57pm AMR



THIS WORK WAS PREPARED BY ME OR UNDER MY SUPERVISION.
Eric N. S. HEE
ENGINEERS SURVEYORS HAWAII, INC.
LICENSE EXPIRATION DATE: 4/30/08

STATE OF HAWAII
DEPARTMENT OF TRANSPORTATION
HIGHWAYS DIVISION

TRAFFIC CONTROL

*HALEAKALA HIGHWAY WIDENING, PHASE 2
HANA HIGHWAY TO PUKALANI BYPASS
FED. AID PROJ. NO. NH-037-1(24)*

SCALE: AS NOTED DATE: MAY, 2005

FED. ROAD DIST. NO.	STATE	FED. AID PROJ. NO.	FISCAL YEAR	SHEET NO.	TOTAL SHEETS
HAWAII	HAW.	NH-037-1(24)	2005	174	288

NOTE:
IF TRAFFIC LIGHTS ARE PRESENT AT THE INTERSECTION, SWITCH LIGHTS TO FLASHING RED FOR ALL WAYS DURING THE USE OF THIS TRAFFIC CONTROL PLAN.

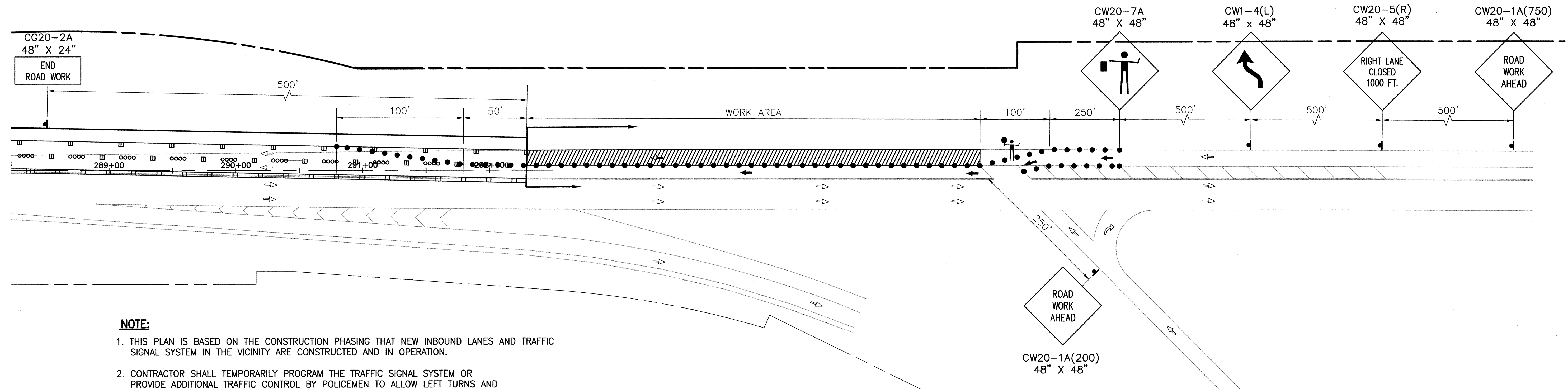

NOTE:

- THIS PLAN IS BASED ON THE CONSTRUCTION PHASING THAT NEW INBOUND LANES AND TRAFFIC SIGNAL SYSTEM IN THE VICINITY ARE CONSTRUCTED AND IN OPERATION.
- CONTRACTOR SHALL TEMPORARILY PROGRAM THE TRAFFIC SIGNAL SYSTEM OR PROVIDE ADDITIONAL TRAFFIC CONTROL BY POLICEMEN TO ALLOW LEFT TURNS AND HIGHWAY CROSSING IN THE EVENT THAT THE NEW TRAFFIC SIGNAL SYSTEM DOES NOT DETECT VEHICLES' WAITING POSITIONS DUE TO THE CHANGED LANE PATTERN OF THIS PLAN.

- LEGEND**
- ◄ SIGN
 - CONE OR DELINEATOR
 - ➔ DIRECTION OF TRAFFIC
 - ◻ FLASHING ARROW SIGNAL
 - ◻ POLICE OFFICER/FLAGMAN
 - ▨ WORK AREA

TRAFFIC CONTROL PLAN
NOT TO SCALE

ORIGINAL PLAN	DATE
DESIGNED BY	
DESIGNED BY	
QUANTITIES BY	
CHECKED BY	
No.	

1 | Estn-1 (estn) Engineering Projects | 1994-94-066 Haleakala Hwy | PHASE 2 WORKING ORDER | PHASE 2 WORKING ORDER | 1/24/05 - 1:54pm AMR

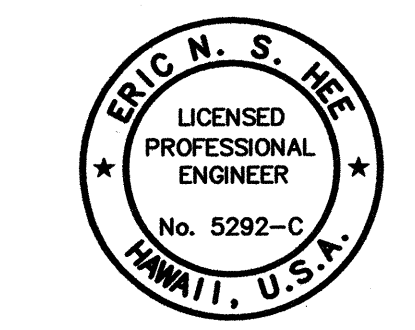

THIS WORK WAS PREPARED BY ME OR UNDER MY SUPERVISION.
Eric N. S. Hee
ENGINEERS SURVEYORS HAWAII, INC.
LICENSE EXPIRATION DATE: 4/30/06

STATE OF HAWAII
DEPARTMENT OF TRANSPORTATION
HIGHWAYS DIVISION

TRAFFIC CONTROL

**HALEAKALA HIGHWAY WIDENING, PHASE 2
HANA HIGHWAY TO PUKALANI BYPASS
FED. AID PROJ. NO. NH-037-1(24)**

SCALE: AS NOTED DATE: MAY, 2005

SHEET No. 14 OF 14 SHEETS