

BASELINE CURVE DATA							
CURVE	(A)	(B)	(C)	(D)	(E)	(F)	(G)
△	13°59'30"	12°41'50"	34°27'	21°43'	19°24'14"	5°25'34"	15°47'04"
R	1800.00	7615.44	3843.72	5705.58	12,301.67	11,435.16	7500.00
T	220.88	847.29	1191.67	1094.42	2109.19	541.88	1039.68
C	438.47	1684.19	2276.44	2149.65	4146.22	1082.55	2059.65
L	439.56	1687.64	2311.10	2162.57	4166.11	1082.95	2066.19
S.E.	N/A	N/A	0.041	0.029	0.02	N/A	N/A

INTERSECTION LAYOUT REFERENCE					
NO.	STA.	NO.	STA.	NO.	STA.
4	49+20	9	161+20		
5	63+50	10	173+00		
6	85+20	11	201+00		
7	101+60	12	217+65		
8	126+25	13	249+20		

FED. ROAD DIST. NO.	STATE	FED. AID PROJ. NO.	FISCAL YEAR	SHEET NO.	TOTAL SHEETS
HAWAII	HAW.	NH-037-1(24)	2005	6	288

NOTES:

- ALL STATIONS AND BASELINE INFORMATION ARE REFERENCED TO THE PROJECT BASELINE (PBL), EXCEPT AS NOTED FOR THE EMERGENCY ESCAPE RAMP (EER).
- FOR SURVEY TRAVERSE CONTROL DATA SEE SHEET 7.

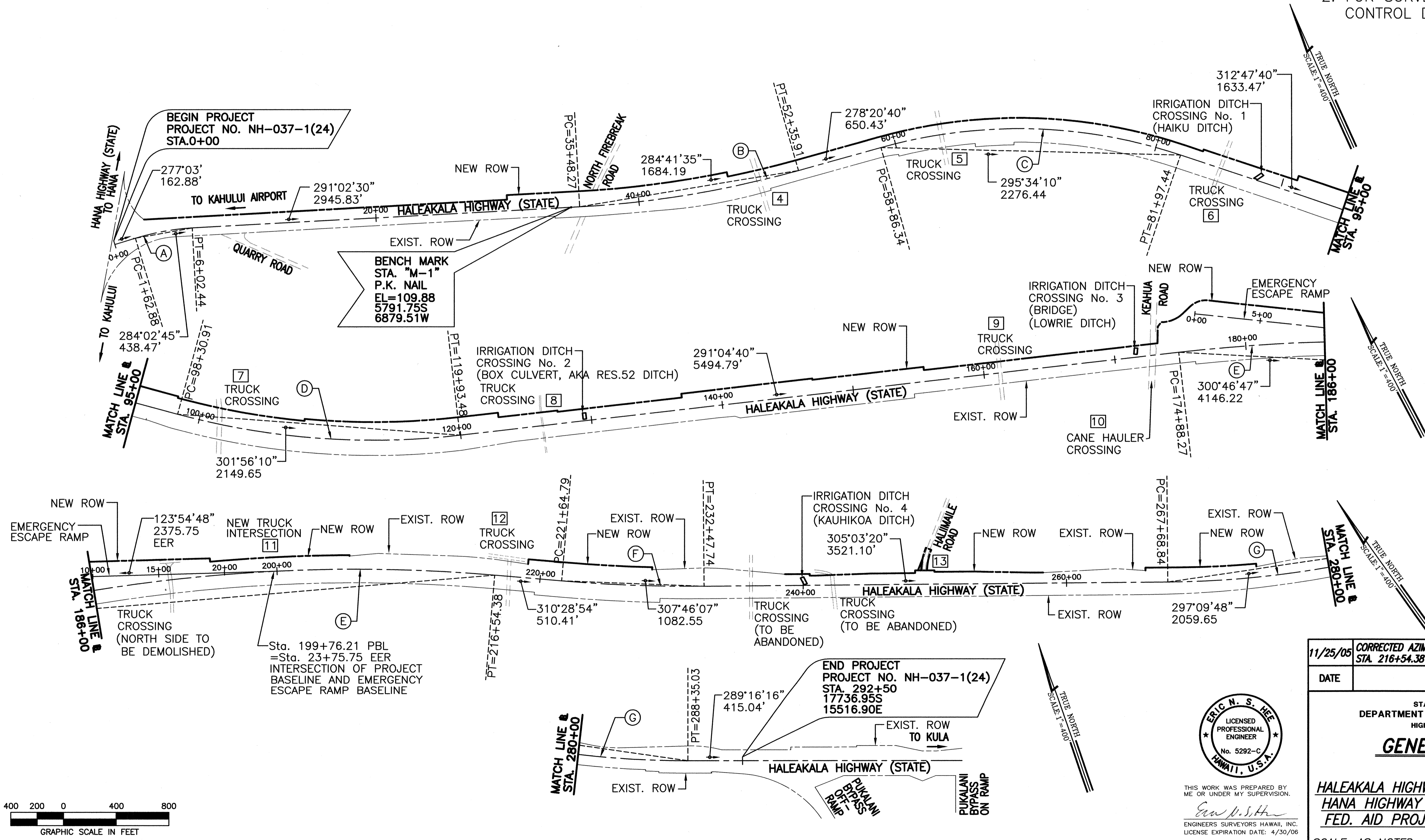

SURVEY PLOTTED BY \_\_\_\_\_ DATE \_\_\_\_\_  
 DRAWN BY \_\_\_\_\_  
 DESIGNED BY \_\_\_\_\_  
 QUANTITIES BY \_\_\_\_\_  
 CHECKED BY \_\_\_\_\_  
 No. \_\_\_\_\_

\Leah-1\Leah-Engineering\Projects\1991\1991-058-Haleakala Hwy Phase 2\WIDENING\GEN PLAN.dwg, Nov 23 2005 - 2:28pm

11/25/05	CORRECTED AZIMUTH & DISTANCE ANNOTATION BETWEEN STA. 216+54.38 & STA. 221+64.79
DATE	REVISION
STATE OF HAWAII DEPARTMENT OF TRANSPORTATION HIGHWAYS DIVISION <b>GENERAL PLAN</b>	
<b>HALEAKALA HIGHWAY WIDENING, PHASE 2</b> <b>HANA HIGHWAY TO PUKALANI BYPASS</b> <b>FED. AID PROJ. NO. NH-037-1(24)</b>	
SCALE: AS NOTED	DATE: MAY, 2005
SHEET No. 1 OF 1 SHEETS	

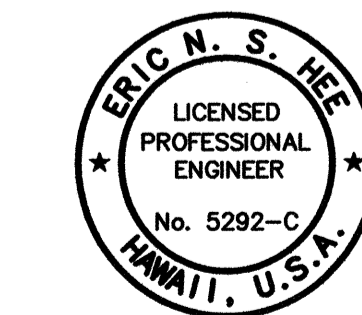

THIS WORK WAS PREPARED BY  
 ME OR UNDER MY SUPERVISION.  
*Eric N. S. Hee*  
 ENGINEERS SURVEYORS HAWAII, INC.  
 LICENSE EXPIRATION DATE: 4/30/06