

INDEX TO DRAWINGS	
SHEET NO	DESCRIPTION
1	TITLE SHEET
2	TYP. SEC., GENERAL NOTES
3-4	PLAN
5	PLAN, SIGN, PAV'T. MARKER
6	GUARD RAIL, DRAINAGE
7-9	DRAINAGE
10-23	STANDARD DETAILS
24	DETAIL-BREAKAWAY CABLE TERMINAL

STATE OF HAWAII
DEPARTMENT OF TRANSPORTATION
LAND TRANSPORTATION FACILITIES DIVISION
HONOLULU, HAWAII
"AS-BUILT" PLANS FOR
KULA HIGHWAY
WIDENING AND RESURFACING
FROM KAIPOIOI BRIDGE TO KEOKEA
PROJECT NO. 37D-01-75
DISTRICT OF MAKAWAO
COUNTY OF MAUI
ISLAND OF MAUI
SCALES

PLAN		1 IN. =	FT.
PROFILE	HOR.	1 IN. =	FT.
	VER.	1 IN. =	FT.
X-SECTIONS	HOR.	1 IN. =	FT.
	VER.	1 IN. =	FT.

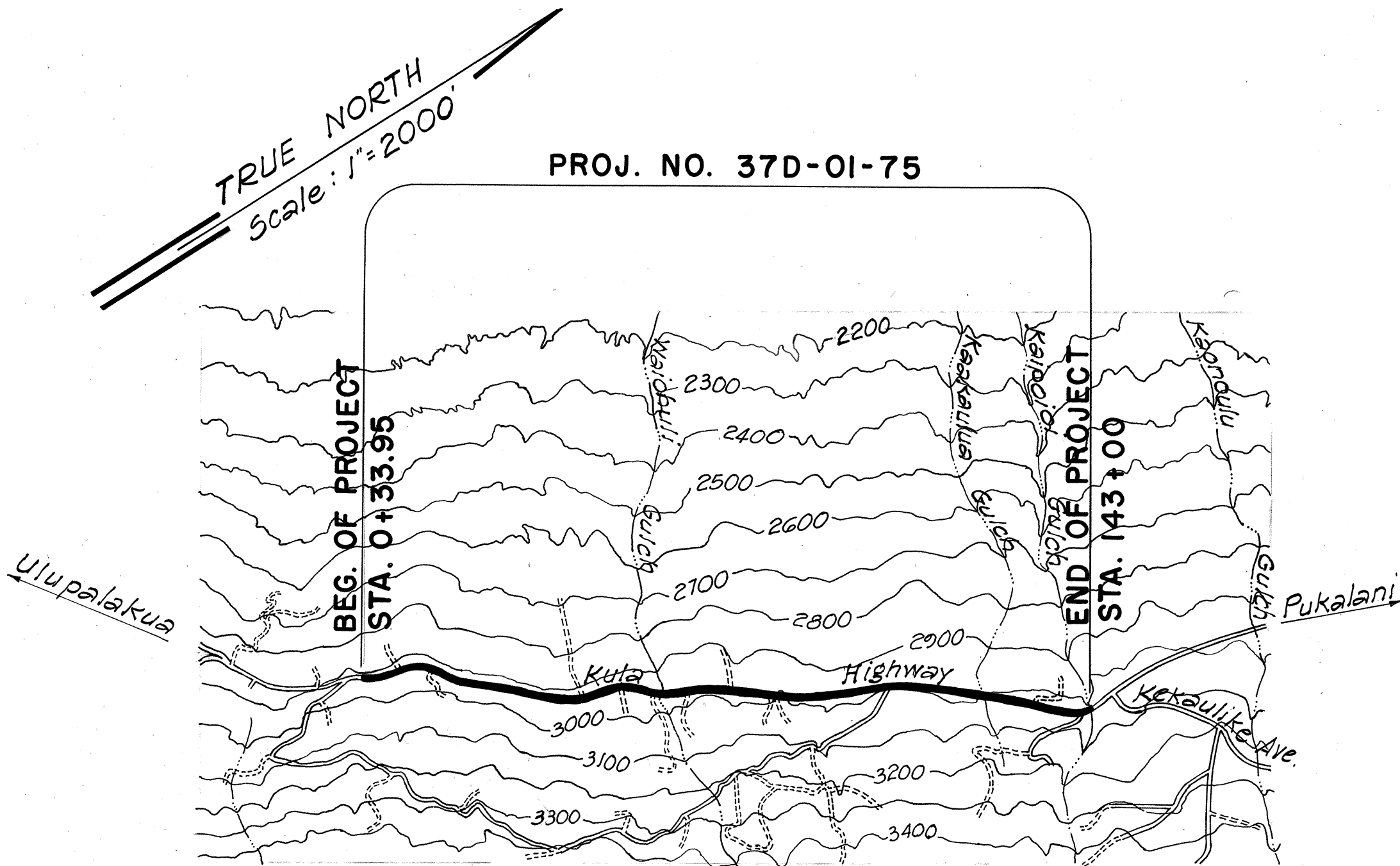

LAYOUT OF PROJECT

SCALE:	1" = 2000'
LENGTH OF PROJECT	2.702 MI.
" " "	4.348 KM.

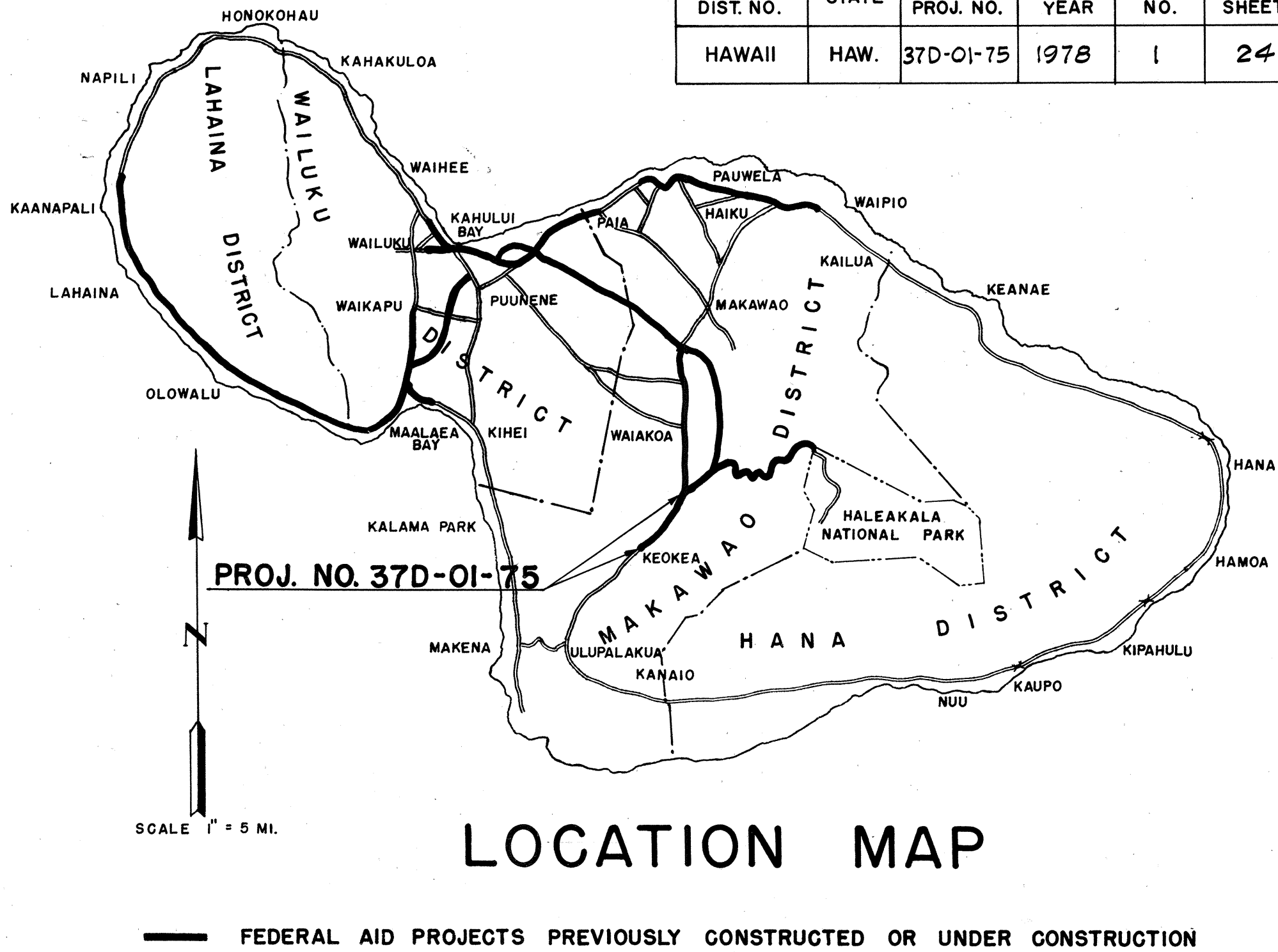

FED. ROAD DIST. NO.	STATE	PROJ. NO.	FISCAL YEAR	SHEET NO.	TOTAL SHEETS
HAWAII	HAW.	37D-01-75	1978	1	24

ALL CHANGES MADE DURING CONSTRUCTION HAVE BEEN INCORPORATED ON THESE PLANS IN RED EXCEPT CHANGES IN THE ORIGINAL THEORETICAL QUANTITIES. FOR ACTUAL QUANTITIES, REFER TO PROJECT LEDGER AND/OR COMPUTATION BOOK.

Stanley F. Kato
RESIDENT ENGINEER

12-28-81
DATE

DEPARTMENT OF TRANSPORTATION STATE OF HAWAII	
APPROVED:	
<i>R. Higashionna</i>	10/12/76
for DIR. OF TRANSPORTATION	DATE

PHONE : 7537
DATE : November, 1977

P.S. & E. BY : *A. Nishimura*
DESIGN UNIT "F"

DESIGNED BY: MAUI DISTRICT OFFICE
STATE HWYS. DIVISION
DATE: MAY 1975