

FED. ROAD DIST. NO.	STATE	FED. AID PROJ. NO.	FISCAL YEAR	SHEET NO.	TOTAL SHEETS
HAWAII	HAW.	NH-036-1(17)	2008	10	13

LEGEND

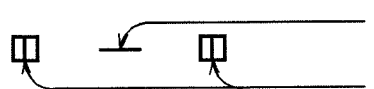

4 each Type A Raised Pavement Markers
Type C Raised Pavement Markers @ 40'-0" o.c.

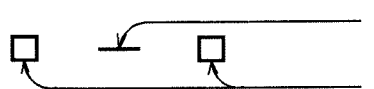

4 each Type J Raised Pavement Markers
Type D Raised Pavement Markers @ 40'-0" o.c.



8" White Stripe with Type C Raised Pavement
Markers @ 20'-0" o.c. (Thermoplastic)

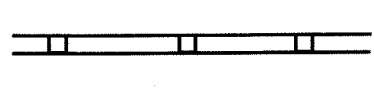

4" Double Solid Yellow with Type D
Raised Pavement Markers @ 20'-0" o.c.
(Thermoplastic)



4" Double Solid Yellow Stripes with Type H
Raised Pavement Markers @ 20'-0" o.c.
(Thermoplastic)



4" Yellow Edge Stripe with Type H Raised
Pavement Markers @ 40'-0" o.c.
(Thermoplastic)



4" Double Solid White Stripes with Type C
Raised Pavement Markers @ 20'-0" o.c.
(Thermoplastic)



Lane Change Restriction Marking
4 each Type A Raised Pavement Markers
Unless Noted Otherwise in The Plans
Type C Raised Pavement Markers @ 20'-0" o.c.
4" White Stripe (Thermoplastic)



4" or 8" White Edge Stripe with Type C Raised
Pavement Markers @ 40'-0" o.c. (Thermoplastic)



4" White Guide Lines (Thermoplastic)



Transverse Median Marking (Thermoplastic)

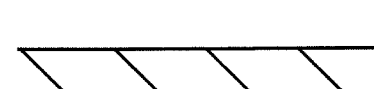

Transverse Shoulder Marking (Thermoplastic)

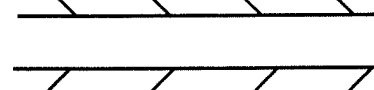

Channelizing Island or Deceleration Lane Gore
(Thermoplastic)



Crosswalk and Stop Line. All Stop Lines
shall be 10'-0" from Crosswalk unless
otherwise noted. The circled number
indicates the number of lanes for payment
(Thermoplastic)



Pavement Arrow (Thermoplastic)



Pavement Word (Thermoplastic)



4 Each Type J Raised Pavement Markers
Type D Raised Pavement Markers @ 40'-0" o.c.
Type H Raised Pavement Markers (Reflective
Surface facing no-passing direction)
4" Single Solid Yellow Stripe (Thermoplastic)



Extension of Edge Line, 4" Wide x 2'-0" Long White
Stripe @ 10'-0" o.c. w/Type C Markers @ 40'-0" o.c.
(Thermoplastic)



Reflector Marker (RM-2, White) w/steel post

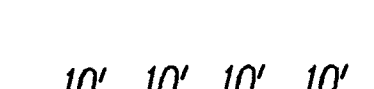

Reflector Marker (RM-2, White) w/flexible post

NOTES

- Layout of pavement markings and striping shall be done by the Contractor and approved by the Engineer prior to any installation work.
- Existing pavement markings not incorporated in the final traffic pattern shall be removed as directed by the Engineer. Costs shall be incidental to the various pavement marking items.
- Raised pavement markers shall not be installed within crosswalks.
- Final locations of all signs shall be approved by the Engineer prior to any installation work.
- Existing signs not shown on these plans shall remain as posted unless otherwise directed by the Engineer. Removal and disposal of existing signs and/or post as designated on these plans shall be incidental to the various signing items.
- Final locations of all Stop Lines shall be approved by the Engineer prior to installation.
- All pavement striping shall be as noted on the legend or plans.
- All preformed pavement marking tapes over existing pavement shall be applied with an approved primer as recommended by the tape manufacturer and as approved by the Engineer. The primer shall be allowed to dry to the tacky stage prior to tape application.
- The Contractor shall erect at the beginning of the project and at the end of the project advance construction warning signs placed as indicated on the plans or as directed by the Engineer for the duration of the highway project and shall be maintained by the Contractor. These signs shall be placed in addition to the required traffic control signs called for in Section 645 - Traffic Control. The advance construction warning signs shall be new and become the property of the State. The Contractor shall remove, clean, and deliver the signs and posts to the District Baseyard, or as directed by the Engineer, upon the completion of the project.

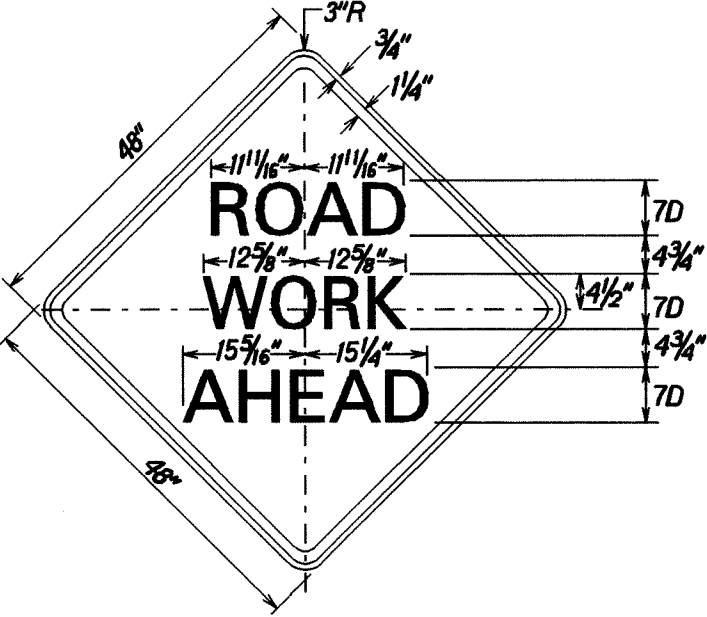

CW20-1A(d)
Scale: 1" = 1'-0"

Colors:
Legend: Black (Non Refl)
Background: Orange

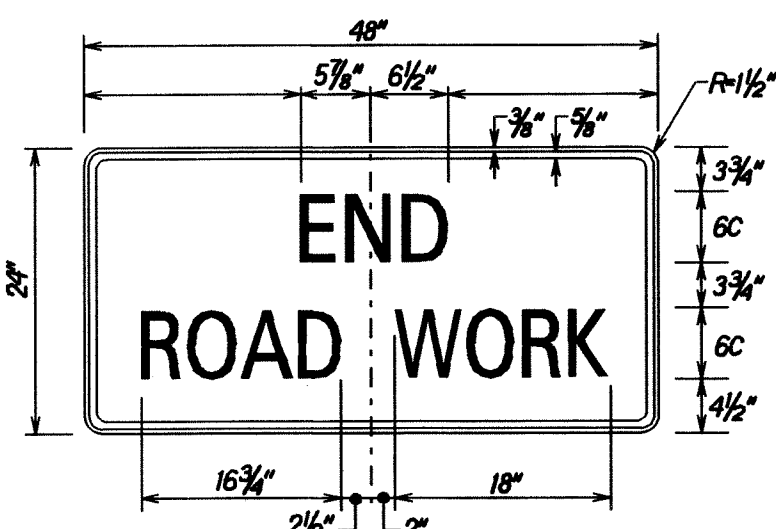

CG20-2A
Scale: 1 1/2" = 1'-0"

Colors:
Legend: Black (Non Refl)
Background: Orange

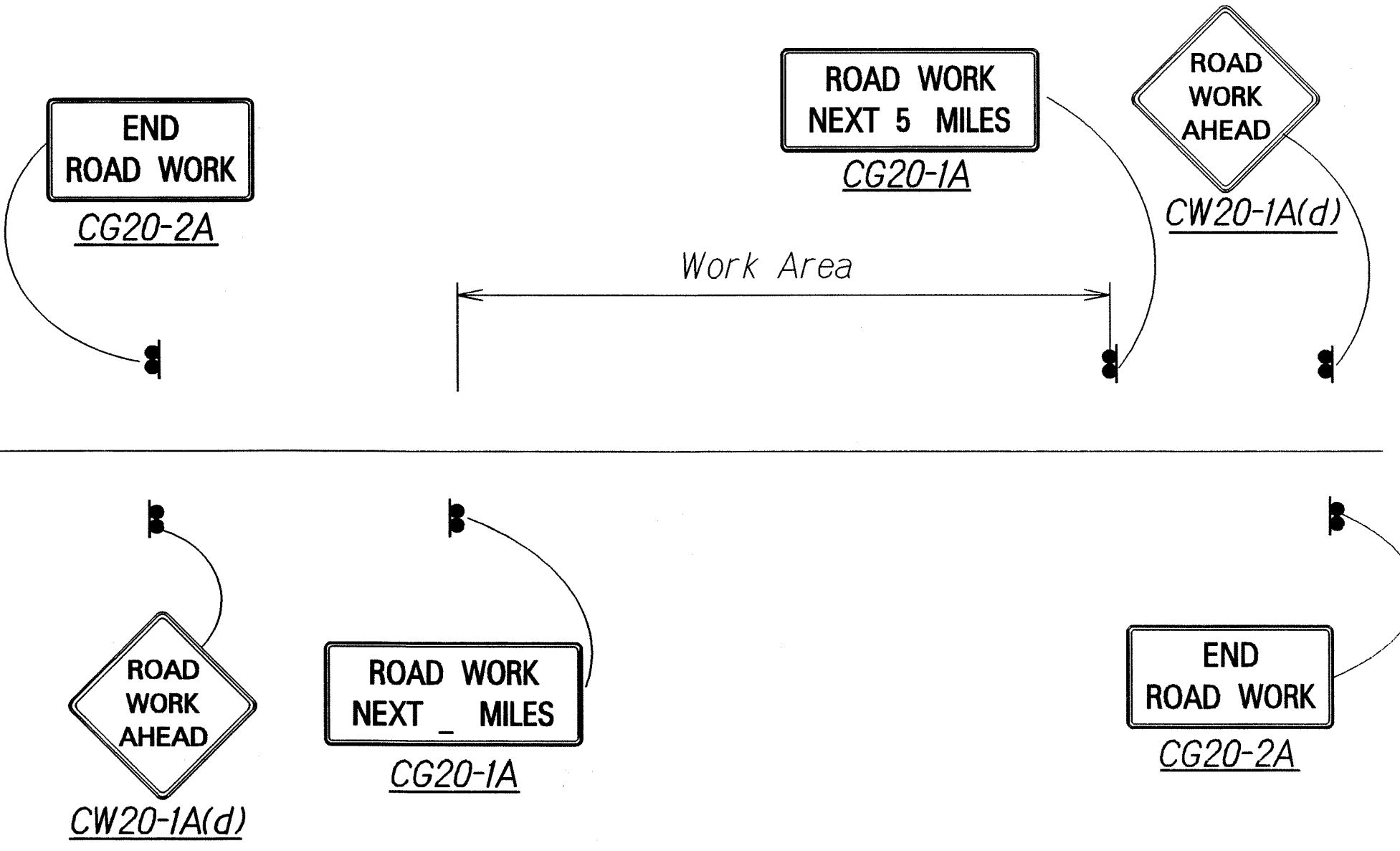

CONSTRUCTION SIGN LAYOUT DETAIL
Not to Scale

DESIGNED BY	DATE
NOTED BY	08/08
CHECKED BY	
ORIGINAL	
PLAN	
NOTE BOOK	
QUANTITIES BY	
CHECKED BY	

STATE OF HAWAII
DEPARTMENT OF TRANSPORTATION
HIGHWAYS DIVISION
PAVEMENT MARKING
LEGEND, DETAILS & NOTES
HANA HIGHWAY PAVEMENT
PREVENTIVE MAINTENANCE
Kaahumanu Avenue to Dairy Road
Federal-Aid Project No. NH-036-1(17)
Scale: As Noted Date: August, 2008
SHEET No. 1 OF 1 SHEETS