

FED. ROAD DIST. NO.	STATE	FED. AID PROJ. NO.	FISCAL YEAR	SHEET NO.	TOTAL SHEETS
HAWAII	HAW.	BR-036-1(15)	2000	20	89

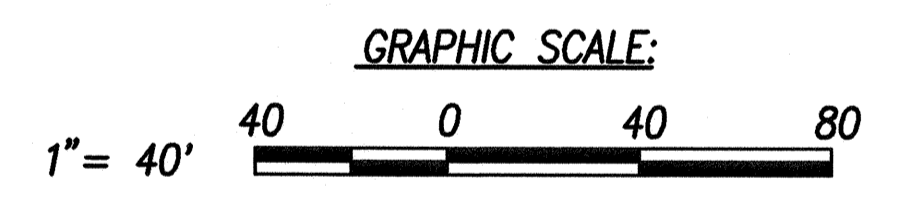

DATE	_____
DESIGNED BY	_____
DRAWN BY	_____
CHECKED BY	_____
QUANTITIES BY	_____
NOTE BOOK	_____
ORIGINAL PLAN	_____
SURVEY PLOTTED BY	_____

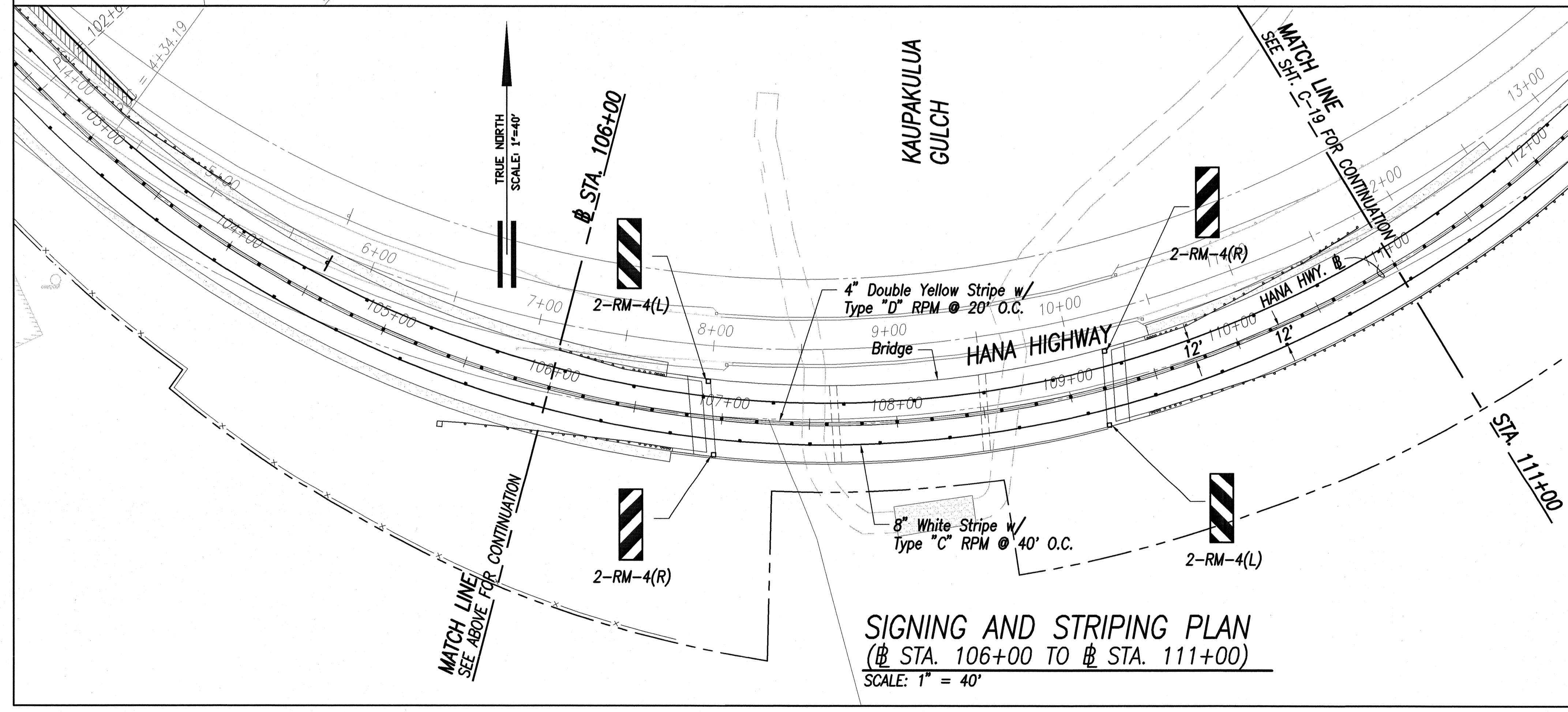
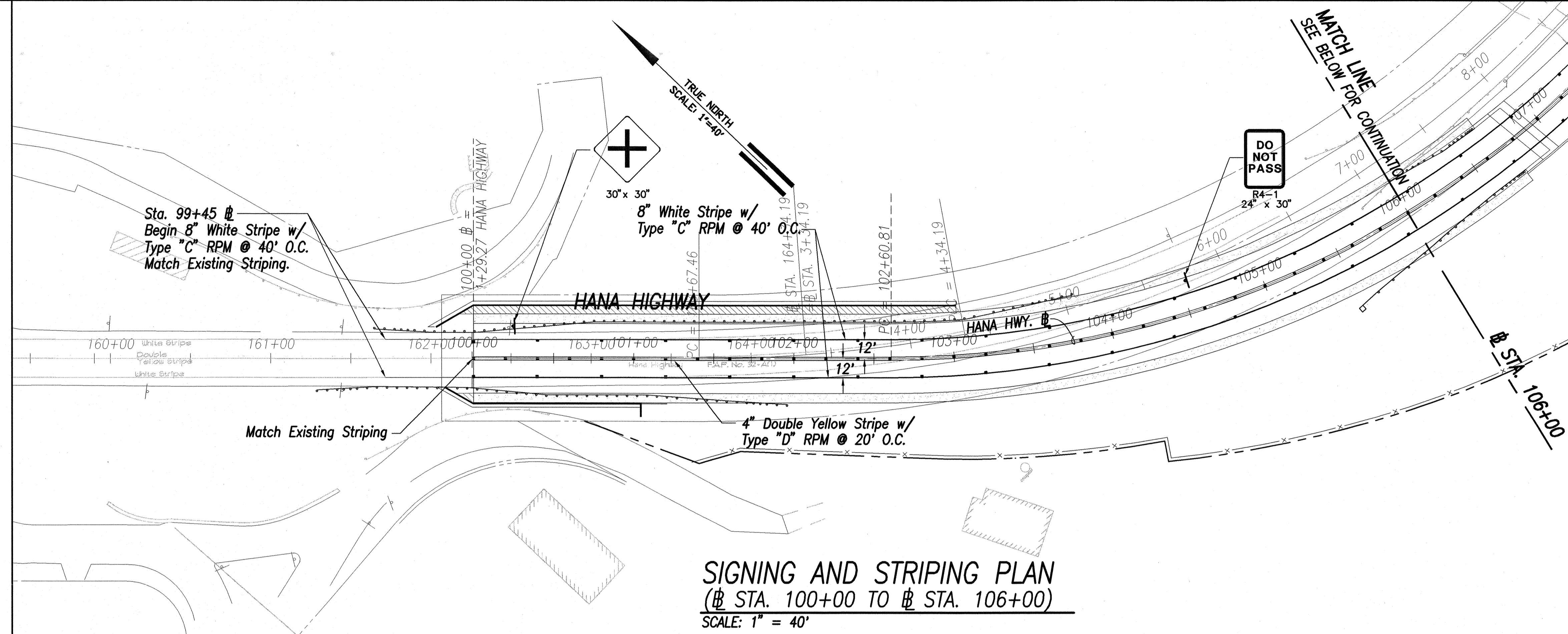
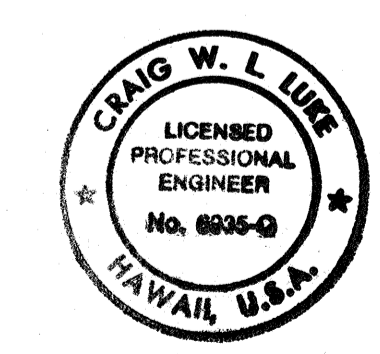

THIS WORK WAS PREPARED BY ME OR UNDER MY SUPERVISION.
 SIGNATURE: *[Signature]* DATE: 7/20/00

STATE OF HAWAII
 DEPARTMENT OF TRANSPORTATION
 HIGHWAYS DIVISION
SIGNING AND STRIPING PLAN
 (# STA. 100+00 TO # STA. 111+00)
 HANA HIGHWAY
 REPLACEMENT OF KAUPAKULUA BRIDGE
 AND APPROACHES
 F.A.P. Proj. No. BR-036-1(15)
 Scale: 1" = 40' Date: June 30, 2000
 SHEET No. C-18 OF 89 SHEETS

FED. ROAD DIST. NO.	STATE	FED. AID PROJ. NO.	FISCAL YEAR	SHEET NO.	TOTAL SHEETS
HAWAII	HAW.	BR-036-1(15)	2000	21	89

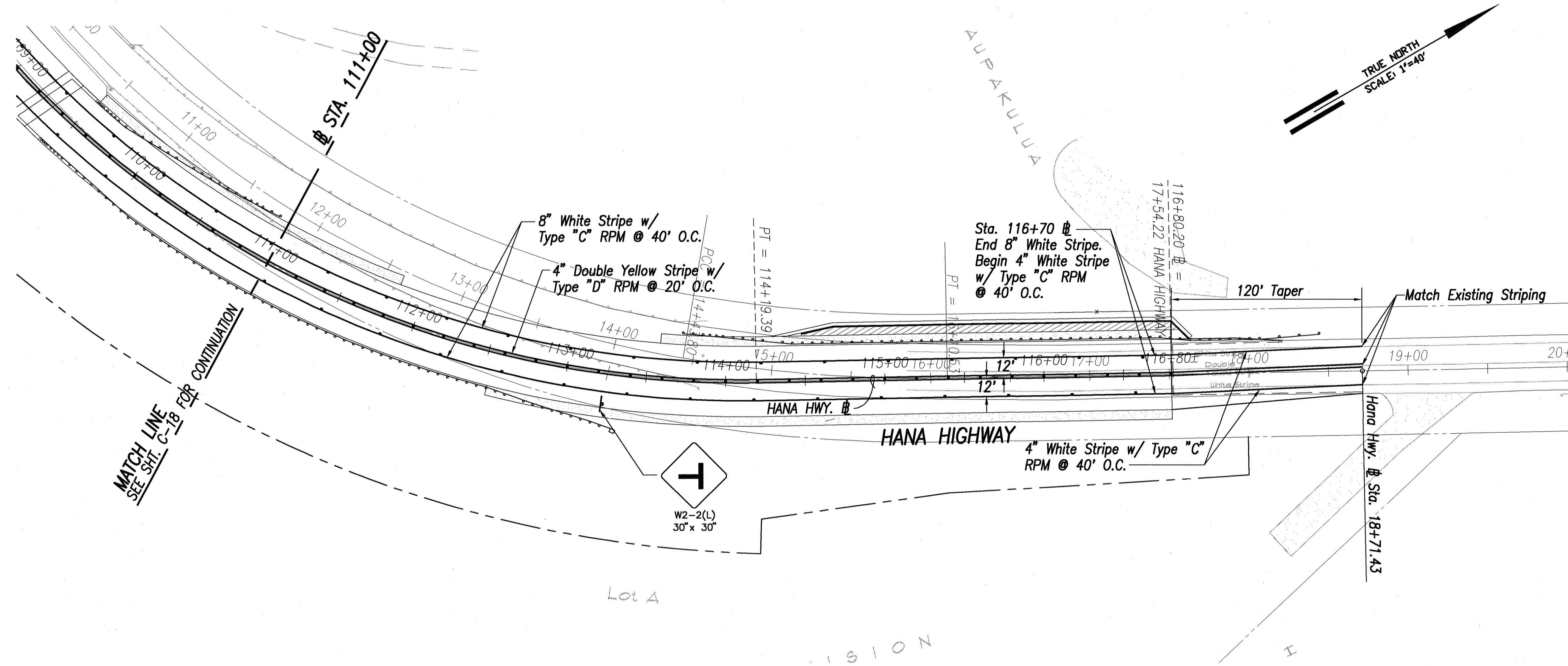

SIGNING AND STRIPING PLAN
 (Sta. 111+00 TO Sta. 116+80±)
 SCALE: 1" = 40'

DATE	_____
SURVEY PLOTTED BY	_____
DRAWN BY	_____
DESIGNED BY	_____
QUANTITIES BY	_____
CHECKED BY	_____
ORIGINAL PLAN	_____
NOTE BOOK	_____
No.	_____

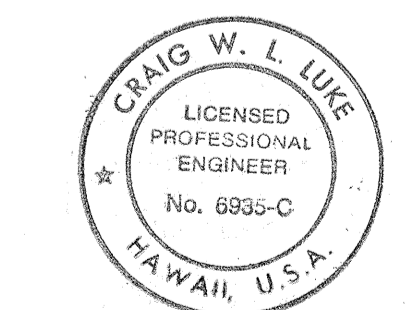
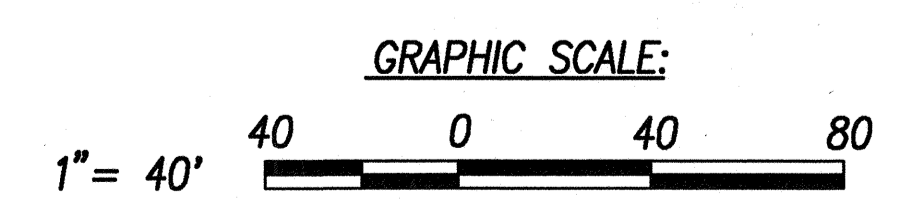

THIS WORK WAS PREPARED BY ME OR UNDER MY SUPERVISION.
 SIGNATURE: *[Signature]* DATE: 7/20/00

STATE OF HAWAII
 DEPARTMENT OF TRANSPORTATION
 HIGHWAYS DIVISION
SIGNING AND STRIPING PLAN
 (Sta. 111+00 TO Sta. 116+80.20)
 HANA HIGHWAY
 REPLACEMENT OF KAUPAKULUA BRIDGE
 AND APPROACHES
 F.A.P. Proj. No. BR-036-1(15)
 Scale: 1" = 40' Date: June 30, 2000
 SHEET No. C-19 OF 89 SHEETS