

INDEX TO DRAWINGS	
SHEET NO.	DESCRIPTION
1	TITLE SHEET
2	STANDARD PLANS SUMMARY
3	GENERAL NOTES & LEGEND
4	TYPICAL SECTIONS
5	TYPICAL DETAILS
6	PLAN
7	DRAINAGE DETAILS
8	PAVEMENT MARKING LEGEND, DETAILS AND NOTES
9	PAVEMENT MARKING & SIGNING PLAN
10	LOOP DETECTOR DETAILS
11	MISCELLANEOUS TRAFFIC SUMMARIES

STATE OF HAWAII

DEPARTMENT OF TRANSPORTATION

HIGHWAYS DIVISION

HONOLULU, HAWAII

"AS-BUILT"

PLANS FOR

HANA HIGHWAY RESURFACING

PAIA TOWN SECTION

PROJECT NO. 36AB-01-95M

DISTRICT OF MAKAWAO

ISLAND OF MAUI

FED. ROAD DIST. NO.	STATE	PROJ. NO.	FISCAL YEAR	SHEET NO.	TOTAL SHEETS
HAWAII	HAW.	36AB-01-95M	1995	1	11

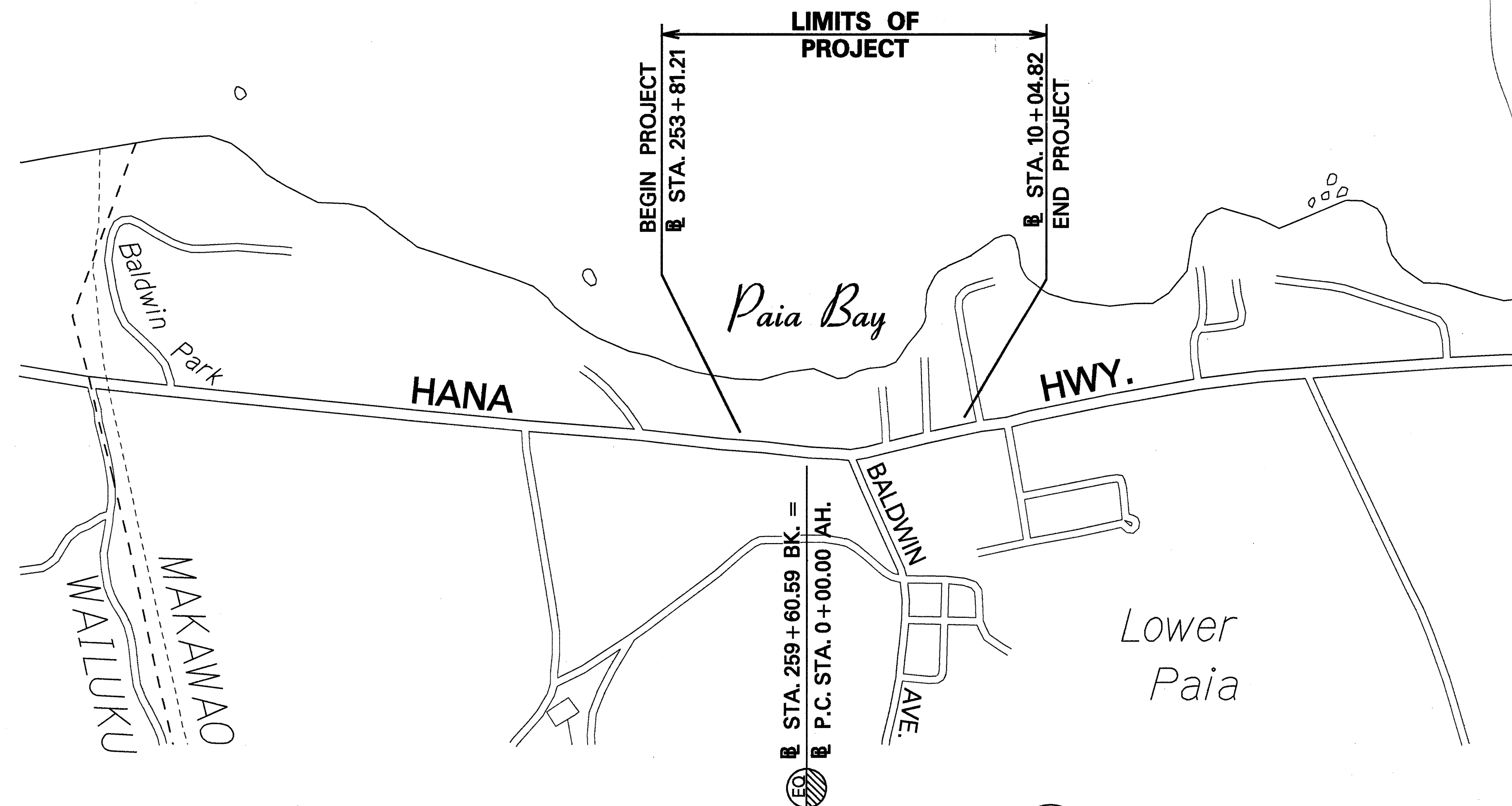
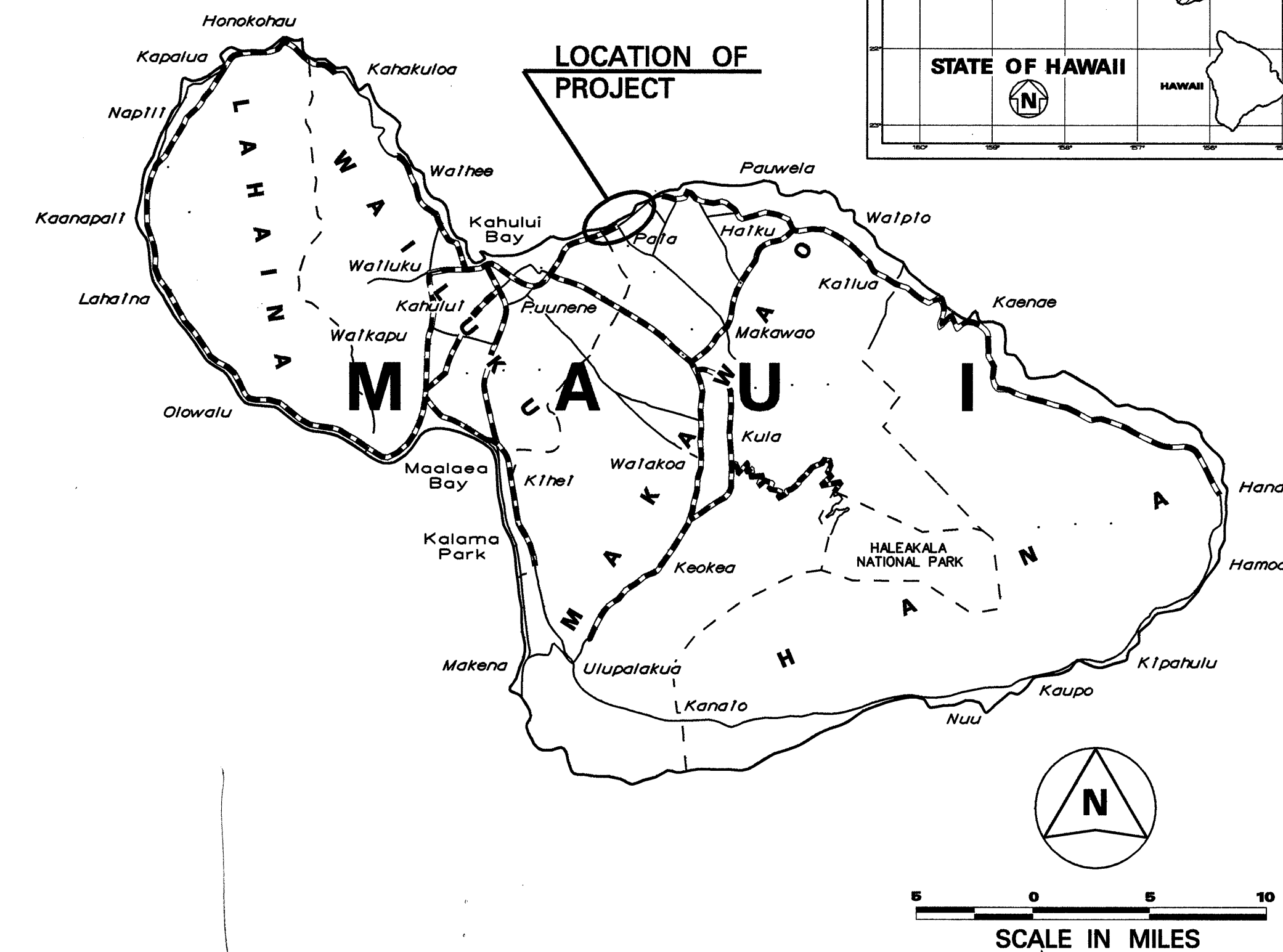
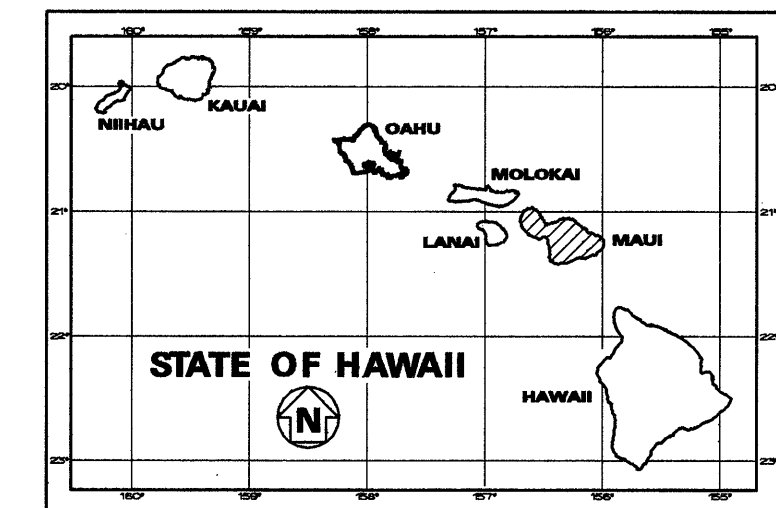

FEDERAL AID PROJECTS PREVIOUSLY CONSTRUCTED OR UNDER CONSTRUCTION

MILE POST 6.53 TO MILE POST 6.83

CHANGES MADE DURING CONSTRUCTION HAVE BEEN INCORPORATED ON THESE PLANS EXCEPT CHANGES IN THE ORIGINAL THEORETICAL QUANTITIES. FOR ACTUAL QUANTITIES, REFER TO PROJECT LEDGER AND/OR COMPUTATION BOOK.

RESIDENT ENGINEER

DATE

DEPARTMENT OF TRANSPORTATION STATE OF HAWAII	
APPROVED:	6/5/95
DIR. OF TRANSPORTATION	DATE

UNIT "A" DESIGNED BY JULIUS B. FRONDA P. S. & E. BY MAY, 1995 DATE 587-2246 PHONE

LAYOUT PLAN
NET LENGTH OF PROJECT..... 0.30 MILE