

FED. ROAD DIST. NO.	STATE	FED. AID PROJ. NO.	FISCAL YEAR	SHEET NO.	TOTAL SHEETS
HAWAII	HAW.	FAU MG-0900(16)	1982	3	32

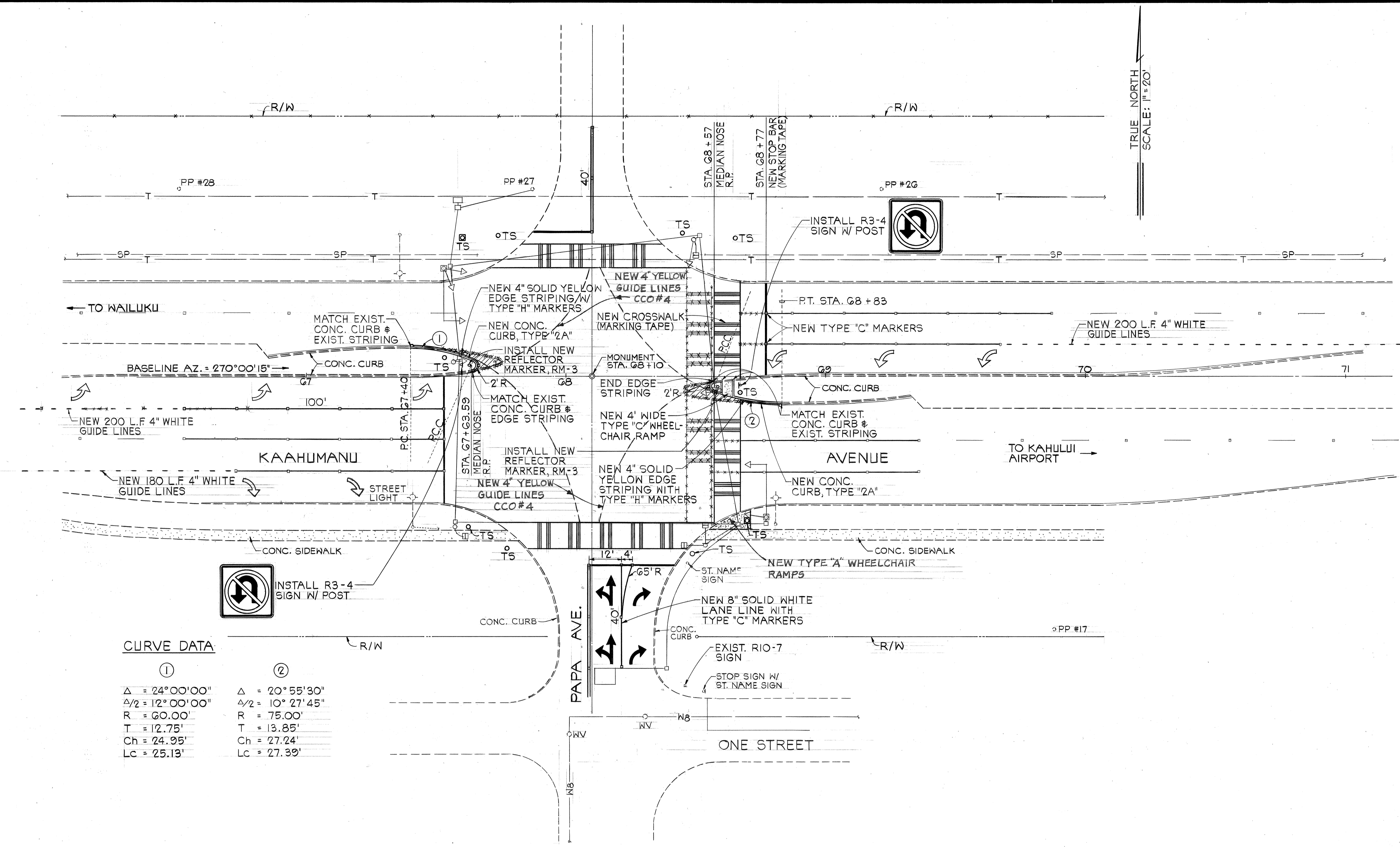

CURVE DATA

①	②
$\Delta = 24^{\circ}00'00''$	$\Delta = 20^{\circ}55'30''$
$\Delta/2 = 12^{\circ}00'00''$	$\Delta/2 = 10^{\circ}27'45''$
$R = 60.00'$	$R = 75.00'$
$T = 12.75'$	$T = 13.85'$
$Ch = 24.95'$	$Ch = 27.24'$
$Lc = 25.13'$	$Lc = 27.39'$

ORIGINAL PLAN	DATE
DESIGNED BY	
TRACED BY	
NOTE BOOK	
DESIGNED BY	
QUANTITIES BY	
CHECKED BY	
No.	



THIS WORK WAS PREPARED BY ME OR UNDER MY SUPERVISION
Theodore S. Kawahara
 Signature

STATE OF HAWAII
 DEPARTMENT OF TRANSPORTATION
 HIGHWAYS DIVISION
**GEOMETRICS, STRIPING
 AND SIGNING PLAN**
 (PAPA AVENUE)
**KAAHUMANU AVENUE
 TRAFFIC SIGNAL
 IMPROVEMENTS**
 FAU PROJECT NO. MG-0900(16)
 SCALE: AS SHOWN DATE: 4-27-82
SHEET NO. 1 OF 6 SHEETS

FED. ROAD DIST. NO.	STATE	FED. AID PROJ. NO.	FISCAL YEAR	SHEET NO.	TOTAL SHEETS
HAWAII	HAW.	FAU MG-0900(IG)	1982	4	32

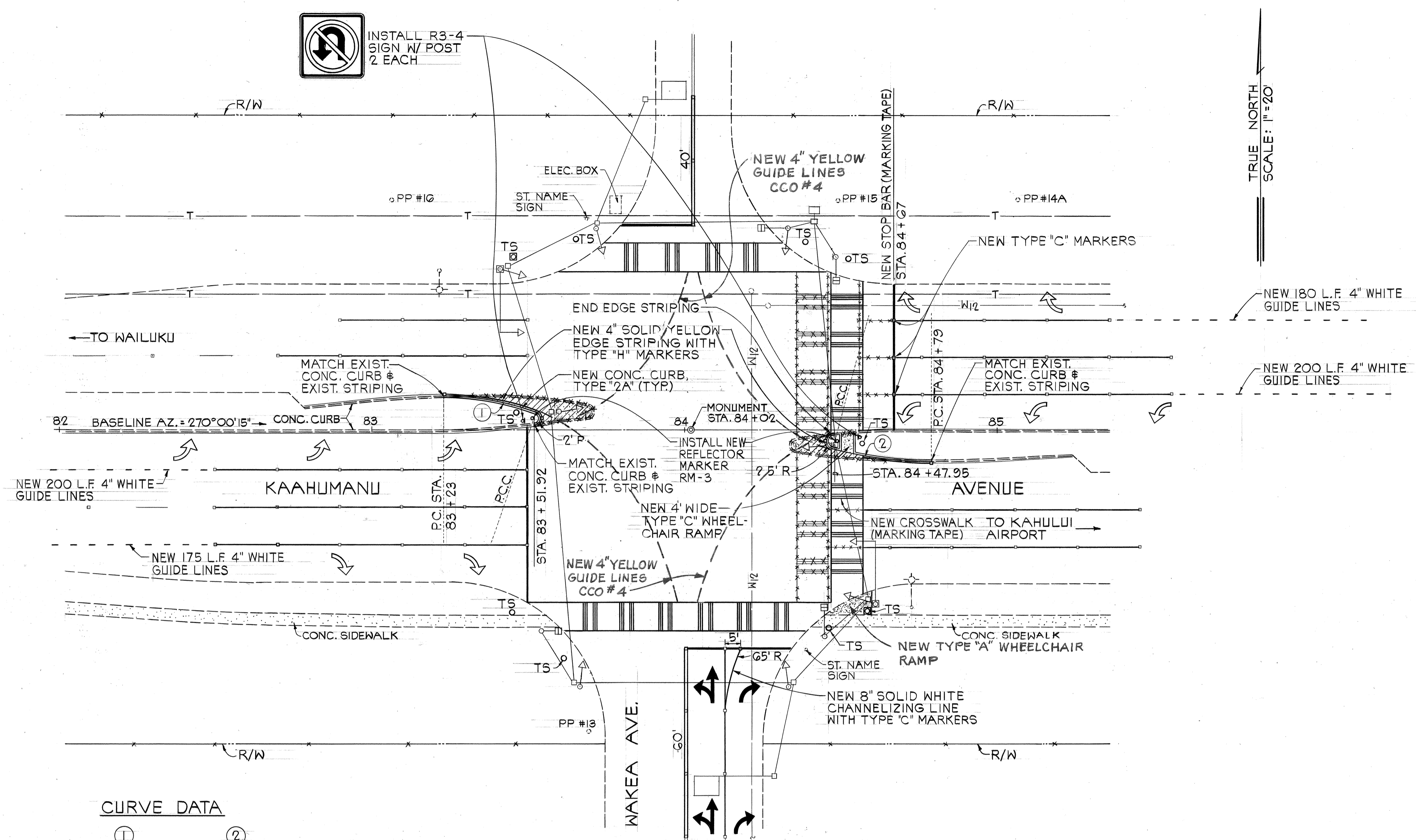

CURVE DATA

①	②
$\Delta = 19^{\circ}11'17''$	$15^{\circ}10'28''$
$\Delta/2 = 9^{\circ}35'38.5''$	$7^{\circ}39'44''$
$R = 90.00'$	$120.00'$
$T = 15.21'$	$10.14'$
$Ch = 30.00'$	$32.00'$
$Lc = 30.14'$	$32.10'$

ORIGINAL PLAN	DATE
DESIGNED BY	
TRACED BY	
NOTE BOOK	
QUANTITIES BY	
CHECKED BY	

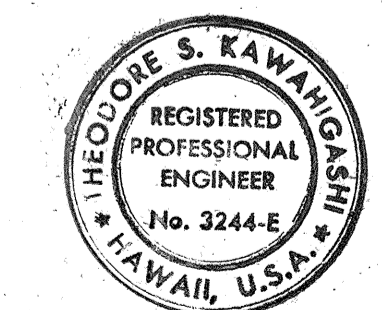

THIS WORK WAS PREPARED BY ME OR UNDER MY SUPERVISION

Theodore S. Kawahigashi
Signature

STATE OF HAWAII
DEPARTMENT OF TRANSPORTATION
HIGHWAYS DIVISION

GEOMETRICS, STRIPING AND SIGNING PLAN
(WAKEA AVENUE)

KAAHUMANU AVENUE
TRAFFIC SIGNAL IMPROVEMENTS

FAU PROJECT NO. MG-0900(IG)
SCALE: AS SHOWN DATE: 4-27-82

SHEET No. 2 OF 6 SHEETS

FED. ROAD DIST. NO.	STATE	FED. AID PROJ. NO.	FISCAL YEAR	SHEET NO.	TOTAL SHEETS
HAWAII	HAW.	FAU MG-0900(16)	1982	7	32

TRUE NORTH
SCALE: 1" = 20'

* CONSTRUCTING CONCRETE SIDEWALK ADJACENT TO WHEELCHAIR RAMPS SHALL BE CONSIDERED INCIDENTAL TO THE RESPECTIVE RAMPS.

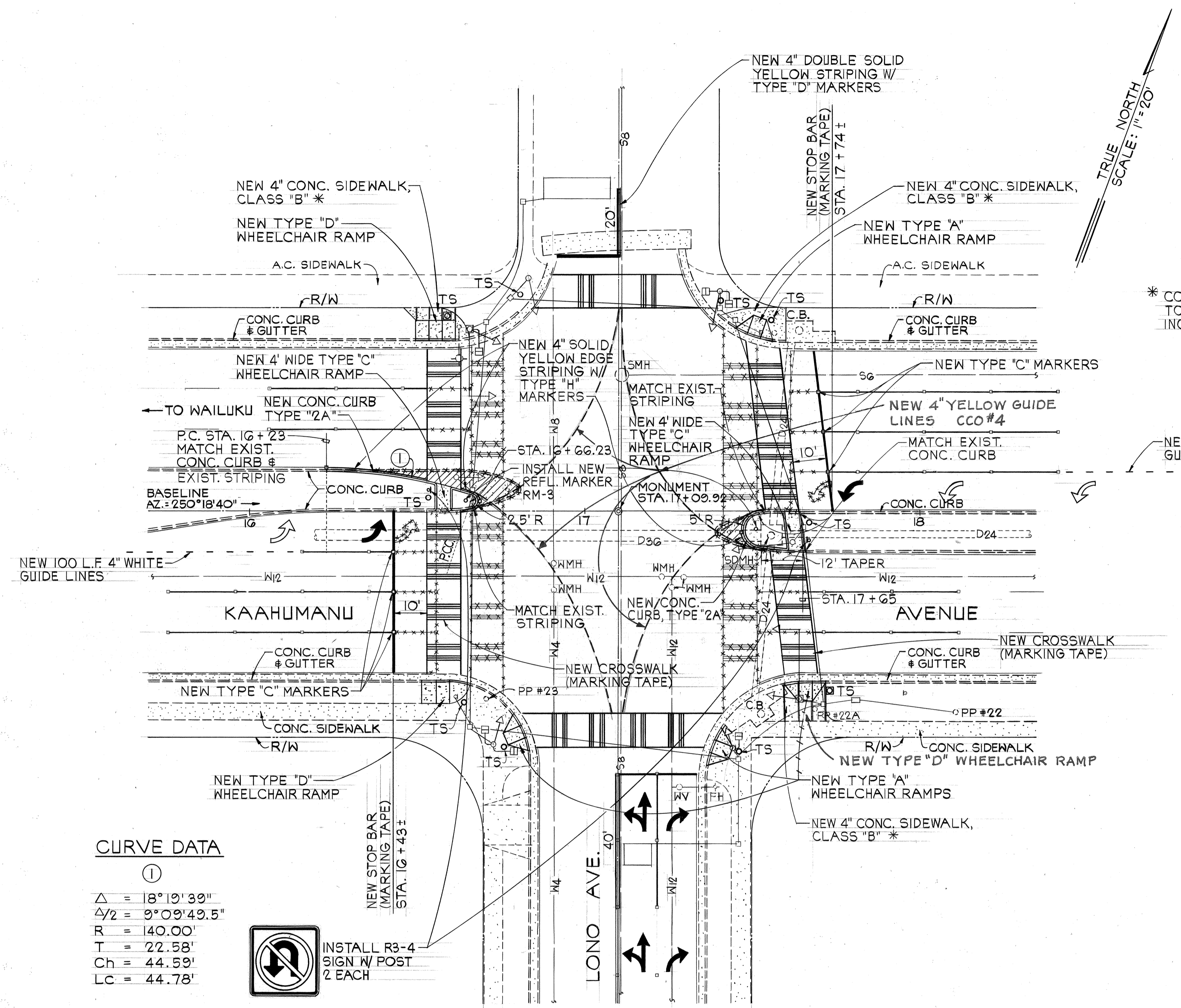

CURVE DATA

①
 $\Delta = 18^{\circ}19'30''$
 $\Delta/2 = 9^{\circ}09'49.5''$
 $R = 140.00'$
 $T = 22.58'$
 $Ch = 44.59'$
 $Lc = 44.78'$

INSTALL R3-4 SIGN W/ POST 2 EACH

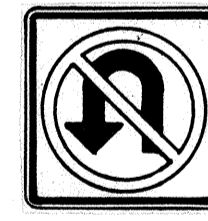

ORIGINAL PLAN	DATE
SURVEY PLOTTED BY	
DESIGNED BY	
TRACED BY	
NOTE BOOK	
QUANTITIES BY	
CHECKED BY	
No.	

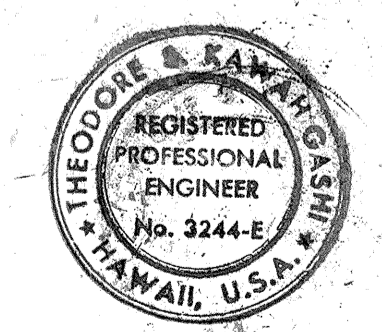

THIS WORK WAS PREPARED BY AND UNDER MY SUPERVISION
Theodore S. Kawahigashi

STATE OF HAWAII
DEPARTMENT OF TRANSPORTATION
HIGHWAYS DIVISION

GEOMETRICS, STRIPING AND SIGNING PLAN
(LONO AVENUE)

KAAHUMANU AVENUE TRAFFIC SIGNAL IMPROVEMENTS

FAU PROJECT NO. MG-0900(16)
SCALE: AS SHOWN DATE: 4-27-82

SHEET No. 5 OF 6 SHEETS

FED. ROAD DIST. NO.	STATE	FED. AID PROJ. NO.	FISCAL YEAR	SHEET NO.	TOTAL SHEETS
HAWAII	HAW.	FAU MG-0900(16)	1982	8	32

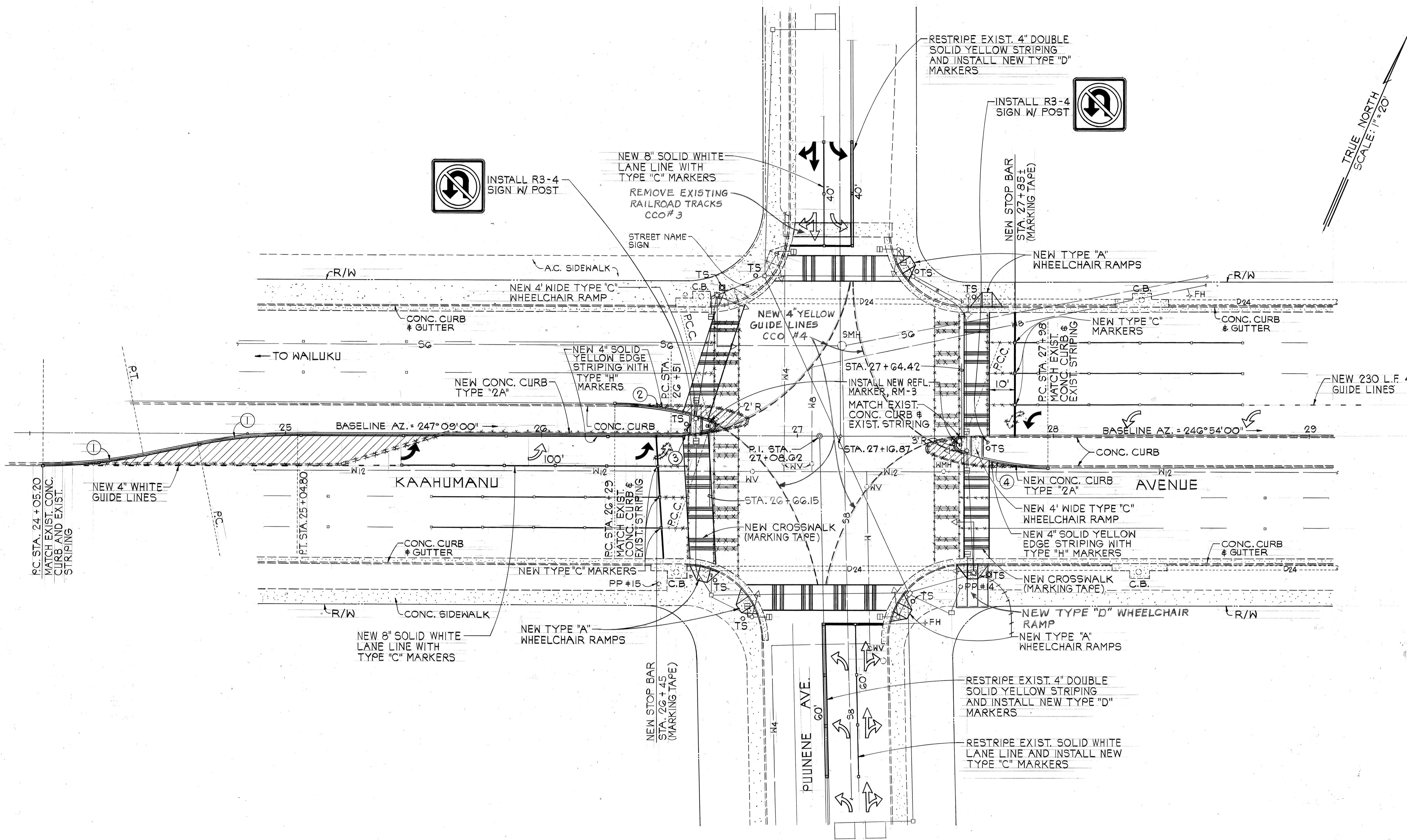

DATE	_____
DESIGNED BY	_____
CHECKED BY	_____
NO.	_____

CURVE DATA						
NO.	Δ	$\Delta/2$	R	T	Ch	Lc
①	11° 18' 36"	5° 39' 18"	200.00'	19.80'	39.42'	39.48'
②	18° 20' 53"	9° 10' 29.5"	120.00'	19.38'	38.27'	38.43'
③	15° 05' 25"	7° 32' 42.5"	60.00'	7.95'	15.76'	15.80'
④	20° 15' 28"	10° 07' 44"	100.00'	17.86'	35.17'	35.36'

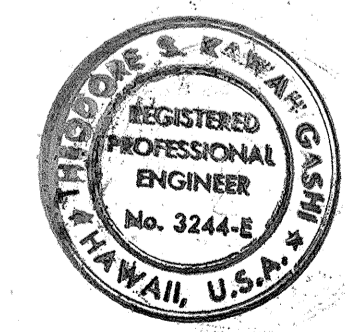

THIS WORK WAS PREPARED BY ME OR UNDER MY SUPERVISION
Shirley S. Kawahara
 Signature

STATE OF HAWAII
 DEPARTMENT OF TRANSPORTATION
 HIGHWAYS DIVISION

GEOMETRICS, STRIPING AND SIGNING PLAN
 (PUUNENE AVENUE)

KAAHUMANU AVENUE TRAFFIC SIGNAL IMPROVEMENTS

FAU PROJECT NO. MG-0900(16)
 SCALE: AS SHOWN DATE: 4-27-82

SHEET NO. 6 OF 6 SHEETS