

FED. ROAD DIST. NO.	STATE	FED. AID PROJ. NO.	FISCAL YEAR	SHEET NO.	TOTAL SHEETS
HAWAII	HAW.	STP-030-1(058)R	2023	31	40

SURVEY PLOTTED BY	DATE
DRAWN BY	3/23
DESIGNED BY	
QUANTITIES BY	
CHECKED BY	
ORIGINAL PLAN	
NOTE BOOK	
me:lay	
honoapiilani	

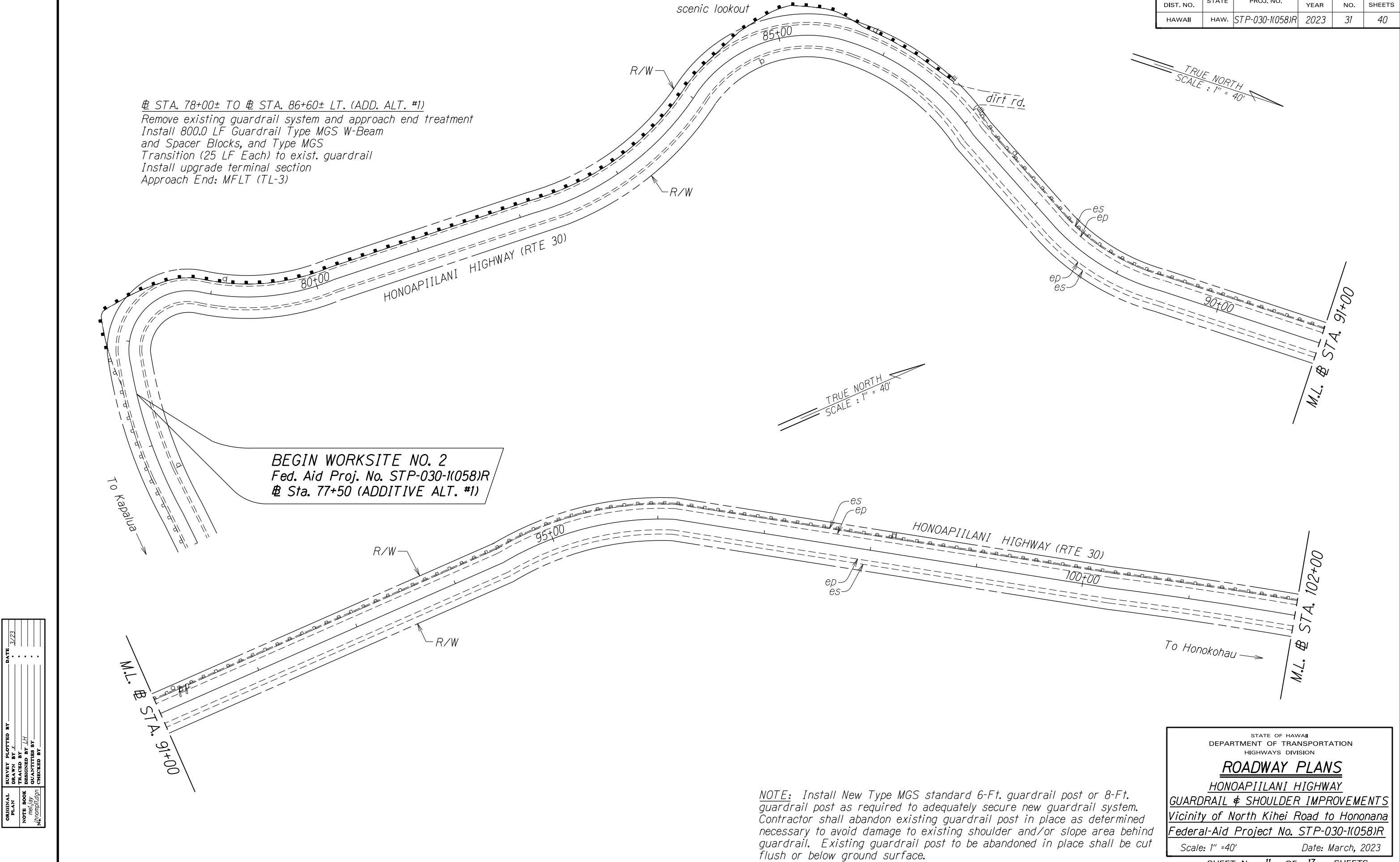

FED. ROAD DIST. NO.	STATE	FED. AID PROJ. NO.	FISCAL YEAR	SHEET NO.	TOTAL SHEETS
HAWAII	HAW.	STP-030-1(058)R	2023	32	40

ORIGINAL PLAN	SURVEY PLOTTED BY	DATE
NOTE BOOK	DRAWN BY	3/23
me/lay	DESIGNED BY	
me/lay	QUANTITIES BY	
me/lay	CHECKED BY	

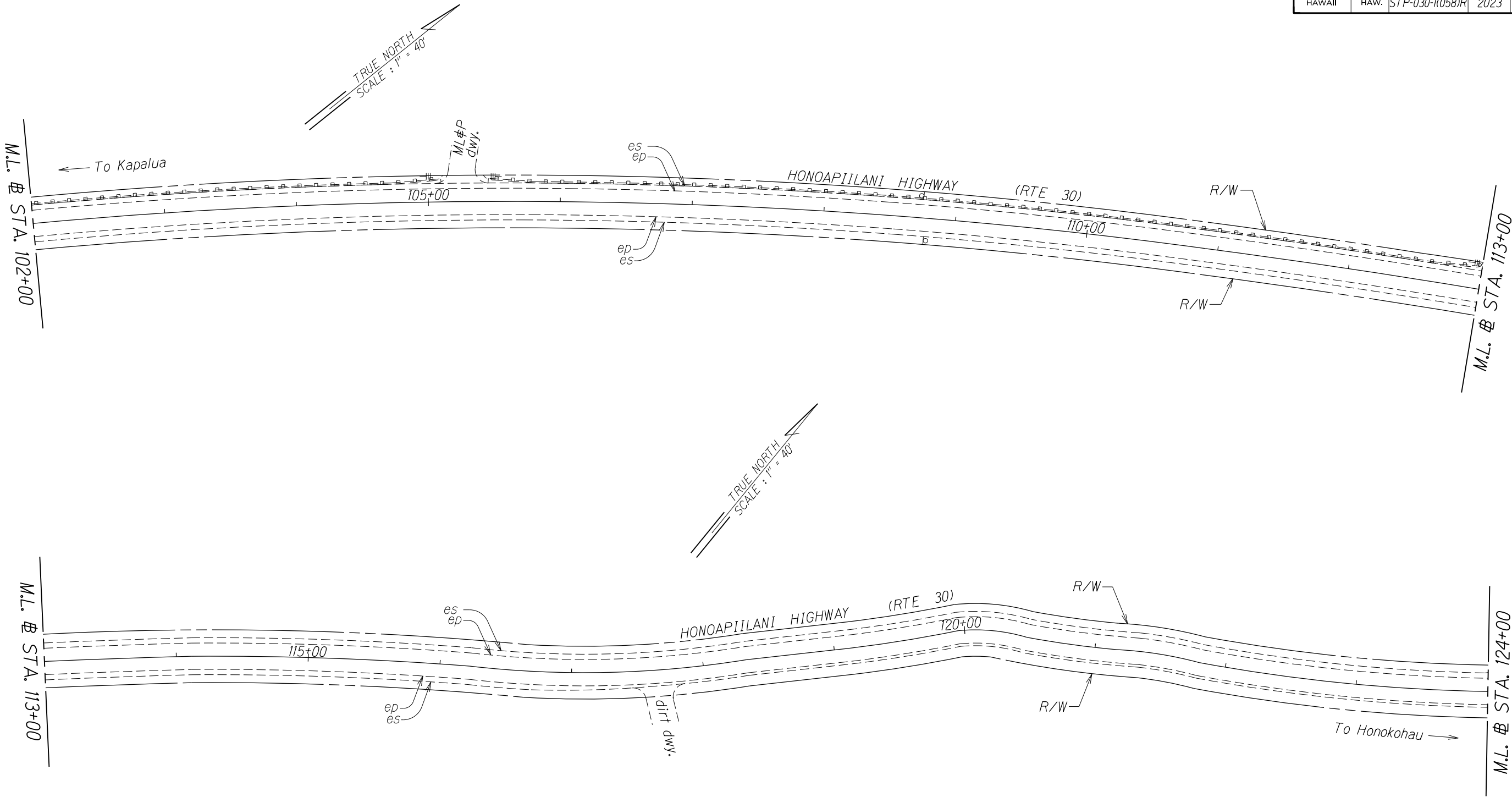

STATE OF HAWAII
DEPARTMENT OF TRANSPORTATION
HIGHWAYS DIVISION

ROADWAY PLANS

HONOAPIILANI HIGHWAY

GUARDRAIL & SHOULDER IMPROVEMENTS

Vicinity of North Kihei Road to Hononana

Federal-Aid Project No. STP-030-1(058)R

Scale: 1" = 40' Date: March, 2023

SHEET No. 12 OF 17 SHEETS

FED. ROAD DIST. NO.	STATE	FED. AID PROJ. NO.	FISCAL YEAR	SHEET NO.	TOTAL SHEETS
HAWAII	HAW.	STP-030-1(058)R	2023	34	40

± STA. 146+80± TO ± STA. 154+50± LT. (ADD. ALT. #1)
Remove existing guardrail system and end treatments
Install 712.50 LF Guardrail Type MGS W-Beam and Spacer Blocks
Install upgrade terminal sections
Approach End: MFLT (TL-3)
Trailing End: Trailing-End Anchor System

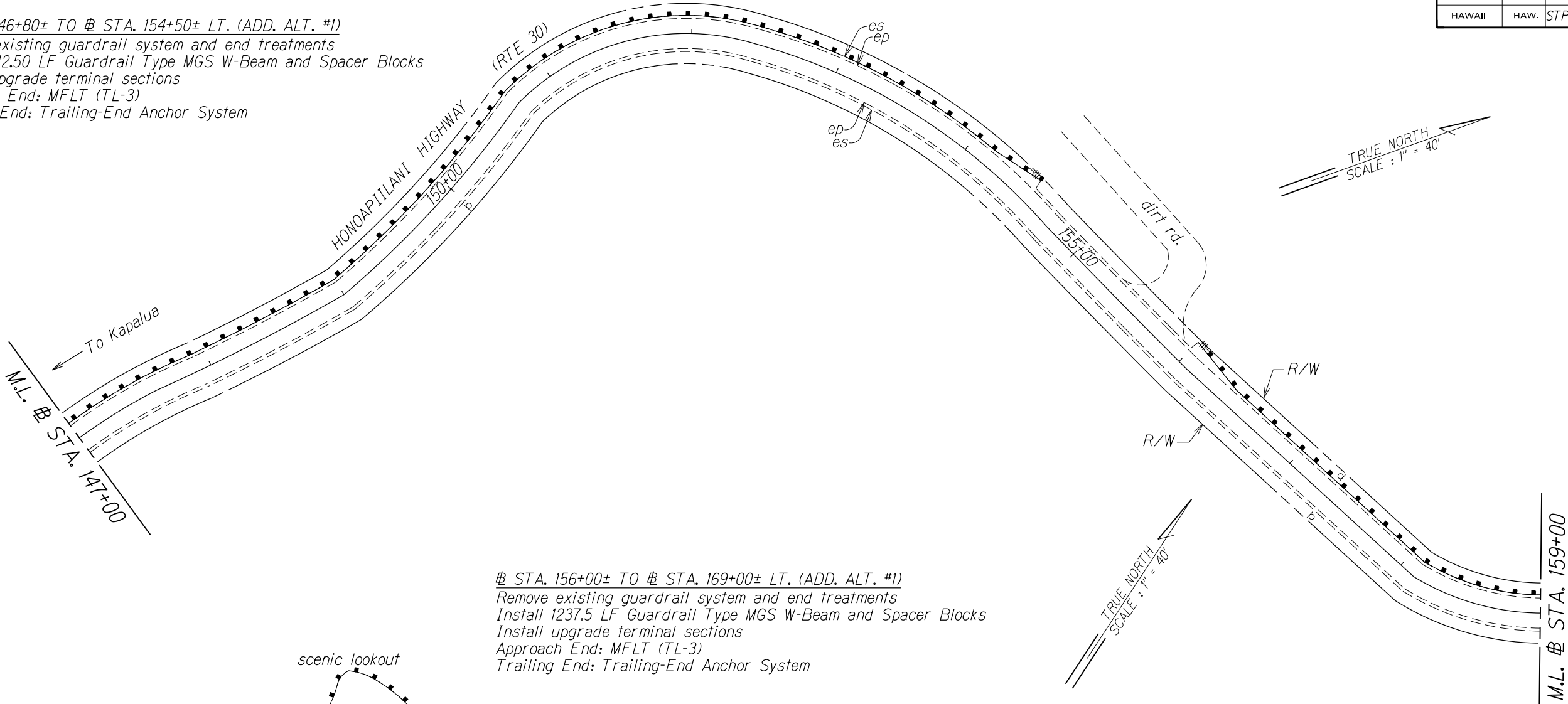

± STA. 156+00± TO ± STA. 169+00± LT. (ADD. ALT. #1)
Remove existing guardrail system and end treatments
Install 1237.5 LF Guardrail Type MGS W-Beam and Spacer Blocks
Install upgrade terminal sections
Approach End: MFLT (TL-3)
Trailing End: Trailing-End Anchor System

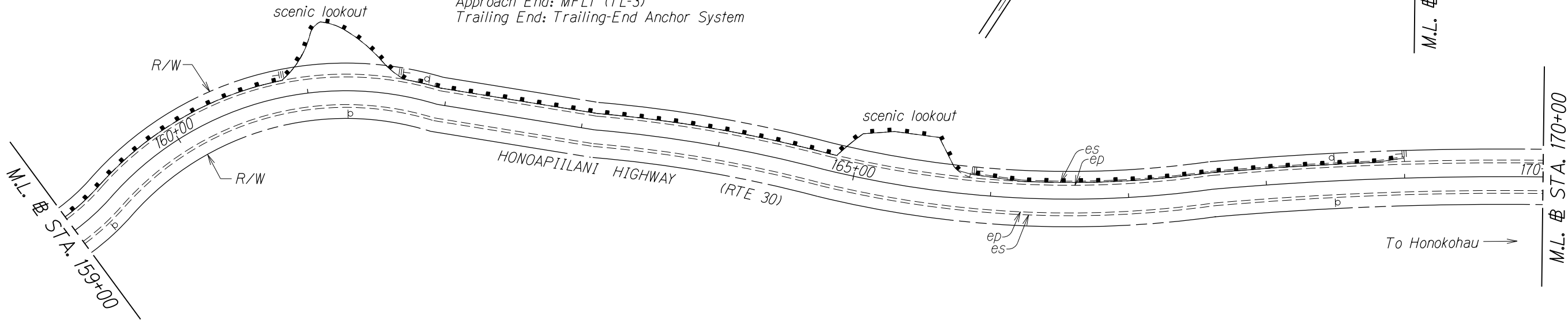

NOTE: Install New Type MGS standard 6-Ft. guardrail post or 8-Ft. guardrail post as required to adequately secure new guardrail system. Contractor shall abandon existing guardrail post in place as determined necessary to avoid damage to existing shoulder and/or slope area behind guardrail. Existing guardrail post to be abandoned in place shall be cut flush or below ground surface.

STATE OF HAWAII
DEPARTMENT OF TRANSPORTATION
HIGHWAYS DIVISION

ROADWAY PLANS

HONOAPIILANI HIGHWAY

GUARDRAIL & SHOULDER IMPROVEMENTS

Vicinity of North Kihei Road to Hononana

Federal-Aid Project No. STP-030-1(058)R

Scale: 1" = 40' Date: March, 2023

SHEET No. 14 OF 17 SHEETS

FED. ROAD DIST. NO.	STATE	FED. AID PROJ. NO.	FISCAL YEAR	SHEET NO.	TOTAL SHEETS
HAWAII	HAW.	STP-030-1(058)R	2023	36	40

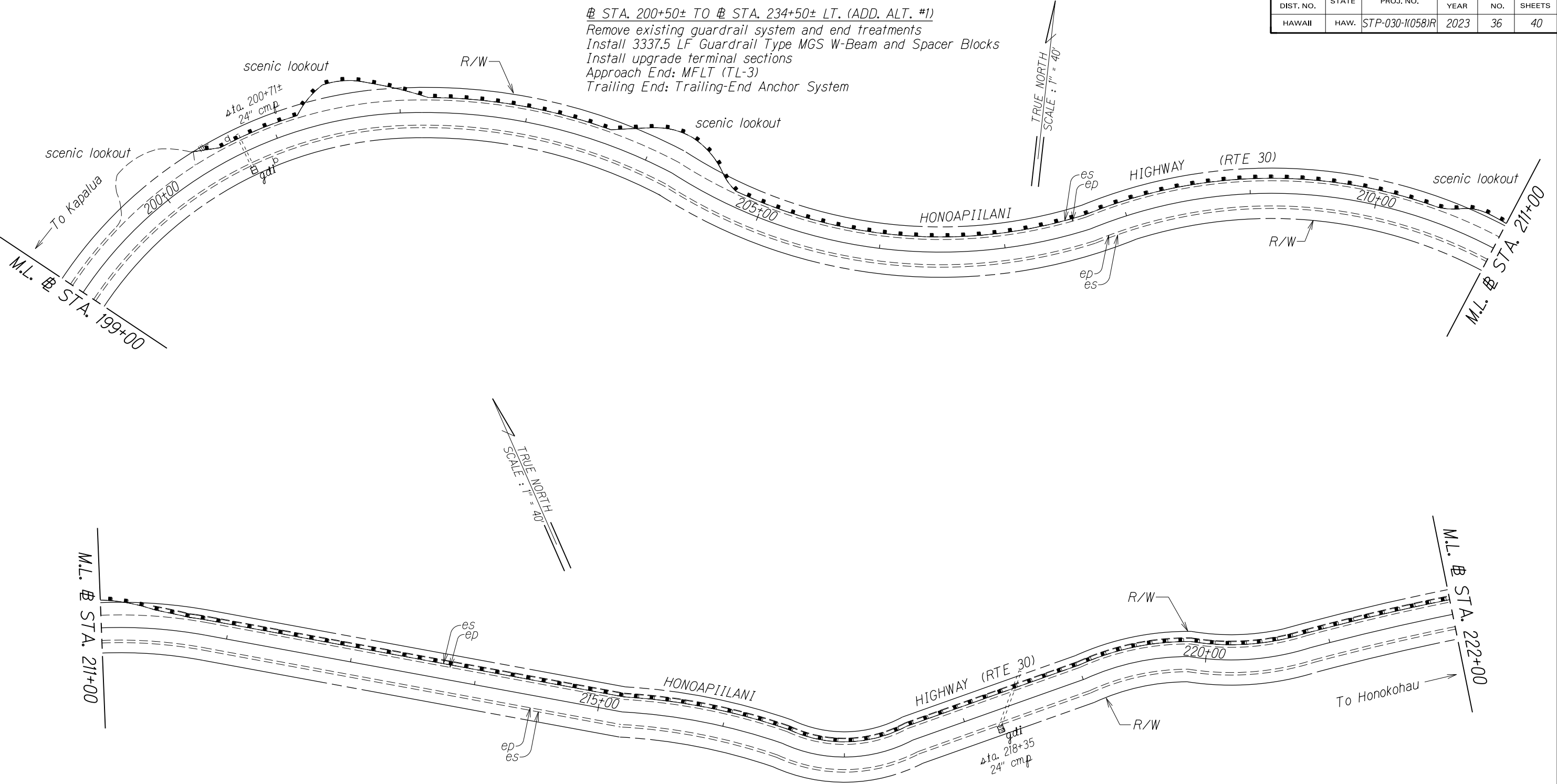

NOTE: Install New Type MGS standard 6-Ft. guardrail post or 8-Ft. guardrail post as required to adequately secure new guardrail system. Contractor shall abandon existing guardrail post in place as determined necessary to avoid damage to existing shoulder and/or slope area behind guardrail. Existing guardrail post to be abandoned in place shall be cut flush or below ground surface.

STATE OF HAWAII
DEPARTMENT OF TRANSPORTATION
HIGHWAYS DIVISION
ROADWAY PLANS
HONOAPIILANI HIGHWAY
GUARDRAIL & SHOULDER IMPROVEMENTS
Vicinity of North Kihei Road to Hononana
Federal-Aid Project No. STP-030-1(058)R
Scale: 1" = 40' Date: March, 2023
SHEET No. 16 OF 17 SHEETS

ORIGINAL PLAN	SURVEY PLOTTED BY	DATE
me/lay		3/23
me/lay	DRAWN BY	
me/lay	DESIGNED BY	
me/lay	QUANTITIES BY	
me/lay	CHECKED BY	

FED. ROAD DIST. NO.	STATE	FED. AID PROJ. NO.	FISCAL YEAR	SHEET NO.	TOTAL SHEETS
HAWAII	HAW.	STP-030-1(058)R	2023	37	40

STA. 200+50± TO # STA. 234+50± LT. (ADD. ALT. #1)

Remove existing guardrail system and end treatments
Install 3337.5 LF Guardrail Type MGS W-Beam and Spacer Blocks
Install upgrade terminal sections
Approach End: MFLT (TL-3)
Trailing End: Trailing-End Anchor System

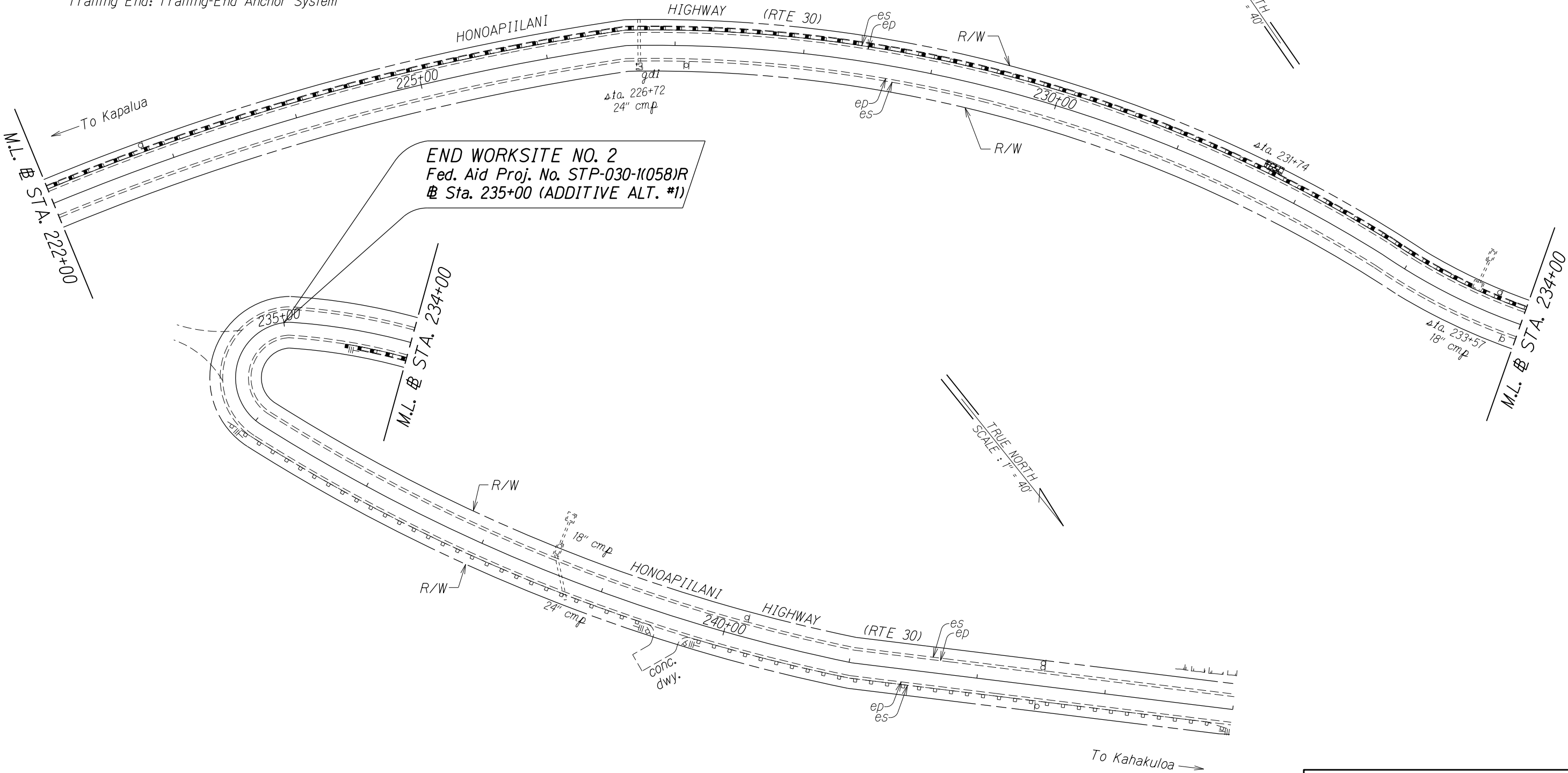

NOTE: Install New Type MGS standard 6-Ft. guardrail post or 8-Ft. guardrail post as required to adequately secure new guardrail system. Contractor shall abandon existing guardrail post in place as determined necessary to avoid damage to existing shoulder and/or slope area behind guardrail. Existing guardrail post to be abandoned in place shall be cut flush or below ground surface.

STATE OF HAWAII
DEPARTMENT OF TRANSPORTATION
HIGHWAYS DIVISION

ROADWAY PLANS

HONOAPIILANI HIGHWAY

GUARDRAIL & SHOULDER IMPROVEMENTS

Vicinity of North Kihei Road to Hononana

Federal-Aid Project No. STP-030-1(058)R

Scale: 1" = 40'

Date: March, 2023

SHEET No. 17 OF 17 SHEETS