

FED. ROAD DIST. NO.	STATE	PROJ. NO.	FISCAL YEAR	SHEET NO.	TOTAL SHEETS
HAWAII	HAW.	30A-01-07M	2007	23	28

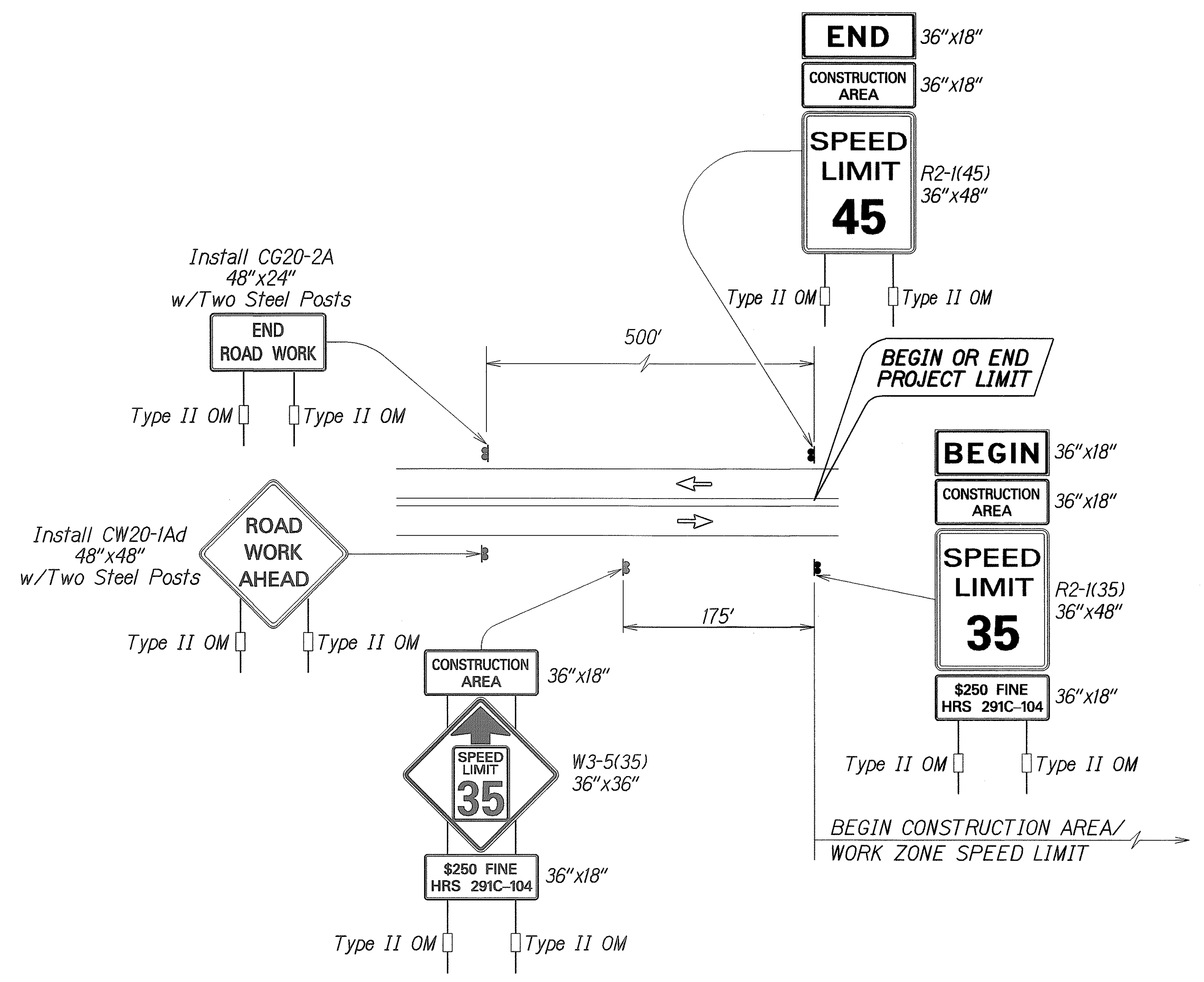

Work Zone Note:

1. This Work Zone Sign Plan is intended for use on long-term stationary work zones/construction phases (3 days or more). All work zones or construction phases less than 3 days duration will use Traffic Control Plans shown in Section 645 of the Special Provisions.
2. All existing regulatory speed limit signs with posts within the work zone/project limits shall be removed and replaced with work zone speed limit sign assemblies (R2-1(35) and W3-5(35) with "CONSTRUCTION AREA" and "\$250 FINE HRS 291C-104" Supplemental Signs).
3. Construction sign assemblies shall be installed on both the approaching and trailing ends of each work zone as shown on this plan.
4. Each construction warning sign and work zone speed limit assembly shall have a minimum of two (2) Type II OM. Installation of each Type II OM shall be considered incidental to Item No. 645.1000, Traffic Control
5. Upon the completion of all physical work or as directed by the Engineer, all construction signs and work zone speed limit assemblies shall be removed. All speed limit signs and posts that were existing at the start of the project within the work zone/project limits shall be restored back to their original locations and configurations.
6. Placement of construction signs shall not obstruct the path of pedestrians and bicyclists.
7. The removal and restoration of existing regulatory speed limit signs with new posts along with the installation, maintenance and removal of work zone speed limit sign assemblies shall be considered incidental to Item No. 645.1000, Traffic Control.

TYPICAL DETAIL FOR CONSTRUCTION SIGNS ON TWO LANE OR MULTILANE UNDIVIDED HIGH SPEED HIGHWAY

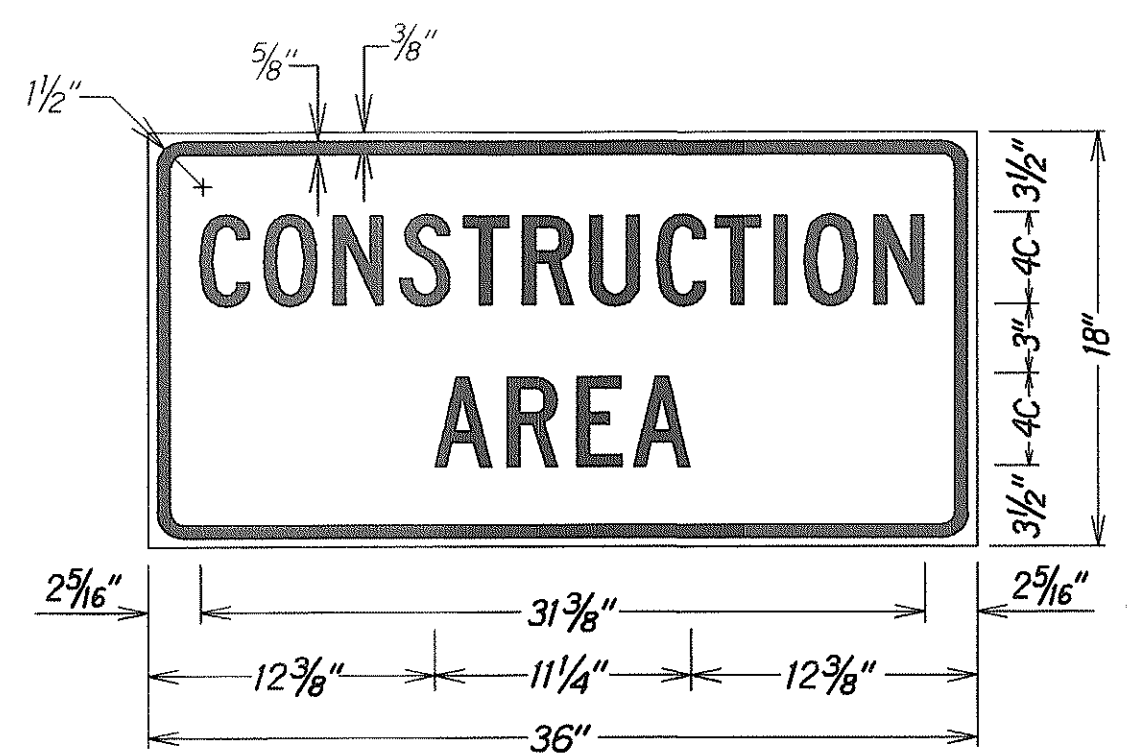

LEGEND: BLACK BACKGROUND: ORANGE

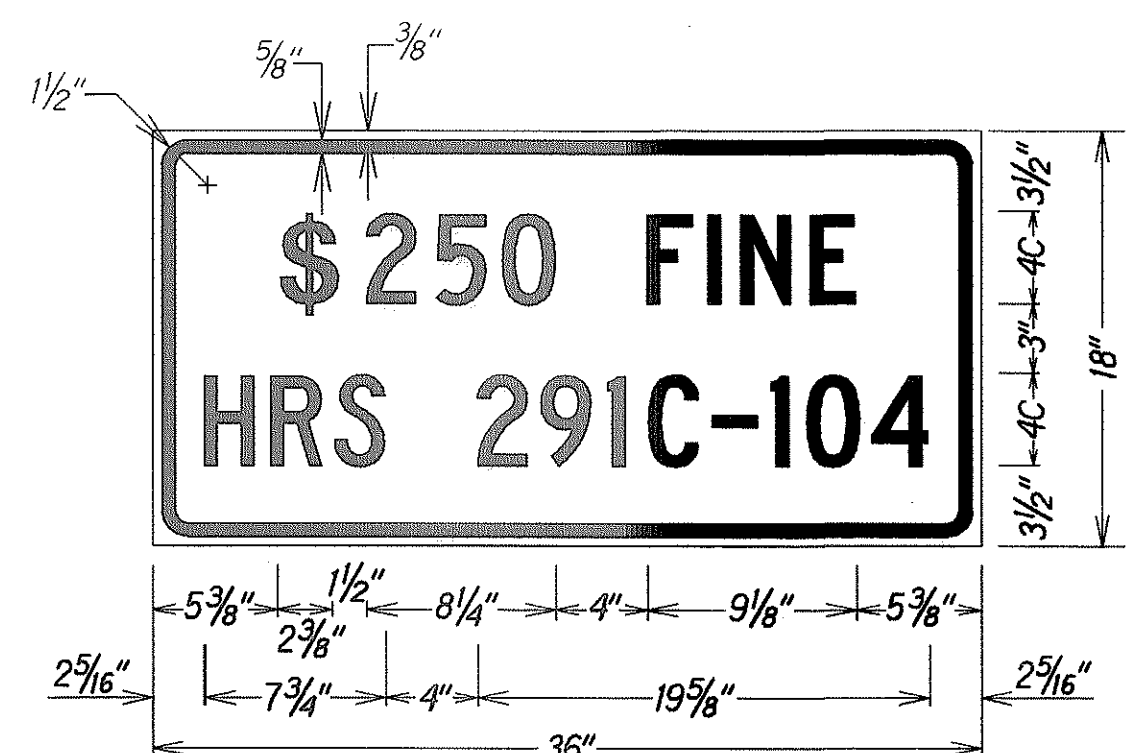

LEGEND: BLACK BACKGROUND: WHITE

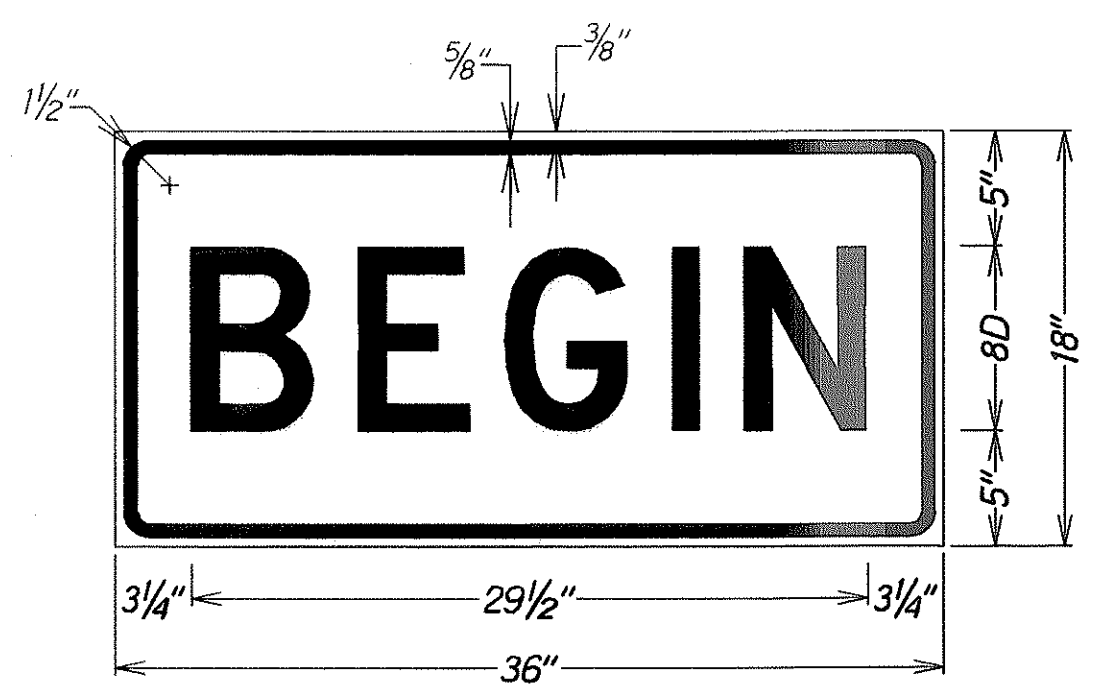

LEGEND: BLACK BACKGROUND: ORANGE

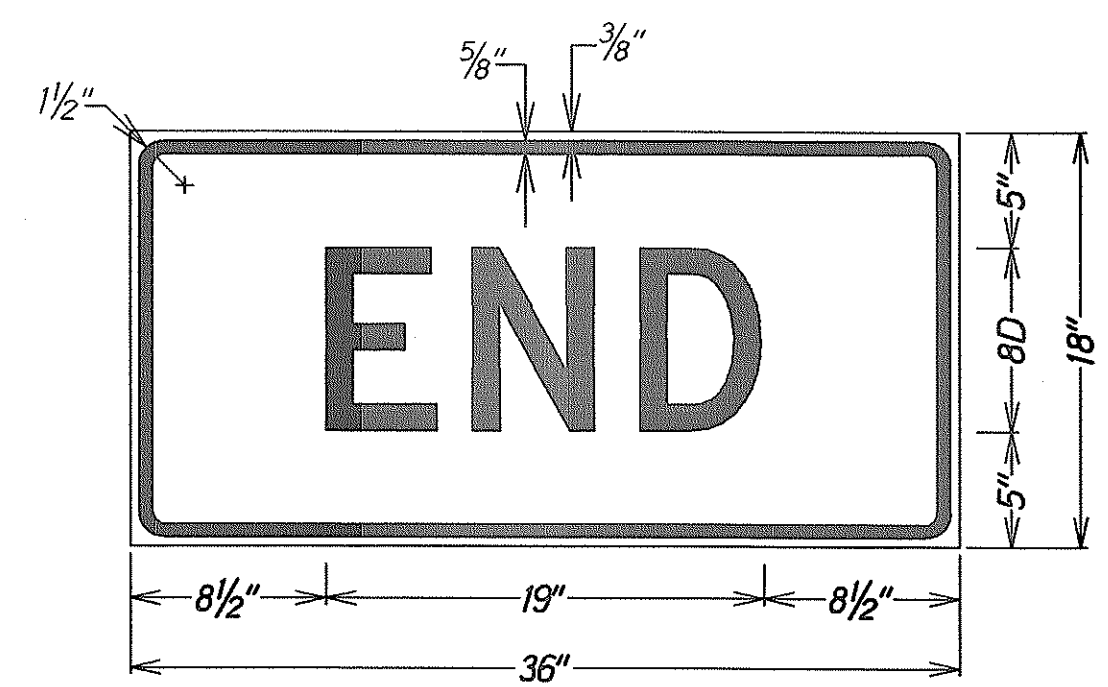

LEGEND: BLACK BACKGROUND: ORANGE

ORIGINAL PLAN	SURVEY PLOTTED BY	DATE
DESIGNED BY	DRAWN BY	
CHECKED BY	NOTED BY	
	DESIGNED BY	
	CHECKED BY	

STATE OF HAWAII
DEPARTMENT OF TRANSPORTATION
HIGHWAYS DIVISION
LOW SPEED UNDIVIDED HIGHWAY
WORK ZONE SIGNING PLAN, NOTES & DETAILS
HONOAPIILANI HIGHWAY RESURFACING
Vicinity of Napilihau, M.P. 28.60 to M.P. 29.20 and
KAHEKILI HIGHWAY REPAIRS AND MAINTENANCE
Honokohau to Papanahoa, M.P. 36.40 to M.P. 41.67
Project No. 30A-01-07M
Not To Scale Date: February, 2007
SHEET No. 1 OF 1 SHEETS