

FED. ROAD DIST. NO.	STATE	FED. AID PROJ. NO.	FISCAL YEAR	SHEET NO.	TOTAL SHEETS
HAWAII	HAW.	STP-030-1(33)	2000	13	29

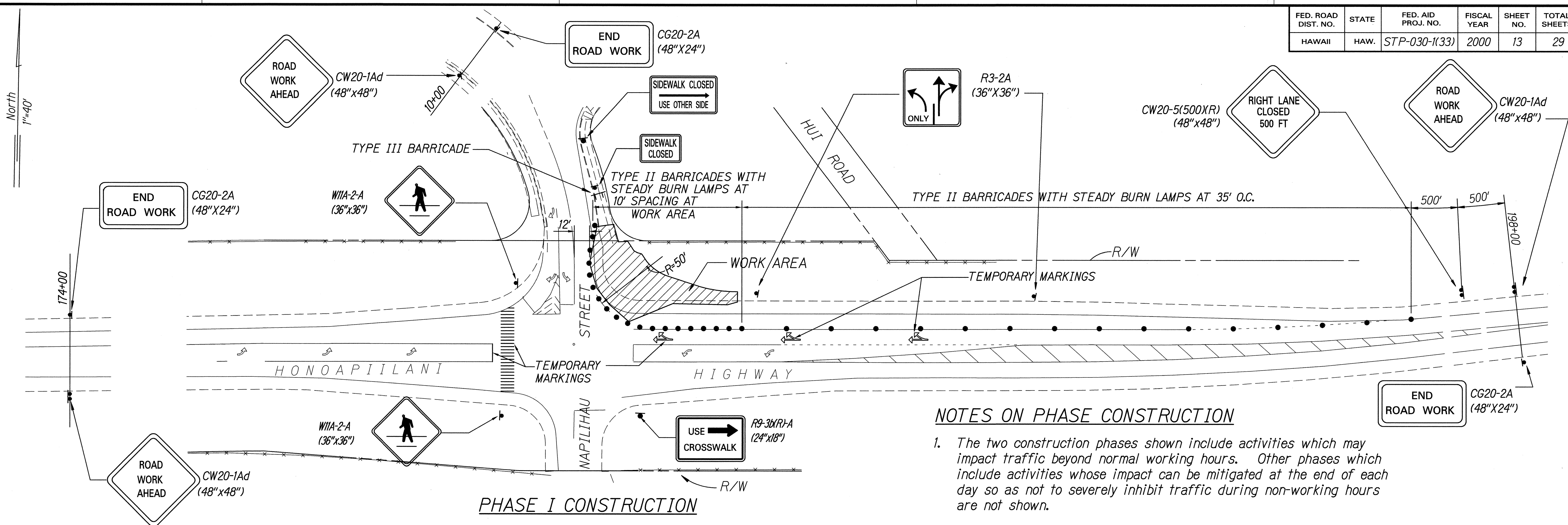

## NOTES ON PHASE CONSTRUCTION

1. *The two construction phases shown include activities which may impact traffic beyond normal working hours. Other phases which include activities whose impact can be mitigated at the end of each day so as not to severely inhibit traffic during non-working hours are not shown.*
2. *All pavement markings shown are existing unless specifically noted as temporary markings. These temporary markings must be installed prior to the beginning of each phase. All existing markings which conflict with the temporary markings shall be removed.*
3. *All signs shown are temporary. Any existing sign which will conflict with traffic operations during each phase shall be covered and/or removed.*
4. *All temporary markings and signs shall be removed after completion of each phase except for the CW20 and CG20 construction signs which shall be kept in place for the entire duration of the construction project.*

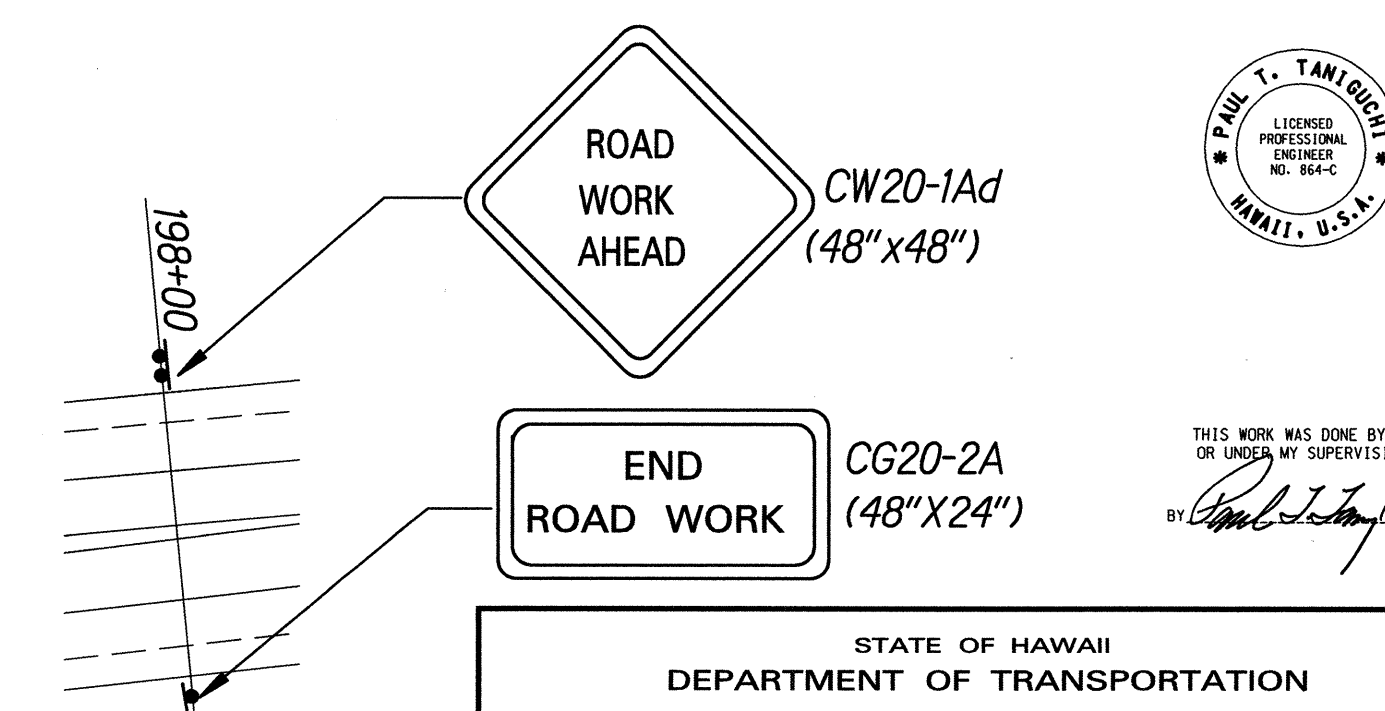
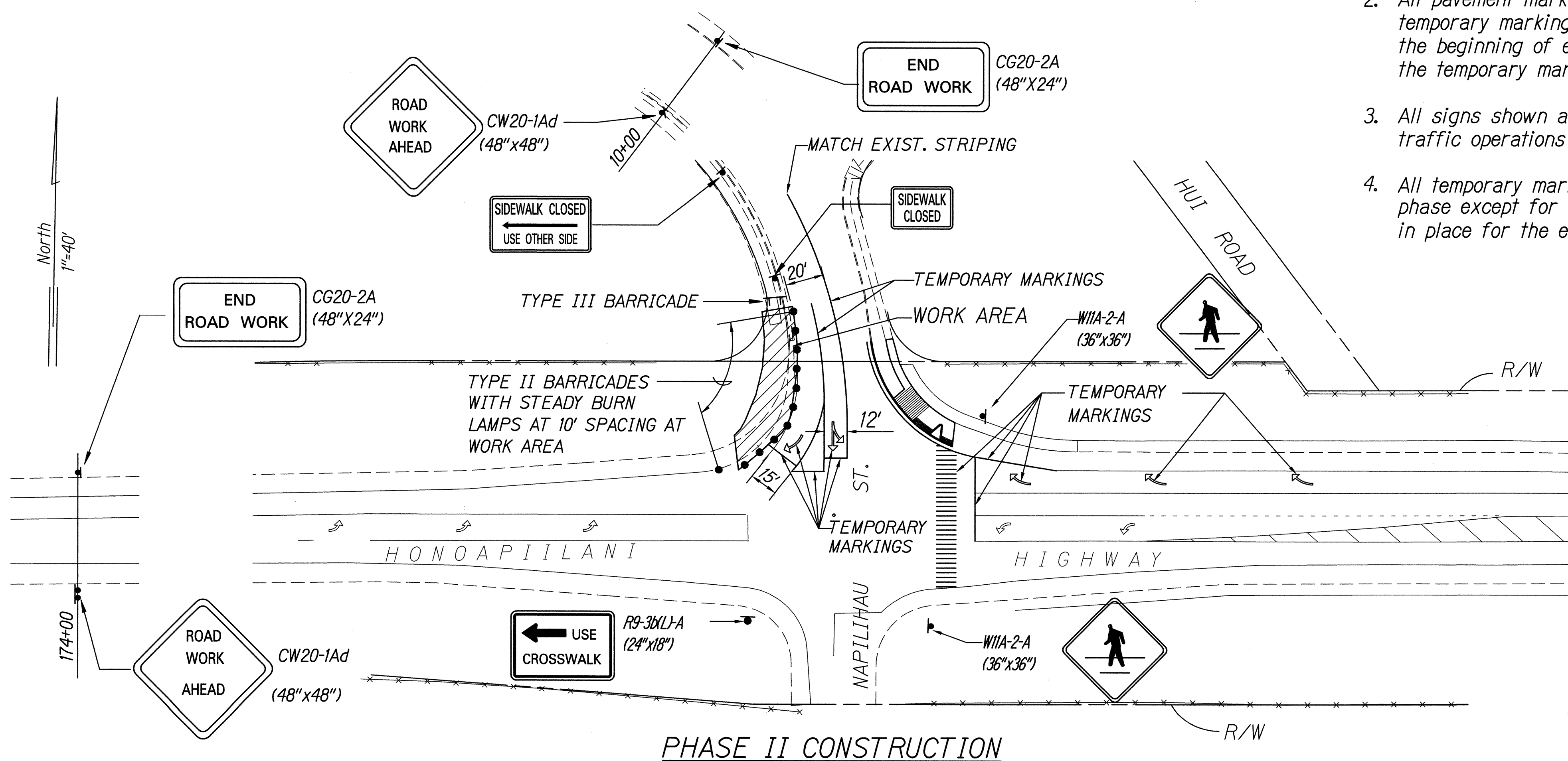

STATE OF HAWAII  
DEPARTMENT OF TRANSPORTATION  
HIGHWAYS DIVISION

*TRAFFIC CONTROL PLAN*

*HONOAPIILANI HIGHWAY*

*Installation of Traffic Signals at Napili Hau Street*

*F.A. Project No. STP-030-1(K33)*

Scale: 1" = 40'      Date: Feb., 1999

SHEET No. 1 OF 1 SHEETS