

DIST. NO.	STATE	FED. AID PROJ. NO.	FISCAL YEAR	SHEET NO.	TOTAL SHEETS
MAUI	HAW.	BR-030-1(37)	2024	15	42

Estimated Onsite Earthwork Summary:

New Road:

Area Of Clearing,	
Grubbing & Grading:	0.04 Acres
Excavation Volume:	3 Cu. Yd.
Embankment Volume:	1 Cu. Yd.
Net Volume:	2 Cu. Yd. (Cut)

Curve Data						
Curve #	Δ	$\Delta/2$	R	T	Ch	Lc
(1)	$31^{\circ}31'15''$	$15^{\circ}45'38''$	$60.00'$	$16.93'$	$32.59'$	$33.01'$
(2)	$14^{\circ}38'43''$	$7^{\circ}19'22''$	$50.00'$	$6.43'$	$12.75'$	$12.78'$

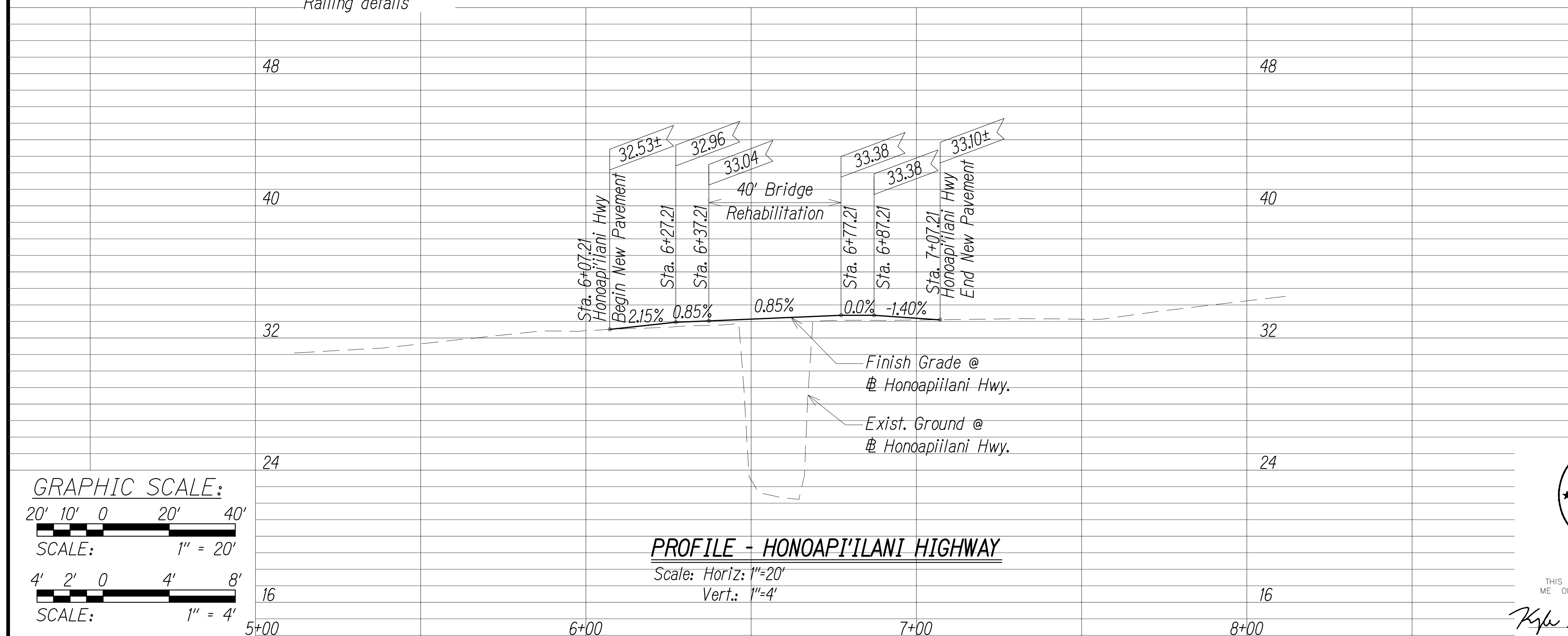
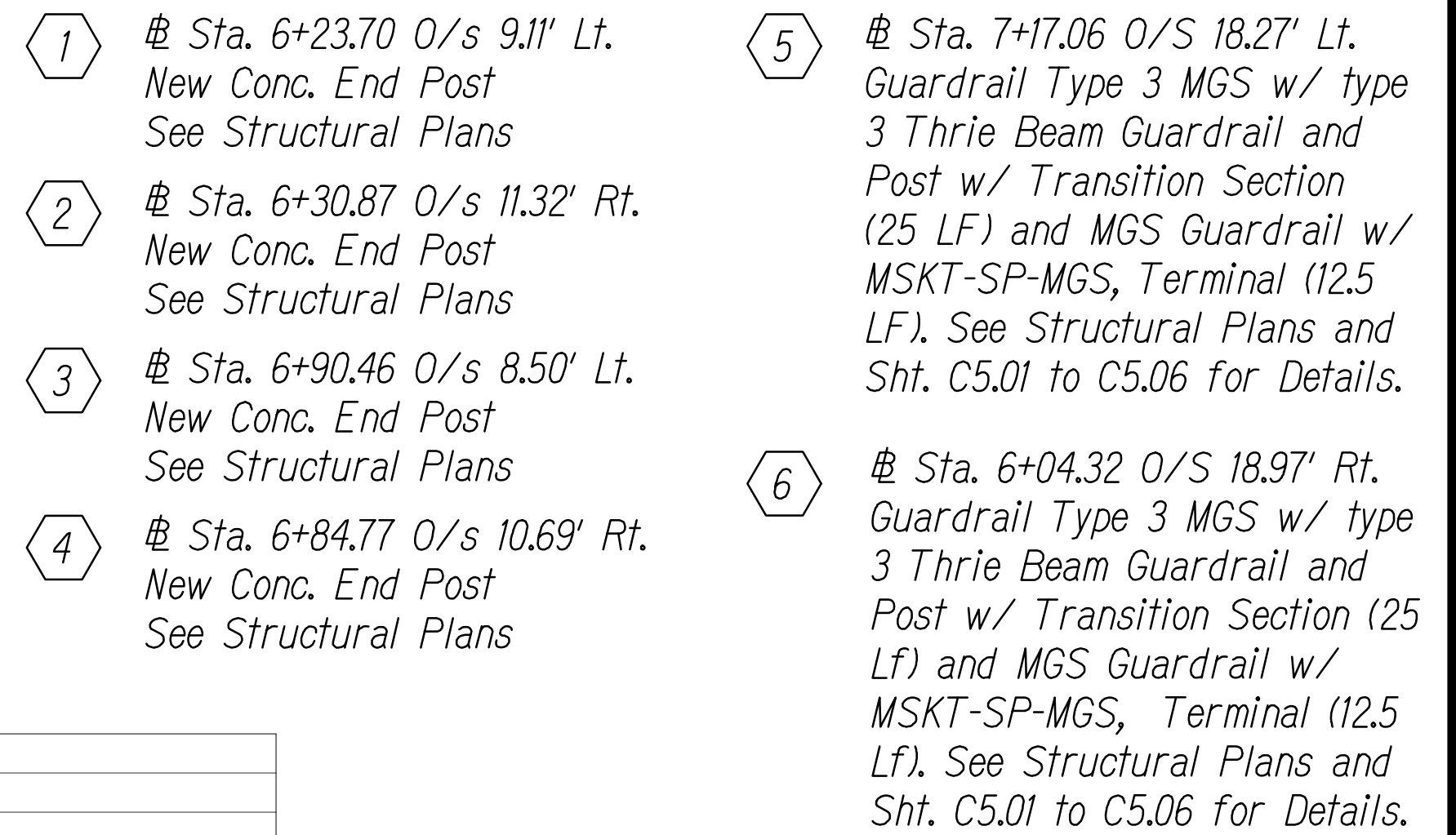
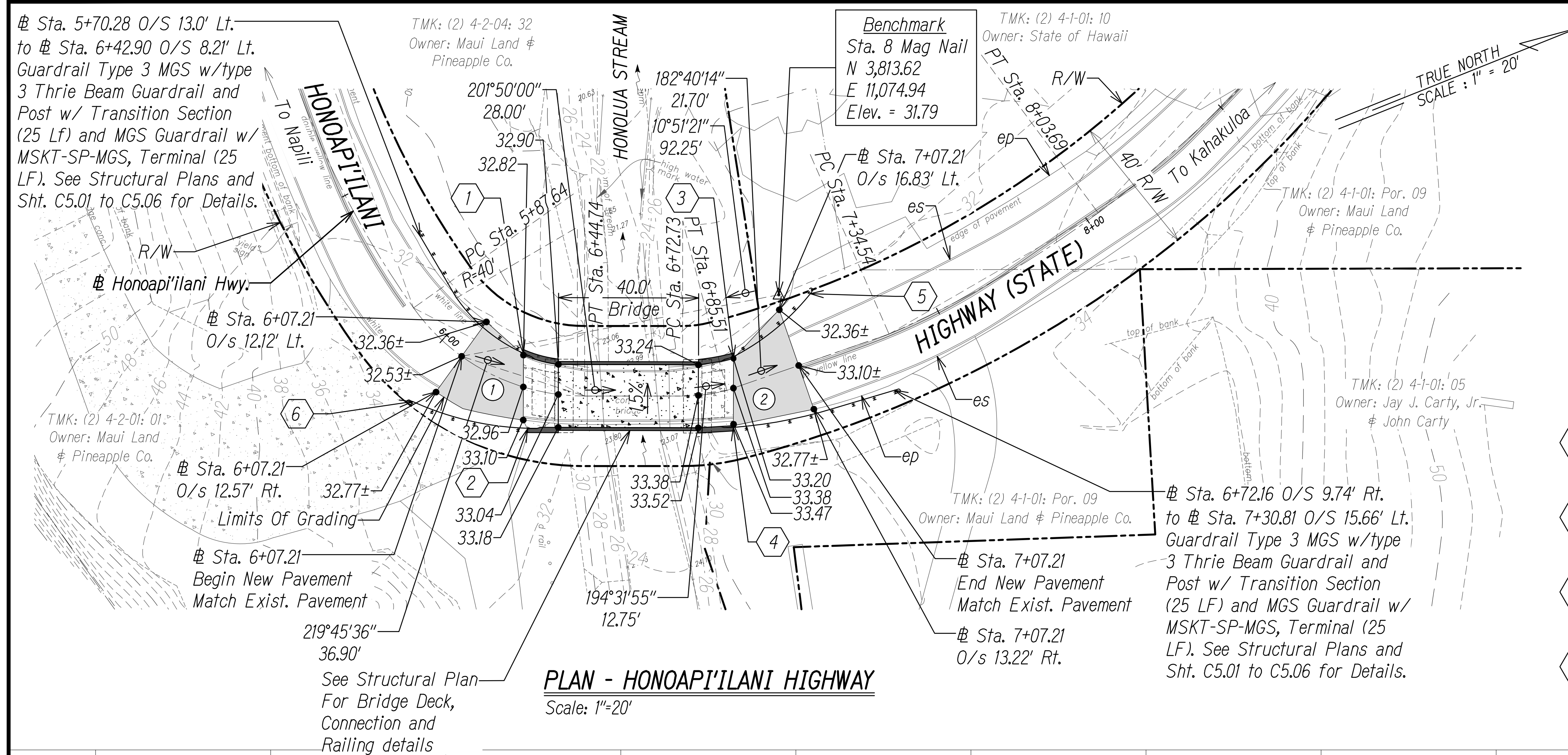

LEGEND:

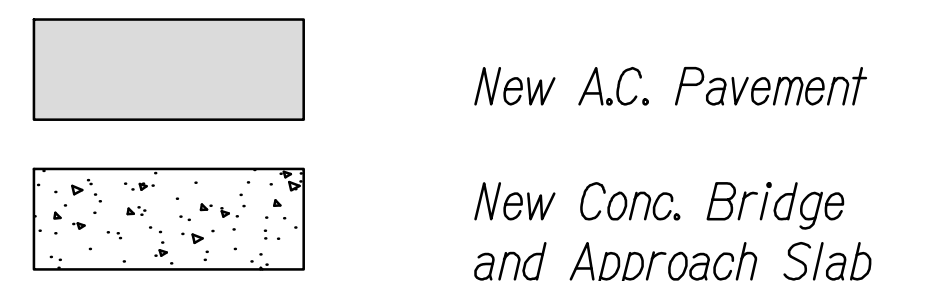

THIS WORK WAS PREPARED BY
ME OR UNDER MY SUPERVISION.

Kyle Shigen APRIL 30, 2026
LIC. EXP. DATE

STATE OF HAWAII
DEPARTMENT OF TRANSPORTATION
HIGHWAYS DIVISION

PLAN AND PROFILE
HONOAPI'ILANI HIGHWAY

Honoapi'ilani Highway
Rehabilitation of Honolulu Bridge
F.A.P. No. BR-030-1(37)

Scale: As Shown Date: August 2024

SHEET No. 02.02 OF 42 SHEETS