

DIST. NO.	STATE	FED. AID PROJ. NO.	FISCAL YEAR	SHEET NO.	TOTAL SHEETS
MAUI	HAW.	BR-030-1(37)	2024	14	42

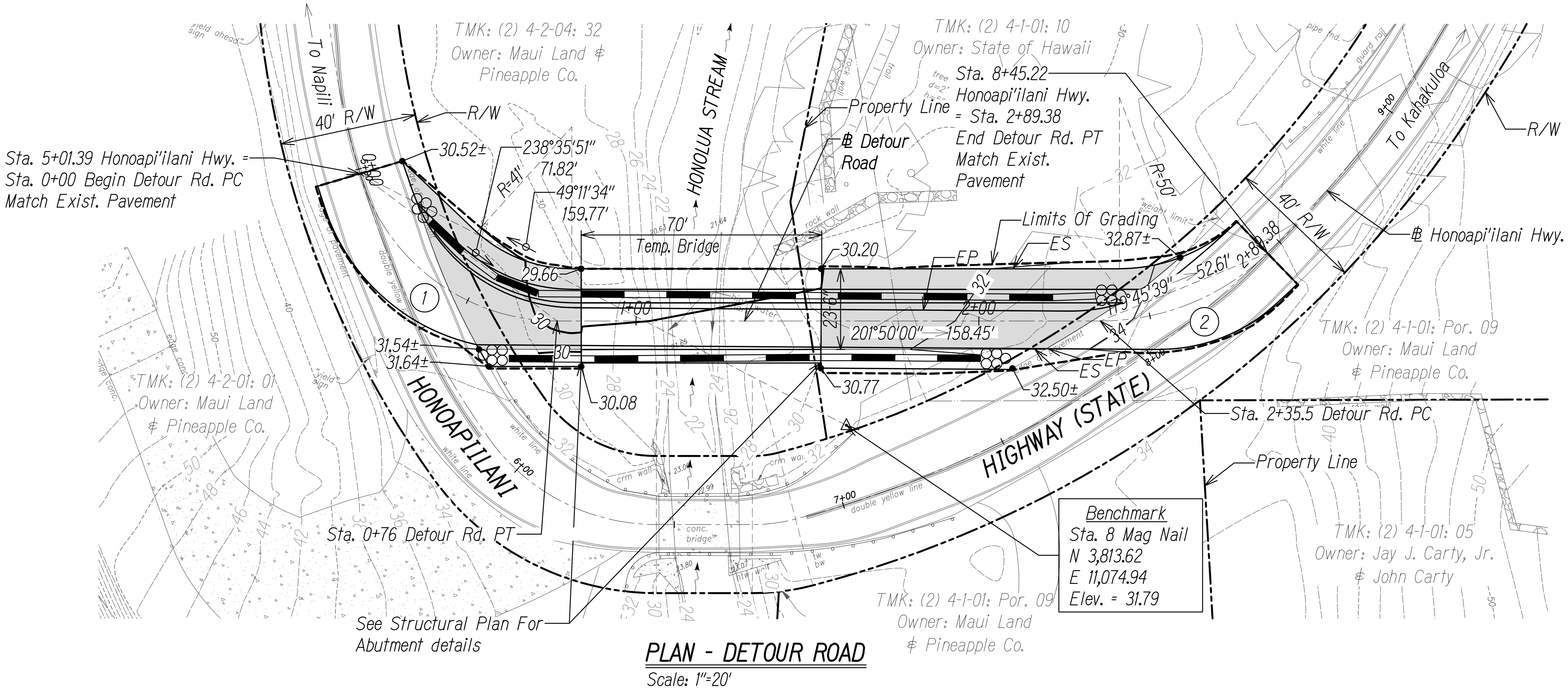

Estimated Onsite Earthwork Summary:

Detour Road:

Area Of Clearing,	0.12 Acres
Grubbing & Grading:	
Excavation Volume:	3 Cu. Yd.
Embankment Volume:	68 Cu. Yd.
Net Volume:	65 Cu. Yd. (Fill)

Curve #	$\Delta$	$\Delta/2$	R	T	Ch	Lc
1	73°31'40"	36°45'50"	60.00'	44.83'	71.82'	77.00'
2	44°08'42"	22°04'21"	70.00'	28.38'	52.61'	53.93'

LEGEND:

- 2 Segments of Portable Concrete Barrier (PCB). See Detail on Sht. C5.07 and C5.08
- New A.C. Pavement
- Crash cushion (3' Diameter). See Detail on Sht. C5.08

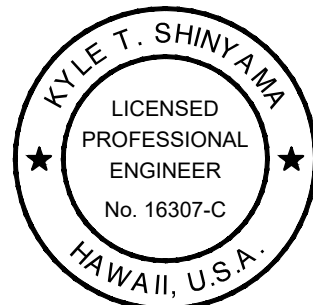
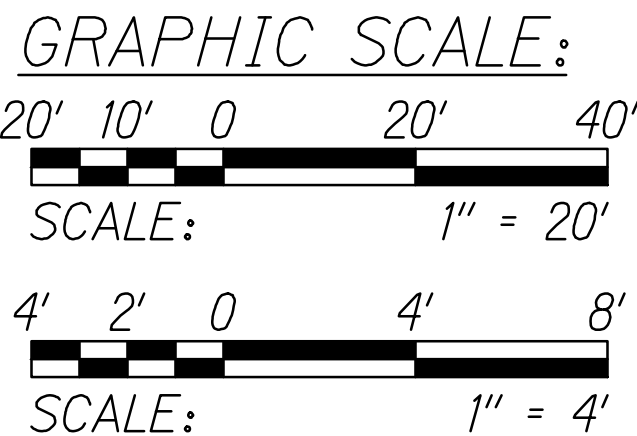
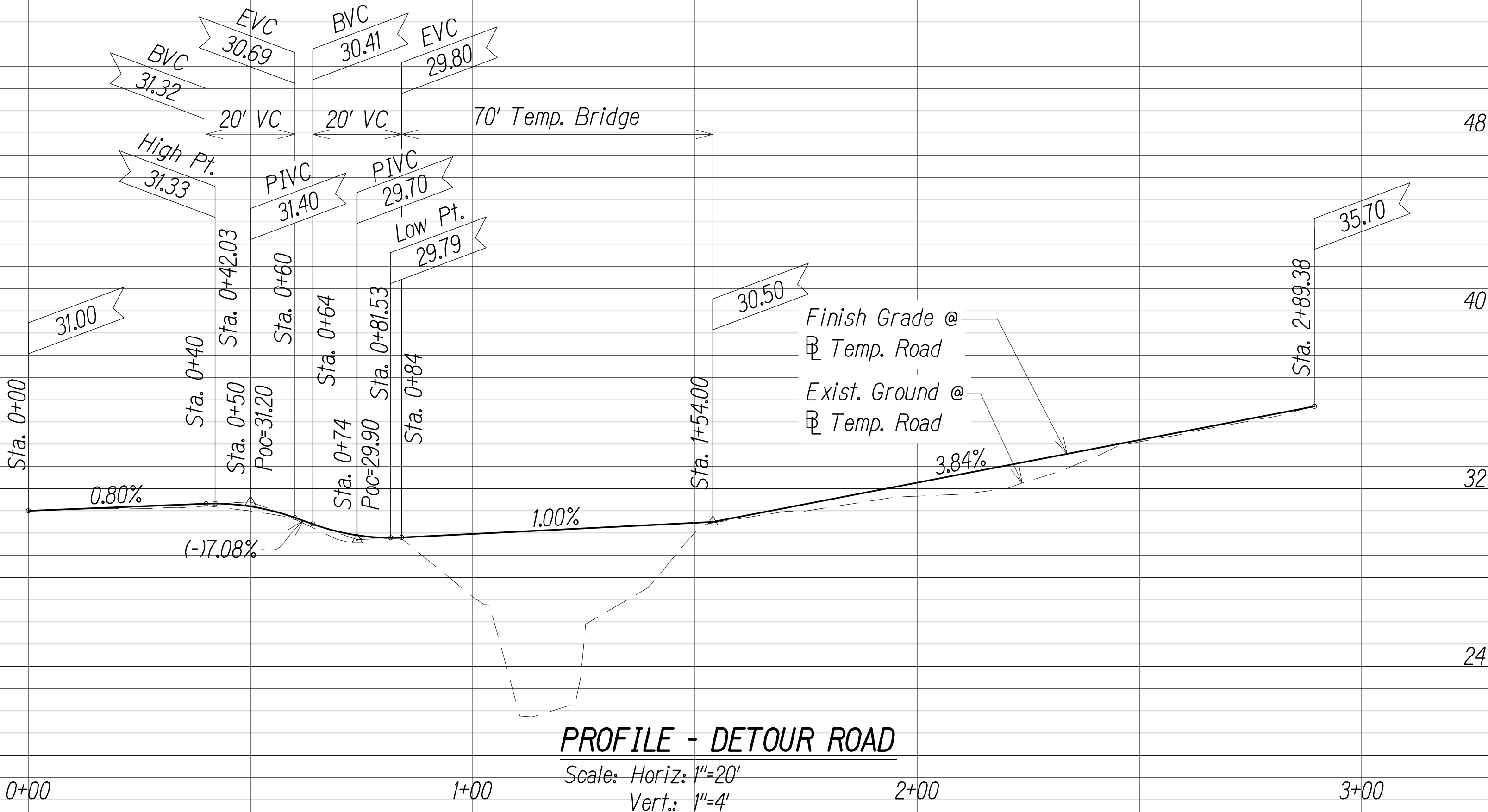

THIS WORK WAS PREPARED BY ME OR UNDER MY SUPERVISION.

Kyle Shinyama

APRIL 30, 2026  
LIC. EXP. DATE

STATE OF HAWAII  
DEPARTMENT OF TRANSPORTATION  
HIGHWAYS DIVISION

**PLAN AND PROFILE  
DETOUR ROAD**

Honoapi'ilani Highway  
Rehabilitation of Honolua Bridge  
F.A.P. No. BR-030-1(37)

Scale: As Shown Date: August 2024

SHEET No. C2.01 OF 42 SHEETS

ORIGINAL PLAN	DATE
NOTE BOOK	
DESIGNED BY	
QUANTITIES BY	
CHECKED BY	