

DIST. NO.	STATE	FED. AID PROJ. NO.	FISCAL YEAR	SHEET NO.	TOTAL SHEETS
MAUI	HAW.	BR-030-1(37)	2024	31	42

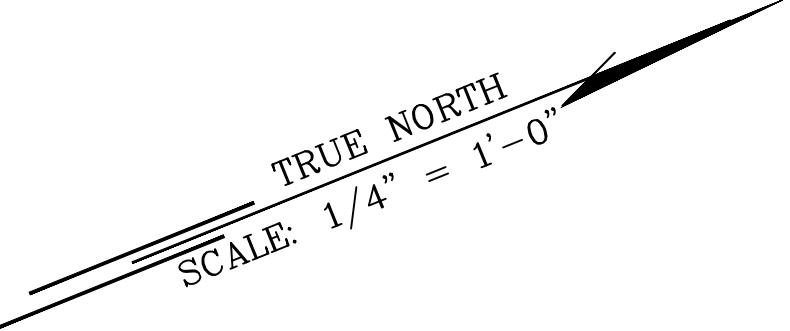

- Note:**
1. Temporarily brace and support existing CRM walls to maintain wall stability during excavation activities, typ.
 2. Provide BMPs to keep all materials out of the stream throughout construction
 3. See note 3C and S3.1 for excavation pay limit.

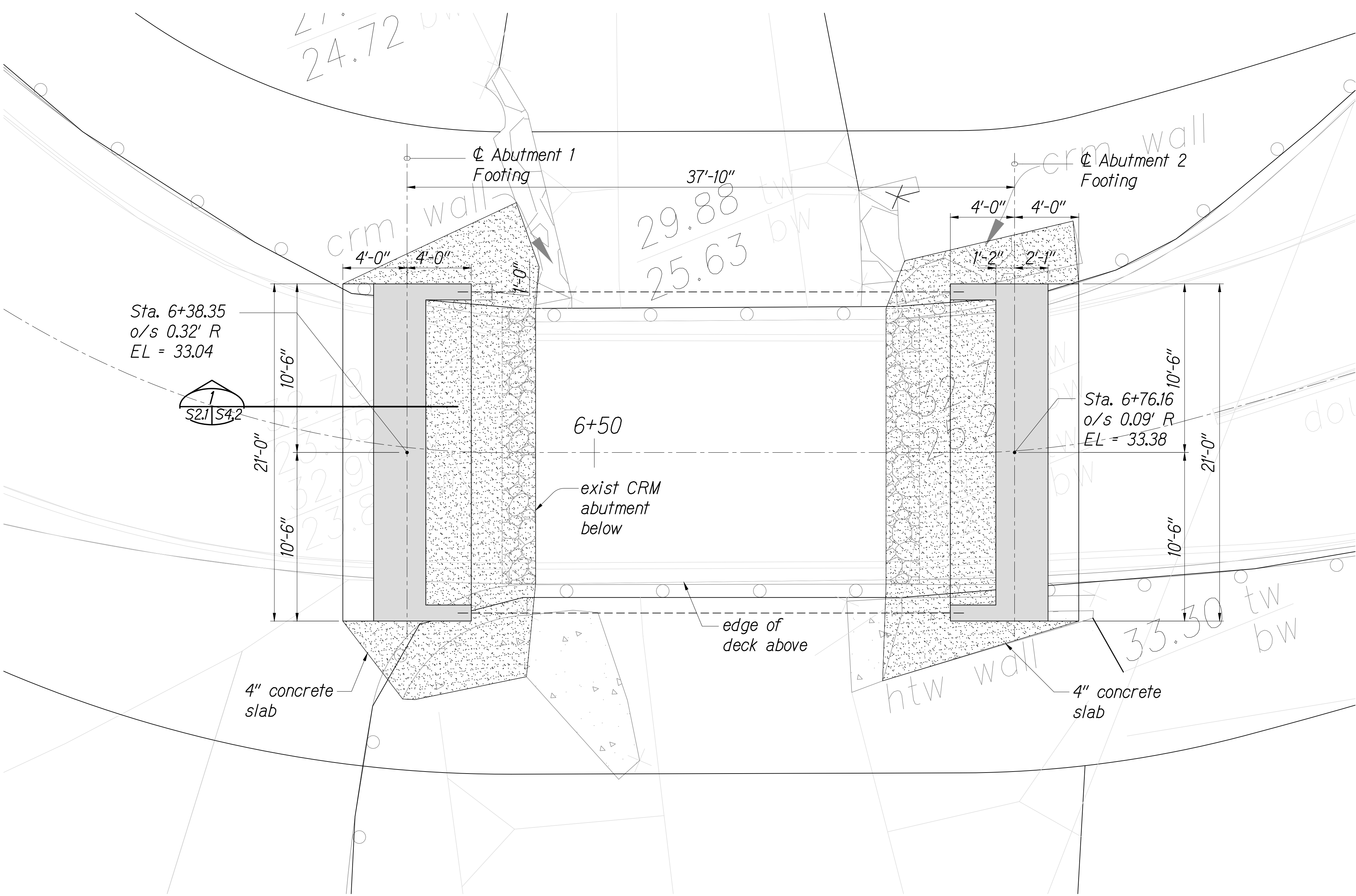

BRIDGE FOUNDATION PLAN

Scale: 1/4" = 1'-0"

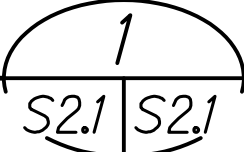

ORIGINAL PLAN	SURVEY PLOTTED BY	DATE
NOTE BOOK	DRAWN BY	
No.	DESIGNED BY	
	QUANTITIES BY	
	CHECKED BY	

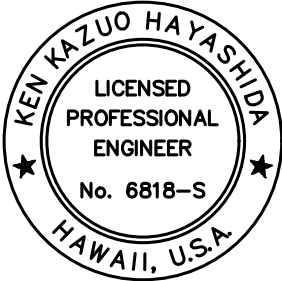

THIS WORK WAS PREPARED BY
ME OR UNDER MY SUPERVISION.
[Signature]
APRIL 30, 2026
LIC. EXP. DATE

STATE OF HAWAII
DEPARTMENT OF TRANSPORTATION
HIGHWAYS DIVISION

Bridge Foundation Plan

Honoapi'ilani Highway
Rehabilitation of Honolua Bridge
F.A.P. No. BR-030-1(37)

Scale: As Shown Date: August 2024

SHEET No. S2.1 OF 42 SHEETS