

FED. ROAD DIST. NO.	STATE	PROJ. NO.	FISCAL YEAR	SHEET NO.	TOTAL SHEETS
HAWAII	HAW.	STP-030-1(39)	2008	ADD. 13	194

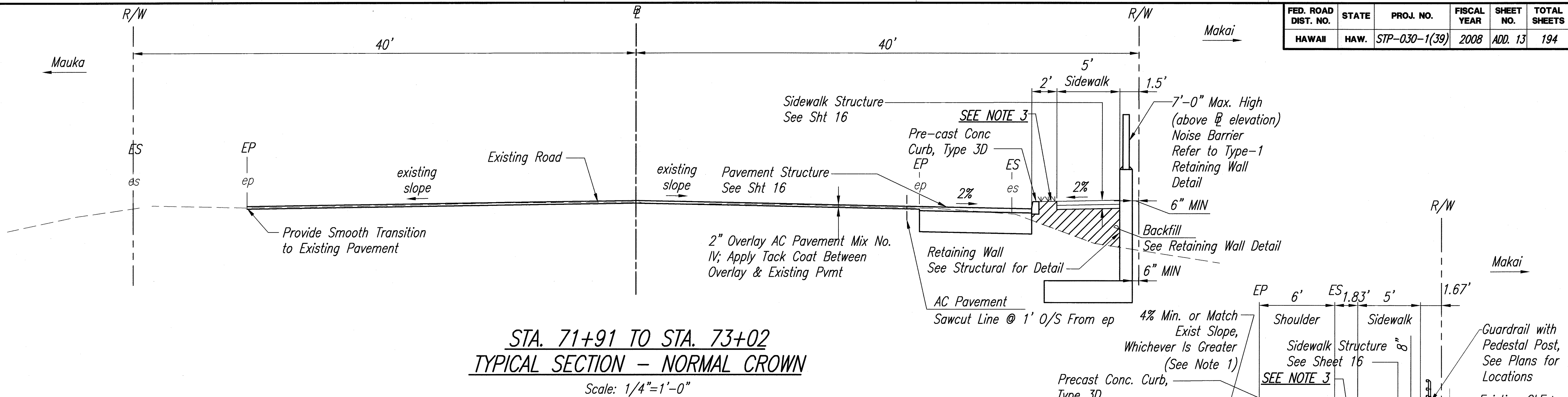

Note:
Existing structures shown to be adjacent to the Right-of-Way may be found to be encroaching within the Right-of-Way or otherwise conflict with new construction. In the event such a conflict is found, it is the Contractor's responsibility to notify the Resident Engineer immediately. All coordination with the affected property owner will be the responsibility of the Department of Transportation. No additional compensation will be authorized the Contractor due to delays caused by such encroachment.

Note:
A. Refer to different *makai* section for Sta 88+73.20 to 90+89.41 detailed on this sheet.

MAKAI - STA. 88+73.20± TO STA. 90+89.41±
Scale: 1/4"=1'-0"

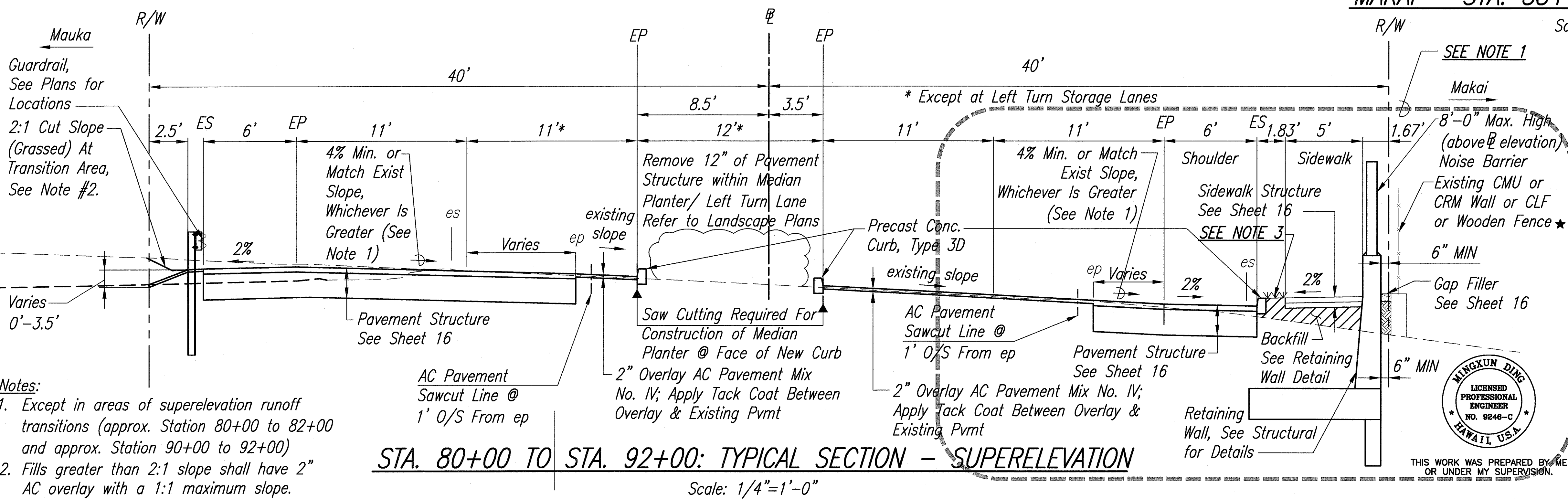

- Notes:**
1. Except in areas of superelevation runoff transitions (approx. Station 80+00 to 82+00 and approx. Station 90+00 to 92+00)
 2. Fills greater than 2:1 slope shall have 2" AC overlay with a 1:1 maximum slope.
 3. Pohuehue R.C. @ 12" O.C.

★ Contractor to prevent all adjacent structures from damage during construction.

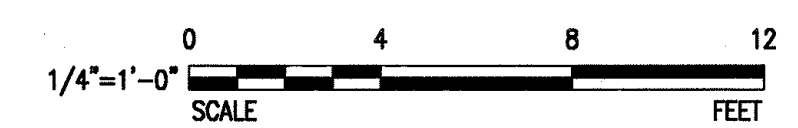

12/22/08	DELETED COLD PLANING, REVISED SHOULDER AND GUARDRAIL SECTIONS & ADDED LANDSCAPE NOTES
DATE	REVISION
STATE OF HAWAII DEPARTMENT OF TRANSPORTATION HIGHWAYS DIVISION ROAD TYPICAL SECTIONS <i>Honoapiilani Highway Widening</i> <i>Lahainaluna Road to Aholo Road</i> <i>Project No. STP-030-1(39)</i> Scale: As Shown Date: February 2008	
SHEET No. 1	OF 4 SHEETS

WINGKUN DING
 LICENSED PROFESSIONAL ENGINEER
 NO. 9248-C
 HAWAII, U.S.A.
 THIS WORK WAS PREPARED BY ME OR UNDER MY SUPERVISION.
 SIGNATURE: *[Signature]* 4/30/10
 EXPIRATION DATE OF LICENSE

ORIGINAL PLAN	DATE
SURVEY PLOTTED BY	
DESIGNED BY	
NOTED BY	
CHECKED BY	
DATE	

PLOT DATE: 06-22-2008 @ 11:36 am
 LAST REVISION: 06-22-2008 @ 11:36 am
 PLOT DATE: 06-22-2008 @ 11:36 am
 LAST REVISION: 06-22-2008 @ 11:36 am

FED. ROAD DIST. NO.	STATE	PROJ. NO.	FISCAL YEAR	SHEET NO.	TOTAL SHEETS
HAWAII	HAW.	STP-030-1(39)	2008	16	194

Note:
Existing structures shown to be adjacent to the Right-of-Way may be found to be encroaching within the Right-of-Way or otherwise conflict with new construction. In the event such a conflict is found, it is the Contractor's responsibility to notify the Resident Engineer immediately. All coordination with the affected property owner will be the responsibility of the Department of Transportation. No additional compensation will be authorized the Contractor due to delays caused by such encroachment.

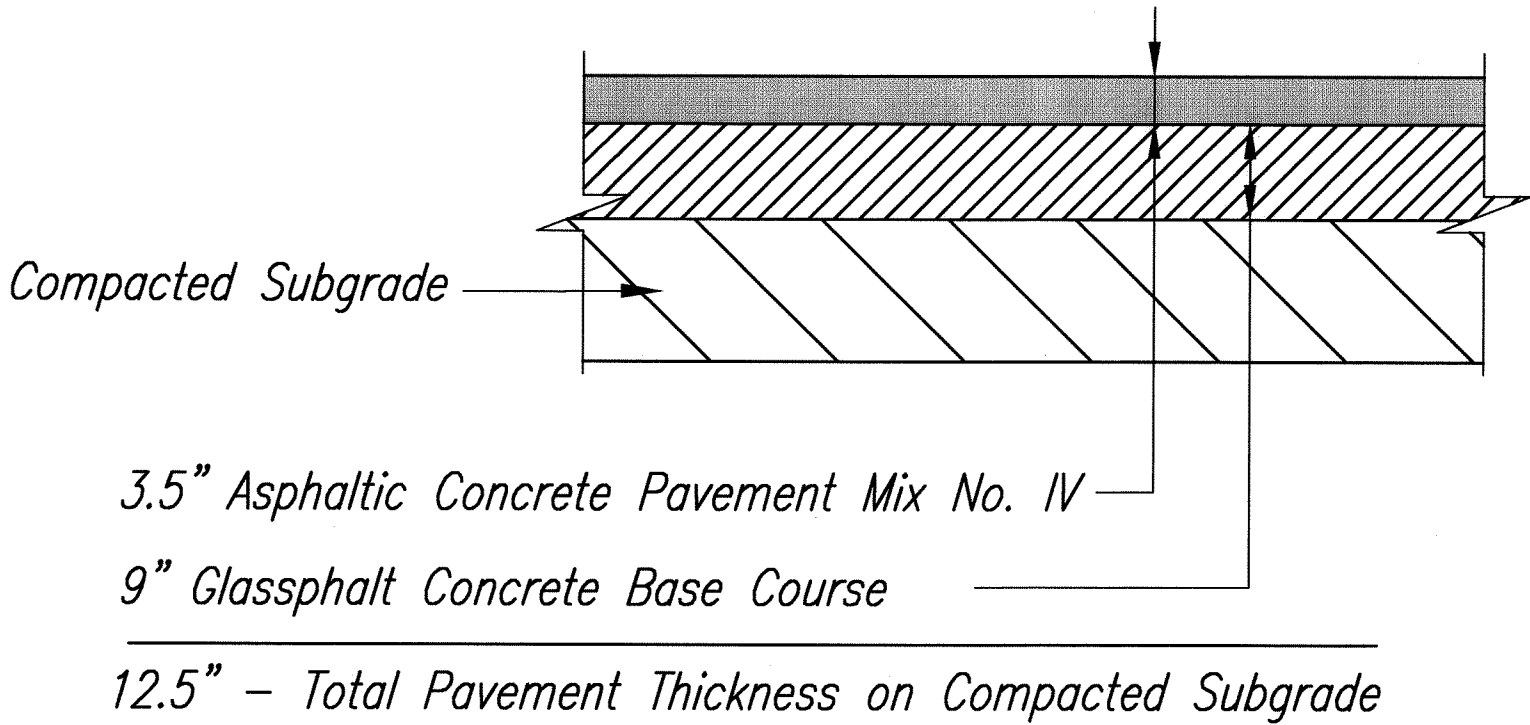

Distressed Pavement Sections

PAVEMENT STRUCTURES

NOT TO SCALE

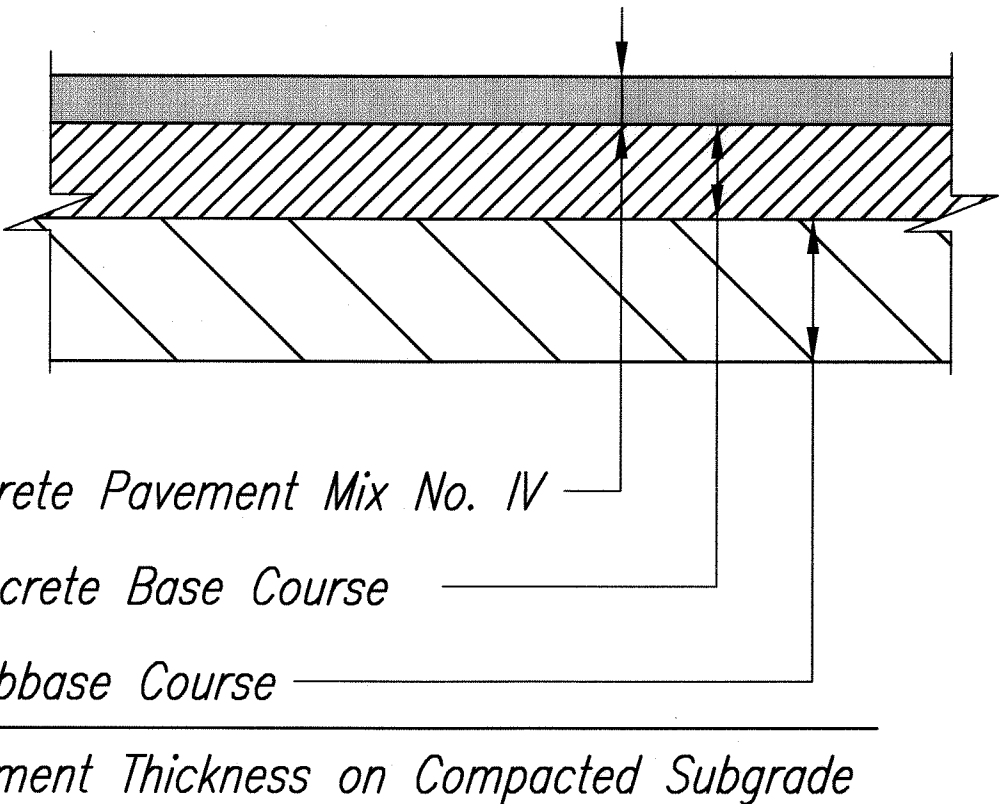
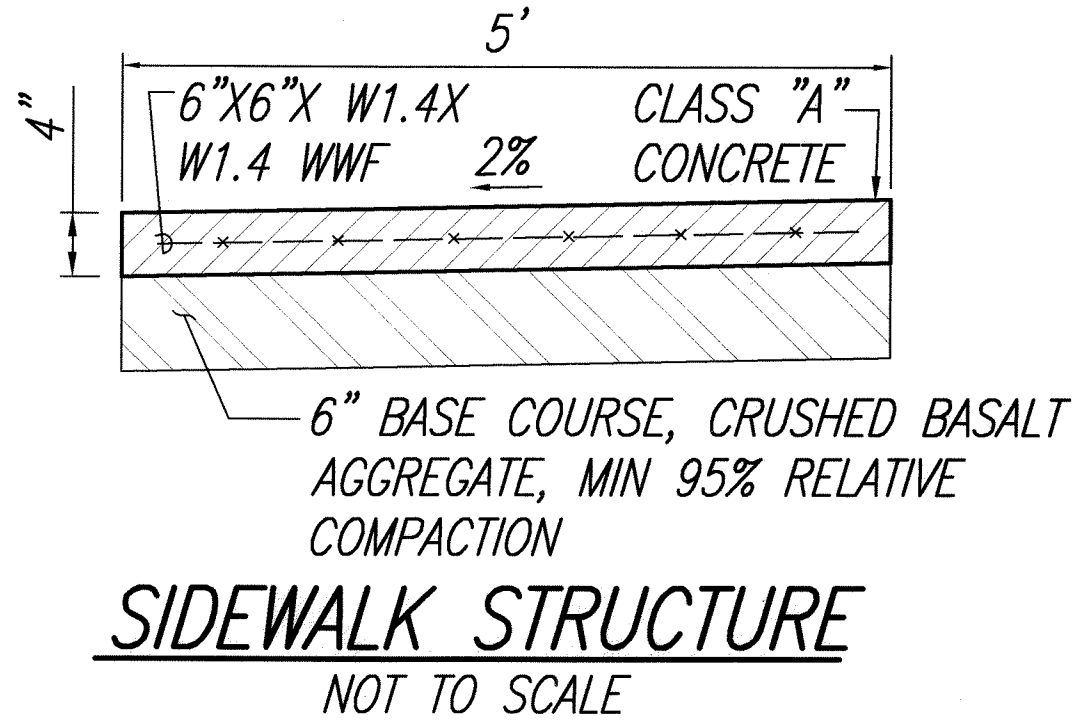

Lahainaluna Road to Aholo Road Sta. 71+12 to Sta. 127+69

PAVEMENT STRUCTURES

NOT TO SCALE

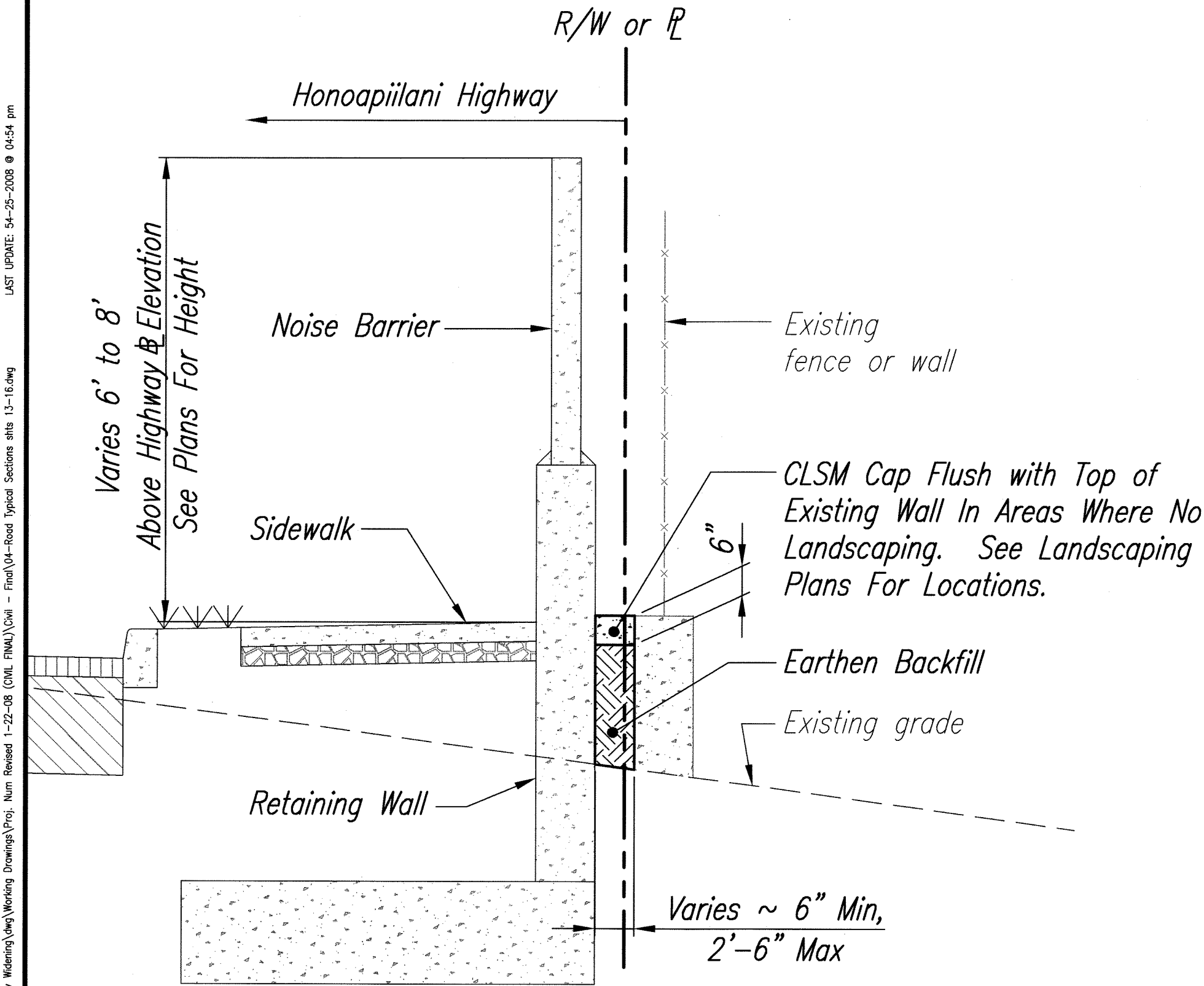

GAP FILLER FOR NEW RETAINING WALL AND EXISTING PROPERTY LINE WALL

Scale: 1" = 1'-0"

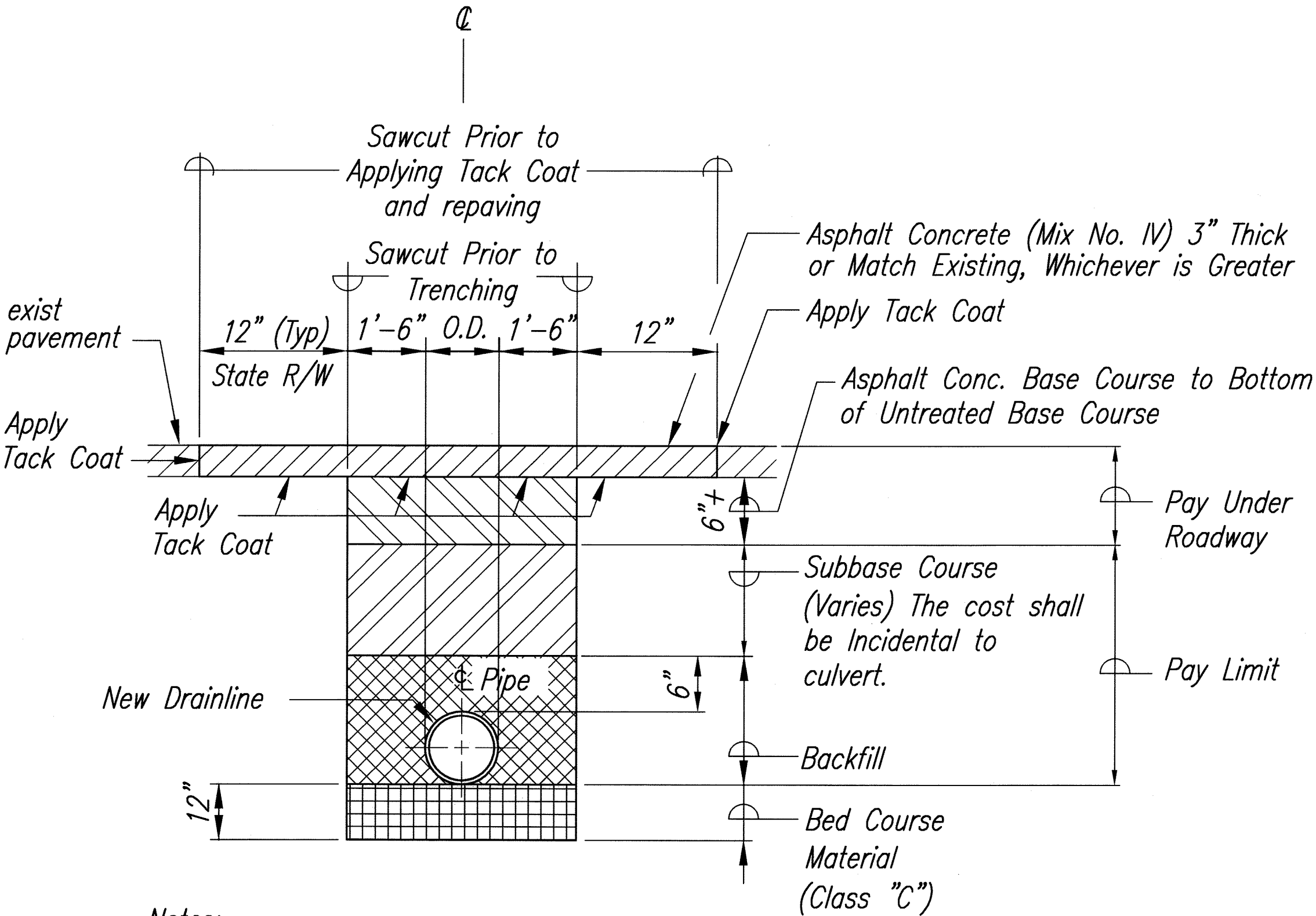

- Notes:
1. Pavement Structure Shall Be Equal to or Better Than Existing in Thickness and Quality.
 2. Trench Shoring Not Shown.

TYPICAL TRENCH RESTORATION DETAILS

NOT TO SCALE



THIS WORK WAS PREPARED BY ME
OR UNDER MY SUPERVISION.

Alan Y. Tomita

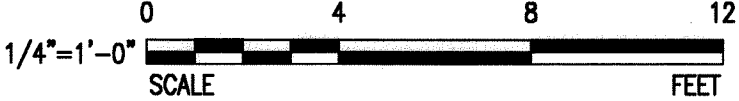

STATE OF HAWAII
DEPARTMENT OF TRANSPORTATION
HIGHWAYS DIVISION

ROAD TYPICAL SECTIONS

*Honoapiilani Highway Widening
Lahainaluna Road to Aholo Road
Project No. STP-030-1(39)*

Scale: As Shown Date: October 2008

SHEET No. 4 OF 4 SHEETS