

FED. ROAD DIST. NO.	STATE	PROJ. NO.	FISCAL YEAR	SHEET NO.	TOTAL SHEETS
HAWAII	HAW.	30A-01-97M	1997	15	24

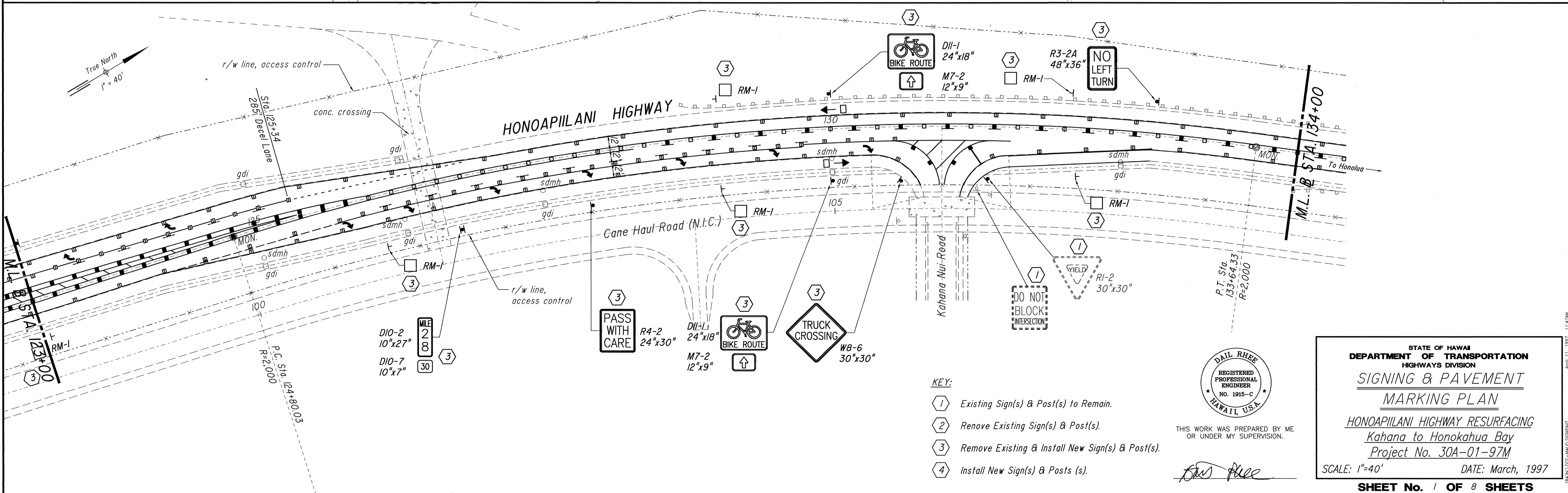

SURVEY PLOTTED BY: _____ DATE: _____
 DRAWN BY: _____
 NOTE BOOK DESIGNED BY: _____
 QUANTITIES BY: _____
 CHECKED BY: _____
 No. _____

- KEY:
- ① Existing Sign(s) & Post(s) to Remain.
 - ② Remove Existing Sign(s) & Post(s).
 - ③ Remove Existing & Install New Sign(s) & Post(s).
 - ④ Install New Sign(s) & Posts (s).

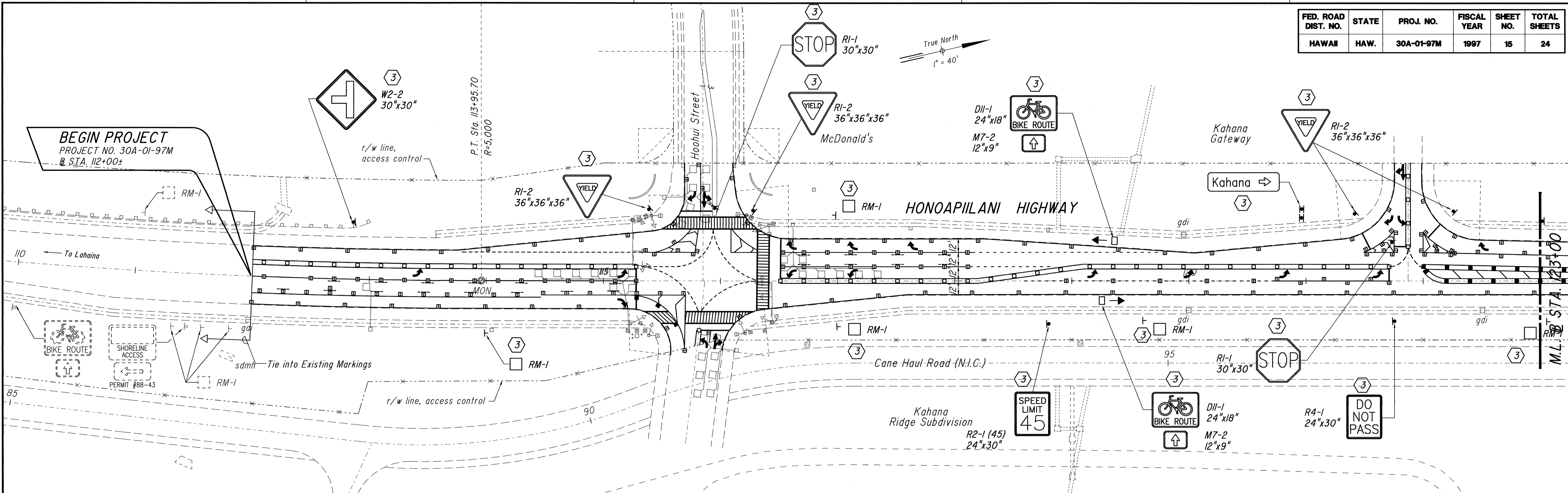
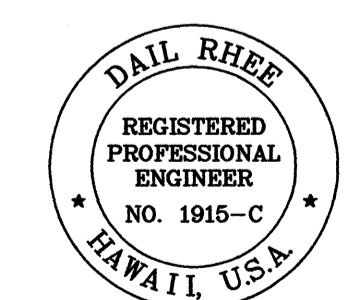

THIS WORK WAS PREPARED BY ME OR UNDER MY SUPERVISION.

Dail Rhee

STATE OF HAWAII
 DEPARTMENT OF TRANSPORTATION
 HIGHWAYS DIVISION
SIGNING & PAVEMENT
MARKING PLAN
 HONOAPIILANI HIGHWAY RESURFACING
 Kahana to Honokahua Bay
 Project No. 30A-01-97M
 SCALE: 1"=40' DATE: March, 1997
SHEET No. 1 OF 8 SHEETS

FED. ROAD DIST. NO.	STATE	PROJ. NO.	FISCAL YEAR	SHEET NO.	TOTAL SHEETS
HAWAII	HAW.	30A-01-97M	1997	16	24

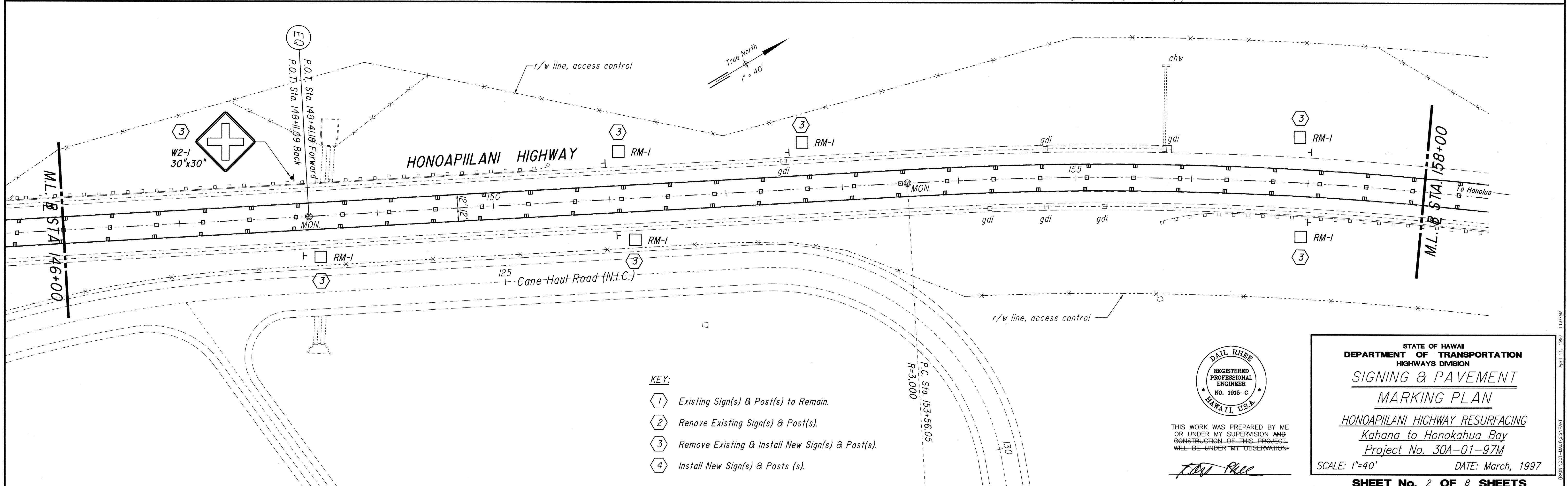
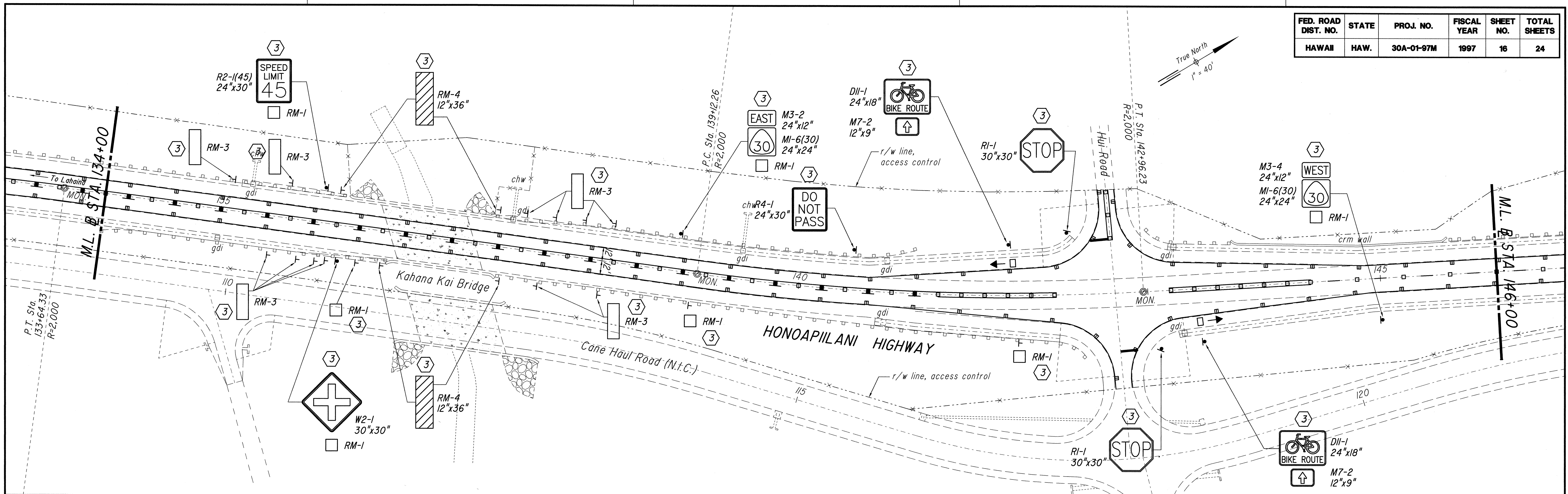

DATE	_____
SURVEY PLOTTED BY	_____
DRAWN BY	_____
TRACED BY	_____
NOTE BOOK	_____
QUANTITIES BY	_____
CHECKED BY	_____
No.	_____

- KEY:**
- ① Existing Sign(s) & Post(s) to Remain.
 - ② Remove Existing Sign(s) & Post(s).
 - ③ Remove Existing & Install New Sign(s) & Post(s).
 - ④ Install New Sign(s) & Posts (s).

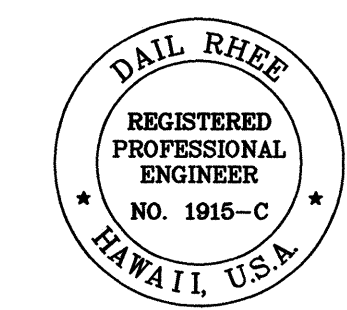

THIS WORK WAS PREPARED BY ME OR UNDER MY SUPERVISION AND CONSTRUCTION OF THIS PROJECT WILL BE UNDER MY OBSERVATION.

Dail Rhee

STATE OF HAWAII
DEPARTMENT OF TRANSPORTATION
HIGHWAYS DIVISION

**SIGNING & PAVEMENT
MARKING PLAN**

HONOAPIILANI HIGHWAY RESURFACING
Kahana to Honokahua Bay
Project No. 30A-01-97M

SCALE: 1"=40' DATE: March, 1997

SHEET No. 2 OF 8 SHEETS

FED. ROAD DIST. NO.	STATE	PROJ. NO.	FISCAL YEAR	SHEET NO.	TOTAL SHEETS
HAWAII	HAW.	30A-01-97M	1997	17	24

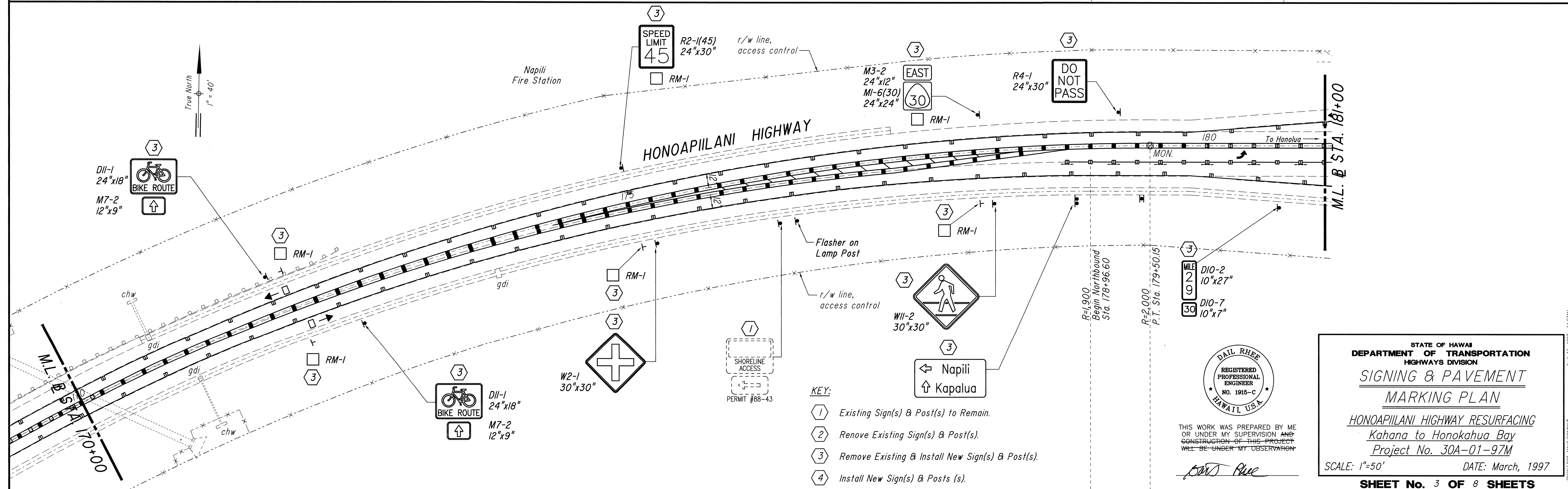
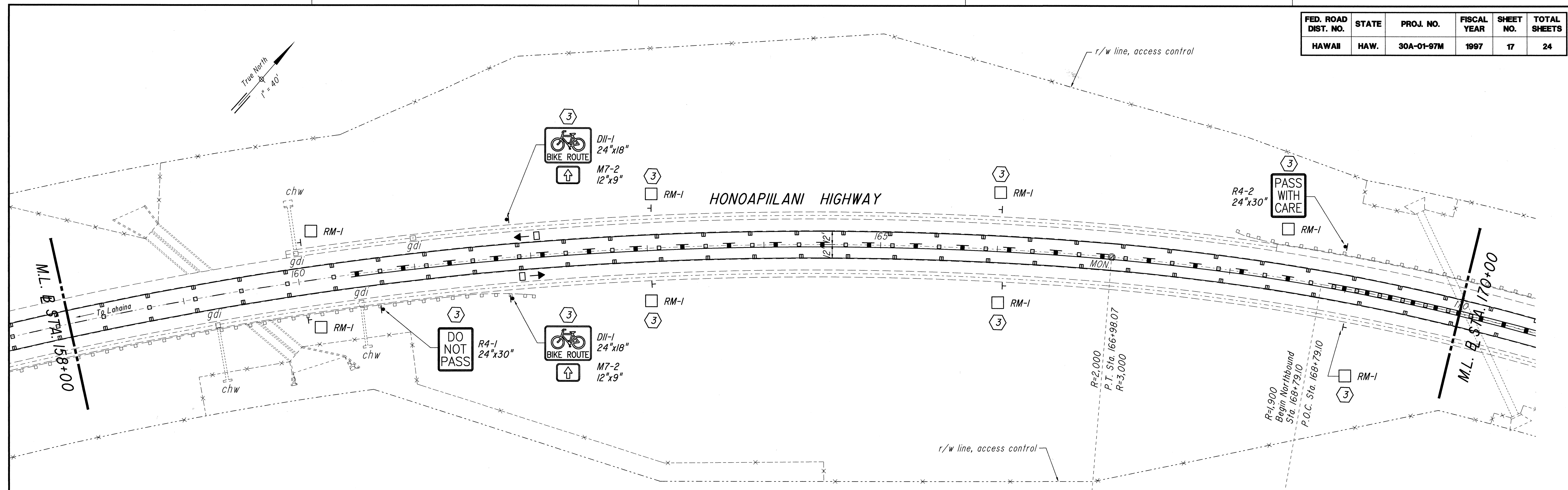

SURVEY PLOTTED BY	DATE
DRAWN BY	
DESIGNED BY	
QUANTITIES BY	
CHECKED BY	
ORIGINAL PLAN	No.

- KEY:**
- ① Existing Sign(s) & Post(s) to Remain.
 - ② Remove Existing Sign(s) & Post(s).
 - ③ Remove Existing & Install New Sign(s) & Post(s).
 - ④ Install New Sign(s) & Posts (s).

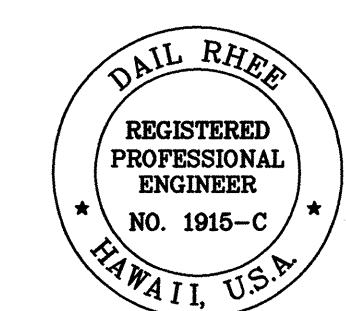

THIS WORK WAS PREPARED BY ME OR UNDER MY SUPERVISION AND CONSTRUCTION OF THIS PROJECT WILL BE UNDER MY OBSERVATION.

Dail Reeb

STATE OF HAWAII
DEPARTMENT OF TRANSPORTATION
HIGHWAYS DIVISION

**SIGNING & PAVEMENT
MARKING PLAN**

HONOAPIILANI HIGHWAY RESURFACING
Kahana to Honokahua Bay
Project No. 30A-01-97M

SCALE: 1"=50' DATE: March, 1997

SHEET No. 3 OF 8 SHEETS

FED. ROAD DIST. NO.	STATE	PROJ. NO.	FISCAL YEAR	SHEET NO.	TOTAL SHEETS
HAWAII	HAW.	30A-01-97M	1997	18	24

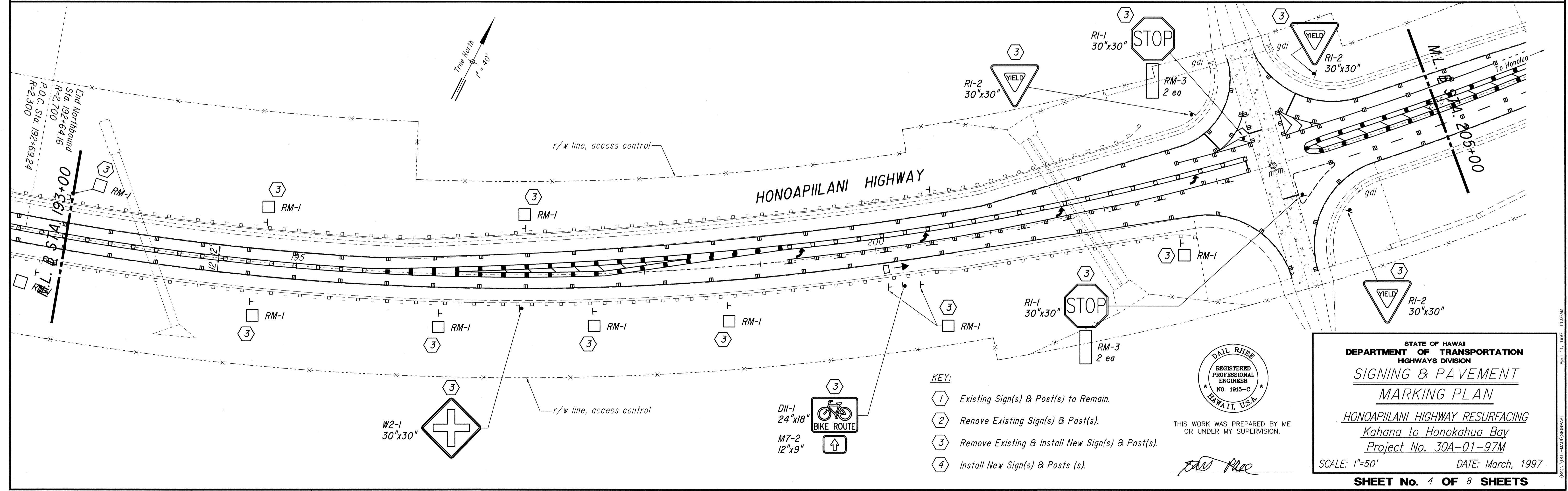
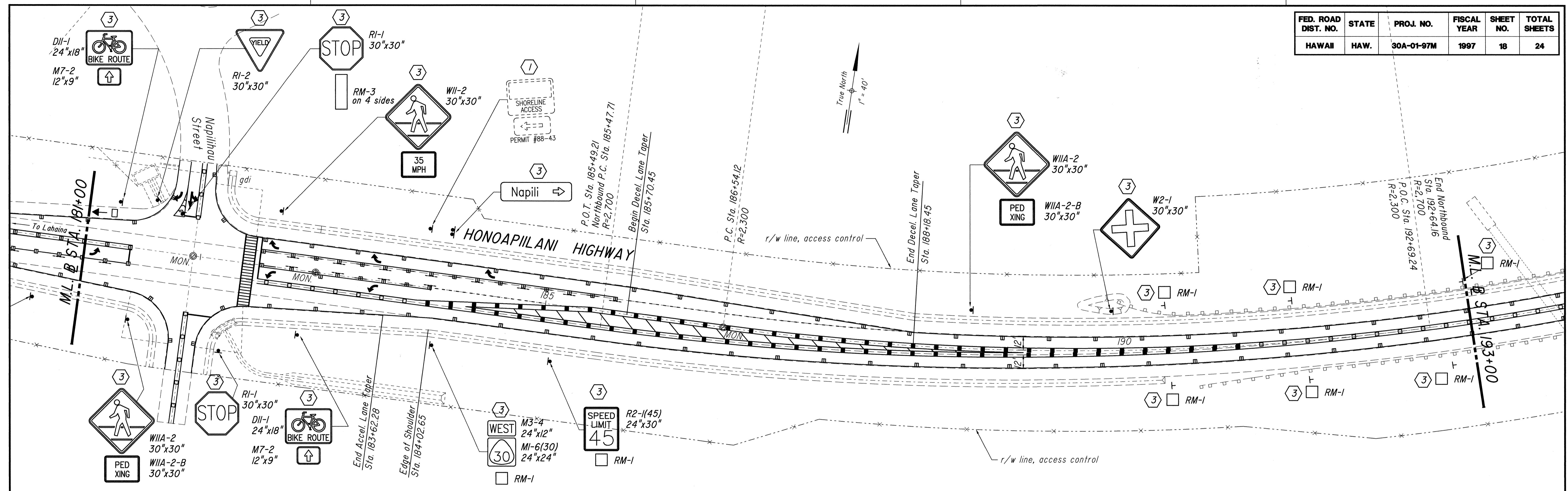

DATE
SURVEY PLOTTED BY
DRAWN BY
TRACED BY
DESIGNED BY
QUANTITIES BY
CHECKED BY
ORIGINAL PLAN
NOTE BOOK
No.

- KEY:
- ① Existing Sign(s) & Post(s) to Remain.
 - ② Remove Existing Sign(s) & Post(s).
 - ③ Remove Existing & Install New Sign(s) & Post(s).
 - ④ Install New Sign(s) & Posts (s).

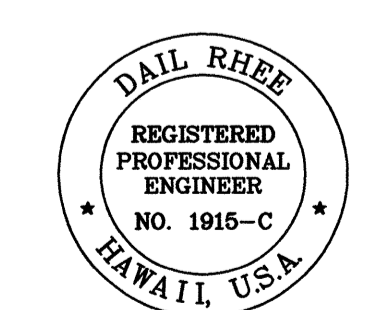

THIS WORK WAS PREPARED BY ME OR UNDER MY SUPERVISION.

Dail Rhee

STATE OF HAWAII
DEPARTMENT OF TRANSPORTATION
HIGHWAYS DIVISION
SIGNING & PAVEMENT MARKING PLAN
HONOAPIILANI HIGHWAY RESURFACING
Kahana to Honokahua Bay
Project No. 30A-01-97M
SCALE: 1"=50' DATE: March, 1997
SHEET No. 4 OF 8 SHEETS

FED. ROAD DIST. NO.	STATE	PROJ. NO.	FISCAL YEAR	SHEET NO.	TOTAL SHEETS
HAWAII	HAW.	30A-01-97M	1997	19	24

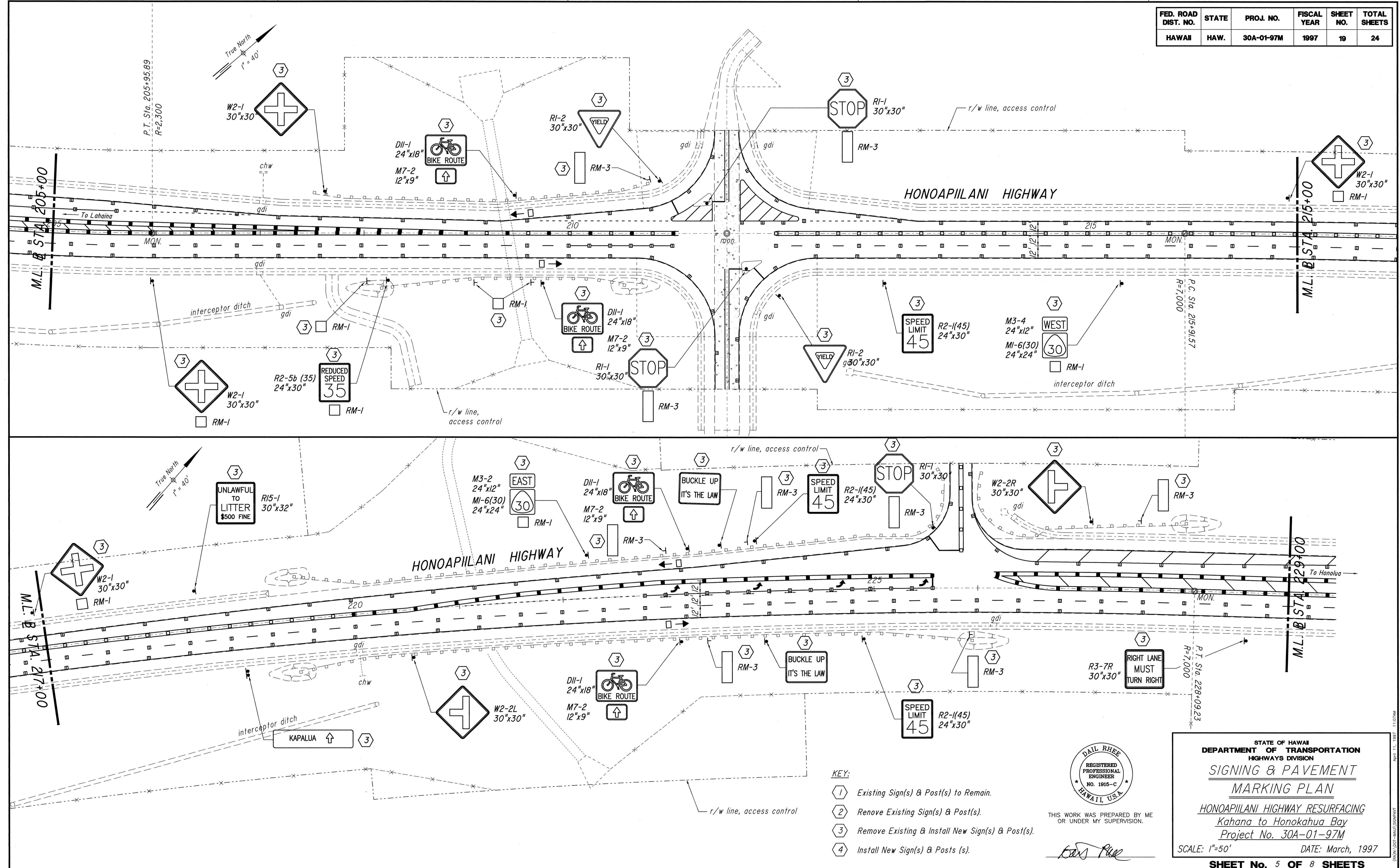

SURVEY PLOTTED BY: _____ DATE: _____
 ORIGINAL PLAN: _____
 DRAWN BY: _____
 TRACED BY: _____
 NOTE BOOK: _____
 DESIGNED BY: _____
 CHECKED BY: _____
 No. _____

- KEY:**
- ① Existing Sign(s) & Post(s) to Remain.
 - ② Remove Existing Sign(s) & Post(s).
 - ③ Remove Existing & Install New Sign(s) & Post(s).
 - ④ Install New Sign(s) & Posts (s).



THIS WORK WAS PREPARED BY ME OR UNDER MY SUPERVISION.

[Signature]

STATE OF HAWAII
 DEPARTMENT OF TRANSPORTATION
 HIGHWAYS DIVISION
SIGNING & PAVEMENT MARKING PLAN
 HONOAPIILANI HIGHWAY RESURFACING
 Kahana to Honokahua Bay
 Project No. 30A-01-97M
 SCALE: 1"=50' DATE: March, 1997
SHEET No. 5 OF 8 SHEETS

FED. ROAD DIST. NO.	STATE	PROJ. NO.	FISCAL YEAR	SHEET NO.	TOTAL SHEETS
HAWAII	HAW.	30A-01-97M	1997	20	24

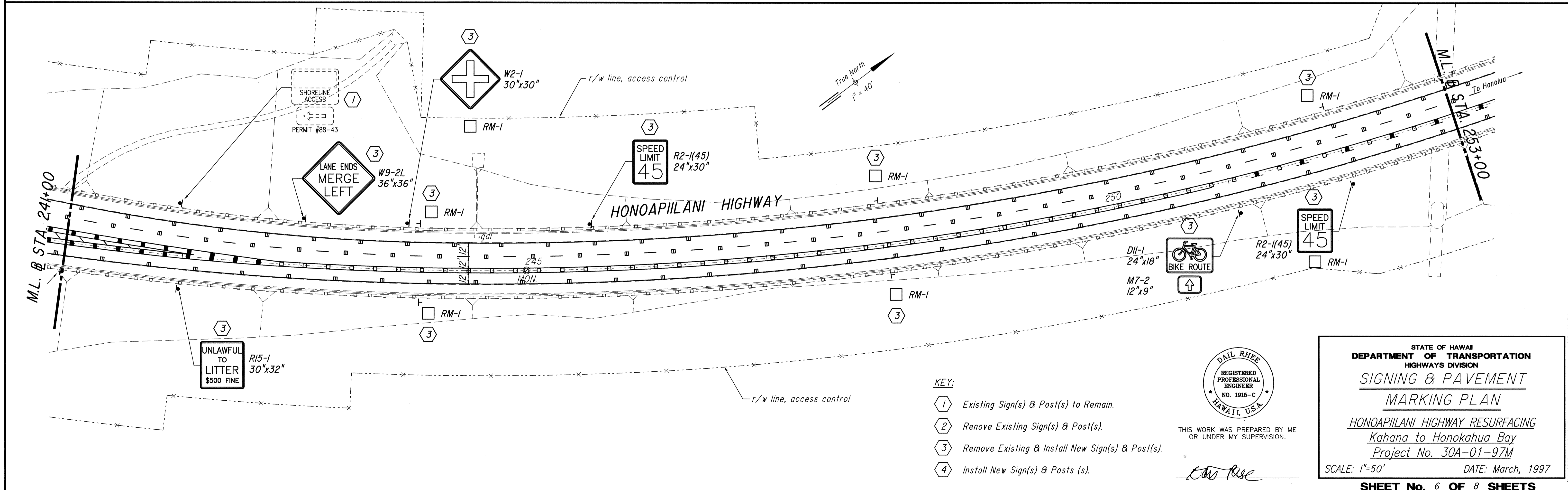
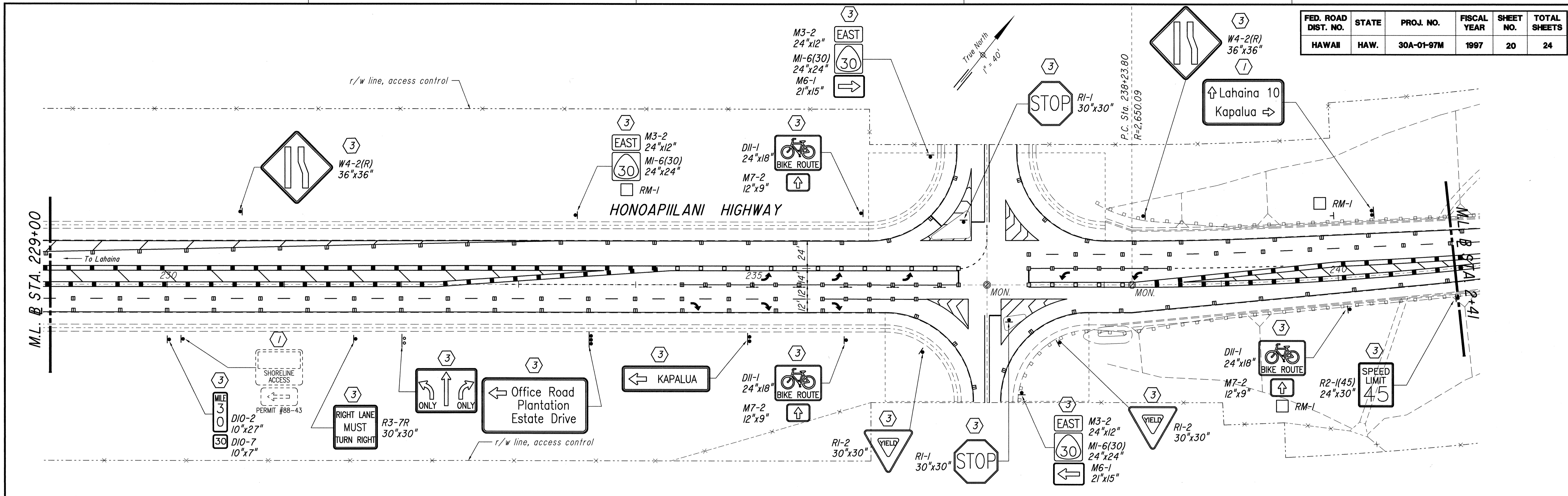

SURVEY PLOTTED BY _____ DATE _____
 DRAWN BY _____
 TRACED BY _____
 NOTE BOOK _____
 QUANTITIES BY _____
 CHECKED BY _____
 No. _____

- KEY:
- ① Existing Sign(s) & Post(s) to Remain.
 - ② Remove Existing Sign(s) & Post(s).
 - ③ Remove Existing & Install New Sign(s) & Post(s).
 - ④ Install New Sign(s) & Posts (s).



THIS WORK WAS PREPARED BY ME OR UNDER MY SUPERVISION.

Dail Rhee

STATE OF HAWAII
 DEPARTMENT OF TRANSPORTATION
 HIGHWAYS DIVISION
SIGNING & PAVEMENT MARKING PLAN
 HONOAPIILANI HIGHWAY RESURFACING
 Kahana to Honokahua Bay
 Project No. 30A-01-97M
 SCALE: 1"=50' DATE: March, 1997
SHEET No. 6 OF 8 SHEETS

FED. ROAD DIST. NO.	STATE	PROJ. NO.	FISCAL YEAR	SHEET NO.	TOTAL SHEETS
HAWAII	HAW.	30A-01-97M	1997	21	24

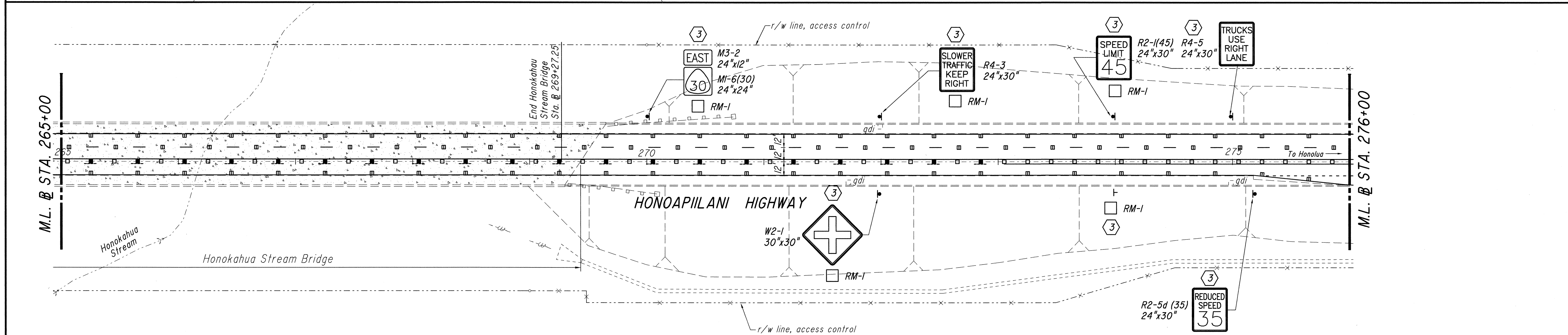
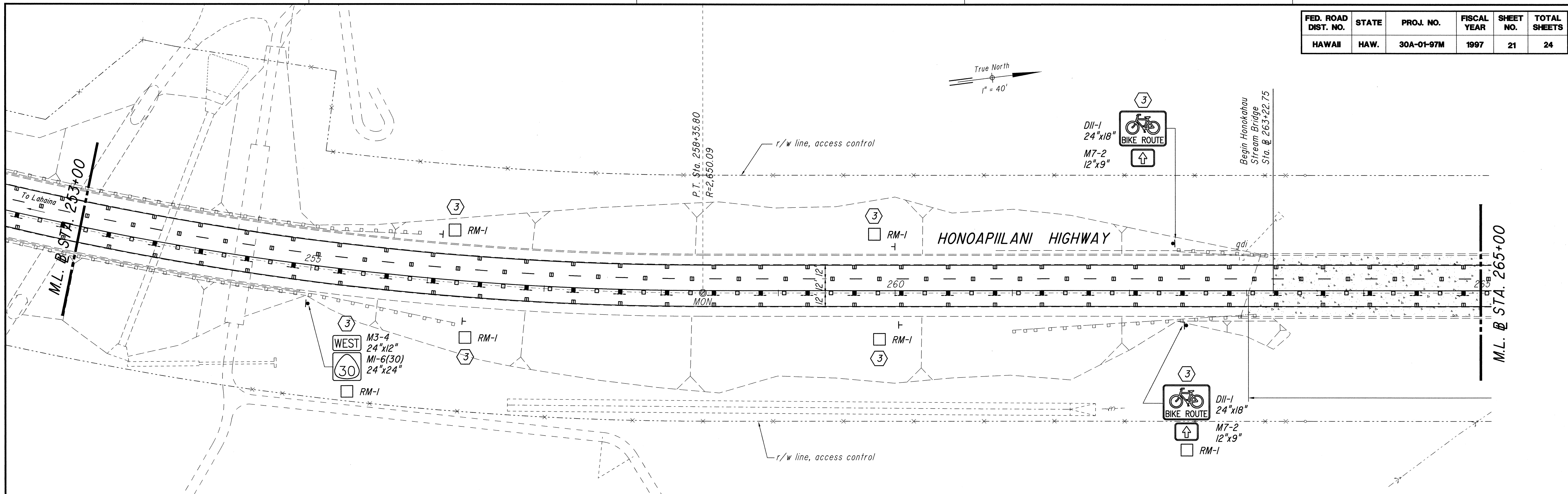

DATE: _____
 SURVEY PLOTTED BY: _____
 DRAWN BY: _____
 TRACED BY: _____
 NOTE BOOK NO.: _____
 CHECKED BY: _____
 No. _____

- KEY:
- ① Existing Sign(s) & Post(s) to Remain.
 - ② Remove Existing Sign(s) & Post(s).
 - ③ Remove Existing & Install New Sign(s) & Post(s).
 - ④ Install New Sign(s) & Posts (s).

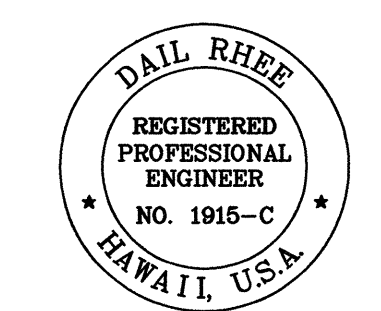

THIS WORK WAS PREPARED BY ME OR UNDER MY SUPERVISION.

Dail Rhee

STATE OF HAWAII
 DEPARTMENT OF TRANSPORTATION
 HIGHWAYS DIVISION
SIGNING & PAVEMENT
MARKING PLAN
 HONOAPIILANI HIGHWAY RESURFACING
 Kahana to Honokahua Bay
 Project No. 30A-01-97M
 SCALE: 1"=50' DATE: March, 1997
SHEET No. 7 OF 8 SHEETS

