

FED. ROAD DIST. NO.	STATE	PROJ. NO.	FISCAL YEAR	SHEET NO.	TOTAL SHEETS
HAWAII	HAW.	30A-01-97M	1997	23	24

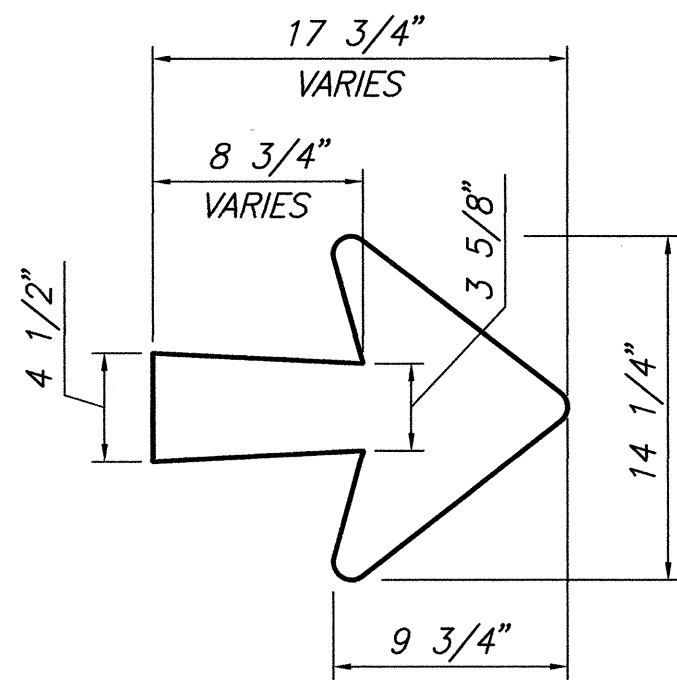

ARROW "A"

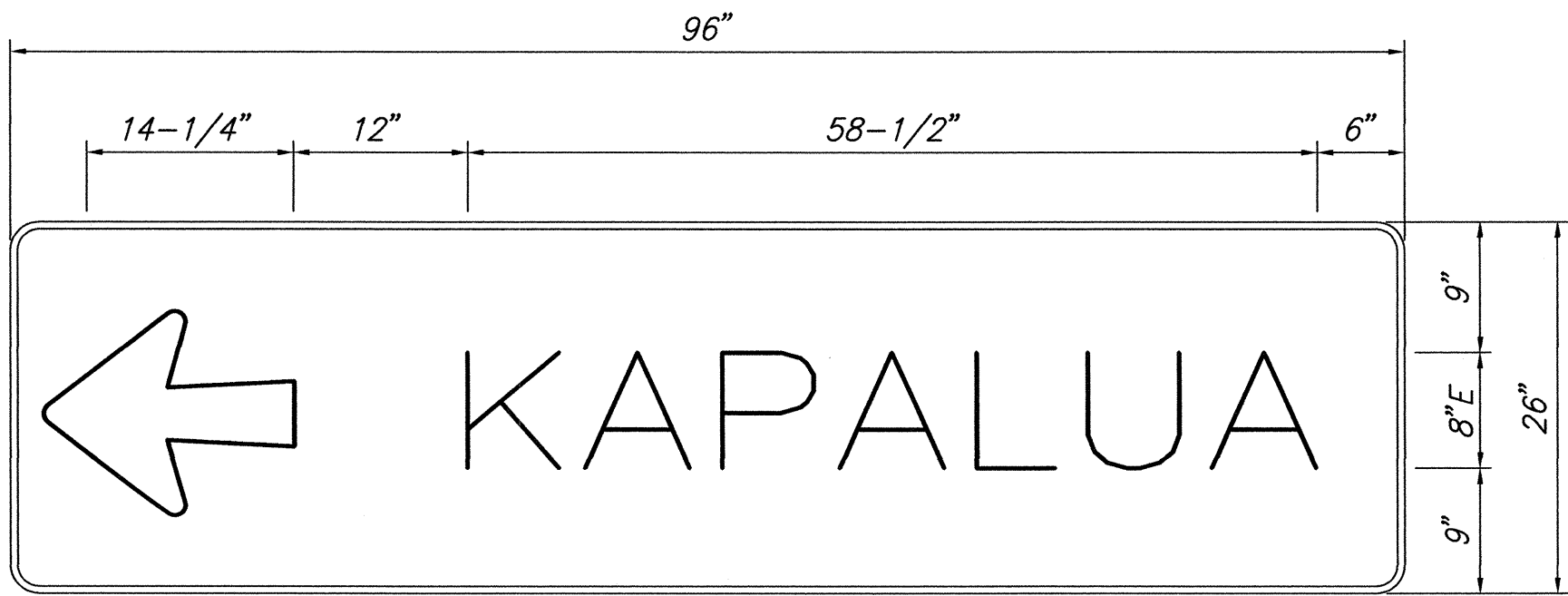
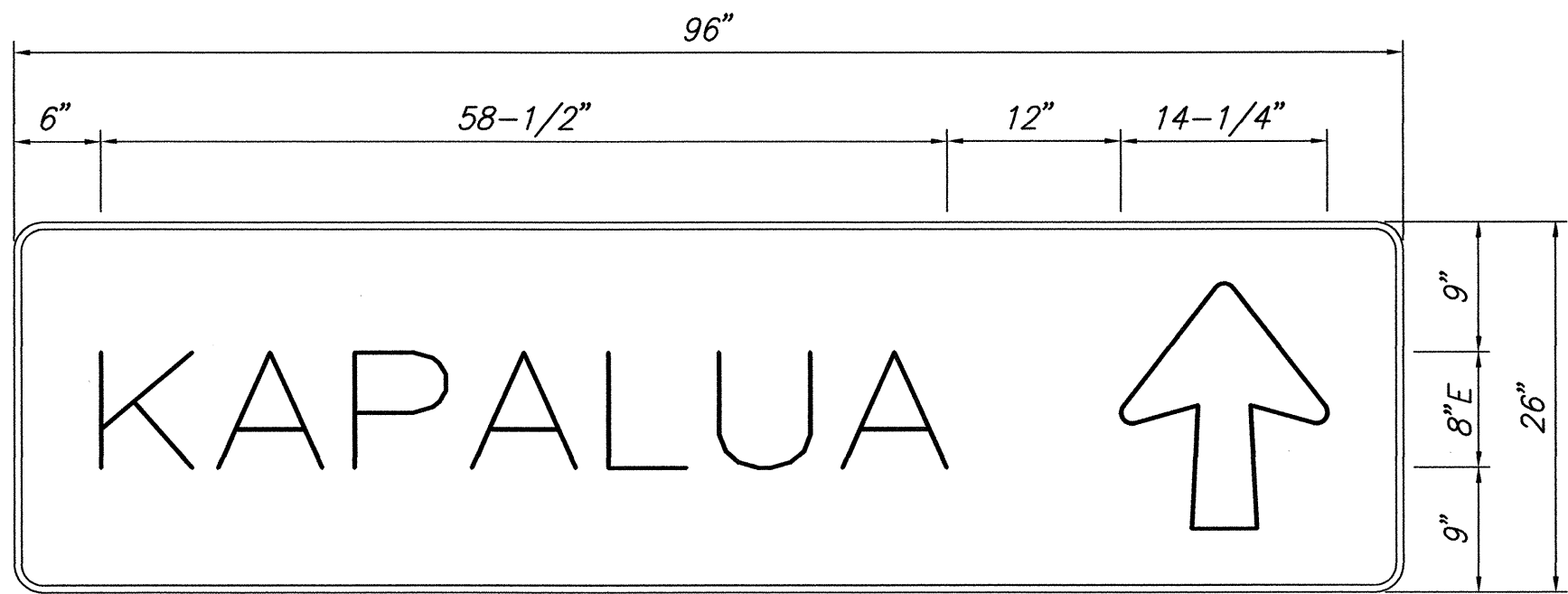
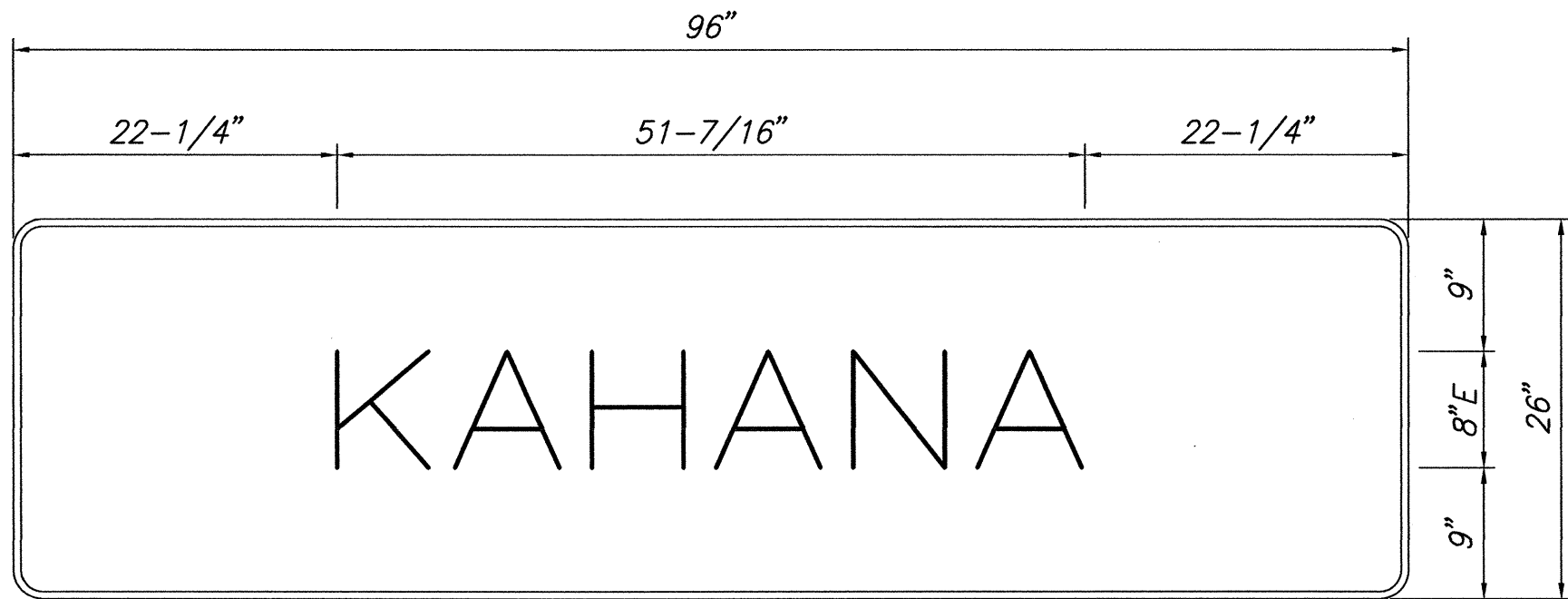
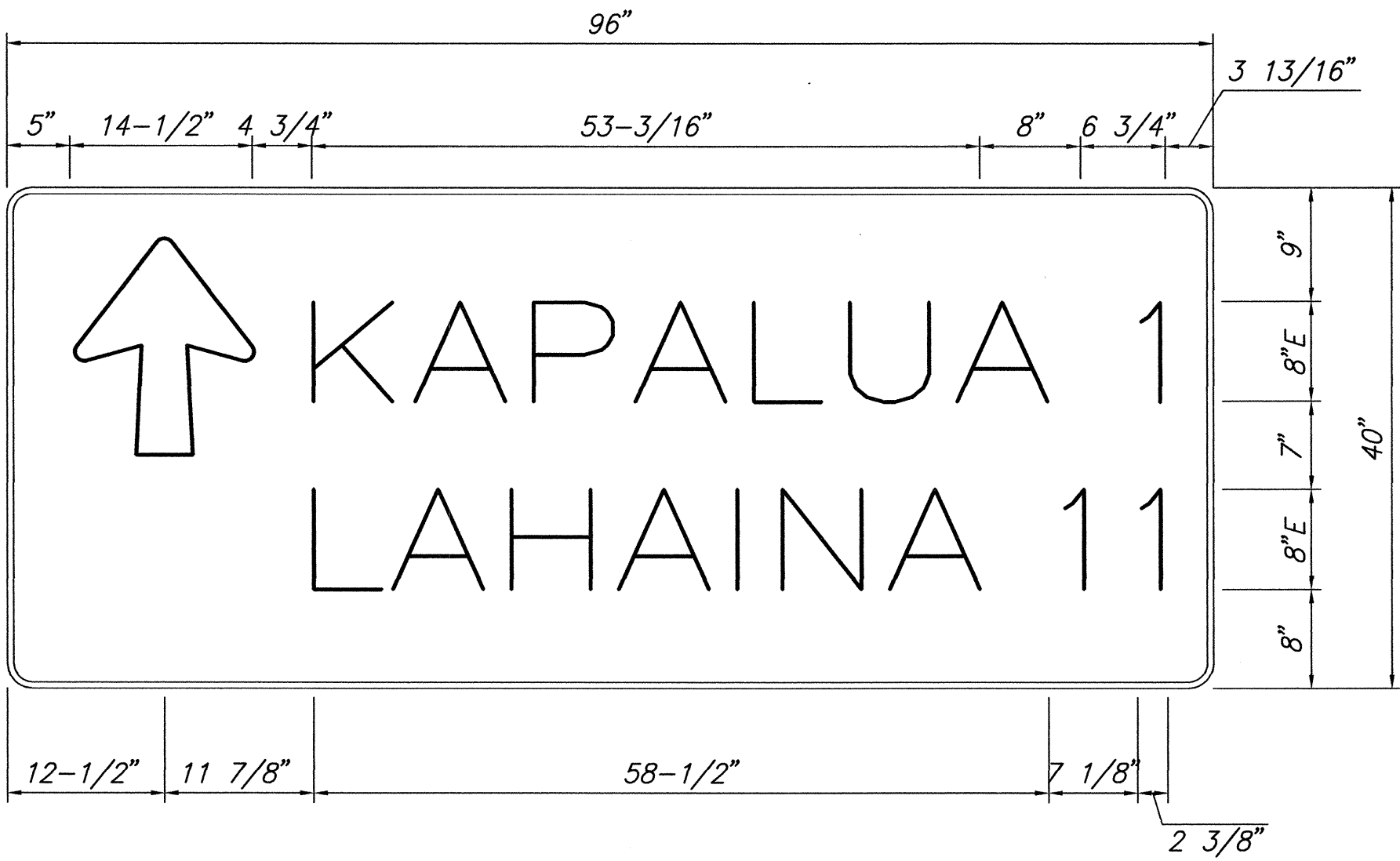
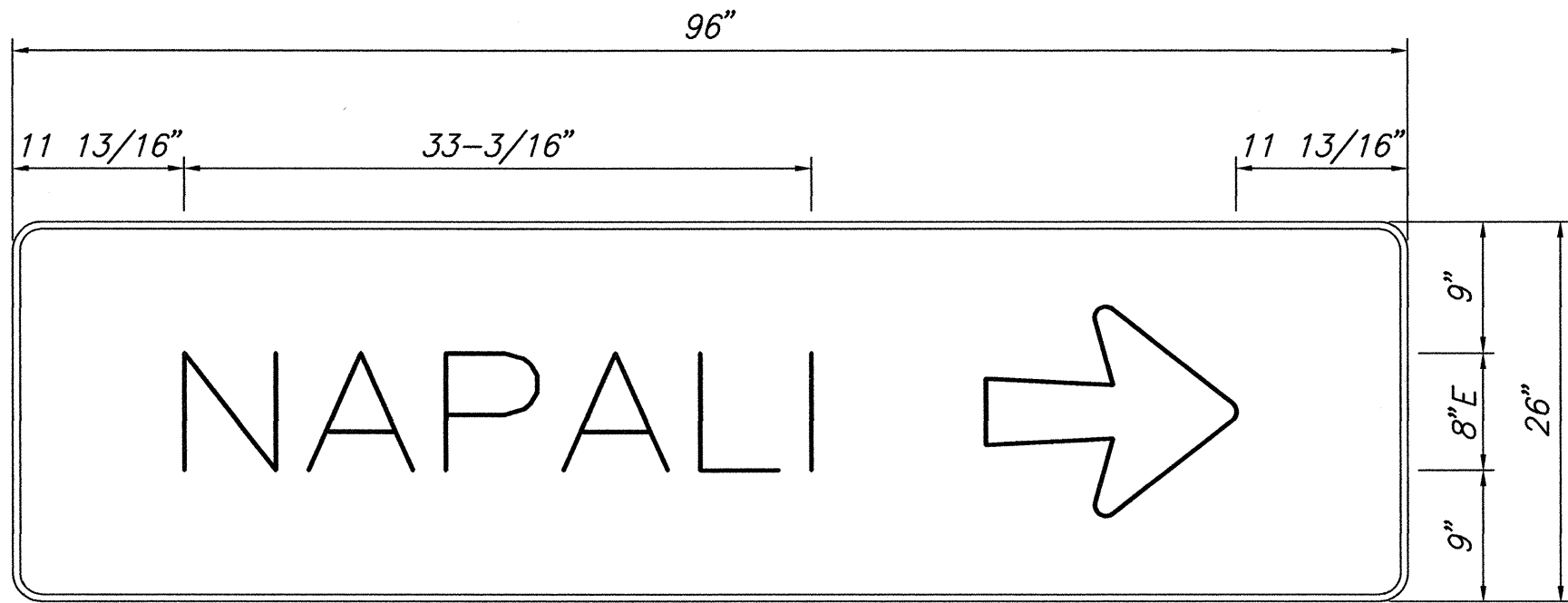
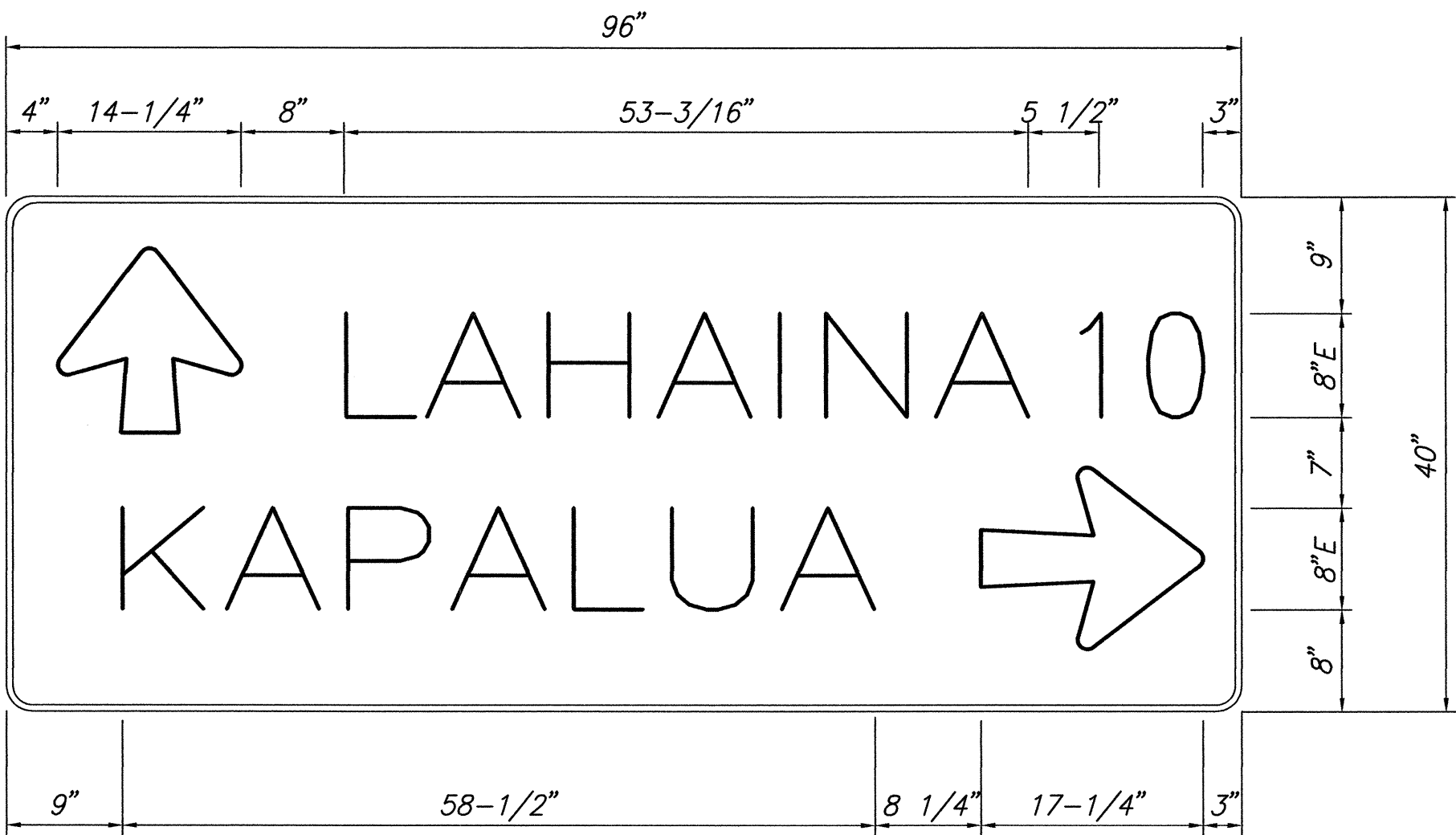
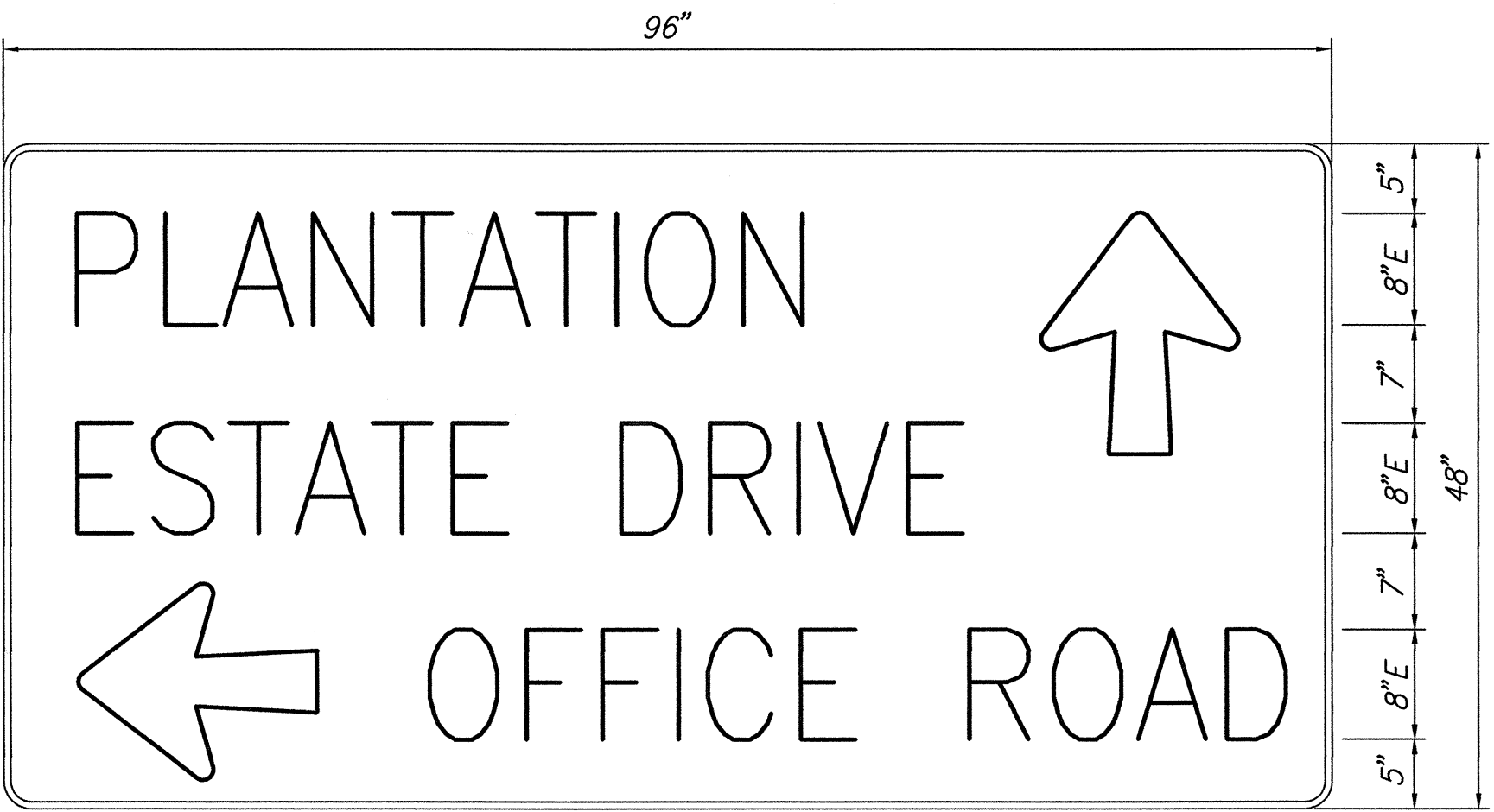

THIS WORK WAS PREPARED BY ME OR UNDER MY SUPERVISION.

*Dail Rhee*

STATE OF HAWAII  
DEPARTMENT OF TRANSPORTATION  
HIGHWAYS DIVISION

SIGN DETAILS

HONOAPIILANI HIGHWAY RESURFACING  
Kahana to Honokahua Bay  
Project No. 30A-01-97M

SCALE: As Shown      DATE: March, 1997

SHEET No. 1 OF 1 SHEETS