

FED. ROAD DIST. NO.	STATE	FED. AID PROJ. NO.	FISCAL YEAR	SHEET NO.	TOTAL SHEETS
HAWAII	HAW.	NH-030-I(38)	2010	63	213

**STRIPING LEGEND**

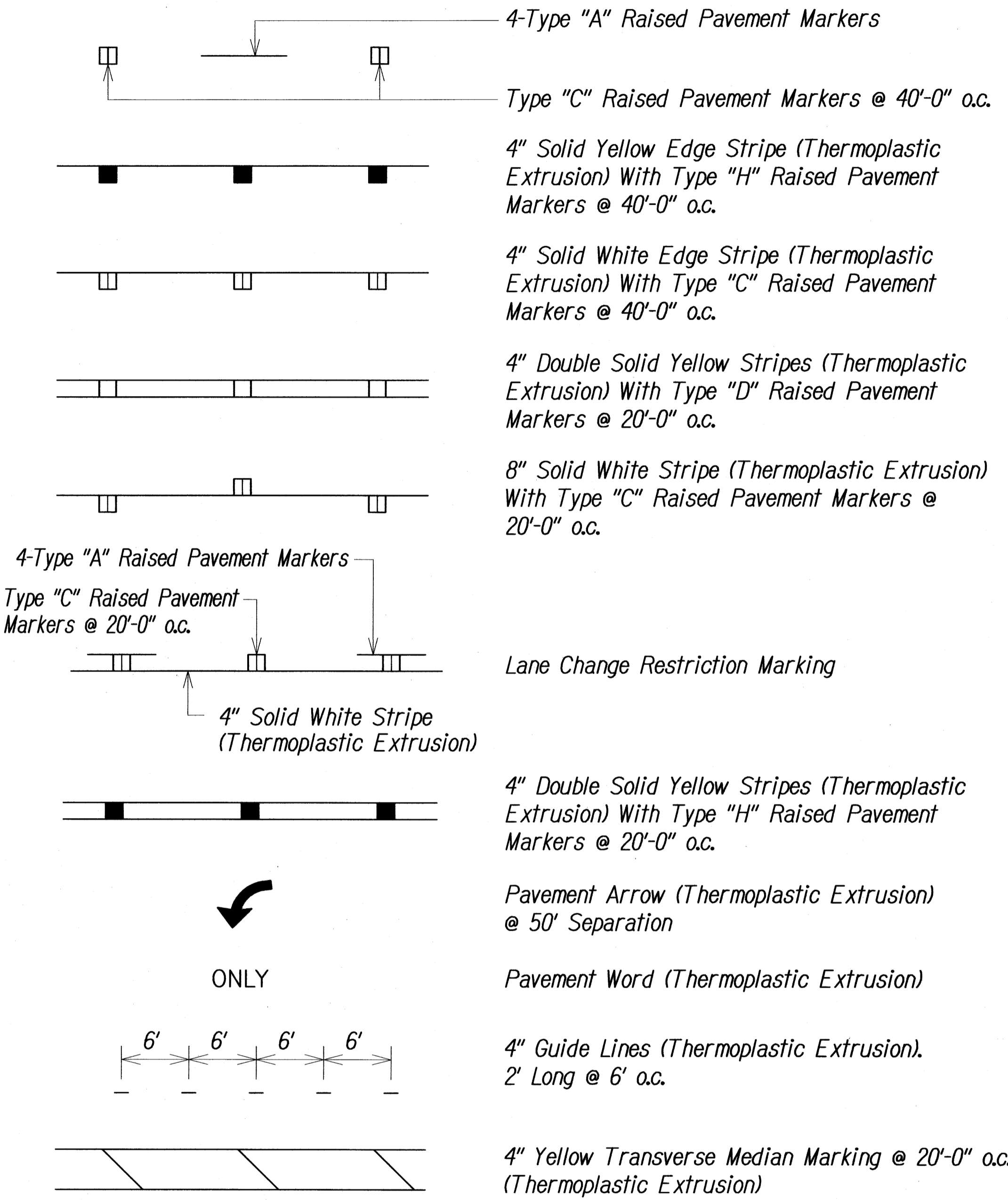

**NOTES**

- Layout of pavement markings and striping shall be done by the Contractor and approved by the Engineer prior to any installation work.
- Existing pavement markings not incorporated in the final traffic pattern shall be removed as directed by the Engineer. Costs shall be incidental to the various pavement marking items.
- Raised pavement markers shall not be installed within crosswalks.
- Final locations of all signs shall be approved by the Engineer prior to any installation work.
- Existing signs not shown on these plans shall remain as posted unless otherwise directed by the Engineer. Removal and disposal of existing signs and/or posts as designated on these plans shall be incidental to the various signing items.
- Final locations of all stop lines shall be approved by the Engineer prior to installation.
- All pavement striping shall be as noted on the legend or plans.
- All preformed pavement marking tapes over existing pavement shall be applied with an approved primer as recommended by the tape manufacturer and as approved by the Engineer. The primer shall be allowed to dry to the tacky stage prior to tape application.
- Pavement marking and striping shall conform to the latest "Manual on Uniform Traffic Control Devices for Streets and Highways" and as amended.
- Edge lines shall not be continued through intersections and shall not be broken for driveways unless otherwise shown or directed.

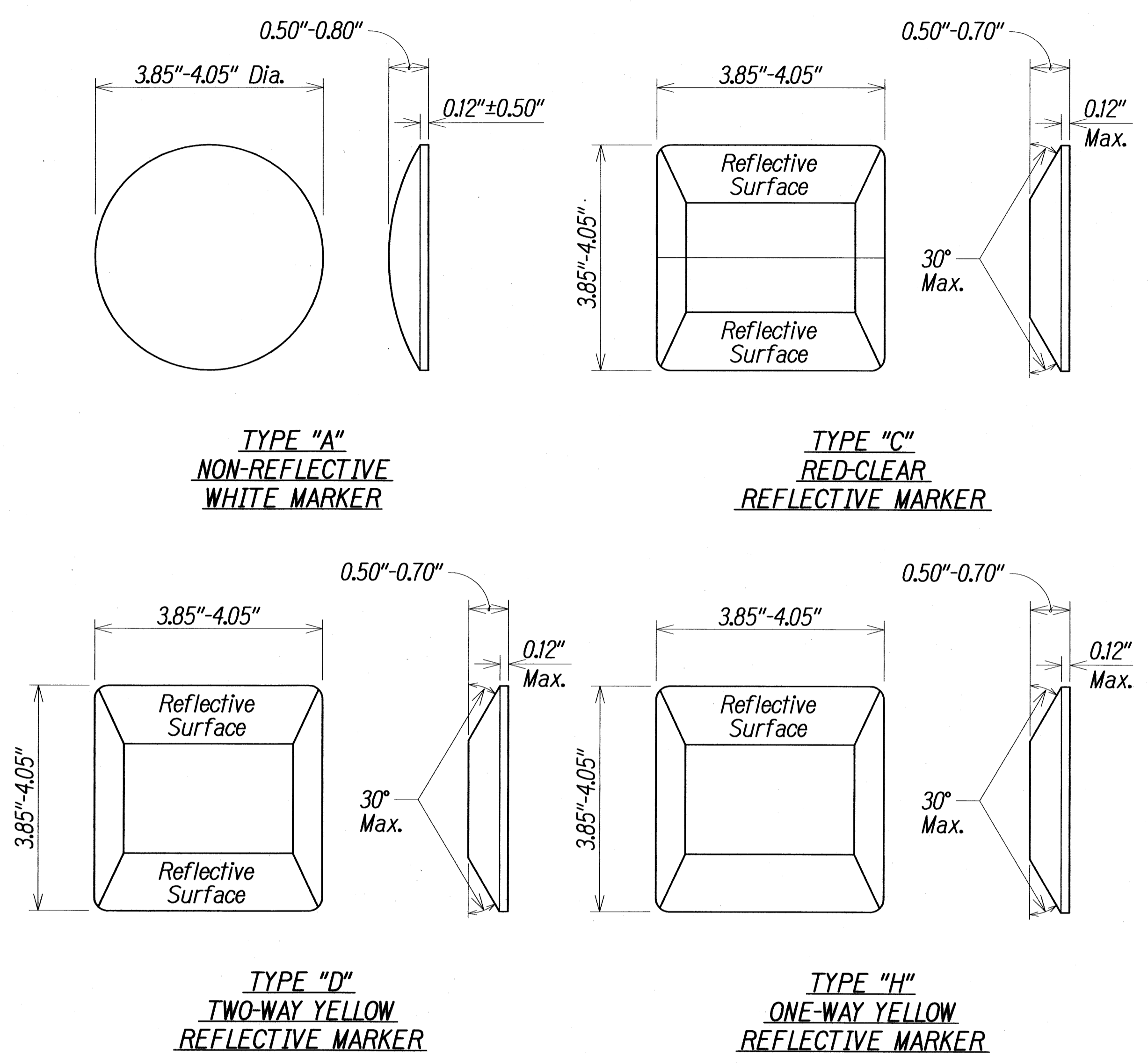

**STANDARD RAISED PAVEMENT MARKER DETAILS**  
Not to Scale

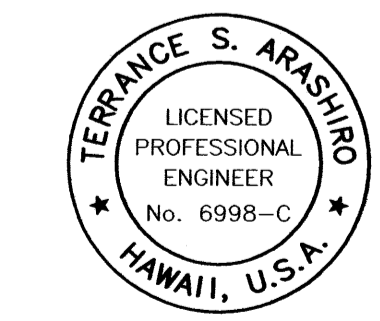

EXP. 4/30/10  
THIS WORK WAS PREPARED BY ME OR UNDER MY SUPERVISION AND CONSTRUCTION OF THIS PROJECT WILL BE UNDER MY OBSERVATION

STATE OF HAWAII  
DEPARTMENT OF TRANSPORTATION  
HIGHWAYS DIVISION

**PAVEMENT MARKING LEGEND,  
NOTES & DETAILS**

HONOAPIILANI HIGHWAY REALIGNMENT, PHASE 1B-1  
Lahainaluna Rd. to Hokiokio Pl.  
Federal Aid Project NO. NH-030-I(38)

Scale: As Shown Date: November 23, 2009

SHEET No. 1 OF 2 SHEETS

FED. ROAD DIST. NO.	STATE	FED. AID PROJ. NO.	FISCAL YEAR	SHEET NO.	TOTAL SHEETS
HAWAII	HAW.	NH-030-I(38)	2010	64	213

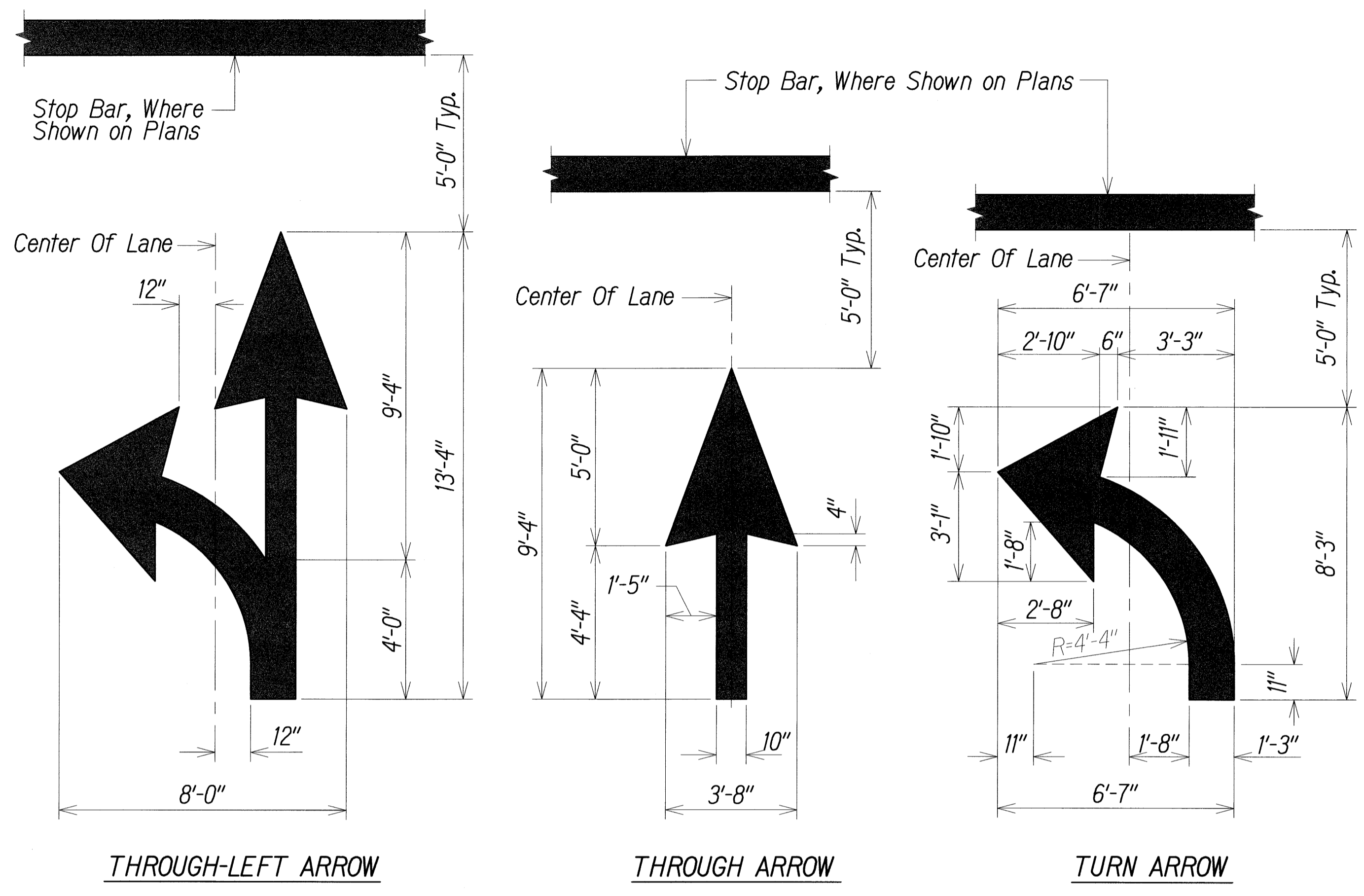

**TYPICAL PAVEMENT ARROW DETAILS**  
 Not to Scale

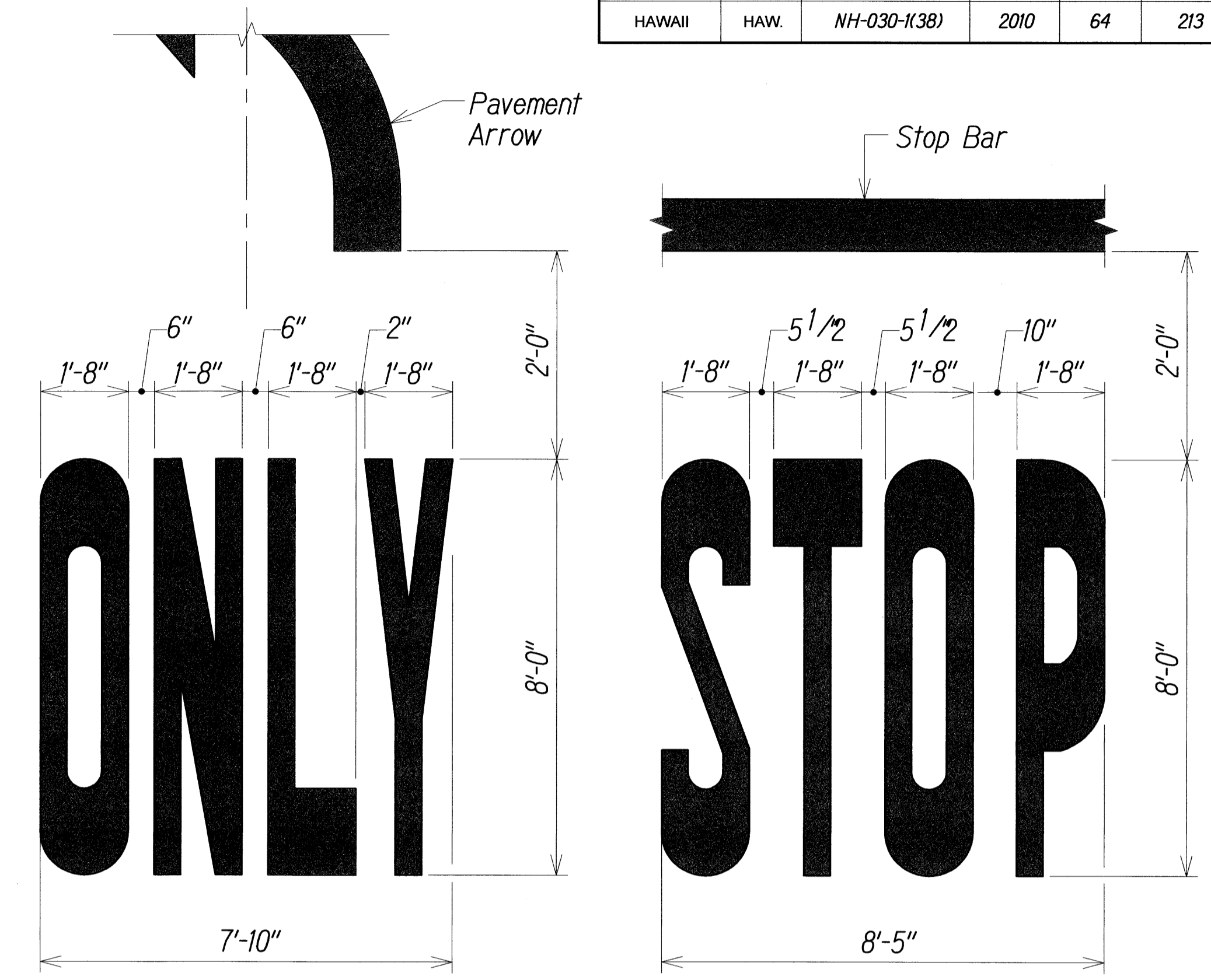
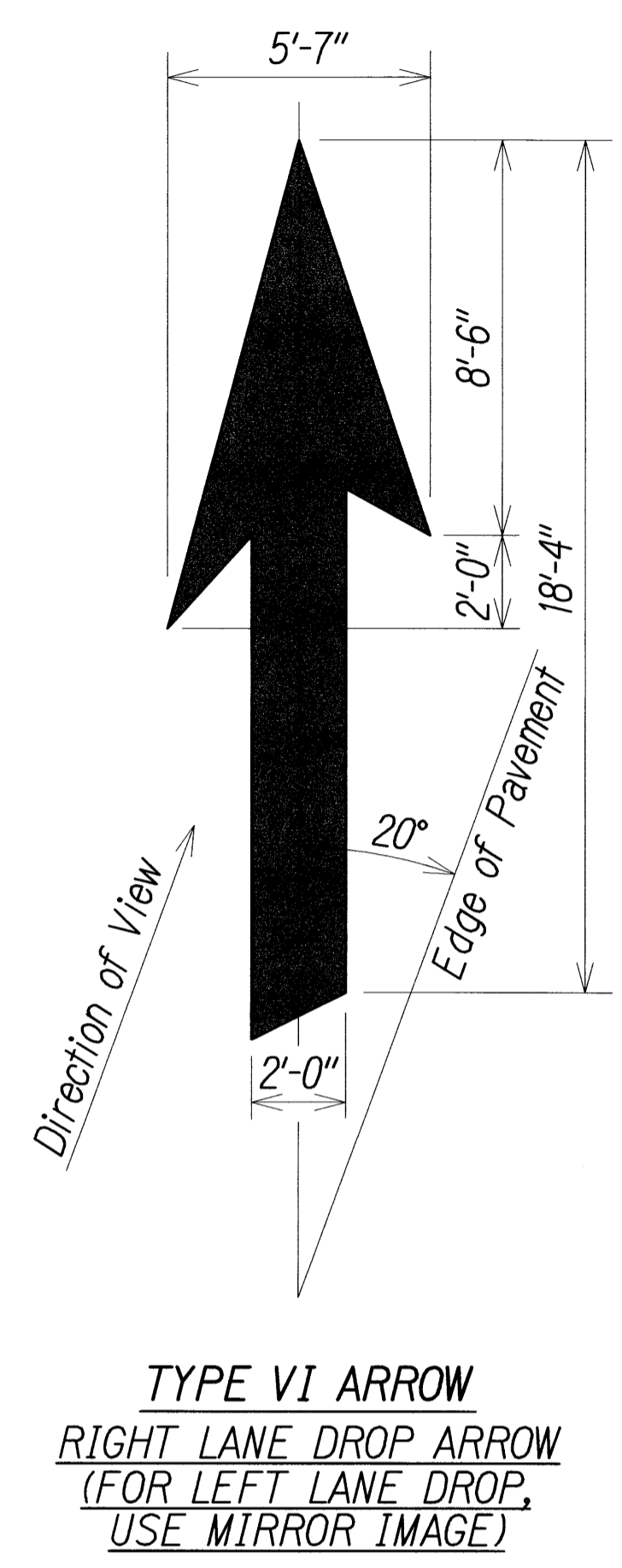

**PAVEMENT WORD DETAILS**  
 Not to Scale

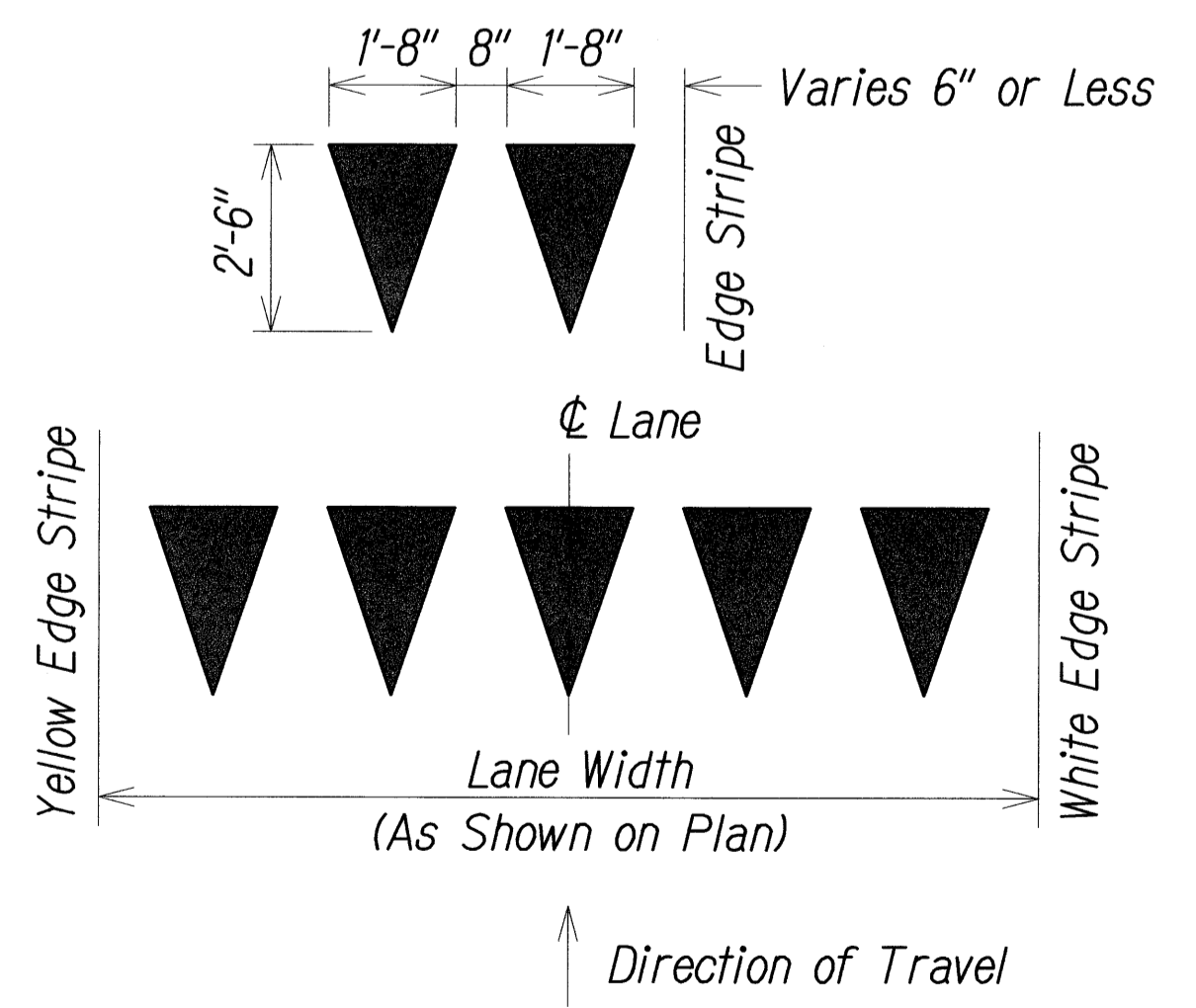

**YIELD LINE**  
 Not to Scale

TERENCE S. ARASHIRO  
 LICENSED PROFESSIONAL ENGINEER  
 No. 6998-C  
 HAWAII, U.S.A.

*T. S. Arashiro*  
 EXP. 4/30/10  
 THIS WORK WAS PREPARED BY ME OR UNDER MY SUPERVISION AND CONSTRUCTION OF THIS PROJECT WILL BE UNDER MY OBSERVATION

STATE OF HAWAII  
 DEPARTMENT OF TRANSPORTATION  
 HIGHWAYS DIVISION

**PAVEMENT MARKING DETAILS**

HONOAPIILANI HIGHWAY REALIGNMENT, PHASE 1B-1  
 Lahainaluna Rd. to Hokiokio Pl.  
 Federal Aid Project NO. NH-030-I(38)

Scale: As Shown Date: November 23, 2009

SHEET No. 2 OF 2 SHEETS

FED. ROAD DIST. NO.	STATE	FED. AID PROJ. NO.	FISCAL YEAR	SHEET NO.	TOTAL SHEETS
HAWAII	HAW.	NH-030-1(38)	2010	65	213

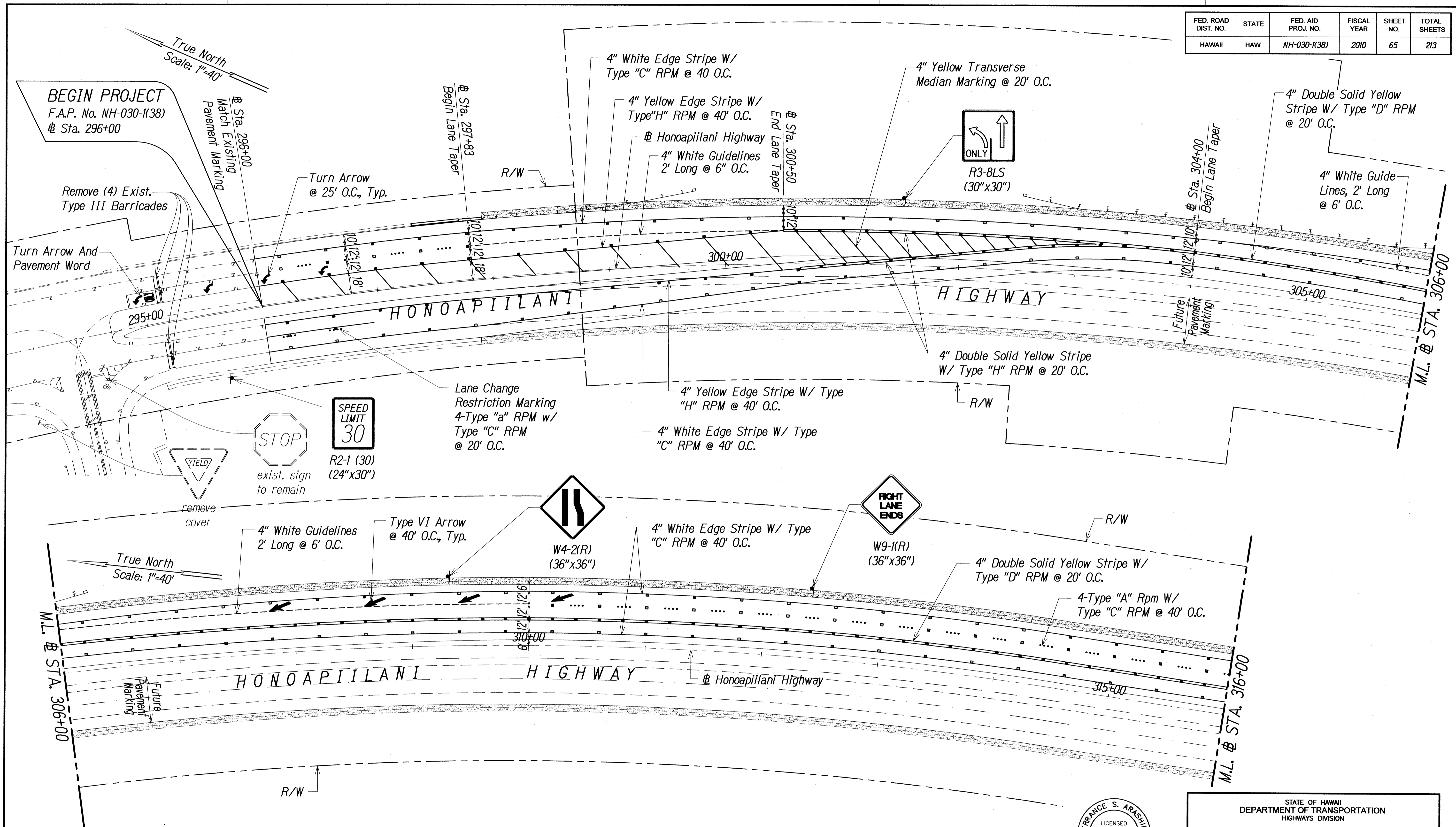

**BEGIN PROJECT**  
F.A.P. No. NH-030-1(38)  
@ Sta. 296+00

Remove (4) Exist. Type III Barricades

Turn Arrow And Pavement Word

Turn Arrow @ 25' O.C., Typ.

STOP  
exist. sign to remain

SPEED LIMIT 30  
R2-1 (30) (24"x30")

Lane Change Restriction Marking  
4-Type "a" RPM w/ Type "C" RPM @ 20' O.C.

W4-2(R) (36"x36")

RIGHT LANE ENDS  
W9-1(R) (36"x36")

R3-8LS (30"x30")

4" White Edge Stripe W/ Type "C" RPM @ 40' O.C.

4" Yellow Edge Stripe W/ Type "H" RPM @ 40' O.C.

4" White Guidelines 2' Long @ 6" O.C.

4" Yellow Transverse Median Marking @ 20' O.C.

4" Double Solid Yellow Stripe W/ Type "D" RPM @ 20' O.C.

4" White Guidelines, 2' Long @ 6" O.C.

4" Double Solid Yellow Stripe W/ Type "H" RPM @ 20' O.C.

4" Yellow Edge Stripe W/ Type "H" RPM @ 40' O.C.

4" White Edge Stripe W/ Type "C" RPM @ 40' O.C.

4" Double Solid Yellow Stripe W/ Type "D" RPM @ 20' O.C.

4-Type "A" Rpm W/ Type "C" RPM @ 40' O.C.

4" White Edge Stripe W/ Type "C" RPM @ 40' O.C.

4" White Guidelines 2' Long @ 6" O.C.

Type VI Arrow @ 40' O.C., Typ.

True North Scale: 1"=40'

M.L. @ STA. 306+00

M.L. @ STA. 316+00

Note:  
See Sht. 70 for Pavement Marking Connection to Honoapiilani Highway Realignment Phase 1A.

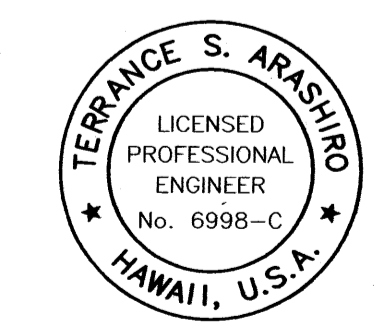

EXP. 4/30/10  
THIS WORK WAS PREPARED BY ME OR UNDER MY SUPERVISION AND CONSTRUCTION OF THIS PROJECT WILL BE UNDER MY OBSERVATION

STATE OF HAWAII  
DEPARTMENT OF TRANSPORTATION  
HIGHWAYS DIVISION

**SIGNAGE & PAVEMENT MARKING PLAN**

HONOAPIILANI HIGHWAY REALIGNMENT, PHASE 1B-1  
Lahainaluna Rd. to Hokiokio Pl.  
Federal Aid Project NO. NH-030-1(38)

Scale: 1" = 40'      Date: November 23, 2009

SHEET No. 1 OF 6 SHEETS

FED. ROAD DIST. NO.	STATE	FED. AID PROJ. NO.	FISCAL YEAR	SHEET NO.	TOTAL SHEETS
HAWAII	HAW.	NH-030-K38	2010	66	213

True North  
Scale: 1"=40'

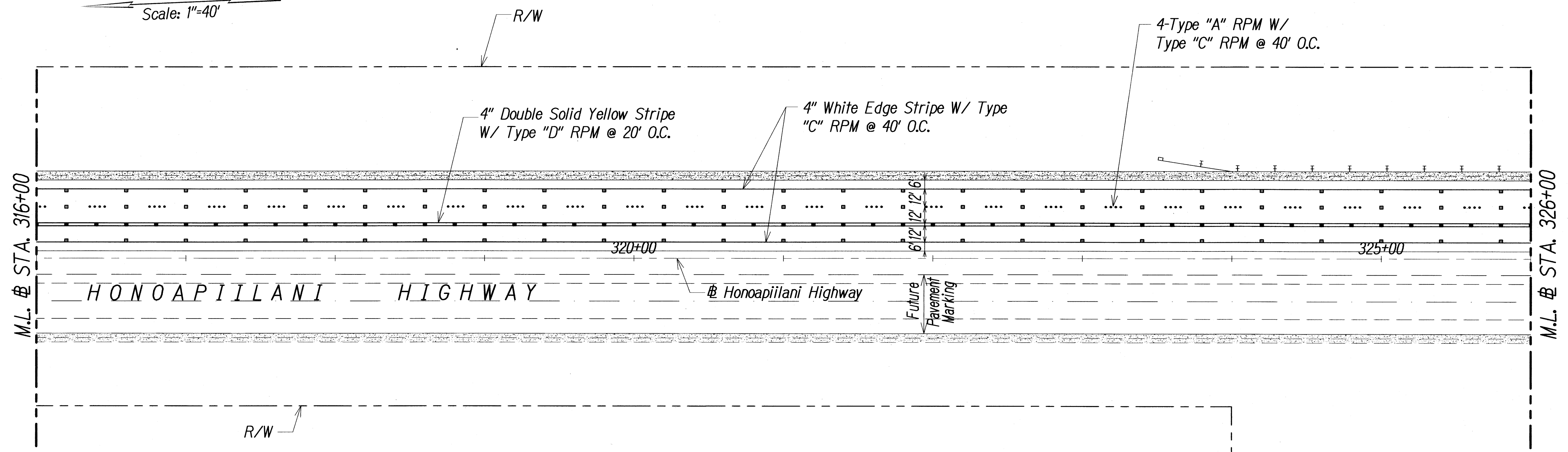

True North  
Scale: 1"=40'

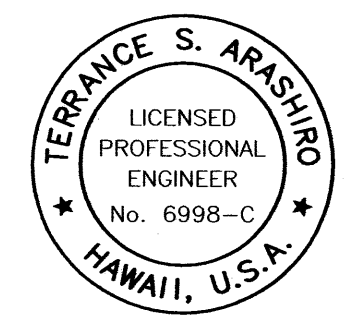
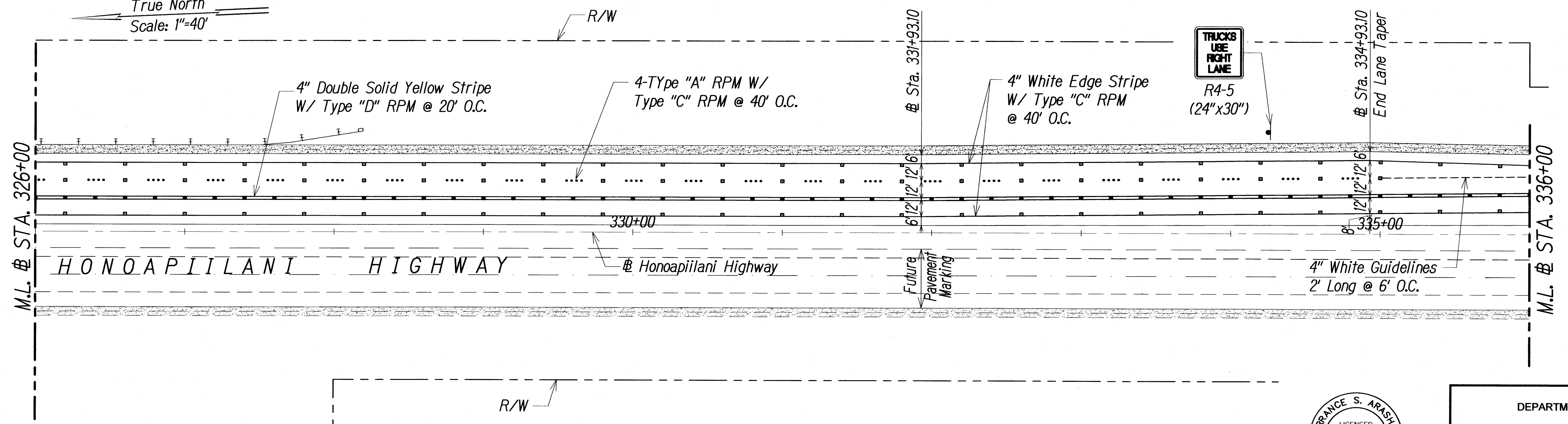

TERRENCE S. ARASIMIO  
L.P.  
LISCENSED PROFESSIONAL ENGINEER  
No. 6998-C  
HAWAII, U.S.A.  
EXP. 4/30/10  
THIS WORK WAS PREPARED BY ME OR UNDER MY SUPERVISION AND CONSTRUCTION OF THIS PROJECT WILL BE UNDER MY OBSERVATION

STATE OF HAWAII  
DEPARTMENT OF TRANSPORTATION  
HIGHWAYS DIVISION

**SIGNAGE & PAVEMENT MARKING PLAN**

HONOAPIILANI HIGHWAY REALIGNMENT, PHASE 1B-1  
Lahainaluna Rd. to Hokiokio Pl.  
Federal Aid Project NO. NH-030-K38

Scale: 1" = 40'      Date: November 23, 2009

FED. ROAD DIST. NO.	STATE	FED. AID PROJ. NO.	FISCAL YEAR	SHEET NO.	TOTAL SHEETS
HAWAII	HAW.	NH-030-1(38)	2010	67	213

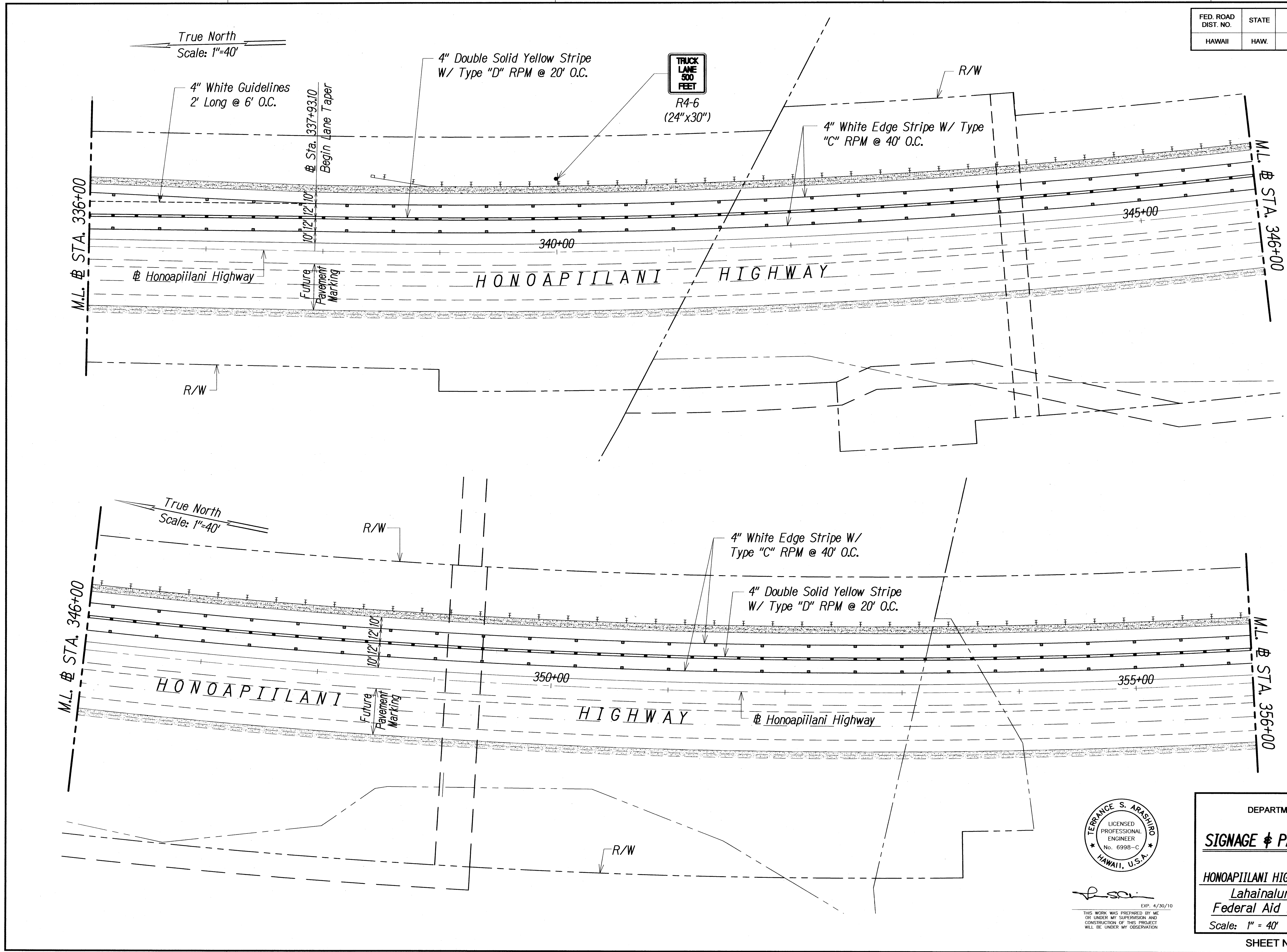

True North  
Scale: 1"=40'

4" White Guidelines  
2' Long @ 6' O.C.

4" Double Solid Yellow Stripe  
W/ Type "D" RPM @ 20' O.C.

TRUCK  
LANE  
500  
FEET  
R4-6  
(24"x30")

4" White Edge Stripe W/ Type  
"C" RPM @ 40' O.C.

M.L. # STA. 336+00

M.L. # STA. 346+00

# Honoapiilani Highway

HONOAPIILANI HIGHWAY

R/W

True North  
Scale: 1"=40'

4" White Edge Stripe W/  
Type "C" RPM @ 40' O.C.

4" Double Solid Yellow Stripe  
W/ Type "D" RPM @ 20' O.C.

M.L. # STA. 346+00

M.L. # STA. 356+00

HONOAPIILANI

HIGHWAY

# Honoapiilani Highway

Future  
Pavement  
Marking

R/W

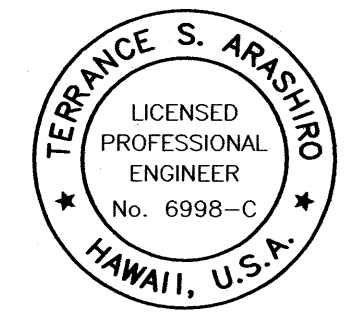

THIS WORK WAS PREPARED BY ME  
OR UNDER MY SUPERVISION AND  
CONSTRUCTION OF THIS PROJECT  
WILL BE UNDER MY OBSERVATION

STATE OF HAWAII  
DEPARTMENT OF TRANSPORTATION  
HIGHWAYS DIVISION

**SIGNAGE & PAVEMENT MARKING PLAN**

HONOAPIILANI HIGHWAY REALIGNMENT, PHASE 1B-1  
Lahainaluna Rd. to Hokiokio Pl.  
Federal Aid Project NO. NH-030-1(38)

Scale: 1" = 40'      Date: November 23, 2009

SHEET No. 3 OF 6 SHEETS

FED. ROAD DIST. NO.	STATE	FED. AID PROJ. NO.	FISCAL YEAR	SHEET NO.	TOTAL SHEETS
HAWAII	HAW.	NH-030-K38)	2010	68	213

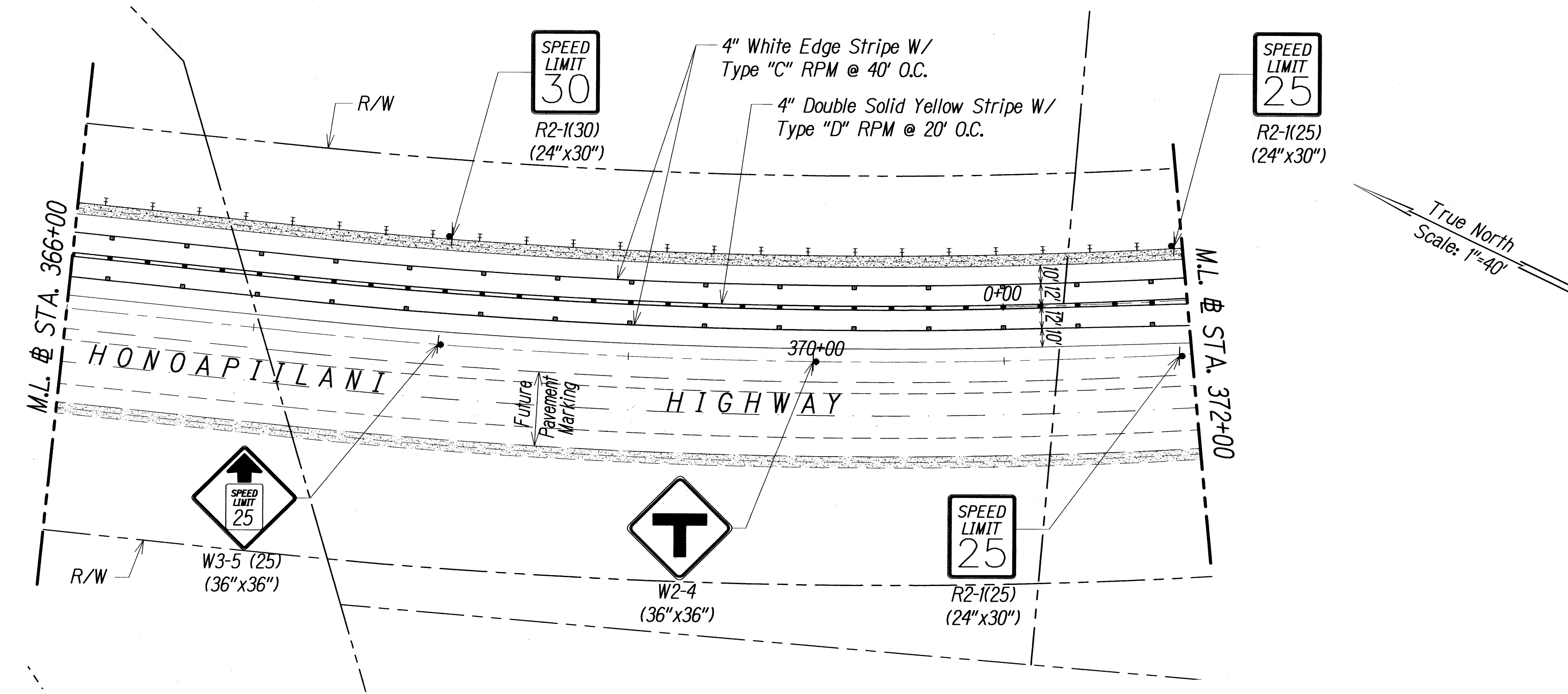
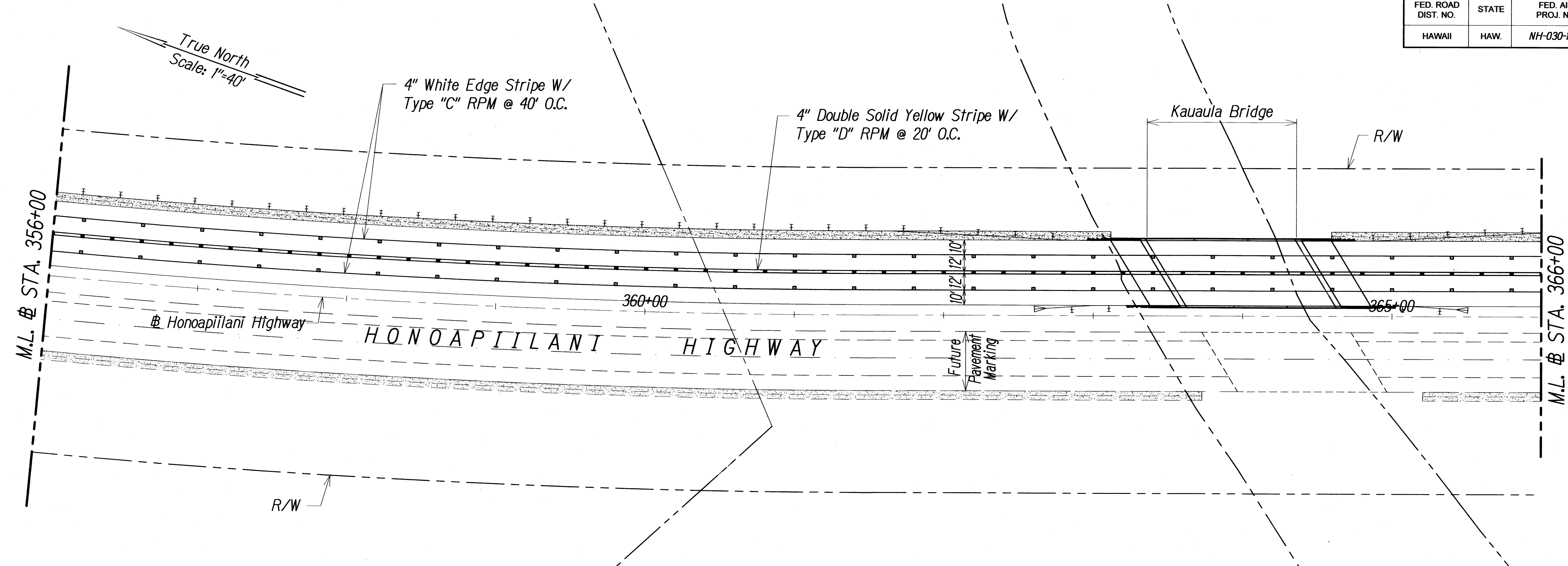

  
 T.S.A.  
 EXP. 4/30/10  
THIS WORK WAS PREPARED BY ME OR UNDER MY SUPERVISION AND CONSTRUCTION OF THIS PROJECT WILL BE UNDER MY OBSERVATION

STATE OF HAWAII  
 DEPARTMENT OF TRANSPORTATION  
 HIGHWAYS DIVISION  
**SIGNAGE & PAVEMENT MARKING PLAN**  
 HONOAPIILANI HIGHWAY REALIGNMENT, PHASE 1B-1  
 Lahainaluna Rd. to Hokiokio Pl.  
 Federal Aid Project NO. NH-030-K38)  
 Scale: 1" = 40'      Date: November 23, 2009  
 SHEET No. 4 OF 6 SHEETS

FED. ROAD DIST. NO.	STATE	FED. AID PROJ. NO.	FISCAL YEAR	SHEET NO.	TOTAL SHEETS
HAWAII	HAW.	NH-030-K38	2010	69	213

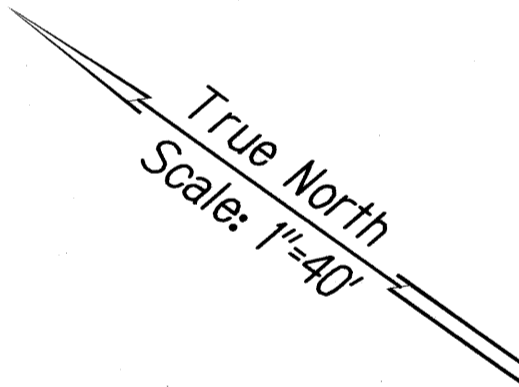
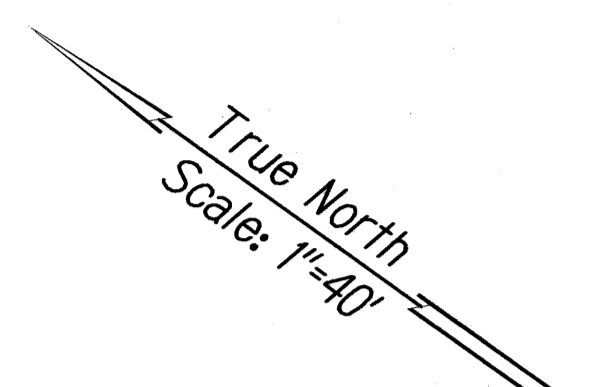
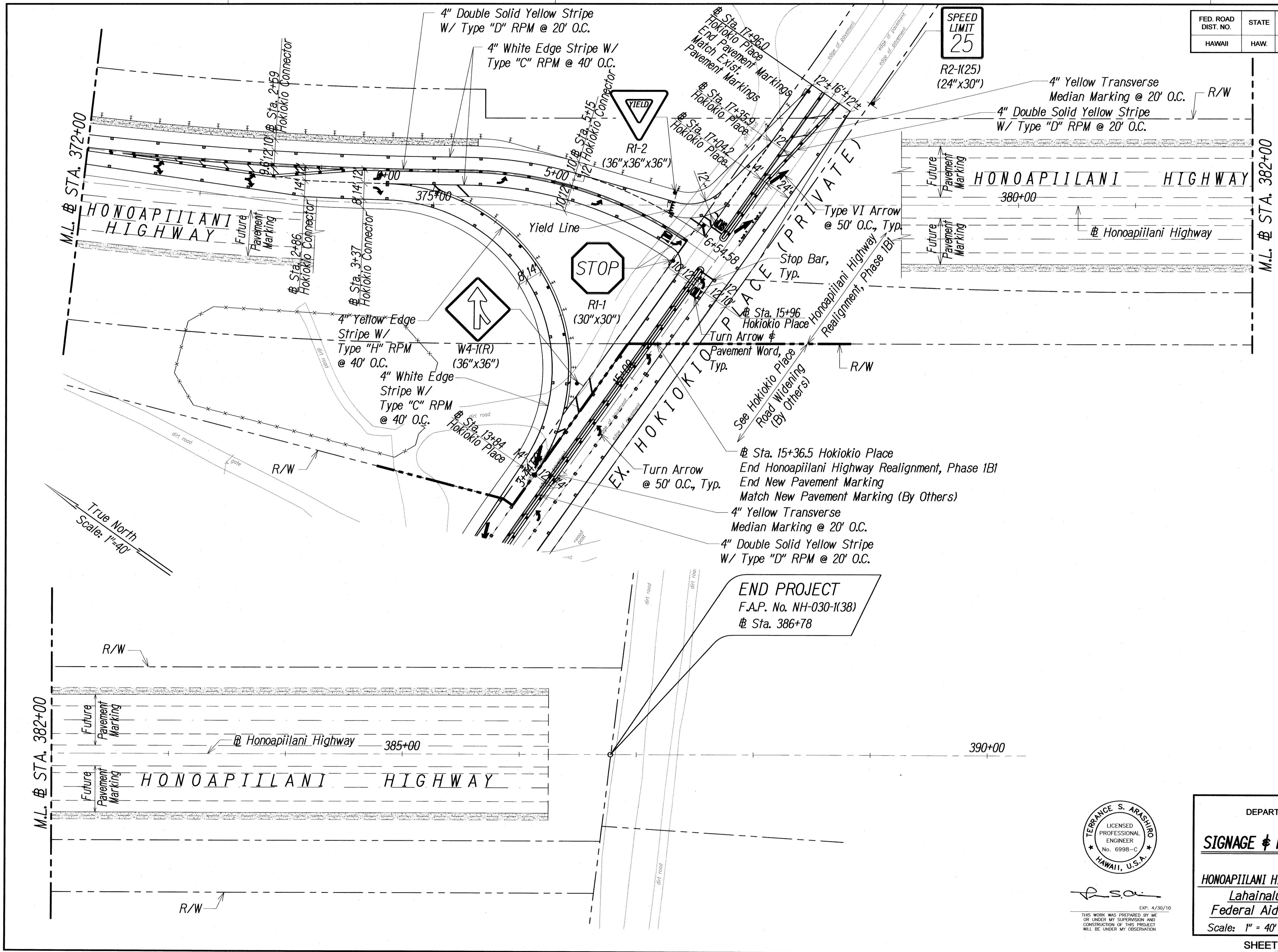

**END PROJECT**  
 F.A.P. No. NH-030-K38  
 @ Sta. 386+78



psa  
 EXP. 4/30/10  
 THIS WORK WAS PREPARED BY ME OR UNDER MY SUPERVISION AND CONSTRUCTION OF THIS PROJECT WILL BE UNDER MY OBSERVATION

STATE OF HAWAII  
 DEPARTMENT OF TRANSPORTATION  
 HIGHWAYS DIVISION

**SIGNAGE & PAVEMENT MARKING PLAN**

HONOAPIILANI HIGHWAY REALIGNMENT, PHASE 1B1  
 Lahainaluna Rd. to Hokiokio Pl.  
 Federal Aid Project NO. NH-030-K38

Scale: 1" = 40'      Date: November 23, 2009

FED. ROAD DIST. NO.	STATE	FED. AID PROJ. NO.	FISCAL YEAR	SHEET NO.	TOTAL SHEETS
HAWAII	HAW.	NH-030-1(38)	2010	70	213

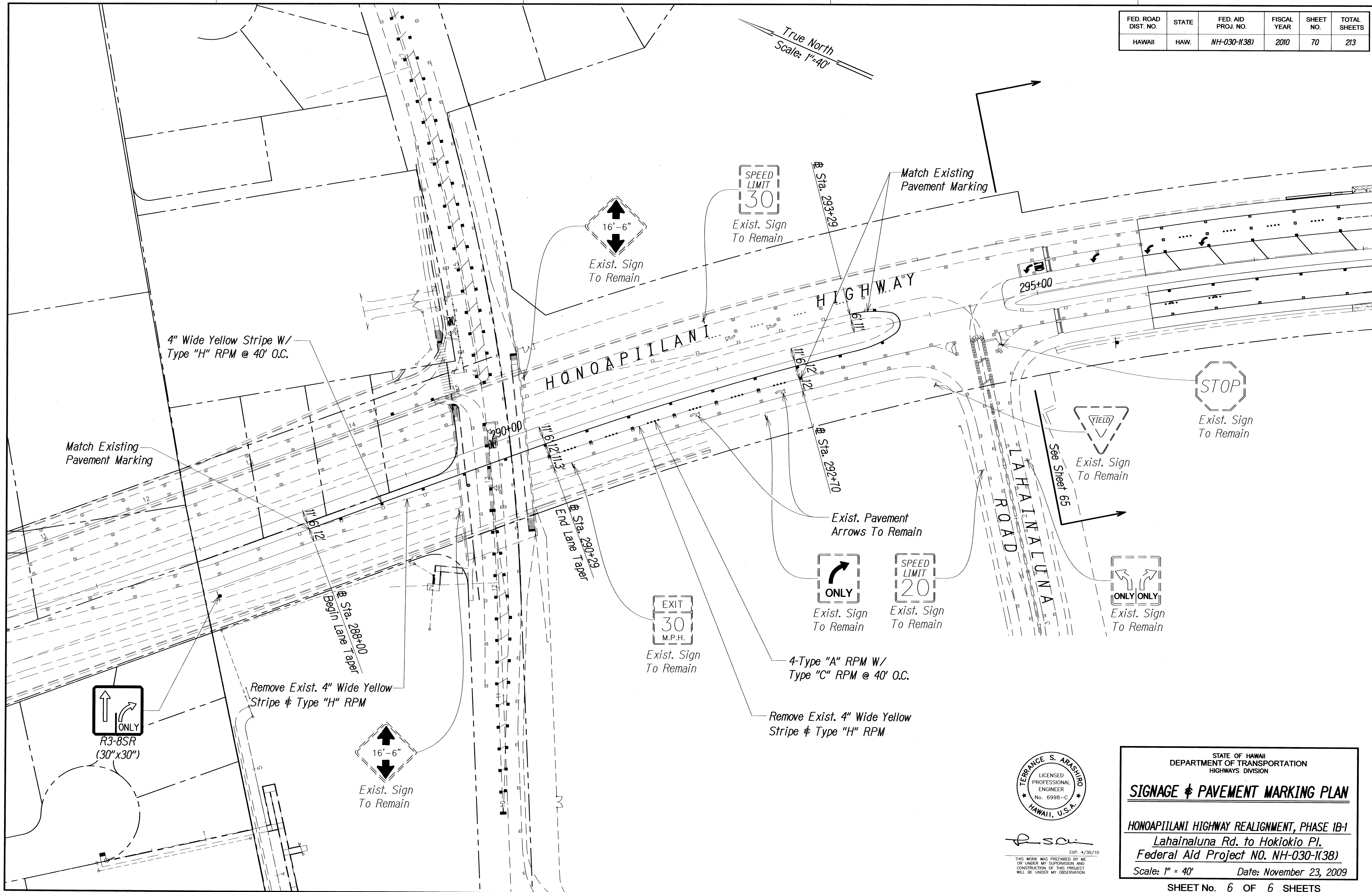

True North  
Scale: 1"=40'

STOP  
Exist. Sign To Remain

SPEED LIMIT 30  
Exist. Sign To Remain

ONLY  
Exist. Sign To Remain

SPEED LIMIT 20  
Exist. Sign To Remain

ONLY ONLY  
Exist. Sign To Remain

EXIT 30 M.P.H.  
Exist. Sign To Remain

R3-BSR (30"x30")  
ONLY

16'-6"  
Exist. Sign To Remain

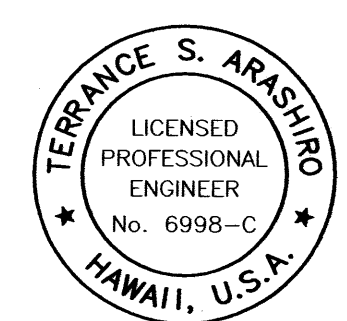

EXP. 4/30/10  
THIS WORK WAS PREPARED BY ME OR UNDER MY SUPERVISION AND CONSTRUCTION OF THIS PROJECT WILL BE UNDER MY OBSERVATION

STATE OF HAWAII  
DEPARTMENT OF TRANSPORTATION  
HIGHWAYS DIVISION

**SIGNAGE & PAVEMENT MARKING PLAN**

HONOAPIILANI HIGHWAY REALIGNMENT, PHASE 1B-1  
Lahainaluna Rd. to Hokiokio PI.  
Federal Aid Project NO. NH-030-1(38)

Scale: 1" = 40'      Date: November 23, 2009