

**PAVEMENT MARKING LEGEND**

- 4 each Type A Raised Pavement Markers  
Type C Raised Pavement Markers @ 40'-0" o.c.
- 4 each Type J Raised Pavement Markers  
Type D Raised Pavement Markers @ 40'-0" o.c.
- 8" White Stripe with Type C Raised Pavement Markers @ 20'-0" o.c. (Tape, Type I or Thermoplastic Extrusion)
- 4" Double Solid Yellow with Type D Raised Pavement Markers @ 20'-0" o.c. (Tape, Type I or Thermoplastic Extrusion)
- 4" Double Solid Yellow Stripes with Type H Raised Pavement Markers @ 20'-0" o.c. (Tape, Type II or Thermoplastic Extrusion)
- 4" Yellow Edge Stripe with Type H Raised Pavement Markers @ 40'-0" o.c. (Tape, Type II or Thermoplastic Extrusion)
- 4" Double Solid White Stripes with Type C Raised Pavement Markers @ 20'-0" o.c. (Tape, Type I or Thermoplastic Extrusion)
- Lane Change Restriction Marking  
4 each Type A Raised Pavement Markers  
Type C Raised Pavement Markers @ 20'-0" o.c.  
4" White Stripe (Tape, Type I or Thermoplastic Extrusion)
- 4" or 8" White Edge Stripe with Type C Raised Pavement Markers @ 40'-0" o.c. (Tape, Type II or Thermoplastic Extrusion)
- 4" White Guide Lines (Tape, Type III or Thermoplastic Extrusion)
- Transverse Median Marking (Tape, Type II or Thermoplastic Extrusion)
- Transverse Shoulder Marking (Tape, Type II or Thermoplastic Extrusion)
- Channelizing Island or Deceleration Lane Gore (Tape, Type II or Thermoplastic Extrusion)
- Crosswalk and Stop Line. All Stop Lines shall be 10'-0" from Crosswalk unless otherwise noted. The circled number indicates the number of lanes for payment. (Tape, Type III or Thermoplastic Extrusion)
- Pavement Arrow (Tape, Type III or Thermoplastic Extrusion)
- Pavement Word (Tape, Type III or Thermoplastic Extrusion)
- 4 Each Type J Raised Pavement Markers  
Type D Raised Pavement Markers @ 40'-0" o.c.  
Type H Raised Pavement Markers (Reflective Surface facing no-passing direction)  
4" Single Solid Yellow Stripe (Tape, Type I or Thermoplastic Extrusion)
- Extension of Edge Line, 4" Wide x 2'-0" Long White Stripe @ 10'-0" o.c. w/Type C Markers @ 40'-0" o.c. (Tape, Type III or Thermoplastic Extrusion)

**NOTES**

1. Layout of pavement markings and striping shall be done by the Contractor and approved by the Engineer prior to any installation work.
2. Existing pavement markings not incorporated in the final traffic pattern shall be removed as directed by the Engineer. Costs shall be incidental to the various pavement marking items.
3. Raised pavement markers shall not be installed within crosswalks.
4. Final locations of all signs shall be approved by the Engineer prior to any installation work.
5. Existing signs not shown on these plans shall remain as posted unless otherwise directed by the Engineer. Removal and disposal of existing signs and/or posts as designated on these plans shall be incidental to the various signing items.
6. Final locations of all Stop Lines shall be approved by the Engineer prior to installation.
7. All pavement striping shall be as noted on the Legend or plans.
8. All preformed pavement marking tapes over existing pavement shall be applied with an approved primer as recommended by the tape manufacturer and as approved by the Engineer. The primer shall be allowed to dry to the tacky stage prior to tape application.
9. Backing for all new Regulatory and Warning Signs shall not be spliced.
10. All sign panels shall conform to Section 621 of Special Provisions and the latest editions and amendments of the following FHWA publications:
  - a. "Manual on Uniform Traffic Control Devices for Streets and Highways" (MUTCD)
  - b. "Standard Highway Signs"
  - c. "Standard Alphabets for Highway Signs"
11. Borders, messages, arrows, symbols and shields shall conform to details as shown on the plans and as specified in the MUTCD.
12. Sign messages shall be as indicated on the plan.
13. All panels shall be reflectorized in accordance with Section 712.20 of the Standard Specifications. Minimum width of panels shall be 2 ft. abutting edges of panels shall be in only one direction if vertical abutting edges are used, no horizontal abutting edges shall be allowed and vice versa.
14. Removal of Existing Delineators and Posts shall be considered incidental to the various signing items.
15. All preformed pavement marking tapes over existing pavement shall be applied with an approved primer as recommended by the tape manufacturer and as directed by the Engineer. The primer shall be allowed to dry to the tacky stage prior to tape application.
16. Install Type II object marker on all utility poles or trees that are within the State highway right of way and within 30 feet of the roadway edge of pavement shall be marked as directed by the Engineer.
17. The final placement and spacing for all reflector markers and object markers shall be determined in the field by the Engineer.

FED. ROAD DIST. NO.	STATE	FED. AID PROJ. NO.	FISCAL YEAR	SHEET NO.	TOTAL SHEETS
HAWAII	HAW.	STP-030-1(21)	1993	17	30

**REFLECTOR MARKER LEGEND**

- RM-1 Reflector Marker w/Steel Post
- RM-1 Reflector Marker w/Flexible Post
- Type II Object Marker w/Steel Post
- Type II Object Marker w/Flexible Post

DATE	_____
SURVEY PLOTTED BY	_____
DRAWN BY	_____
TRACED BY	_____
QUANTITIES BY	_____
CHECKED BY	_____
NO.	_____

STATE OF HAWAII  
DEPARTMENT OF TRANSPORTATION  
HIGHWAYS DIVISION

**MISCELLANEOUS TRAFFIC  
LEGENDS & NOTES**

**HONOAPIILANI HIGHWAY RESURFACING  
Puamana to Olowalu  
Fed. Aid. Project No. STP-030-1(21)**

Date: Feb. 1993

SHEET No. 17 OF 14 SHEETS

FED. ROAD DIST. NO.	STATE	FED. AID PROJ. NO.	FISCAL YEAR	SHEET NO.	TOTAL SHEETS
HAWAII	HAW.	STP-030-1(21)	1993	18	30

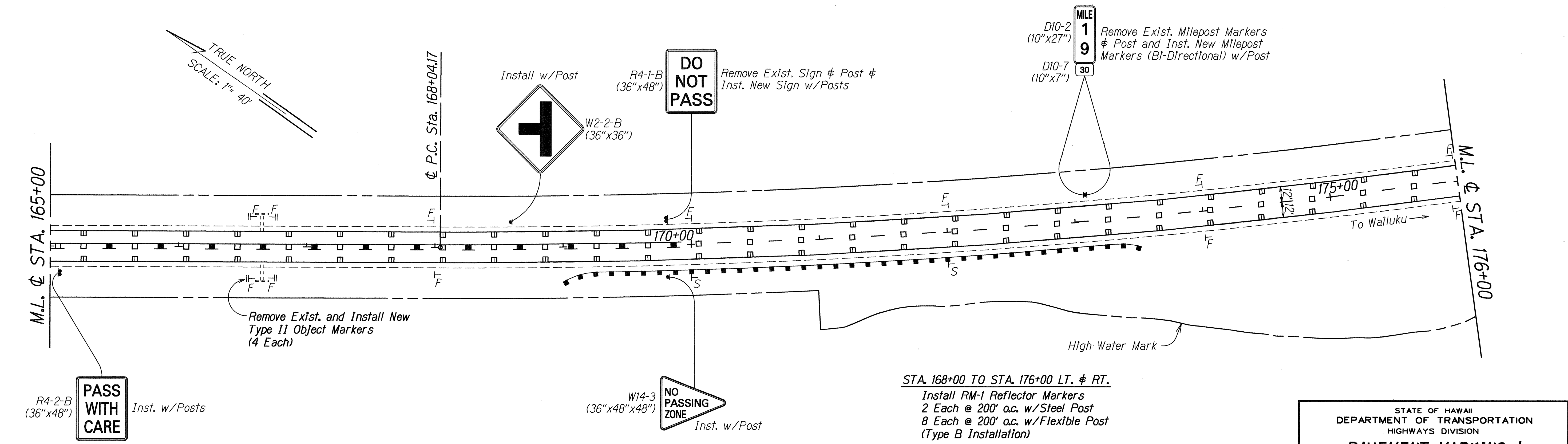
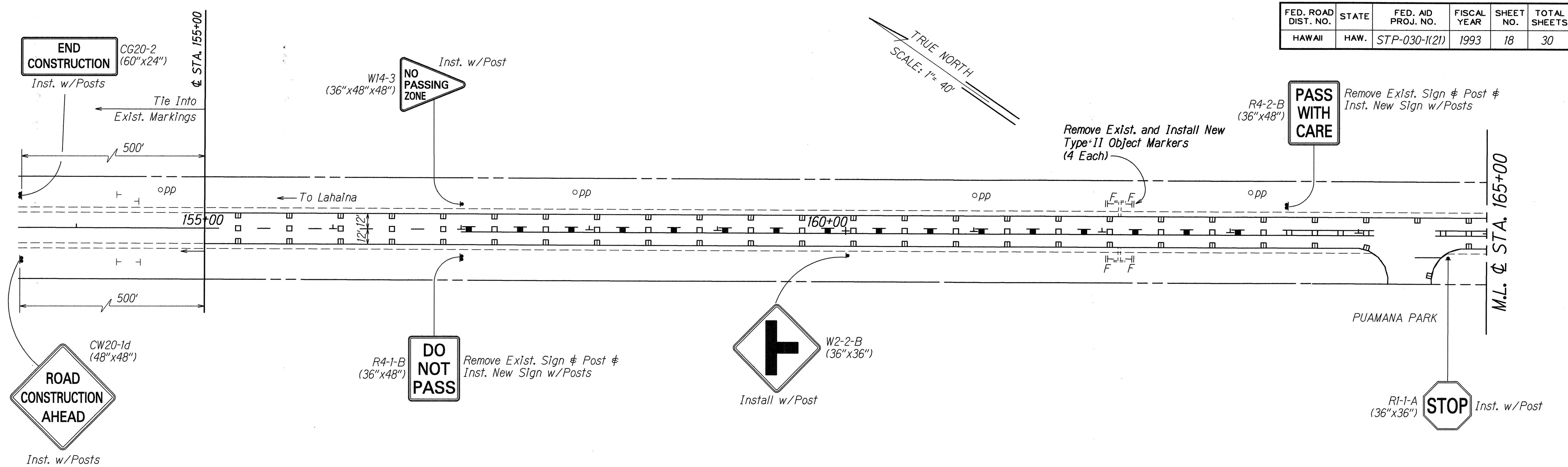

STA. 168+00 TO STA. 176+00 LT. & RT.  
Install RM-1 Reflector Markers  
2 Each @ 200' o.c. w/Steel Post  
8 Each @ 200' o.c. w/Flexible Post  
(Type B Installation)

SURVEY PLOTTED BY	DATE
DRAWN BY	
CHECKED BY	
NOTE BOOK	
CHECKED BY	
No.	

6/10/93	Added "Side Road" Sign @ Sta. 160+00± Rt. & Sta. 168+50± Lt. per Addendum No. 1.
DATE	REVISION

STATE OF HAWAII  
DEPARTMENT OF TRANSPORTATION  
HIGHWAYS DIVISION

**PAVEMENT MARKING & SIGNING PLAN**

HONOAPIILANI HIGHWAY RESURFACING  
Puamana to Olowalu  
Fed. Aid. Project No. STP-030-1(21)  
Scale: 1" = 40' Date: Feb. 1993  
SHEET No. T2 OF 14 SHEETS

FED. ROAD DIST. NO.	STATE	FED. AID PROJ. NO.	FISCAL YEAR	SHEET NO.	TOTAL SHEETS
HAWAII	HAW.	STP-030-1(21)	1993	19	30

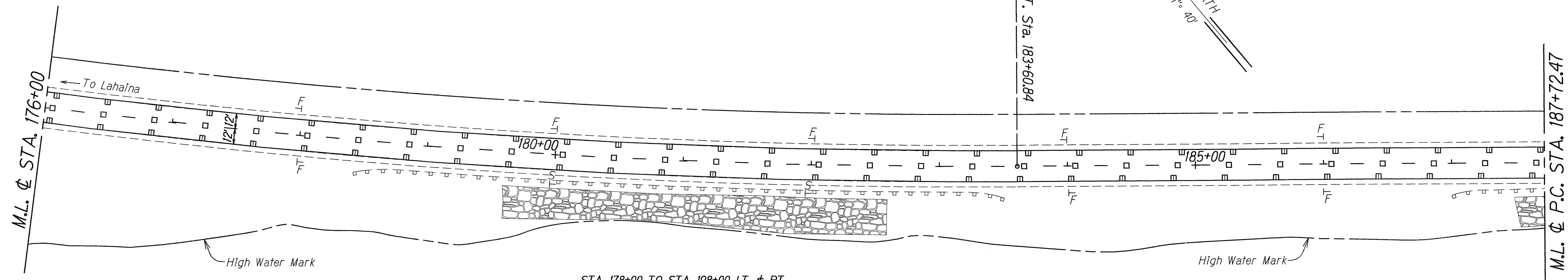

STA. 178+00 TO STA. 198+00 LT. & RT.  
 Install RM-1 Reflector Markers  
 7 Each @ 200' o.c. w/Steel Post  
 15 Each @ 200' o.c. w/Flexible Post  
 (Type B Installation)

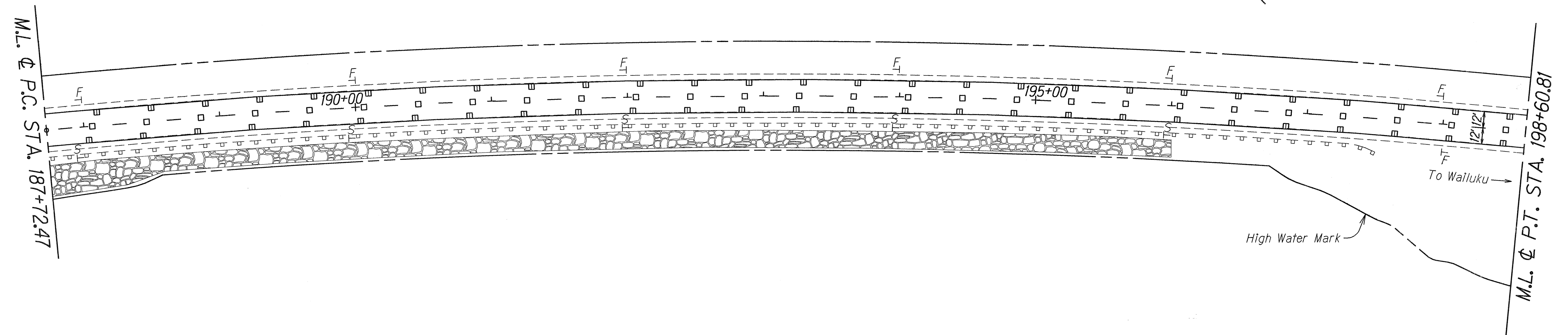

ORIGINAL PLAN	SURVEY PLOTTED BY	DATE
NOTE BOOK	DRAWN BY	
	TRACED BY	
	DESIGNED BY	
	CHECKED BY	

STATE OF HAWAII  
 DEPARTMENT OF TRANSPORTATION  
 HIGHWAYS DIVISION

**PAVEMENT MARKING &  
 SIGNING PLAN**

HONOAPIILANI HIGHWAY RESURFACING  
 Puamana to Olowalu  
 Fed. Aid. Project No. STP-030-1(21)

Scale: 1" = 40' Date: Feb. 1993

SHEET No. 19 OF 30 SHEETS

FED. ROAD DIST. NO.	STATE	FED. AID PROJ. NO.	FISCAL YEAR	SHEET NO.	TOTAL SHEETS
HAWAII	HAW.	STP-030-1(21)	1993	20	30

TRUE NORTH  
SCALE: 1" = 40'

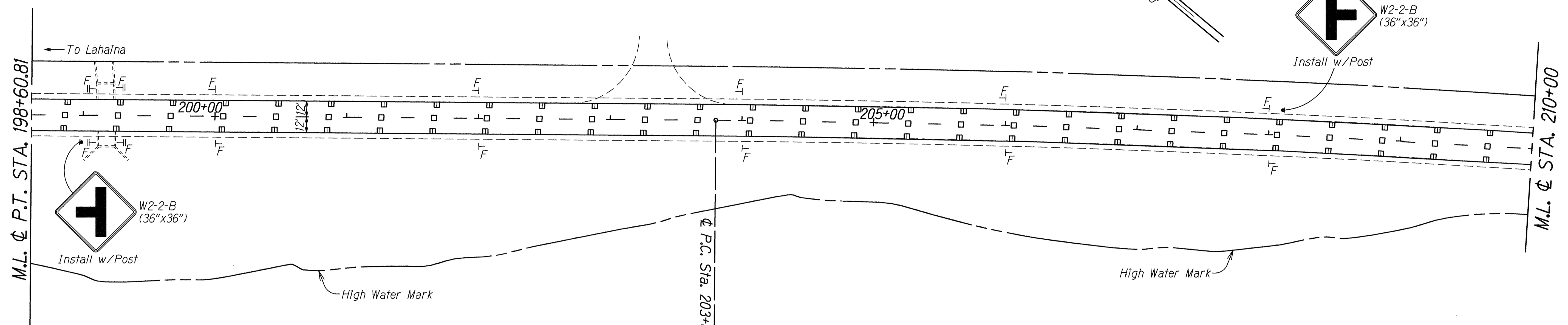

STA. 200+00 TO STA. 220+00 LT. & RT.  
Install RM-1 Reflector Markers  
3 Each @ 200' o.c. w/Steel Post  
19 Each @ 200' o.c. w/Flexible Post  
(Type B Installation)

TRUE NORTH  
SCALE: 1" = 40'

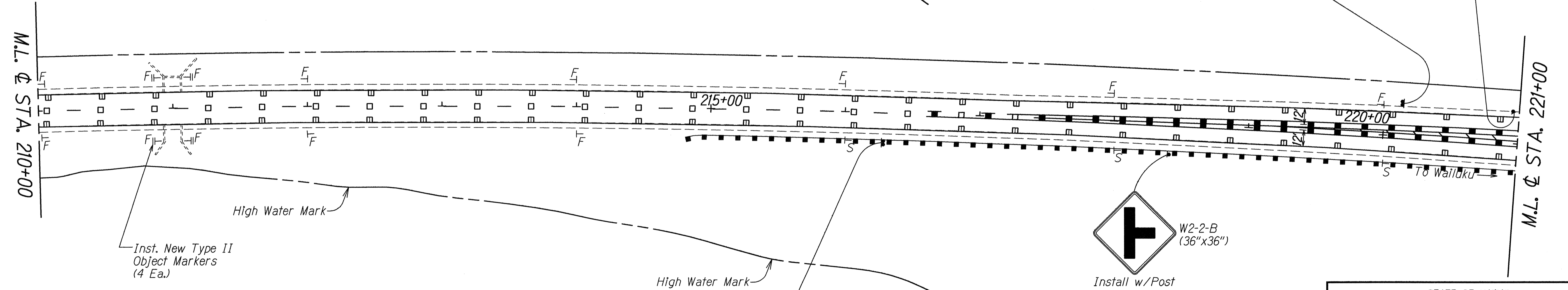

Inst. w/Posts  
R2-1(45)-B (36"x48")  
SPEED LIMIT 45  
R8-3a-B (36"x36")  
Remove Exist. Sign & Post and Inst. New Signs w/Post  
ANY TIME (36"x24")

R4-1-B (36"x48")  
DO NOT PASS  
Remove Exist. Sign & Post and Inst. New Sign w/Posts

W2-2-B (36"x36")  
Install w/Post

SURVEY PLOTTED BY	DATE
DRAWN BY	
CHECKED BY	
NOTE BOOK	
QUANTITIES BY	
CHECKED BY	

DATE	REVISION
6/10/93	Added "Side Road" Sign @ Sta. 199+00± Rt., Sta. 208+00± Lt. & Sta. 218+40± Rt. and Revised Reflector Marker Quantities per Addendum No. 1.

STATE OF HAWAII  
DEPARTMENT OF TRANSPORTATION  
HIGHWAYS DIVISION

**PAVEMENT MARKING & SIGNING PLAN**

HONOAPIILANI HIGHWAY RESURFACING  
Puamana to Olowalu  
Fed. Aid. Project No. STP-030-1(21)  
Scale: 1" = 40' Date: Feb. 1993

SHEET No. T4 OF 14 SHEETS





FED. ROAD DIST. NO.	STATE	FED. AID PROJ. NO.	FISCAL YEAR	SHEET NO.	TOTAL SHEETS
HAWAII	HAW.	STP-030-1(21)	1993	23	30

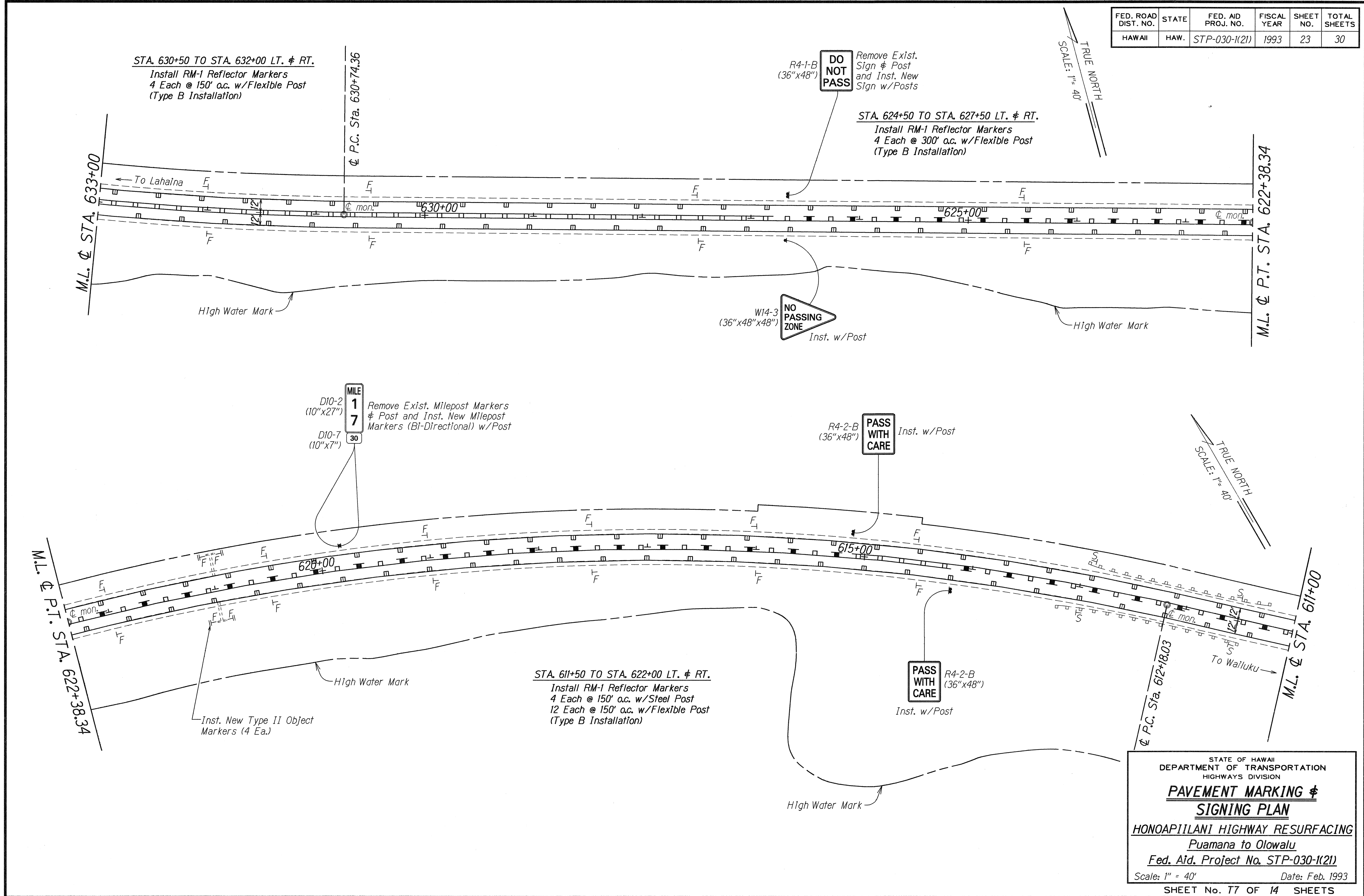

STA. 630+50 TO STA. 632+00 LT. & RT.  
Install RM-1 Reflector Markers  
4 Each @ 150' o.c. w/Flexible Post  
(Type B Installation)

R4-1-B (36"x48")  
**DO NOT PASS**  
Remove Exist. Sign & Post and Inst. New Sign w/Posts

STA. 624+50 TO STA. 627+50 LT. & RT.  
Install RM-1 Reflector Markers  
4 Each @ 300' o.c. w/Flexible Post  
(Type B Installation)

W14-3 (36"x48"x48")  
**NO PASSING ZONE**  
Inst. w/Post

D10-2 (10"x27")  
**MILE 17**  
Remove Exist. Milepost Markers & Post and Inst. New Milepost Markers (Bi-Directional) w/Post

R4-2-B (36"x48")  
**PASS WITH CARE**  
Inst. w/Post

STA. 611+50 TO STA. 622+00 LT. & RT.  
Install RM-1 Reflector Markers  
4 Each @ 150' o.c. w/Steel Post  
12 Each @ 150' o.c. w/Flexible Post  
(Type B Installation)

R4-2-B (36"x48")  
**PASS WITH CARE**  
Inst. w/Post

Inst. New Type II Object Markers (4 Ea.)

SURVEY PLOTTED BY	DATE
DRAWN BY	
DESIGNED BY	
NOTE BOOK	
QUANTITIES BY	
CHECKED BY	
N.	

STATE OF HAWAII  
DEPARTMENT OF TRANSPORTATION  
HIGHWAYS DIVISION

**PAVEMENT MARKING & SIGNING PLAN**

HONOAPIILANI HIGHWAY RESURFACING  
Puamana to Olowalu  
Fed. Aid. Project No. STP-030-1(21)  
Scale: 1" = 40' Date: Feb. 1993

SHEET No. 17 OF 14 SHEETS

FED. ROAD DIST. NO.	STATE	FED. AID PROJ. NO.	FISCAL YEAR	SHEET NO.	TOTAL SHEETS
HAWAII	HAW.	STP-030-1(21)	1993	24	30

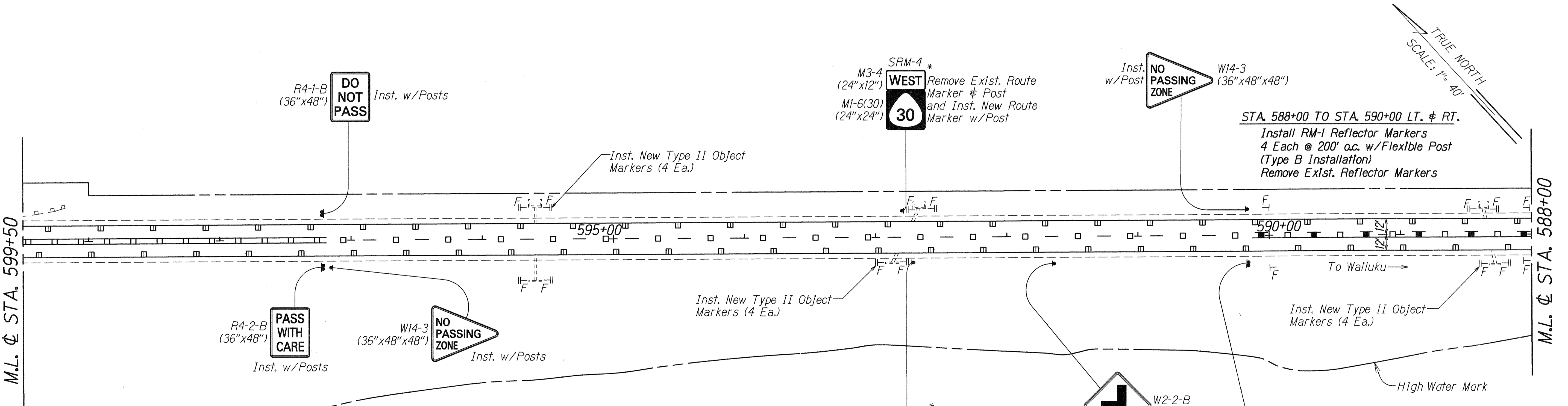
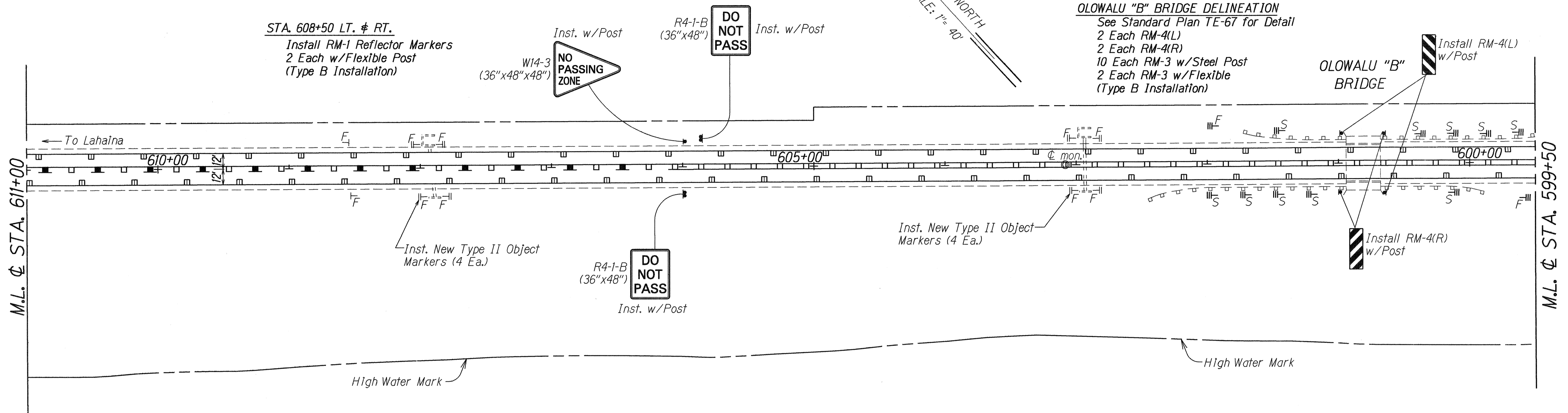

SURVEY PLOTTED BY	DATE
DRAWN BY	
DESIGNED BY	
CHECKED BY	
ORIGINAL PLAN	
NOTE BOOK	
NO.	

\* The first letter of the cardinal direction words shall be 10 percent larger, rounded up to the nearest whole number size.

STATE OF HAWAII  
DEPARTMENT OF TRANSPORTATION  
HIGHWAYS DIVISION

**PAVEMENT MARKING & SIGNING PLAN**

HONOAPIILANI HIGHWAY RESURFACING  
Puamana to Olowalu  
Fed. Aid. Project No. STP-030-1(21)

Scale: 1" = 40' Date: Feb. 1993

SHEET No. 78 OF 14 SHEETS

FED. ROAD DIST. NO.	STATE	FED. AID PROJ. NO.	FISCAL YEAR	SHEET NO.	TOTAL SHEETS
HAWAII	HAW.	STP-030-1(21)	1993	25	30

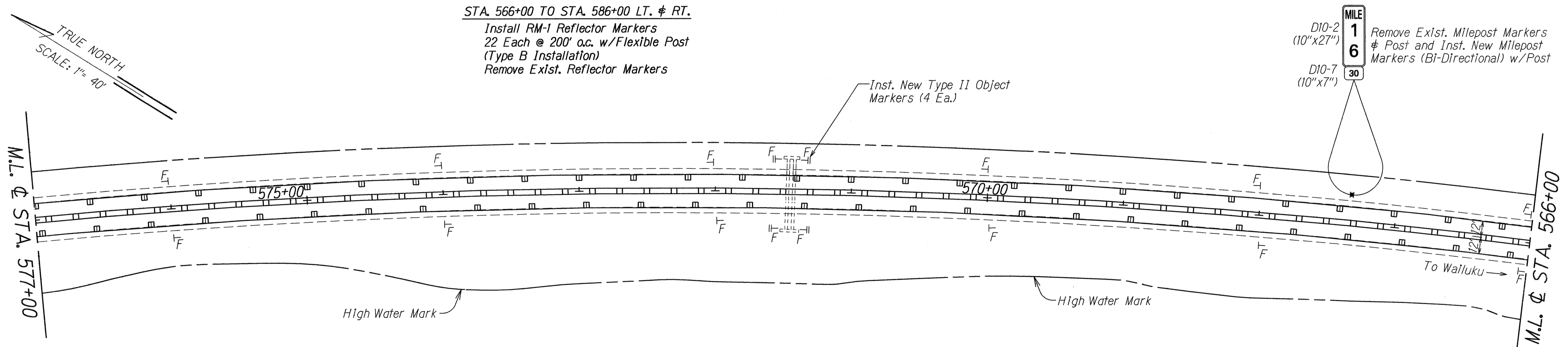
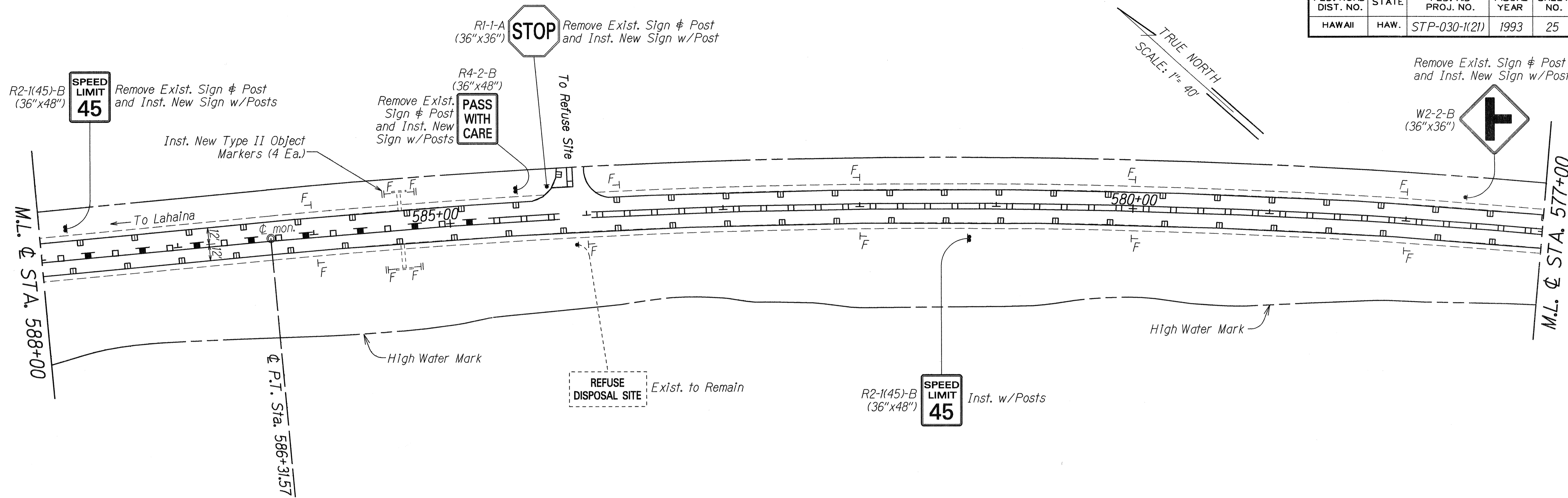

STA. 566+00 TO STA. 586+00 LT. & RT.  
 Install RM-1 Reflector Markers  
 22 Each @ 200' o.c. w/Flexible Post  
 (Type B Installation)  
 Remove Exist. Reflector Markers

DATE	_____
SURVEY PLOTTED BY	_____
ORIGINAL PLAN	_____
DESIGNED BY	_____
TRACED BY	_____
NOTE BOOK	_____
CHECKED BY	_____
N.	_____

STATE OF HAWAII  
 DEPARTMENT OF TRANSPORTATION  
 HIGHWAYS DIVISION

**PAVEMENT MARKING & SIGNING PLAN**

HONOAPIILANI HIGHWAY RESURFACING  
 Puamana to Olowalu  
 Fed. Aid. Project No. STP-030-1(21)

Scale: 1" = 40' Date: Feb. 1993

SHEET No. T9 OF 14 SHEETS

FED. ROAD DIST. NO.	STATE	FED. AID PROJ. NO.	FISCAL YEAR	SHEET NO.	TOTAL SHEETS
HAWAII	HAW.	STP-030-1(21)	1993	26	30

STA. 564+00 TO STA. 565+00 LT. & RT.  
Install RM-1 Reflector Markers  
4 Each @ 100' o.c. w/Steel Post

STA. 556+00 TO STA. 562+00 LT. & RT.  
Install RM-1 Reflector Markers  
8 Each @ 200' o.c. w/Flexible Post  
(Type B Installation)

TRUE NORTH  
SCALE: 1" = 40'

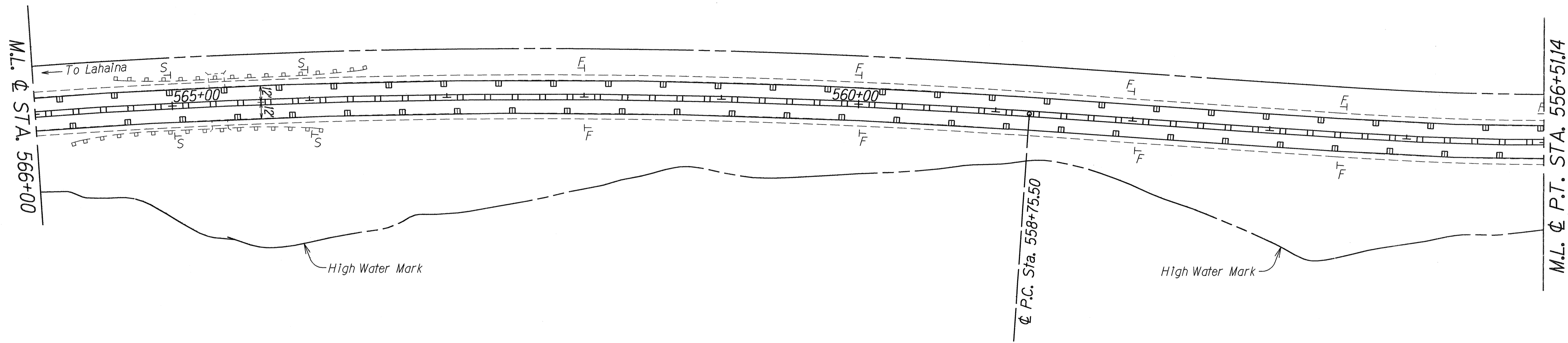

TRUE NORTH  
SCALE: 1" = 40'

STA. 546+00 LT. & RT.  
Install RM-1 Reflector Markers  
2 Each w/Flexible Post  
(Type B Installation)

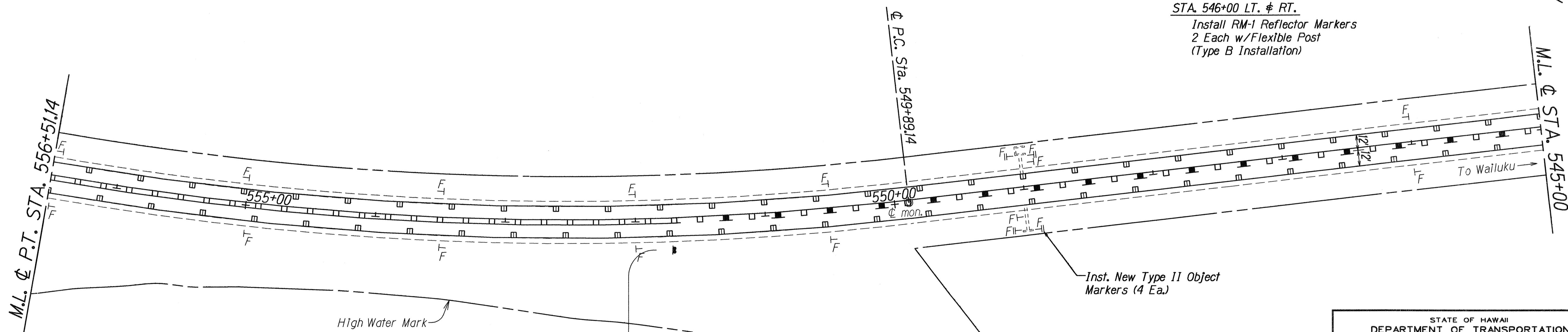

STA. 549+00 TO STA. 556+50 LT. & RT.  
Install RM-1 Reflector Markers  
12 Each @ 150' o.c. w/Flexible Post  
(Type B Installation)

R4-2-B  
(36" x 48")  
**PASS WITH CARE**  
Inst. w/Posts

Inst. New Type II Object Markers (4 Ea.)

ORIGINAL PLAN	SURVEY PLOTTED BY	DATE
NOTE BOOK	DRAWN BY	
	DESIGNED BY	
	CHECKED BY	

STATE OF HAWAII  
DEPARTMENT OF TRANSPORTATION  
HIGHWAYS DIVISION

**PAVEMENT MARKING & SIGNING PLAN**

HONOAPIILANI HIGHWAY RESURFACING  
Puamana to Olowalu  
Fed. Aid. Project No. STP-030-1(21)  
Scale: 1" = 40' Date: Feb. 1993  
SHEET No. 110 OF 14 SHEETS

FED. ROAD DIST. NO.	STATE	FED. AID PROJ. NO.	FISCAL YEAR	SHEET NO.	TOTAL SHEETS
HAWAII	HAW.	STP-030-1(21)	1993	27	30

TRUE NORTH  
SCALE: 1" = 40'

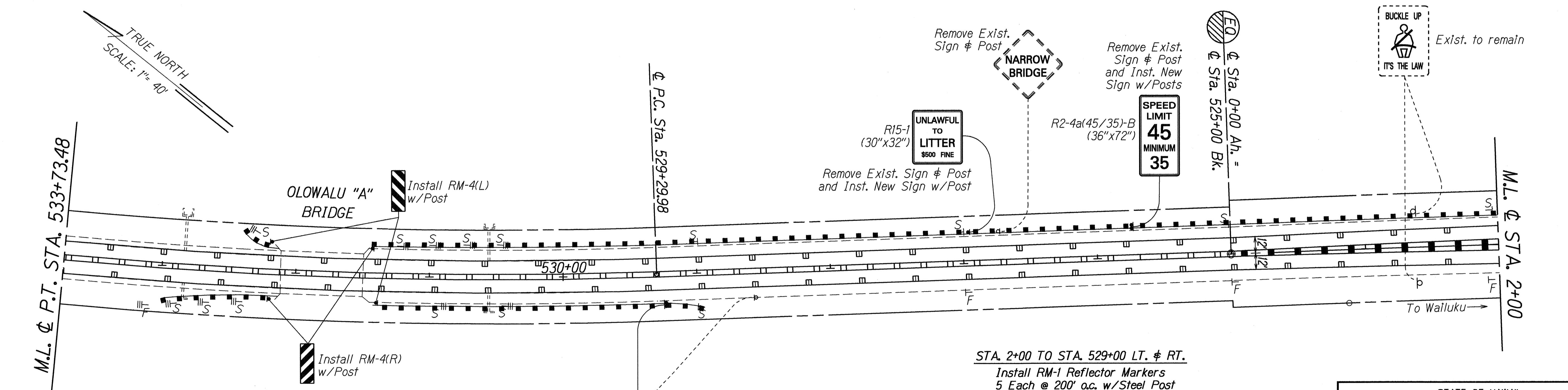
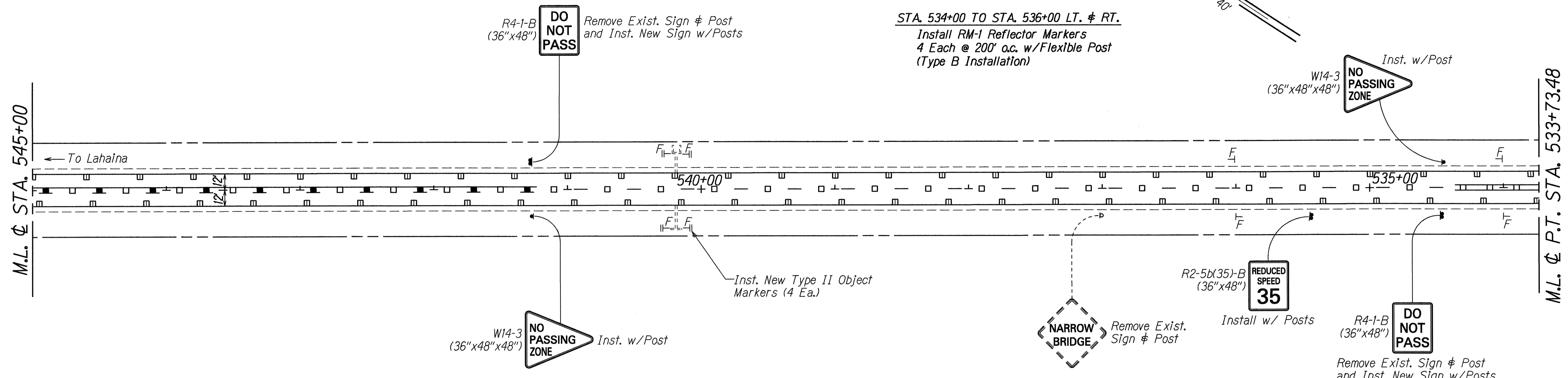

**LOWALU "A" BRIDGE DELINEATION**  
See Standard Plan TE-67 for Detail  
2 Each RM-4(L)  
2 Each RM-4(R)  
10 Each RM-3 w/Steel Post  
1 Each RM-3 w/Flexible Post  
(Type B Installation)

**STA. 2+00 TO STA. 529+00 LT. & RT.**  
Install RM-1 Reflector Markers  
5 Each @ 200' o.c. w/Steel Post  
3 Each @ 200' o.c. w/Flexible Post  
(Type B Installation)

R4-1-B (36"x48")  
**DO NOT PASS**  
Remove Exist. Sign & Post and Inst. New Sign w/Posts

**STA. 534+00 TO STA. 536+00 LT. & RT.**  
Install RM-1 Reflector Markers  
4 Each @ 200' o.c. w/Flexible Post  
(Type B Installation)

W14-3 (36"x48"x48")  
**NO PASSING ZONE**  
Inst. w/Post

R2-5b(35)-B (36"x48")  
**REDUCED SPEED 35**  
Install w/ Posts

W14-3 (36"x48"x48")  
**NO PASSING ZONE**  
Inst. w/Post

**NARROW BRIDGE**  
Remove Exist. Sign & Post

R4-1-B (36"x48")  
**DO NOT PASS**  
Remove Exist. Sign & Post and Inst. New Sign w/Posts

Remove Exist. Sign & Post  
**NARROW BRIDGE**

R15-1 (30"x32")  
**UNLAWFUL TO LITTER \$500 FINE**  
Remove Exist. Sign & Post and Inst. New Sign w/Post

**SPEED LIMIT 45 MINIMUM 35**

**BUCKLE UP IT'S THE LAW**  
Exist. to remain

R2-1(35)-B (36"x48")  
**SPEED LIMIT 35**  
Remove Exist. Sign & Post and Inst. New Sign w/Posts

DATE	
SURVEY PLOTTED BY	
ORIGINAL PLAN	
DRAWN BY	
DESIGNED BY	
CHECKED BY	
NOTE BOOK	
NO.	

6/10/93	Revised Reflector Marker Quantities per Addendum No. 1.
DATE	REVISION

STATE OF HAWAII  
DEPARTMENT OF TRANSPORTATION  
HIGHWAYS DIVISION

**PAVEMENT MARKING & SIGNING PLAN**

HONOAPIILANI HIGHWAY RESURFACING  
Puamana to Olowalu  
Fed. Aid. Project No. STP-030-1(21)  
Scale: 1" = 40' Date: Feb. 1993

SHEET No. 27 OF 14 SHEETS

FED. ROAD DIST. NO.	STATE	FED. AID PROJ. NO.	FISCAL YEAR	SHEET NO.	TOTAL SHEETS
HAWAII	HAW.	STP-030-1(21)	1993	28	30

STA. 4+00 TO STA. 6+00 LT. # RT.

Install RM-1 Reflector Markers  
4 Each @ 200' o.c. w/Flexible Post  
(Type B Installation)

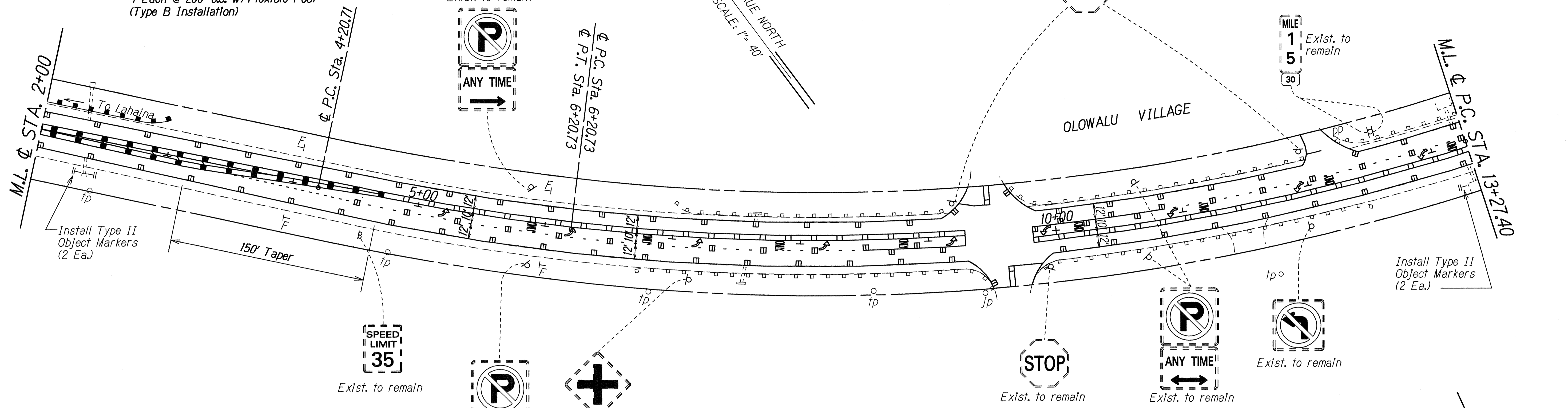

STA. 20+00 TO STA. 24+00 LT.

Install RM-1 Reflector Markers  
3 Each @ 200' o.c. w/Steel Post

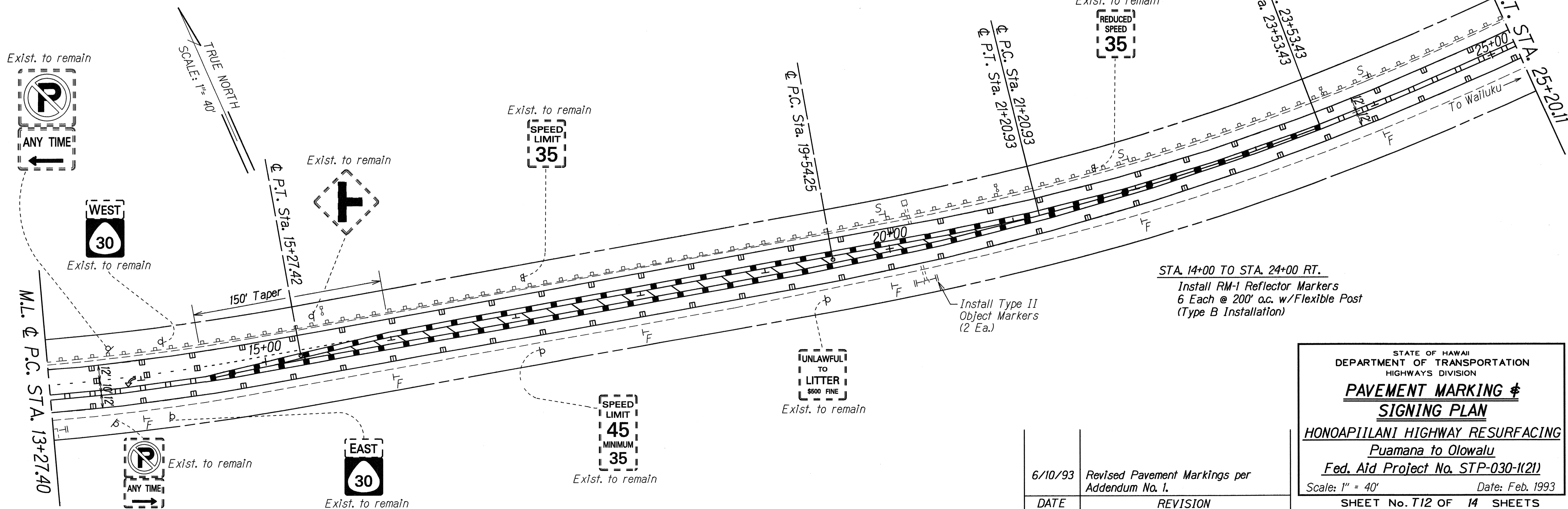

STA. 14+00 TO STA. 24+00 RT.

Install RM-1 Reflector Markers  
6 Each @ 200' o.c. w/Flexible Post  
(Type B Installation)

SURVEY PLOTTED BY	DATE
DRAWN BY	
TRACED BY	
QUANTITIES BY	
CHECKED BY	
NO.	

DATE	REVISION
6/10/93	Revised Pavement Markings per Addendum No. 1.

STATE OF HAWAII  
DEPARTMENT OF TRANSPORTATION  
HIGHWAYS DIVISION

**PAVEMENT MARKING #  
SIGNING PLAN**

HONOAPIILANI HIGHWAY RESURFACING  
Puamana to Olowalu  
Fed. Aid Project No. STP-030-1(21)  
Scale: 1" = 40' Date: Feb. 1993  
SHEET No. T12 OF 14 SHEETS

FED. ROAD DIST. NO.	STATE	FED. AID PROJ. NO.	FISCAL YEAR	SHEET NO.	TOTAL SHEETS
HAWAII	HAW.	STP-030-1(21)	1993	29	30

STA. 26+00 TO STA. 32+00 LT. & RT.  
 Install RM-1 Reflector Markers  
 4 Each @ 200' o.c. w/Steel Post  
 4 Each @ 200' o.c. w/Flexible Post  
 (Type B Installation)

TRUE NORTH  
 SCALE: 1" = 40'

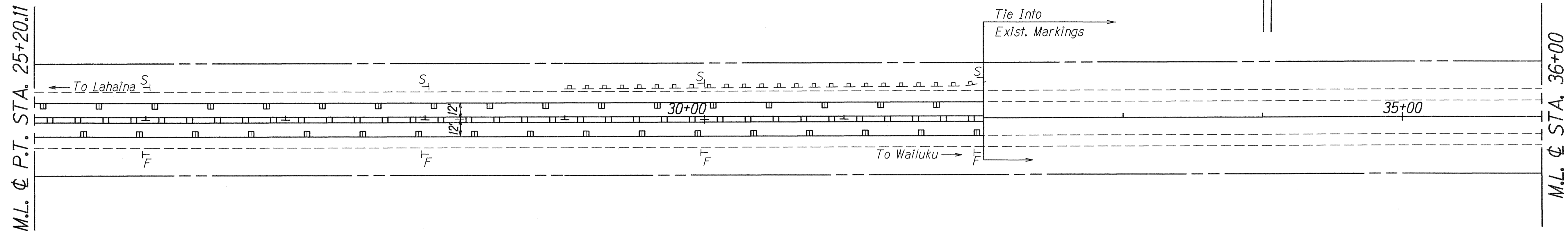

TRUE NORTH  
 SCALE: 1" = 40'

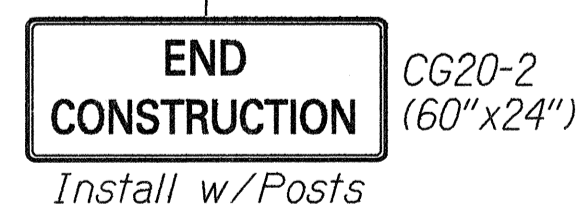
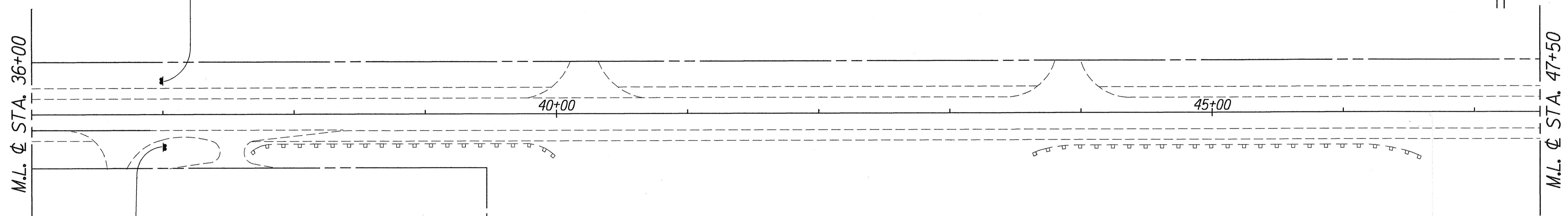
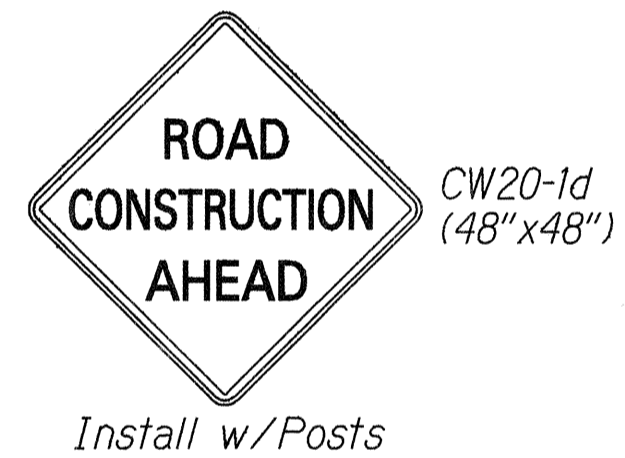

SURVEY PLOTTED BY	DATE
DRAWN BY	
TRACED BY	
QUANTITIES BY	
CHECKED BY	
ORIGINAL PLAN	
NOTE BOOK	
No.	

STATE OF HAWAII  
 DEPARTMENT OF TRANSPORTATION  
 HIGHWAYS DIVISION

**PAVEMENT MARKING &  
 SIGNING PLAN**



HONOAPIILANI HIGHWAY RESURFACING  
 Puamana to Olowalu  
 Fed. Aid Project No. STP-030-1(21)

Scale: 1" = 40' Date: Feb. 1993

SHEET No. 113 OF 14 SHEETS

FED. ROAD DIST. NO.	STATE	FED. AID PROJ. NO.	FISCAL YEAR	SHEET NO.	TOTAL SHEETS
HAWAII	HAW.	STP--030-1(21)	1993	30	30

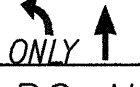
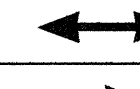
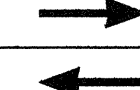
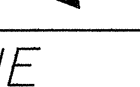
### TRAFFIC SIGN SUMMARY

SIGN NO.	MESSAGE	QUANTITY			
		10 SQ. FT. OR LESS		GREATER THAN 10 SQ. FT.	
		W/POST	W/O POST	W/POSTS	W/O POST
R1-1-A	STOP	3			
R2-1(35)-B	SPEED LIMIT 35			2	
R2-1(45)-B	SPEED LIMIT 45			3	
R2-4a(45/35)-B	SPEED LIMIT 45 MINIMUM 35			2	
R2-5b(35)-B	REDUCED SPEED 35			2	
R3-40		2			
R4-1-B	DO NOT PASS			12	
R4-2-B	PASS WITH CARE			7	
R8-3a-B	NO PARKING SYMBOL, ANY TIME 	2			
R8-3a-B(R)	NO PARKING SYMBOL, ANY TIME 	1			
R8-3a-B(L)	NO PARKING SYMBOL, ANY TIME 	1			
R15-1	UNLAWFUL TO LITTER \$500 FINE	1			
W2-2-B		7			
W14-3	NO PASSING ZONE	9			
TOTAL		26		28	

### PAVEMENT MARKING SUMMARY

DESCRIPTION	QUANTITY
<b>PAVEMENT MARKERS</b>	
TYPE C _____	1,300 Ea.
TYPE D _____	820 Ea.
TYPE H _____	340 Ea.
TYPE J _____	1,300 Ea.
<b>TAPE - TYPE I OR THERMOPLASTIC EXTRUSION</b>	
4-INCH PAVEMENT STRIPE (YELLOW) _____	3,900 L.F.
8-INCH PAVEMENT STRIPE (WHITE) _____	290 L.F.
DOUBLE 4-INCH PAVEMENT STRIPE (YELLOW) _____	9,400 L.F.
<b>TAPE - TYPE II OR THERMOPLASTIC EXTRUSION</b>	
4-INCH PAVEMENT STRIPE (WHITE) _____	48,700 L.F.
4-INCH PAVEMENT STRIPE (YELLOW) _____	1,200 L.F.
12-INCH PAVEMENT STRIPE (YELLOW) _____	450 L.F.
DOUBLE 4-INCH PAVEMENT STRIPE (YELLOW) _____	4,700 L.F.
<b>TAPE - TYPE III OR THERMOPLASTIC EXTRUSION</b>	
4-INCH PAVEMENT STRIPE (WHITE) _____	1,200 L.F.
12-INCH PAVEMENT STRIPE (WHITE) _____	160 L.F.
PAVEMENT ARROW _____	13 Ea.
PAVEMENT WORD _____	10 Ea.

### ROUTE MARKER SUMMARY

SIGN ASSEMBLY	LOCATION	SIGN NO. AND MESSAGE	TYPE A ASSEMBLY	
			W/POST	W/O POST
SRM-1	Sta. 230+00± Lt.	M3-4 WEST	1	
		M1-6(30) 30		
SRM-2	Sta. 230+00± Rt.	M3-2 EAST	1	
		M1-6(30) 30		
SRM-3	Sta. 592+80± Lt.	M3-2 EAST	1	
		M1-6(30) 30		
SRM-4	Sta. 592+80± Rt.	M3-4 WEST	1	
		M1-6(30) 30		
TOTAL			4	

### MILEPOST MARKER ASSEMBLY

LOCATION	SIGN NO. AND MESSAGE	QUANTITY	
		W/O POST	W/POST
Sta. 173+10± Lt.	D10-2 MILE 19 D10-7 30	1	1
Sta. 226+45± Lt.	D10-2 MILE 18 D10-7 30	1	1
Sta. 619+80± Rt.	D10-2 MILE 17 D10-7 30	1	1
Sta. 567+35± Rt.	D10-2 MILE 16 D10-7 30	1	1
TOTAL		4	4

### REFLECTOR MARKER SUMMARY

TYPE	QUANTITY			
	W/FLEXIBLE POST		W/STEEL POST	
	YELLOW	WHITE	YELLOW	WHITE
RM-1		168		35
RM-3		6		29
RM-4 (BLACK W/YELLOW)			12	

### CONSTRUCTION SIGN SUMMARY

SIGN NO.	LOCATION	MESSAGE	W/POSTS	W/O POST
CG20-2	Sta. 150+00± Lt.	END CONSTRUCTION	1	
CW20-1d	Sta. 150+00± Rt.	ROAD CONSTRUCTION AHEAD	1	
CW20-1d	Sta. 37+00 Lt.	ROAD CONSTRUCTION AHEAD	1	
CG20-2	Sta. 37+00 Rt.	END CONSTRUCTION	1	
TOTAL			4	

6/10/93 Revised Traffic Sign Reflector  
Marker and Pavement Marking  
Summaries per Addendum No. 1.

DATE REVISION

STATE OF HAWAII  
DEPARTMENT OF TRANSPORTATION  
HIGHWAYS DIVISION  
**MISCELLANEOUS TRAFFIC  
SUMMARIES**  
HONOAPIILANI HIGHWAY RESURFACING  
Puamana to Olowalu  
Fed. Aid. Project No. STP-030-1(21)

Date: May, 1993

SHEET No. 14 OF 14 SHEETS

**ADD. 30**

SURVEY PLOTTED BY \_\_\_\_\_ DATE \_\_\_\_\_  
 DRAWN BY \_\_\_\_\_  
 TRACED BY \_\_\_\_\_  
 NOTE BOOK \_\_\_\_\_  
 QUANTITIES BY \_\_\_\_\_  
 CHECKED BY \_\_\_\_\_  
 No. \_\_\_\_\_