

FED. ROAD DIST. NO.	STATE	FED. AID PROJ. NO.	FISCAL YEAR	SHEET NO.	TOTAL SHEETS
HAWAII	HAW.	HES-STP-030-1(19)	1993	8	14

TRUE NORTH
SCALE: 1" = 40'

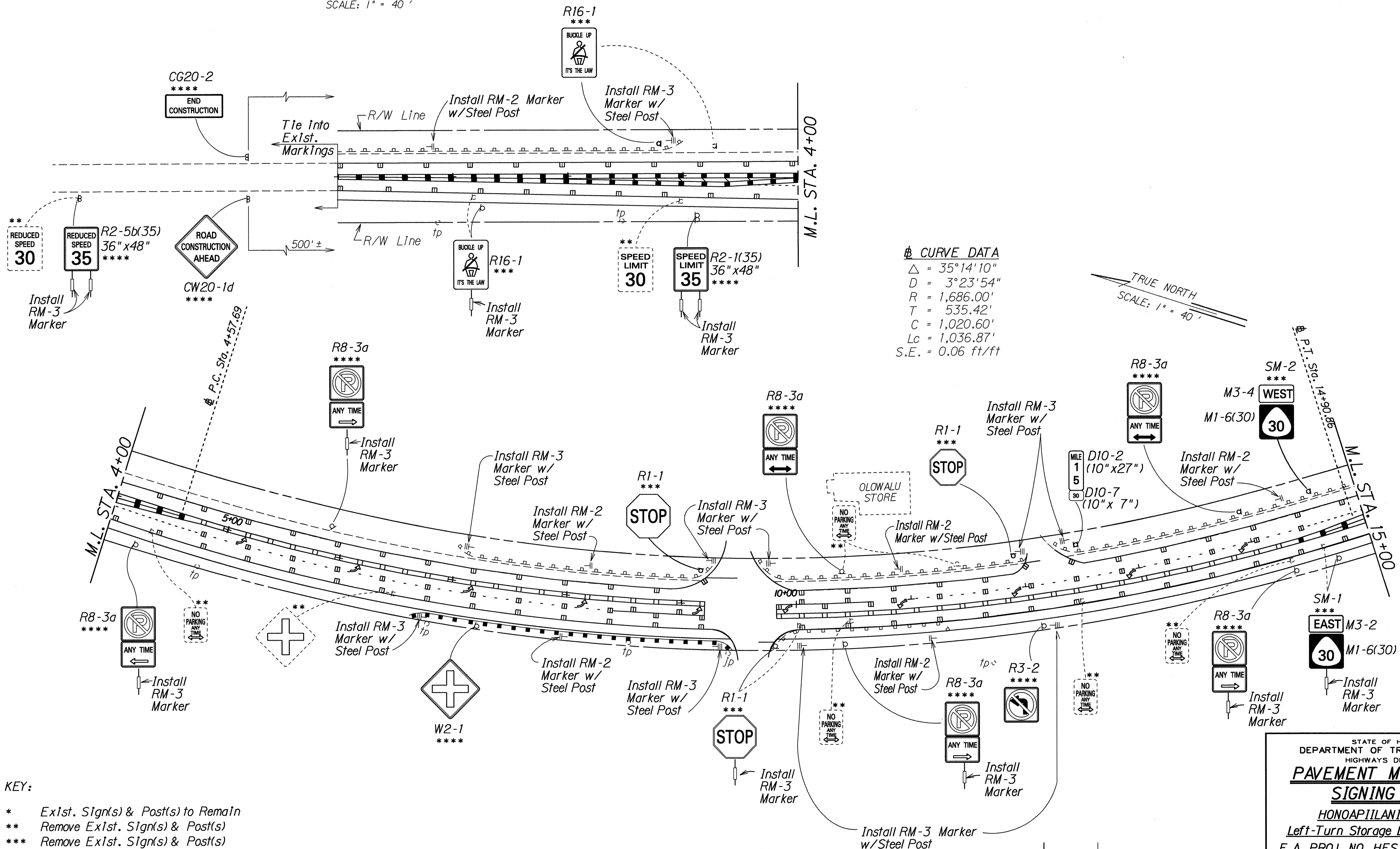

CURVE DATA

Δ	= 35°14'10"
D	= 3°23'54"
R	= 1,686.00'
T	= 535.42'
C	= 1,020.60'
Lc	= 1,036.87'
S.E.	= 0.06 ft/ft

TRUE NORTH
SCALE: 1" = 40'

DATE	REVISION

- KEY:**
- * Exist. Sign(s) & Post(s) to Remain
 - ** Remove Exist. Sign(s) & Post(s)
 - *** Remove Exist. Sign(s) & Post(s) & Install New Sign(s) w/Post(s)
 - **** Install New Sign(s) w/Post(s)

STATE OF HAWAII
DEPARTMENT OF TRANSPORTATION
HIGHWAYS DIVISION

PAVEMENT MARKING & SIGNING PLAN

HONOAPIILANI HIGHWAY
Left-Turn Storage Lanes at Olowalu
F.A. PROJ. NO. HES-STP-030-1(19)

Scale: 1" = 40' Date: May, 1993

SHEET No. T2 OF 4 SHEETS

6/1/93	Deleted Acceleration Lane
DATE	REVISION

FED. ROAD DIST. NO.	STATE	FED. AID PROJ. NO.	FISCAL YEAR	SHEET NO.	TOTAL SHEETS
HAWAII	HAW.	HES-STP-030-1(19)	1993	9	14

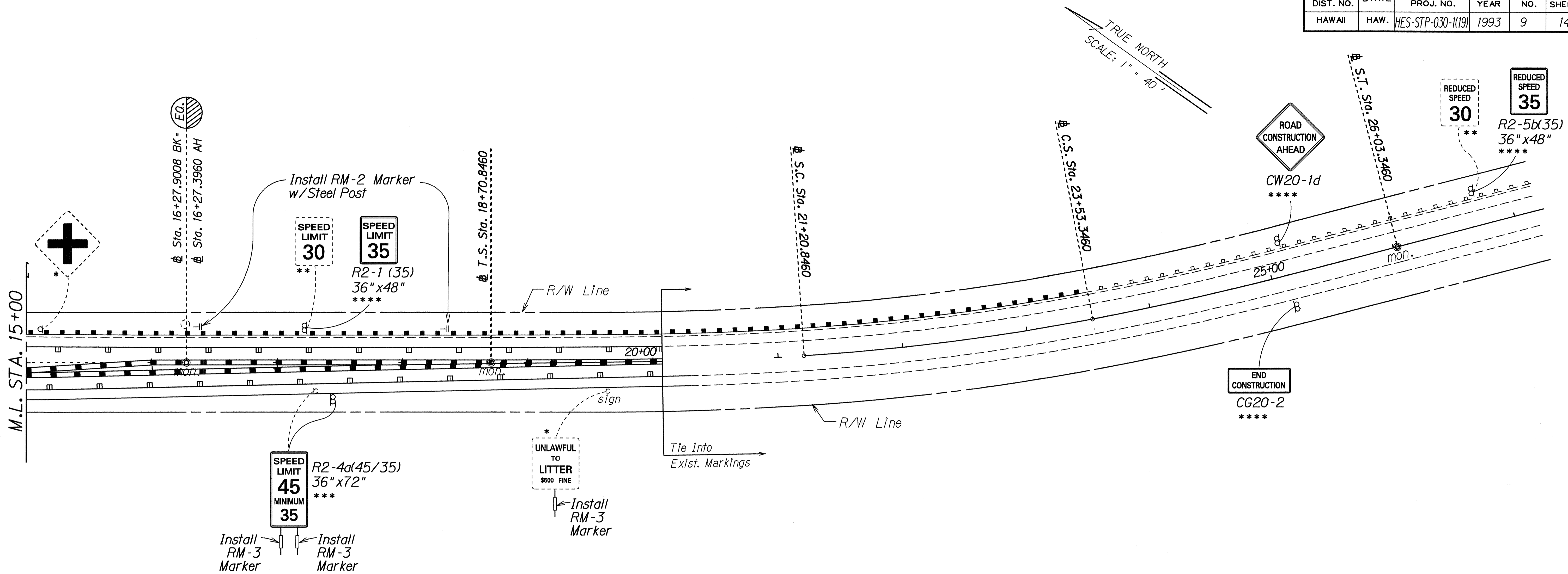

- KEY:
- * Exist. Sign(s) & Post(s) to Remain
 - ** Remove Exist. Sign(s) & Post(s)
 - *** Remove Exist. Sign(s) & Post(s) & Install New Sign(s) w/Post(s)
 - **** Install New Sign(s) w/Post(s)

DATE	REVISION
6/1/93	Added Post to R2-4a(45/35). Deleted Acceleration Lane.

STATE OF HAWAII
DEPARTMENT OF TRANSPORTATION
HIGHWAYS DIVISION

PAVEMENT MARKING & SIGNING PLAN

HONOAPIILANI HIGHWAY
Left-Turn Storage Lanes at Olowalu

F.A. PROJ. NO. HES-STP-030-1(19)

Scale: 1" = 40' Date: May, 1993

SHEET No. T3 OF 4 SHEETS

SURVEY PLOTTED BY	DATE
DESIGNED BY	
NOTED BY	
CHECKED BY	
QUANTITIES BY	
DATE	