

FED. ROAD DIST. NO.	STATE	FED. AID PROJ. NO.	FISCAL YEAR	SHEET NO.	TOTAL SHEETS
HAWAII	HAW	F-030-1(18)	1984	57	169

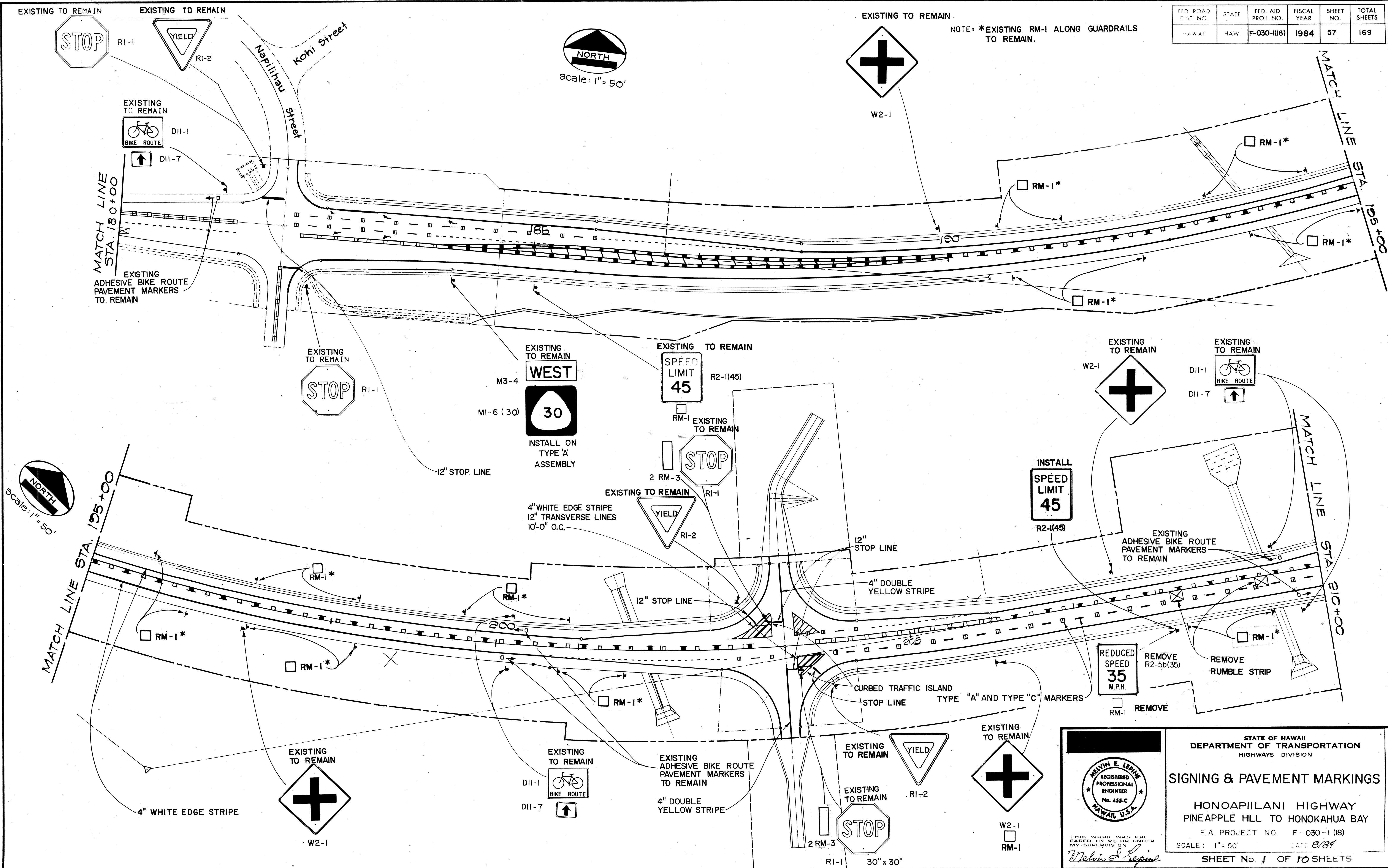

DATE
SURVEY PLOTTED BY
DESIGNED BY
QUANTITIES BY
CHECKED BY
ORIGINAL PLAN
NOTE BOOK
No.

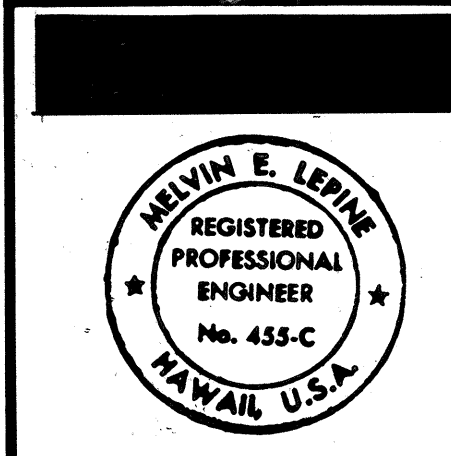

THIS WORK WAS PREPARED BY ME OR UNDER MY SUPERVISION
Melvin E. LePine

STATE OF HAWAII
 DEPARTMENT OF TRANSPORTATION
 HIGHWAYS DIVISION

SIGNING & PAVEMENT MARKINGS

HONOAPIILANI HIGHWAY
 PINEAPPLE HILL TO HONOKAHUA BAY

F.A. PROJECT NO. F-030-1 (18)
 SCALE: 1" = 50' DATE: 8/84

SHEET No. 1 OF 10 SHEETS

FED. ROAD DIST. NO.	STATE	FED. AID PROJ. NO.	FISCAL YEAR	SHEET NO.	TOTAL SHEETS
HAWAII	HAW.	F-030-1(18)	1984	58	169

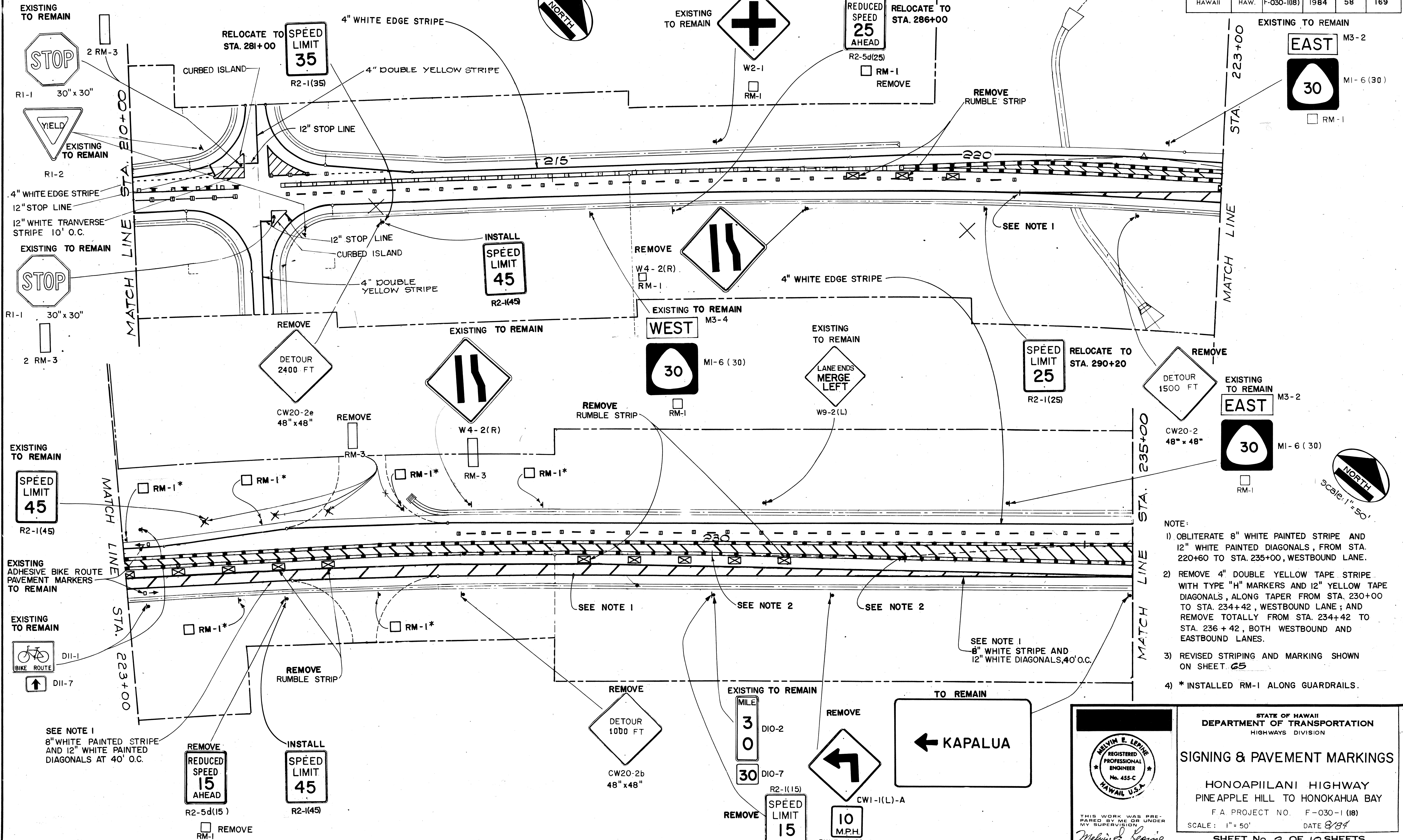
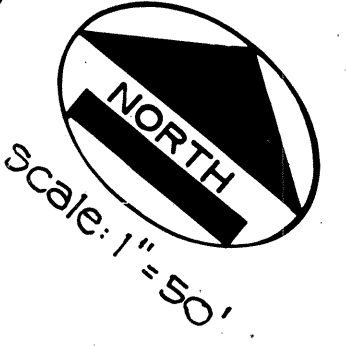
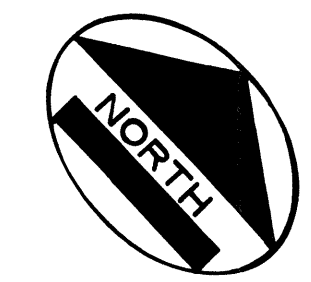

- NOTE:
- 1) OBLITERATE 8" WHITE PAINTED STRIPE AND 12" WHITE PAINTED DIAGONALS, FROM STA. 220+60 TO STA. 235+00, WESTBOUND LANE.
 - 2) REMOVE 4" DOUBLE YELLOW TAPE STRIPE WITH TYPE "H" MARKERS AND 12" YELLOW TAPE DIAGONALS, ALONG TAPER FROM STA. 230+00 TO STA. 234+42, WESTBOUND LANE; AND REMOVE TOTALLY FROM STA. 234+42 TO STA. 236+42, BOTH WESTBOUND AND EASTBOUND LANES.
 - 3) REVISED STRIPING AND MARKING SHOWN ON SHEET 65
 - 4) * INSTALLED RM-1 ALONG GUARDRAILS.

DATE
DESIGNED BY
DRAWN BY
CHECKED BY
ORIGINAL PLAN
NOTE BOOK
No.

STATE OF HAWAII
DEPARTMENT OF TRANSPORTATION
HIGHWAYS DIVISION

SIGNING & PAVEMENT MARKINGS

HONOAPIILANI HIGHWAY
PINEAPPLE HILL TO HONOKAHUA BAY

F.A. PROJECT NO. F-030-1 (18)
SCALE: 1" = 50' DATE 8/84

SHEET No. 2 OF 10 SHEETS

THIS WORK WAS PREPARED BY ME OR UNDER MY SUPERVISION

Melvin E. Levine

FED. ROAD DIST. NO.	STATE	FED. AID PROJ. NO.	FISCAL YEAR	SHEET NO.	TOTAL SHEETS
HAWAII	HAW.	F-030-1(8)	1984	59	169

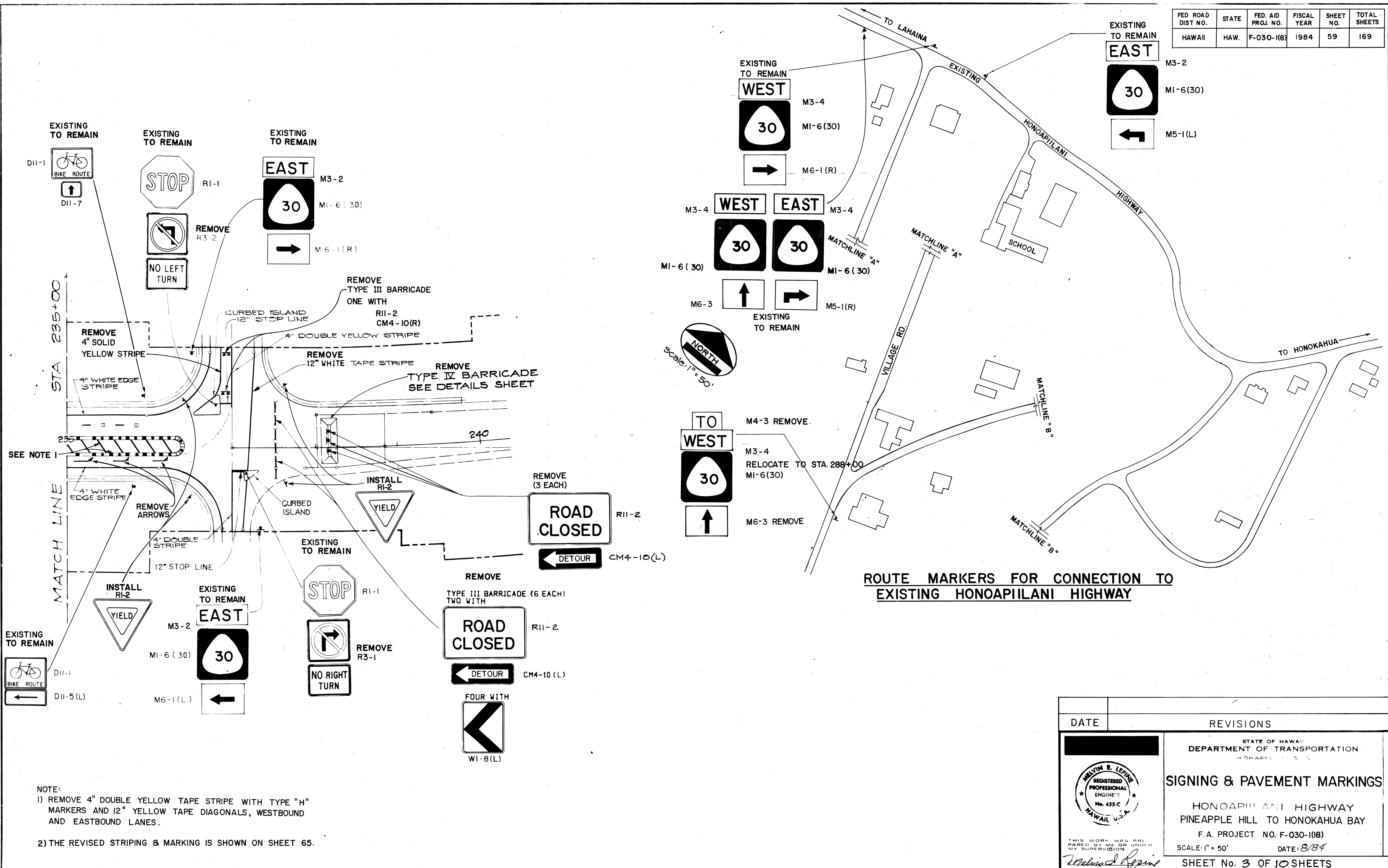

ROUTE MARKERS FOR CONNECTION TO EXISTING HONOAPIILANI HIGHWAY

NOTE:
 1) REMOVE 4" DOUBLE YELLOW TAPE STRIPE WITH TYPE "H" MARKERS AND 12" YELLOW TAPE DIAGONALS, WESTBOUND AND EASTBOUND LANES.
 2) THE REVISED STRIPING & MARKING IS SHOWN ON SHEET 65.

DATE	BY

DATE	REVISIONS

STATE OF HAWAII
 DEPARTMENT OF TRANSPORTATION
 HIGHWAYS

SIGNING & PAVEMENT MARKINGS

HONOAPIILANI HIGHWAY
 PINEAPPLE HILL TO HONOKAHUA BAY
 F.A. PROJECT NO. F-030-1(18)
 SCALE: 1" = 50' DATE: 8/84

SHEET No. 3 OF 10 SHEETS

REGISTERED PROFESSIONAL ENGINEER
 No. 455-C
 HAWAII, U.S.A.

THIS WORK WAS PREPARED BY ME OR UNDER MY SUPERVISION

FED. ROAD DIST. NO.	STATE	FED. AID PROJ. NO.	FISCAL YEAR	SHEET NO.	TOTAL SHEETS
HAWAII	HAW.	F-030-1(18)	1984	60	169

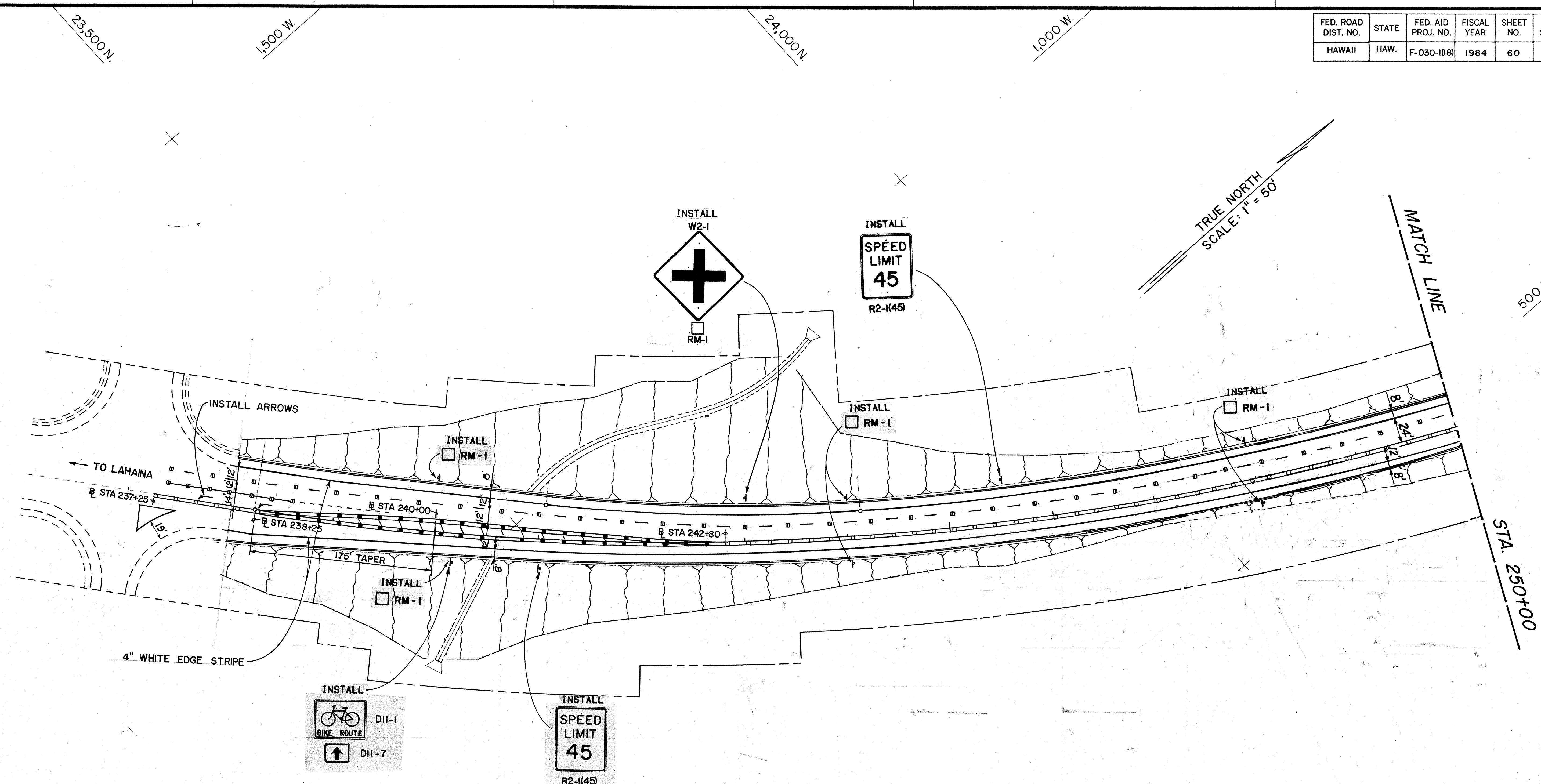

- LEGEND: (PAVEMENT MARKERS)
- 4 TYPE "A" (NON-REFLECTIVE WHITE)
 - 4 TYPE "J" (NON-REFLECTIVE YELLOW)
 - TYPE "C" (RED-CLEAR REFLECTIVE)
 - TYPE "D" (TWO-WAY YELLOW REFLECTIVE)
 - TYPE "H" (ONE-WAY YELLOW REFLECTIVE)

- LEGEND: (PAVEMENT MARKINGS)
- 4" WHITE EDGE STRIPE (PAINT)
 - 8" WHITE STRIPE WITH TYPE "C" MARKERS 20' O.C. (TAPE)
 - 4" YELLOW STRIPE WITH TYPE "H", "J" AND "D" MARKERS (TAPE)
 - 4" DOUBLE YELLOW STRIPE WITH TYPE "D" MARKERS 20'-0" O.C. (TAPE)
 - TYPE "J" AND "D" MARKERS
 - 4" WHITE GUIDE LINE (TAPE)
 - TYPE "A" AND "C" MARKERS
 - 4" DOUBLE YELLOW STRIPE AND TRANSVERSE LINES WITH TYPE "H" MARKERS 20'-0" O.C. (TAPE)

SURVEY PLOTTED BY: _____ DATE: _____
 DRAWN BY: _____
 DESIGNED BY: _____
 NOTE BOOK: _____
 QUANTITIES BY: _____
 CHECKED BY: _____
 No. _____

THIS WORK WAS PREPARED BY ME OR UNDER MY SUPERVISION.
Melvin E. Lepine

STATE OF HAWAII
 DEPARTMENT OF TRANSPORTATION
 HIGHWAYS DIVISION
SIGNING & PAVEMENT MARKINGS
 HONOAPIILANI HIGHWAY
 PINEAPPLE HILL TO HONOKAHUA BAY
 F.A. PROJECT NO. F-030-1 (18)
 SCALE: 1" = 50' DATE 8/84
SHEET No. 4 OF 10 SHEETS

FED. ROAD DIST. NO.	STATE	FED. AID PROJ. NO.	FISCAL YEAR	SHEET NO.	TOTAL SHEETS
HAWAII	HAW.	F-030-1(18)	1984	61	169

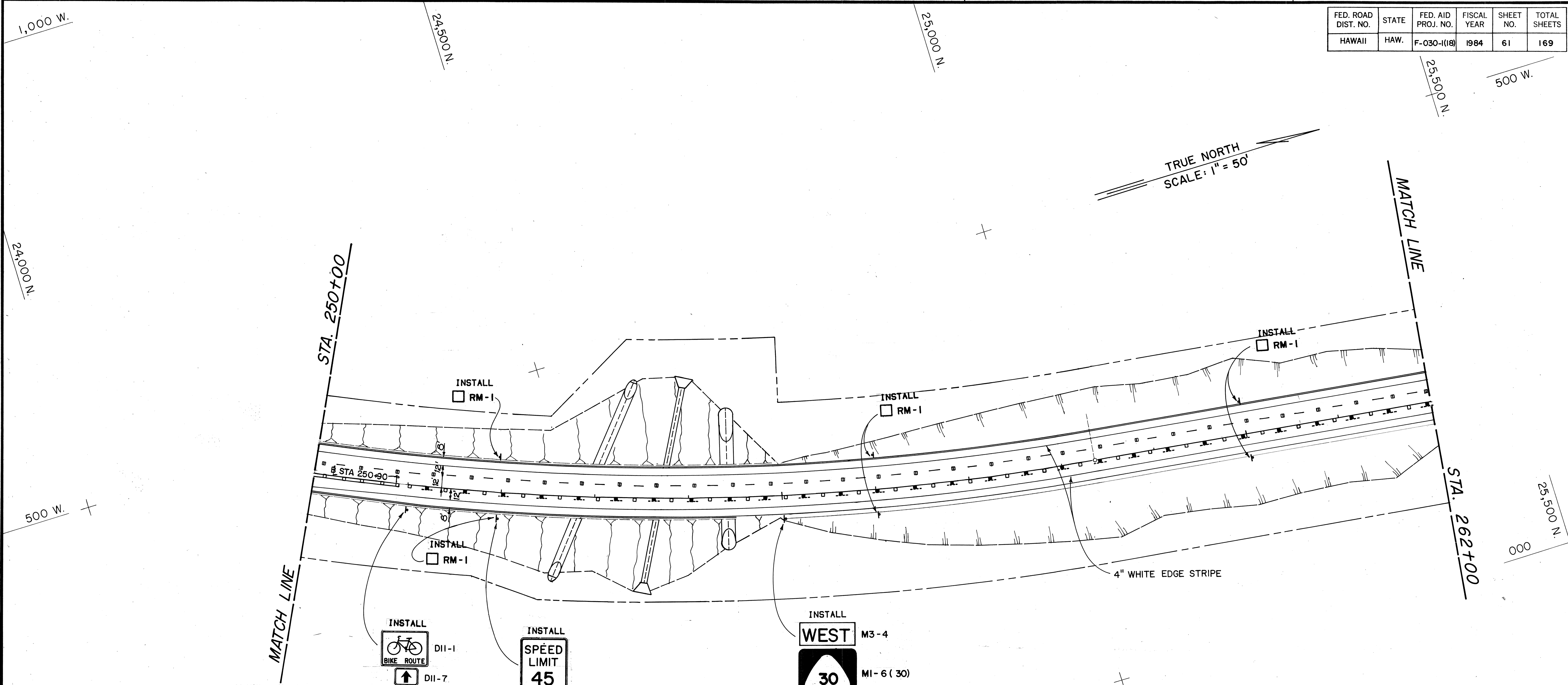

- LEGEND: (PAVEMENT MARKINGS)**
- 4" WHITE EDGE STRIPE (PAINT)
 - 8" WHITE STRIPE WITH TYPE "C" MARKERS 20' O.C. (TAPE)
 - 4" YELLOW STRIPE WITH TYPE "H", "J" AND "D" MARKERS (TAPE)
 - 4" DOUBLE YELLOW STRIPE WITH TYPE "D" MARKERS 20'-0" O.C. (TAPE)
 - TYPE "J" AND "D" MARKERS
 - 4" WHITE GUIDE LINE (TAPE)
 - TYPE "A" AND "C" MARKERS
 - 4" DOUBLE YELLOW STRIPE AND TRANSVERSE LINES WITH TYPE "H" MARKERS 20'-0" O.C. (TAPE)

- LEGEND: (PAVEMENT MARKERS)**
- 4 TYPE "A" (NON-REFLECTIVE WHITE)
 - 4 TYPE "J" (NON-REFLECTIVE YELLOW)
 - TYPE "C" (RED-CLEAR REFLECTIVE)
 - TYPE "D" (TWO-WAY YELLOW REFLECTIVE)
 - TYPE "H" (ONE-WAY YELLOW REFLECTIVE)

INSTALL WEST M3-4

INSTALL 30 MI-6(30)

INSTALL ON TYPE "A" ASSEMBLY

RM-1

INSTALL BICYCLE ROUTE DII-1

INSTALL ↑ DII-7

INSTALL SPEED LIMIT 45 R2-1(45)

SURVEY PLOTTED BY	DATE
DRAWN BY	
DESIGNED BY	
QUANTITIES BY	
CHECKED BY	
ORIGINAL PLAN	
NOTE BOOK	
No.	

MELVIN E. LEPIVÉ
REGISTERED PROFESSIONAL ENGINEER
No. 455-C
HAWAII U.S.A.

THIS WORK WAS PREPARED BY ME OR UNDER MY SUPERVISION

Melvin E. Lepivé

STATE OF HAWAII
DEPARTMENT OF TRANSPORTATION
HIGHWAYS DIVISION

SIGNING & PAVEMENT MARKINGS

HONOAPIILANI HIGHWAY
PINEAPPLE HILL TO HONOKAHUA BAY

F.A. PROJECT NO. F-030-1 (18)

SCALE: 1" = 50' DATE 8/84

SHEET No. 5 OF 10 SHEETS

FED. ROAD DIST. NO.	STATE	FED. AID PROJ. NO.	FISCAL YEAR	SHEET NO.	TOTAL SHEETS
HAWAII	HAW.	F-030-1(18)	1984	62	169

500 W.

25,500 N.

26,000 N.

26,500 N.

TRUE NORTH
SCALE: 1" = 50'

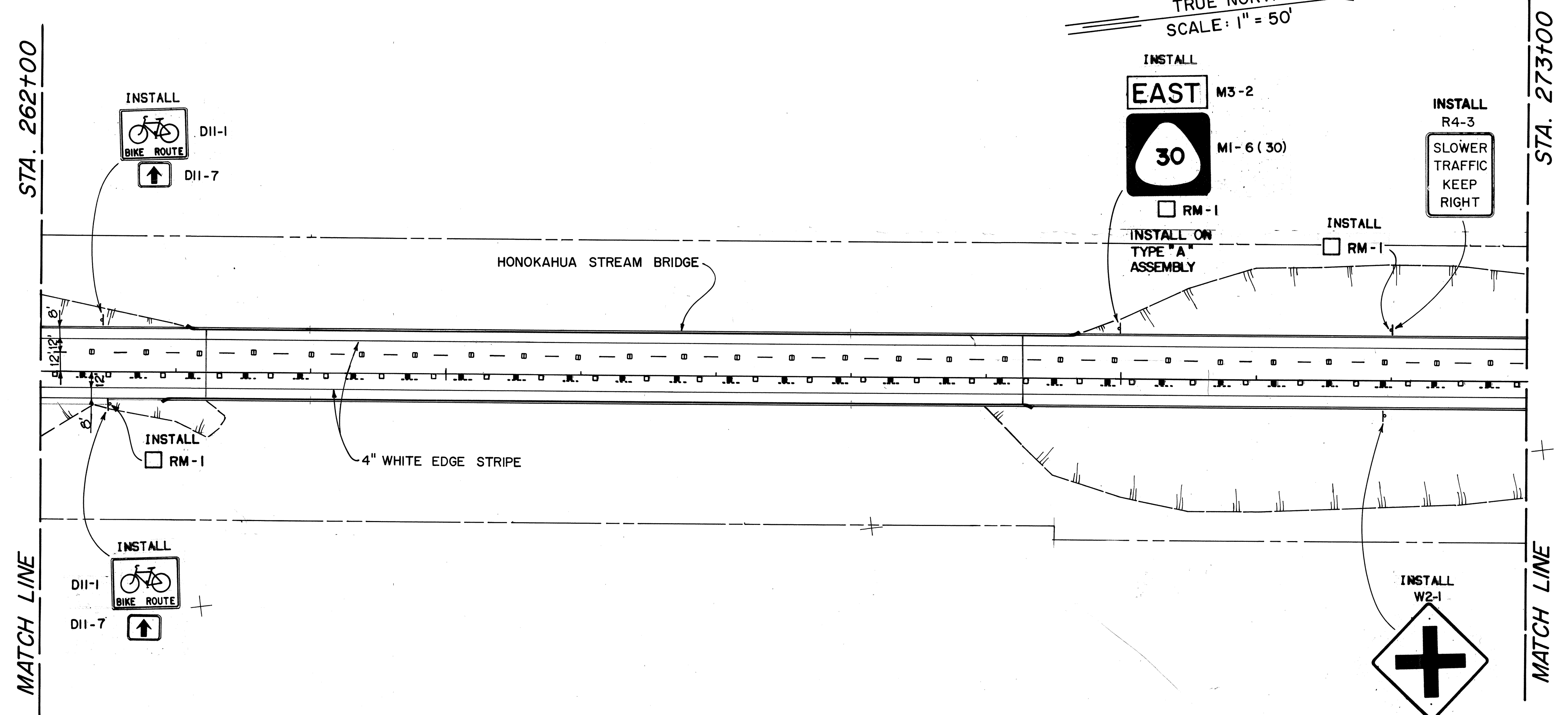

STA. 262+00

STA. 273+00

HONOKAHUA STREAM BRIDGE

4" WHITE EDGE STRIPE

MATCH LINE

MATCH LINE

000

000

- LEGEND: (PAVEMENT MARKERS)
- 4 TYPE "A" (NON-REFLECTIVE WHITE)
 - 4 TYPE "J" (NON-REFLECTIVE YELLOW)
 - ▣ TYPE "C" (RED-CLEAR REFLECTIVE)
 - TYPE "D" (TWO-WAY YELLOW REFLECTIVE)
 - TYPE "H" (ONE-WAY YELLOW REFLECTIVE)

- LEGEND: (PAVEMENT MARKINGS)
- 4" WHITE EDGE STRIPE (PAINT)
 - 8" WHITE STRIPE WITH TYPE "C" MARKERS 20' O.C. (TAPE)
 - 4" YELLOW STRIPE WITH TYPE "H", "J" AND "D" MARKERS (TAPE)
 - 4" DOUBLE YELLOW STRIPE WITH TYPE "D" MARKERS 20'-0" O.C. (TAPE)
 - TYPE "J" AND "D" MARKERS
 - 4" WHITE GUIDE LINE (TAPE)
 - TYPE "A" AND "C" MARKERS
 - 4" DOUBLE YELLOW STRIPE AND TRANSVERSE LINES WITH TYPE "H" MARKERS 20'-0" O.C. (TAPE)

25,500 N.

26,000 N.

26,500 N.

500 E.

ORIGINAL PLAN
NOTE BOOK
No.

MELVIN E. LEVINE
REGISTERED PROFESSIONAL ENGINEER
No. 455-C
HAWAII, U.S.A.

THIS WORK WAS PREPARED BY ME OR UNDER MY SUPERVISION.
Melvin E. Levine

STATE OF HAWAII
DEPARTMENT OF TRANSPORTATION
HIGHWAYS DIVISION

SIGNING & PAVEMENT MARKINGS

HONOAPIILANI HIGHWAY
PINEAPPLE HILL TO HONOKAHUA BAY

F.A. PROJECT NO. F-030-1 (18)
SCALE: 1" = 50' DATE 8/84

SHEET No. 6 OF 10 SHEETS

FED. ROAD DIST. NO.	STATE	FED. AID PROJ. NO.	FISCAL YEAR	SHEET NO.	TOTAL SHEETS
HAWAII	HAW.	F-030-1(18)	1984	63	169

TRUE NORTH
SCALE: 1" = 50'

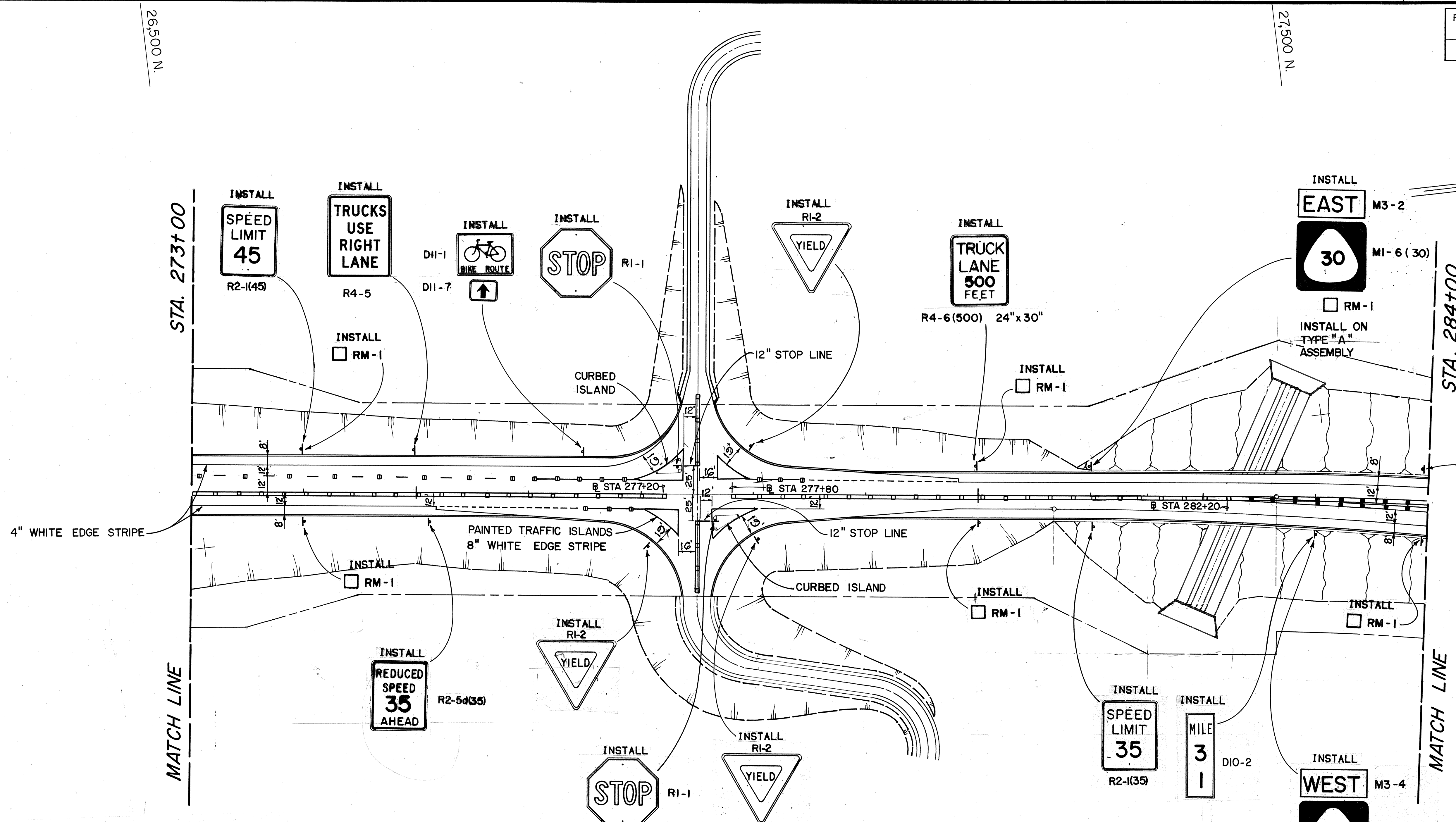

LEGEND: (PAVEMENT MARKINGS)

- 4" WHITE EDGE STRIPE (PAINT)
- 8" WHITE STRIPE WITH TYPE "C" MARKERS 20'-0" O.C. (TAPE)
- 4" YELLOW STRIPE WITH TYPE "H", "J" AND "D" MARKERS (TAPE)
- 4" DOUBLE YELLOW STRIPE WITH TYPE "D" MARKERS 20'-0" O.C. (TAPE)
- TYPE "J" AND "D" MARKERS
- 4" WHITE GUIDE LINE (TAPE)
- TYPE "A" AND "C" MARKERS
- 4" DOUBLE YELLOW STRIPE AND TRANSVERSE LINES WITH TYPE "H" MARKERS 20'-0" O.C. (TAPE)

LEGEND: (PAVEMENT MARKERS)

- 4 TYPE "A" (NON-REFLECTIVE WHITE)
- 4 TYPE "J" (NON-REFLECTIVE YELLOW)
- TYPE "C" (RED-CLEAR REFLECTIVE)
- TYPE "D" (TWO-WAY YELLOW REFLECTIVE)
- TYPE "H" (ONE-WAY YELLOW REFLECTIVE)

ORIGINAL PLAN
DATE
DRAWN BY
DESIGNED BY
NOTE BOOK
QUANTITIES BY
CHECKED BY

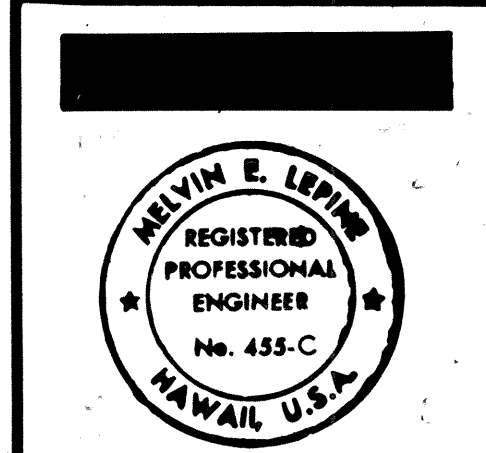

STATE OF HAWAII
DEPARTMENT OF TRANSPORTATION
HIGHWAYS DIVISION
SIGNING & PAVEMENT MARKINGS
HONOAPIILANI HIGHWAY
PINEAPPLE HILL TO HONOKAHUA BAY
F.A. PROJECT NO. F-030-1 (18)
SCALE: 1" = 50' DATE 8/81
SHEET No. 7 OF 10 SHEETS

FED. ROAD DIST. NO.	STATE	FED. AID PROJ. NO.	FISCAL YEAR	SHEET NO.	TOTAL SHEETS
HAWAII	HAW.	F-030-1(8)	1984	64	169

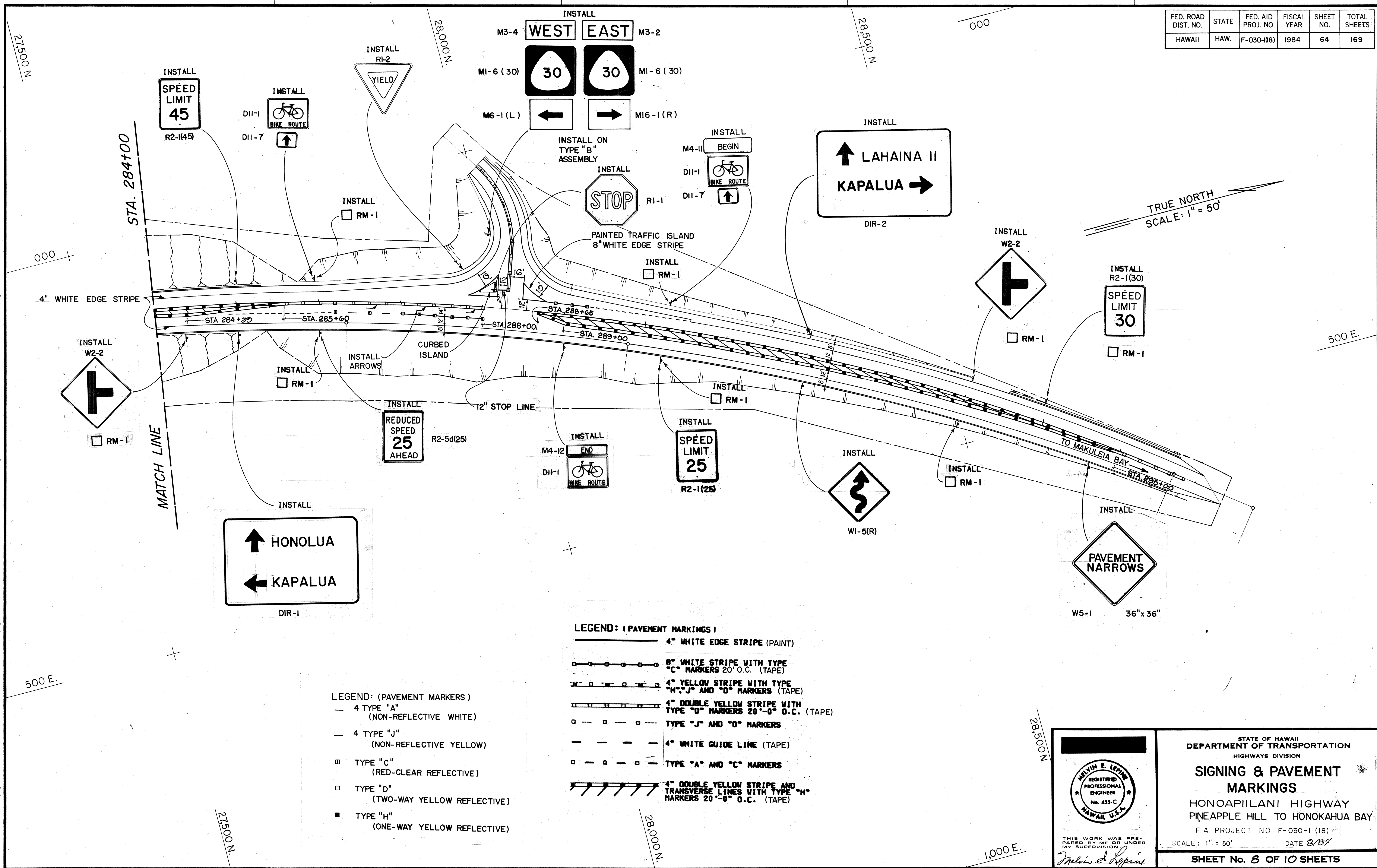

TRUE NORTH
SCALE: 1" = 50'

LEGEND: (PAVEMENT MARKINGS)

- 4" WHITE EDGE STRIPE (PAINT)
- 8" WHITE STRIPE WITH TYPE "C" MARKERS 20' O.C. (TAPE)
- 4" YELLOW STRIPE WITH TYPE "H", "J" AND "D" MARKERS (TAPE)
- 4" DOUBLE YELLOW STRIPE WITH TYPE "D" MARKERS 20'-0" O.C. (TAPE)
- TYPE "J" AND "D" MARKERS
- 4" WHITE GUIDE LINE (TAPE)
- TYPE "A" AND "C" MARKERS
- 4" DOUBLE YELLOW STRIPE AND TRANSVERSE LINES WITH TYPE "H" MARKERS 20'-0" O.C. (TAPE)

LEGEND: (PAVEMENT MARKERS)

- 4 TYPE "A" (NON-REFLECTIVE WHITE)
- 4 TYPE "J" (NON-REFLECTIVE YELLOW)
- TYPE "C" (RED-CLEAR REFLECTIVE)
- TYPE "D" (TWO-WAY YELLOW REFLECTIVE)
- TYPE "H" (ONE-WAY YELLOW REFLECTIVE)

DATE	_____
SURVEY PLOTTED BY	_____
DRAWN BY	_____
TRACED BY	_____
DESIGNED BY	_____
QUANTITIES BY	_____
CHECKED BY	_____
ORIGINAL PLAN	_____
NOTE BOOK	_____
No.	_____

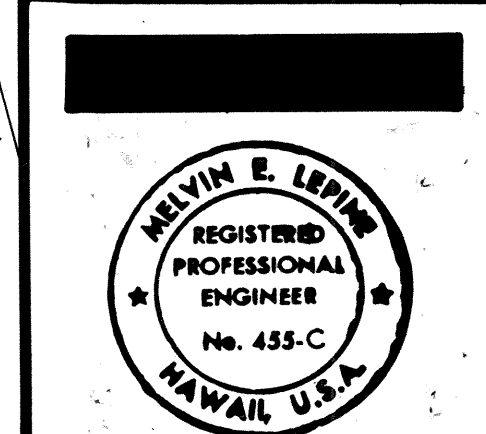

THIS WORK WAS PREPARED BY ME OR UNDER MY SUPERVISION
Melvin E. Lepine

STATE OF HAWAII
DEPARTMENT OF TRANSPORTATION
HIGHWAYS DIVISION

SIGNING & PAVEMENT MARKINGS

HONOAPIILANI HIGHWAY
PINEAPPLE HILL TO HONOKAHUA BAY

F.A. PROJECT NO. F-030-1 (18)

SCALE: 1" = 50' DATE 8/84

SHEET No. 8 OF 10 SHEETS

FED. ROAD DIST. NO.	STATE	FED. AID PROJ. NO.	FISCAL YEAR	SHEET NO.	TOTAL SHEETS
HAWAII	HAW.	F-030-1(18)	1984	65	169

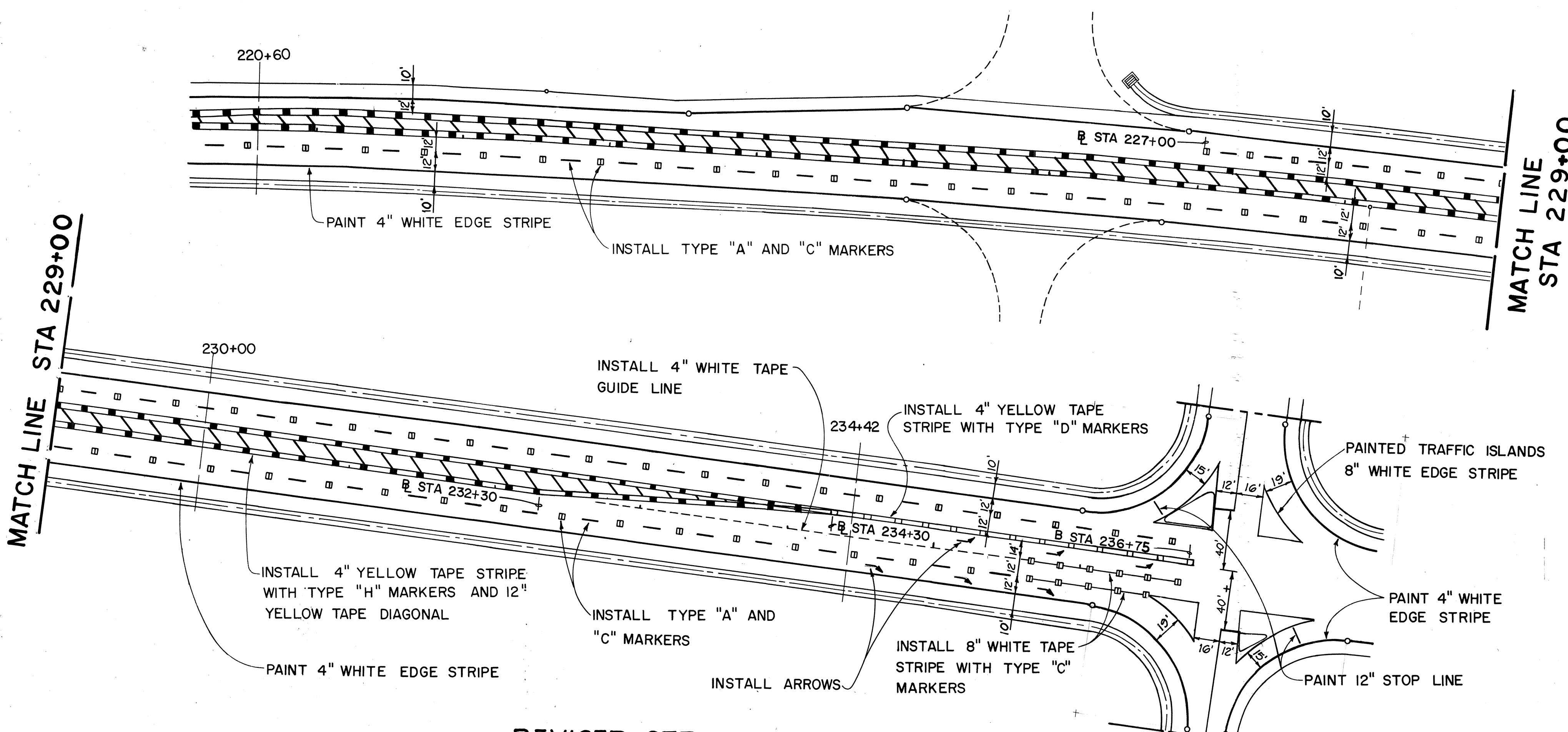

REVISED STRIPING AND PAVEMENT MARKING STA. 220+60 TO 238+00
SCALE: 1" = 50'-0"

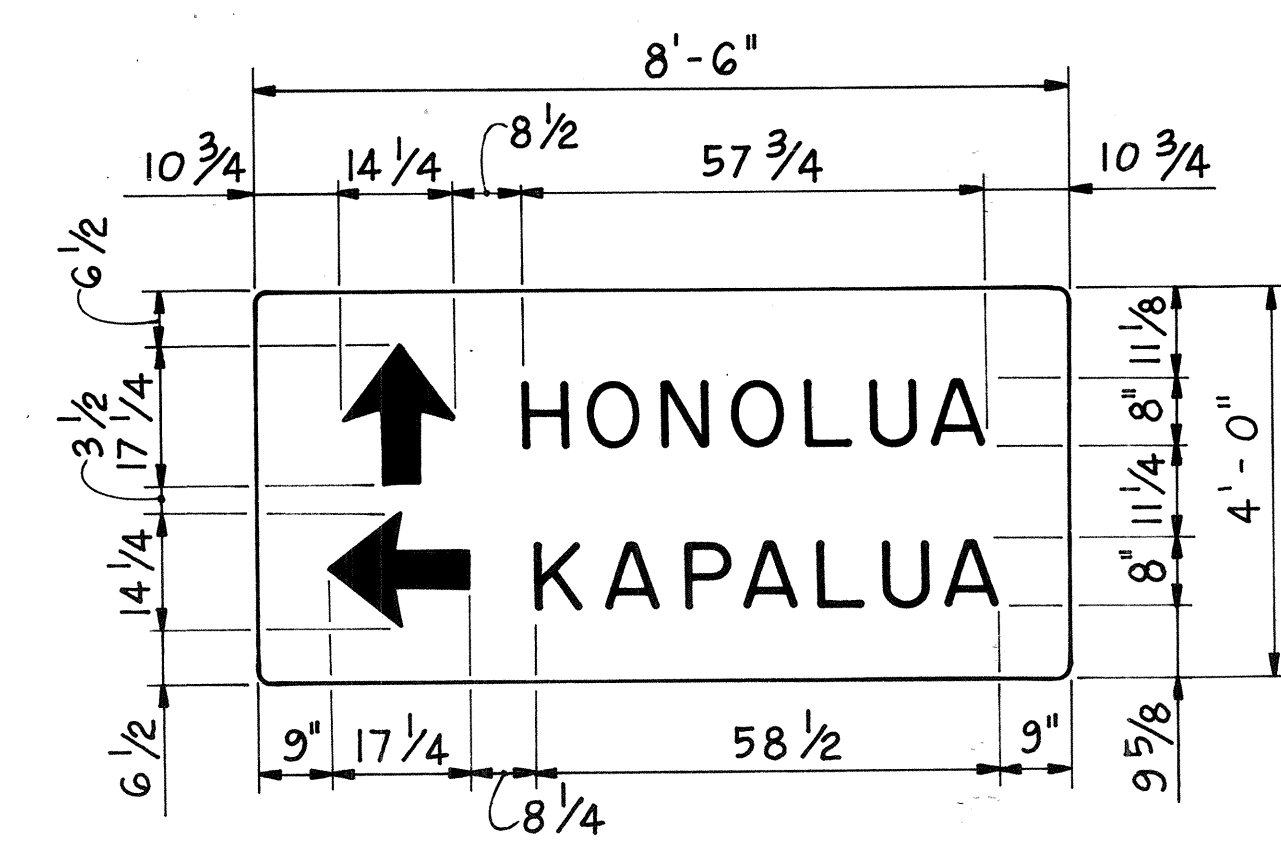

SIGN DIR-1
N.T.S.

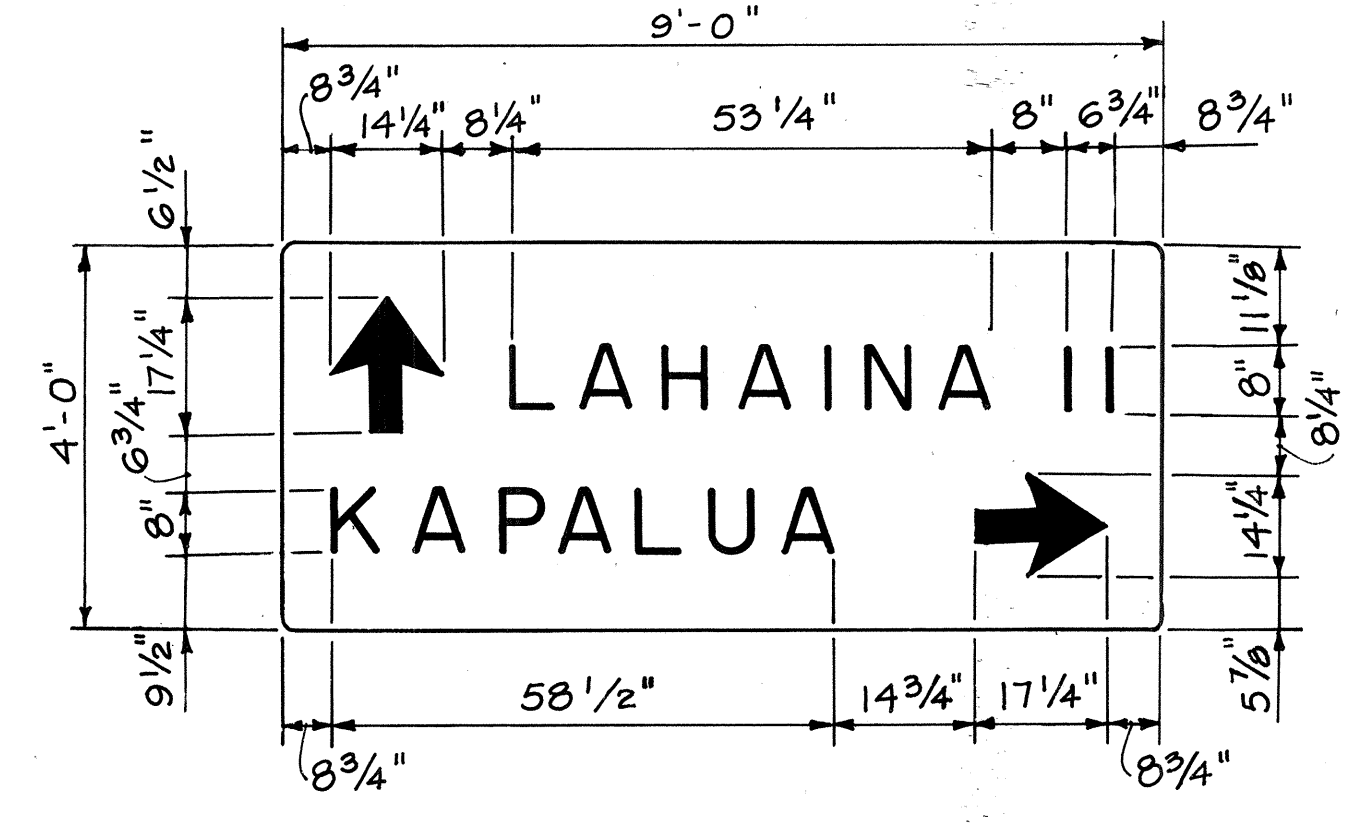

SIGN DIR-2
N.T.S.

- NOTES:**
- SIGNS SHALL CONFORM TO SERIES "E" LETTERS SHOWN IN THE "STANDARD ALPHABETS FOR HIGHWAY SIGNS," BUREAU OF PUBLIC ROADS 1966.
 - ARROWS, LEGENDS, AND BORDERS SHALL CONFORM WITH DETAILS SHOWN ON THE PLANS AND SHALL BE DEMOUNTABLE ALUMINUM CUTOUTS WITH WHITE REFLECTIVE SHEETING ON A GREEN REFLECTIVE SHEETING BACKGROUND.
 - SIGN BORDERS AND CORNER RADII FOR SIGN FACES DETAILED HEREIN SHALL BE 1/4 INCHES WIDE, AND 6 INCHES, RESPECTIVELY.
 - SIGN PANELS SHALL BE 0.100" SHEET ALUMINUM, SINGLE PLATE.
 - SEE MISCELLANEOUS SIGN DETAIL SHEET FOR MOUNTING DETAILS. USE 2-1/2"x2-1/2", 10-GAGE GALVANIZED STEEL SQUARE TUBE POST SUPPORT FOR EACH SIGN.

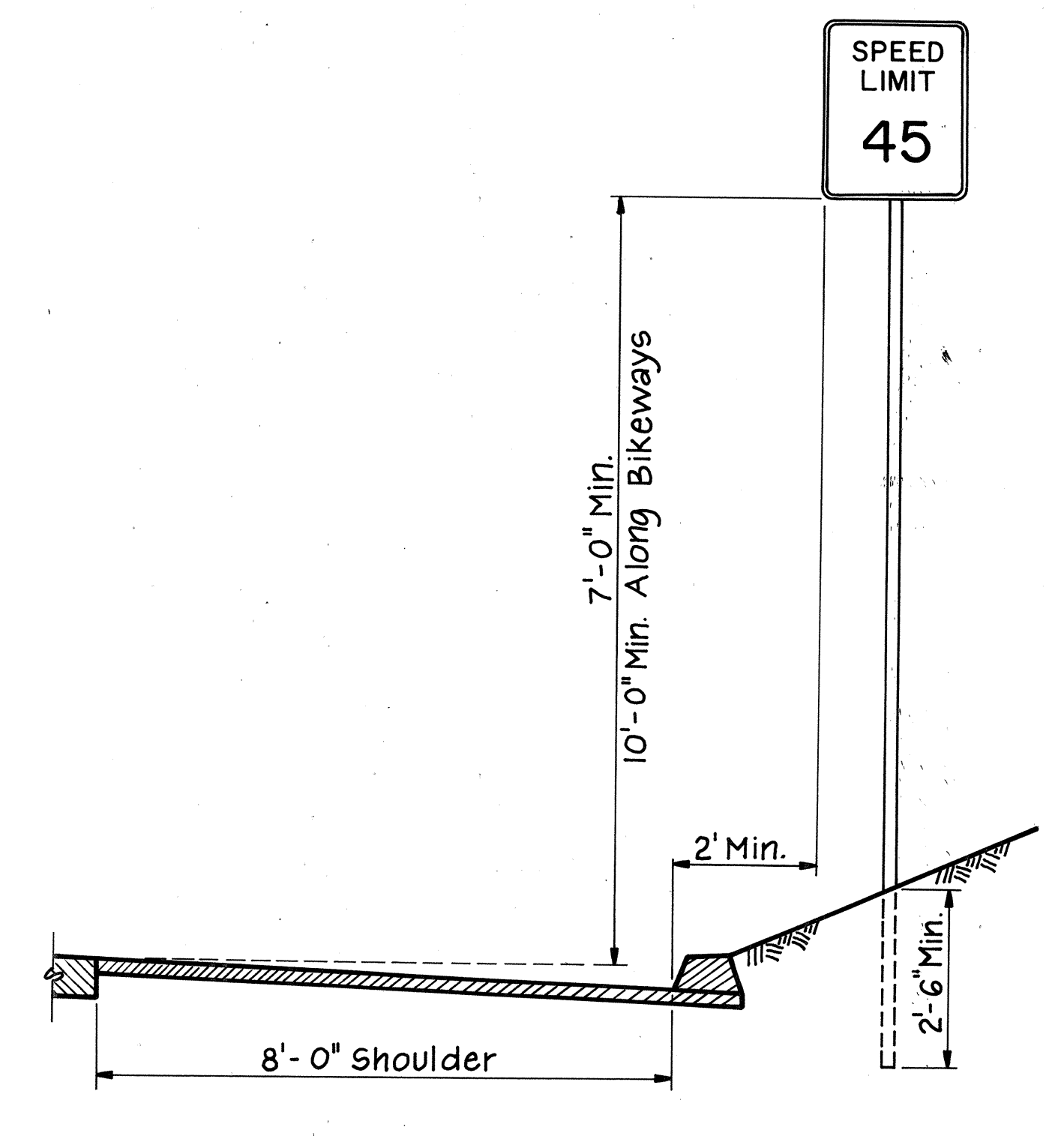

HEIGHT AND LATERAL LOCATIONS OF SIGNS TYPICAL INSTALLATION
N.T.S.

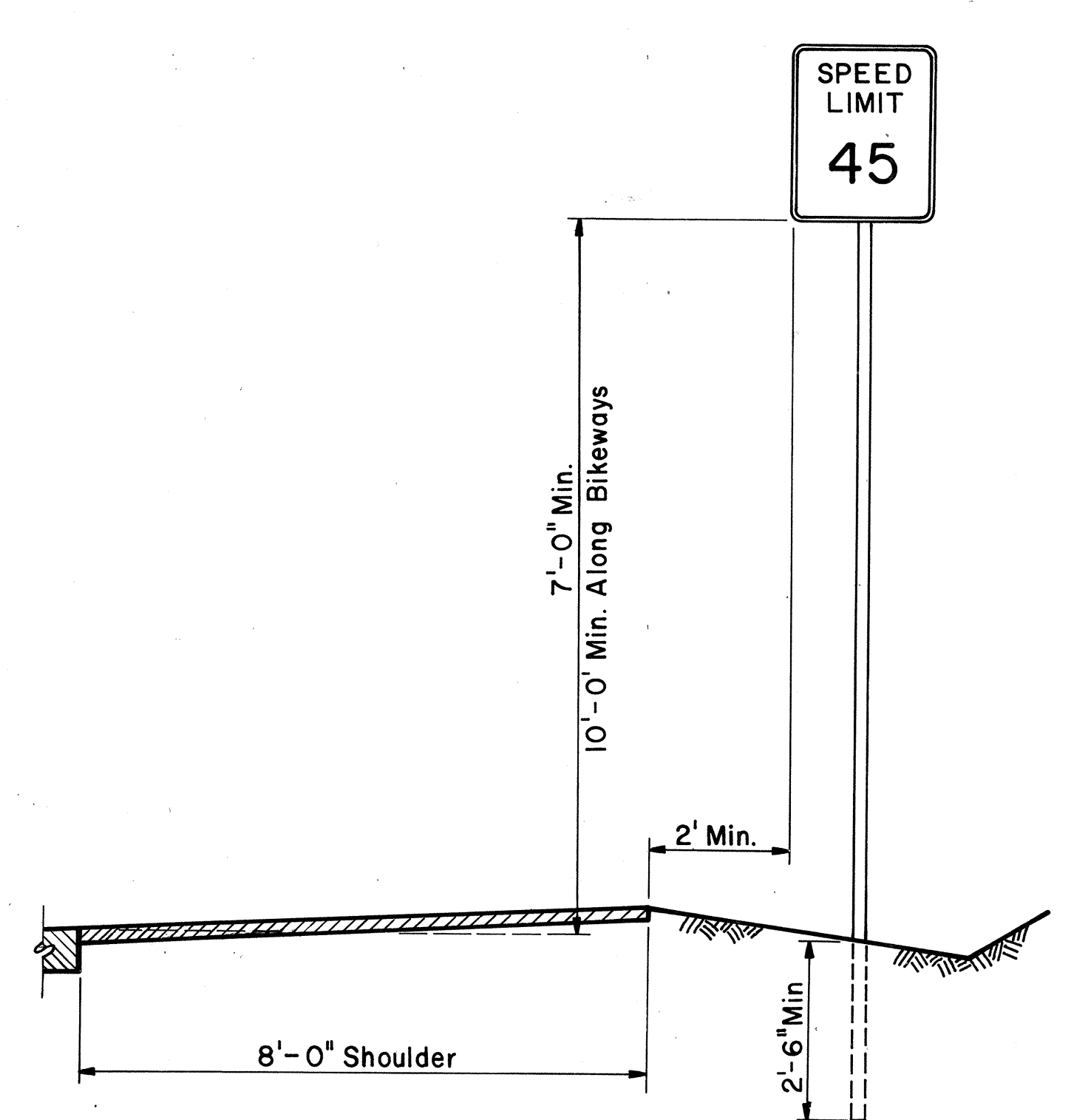

HEIGHT AND LATERAL LOCATIONS OF SIGNS TYPICAL INSTALLATION
N.T.S.

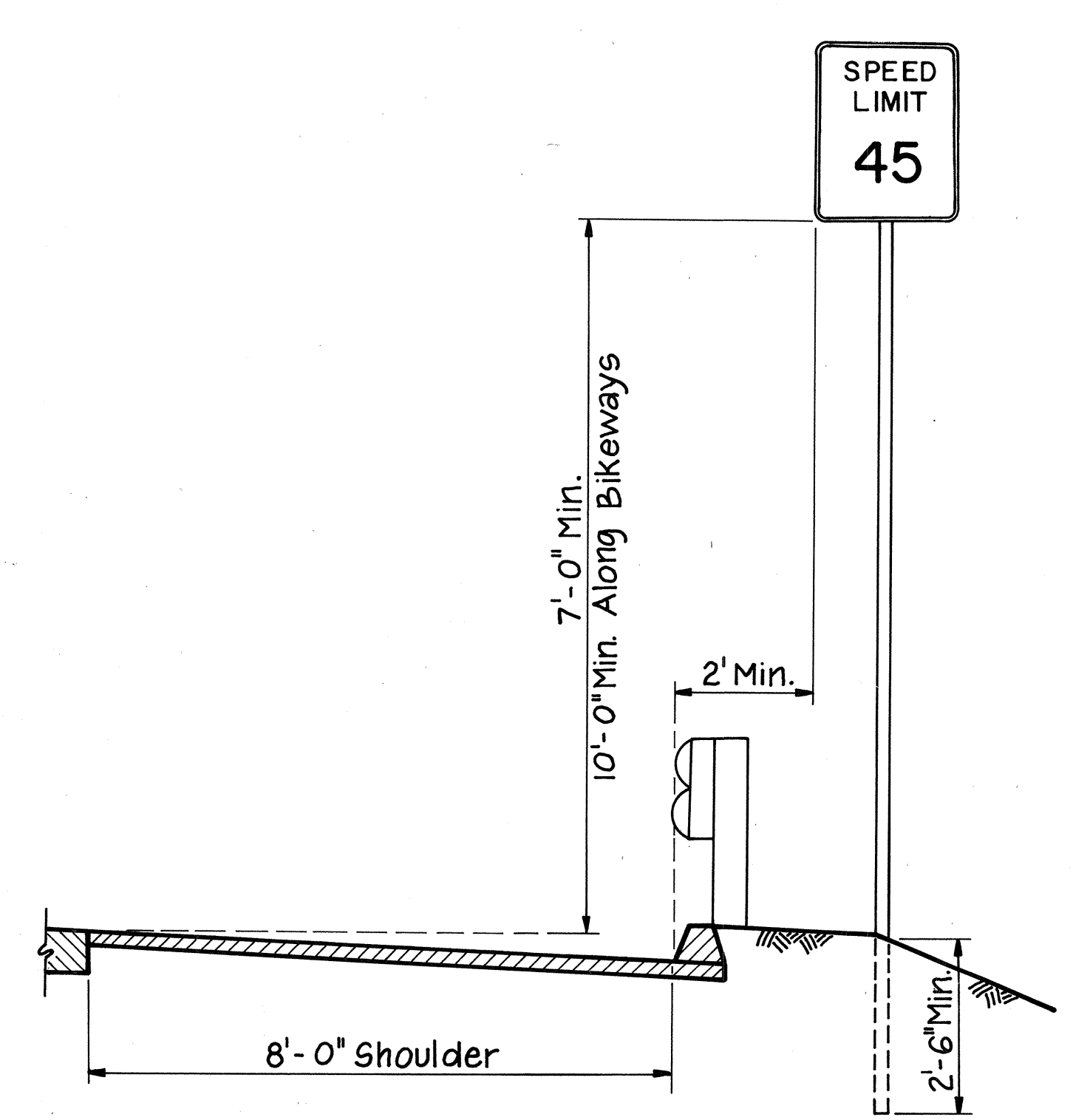

HEIGHT AND LATERAL LOCATIONS OF SIGNS TYPICAL INSTALLATION
N.T.S.

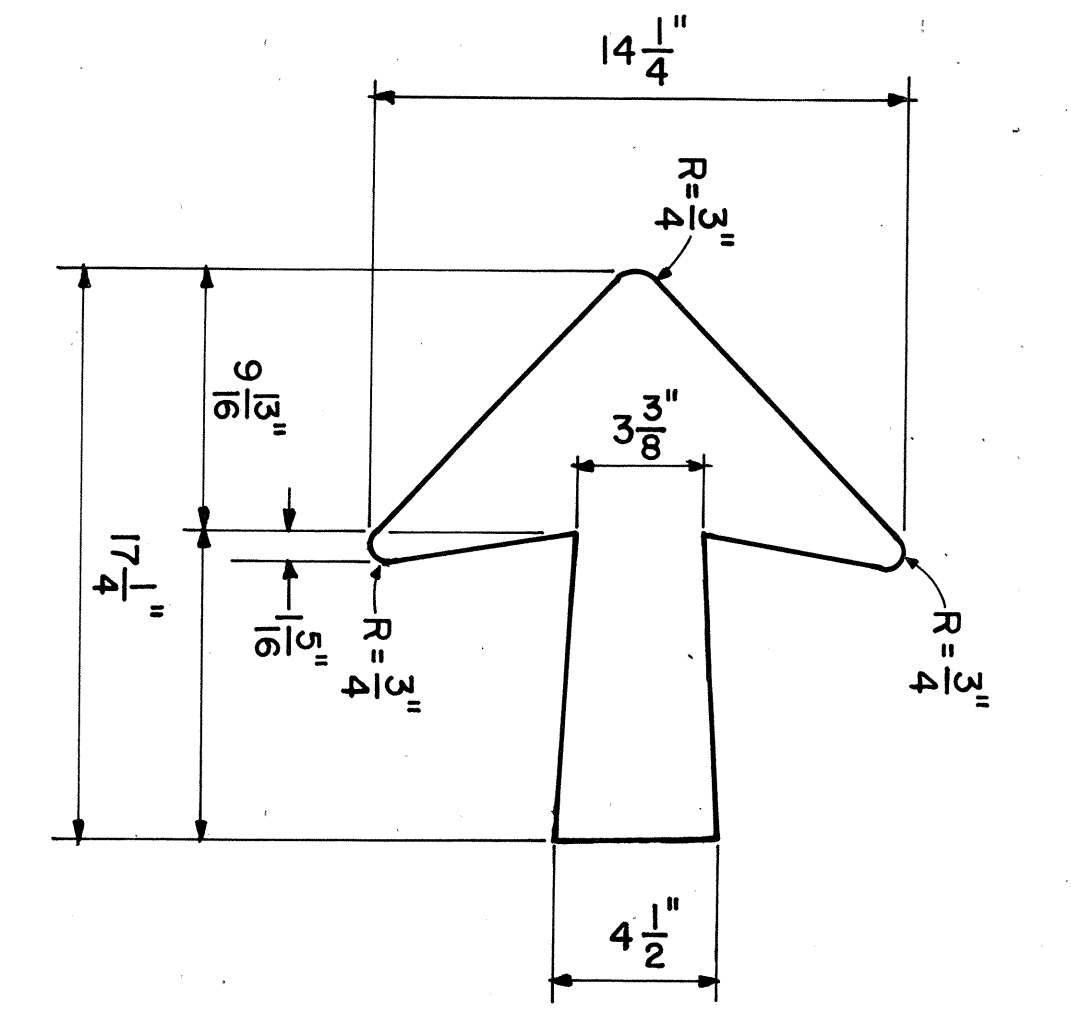

DIRECTION SIGN ARROW DETAIL
N.T.S.

THIS WORK WAS PREPARED BY ME OR UNDER MY SUPERVISION

MELVIN E. LEPPINE
REGISTERED PROFESSIONAL ENGINEER
No. 455-C
HAWAII U.S.A.

STATE OF HAWAII
DEPARTMENT OF TRANSPORTATION
HIGHWAYS DIVISION

SIGNING & PAVEMENT MARKINGS

HONOAPIILANI HIGHWAY
PINEAPPLE HILL TO HONOKAHUA

F.A. PROJECT NO. F-030-1 (18)
SCALE: AS SHOWN DATE 8/84

SHEET No. 9 OF 10 SHEETS

FED. ROAD DIST. NO.	STATE	FED. AID PROJ. NO.	FISCAL YEAR	SHEET NO.	TOTAL SHEETS
HAWAII	HAW.	F-030-1(18)	1984	66	169

SIGNING BY STATION

TO BE INSTALLED

STATION	TYPE	DESCRIPTION	RELOCATED FROM STA
208+15	RT	R2-1 (45) *	SPEED LIMIT 45 MPH
212+95	RT	R2-1 (45) *	SPEED LIMIT 45 MPH
224+90	RT	R2-1 (45) *	SPEED LIMIT 45 MPH
236+40	LT	R1-2 *	YIELD
236+50	RT	R1-2 *	YIELD
237+65	LT	R1-2 *	YIELD
237+65	RT	R1-2 *	YIELD
240+00	LT	RM-1 *	REFLECTIVE MARKER
240+15	RT	RM-1 *	REFLECTIVE MARKER
240+15	RT	D11-7	ARROW
240+15	RT	D11-1 *	BIKE ROUTE
241+00	RT	R2-1 (45) *	SPEED LIMIT 45 MPH
243+00	LT	W2-1 *	INTERSECTION
243+00	LT	RM-1 *	REFLECTIVE MARKER
244+00	LT	RM-1 *	REFLECTIVE MARKER
244+00	RT	RM-1 *	REFLECTIVE MARKER
245+55	LT	R2-1 (45) *	SPEED LIMIT 45 MPH
248+00	LT	RM-1 *	REFLECTIVE MARKER
248+00	RT	RM-1 *	REFLECTIVE MARKER
251+00	RT	D11-7	ARROW
251+00	RT	D11-1 *	BIKE ROUTE
251+95	RT	RM-1 *	REFLECTIVE MARKER
251+95	RT	R2-1 (45) *	SPEED LIMIT 45 MPH
252+00	LT	RM-1 *	REFLECTIVE MARKER
255+00	RT	RM-1 *	REFLECTIVE MARKER
255+00	RT	M1-6 (30) **	ROUTE 30
255+00	RT	M3-4	WEST
256+00	LT	RM-1 *	REFLECTIVE MARKER
256+00	RT	RM-1 *	REFLECTIVE MARKER
260+00	LT	RM-1 *	REFLECTIVE MARKER
260+00	RT	RM-1 *	REFLECTIVE MARKER
262+45	LT	D11-7	ARROW
262+45	LT	D11-1 *	BIKE ROUTE
262+50	RT	D11-1 *	BIKE ROUTE
262+50	RT	RM-1 *	REFLECTIVE MARKER
262+50	RT	D11-7	ARROW
270+00	LT	M3-2	EAST
270+00	LT	M1-6 (30) **	ROUTE 30
270+00	LT	RM-1 *	REFLECTIVE MARKER
271+95	RT	W2-1 *	INTERSECTION
271+95	RT	RM-1 *	REFLECTIVE MARKER
272+00	LT	R4-3 *	SLOWER TRAFFIC KEEP RT.
272+00	LT	RM-1 *	REFLECTIVE MARKER
274+00	LT	RM-1 *	REFLECTIVE MARKER
274+00	LT	R2-1 (45) *	SPEED LIMIT 45 MPH
274+00	RT	RM-1 *	REFLECTIVE MARKER
275+00	LT	R4-5 *	TRUCKS USE RIGHT LANE
275+10	RT	R2-5D (35) *	REDUCED SPEED AHEAD 35 MPH
276+50	LT	D11-1 *	BIKE ROUTE
276+50	LT	D11-7	ARROW
277+10	RT	R1-2 *	YIELD
277+35	LT	R1-1 *	STOP
277+65	RT	R1-1 *	STOP
278+00	RT	R1-2 *	YIELD
278+00	LT	R1-2 *	YIELD
280+00	LT	RM-1 *	REFLECTIVE MARKER
280+00	RT	RM-1 *	REFLECTIVE MARKER
280+00	LT	R4-6 (500) *	TRUCK LANE 500 FT
281+00	RT	R2-1 (35) *	SPEED LIMIT 35 MPH
283+00	RT	D10-2	MILE 31
283+00	RT	RM-1 *	REFLECTIVE MARKER
283+00	LT	RM-1 *	REFLECTIVE MARKER
283+00	RT	M1-6 (30) **	ROUTE 30
283+00	LT	M1-6 (30) **	ROUTE 30
283+00	RT	M3-4	WEST
283+00	LT	M3-2	EAST
284+00	RT	RM-1 *	REFLECTIVE MARKER
284+00	LT	W2-1 *	INTERSECTION
284+00	LT	RM-1 *	REFLECTIVE MARKER
284+35	RT	RM-1 *	REFLECTIVE MARKER
284+35	RT	W2-2 *	INTERSECTION
285+00	LT	R2-1 (45) *	SPEED LIMIT 45 MPH
285+00	RT	DIR-1 *	DIRECTION SIGN
286+00	LT	RM-1 *	REFLECTIVE MARKER
286+00	LT	D11-7	ARROW

STATION	TYPE	DESCRIPTION	RELOCATED FROM STA
286+00	LT	D11-1 *	BIKE ROUTE
286+00	RT	R2-5D (25) *	REDUCED SPEED AHEAD 25 MPH
286+00	LT	RM-1 *	REFLECTIVE MARKER
287+70	LT	R1-2 *	YIELD
288+00	LT	M6-1 (R)	RIGHT ARROW
288+00	LT	M3-2	EAST
288+00	LT	M1-6 (30) ***	ROUTE 30
288+00	LT	M3-4	WEST
288+00	LT	M1-6 (30) ***	ROUTE 30
288+00	LT	M6-1 (L)	LEFT ARROW
288+10	LT	R1-1 *	STOP
289+00	RT	M4-12	END
289+00	RT	D11-1 *	BIKE ROUTE
290+20	RT	RM-1 *	REFLECTIVE MARKER
290+20	RT	R2-1 (25) *	SPEED LIMIT 25
290+25	LT	M4-11	BEGIN
290+25	LT	RM-1 *	REFLECTIVE MARKER
290+25	LT	D11-1 *	BIKE ROUTE
290+25	LT	D11-7	ARROW
292+00	LT	DIR-2 *	DIRECTION SIGN
292+20	RT	W1-5 (R) *	WINDING ROAD
294+00	RT	RM-1 *	REFLECTIVE MARKER
294+00	LT	W2-2 *	INTERSECTION
294+00	LT	RM-1 *	REFLECTIVE MARKER
295+00	LT	RM-1 *	REFLECTIVE MARKER
295+00	LT	R2-1 (30) *	SPEED LIMIT 30
295+65	RT	W5-1 *	PAVEMENT NARROWS

TO BE REMOVED

STATION	TYPE	DESCRIPTION
208+15	RT	R2-5B (35) *
208+15	RT	RM-1 *
212+95	RT	CW20-2 *
216+40	RT	RM-1 *
218+00	RT	RM-1 *
218+00	RT	W4-2 (R) *
222+00	RT	CW20-2 *
224+00	LT	RM-3 *
224+85	LT	RM-3 *
224+90	RT	RM-1 *
224+90	RT	R2-5D (15) *
225+50	LT	RM-3 *
226+35	LT	RM-3 *
227+00	RT	CW20-2 *
230+00	RT	R2-1 (15) *
231+40	RT	CW1-1 (L) -A *
231+40	RT	CW13-1 (10) -A *
235+95	LT	R3-2 *
236+95	LT	TYPE 3
236+95	LT	CM4-10 (R)
236+95	LT	R11-2
237+20	RT	R3-1 *
237+50	CL	W1-8 (L)
237+50	CL	CM4-10 (L)
237+50	CL	R11-2
237+50	CL	TYPE 3
238+15	CL	CM4-10 (L)
238+15	CL	R11-2
238+15	CL	TYPE 4
VILLAGE ROAD	M6-3	STRAIGHT ARROW
VILLAGE ROAD	M4-3	TO

* WITH POST
 ** ON TYPE "A" ASSEMBLY
 *** ON TYPE "B" ASSEMBLY

SIGNING BY TYPE

TO BE INSTALLED

STATION	TYPE	DESCRIPTION	RELOCATED FROM STA
283+00	RT	D10-2	MILE 31
251+00	RT	D11-1 *	BIKE ROUTE
276+50	LT	D11-1 *	BIKE ROUTE
286+00	LT	D11-1 *	BIKE ROUTE
262+50	RT	D11-1 *	BIKE ROUTE
240+15	RT	D11-1 *	BIKE ROUTE
289+00	RT	D11-1 *	BIKE ROUTE
290+25	LT	D11-1 *	BIKE ROUTE
262+45	LT	D11-1 *	BIKE ROUTE
262+50	RT	D11-7	ARROW
286+00	LT	D11-7	ARROW
251+00	RT	D11-7	ARROW
276+50	LT	D11-7	ARROW
290+25	LT	D11-7	ARROW
262+45	LT	D11-7	ARROW
240+15	RT	D11-7	ARROW
285+00	RT	DIR-1 *	DIRECTION SIGN
292+00	LT	DIR-2 *	DIRECTION SIGN
283+00	RT	M1-6 (30) **	ROUTE 30
270+00	LT	M1-6 (30) **	ROUTE 30
255+00	RT	M1-6 (30) **	ROUTE 30
283+00	LT	M1-6 (30) **	ROUTE 30
288+00	LT	M1-6 (30) ***	ROUTE 30
288+00	LT	M1-6 (30) ***	ROUTE 30
288+00	LT	M3-2	EAST
283+00	LT	M3-2	EAST
270+00	LT	M3-2	EAST
255+00	RT	M3-4	WEST
288+00	LT	M3-4	WEST
283+00	RT	M3-4	WEST
290+25	LT	M4-11	BEGIN
289+00	RT	M4-12	END
288+00	LT	M6-1 (L)	LEFT ARROW
288+00	LT	M6-1 (R)	RIGHT ARROW
288+10	LT	R1-1 *	STOP
277+65	RT	R1-1 *	STOP
277+35	LT	R1-1 *	STOP
277+10	RT	R1-2 *	YIELD
287+70	LT	R1-2 *	YIELD
278+00	LT	R1-2 *	YIELD
278+00	RT	R1-2 *	YIELD
236+40	LT	R1-2 *	YIELD
236+50	RT	R1-2 *	YIELD
237+65	RT	R1-2 *	YIELD
290+20	RT	R2-1 (25) *	SPEED LIMIT 25 MPH
295+00	LT	R2-1 (30) *	SPEED LIMIT 30 MPH
281+00	RT	R2-1 (35) *	SPEED LIMIT 35 MPH
285+00	LT	R2-1 (45) *	SPEED LIMIT 45 MPH
245+55	LT	R2-1 (45) *	SPEED LIMIT 45 MPH
251+95	RT	R2-1 (45) *	SPEED LIMIT 45 MPH
274+00	LT	R2-1 (45) *	SPEED LIMIT 45 MPH
241+00	RT	R2-1 (45) *	SPEED LIMIT 45 MPH
208+15	RT	R2-1 (45) *	SPEED LIMIT 45 MPH
212+95	RT	R2-1 (45) *	SPEED LIMIT 45 MPH
224+90	RT	R2-1 (45) *	SPEED LIMIT 45 MPH
224+90	RT	R2-5D (15) *	REDUCED SPEED AHEAD 15 MPH
225+50	LT	RM-3 *	REFLECTIVE MARKER
226+35	LT	RM-3 *	REFLECTIVE MARKER
227+00	RT	CW20-2 *	DETOUR 1000 FT
230+00	RT	R2-1 (15) *	SPEED LIMIT 15
231+40	RT	CW1-1 (L) -A *	LEFT TURN ARROW
231+40	RT	CW13-1 (10) -A *	10 MPH
235+95	LT	R3-2 *	NO LEFT TURN
236+95	LT	TYPE 3	2-BARRICADES
236+95	LT	CM4-10 (R)	DETOUR RT ARROW
236+95	LT	R11-2	ROAD CLOSED
237+20	RT	R3-1 *	NO RIGHT TURN
237+50	CL	W1-8 (L)	4-LEFT ARROWS
237+50	CL	CM4-10 (L)	2-DETOUR LT ARROW
237+50	CL	R11-2	2-ROAD CLOSED
237+50	CL	TYPE 3	6-BARRICADES
238+15	CL	CM4-10 (L)	3-DETOUR LT ARROW
238+15	CL	R11-2	3-ROAD CLOSED
238+15	CL	TYPE 4	BARRICADE
VILLAGE ROAD	M6-3	STRAIGHT ARROW	
VILLAGE ROAD	M4-3	TO	

STATION	TYPE	DESCRIPTION	RELOCATED FROM STA
286+00	LT	RM-1 *	REFLECTIVE MARKER
270+00	LT	RM-1 *	REFLECTIVE MARKER
243+00	LT	RM-1 *	REFLECTIVE MARKER
294+00	LT	RM-1 *	REFLECTIVE MARKER
283+00	RT	RM-1 *	REFLECTIVE MARKER
255+00	RT	RM-1 *	REFLECTIVE MARKER
256+00	LT	RM-1 *	REFLECTIVE MARKER
248+00	RT	RM-1 *	REFLECTIVE MARKER
252+00	LT	RM-1 *	REFLECTIVE MARKER
280+00	RT	RM-1 *	REFLECTIVE MARKER
244+00	LT	RM-1 *	REFLECTIVE MARKER
260+00	RT	RM-1 *	REFLECTIVE MARKER
274+00	RT	RM-1 *	REFLECTIVE MARKER
260+00	LT	RM-1 *	REFLECTIVE MARKER
284+00	RT	RM-1 *	REFLECTIVE MARKER
256+00	RT	RM-1 *	REFLECTIVE MARKER
248+00	LT	RM-1 *	REFLECTIVE MARKER
294+00	RT	RM-1 *	REFLECTIVE MARKER
244+00	RT	RM-1 *	REFLECTIVE MARKER
240+00	LT	RM-1 *	REFLECTIVE MARKER
292+20	RT	W1-5 (R) *	WINDING ROAD
271+95	RT	W2-1 *	INTERSECTION
243+00	LT	W2-1 *	INTERSECTION
284+00	LT	W2-1 *	INTERSECTION
294+00	LT	W2-2 *	INTERSECTION
284+35	RT	W2-2 *	INTERSECTION
295+65	RT	W5-1 *	PAVEMENT NARROWS

TO BE REMOVED

STATION	TYPE	DESCRIPTION
208+15	RT	RM-1 *
208+15	RT	R2-5B (35) *
212+95	RT	CW20-2 *
216+40	RT	RM-1 *
218+00	RT	RM-1 *
218+00	RT	W4-2 (R) *
222+00	RT	CW20-2 *
224+00	LT	RM-3 *
224+85	LT	RM-3 *
224+90	RT	R2-5D (15) *
224+90	RT	RM-1 *
225+50	LT	RM-3 *
226+35	LT	RM-3 *
227+00	RT	CW20-2 *
230+00	RT	R2-1 (15) *
231+40	RT	CW1-1 (L) -A *
231+40	RT	CW13-1 (10) -A *
235+95	LT	R3-2 *
236+95	LT	R11-2
236+95	LT	CM4-10 (R)
236+95	LT	TYPE 3
237+20	RT	R3-1 *
237+50	CL	CM4-10 (L)
237+50	CL	R11-2
237+50	CL	W1-8 (L)
237+50	CL	TYPE 3
238+15	CL	R11-2
238+15	CL	CM4-10 (L)
238+15	CL	TYPE 4
VILLAGE ROAD	M6-3	STRAIGHT ARROW
VILLAGE ROAD	M4-3	TO

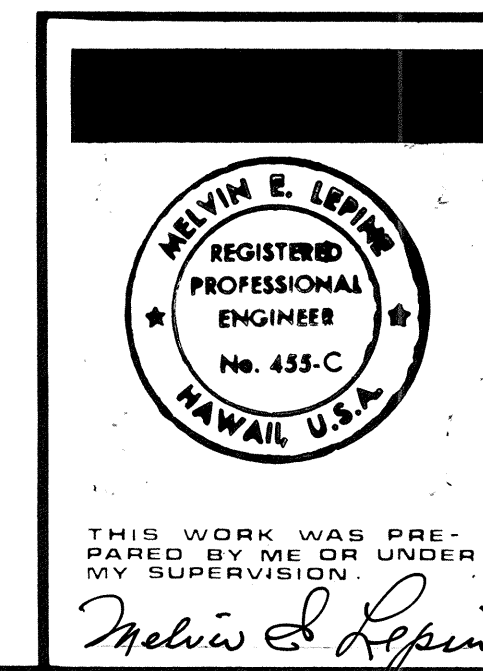

STATE OF HAWAII
 DEPARTMENT OF TRANSPORTATION
 HIGHWAYS DIVISION

SIGNING REQUIREMENTS

HONOAPIILANI HIGHWAY
 PINEAPPLE HILL TO HONOKAHUA
 F.A. PROJECT NO. F-030-1(18)

DATE 8/84

SHEET No. 10 OF 10 SHEETS