

INDEX TO DRAWINGS	
SHEET NO.	DESCRIPTION
1	TITLE SHEET
2	STANDARD PLANS SUMMARY
3	GENERAL NOTES & LEGEND
4 - 6	WATER POLLUTION & EROSION CONTROL NOTES
7 - 11	TYPICAL SECTIONS & DETAILS
12 - 24	ROADWAY PLANS
25	PAVEMENT MARKING LEGEND, DETAILS & NOTES
26 - 27	RUMBLE STRIP DETAILS & NOTES
28	WORK ZONE SIGNING PLAN, NOTES & DETAILS
29 - 41	SIGNING & PAVEMENT MARKING PLANS

STATE OF HAWAII

DEPARTMENT OF TRANSPORTATION

HIGHWAYS DIVISION

HONOLULU, HAWAII

PLANS FOR

HANA HIGHWAY RESURFACING

HALEAKALA HIGHWAY TO PAIA

AND

HALEAKALA HIGHWAY RESURFACING

HANA HIGHWAY TO NORTH FIREBREAK ROAD

PROJECT NO. HWY-M-01-15M

DISTRICT OF MAKAWAO AND WAILUKU

ISLAND OF MAUI

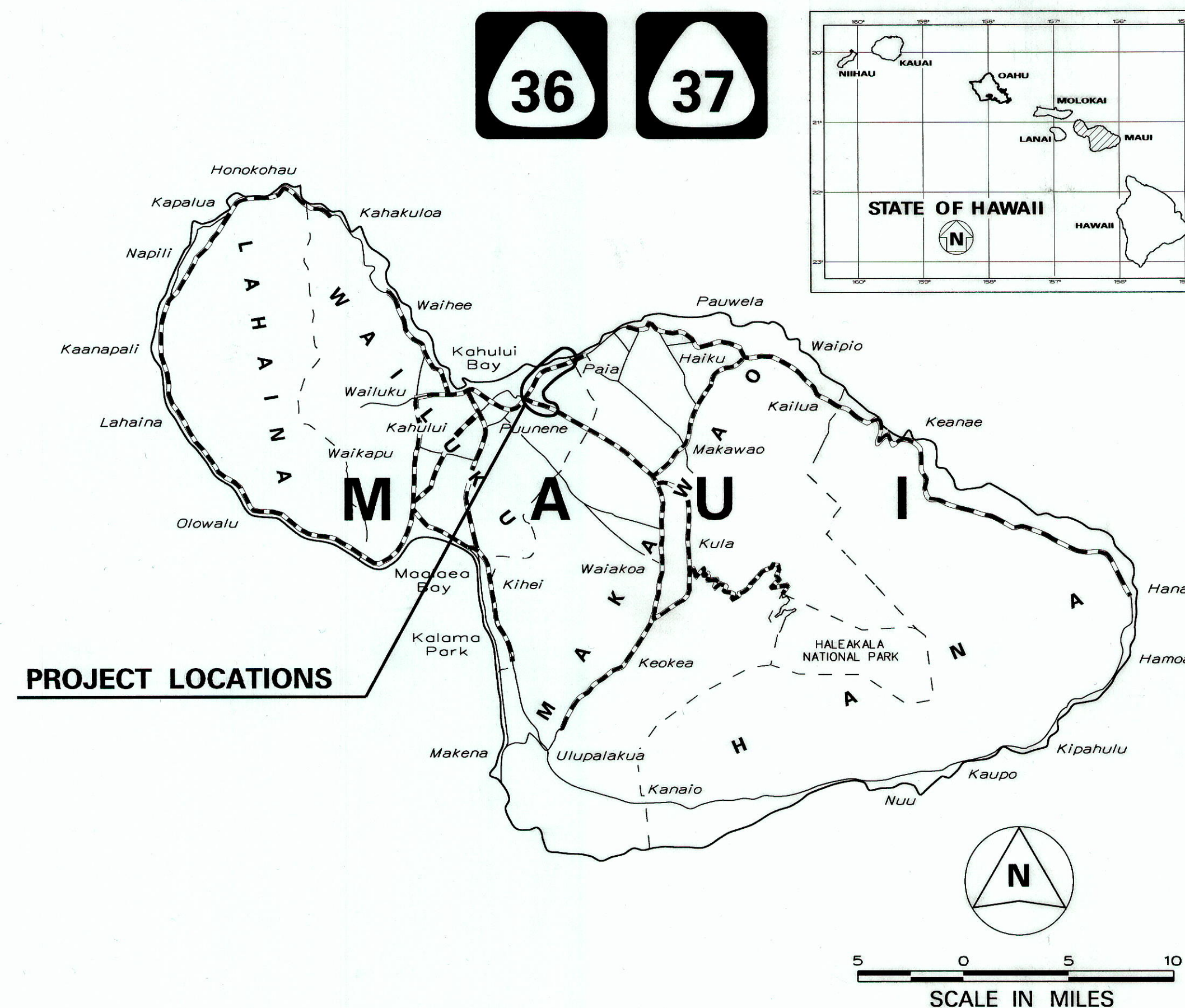

ROUTE 36 HANA HIGHWAY

MILE POST 2.81 TO MILE POST 6.61

ROUTE 37 HALEAKALA HIGHWAY

MILE POST 0.00 TO MILE POST 0.94

DESIGNED BY

HWY-M

MANAGED BY

HWY-ME

PHONE

873-3535

DATE

MAY, 2015

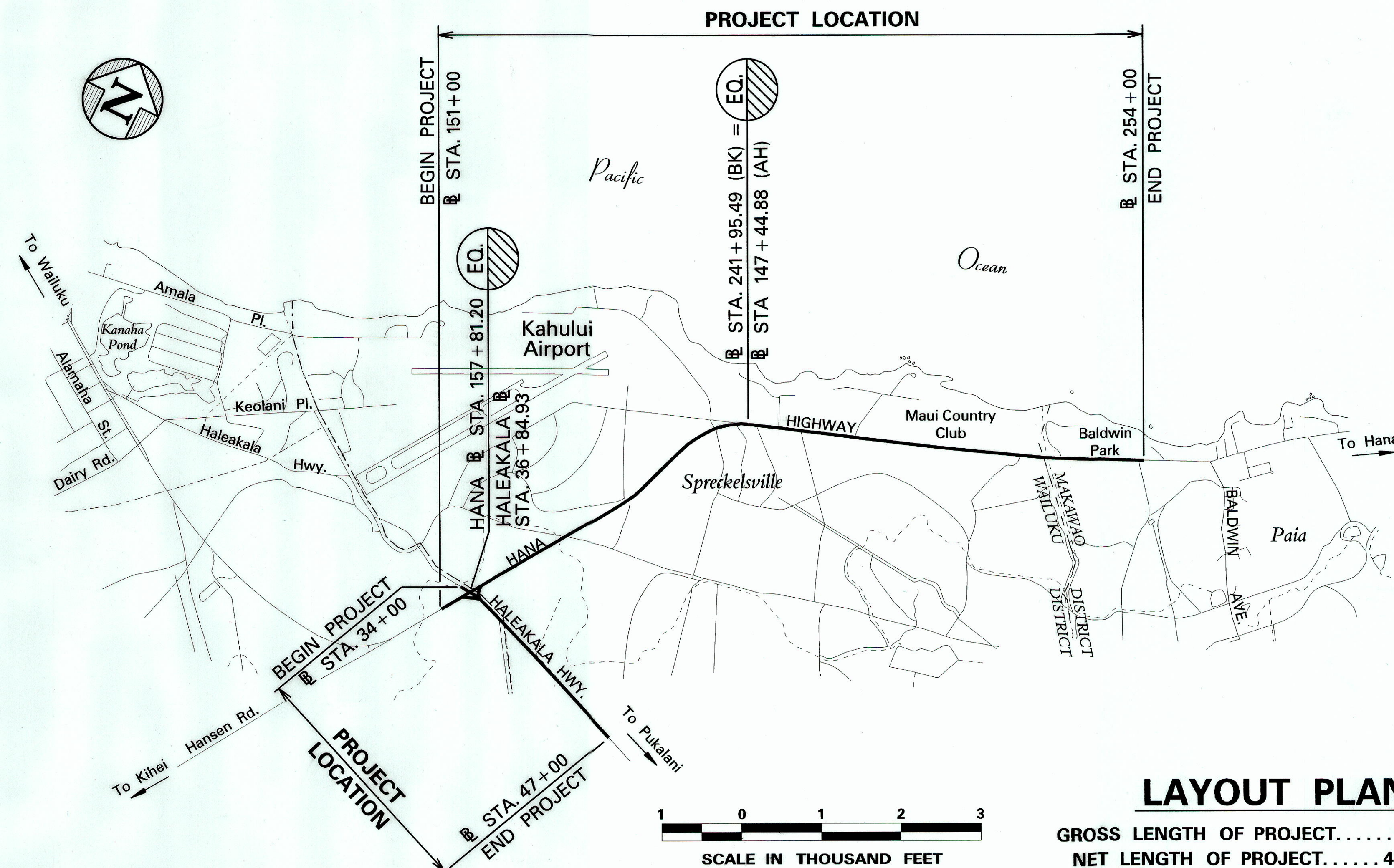

LAYOUT PLAN

GROSS LENGTH OF PROJECT.....4.74 MILES

NET LENGTH OF PROJECT.....4.74 MILES

CHANGES MADE DURING CONSTRUCTION HAVE BEEN INCORPORATED ON THESE PLANS EXCEPT CHANGES IN THE ORIGINAL THEORETICAL QUANTITIES. FOR ACTUAL QUANTITIES, REFER TO PROJECT LEDGER AND/OR COMPUTATION BOOK.

5/11/15

DATE

DEPARTMENT OF TRANSPORTATION

STATE OF HAWAII

APPROVED:

DIR. OF TRANSPORTATION

DATE