

FED. ROAD DIST. NO.	STATE	PROJ. NO.	FISCAL YEAR	SHEET NO.	TOTAL SHEETS
HAWAII	HAW.	HWY-M-07-07M	2007	4	20

LEGEND

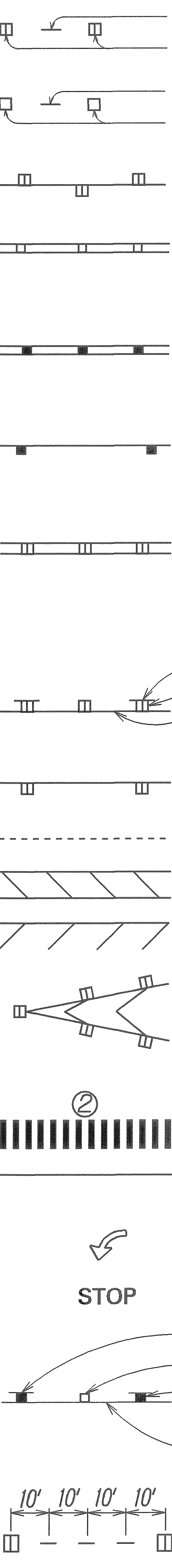

4 each Type A Raised Pavement Markers
Type C Raised Pavement Markers @ 40'-0" o.c.

4 each Type J Raised Pavement Markers
Type D Raised Pavement Markers @ 40'-0" o.c.

8" White Stripe with Type C Raised Pavement Markers @ 20'-0" o.c.

4" Double Solid Yellow with Type D Raised Pavement Markers @ 20'-0" o.c.

4" Double Solid Yellow Stripes with Type H Raised Pavement Markers @ 20'-0" o.c.

4" Yellow Edge Stripe with Type H Raised Pavement Markers @ 40'-0" o.c.

4" Double Solid White Stripes with Type C Raised Pavement Markers @ 20'-0" o.c.

Lane Change Restriction Marking
4 each Type A Raised Pavement Markers
Type C Raised Pavement Markers @ 20'-0" o.c.
4" White Stripe

4" or 8" White Edge Stripe with Type C Raised Pavement Markers @ 40'-0" o.c.

4" White Guide Lines

Transverse Median Marking

Transverse Shoulder Marking

Channelizing Island or Deceleration Lane Gore

Crosswalk and Stop Line. All Stop Lines shall be 10'-0" from Crosswalk unless otherwise noted. The circled number indicates the number of lanes for payment (Paint)

Pavement Arrow (Paint)

STOP

Pavement Word

4 Each Type J Raised Pavement Markers
Type D Raised Pavement Markers @ 40'-0" o.c.
Type H Raised Pavement Markers (Reflective Surface facing no-passing direction)
4" Single Solid Yellow Stripe

Extension of Edge Line, 4" Wide x 2'-0" Long White Stripe @ 10'-0" o.c. w/Type C Markers @ 40'-0" o.c. (Paint)

NOTE: For Striping Materials, See Raised Pavement And Striping Summary (See Sheet No. 12)

GENERAL NOTES

- This project is located at various locations (Hana Highway, Haleakala Highway and Honoapiilani Highway). The scope of work for this project consists of installing pavement striping, raised pavement markers, pavement arrows, yield crosswalk marking and symbol pavement marking.
- The Contractor is reminded of the requirements of Subsection 108.01 - Subletting of Contract, which requires him perform work amounting to not less than 50 percent of the total contract cost less deductible items. Non-compliance with this Subsection may be grounds for rejection of bid.
- The Contractor's attention is directed to the following Sections of the Special Provisions: Subsection 107.13 - Public Convenience and Safety; Subsection 107.21 - Contractor's Responsibility For Utility Property And Services; and Section 645 - Traffic Control.
- At the end of each day's work, the Contractor shall remove all equipment and other obstructions to permit free and safe passage of public traffic.
- The Contractor shall notify the Engineer in writing two (2) weeks before commencement of work.
- The Contractor shall remove and dispose of all existing raised pavement markers prior to the pavement striping. This work shall be considered incidental to the various pavement marking items and will not be paid for separately.
- Layout of pavement markings and striping shall be done by the Contractor and approved by the Engineer prior to any installation work.
- Existing pavement markings not incorporated in the final traffic pattern shall be removed as directed by the Engineer. Costs shall be incidental to the various pavement marking items.
- Raised pavement markers shall not be installed within crosswalks.
- Final locations of all Stop Lines shall be approved by the Engineer prior to installation.
- All pavement striping shall be as noted on the legend or plans.
- All preformed pavement marking tapes over existing pavement shall be applied with an approved primer as recommended by the tape manufacturer and as approved by the Engineer. The primer shall be allowed to dry to the tacky stage prior to tape application.
- Existing crosswalk markings shall be eradicated as required to conform to the new layout as shown on this sheet. This work will not be paid for separately but shall be considered incidental to Item No. 629.1020.
- The Contractor shall erect and maintain at the beginning and end of the project advance construction warning signs placed as indicated on the plans or as directed by the Engineer for the duration of the highway project. These Signs shall be placed in addition to the required traffic control signs called for in Section 645 - Traffic Control. The advance construction warning signs shall be new and become the property of the State. The Contractor shall remove, clean, and deliver the signs and posts to the Maui District Baseyard or as directed by the Engineer upon the completion of the project.

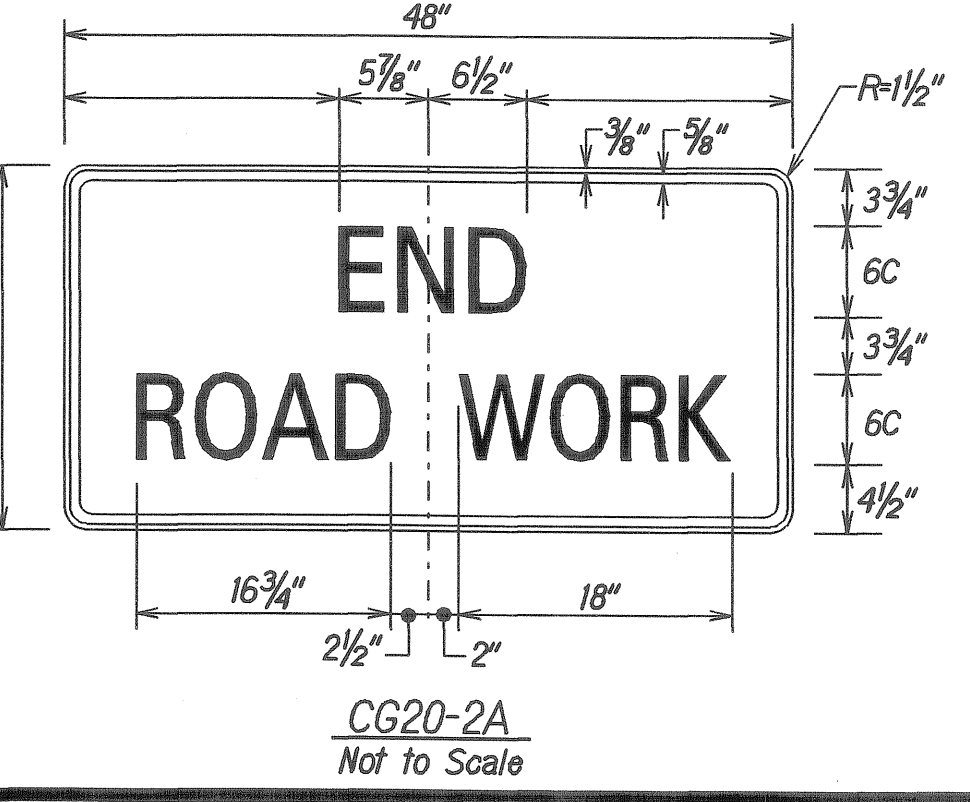
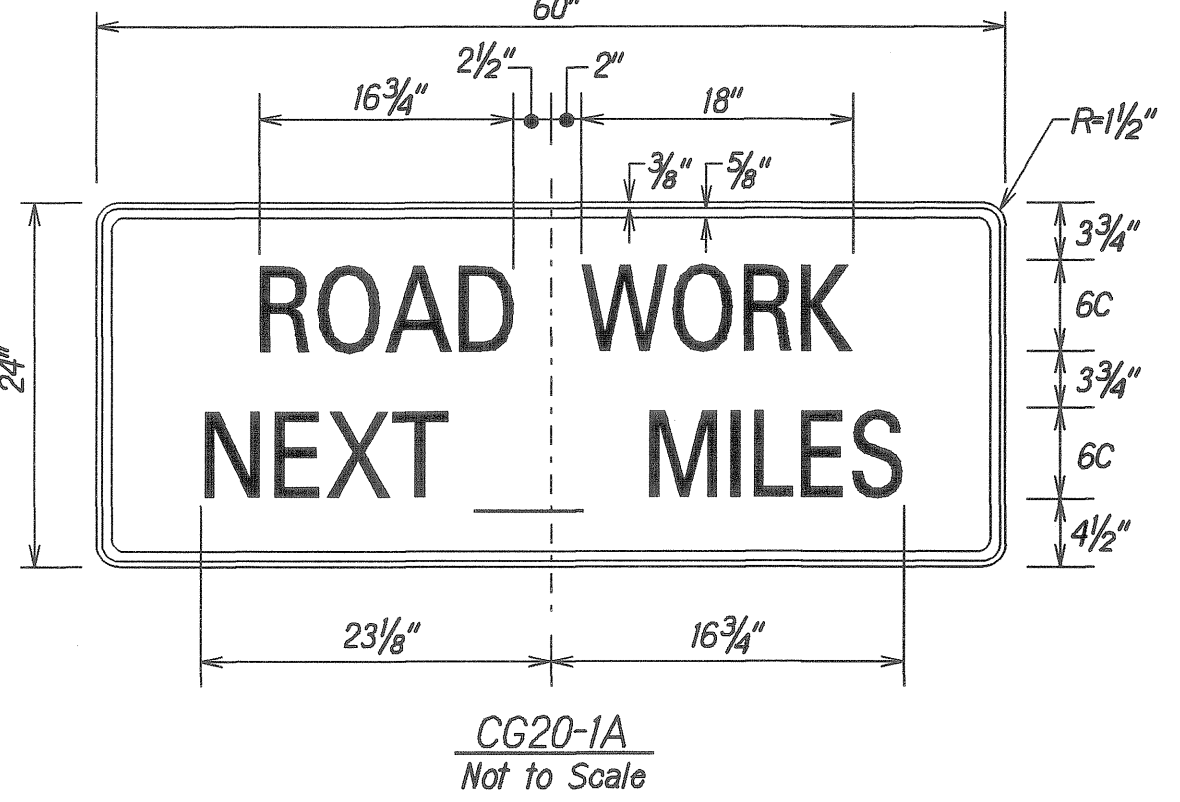
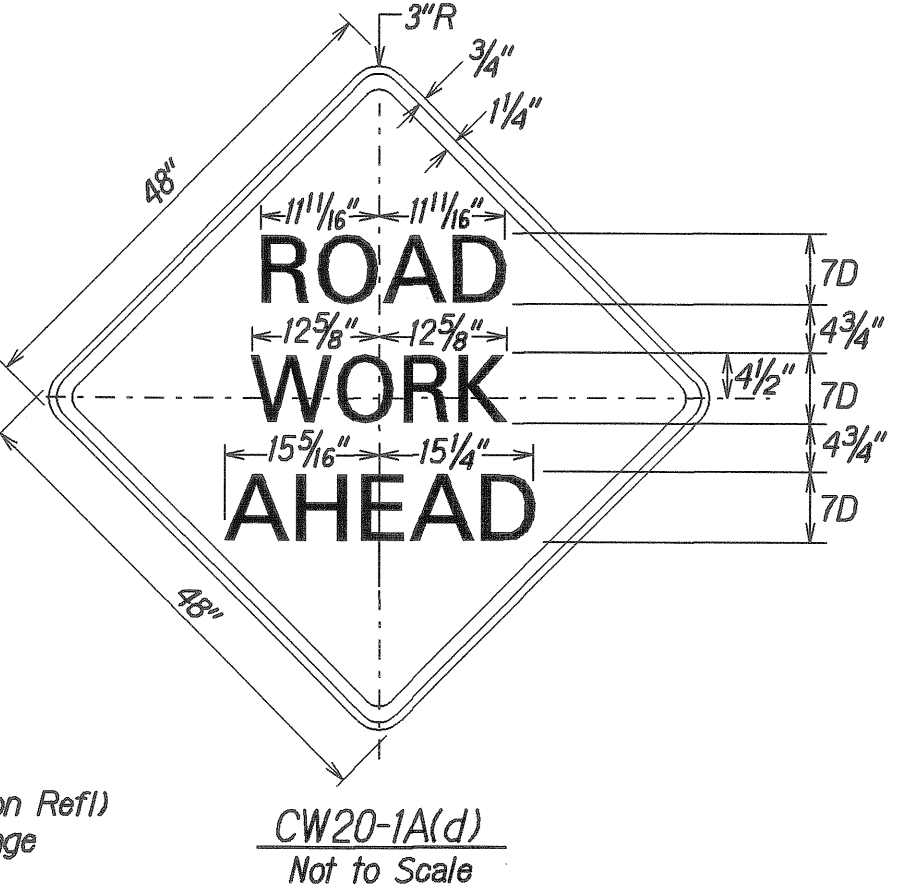

CROSSWALK STRIPING DETAIL

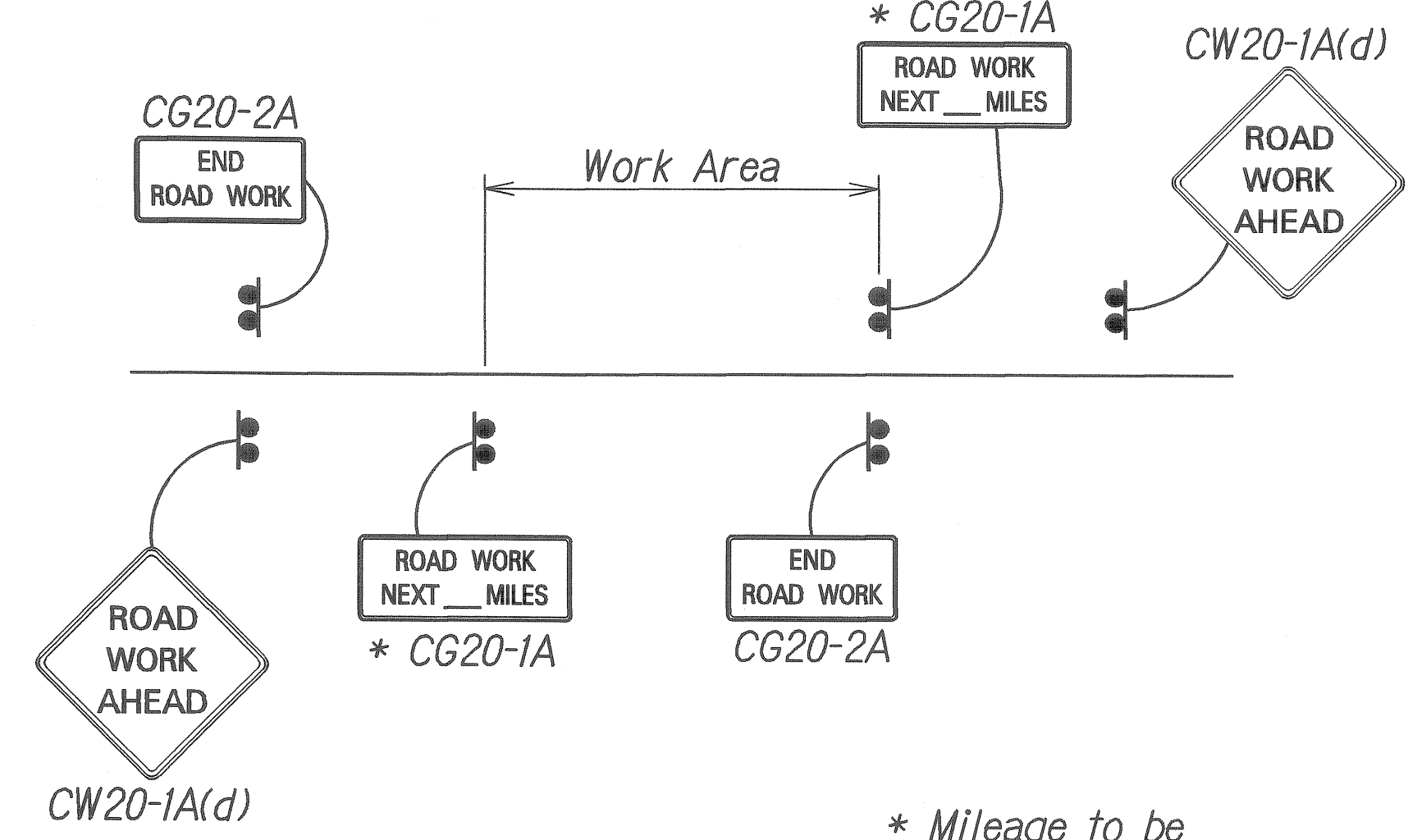
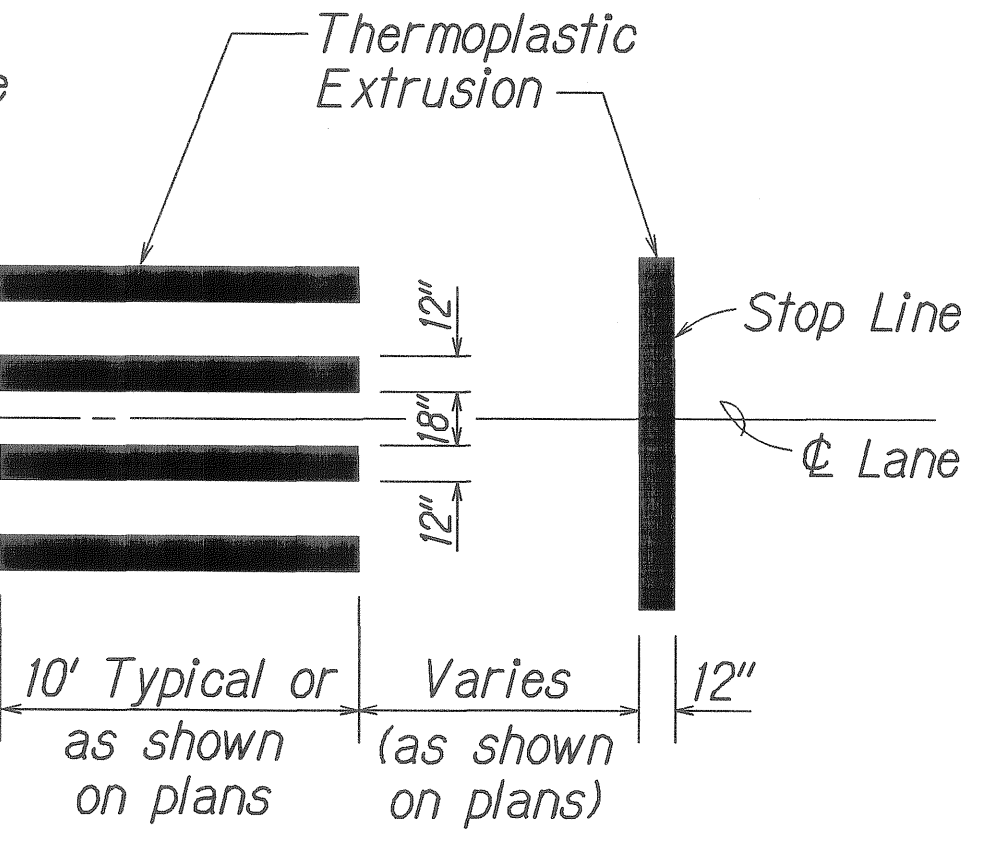

PERMANENT CONSTRUCTION SIGN LAYOUT DETAIL

Not to Scale

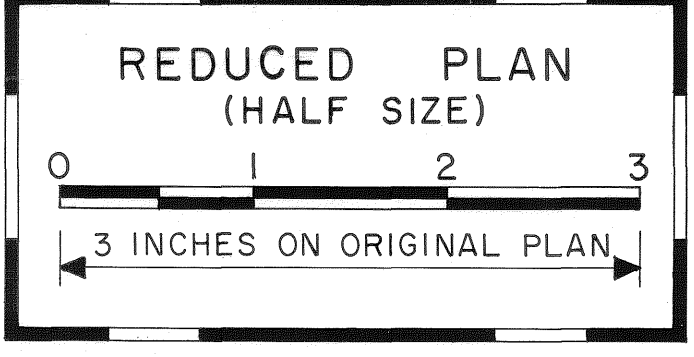

STATE OF HAWAII
DEPARTMENT OF TRANSPORTATION
HIGHWAYS DIVISION

**PAVEMENT MARKING LEGEND,
DETAILS & GENERAL NOTES**

PAVEMENT MARKING AND STRIPING

At Various Locations, Maui

Project No. HWY-M-07-07M

Scale: As Shown Date: April, 2007

SHEET No. 1 OF 1 SHEETS

SURVEY PLOTTED BY	DATE
DESIGNED BY	4/07
TRACED BY	
NOTES	
QUANTITIES BY	
CHECKED BY	