

FED. ROAD DIST. NO.	STATE	PROJ. NO.	FISCAL YEAR	SHEET NO.	TOTAL SHEETS
HAWAII	HAW.	HWY-M-04-00	2002	6	63

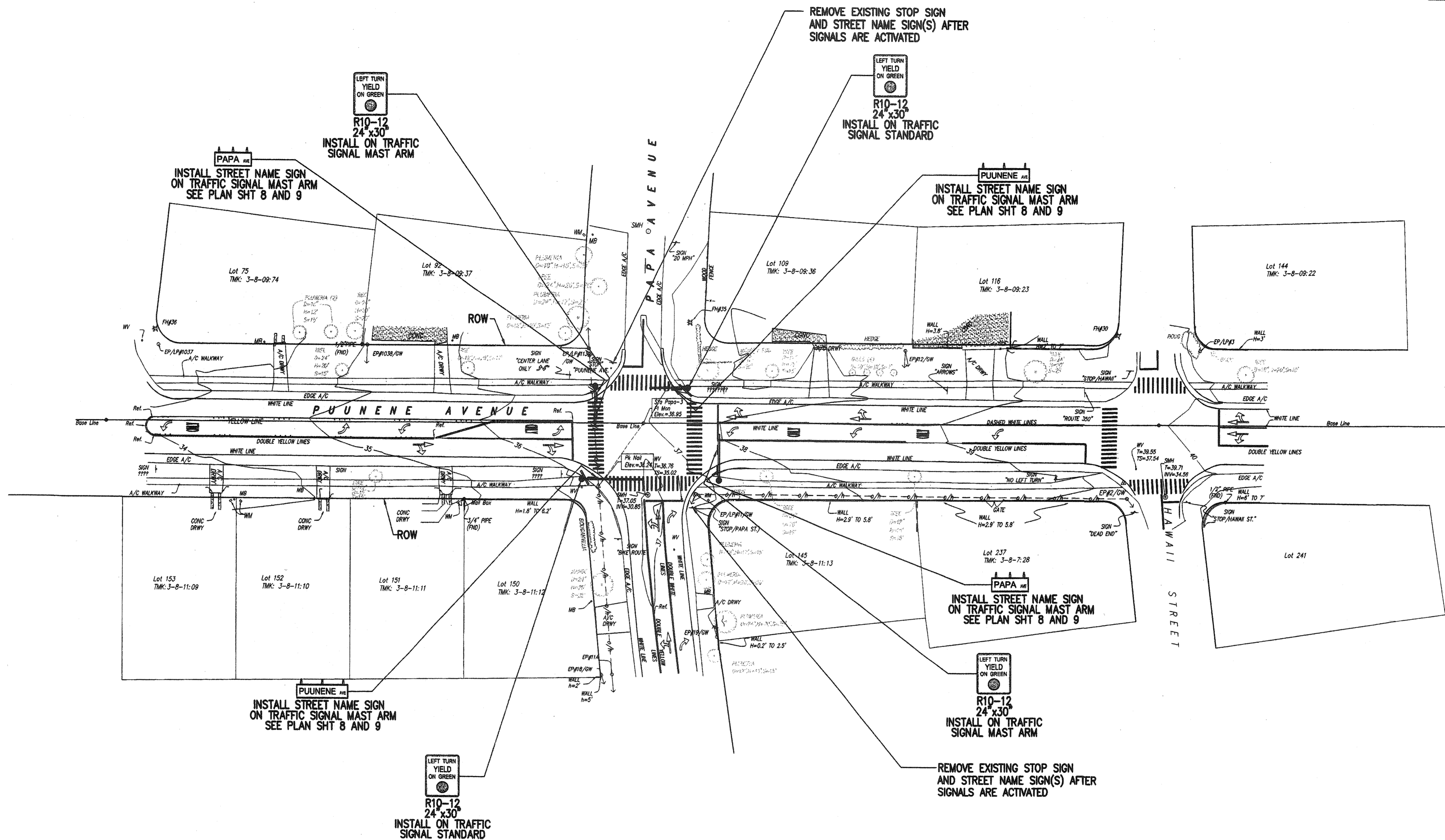
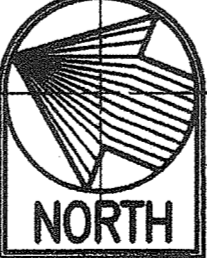

DATE	_____
SURVEY PLOTTED BY	_____
DRAWN BY	_____
TRACED BY	_____
DESIGNED BY	_____
QUANTITIES BY	_____
CHECKED BY	_____
ORIGINAL PLAN	_____
NOTE BOOK	_____
No.	_____

**SIGNING PLAN**  
 SCALE: 1"=40'

**NOTE:**  
 THE CONTRACTOR SHALL REPLACE OR REPAIR TRAFFIC SIGNS, POSTS, PAVEMENT MARKINGS AND PAVEMENT STRIPING DISTURBED BY HIS ACTIVITIES AT HIS OWN EXPENSE.

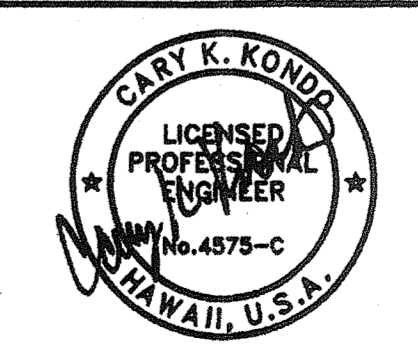
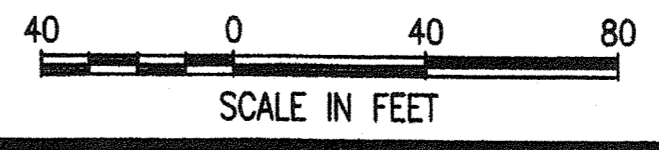

THIS WORK WAS PREPARED BY ME OR UNDER MY SUPERVISION

STATE OF HAWAII  
 DEPARTMENT OF TRANSPORTATION  
 HIGHWAYS DIVISION  
**SIGNING PLAN**  
 TRAFFIC OPERATIONAL IMPROVEMENTS  
 AT VARIOUS LOCATIONS  
 PUUNENE AVENUE  
 AND KAAHUMANU AVENUE  
 Project No. HWY-M-04-00  
 Scale: AS NOTED Date: Apr. 2002  
 SHEET No. 1 OF 2 SHEETS

**"AS BUILT"**

File: 24\_May\_2002\_12:02pm  
 I:\AUTOCAD\CAD\98700700\PACKAGE-1\1-006

