

FED. ROAD DIST. NO.	STATE	PROJ. NO.	FISCAL YEAR	SHEET NO.	TOTAL SHEETS
HAWAII	HAW.	HWY-M-05-04	2004	6	33

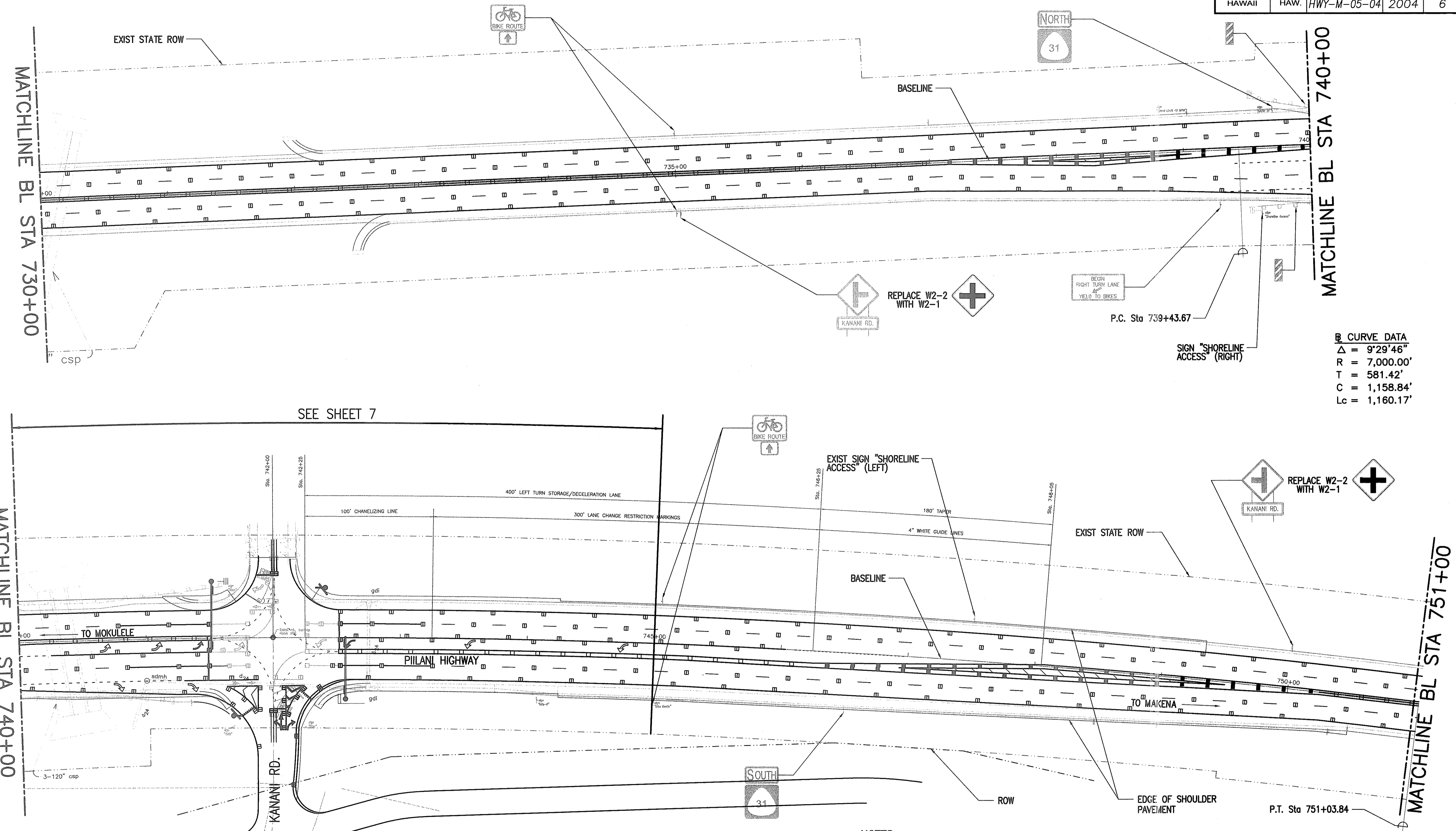

CURVE DATA

Δ	= 9°29'46"
R	= 7,000.00'
T	= 581.42'
C	= 1,158.84'
Lc	= 1,160.17'

NOTES:

1. THE CONTRACTOR SHALL REPLACE OR REPAIR TRAFFIC SIGNS, POSTS, PAVEMENT MARKINGS AND PAVEMENT STRIPING DESTROYED BY HIS ACTIVITIES AT HIS OWN EXPENSE.
2. ALL EXISTING STRIPING OF PAVEMENT MARKERS THAT ARE SUPERSEDED BY NEW STRIPING SHALL BE REMOVED.
3. ALL NEW WORK SHALL TIE INTO THE EXISTING TO PROVIDE A SMOOTH CONNECTION.

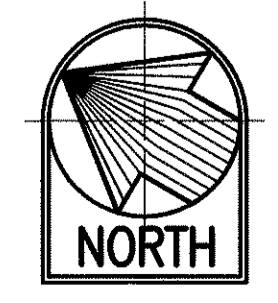

SIGNING & STRIPING PLAN

SCALE: 1"=40'

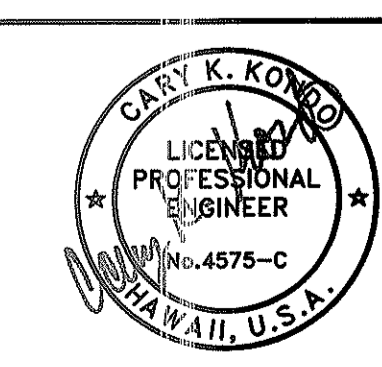

THIS WORK WAS PREPARED BY ME OR UNDER MY SUPERVISION

STATE OF HAWAII
DEPARTMENT OF TRANSPORTATION
HIGHWAYS DIVISION

SIGNING & STRIPING PLAN

TRAFFIC OPERATIONAL IMPROVEMENTS
AT VARIOUS LOCATIONS
PIILANI HIGHWAY AT
KANANI ROAD

Project No. HWY-M-05-04
Scale: AS NOTED Date: May 2004
SHEET No. 1 OF 2 SHEETS

Tue, 20 Apr 2004 9:18am
M:\DOT\1999700\00 Mail Intersections\CAD Sheets\06-signingandstriping.dwg

PLANE: RCW=20270'

SURVEY PLOTTED BY	DATE
DRAWN BY	
DESIGNED BY	
QUANTITIES BY	
CHECKED BY	
No.	

SEE SHEET 7

