

FED. ROAD DIST. NO.	STATE	PROJ. NO.	FISCAL YEAR	SHEET NO.	TOTAL SHEETS
HAWAII	HAW.	470A-01-00M	2000	6	39

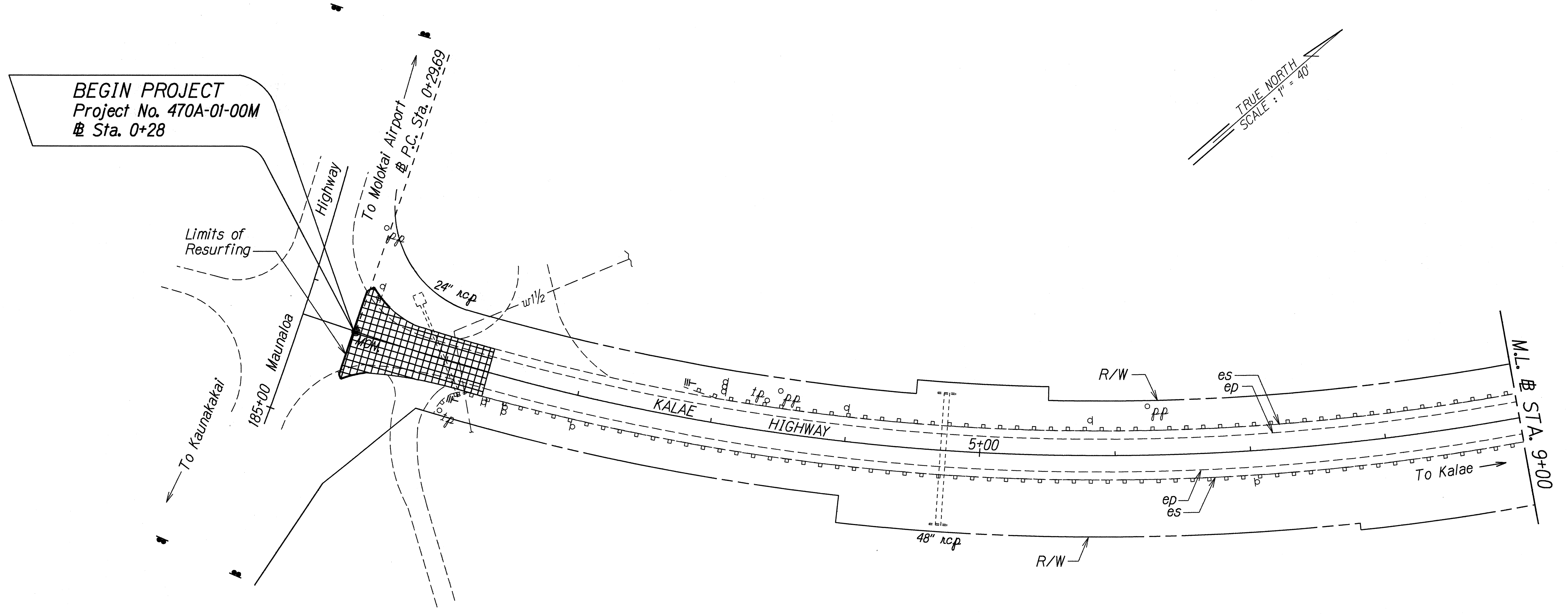

ORIGINAL PLAN	SURVEY PLOTTED BY	DATE
NOTE BOOK	DESIGNED BY	6/21/2000
QUANTITIES BY	CHECKED BY	

STATE OF HAWAII
DEPARTMENT OF TRANSPORTATION
HIGHWAYS DIVISION

ROADWAY PLAN
KALAE HIGHWAY RESURFACING
Maunaloa Highway to
Kalaupapa Lookout Parking Lot
Project No. 470A-01-00M

Scale: 1" = 40' Date: February, 2000

SHEET No. 1 OF 15 SHEETS

FED. ROAD DIST. NO.	STATE	PROJ. NO.	FISCAL YEAR	SHEET NO.	TOTAL SHEETS
HAWAII	HAW.	470A-01-00M	2000	7	39

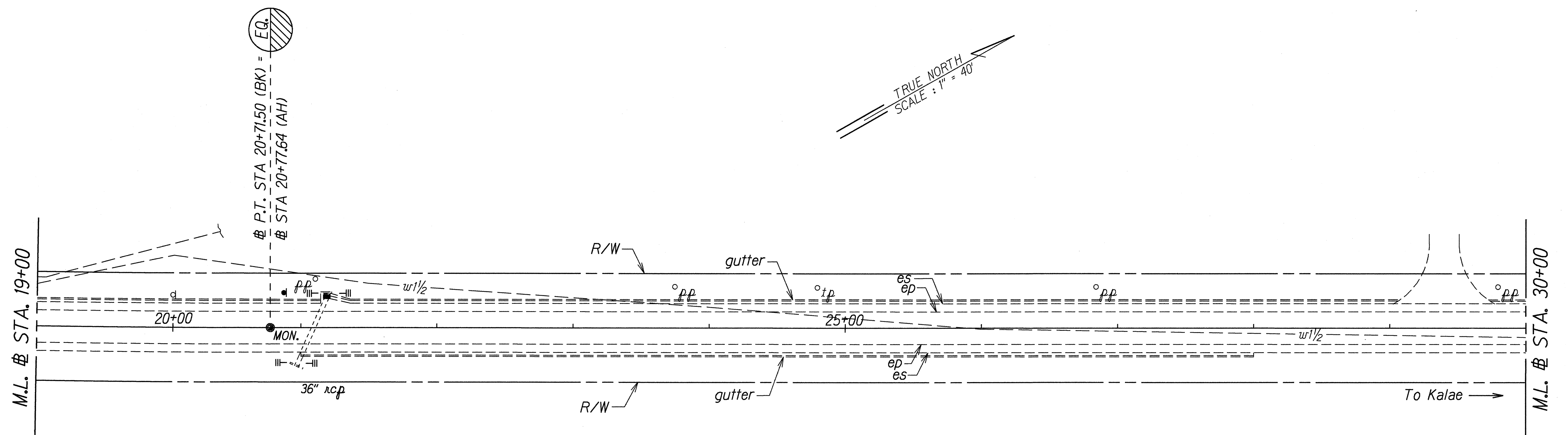
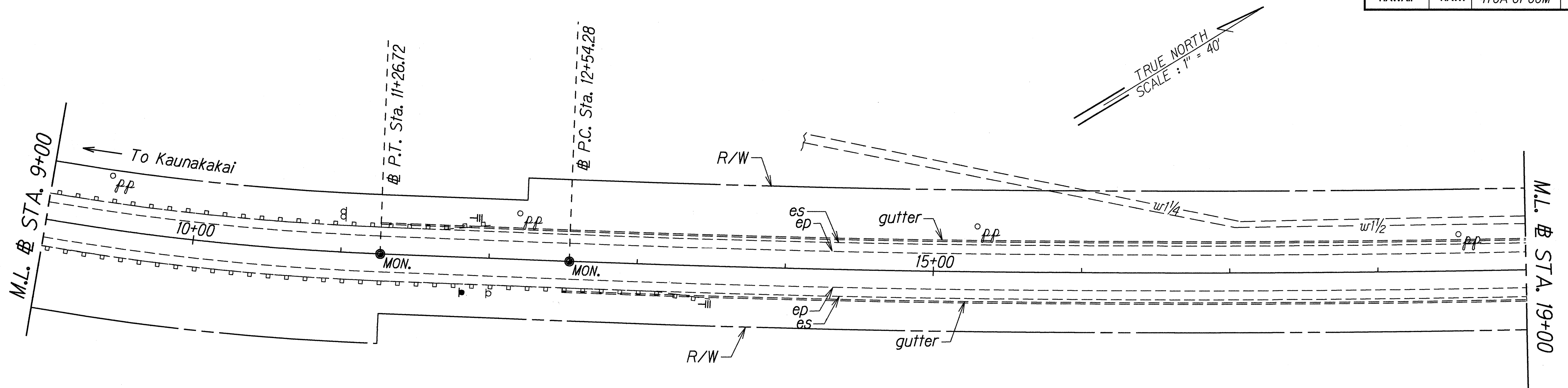

ORIGINAL PLAN	SURVEY PLOTTED BY	DATE
NOTE BOOK	TRACED BY	Feb. 2000
DESIGNED BY	DESIGNED BY	
QUANTITIES BY	QUANTITIES BY	
CHECKED BY	CHECKED BY	

STATE OF HAWAII
DEPARTMENT OF TRANSPORTATION
HIGHWAYS DIVISION

ROADWAY PLAN
KALAE HIGHWAY RESURFACING
Maunaloa Highway to
Kalaupapa Lookout Parking Lot
Project No. 470A-01-00M

Scale: 1" = 40' Date: February, 2000

SHEET No. 2 OF 15 SHEETS

FED. ROAD DIST. NO.	STATE	PROJ. NO.	FISCAL YEAR	SHEET NO.	TOTAL SHEETS
HAWAII	HAW.	470A-01-00M	2000	8	39

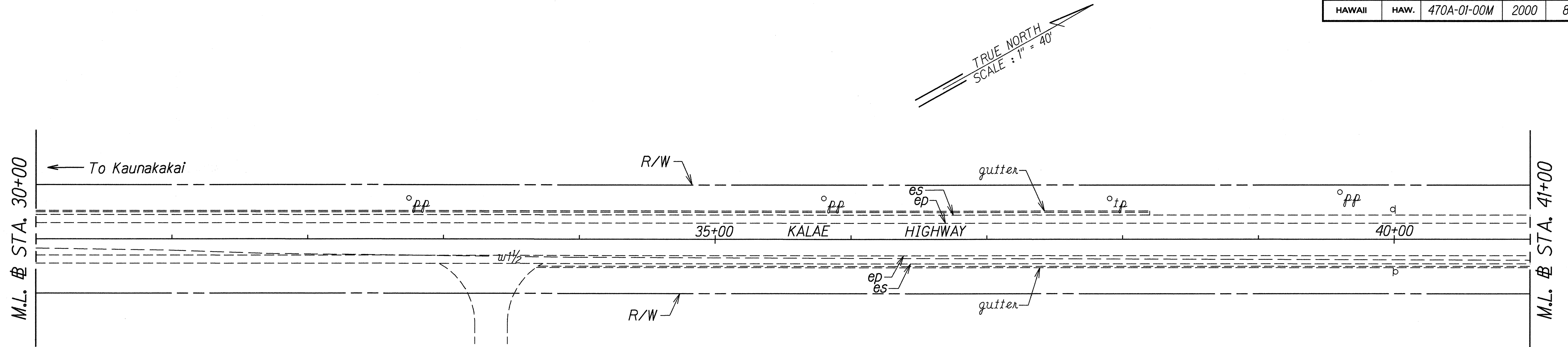

@ STA. 45+30± to @ STA. 46+00±
 Construct 70 L.F. of A.C. swale along the driveway prior to resurface. This work shall be incidental to Item No. 401.0400 (Asphalt Concrete Pavement, Mix No. IV) For detail, See Plan Sht. No. 5.

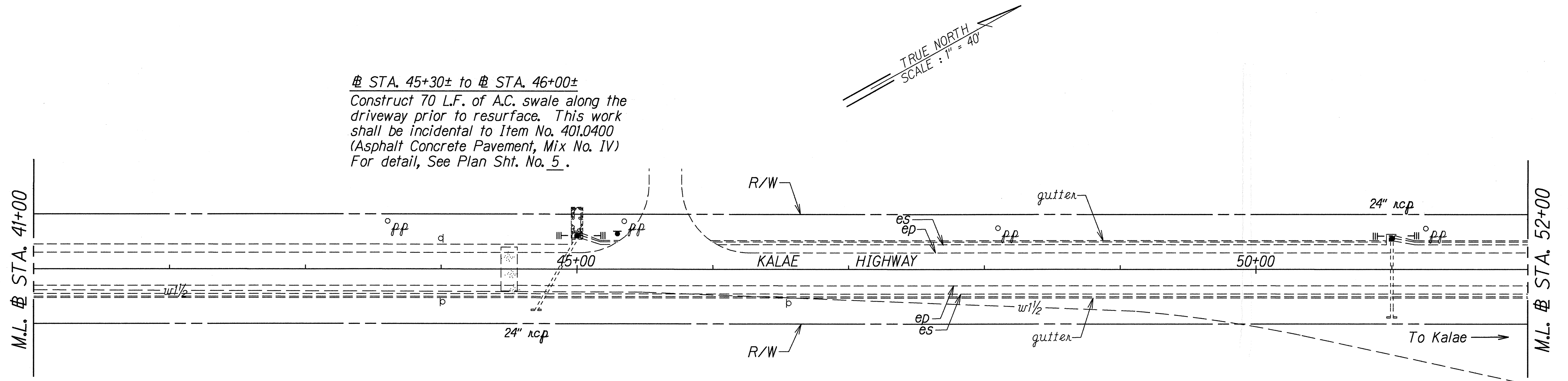

@ STA. 44+50±
 Demolish existing concrete tractor crossing and fill with Asphalt Concrete Base Course compact with 95% compaction. Finish grade to be determined in the field by the Engineer. This work shall be paid incidental to Item No. 312.0100 - Plant Mix Glassphalt Concrete Base Course.

ORIGINAL PLAN	DATE
DESIGNED BY	Feb. 2000
DESIGNED BY	
QUANTITIES BY	
CHECKED BY	

STATE OF HAWAII
 DEPARTMENT OF TRANSPORTATION
 HIGHWAYS DIVISION
ROADWAY PLAN
KALAE HIGHWAY RESURFACING
 Maunaloa Highway to
 Kalaupapa Lookout Parking Lot
 Project No. 470A-01-00M
 Scale: 1" = 40' Date: February, 2000
 SHEET No. 3 OF 15 SHEETS

FED. ROAD DIST. NO.	STATE	PROJ. NO.	FISCAL YEAR	SHEET NO.	TOTAL SHEETS
HAWAII	HAW.	470A-01-00M	2000	9	39

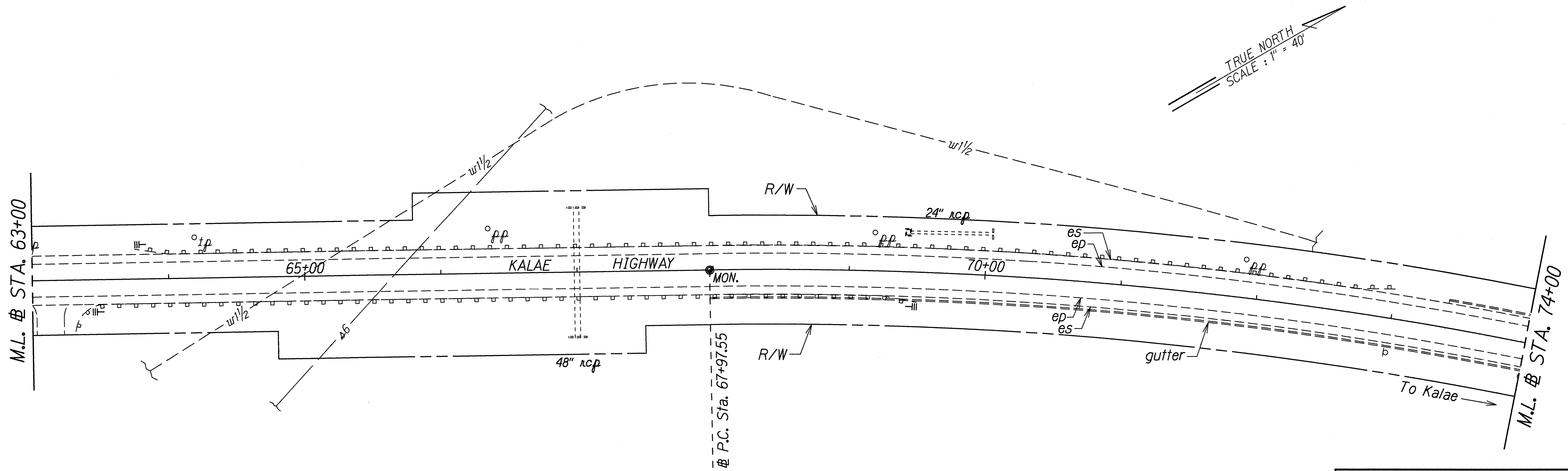
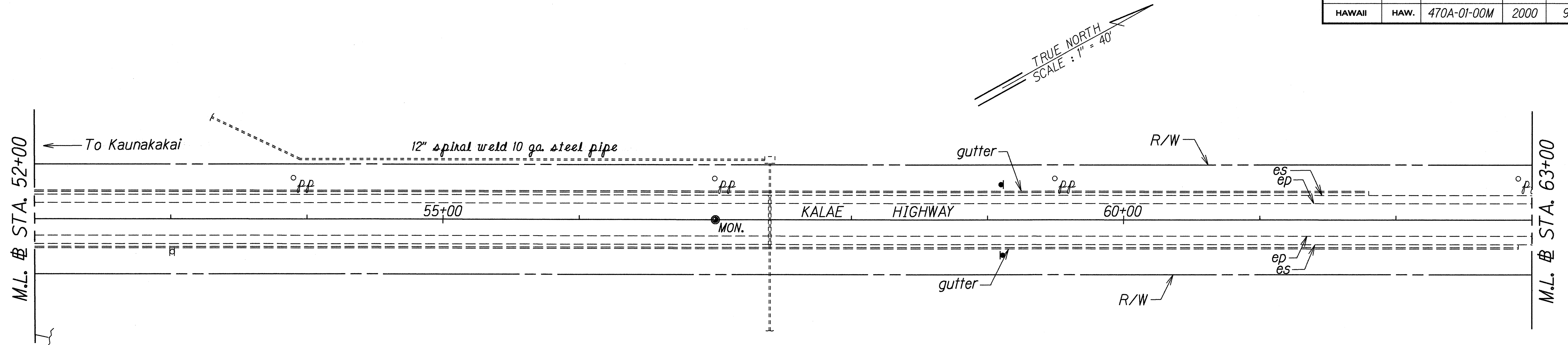

ORIGINAL PLAN	DATE	SCALE
REVISION		
DESIGNED BY		
QUANTITIES BY		
CHECKED BY		

STATE OF HAWAII
DEPARTMENT OF TRANSPORTATION
HIGHWAYS DIVISION

ROADWAY PLAN
KALAE HIGHWAY RESURFACING
Maunaloa Highway to
Kalaupapa Lookout Parking Lot
Project No. 470A-01-00M

Scale: 1" = 40' Date: February, 2000

SHEET No. 4 OF 15 SHEETS

FED. ROAD DIST. NO.	STATE	PROJ. NO.	FISCAL YEAR	SHEET NO.	TOTAL SHEETS
HAWAII	HAW.	470A-01-00M	2000	10	39

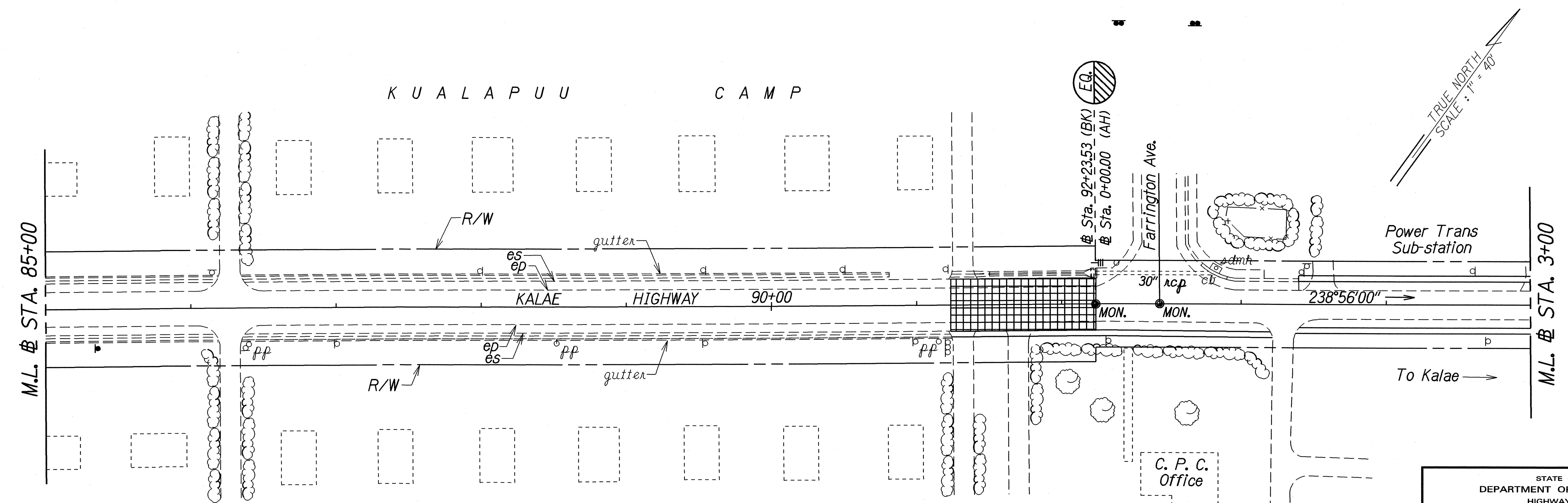
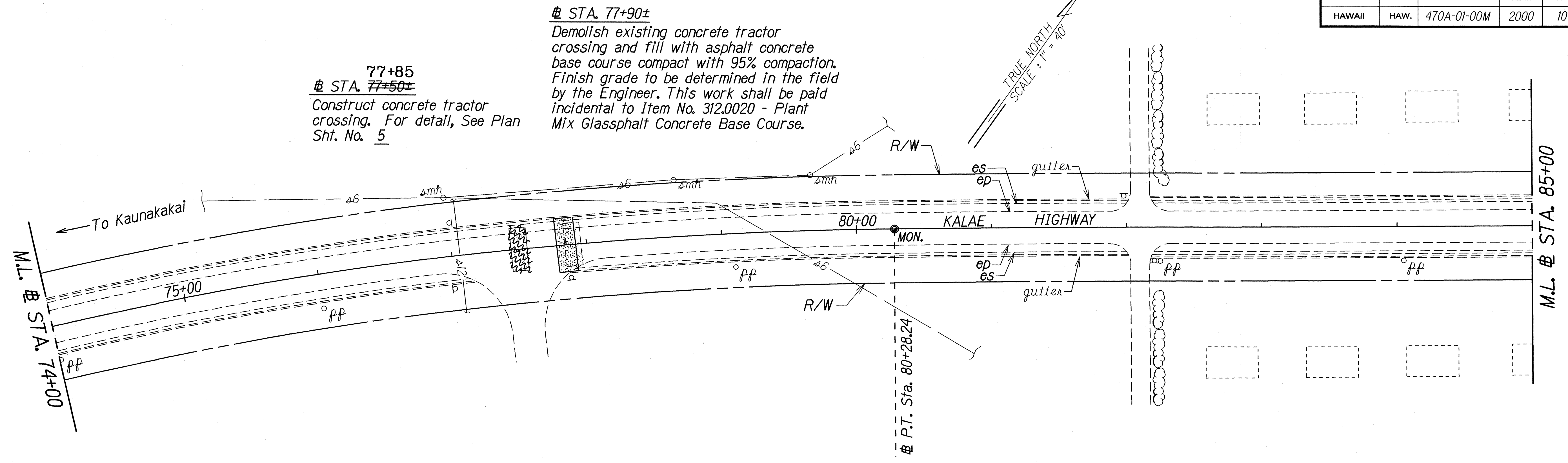

DESIGNED BY	DATE
DRAWN BY	Feb. 2000
CHECKED BY	
QUANTITIES BY	
NOTED BY	
ORIGINAL PLAN	

LEGEND FOR AS-BUILT POSTINGS	
	Squiggly line for as-built deletion
	Double line for as-built deletion
Roadway	Text for as-built posting

STATE OF HAWAII
DEPARTMENT OF TRANSPORTATION
HIGHWAYS DIVISION

ROADWAY PLAN
KALAE HIGHWAY RESURFACING
Maunaloa Highway to
Kalaupapa Lookout Parking Lot
Project No. 470A-01-00M

Scale: 1" = 40' Date: February, 2000

SHEET No. 5 OF 15 SHEETS

"AS BUILT"

FED. ROAD DIST. NO.	STATE	PROJ. NO.	FISCAL YEAR	SHEET NO.	TOTAL SHEETS
HAWAII	HAW.	470A-01-00M	2000	11	39

STA. 1+30± to # STA. 5+30±, LT.
Construct 400 L.F. of 6' wide shoulder
For detail, See Plan Sht. No. 5

NOTE: Concrete gutter Type 2 (61614) to be installed
in conjunction with the Kalae Hwy. Guardrail &
Shoulder Improvements project

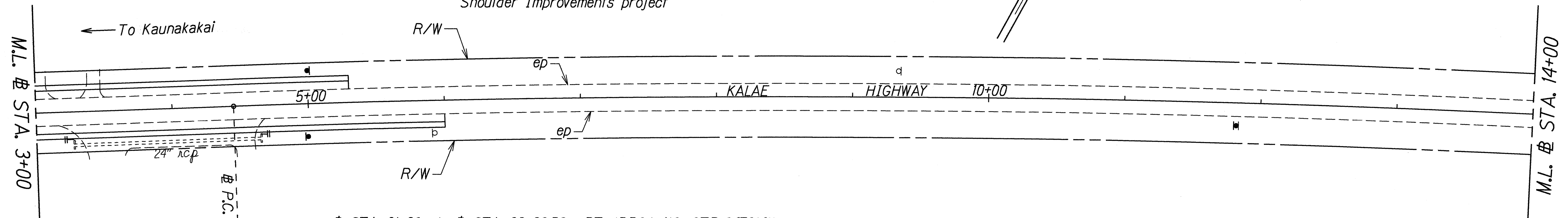

STA. 91+20± to # STA. 92+23.53±, RT. (PROJ. NO. STP-0470(4))
STA. 0+00± to # STA. 6+00±, RT. (PROJ. NO. RS-0900(24))
Construct 705 L.F. of 6' wide shoulder
For detail, See Plan Sht. No. 5

NOTE: Concrete gutter Type 2 (61614) to be installed
in conjunction with the Kalae Hwy. Guardrail &
Shoulder Improvements project

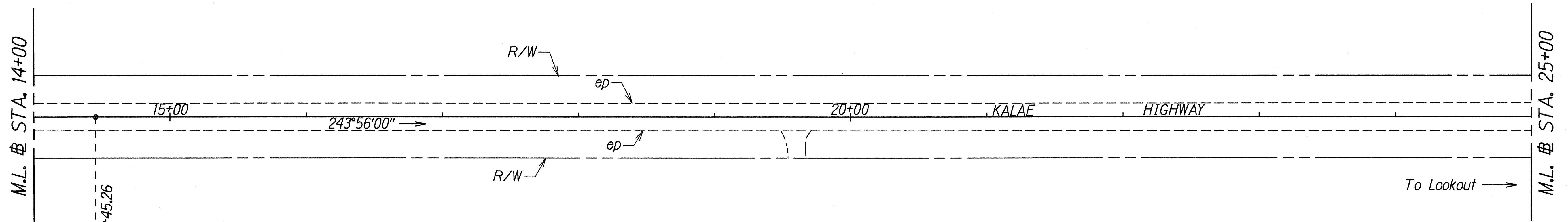

ORIGINAL PLAN	DATE
DESIGNED BY	Feb. 2000
TRACED BY	
NOTE BOOK	
DESIGNED BY	
QUANTITIES BY	
CHECKED BY	

STATE OF HAWAII
DEPARTMENT OF TRANSPORTATION
HIGHWAYS DIVISION

ROADWAY PLAN
KALAE HIGHWAY RESURFACING
Maunaloa Highway to
Kalaupapa Lookout Parking Lot
Project No. 470A-01-00M

Scale: 1" = 40' Date: February, 2000

SHEET No. 6 OF 15 SHEETS

FED. ROAD DIST. NO.	STATE	PROJ. NO.	FISCAL YEAR	SHEET NO.	TOTAL SHEETS
HAWAII	HAW.	470A-01-00M	2000	12	39

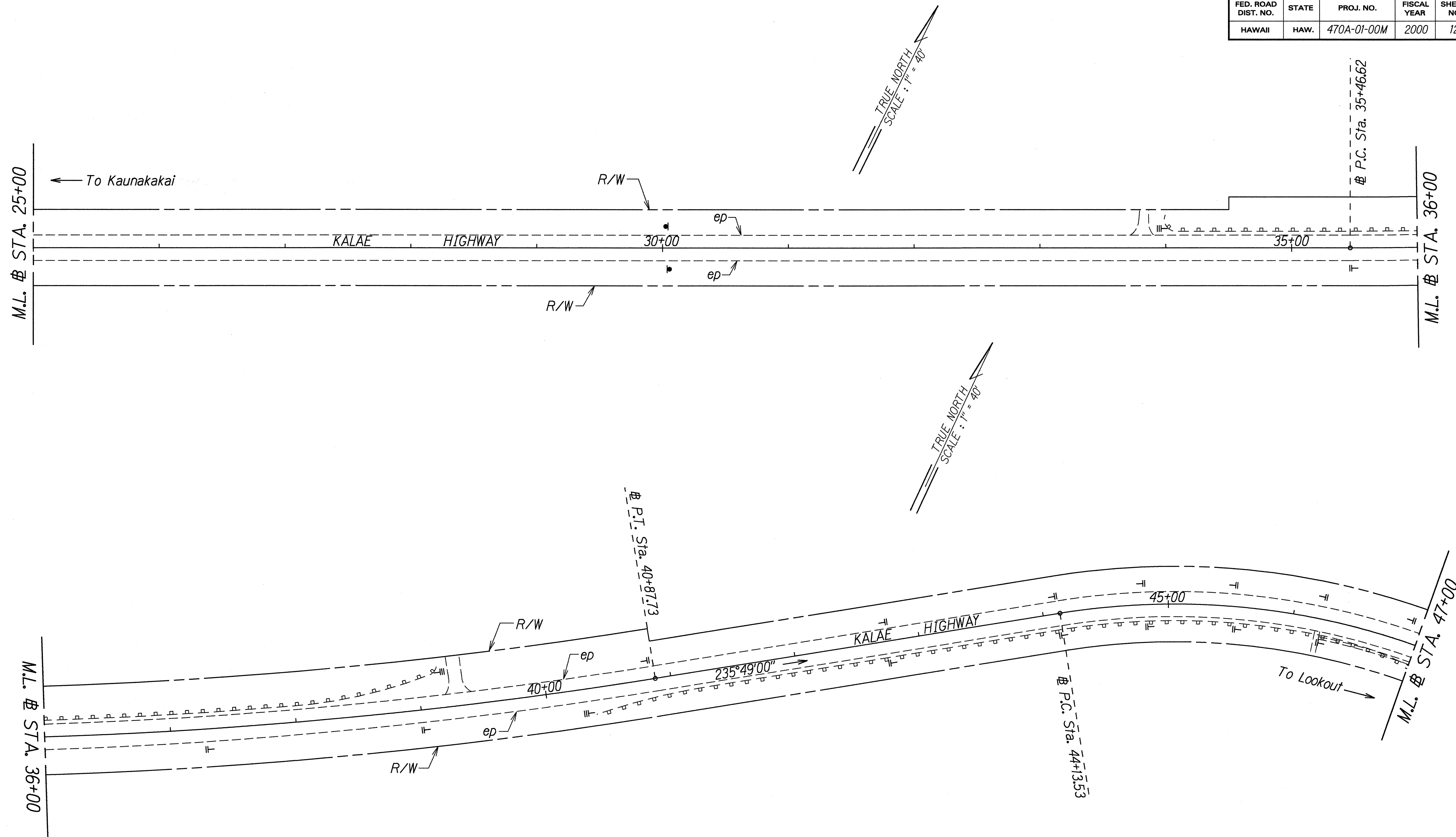

DATE	Feb. 2000
SURVEY PLOTTED BY	
TRACED BY	
DESIGNED BY	
QUANTITIES BY	
CHECKED BY	

STATE OF HAWAII
DEPARTMENT OF TRANSPORTATION
HIGHWAYS DIVISION

ROADWAY PLAN
KALAE HIGHWAY RESURFACING
Maunaloa Highway to
Kalaupapa Lookout Parking Lot
Project No. 470A-01-00M

Scale: 1" = 40' Date: February, 2000

SHEET No. 7 OF 15 SHEETS

FED. ROAD DIST. NO.	STATE	PROJ. NO.	FISCAL YEAR	SHEET NO.	TOTAL SHEETS
HAWAII	HAW.	470A-01-00M	2000	13	39

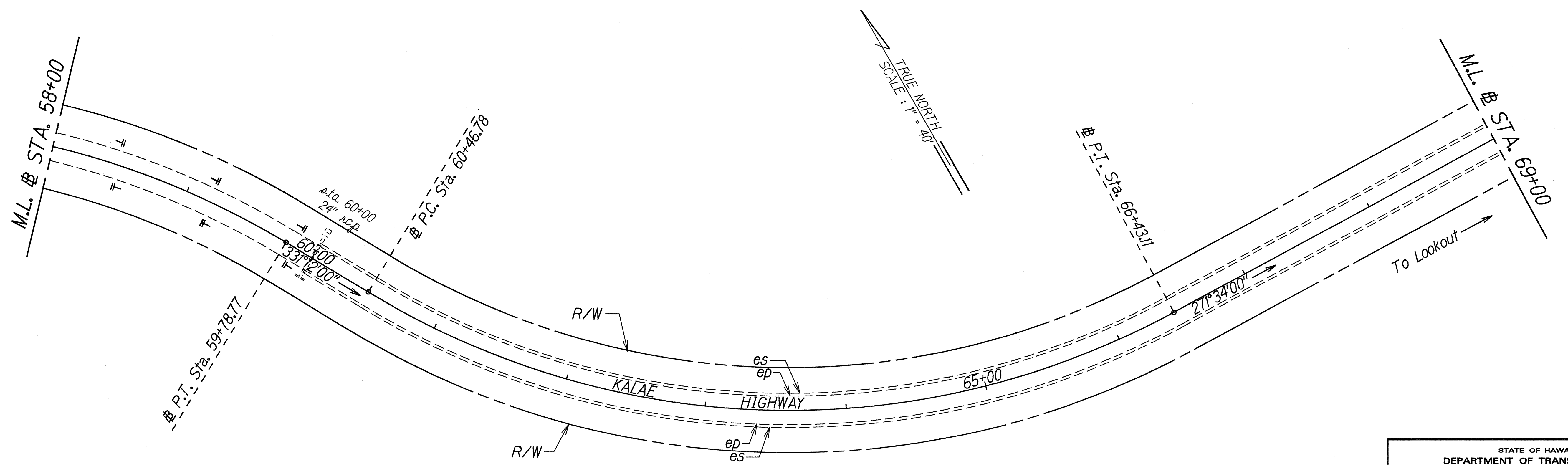
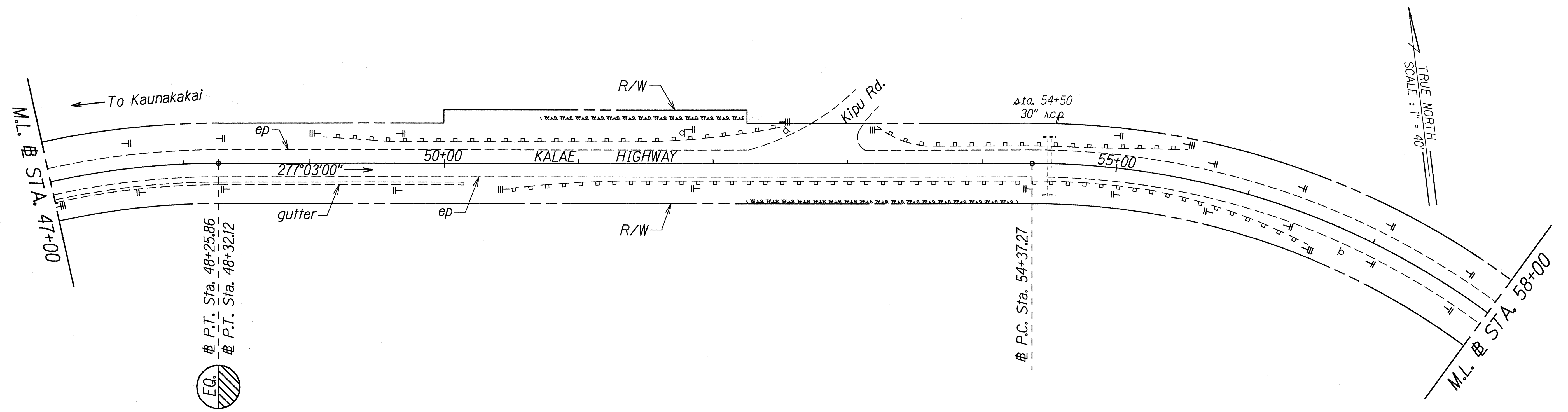

ORIGINAL PLAN	DATE
NO. OF BOOK	DATE
DESIGNED BY	DATE
QUANTITIES BY	DATE
CHECKED BY	DATE

STATE OF HAWAII
DEPARTMENT OF TRANSPORTATION
HIGHWAYS DIVISION

ROADWAY PLAN
KALAE HIGHWAY RESURFACING
Maunaloa Highway to
Kalaupapa Lookout Parking Lot
Project No. 470A-01-00M

Scale: 1" = 40' Date: February, 2000

SHEET No. 8 OF 15 SHEETS

FED. ROAD DIST. NO.	STATE	PROJ. NO.	FISCAL YEAR	SHEET NO.	TOTAL SHEETS
HAWAII	HAW.	470A-01-00M	2000	14	39

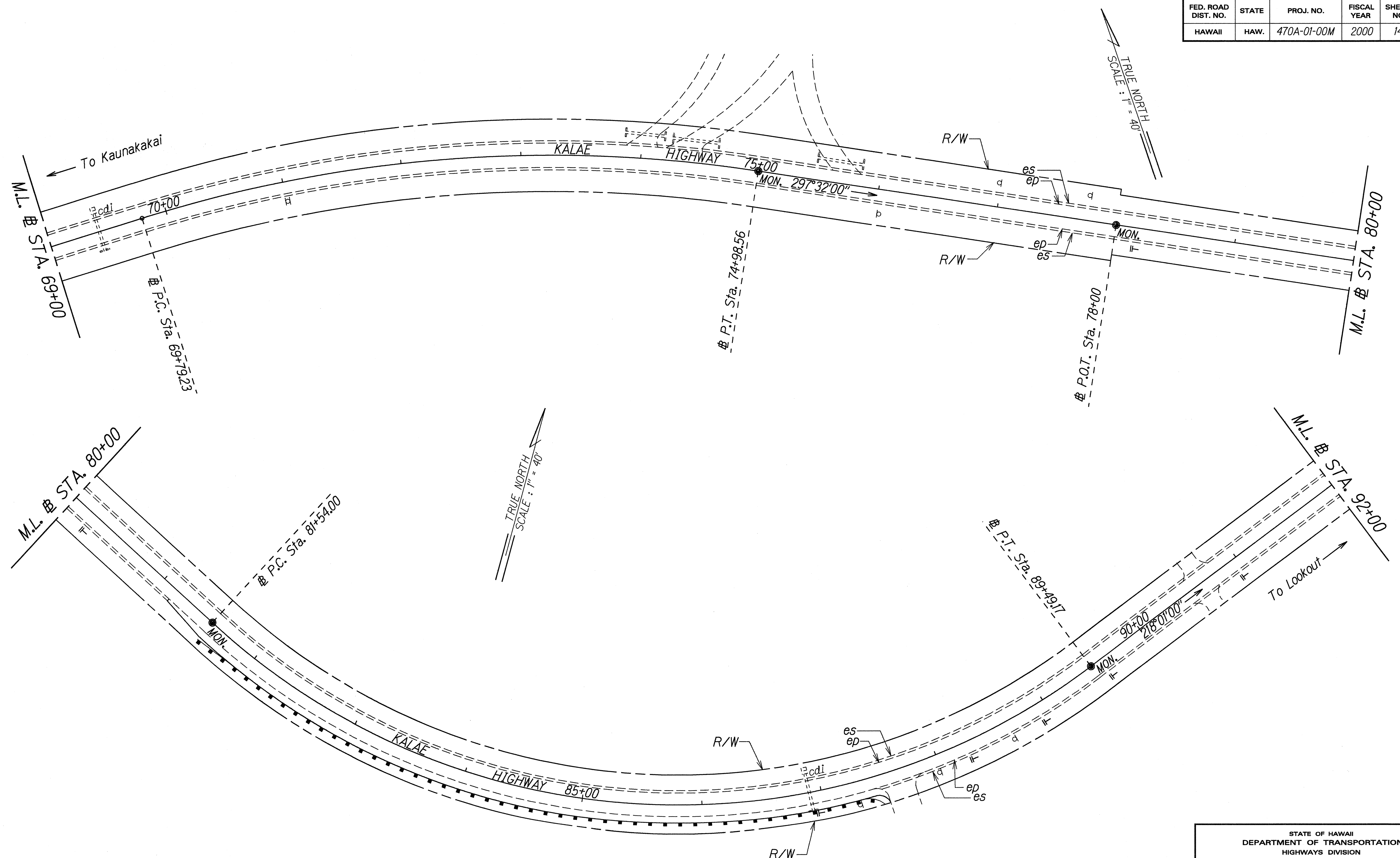

DATE	02/02/2000
SURVEY PLOTTED BY	
DESIGNED BY	
QUANTITIES BY	
CHECKED BY	
ORIGINAL PLAN	
NOTE BOOK	
DESIGNED BY	
QUANTITIES BY	
CHECKED BY	

STA. 81+55± RT. - STA. 87+55± RT.
 Construct 600 L.F. of 6' wide shoulder
 See Detail on Sht. No. 5
 (NOTE: Guardrail to be installed in conjunction
 with the Kalae Hwy. Guardrail and Shoulder
 Improvements project)

STATE OF HAWAII
 DEPARTMENT OF TRANSPORTATION
 HIGHWAYS DIVISION

ROADWAY PLAN
KALAE HIGHWAY RESURFACING
 Maunaloa Highway to
 Kalaupapa Lookout Parking Lot
 Project No. 470A-01-00M

Scale: 1" = 40' Date: February, 2000

SHEET No. 9 OF 15 SHEETS

FED. ROAD DIST. NO.	STATE	PROJ. NO.	FISCAL YEAR	SHEET NO.	TOTAL SHEETS
HAWAII	HAW.	470A-01-00M	2000	15	39

STA. 92+00± to # STA. 100+00±, LT.
 Reconstruct 800 L.F. # eradicate tree roots laying on the roadway.
 For detail, See Plan Sht. No. 5

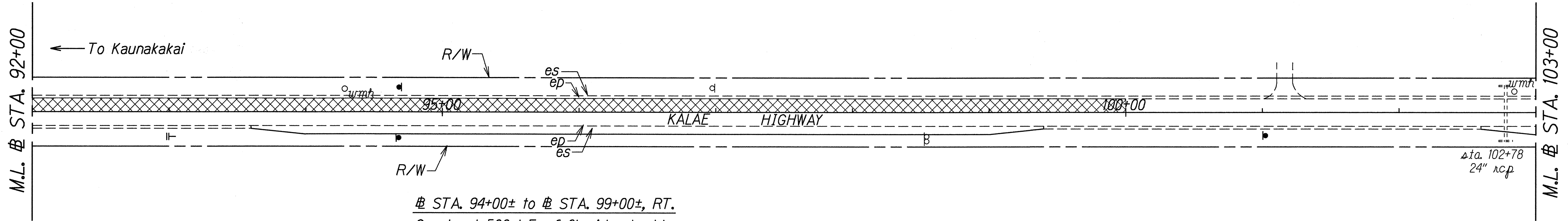
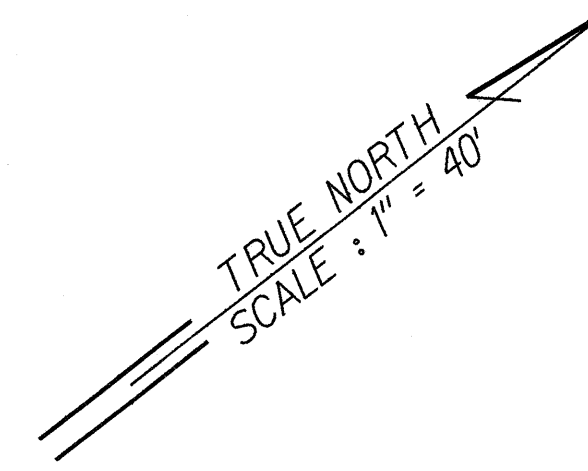

STA. 94+00± to # STA. 99+00±, RT.
 Construct 500 L.F. of 6' wide shoulder
 For detail, See Plan Sht. No. 5

(NOTE: Guardrail to be installed in conjunction with the Kalae Hwy. Guardrail and Shoulder Improvements project)

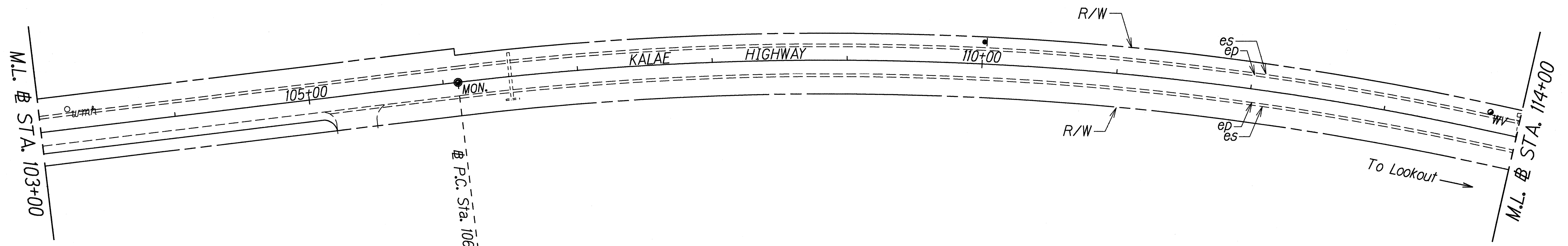
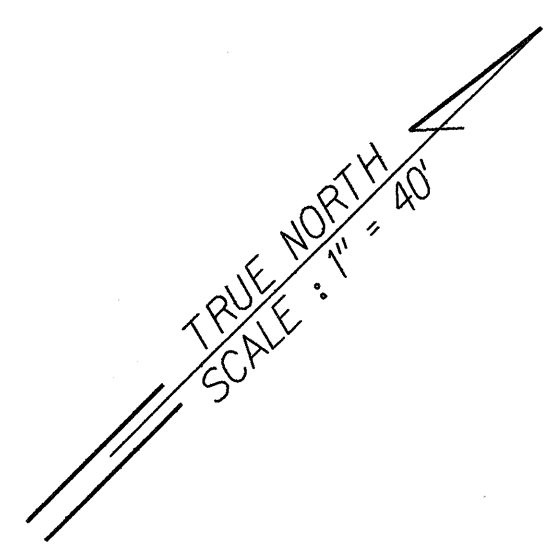

STA. 103+00± to # STA. 105+00±, RT.
 Construct 200 L.F. of 6' wide shoulder
 For detail, See Plan Sht. No. 5

(NOTE: Guardrail to be installed in conjunction with the Kalae Hwy. Guardrail and Shoulder Improvements project)

ORIGINAL PLAN	DATE
DESIGNED BY	6/21/2000
DESIGNED BY	
QUANTITIES BY	
CHECKED BY	

STATE OF HAWAII
 DEPARTMENT OF TRANSPORTATION
 HIGHWAYS DIVISION

ROADWAY PLAN
KALAE HIGHWAY RESURFACING
 Maunaloa Highway to
 Kalaupapa Lookout Parking Lot
 Project No. 470A-01-00M

Scale: 1" = 40' Date: February, 2000

SHEET No. 10 OF 15 SHEETS

FED. ROAD DIST. NO.	STATE	PROJ. NO.	FISCAL YEAR	SHEET NO.	TOTAL SHEETS
HAWAII	HAW.	470A-01-00M	2000	16	39

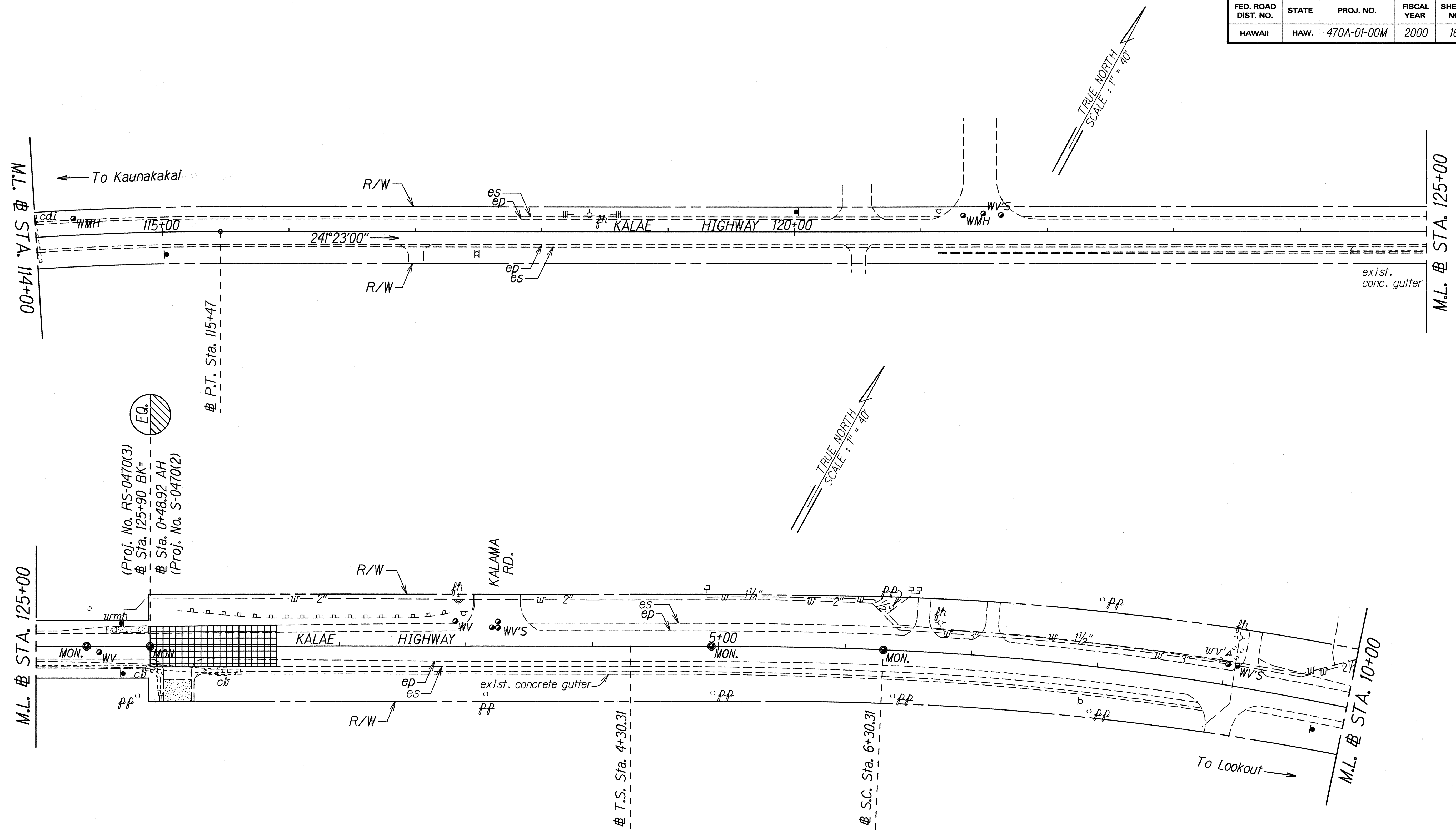

ORIGINAL PLAN	SURVEY PLOTTED BY	DATE
NOTED BOOK	DESIGNED BY	
QUANTITIES BY	CHECKED BY	

STATE OF HAWAII
DEPARTMENT OF TRANSPORTATION
HIGHWAYS DIVISION

ROADWAY PLAN
KALAE HIGHWAY RESURFACING
Maunaloa Highway to
Kalaupapa Lookout Parking Lot
Project No. 470A-01-00M

Scale: 1" = 40' Date: February, 2000

SHEET No. 11 OF 15 SHEETS

FED. ROAD DIST. NO.	STATE	PROJ. NO.	FISCAL YEAR	SHEET NO.	TOTAL SHEETS
HAWAII	HAW.	470A-01-00M	2000	17	39

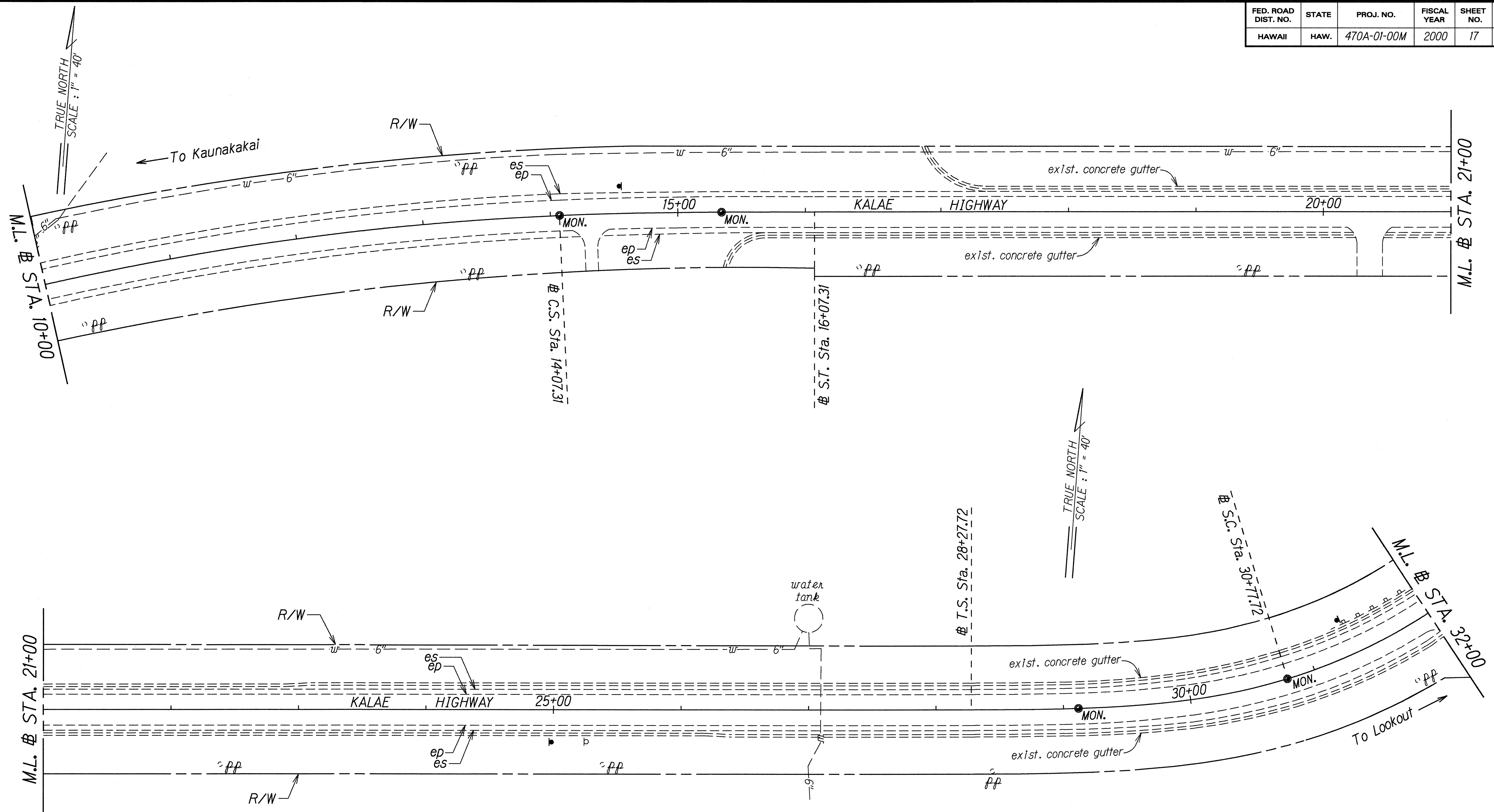

ORIGINAL PLAN	DATE
DESIGNED BY	2000
DESIGNED BY	
QUANTITIES BY	
CHECKED BY	

STATE OF HAWAII
DEPARTMENT OF TRANSPORTATION
HIGHWAYS DIVISION

ROADWAY PLAN
KALAE HIGHWAY RESURFACING
Maunaloa Highway to
Kalaupapa Lookout Parking Lot
Project No. 470A-01-00M

Scale: 1" = 40' Date: February, 2000

SHEET No. 12 OF 15 SHEETS

FED. ROAD DIST. NO.	STATE	PROJ. NO.	FISCAL YEAR	SHEET NO.	TOTAL SHEETS
HAWAII	HAW.	470A-01-00M	2000	18	39

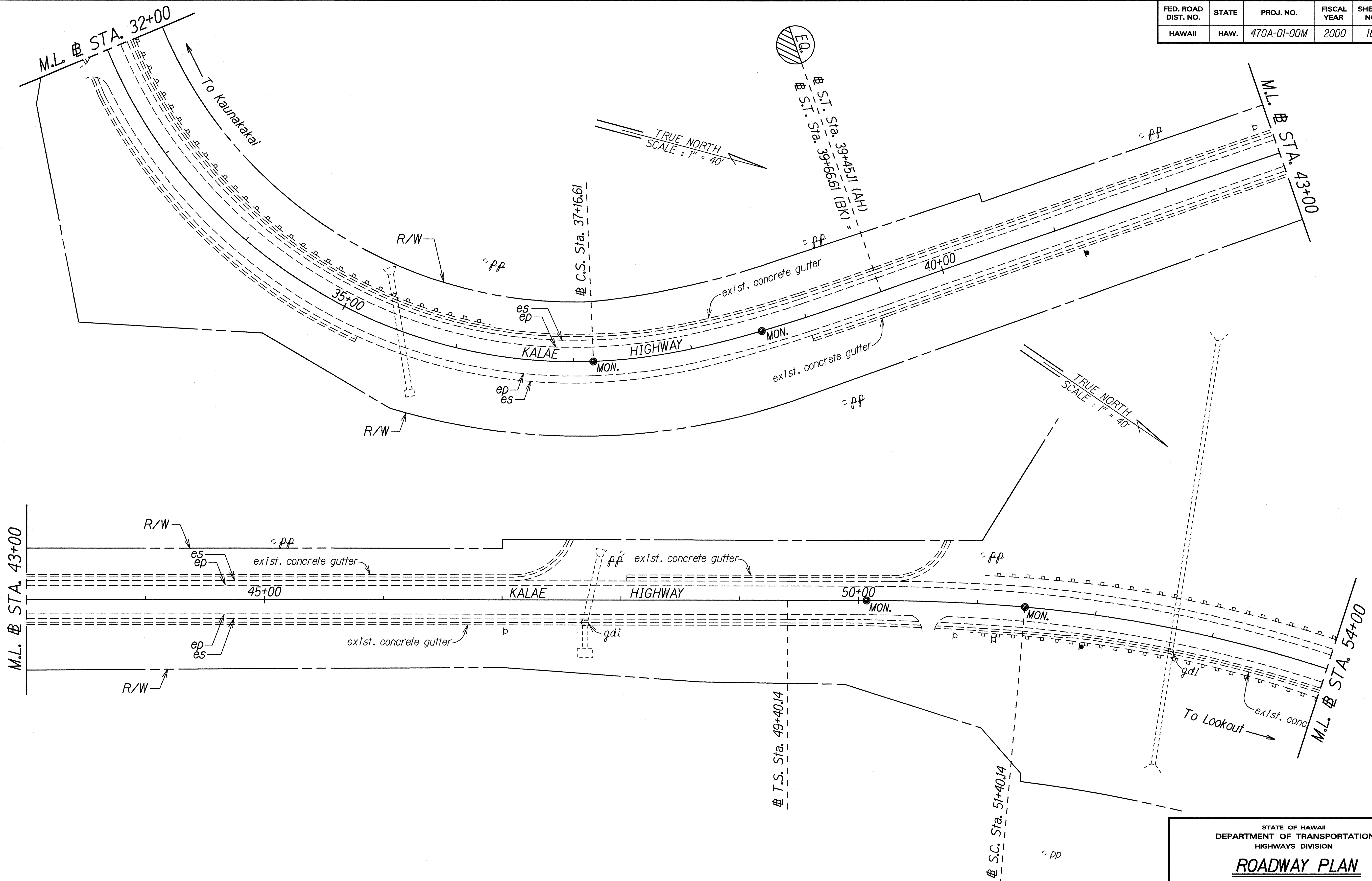

ORIGINAL PLAN	DATE
NOTED BY	DATE
DESIGNED BY	DATE
CHECKED BY	DATE

STATE OF HAWAII
DEPARTMENT OF TRANSPORTATION
HIGHWAYS DIVISION

ROADWAY PLAN
KALAE HIGHWAY RESURFACING
Maunaloa Highway to
Kalaupapa Lookout Parking Lot
Project No. 470A-01-00M

Scale: 1" = 40' Date: February, 2000

SHEET No. 13 OF 15 SHEETS

FED. ROAD DIST. NO.	STATE	PROJ. NO.	FISCAL YEAR	SHEET NO.	TOTAL SHEETS
HAWAII	HAW.	470A-01-00M	2000	19	39

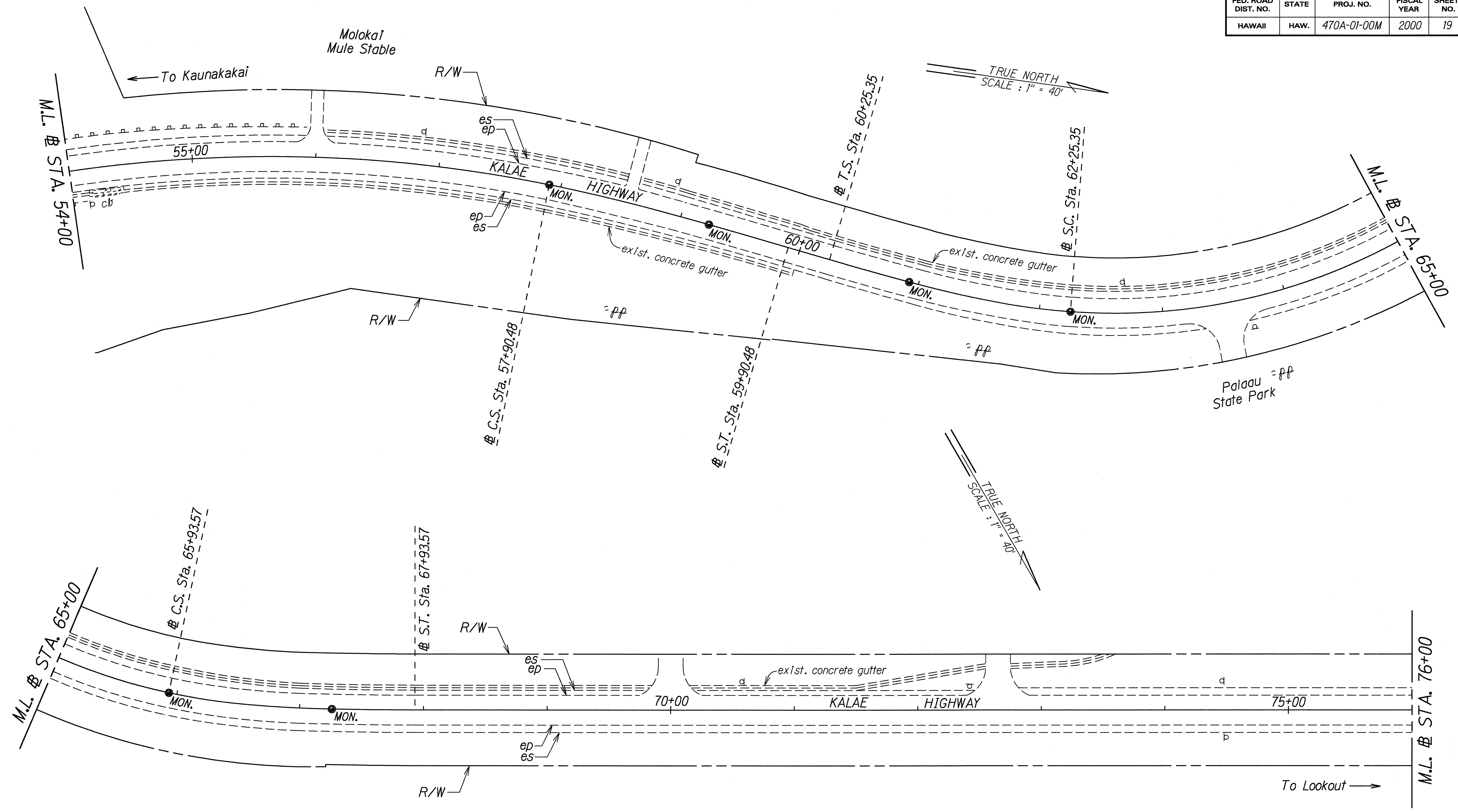

ORIGINAL PLAN	DATE
DESIGNED BY	Feb. 2000
DESIGNED BY	
QUANTITIES BY	
CHECKED BY	

STATE OF HAWAII
DEPARTMENT OF TRANSPORTATION
HIGHWAYS DIVISION

ROADWAY PLAN
KALAE HIGHWAY RESURFACING
Maunaloa Highway to
Kalaupapa Lookout Parking Lot
Project No. 470A-01-00M

Scale: 1" = 40' Date: February, 2000

SHEET No. 14 OF 15 SHEETS

FED. ROAD DIST. NO.	STATE	PROJ. NO.	FISCAL YEAR	SHEET NO.	TOTAL SHEETS
HAWAII	HAW.	470A-01-00M	2000	20	39

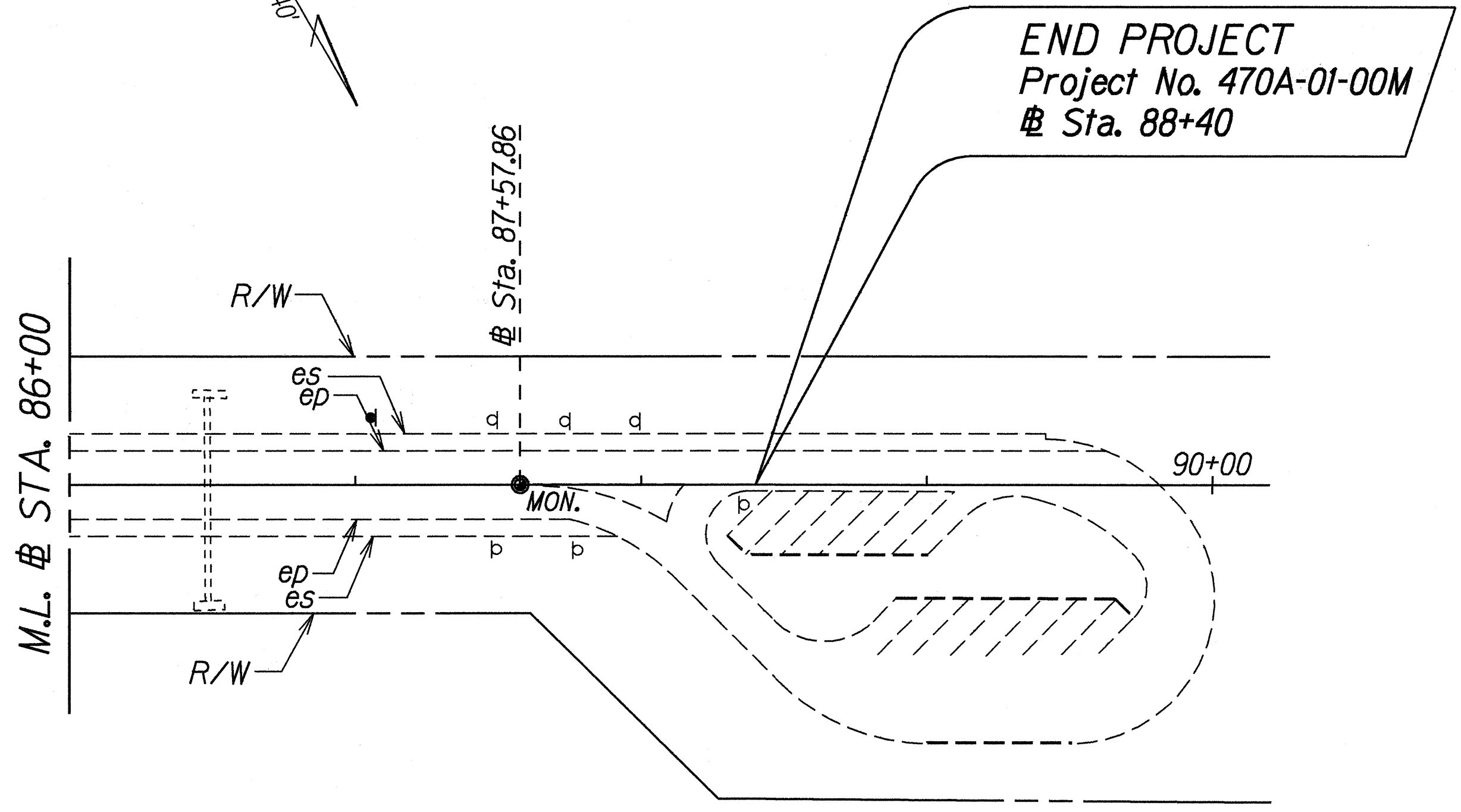
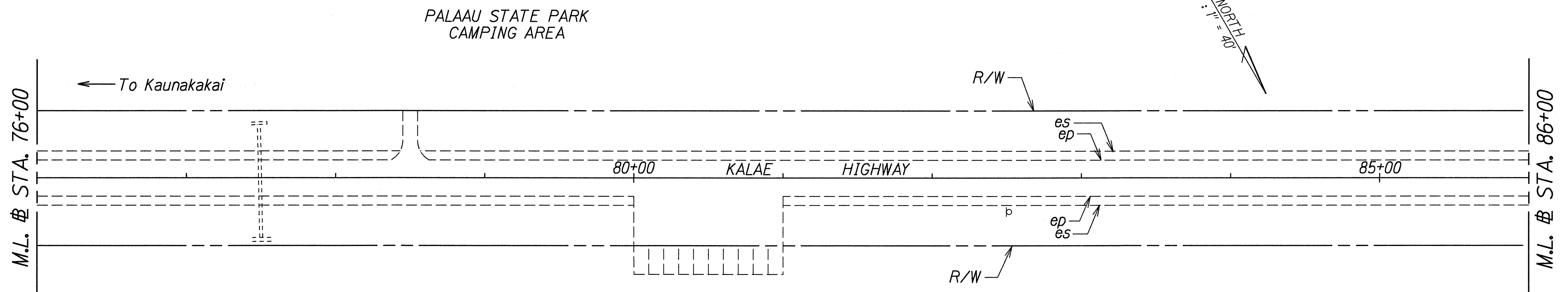

ORIGINAL PLAN	DATE
NOTED BY	DATE
DESIGNED BY	DATE
QUANTITIES BY	DATE
CHECKED BY	DATE

STATE OF HAWAII
DEPARTMENT OF TRANSPORTATION
HIGHWAYS DIVISION

ROADWAY PLAN
KALAE HIGHWAY RESURFACING
*Maunaloa Highway to
Kalaupapa Lookout Parking Lot*
Project No. 470A-01-00M

Scale: 1" = 40' Date: February, 2000

SHEET No. 15 OF 15 SHEETS