

FED. ROAD DIST. NO.	STATE	FED. AID PROJ. NO.	FISCAL YEAR	SHEET NO.	TOTAL SHEETS
HAWAII	HAW.	F-19(4)	1953	3	40

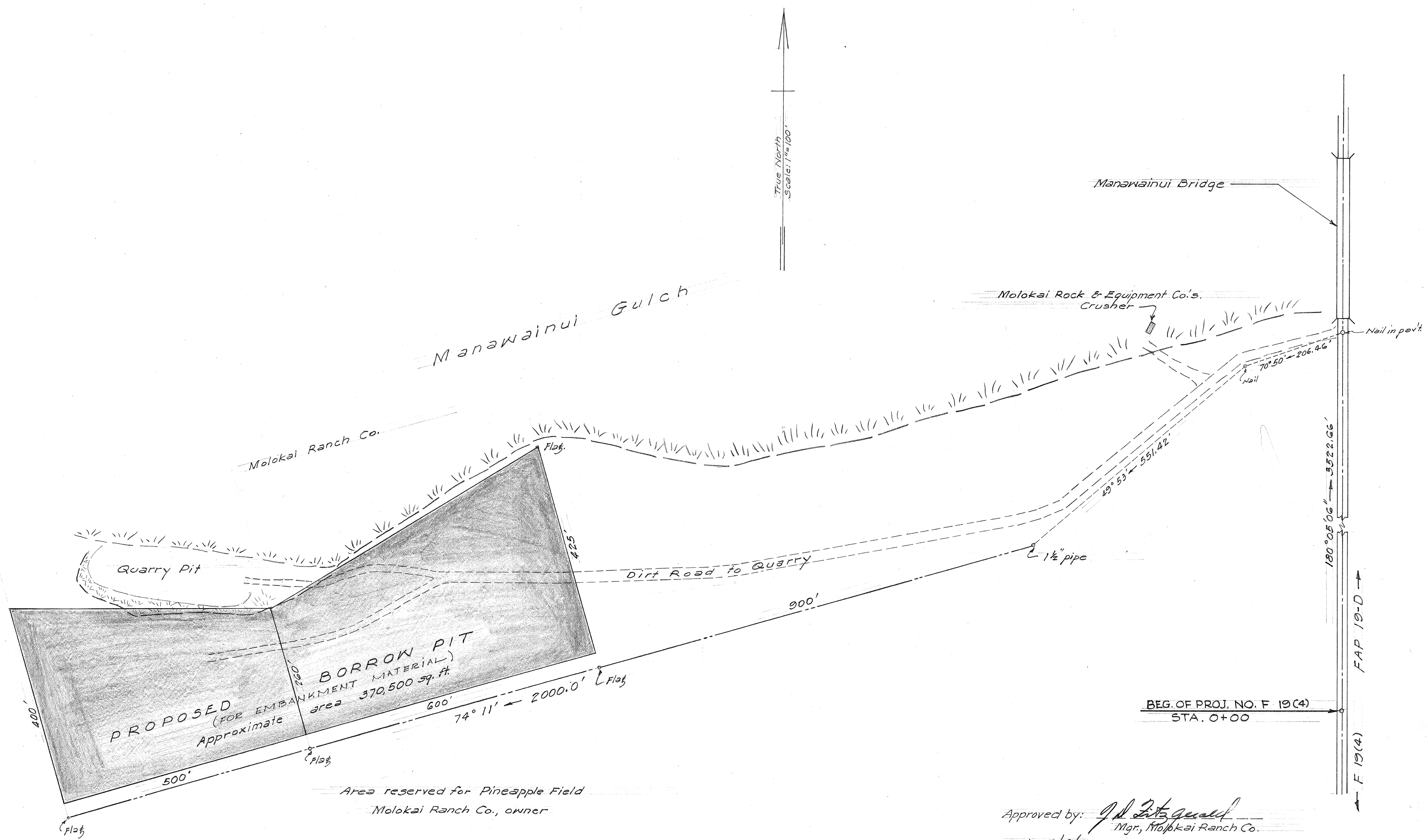

DESIGNED BY	DATE
DRAWN BY	
TRACED BY	
QUANTITIES CHECKED BY	
CHECKED BY	
ORIGINAL PLAN	
NOTE BOOK	
NO.	

Approved by: *J. A. Fitzgerald*
 Mgr., Molokai Ranch Co.
 Date: 12/9/1952

Hauling distance 1.0 mile
 to beginning of Proj. F-19(4)

TERRITORIAL HIGHWAY DEPARTMENT
 TERRITORY OF HAWAII
 KAUNAKAKAI-KUALAPUU ROAD
 FED. AID PROJ. NO. F-19(4)
 PLAN SHOWING LOCATION
 OF PROPOSED BORROW PIT
 Scale: 1"=100'
 Dec. 1952

SHEET No. OF SHEETS

5605.3