

FED. ROAD DIST. NO.	STATE	PROJ. NO.	FISCAL YEAR	SHEET NO.	TOTAL SHEETS
HAWAII	HAW.	450A-01-12M	2014	25	38

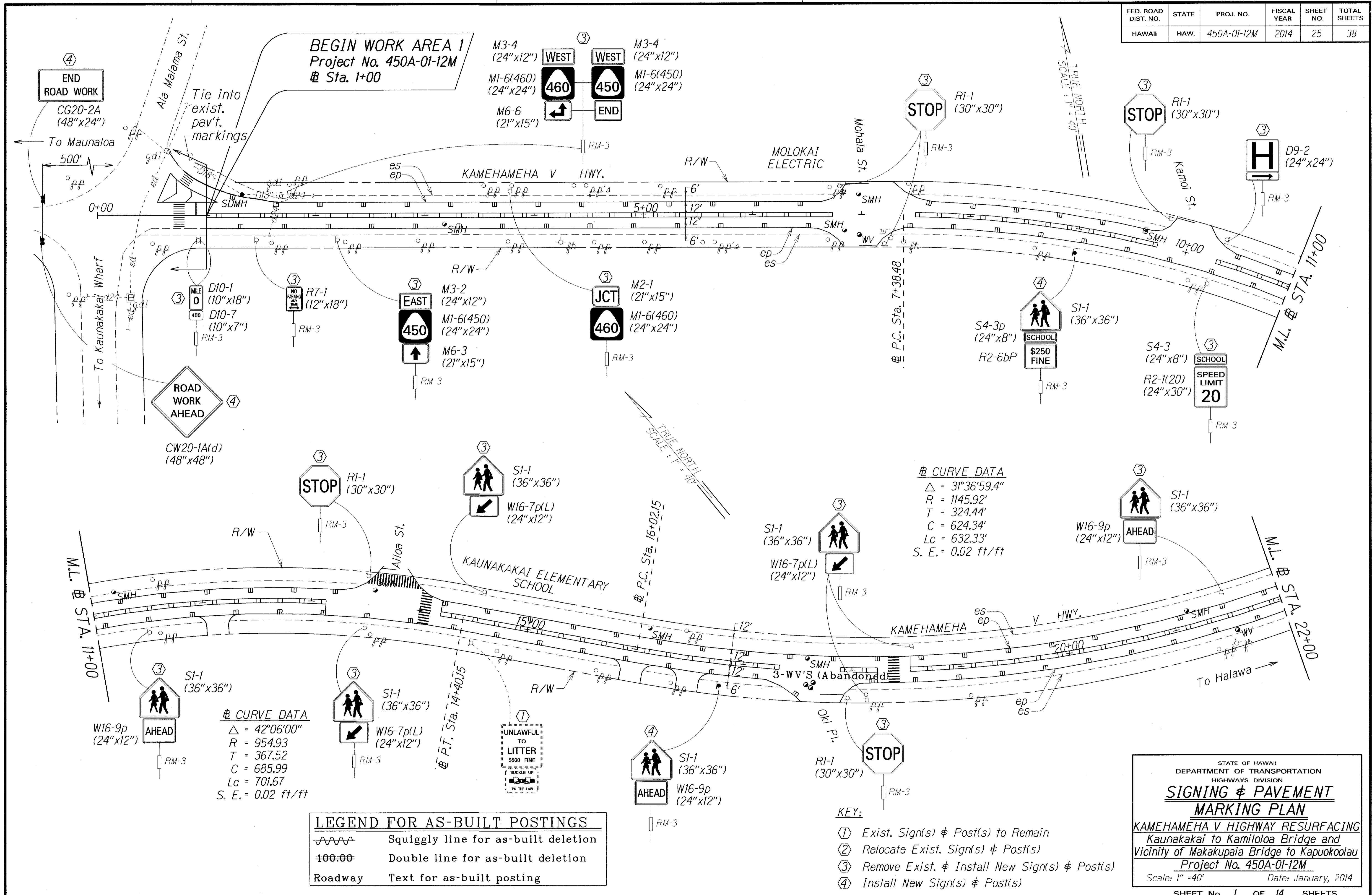

CURVE DATA
 $\Delta = 3^\circ 36' 59.4''$
 $R = 1145.92'$
 $T = 324.44'$
 $C = 624.34'$
 $Lc = 632.33'$
 $S. E. = 0.02 \text{ ft/ft}$

CURVE DATA
 $\Delta = 42^\circ 06' 00''$
 $R = 954.93$
 $T = 367.52$
 $C = 685.99$
 $Lc = 701.67$
 $S. E. = 0.02 \text{ ft/ft}$

	Squiggly line for as-built deletion
	Double line for as-built deletion
Roadway	Text for as-built posting

- KEY:
- ① Exist. Sign(s) & Post(s) to Remain
 - ② Relocate Exist. Sign(s) & Post(s)
 - ③ Remove Exist. & Install New Sign(s) & Post(s)
 - ④ Install New Sign(s) & Post(s)

STATE OF HAWAII
DEPARTMENT OF TRANSPORTATION
HIGHWAYS DIVISION
SIGNING & PAVEMENT MARKING PLAN
KAMEHAMEHA V HIGHWAY RESURFACING
Kaunakakai to Kamiloloa Bridge and
Vicinity of Makakupaia Bridge to Kapuokoolau
Project No. 450A-01-12M
Scale: 1" = 40' Date: January, 2014
SHEET No. 1 OF 14 SHEETS

SURVEY PLOTTED BY	DATE
DRAWN BY	
TRACED BY	
DESIGNED BY	
NOTED BY	
CHECKED BY	

"AS-BUILT"

FED. ROAD DIST. NO.	STATE	PROJ. NO.	FISCAL YEAR	SHEET NO.	TOTAL SHEETS
HAWAII	HAW.	450A-01-12M	2014	26	38

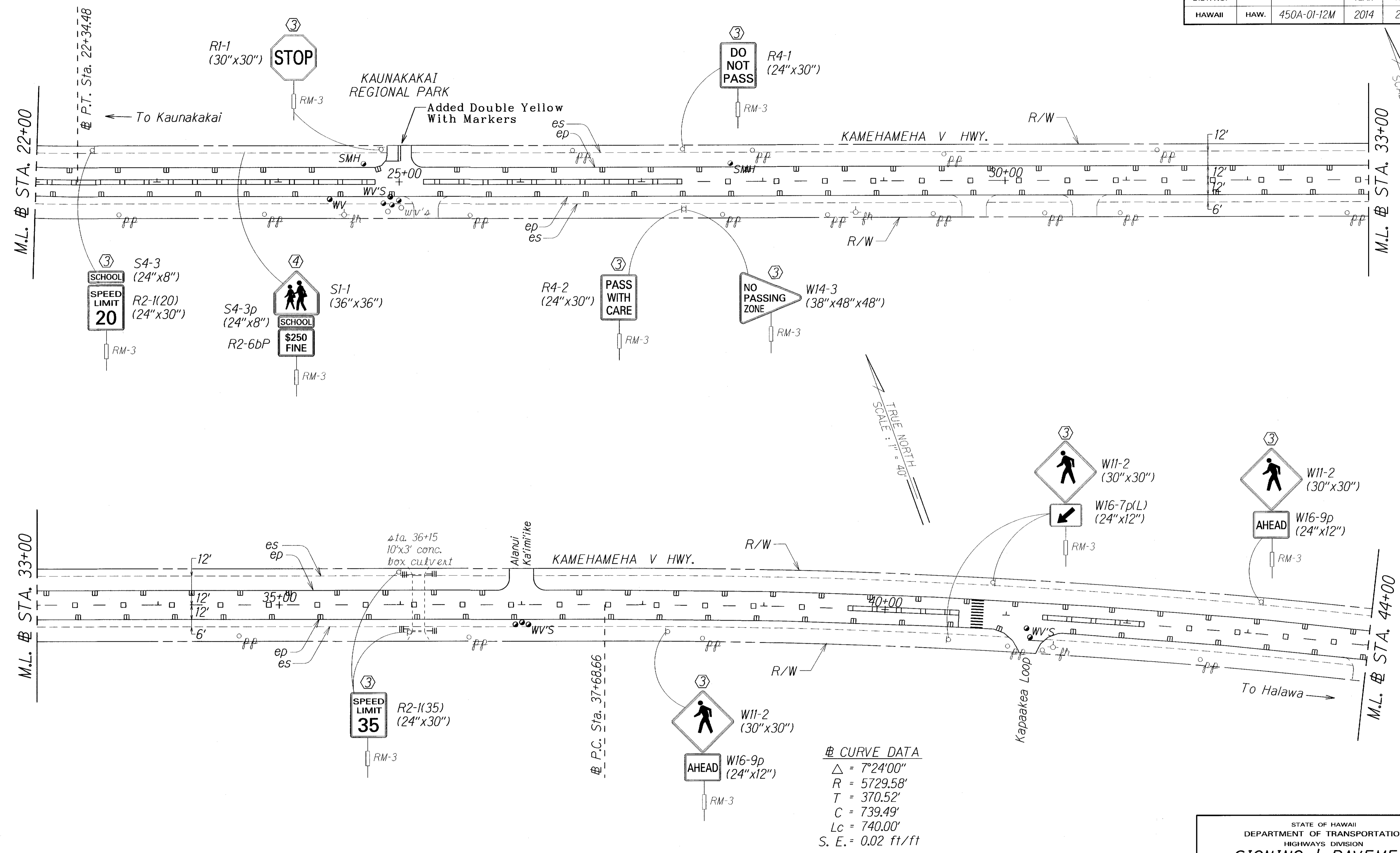

△ CURVE DATA
 $\Delta = 7^{\circ}24'00''$
 $R = 5729.58'$
 $T = 370.52'$
 $C = 739.49'$
 $Lc = 740.00'$
 $S. E. = 0.02 \text{ ft/ft}$

LEGEND FOR AS-BUILT POSTINGS	
	Squiggly line for as-built deletion
	Double line for as-built deletion
Roadway	Text for as-built posting

- KEY:**
- ① Exist. Sign(s) & Post(s) to Remain
 - ② Relocate Exist. Sign(s) & Post(s)
 - ③ Remove Exist. & Install New Sign(s) & Post(s)
 - ④ Install New Sign(s) & Post(s)

ORIGINAL PLAN	DATE
SURVEY PLOTTED BY	
DRAWN BY	
TRACED BY	
DESIGNED BY	
CHECKED BY	

STATE OF HAWAII
DEPARTMENT OF TRANSPORTATION
HIGHWAYS DIVISION

SIGNING & PAVEMENT MARKING PLAN

KAMEHAMEHA V HIGHWAY RESURFACING
Kaunakakai to Kamiloloa Bridge and
Vicinity of Makakupaia Bridge to Kapuokoolau
Project No. 450A-01-12M
Scale: 1" = 40' Date: January, 2014

SHEET No. 2 OF 14 SHEETS

"AS-BUILT"

FED. ROAD DIST. NO.	STATE	PROJ. NO.	FISCAL YEAR	SHEET NO.	TOTAL SHEETS
HAWAII	HAW.	450A-01-12M	2014	27	38

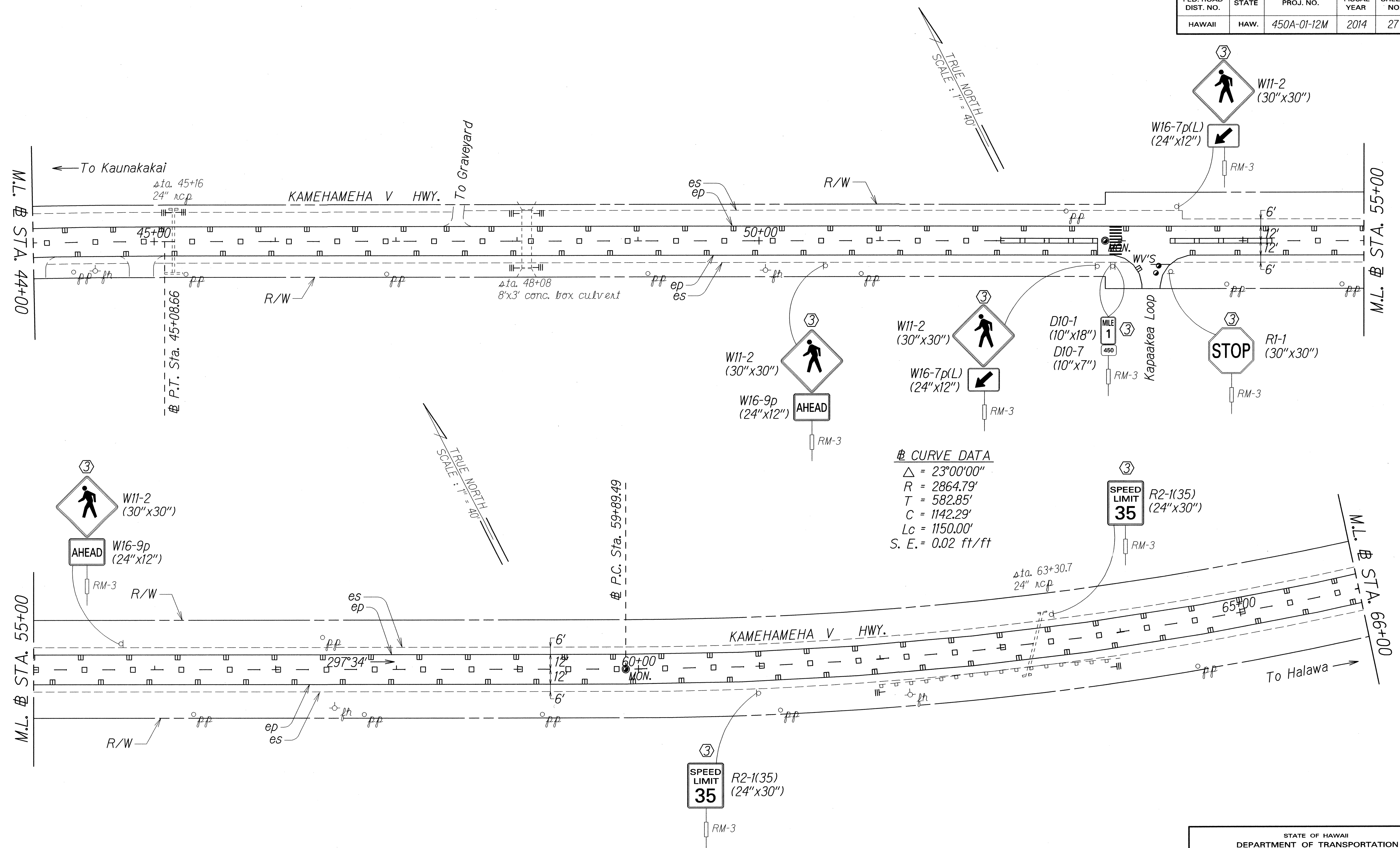

CURVE DATA
 $\Delta = 23^{\circ}00'00''$
 $R = 2864.79'$
 $T = 582.85'$
 $C = 1142.29'$
 $Lc = 1150.00'$
 $S. E. = 0.02 \text{ ft/ft}$

SURVEY PLOTTED BY: _____ DATE: 10/07
 DRAWN BY: JG
 TRACED BY: _____
 NOTE BOOK: _____
 QUANTITIES BY: _____
 CHECKED BY: _____
 ORIGINAL PLAN: _____
 DATE: _____
 NOTE: _____
 CHECKED BY: _____

- KEY:**
- ① Exist. Sign(s) & Post(s) to Remain
 - ② Relocate Exist. Sign(s) & Post(s)
 - ③ Remove Exist. & Install New Sign(s) & Post(s)
 - ④ Install New Sign(s) & Post(s)

STATE OF HAWAII
 DEPARTMENT OF TRANSPORTATION
 HIGHWAYS DIVISION
SIGNING & PAVEMENT MARKING PLAN
 KAMEHAMEHA V HIGHWAY RESURFACING
 Kaunakakai to Kamiloloa Bridge and
 Vicinity of Makakupaia Bridge to Kapuokoolau
 Project No. 450A-01-12M
 Scale: 1" = 40' Date: January, 2014
 SHEET No. 3 OF 14 SHEETS

FED. ROAD DIST. NO.	STATE	PROJ. NO.	FISCAL YEAR	SHEET NO.	TOTAL SHEETS
HAWAII	HAW.	450A-01-12M	2014	29	38

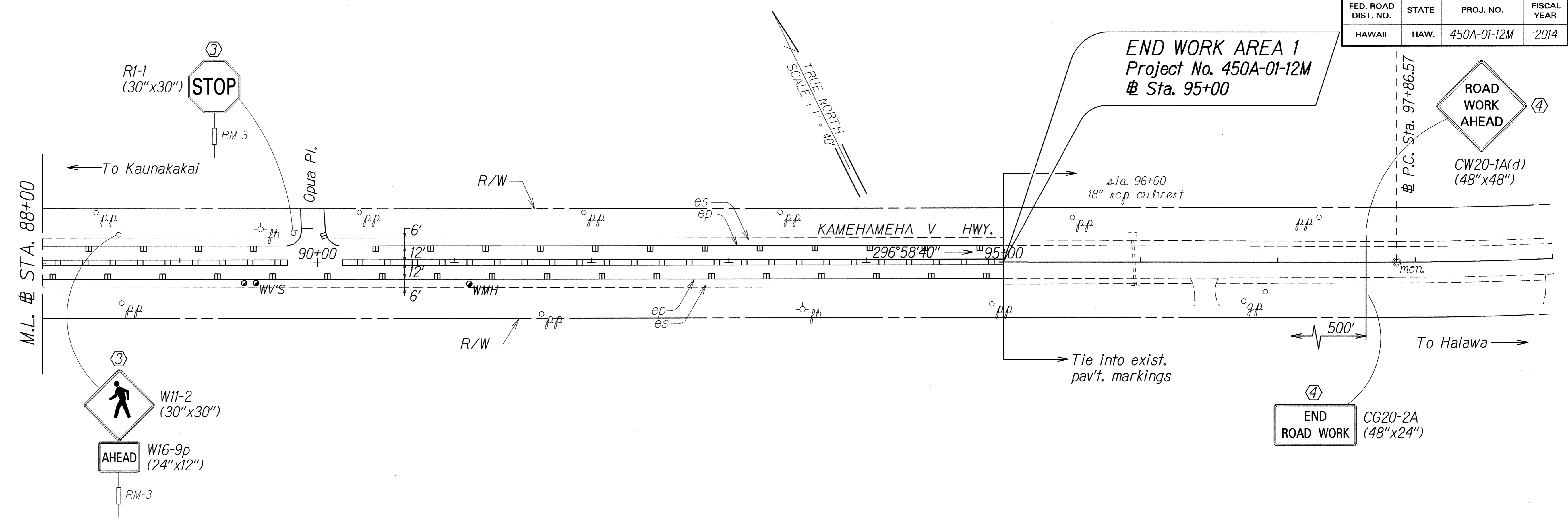

ORIGINAL PLAN	SURVEY PLOTTED BY	DATE
NOTE BOOK	TRACED BY	10/07
DESIGNED BY	DESIGNED BY	
QUANTITIES BY	QUANTITIES BY	
CHECKED BY	CHECKED BY	

- KEY:**
- ① Exist. Sign(s) & Post(s) to Remain
 - ② Relocate Exist. Sign(s) & Post(s)
 - ③ Remove Exist. & Install New Sign(s) & Post(s)
 - ④ Install New Sign(s) & Post(s)

STATE OF HAWAII
DEPARTMENT OF TRANSPORTATION
HIGHWAYS DIVISION

**SIGNING & PAVEMENT
MARKING PLAN**

KAMEHAMEHA V HIGHWAY RESURFACING
Kaunakakai to Kamiloloa Bridge and
Vicinity of Makakupaia Bridge to Kapuokoolau
Project No. 450A-01-12M

Scale: 1" = 40' Date: January, 2014

SHEET No. 5 OF 14 SHEETS

FED. ROAD DIST. NO.	STATE	PROJ. NO.	FISCAL YEAR	SHEET NO.	TOTAL SHEETS
HAWAII	HAW.	450A-01-12M	2014	30	38

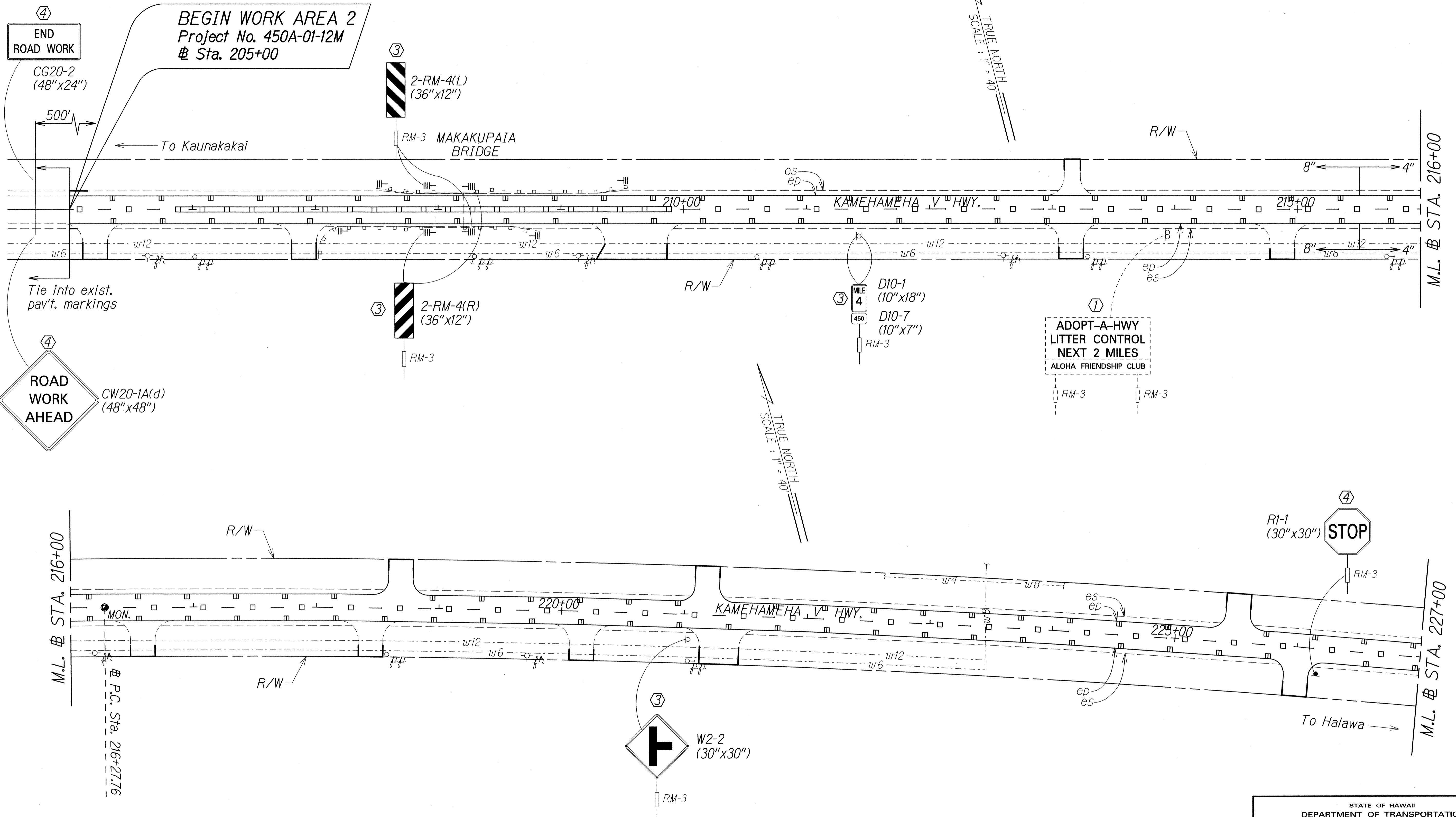

ORIGINAL PLAN	SURVEY PLOTTED BY	DATE
NOTE BOOK	DRAWN BY J. Guerrero	April, 1995
DESIGNED BY C. Burgess	CHECKED BY	
DATE		

- KEY:**
- ① Exist. Sign(s) & Post(s) to Remain
 - ② Remove Exist. Sign(s) & Post(s)
 - ③ Remove Exist. & Install New Sign(s) & Post(s)
 - ④ Install New Sign(s) & Post(s)

STATE OF HAWAII
DEPARTMENT OF TRANSPORTATION
HIGHWAYS DIVISION

**SIGNING & PAVEMENT
MARKING PLAN**

KAMEHAMEHA V HIGHWAY RESURFACING
Kaunakakai to Kamiloloa Bridge and
Vicinity of Makakupaia Bridge to Kapuokoolau
Project No. 450A-01-12M

Scale: 1" = 40' Date: January, 2014

SHEET No. 6 OF 14 SHEETS

FED. ROAD DIST. NO.	STATE	PROJ. NO.	FISCAL YEAR	SHEET NO.	TOTAL SHEETS
HAWAII	HAW.	450A-01-12M	2014	31	38

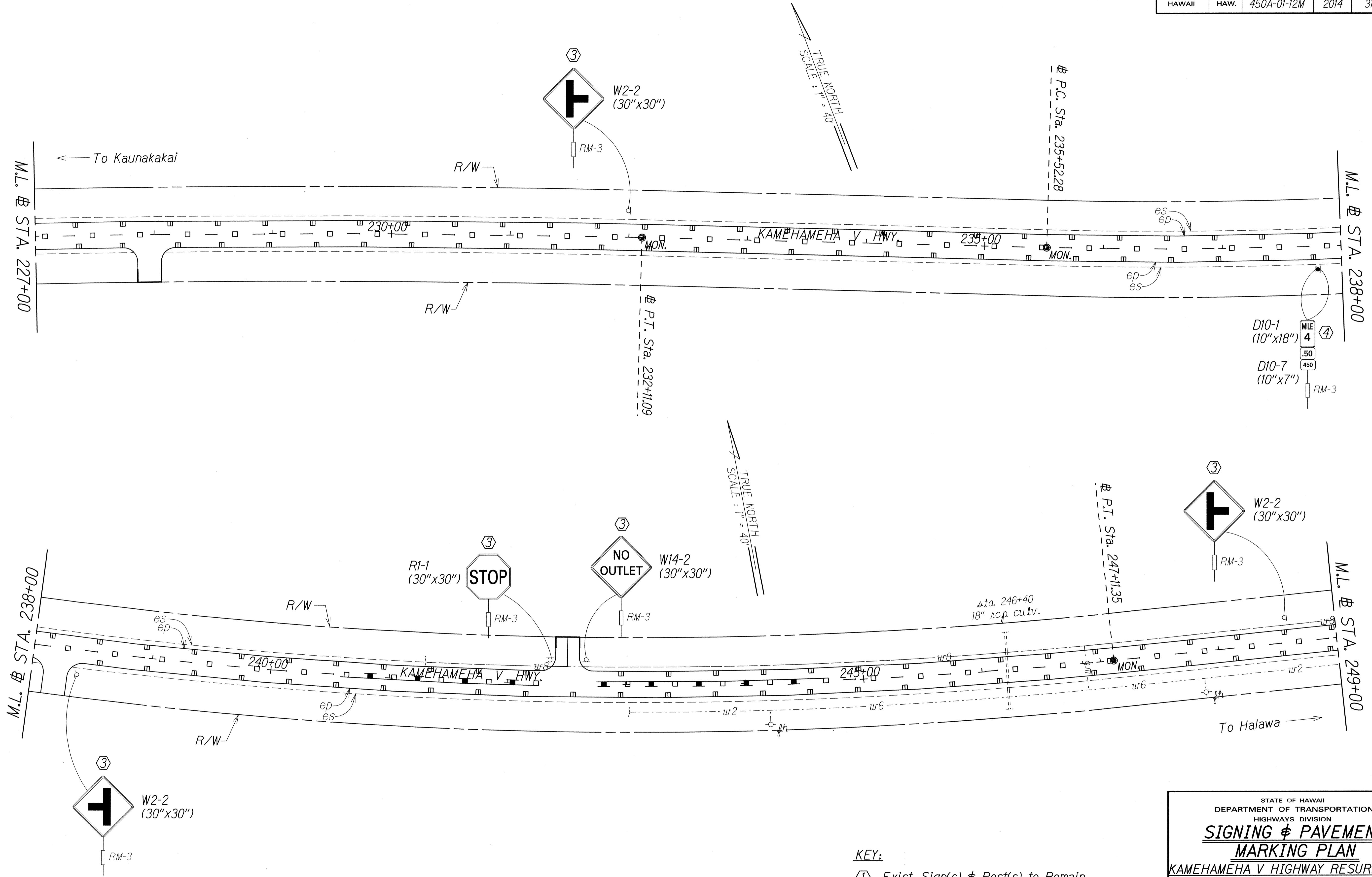

ORIGINAL PLAN
 SURVEY PLOTTED BY: DATE: April 1992
 DRAWN BY: J. G. GILBERTO
 NOTE BOOK NO. 1097-0715
 DESIGNED BY: C. BARBER
 CHECKED BY: M. HARRIS

- KEY:**
- ① Exist. Sign(s) & Post(s) to Remain
 - ② Remove Exist. Sign(s) & Post(s)
 - ③ Remove Exist. & Install New Sign(s) & Post(s)
 - ④ Install New Sign(s) & Post(s)

STATE OF HAWAII
 DEPARTMENT OF TRANSPORTATION
 HIGHWAYS DIVISION
SIGNING & PAVEMENT MARKING PLAN
 KAMEHAMEHA V HIGHWAY RESURFACING
 Kaunakakai to Kamiloloa Bridge and
 Vicinity of Makakupaia Bridge to Kapuokoolau
 Project No. 450A-01-12M
 Scale: 1" = 40' Date: January, 2014
 SHEET No. 7 OF 14 SHEETS

FED. ROAD DIST. NO.	STATE	PROJ. NO.	FISCAL YEAR	SHEET NO.	TOTAL SHEETS
HAWAII	HAW.	450A-01-12M	2014	32	38

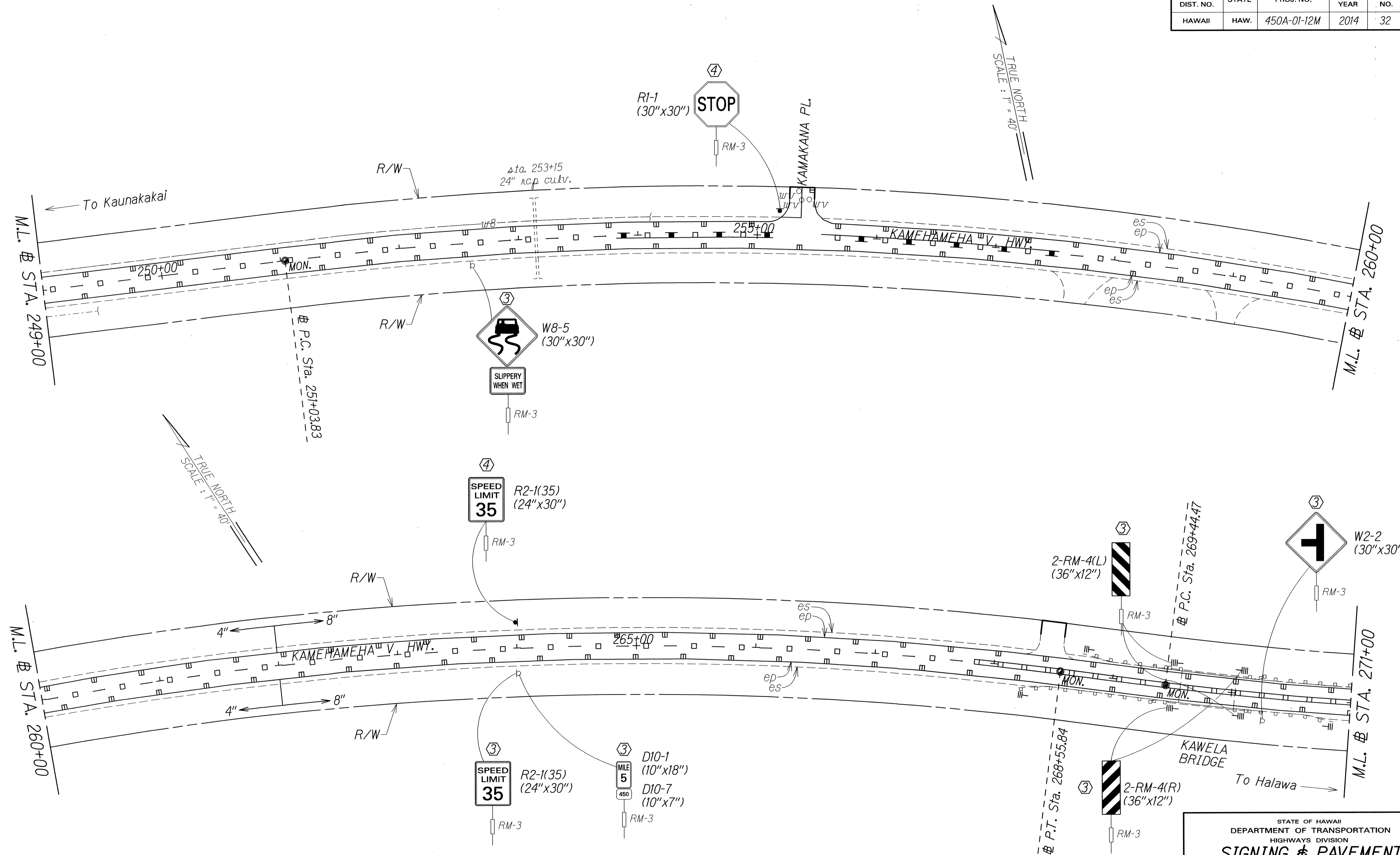

SURVEY PLOTTED BY: DATE: APRIL 1992
 DRAWN BY: J. GUERZANO
 TRACED BY: C. BRADSHAW
 QUANTITIES BY: J. GUERZANO
 CHECKED BY: J. GUERZANO

- KEY:**
- ① Exist. Sign(s) & Post(s) to Remain
 - ② Remove Exist. Sign(s) & Post(s)
 - ③ Remove Exist. & Install New Sign(s) & Post(s)
 - ④ Install New Sign(s) & Post(s)

STATE OF HAWAII
 DEPARTMENT OF TRANSPORTATION
 HIGHWAYS DIVISION
SIGNING & PAVEMENT MARKING PLAN
 KAMEHAMEHA V HIGHWAY RESURFACING
 Kaunakakai to Kamiloloa Bridge and
 Vicinity of Makakupaia Bridge to Kapuokoolau
 Project No. 450A-01-12M
 Scale: 1" = 40' Date: January, 2014

FED. ROAD DIST. NO.	STATE	PROJ. NO.	FISCAL YEAR	SHEET NO.	TOTAL SHEETS
HAWAII	HAW.	450A-01-12M	2014	33	38

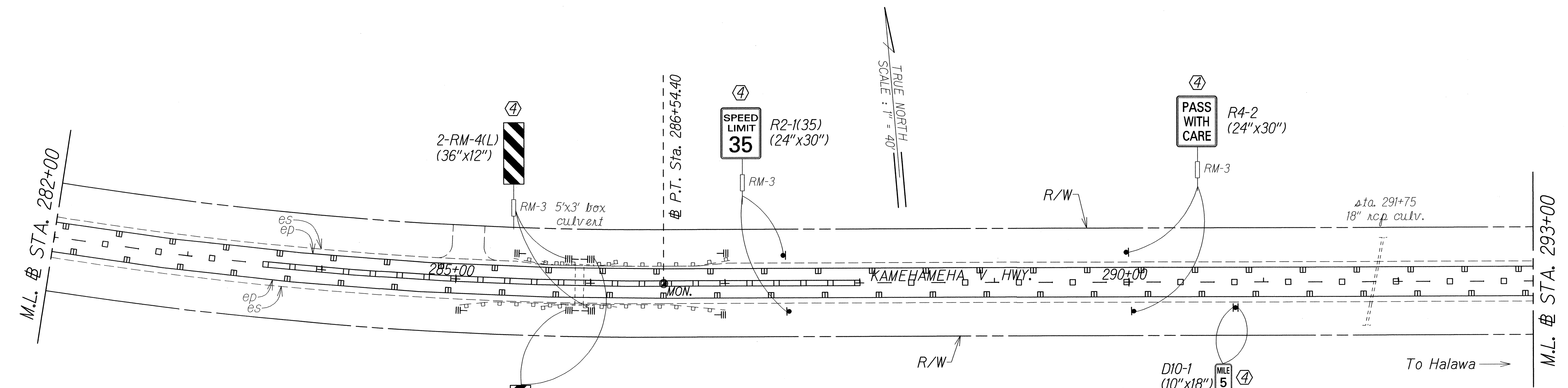
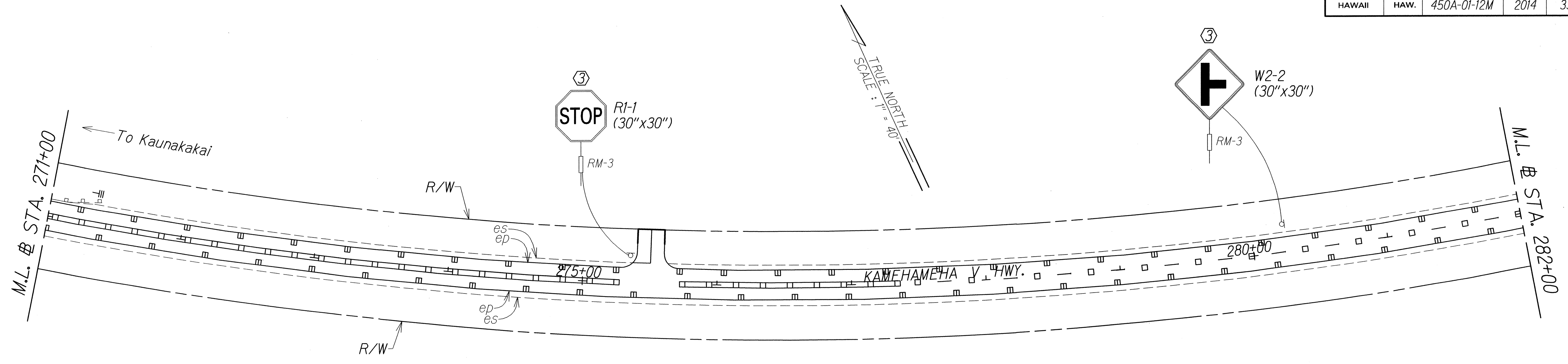

DESIGNED BY	DATE
TRACED BY	APRIL 1995
DESIGNED BY	
QUANTITIES BY	
CHECKED BY	

- KEY:**
- ① Exist. Sign(s) & Post(s) to Remain
 - ② Remove Exist. Sign(s) & Post(s)
 - ③ Remove Exist. & Install New Sign(s) & Post(s)
 - ④ Install New Sign(s) & Post(s)

STATE OF HAWAII
DEPARTMENT OF TRANSPORTATION
HIGHWAYS DIVISION

**SIGNING & PAVEMENT
MARKING PLAN**

KAMEHAMEHA V HIGHWAY RESURFACING
Kaunakakai to Kamiloloa Bridge and
Vicinity of Makakupaia Bridge to Kapuokoolau
Project No. 450A-01-12M
Scale: 1" = 40' Date: January, 2014

SHEET No. 9 OF 14 SHEETS

FED. ROAD DIST. NO.	STATE	PROJ. NO.	FISCAL YEAR	SHEET NO.	TOTAL SHEETS
HAWAII	HAW.	450A-01-12M	2014	34	38

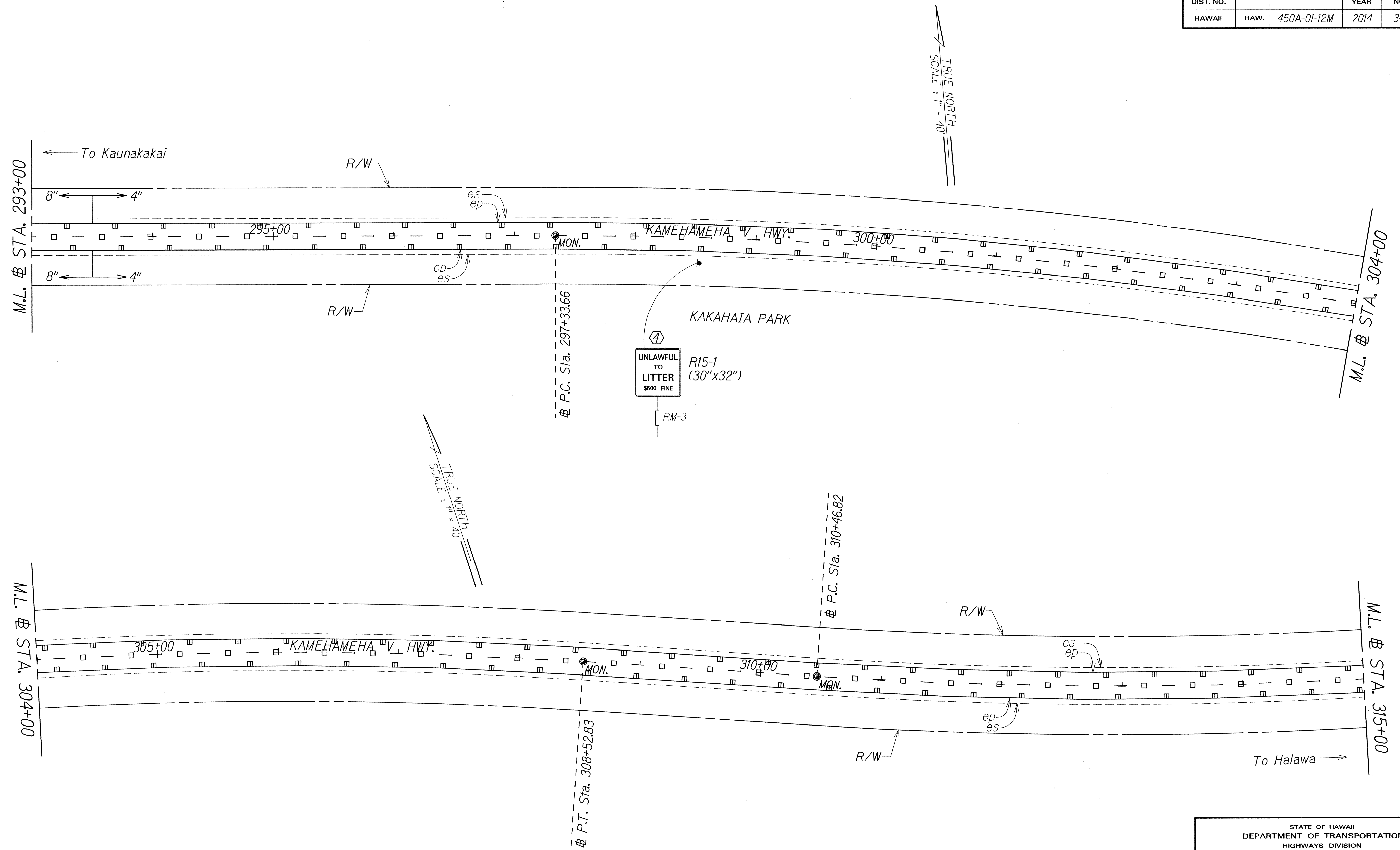

ORIGINAL PLAN	DATE
DESIGNED BY	APRIL 1993
TRACED BY	
DESIGNED BY	
QUANTITIES BY	
CHECKED BY	

- KEY:
- ① Exist. Sign(s) & Post(s) to Remain
 - ② Remove Exist. Sign(s) & Post(s)
 - ③ Remove Exist. & Install New Sign(s) & Post(s)
 - ④ Install New Sign(s) & Post(s)

STATE OF HAWAII
DEPARTMENT OF TRANSPORTATION
HIGHWAYS DIVISION

**SIGNING & PAVEMENT
MARKING PLAN**

KAMEHAMEHA V HIGHWAY RESURFACING
Kaunakakai to Kamiloloa Bridge and
Vicinity of Makakupaia Bridge to Kapuokoolau
Project No. 450A-01-12M
Scale: 1" = 40' Date: January, 2014

SHEET No. 10 OF 14 SHEETS

FED. ROAD DIST. NO.	STATE	PROJ. NO.	FISCAL YEAR	SHEET NO.	TOTAL SHEETS
HAWAII	HAW.	450A-01-12M	2014	35	38

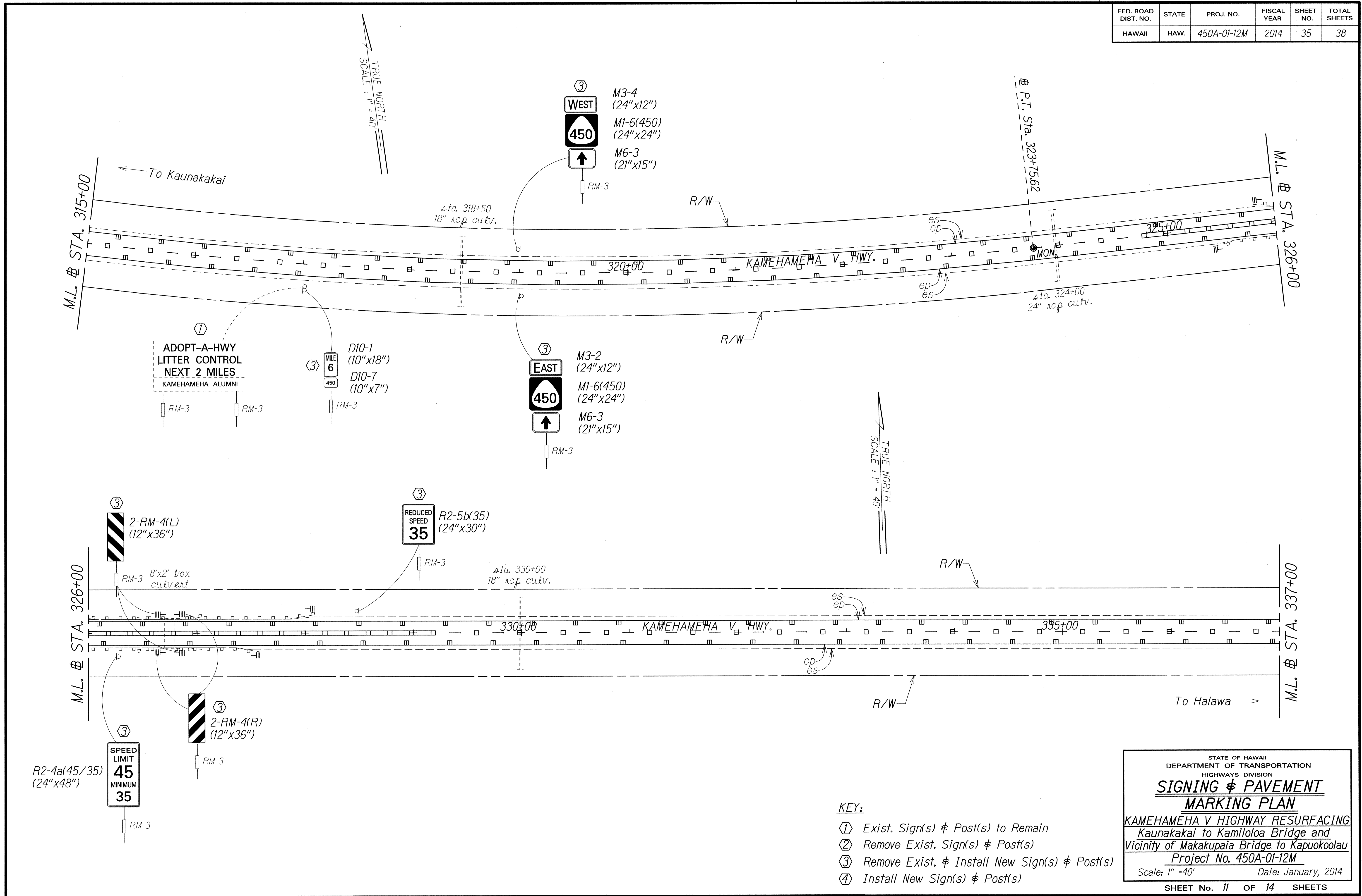

ORIGINAL PLAN	DATE
DESIGNED BY	DATE
DESIGNED BY	DATE
QUANTITIES BY	DATE
CHECKED BY	DATE

- KEY:**
- ① Exist. Sign(s) & Post(s) to Remain
 - ② Remove Exist. Sign(s) & Post(s)
 - ③ Remove Exist. & Install New Sign(s) & Post(s)
 - ④ Install New Sign(s) & Post(s)

STATE OF HAWAII
DEPARTMENT OF TRANSPORTATION
HIGHWAYS DIVISION

**SIGNING & PAVEMENT
MARKING PLAN**

KAMEHAMEHA V HIGHWAY RESURFACING
Kaunakakai to Kamiloloa Bridge and
Vicinity of Makakupaia Bridge to Kapuokoolau
Project No. 450A-01-12M

Scale: 1" = 40' Date: January, 2014

SHEET No. 11 OF 14 SHEETS

FED. ROAD DIST. NO.	STATE	PROJ. NO.	FISCAL YEAR	SHEET NO.	TOTAL SHEETS
HAWAII	HAW.	450A-01-12M	2014	36	38

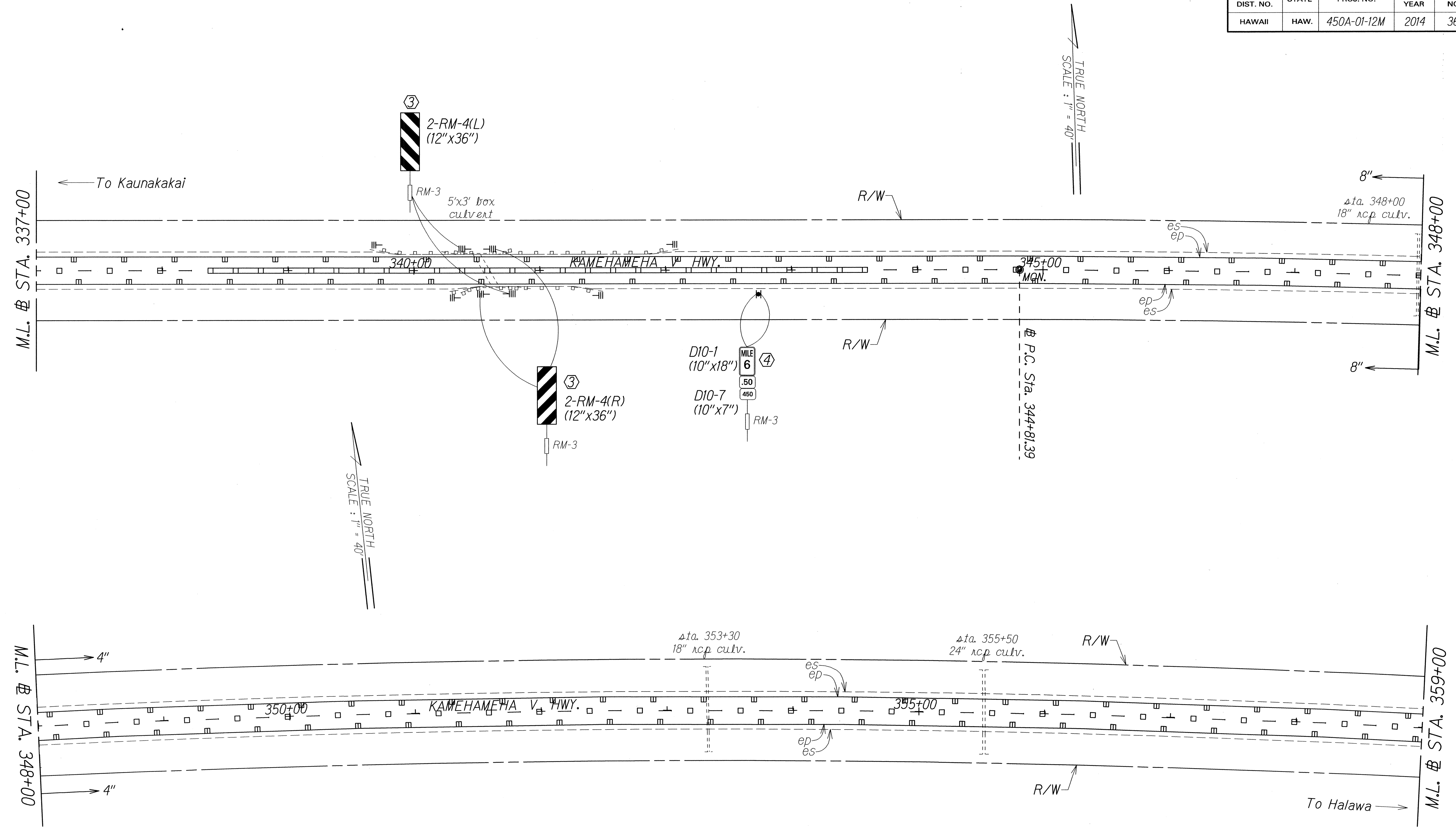

ORIGINAL PLAN	DATE
SURVEY PLOTTED BY	April 1993
DRAWN BY	J. Guerrero
DESIGNED BY	C. Fongosa
QUANTITIES BY	
CHECKED BY	

- KEY:**
- ① Exist. Sign(s) & Post(s) to Remain
 - ② Remove Exist. Sign(s) & Post(s)
 - ③ Remove Exist. & Install New Sign(s) & Post(s)
 - ④ Install New Sign(s) & Post(s)

STATE OF HAWAII
DEPARTMENT OF TRANSPORTATION
HIGHWAYS DIVISION

**SIGNING & PAVEMENT
MARKING PLAN**

KAMEHAMEHA V HIGHWAY RESURFACING
Kaunakakai to Kamiloloa Bridge and
Vicinity of Makapuaia Bridge to Kapuokoolau
Project No. 450A-01-12M
Scale: 1" = 40' Date: January, 2014

SHEET No. 12 OF 14 SHEETS

FED. ROAD DIST. NO.	STATE	PROJ. NO.	FISCAL YEAR	SHEET NO.	TOTAL SHEETS
HAWAII	HAW.	450A-01-12M	2014	37	38

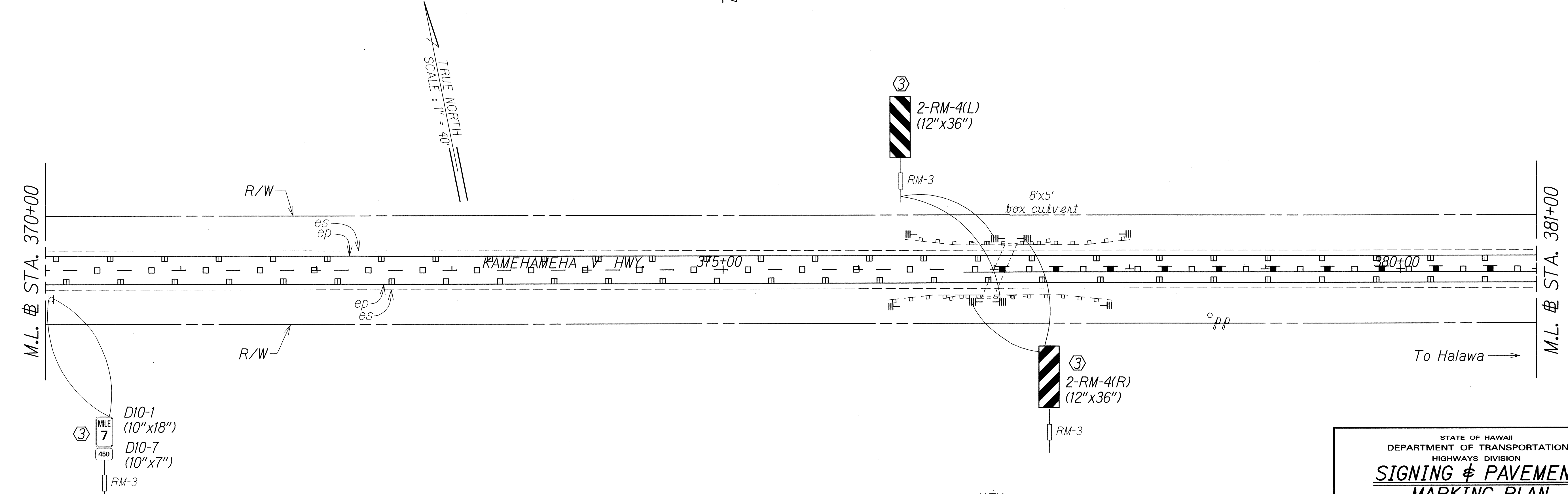
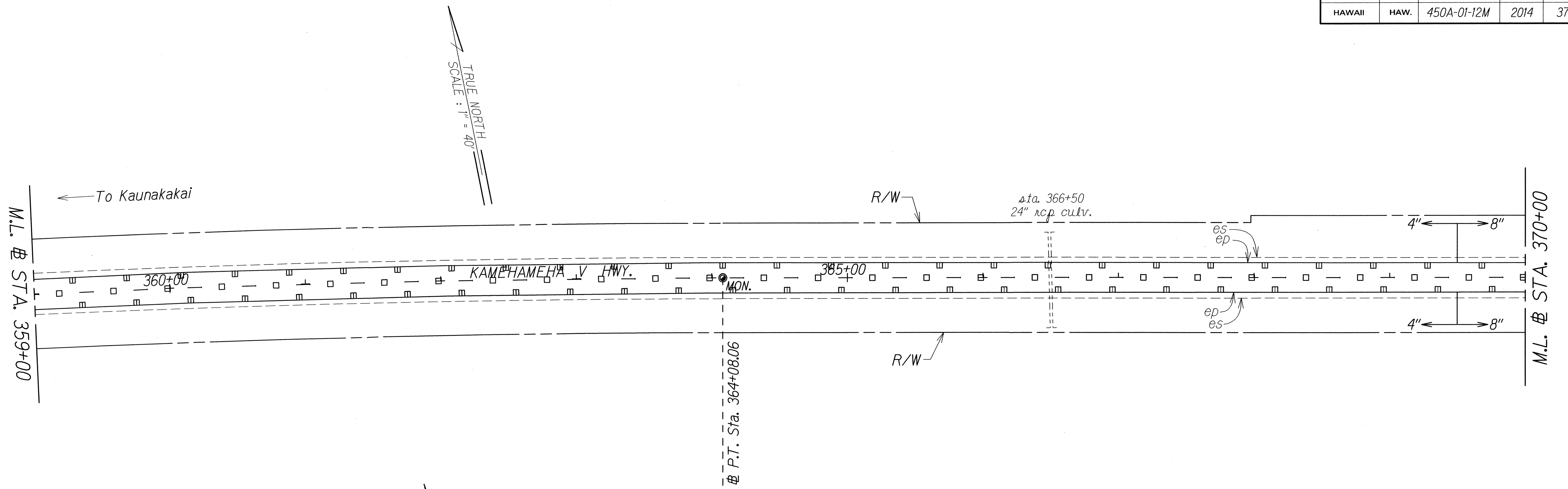

ORIGINAL PLAN	SURVEY PLOTTED BY	DATE
NOTE BOOK	DRAWN BY J. Guerrero	April, 1992
DESIGNED BY C. Robinson	TRACED BY	
CHECKED BY		

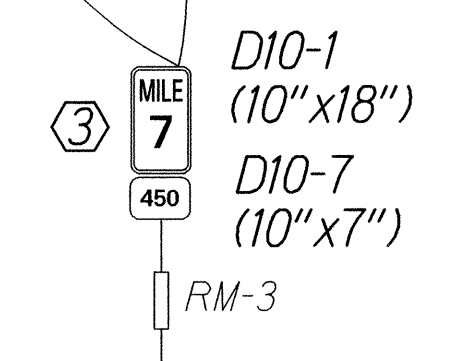

- KEY:**
- ① Exist. Sign(s) & Post(s) to Remain
 - ② Remove Exist. Sign(s) & Post(s)
 - ③ Remove Exist. & Install New Sign(s) & Post(s)
 - ④ Install New Sign(s) & Post(s)

STATE OF HAWAII
DEPARTMENT OF TRANSPORTATION
HIGHWAYS DIVISION

**SIGNING & PAVEMENT
MARKING PLAN**

KAMEHAMEHA V HIGHWAY RESURFACING
Kaunakakai to Kamiloloa Bridge and
Vicinity of Makakupaia Bridge to Kapuokoolau
Project No. 450A-01-12M

Scale: 1" = 40' Date: January, 2014

SHEET No. 13 OF 14 SHEETS

FED. ROAD DIST. NO.	STATE	PROJ. NO.	FISCAL YEAR	SHEET NO.	TOTAL SHEETS
HAWAII	HAW.	450A-01-12M	2014	38	38

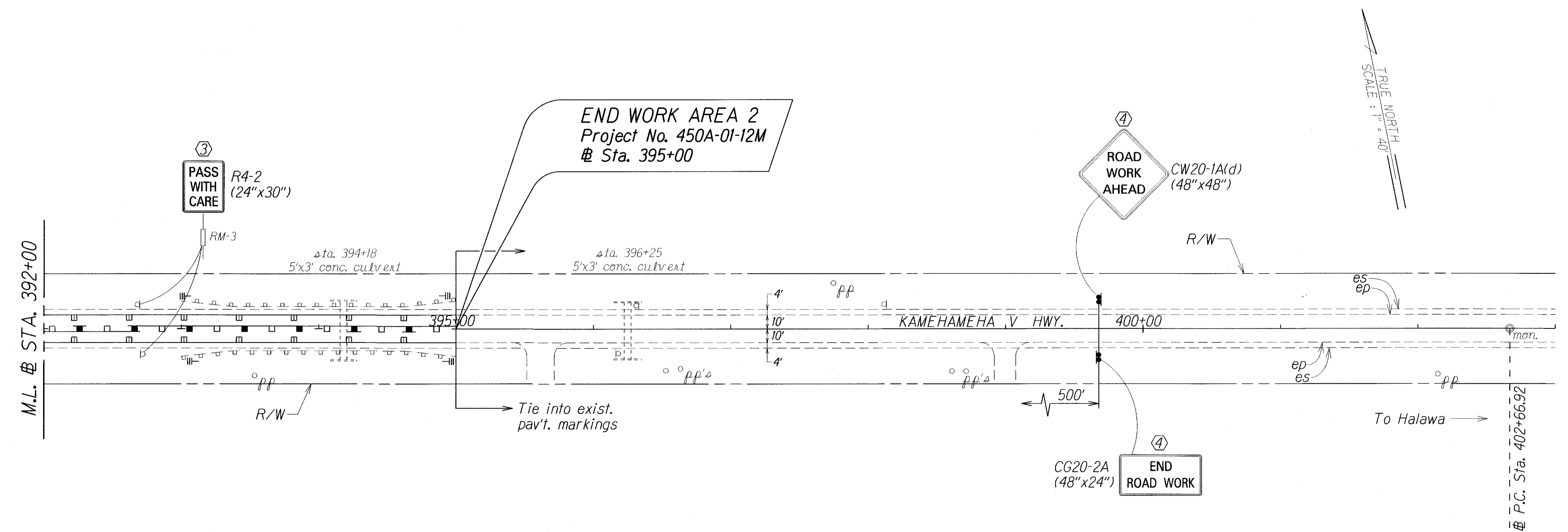
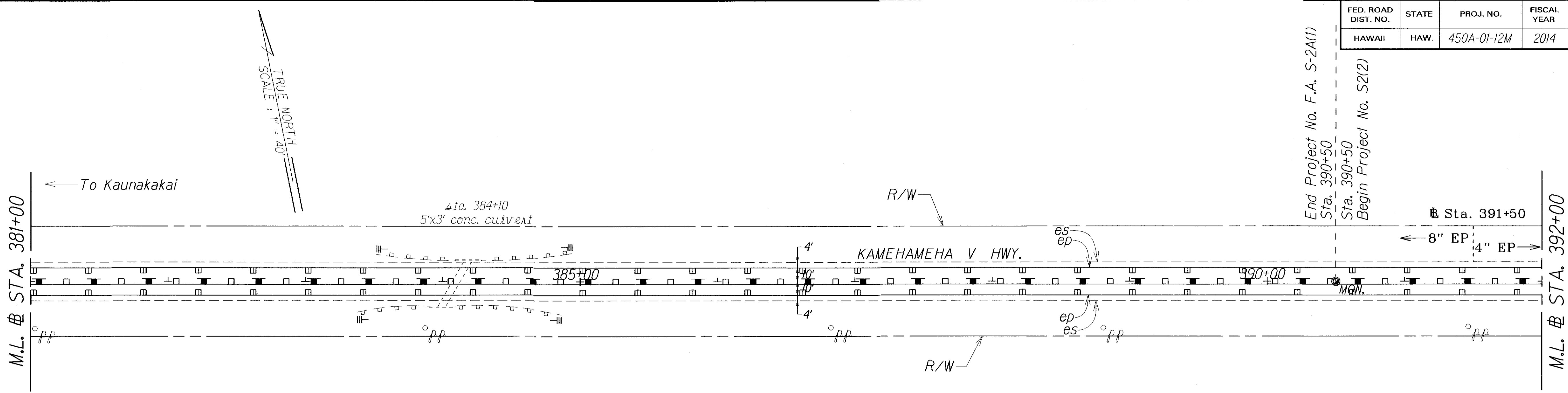

ORIGINAL PLAN	DATE
SURVEY PLOTTED BY	
DRAWN BY	
DESIGNED BY	
QUANTITIES BY	
CHECKED BY	

LEGEND FOR AS-BUILT POSTINGS	
	Squiggly line for as-built deletion
	Double line for as-built deletion
Roadway	Text for as-built posting

- KEY:
- ① Exist. Sign(s) & Post(s) to Remain
 - ② Remove Exist. Sign(s) & Post(s)
 - ③ Remove Exist. & Install New Sign(s) & Post(s)
 - ④ Install New Sign(s) & Post(s)

STATE OF HAWAII
DEPARTMENT OF TRANSPORTATION
HIGHWAYS DIVISION

**SIGNING & PAVEMENT
MARKING PLAN**

KAMEHAMEHA V HIGHWAY RESURFACING
Kaunakakai to Kamiloloa Bridge and
Vicinity of Makakupaia Bridge to Kapuokoolau
Project No. 450A-01-12M

Scale: 1" = 40' Date: January, 2014

SHEET No. 14 OF 14 SHEETS

"AS-BUILT"