

FED. ROAD DIST. NO.	STATE	FED. AID PROJ. NO.	FISCAL YEAR	SHEET NO.	TOTAL SHEETS
HAWAII	HAW.	BR-0450(8)	2011	ADD. 48	93

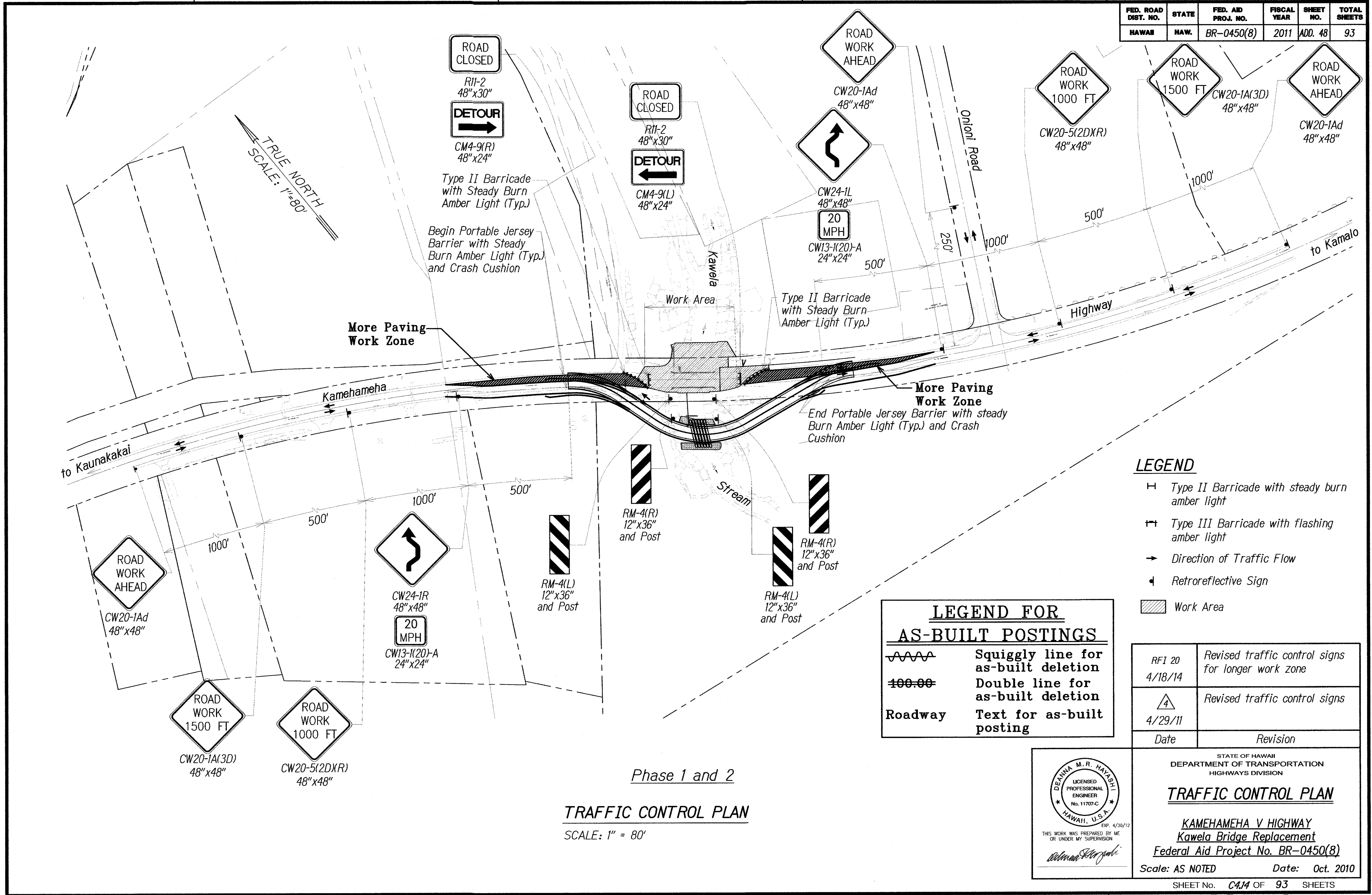

FED. ROAD DIST. NO.	STATE	FED. AID PROJ. NO.	FISCAL YEAR	SHEET NO.	TOTAL SHEETS
HAWAII	HAW.	BR-0450(8)	2011	ADD. 48 S-1	93

Traffic Control Plan Notes:

- Any requests for adjustments to the Traffic Control Plans shall be submitted in writing and approved by the Engineer. The Contractor's attention is directed to Subsection 108.08 - Liquidated Damages for Failure to Complete the Work or Portions of the Work on Time of the Special Provisions.
- Relocation and/or removal of temporary signs, posts and portable concrete barriers used for Traffic Control shall be considered incidental to their respective contract items.
- All temporary signs and delineators for the purposes of Traffic Control shall become the property of the Contractor at the completion of the project.
- The Contractor shall use ground anchorage steel pins for Portable Concrete Barriers.
- Portable concrete barrier panels not in use during construction work shall not be stockpiled or otherwise stored within the highway rights-of-way except at locations approved by the Engineer.
- The location of pavement markings and signs, delineators and portable concrete guardrail panels used in Traffic Control Plans shall be as shown on the plans and/or as determined in the field by the Engineer.
- The Contractor shall periodically wash down signs, delineators and portable concrete barriers called for in the Traffic Control Plans deemed necessary by the Engineer. This work shall be considered incidental to the various contract items and no payment will be made therefore.
- Damage to signs, temporary pavement markers, delineators, barricades, sand barrels, lamps and portable concrete barriers caused by the public shall be repaired or replaced by the Contractor as soon as possible or as directed by the Engineer. This work shall be paid for under Item No. 645.0200 Police Officers and/or Additional Traffic Control Devices. Damage caused due to the Contractor's action shall be repaired or replaced at the Contractor's expense.
- Work required in the Traffic Control Plans will be paid under applicable contract items or as otherwise specified herein.
- All other traffic control work shall be in accordance with Section 645 - Traffic Control Work required for lane closures during the working day will not be paid for but shall be considered incidental to various contract items. Advance Construction Warning Signs as required under Section 645 of the Special Provisions shall be installed on all approaches to construction areas including on-ramps. This work shall be considered incidental to the various contract items.
- The Type II Barricades with steady burn amber lamp used during Traffic Control shall be considered incidental to the various contract items.
- This Work Zone Sign Plan is intended for use on long-term stationary work zones/construction phases (3 days or more). All work zones or construction phases less than 3 days duration will use Traffic Control Plans shown in Section 645 of the Special Provisions.
- All existing regulatory speed limit signs with posts within the work zone/project limits shall be removed and replaced with work zone speed limit sign assemblies (R2-I(20) and CW3-5(20) with "CONSTRUCTION AREA" and "\$250 FINE HRS 291C-104" Supplemental Signs).
- Construction sign assemblies shall be installed on both the approaching and trailing ends of each work zone as shown on this plan.
- Each construction warning sign shall have a minimum of two (2) Type II OM. Each work zone speed limit assembly shall have a minimum of one (1) Type II OM. Installation of each Type II OM shall be considered incidental to Item No. 621.7100, Construction Signs and Posts.
- Upon the completion of all physical work or as directed by the Engineer, all construction signs and work zone speed limit assemblies shall be removed. All speed limit signs and posts that were existing at the start of the project within the work zone/project limits shall be restored back to their original locations and configurations.
- Placement of construction signs shall not obstruct the path of pedestrians and bicyclists.
- The removal and restoration of existing regulatory speed limit signs with new posts along with the installation, maintenance and removal of work zone speed limit sign assemblies shall be considered incidental to Item No. 621.7100, Construction Sign with Posts.
- Project limits are from Kam. V Highway Baseline Sta. 266+30 to 273+80.

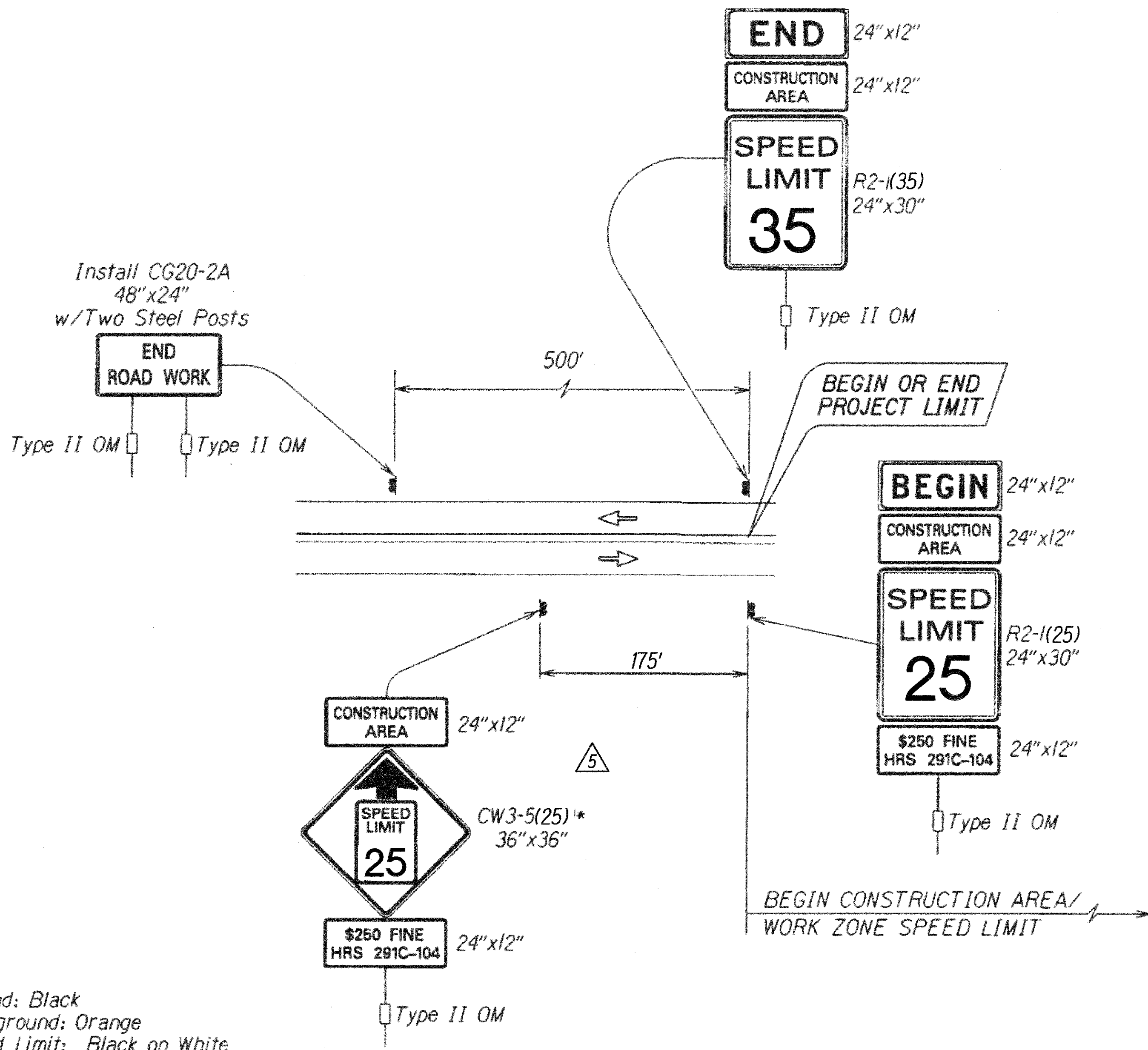

TYPICAL DETAIL FOR CONSTRUCTION SIGNS
ON TWO LANE OR MULTILANE UNDIVIDED LOW SPEED HIGHWAY

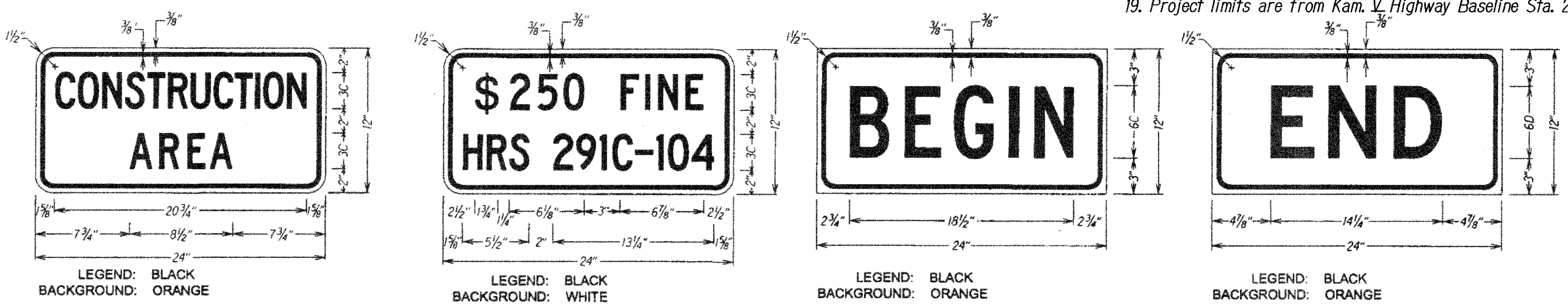

5/03/12	Revised speed limit
4/29/11	New sheet
Date	Revision
STATE OF HAWAII DEPARTMENT OF TRANSPORTATION HIGHWAYS DIVISION	
TRAFFIC CONTROL PLAN	
KAMEHAMEHA V HIGHWAY Kawela Bridge Replacement Federal Aid Project No. BR-0450(8)	
Scale: AS NOTED	Date: Oct. 2010
SHEET No. C414 OF 93 SHEETS	

