

LEGEND:

- COLD MILL AC PAVEMENT (3" DEPTH) (02101)
- COLD MILL AC PAVEMENT (4" DEPTH) (02101)
- MARKING TO BE OBLITERATED (02620)
- BORING LOCATION
- B-XX BORING LOG NUMBER
- AIRFIELD SIGNAGE
- EDGE LIGHT

NOTES:

- CONTRACTOR SHALL LOCATE AND PROTECT ALL UTILITIES, STRUCTURES, AND PAVED AREAS TO REMAIN. SAWCUTTING SHALL BE CAREFULLY CONTROLLED TO PREVENT DAMAGE TO ADJACENT PAVEMENT, THE UNDERLAYING MATERIAL, OR EXISTING STRUCTURES TO REMAIN IN PLACE. ANY DAMAGE TO UTILITIES AND PAVED AREAS SHALL BE RESTORED / REPAIRED TO PRE-CONSTRUCTION CONDITIONS AT THE CONTRACTOR'S EXPENSE.
- CONTRACTOR SHALL SAW CUT PAVEMENT ALONG MILLING WORK LIMITS.
- FOLLOWING MILL OPERATION, RPR SHALL DETERMINE IF MILL DEPTH IS SUFFICIENT AND CONDITION OF MILLED SURFACE IS SATISFACTORY. CONTRACTOR SHALL MILL ADDITIONAL DEPTH AS DIRECTED BY RPR.
- CLEANUP OF WASTE MATERIAL SHALL BE CONTINUOUS DURING THE SAWCUTTING OPERATION AND ALL OTHER DEMOLITION ACTIVITIES. CLEANUP SHALL USE A VACUUM SWEEPER.
- ASPHALT MILLINGS SHALL BE HAULED OFF SITE.
- REFER TO PHASING PLANS FOR HAUL ROUTES AND STAGING AREAS.
- CONTRACTOR AND RPR SHALL INSPECT EXISTING CRACKS WITHIN ASPHALT PAVEMENT AREAS NOT AFFECTED BY PAVING WORK. EXISTING CRACKS TO BE SAWCUT TO TOLERANCES NOTED IN SECTION 02101.

50' 0 50' 100'
SCALE: 1" = 50'-0"



Airports Division
DEPARTMENT OF TRANSPORTATION
STATE OF HAWAII



I HEREBY CERTIFY THAT THIS
WORK WAS PREPARED BY ME
OR UNDER MY SUPERVISION

Signature: Shannon Rachel Holman
4/30/24
Expiration Date

DSGN.	DRWN.	CHKD.	APPD.
TR	NM	AC	SH

KEY PLAN / NOTES:

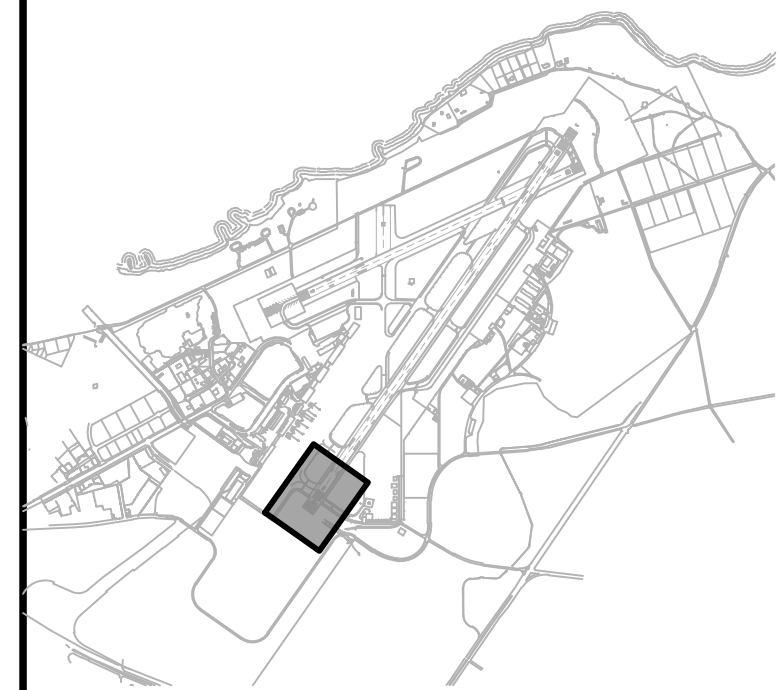

NO.	DATE	REVISIONS
-----	------	-----------

CONSTRUCTION
DOCUMENTS

JULY 11, 2022
DATE

PROJECT TITLE :

RESURFACE RUNWAY 2-20

AT
KAHULUI AIRPORT
KAHULUI, MAUI, HAWAII

PROJECT NO.:

AM1022-21

SHEET TITLE:

CIVIL DEMOLITION
PLAN 1

DATE :
07/11/2022
SHEET :
19 OF 46 SHEETS

DWG. NO.

C-201

C:\USERS\DDABU\ORION ENGINEERS & ASSOCIATES\PROJECTS\AM1022-21\INTERIM ENGINEERING\05_DRAWING\AM1022-21-05-DEM-CIVIL-INTRM.DWG

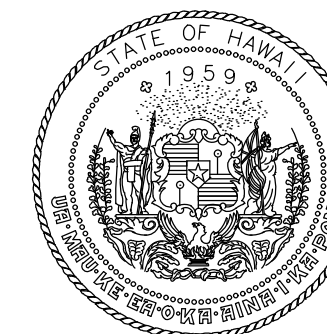
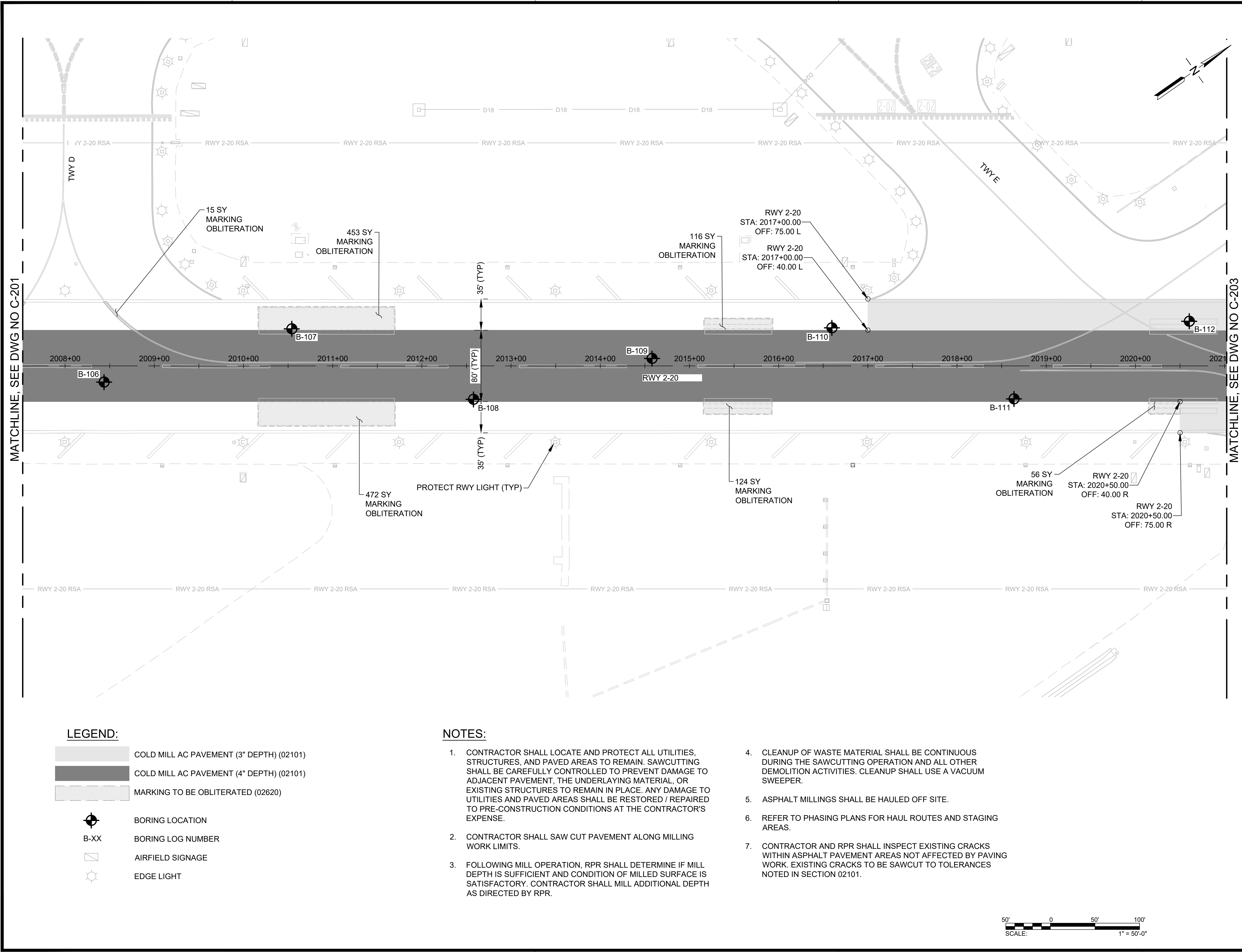

Airports Division
DEPARTMENT OF TRANSPORTATION
STATE OF HAWAII



I HEREBY CERTIFY THAT THIS
WORK WAS PREPARED BY ME
OR UNDER MY SUPERVISION

Signature: Shannon Rachel Holman
4/30/24
Expiration Date

DSGN.	DRWN.	CHKD.	APPD.
TR	NM	AC	SH

KEY PLAN / NOTES:

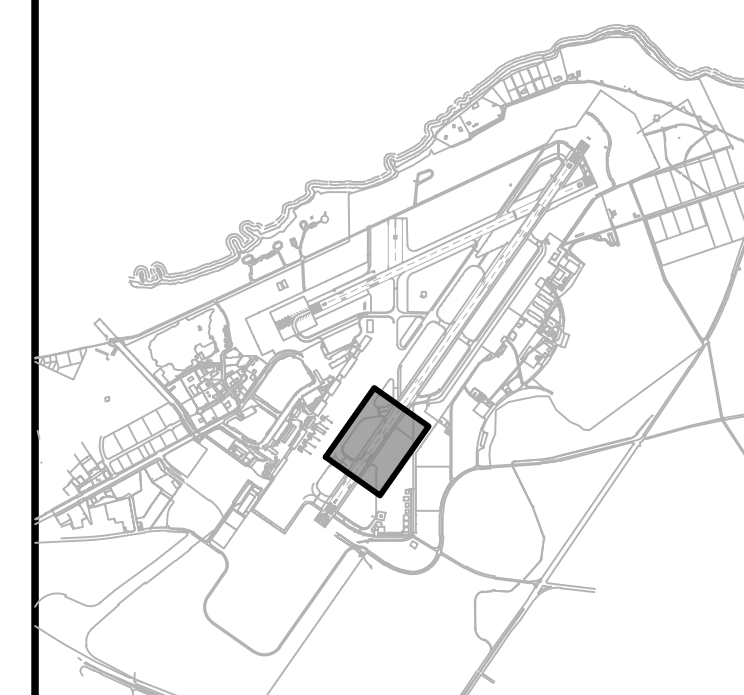

NO.	DATE	REVISIONS
-----	------	-----------

CONSTRUCTION DOCUMENTS

JULY 11, 2022
DATE

PROJECT TITLE :

RESURFACE RUNWAY 2-20

AT
KAHULUI AIRPORT
KAHULUI, MAUI, HAWAII

PROJECT NO.:

AM1022-21

SHEET TITLE:

CIVIL DEMOLITION
PLAN 2

DATE :

07/11/2022

SHEET :

20 OF 46 SHEETS

DWG. NO.

C-202

C:\USERS\DDABU\ORION ENGINEERS & ASSOCIATES\PROJECTS\1022-21\INTERIM ENGINEERING\1022-21-00-DEMCONTRM.DWG

MATCHLINE, SEE DWG NO C-202

MATCHLINE, SEE DWG NO C-204

LEGEND:

- COLD MILL AC PAVEMENT (3" DEPTH) (02101)
- COLD MILL AC PAVEMENT (4" DEPTH) (02101)
- MARKING TO BE OBLITERATED (02620)



BORING LOCATION

B-XX

BORING LOG NUMBER



AIRFIELD SIGNAGE



EDGE LIGHT

NOTES:

- CONTRACTOR SHALL LOCATE AND PROTECT ALL UTILITIES, STRUCTURES, AND PAVED AREAS TO REMAIN. SAWCUTTING SHALL BE CAREFULLY CONTROLLED TO PREVENT DAMAGE TO ADJACENT PAVEMENT, THE UNDERLYING MATERIAL, OR EXISTING STRUCTURES TO REMAIN IN PLACE. ANY DAMAGE TO UTILITIES AND PAVED AREAS SHALL BE RESTORED / REPAIRED TO PRE-CONSTRUCTION CONDITIONS AT THE CONTRACTOR'S EXPENSE.
- CONTRACTOR SHALL SAW CUT PAVEMENT ALONG MILLING WORK LIMITS.
- FOLLOWING MILL OPERATION, RPR SHALL DETERMINE IF MILL DEPTH IS SUFFICIENT AND CONDITION OF MILLED SURFACE IS SATISFACTORY. CONTRACTOR SHALL MILL ADDITIONAL DEPTH AS DIRECTED BY RPR.
- CLEANUP OF WASTE MATERIAL SHALL BE CONTINUOUS DURING THE SAWCUTTING OPERATION AND ALL OTHER DEMOLITION ACTIVITIES. CLEANUP SHALL USE A VACUUM SWEEPER.
- ASPHALT MILLINGS SHALL BE HAULED OFF SITE.
- REFER TO PHASING PLANS FOR HAUL ROUTES AND STAGING AREAS.
- CONTRACTOR AND RPR SHALL INSPECT EXISTING CRACKS WITHIN ASPHALT PAVEMENT AREAS NOT AFFECTED BY PAVING WORK. EXISTING CRACKS TO BE SAWCUT TO TOLERANCES NOTED IN SECTION 02101.

50' 0 50' 100'
SCALE: 1" = 50'-0"

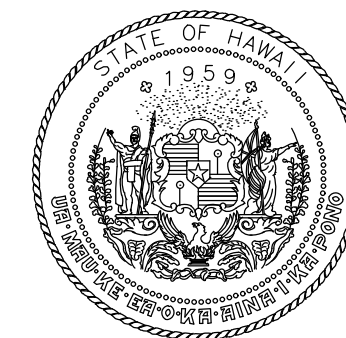

Airports Division
DEPARTMENT OF TRANSPORTATION
STATE OF HAWAII



I HEREBY CERTIFY THAT THIS
WORK WAS PREPARED BY ME
OR UNDER MY SUPERVISION

Signature: Shannon Rachel Holman
Expiration Date: 4/30/24

DSGN.	DRWN.	CHKD.	APPD.
TR	NM	AC	SH

KEY PLAN / NOTES:

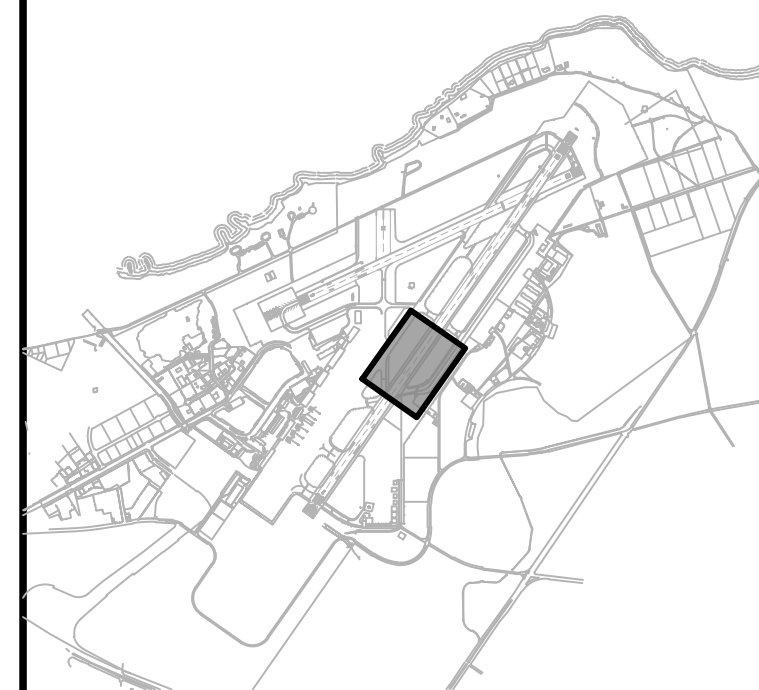

NO.	DATE	REVISIONS
-----	------	-----------

CONSTRUCTION
DOCUMENTS

JULY 11, 2022
DATE

PROJECT TITLE :

RESURFACE RUNWAY 2-20

AT
KAHULUI AIRPORT
KAHULUI, MAUI, HAWAII

PROJECT NO.:

AM1022-21

SHEET TITLE:

CIVIL DEMOLITION
PLAN 3

DATE :	DWG. NO.
07/11/2022	C-203
SHEET :	
21 OF 46 SHEETS	

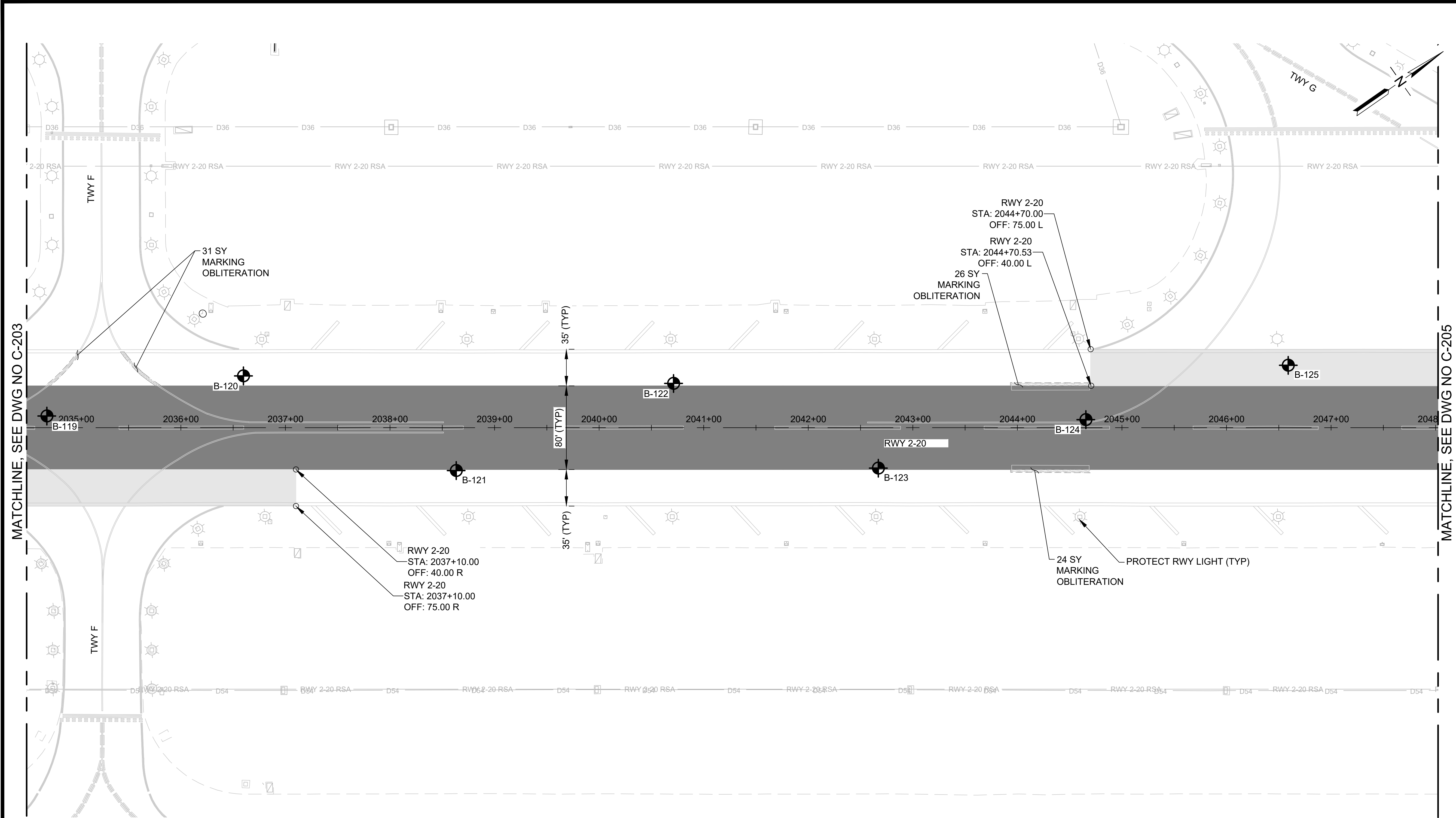

MATCHLINE, SEE DWG NO C-203

MATCHLINE, SEE DWG NO C-205

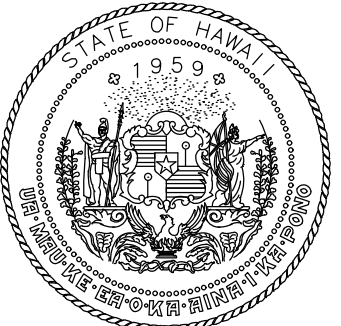

Airports Division
DEPARTMENT OF TRANSPORTATION
STATE OF HAWAII



I HEREBY CERTIFY THAT THIS
WORK WAS PREPARED BY ME
OR UNDER MY SUPERVISION

Signature: Shanon Rachel Holman
4/30/24
Expiration Date

DSGN.	DRWN.	CHKD.	APPD.
TR	NM	AC	SH

KEY PLAN / NOTES:

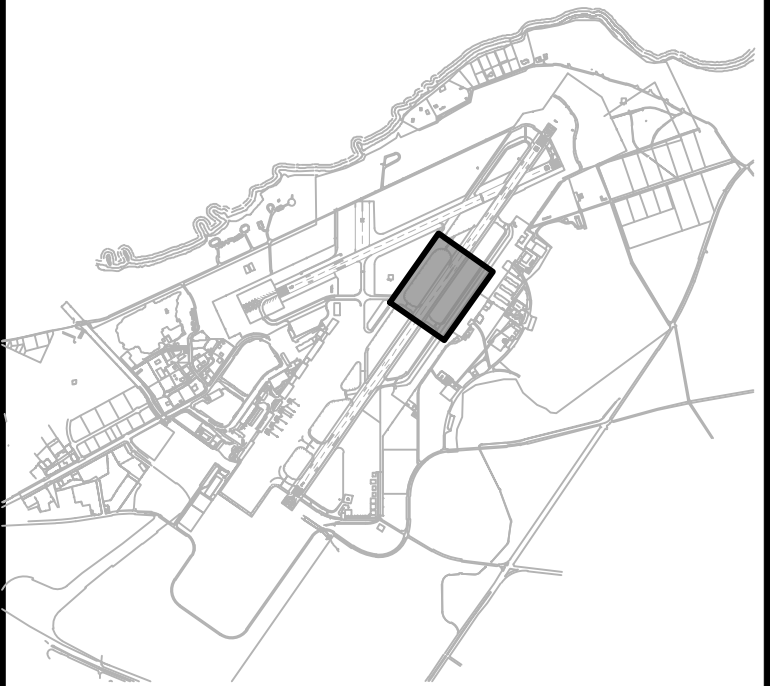

NO.	DATE	REVISIONS
-----	------	-----------

CONSTRUCTION
DOCUMENTS

JULY 11, 2022
DATE

PROJECT TITLE :

RESURFACE RUNWAY 2-20

AT
KAHULUI AIRPORT
KAHULUI, MAUI, HAWAII

PROJECT NO.:

AM1022-21

SHEET TITLE:

CIVIL DEMOLITION
PLAN 4

DATE :
07/11/2022

SHEET :

22 OF 46 SHEETS

DWG. NO.

C-204

C:\USERS\DDABU\ORION ENGINEERS & ASSOCIATES\PROJECTS\1022-20-RESURF-4\1022-20-RESURF-4-DEMCONTRM.DWG

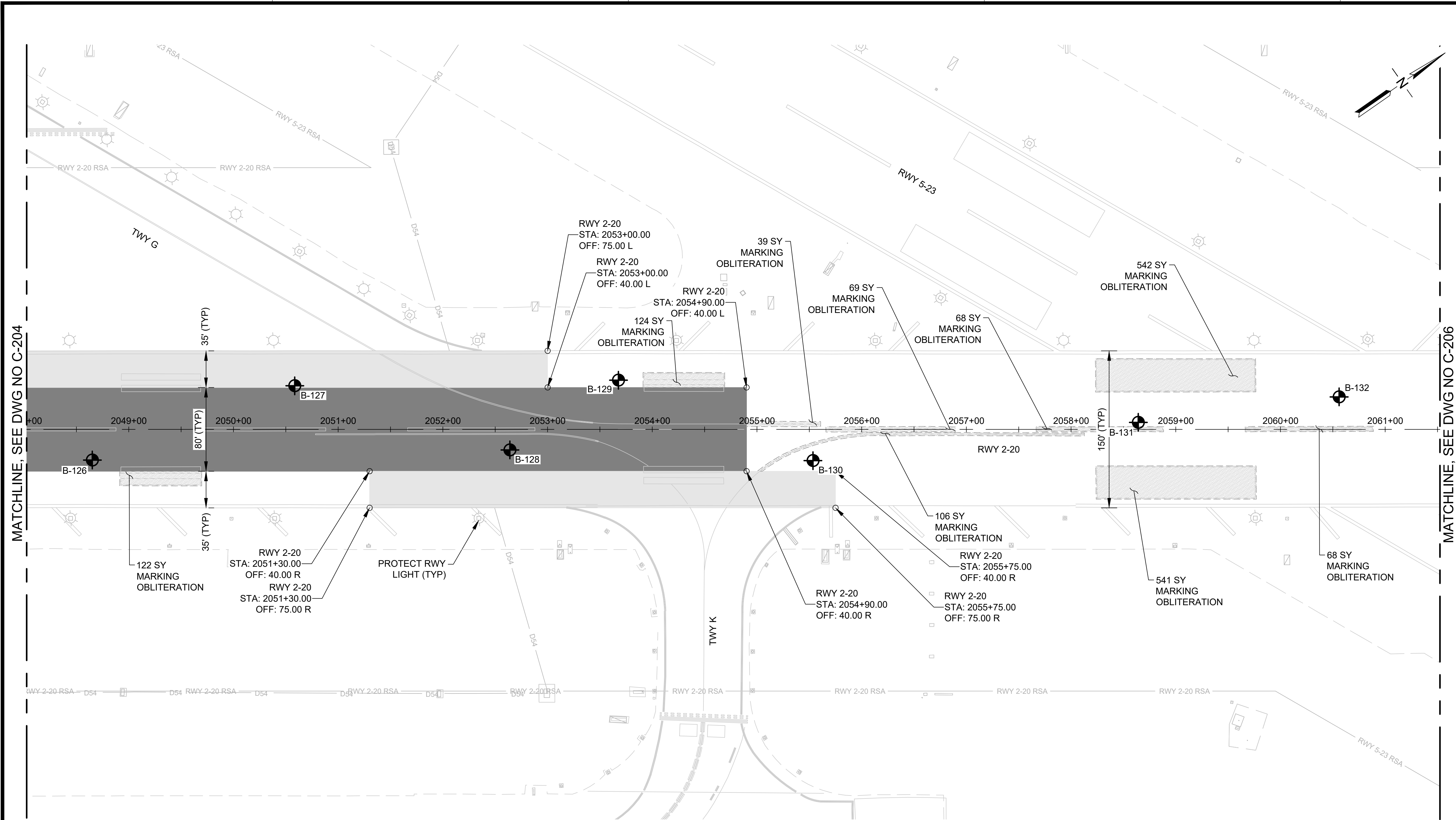

LEGEND:

- COLD MILL AC PAVEMENT (3" DEPTH) (02101)
- COLD MILL AC PAVEMENT (4" DEPTH) (02101)
- MARKING TO BE OBLITERATED (02620)

- BORING LOCATION
- B-XX BORING LOG NUMBER
- AIRFIELD SIGNAGE
- EDGE LIGHT

NOTES:

- CONTRACTOR SHALL LOCATE AND PROTECT ALL UTILITIES, STRUCTURES, AND PAVED AREAS TO REMAIN. SAWCUTTING SHALL BE CAREFULLY CONTROLLED TO PREVENT DAMAGE TO ADJACENT PAVEMENT, THE UNDERLAYING MATERIAL, OR EXISTING STRUCTURES TO REMAIN IN PLACE. ANY DAMAGE TO UTILITIES AND PAVED AREAS SHALL BE RESTORED / REPAIRED TO PRE-CONSTRUCTION CONDITIONS AT THE CONTRACTOR'S EXPENSE.
- CONTRACTOR SHALL SAW CUT PAVEMENT ALONG MILLING WORK LIMITS.
- FOLLOWING MILL OPERATION, RPR SHALL DETERMINE IF MILL DEPTH IS SUFFICIENT AND CONDITION OF MILLED SURFACE IS SATISFACTORY. CONTRACTOR SHALL MILL ADDITIONAL DEPTH AS DIRECTED BY RPR.
- CLEANUP OF WASTE MATERIAL SHALL BE CONTINUOUS DURING THE SAWCUTTING OPERATION AND ALL OTHER DEMOLITION ACTIVITIES. CLEANUP SHALL USE A VACUUM SWEEPER.
- ASPHALT MILLINGS SHALL BE HAULED OFF SITE.
- REFER TO PHASING PLANS FOR HAUL ROUTES AND STAGING AREAS.
- CONTRACTOR AND RPR SHALL INSPECT EXISTING CRACKS WITHIN ASPHALT PAVEMENT AREAS NOT AFFECTED BY PAVING WORK. EXISTING CRACKS TO BE SAWCUT TO TOLERANCES NOTED IN SECTION 02101.

50' 0 50' 100'
SCALE: 1" = 50'-0"

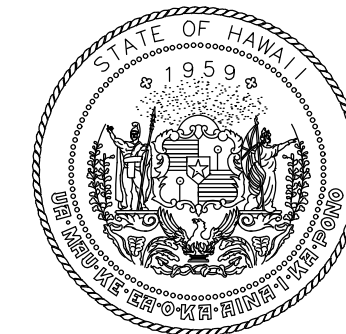

Airports Division
DEPARTMENT OF TRANSPORTATION
STATE OF HAWAII



I HEREBY CERTIFY THAT THIS
WORK WAS PREPARED BY ME
OR UNDER MY SUPERVISION

Signature: [Signature] 4/30/24
Expiration Date

DSGN.	DRWN.	CHKD.	APPD.
TR	NM	AC	SH

KEY PLAN / NOTES:

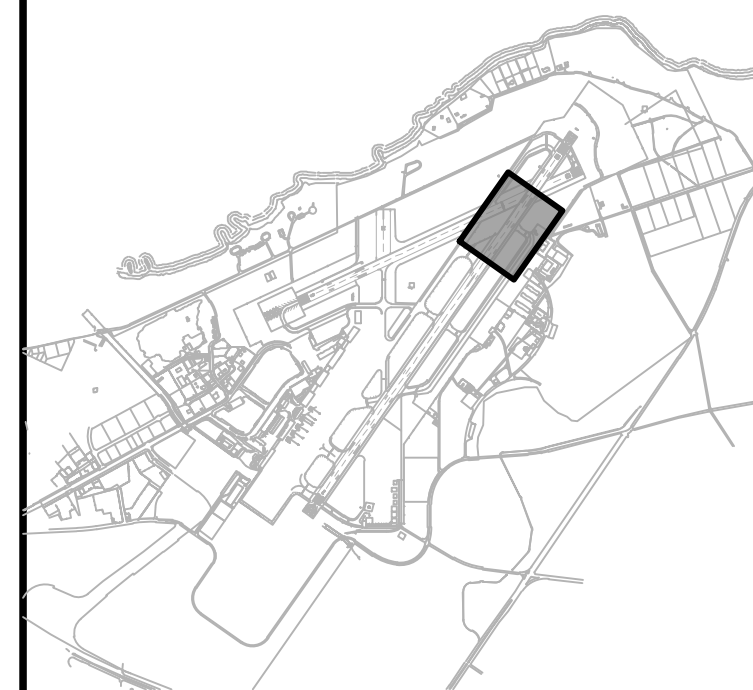

NO.	DATE	REVISIONS
-----	------	-----------

CONSTRUCTION
DOCUMENTS

JULY 11, 2022
DATE

PROJECT TITLE :

RESURFACE RUNWAY 2-20

AT
KAHULUI AIRPORT
KAHULUI, MAUI, HAWAII

PROJECT NO.:

AM1022-21

SHEET TITLE:

CIVIL DEMOLITION
PLAN 5

DATE :

07/11/2022

SHEET :

23 OF 46 SHEETS

DWG. NO.

C-205

C:\USERS\DDABU\ORION ENGINEERS & ASSOCIATES\PROJECTS\1022-20\CGG 2-20\REHAB - DOCUMENTS\1022-20-CGG-DEM-CINTRM.DWG

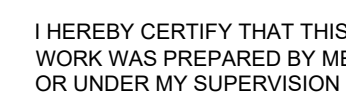

Signature: Sharon H. Hines Expiration: 4/30/2018

KEY PLAN / NOTES:



JULY 11, 2022
DATE

RESURFACE RUNWAY 2-20

AT
KAHULUI AIRPORT
KAHULUI, MAUI, HAWAII

PROJECT NO.:

AM1022-21

SHEET TITLE:

**CIVIL DEMOLITION
PLAN 6**

DATE :
07/11/2022

SHEET :

24 OF 46 SHEETS

DWG. NO.

C-206



LEGEND:

BORING LOCATION

B-X)

BORING LOG NUMBER



AIRFIELD SIGNAGE



EDGE LIGHT

NOTES:

1. CONTRACTOR SHALL LOCATE AND PROTECT ALL UTILITIES, STRUCTURES, AND PAVED AREAS TO REMAIN. SAWCUTTING SHALL BE CAREFULLY CONTROLLED TO PREVENT DAMAGE TO ADJACENT PAVEMENT, THE UNDERLYING MATERIAL, OR EXISTING STRUCTURES TO REMAIN IN PLACE. ANY DAMAGE TO UTILITIES AND PAVED AREAS SHALL BE RESTORED / REPAIRED TO PRE-CONSTRUCTION CONDITIONS AT THE CONTRACTOR'S EXPENSE.
2. CONTRACTOR SHALL SAW CUT PAVEMENT ALONG MILLING WORK LIMITS.
3. FOLLOWING MILL OPERATION, RPR SHALL DETERMINE IF MILL DEPTH IS SUFFICIENT AND CONDITION OF MILLED SURFACE IS SATISFACTORY. CONTRACTOR SHALL MILL ADDITIONAL DEPTH AS DIRECTED BY RPR.
4. CLEANUP OF WASTE MATERIAL SHALL BE CONTINUOUS DURING THE SAWCUTTING OPERATION AND ALL OTHER DEMOLITION ACTIVITIES. CLEANUP SHALL USE A VACUUM SWEEPER.
5. ASPHALT MILLINGS SHALL BE HAULED OFF SITE.
6. REFER TO PHASING PLANS FOR HAUL ROUTES AND STAGING AREAS.
7. CONTRACTOR AND RPR SHALL INSPECT EXISTING CRACKS WITHIN ASPHALT PAVEMENT AREAS NOT AFFECTED BY PAVING WORK. EXISTING CRACKS TO BE SAWCUT TO TOLERANCES NOTED IN SECTION 02101.

