

LOT 1-B
22.441 Acres

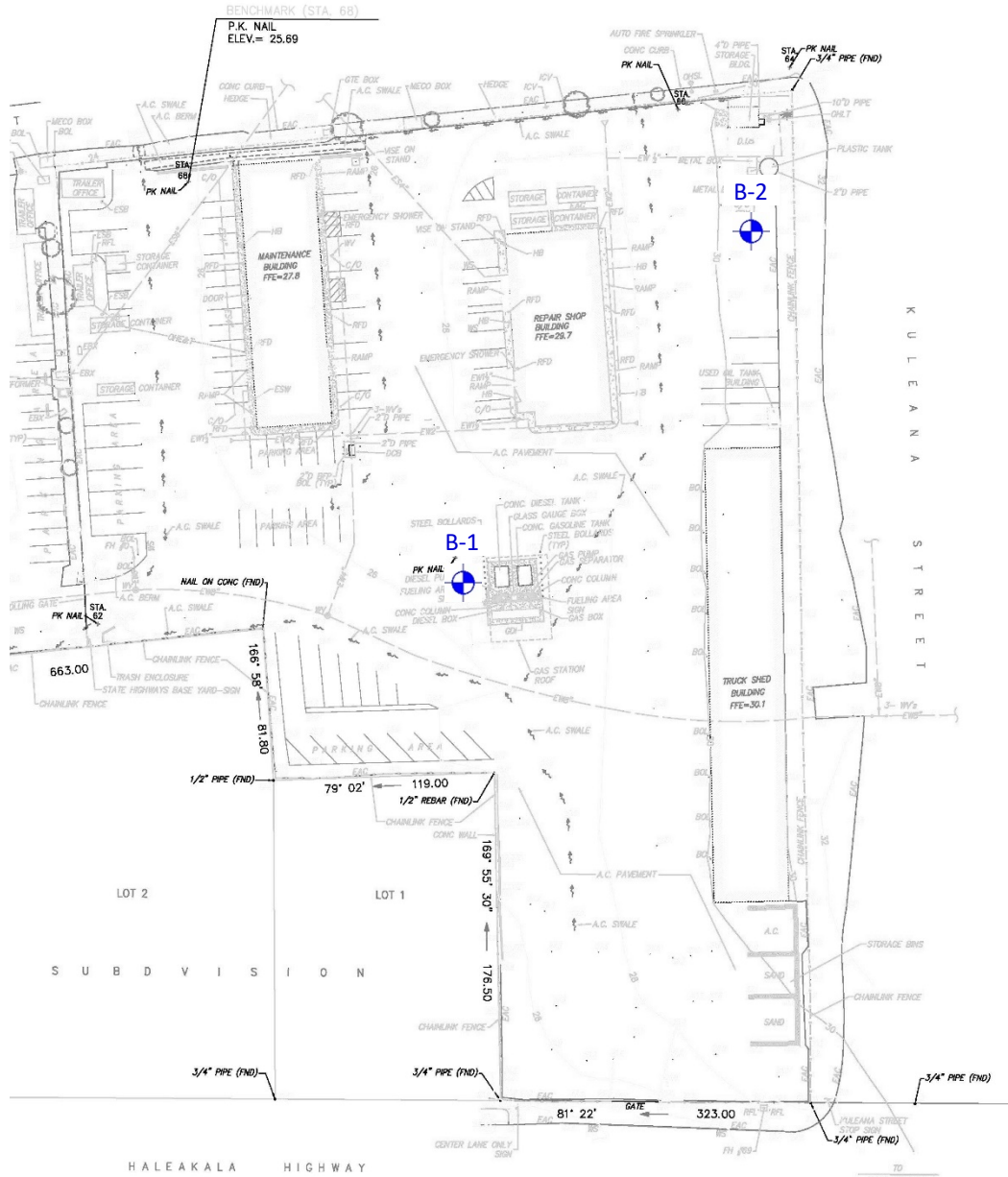

REFERENCE: TOPOGRAPHIC SURVEY MAP TRANSMITTED BY THE
LIMTIACO CONSULTING GROUP ON MARCH 16, 2020

SCALE: 1 INCH = APPROX. 100 FEET

 APPROXIMATE BORING LOCATION

SITE PLAN
SITE IMPROVEMENTS AT DOT KAHULUI BASEYARD
650 PALAPALA DRIVE
TMK: (2) 3-8-079: 018 (POR.)
KAHULUI, MAUI, HAWAII

PROJECT NO.: 031620-00

DATE: AUGUST 2020

PLATE

2