

FED. ROAD DIST. NO.	STATE	PROJ. NO.	FISCAL YEAR	SHEET NO.	TOTAL SHEETS
HAWAII	HAW.	HWY-M-ART18-01	2022	18	80

GENERAL NOTES:

- REFER TO MECHANICAL SHEETS FOR ALL HVAC, PLUMBING ITEMS BUT NOT LIMITED TO HVAC EQUIPMENT, PIPING, DUCTING, PIPING SUPPORTS AND CHILL WATER PIPING, AND CONNECTIONS.
- REFER TO ELECTRICAL SHEETS FOR ALL POWER, POWER POLES, FIRE ALARM, IT, AND LIGHTING WORK.
- REFER TO ELECTRICAL SHEET FOR SCOPE OF WORK ASSOCIATED WITH EXTERIOR NEW ELECTRICAL SWITCH.

LEGEND:

	EXISTING ELECTRICAL OUTLET, REFER TO ELECTRICAL SHEETS.		EXISTING CMU WALL.
	EXISTING ELECTRICAL FLOOR OUTLET, REFER TO ELECTRICAL SHEETS.		WORKSTATION STORAGE ELEMENTS.
	EXISTING WALL PARTITION.		

FURNITURE LEGEND:

- BASIS OF DESIGN: HON ACCELERATE, POWERED WORKSTATIONS, OR PRE-APPROVED EQUAL.
- MFG REP.: ALEXANDER BROTHERS LTD (808)-837-7828, earl@aidhawaii.com

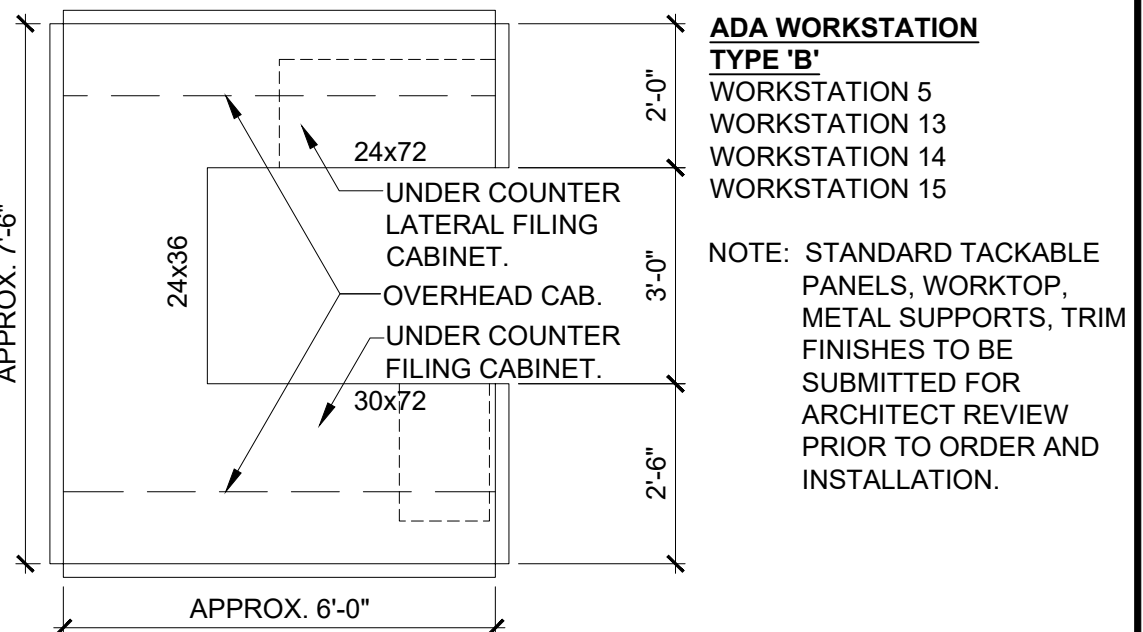
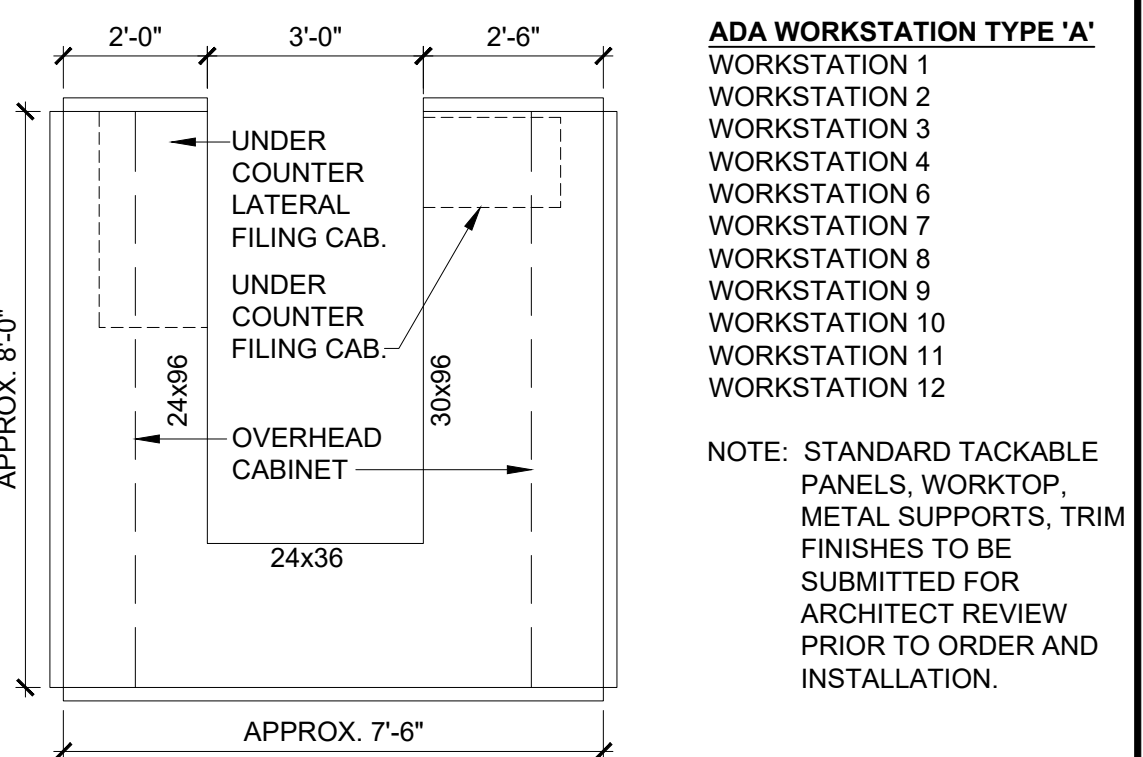

KEY PLAN:

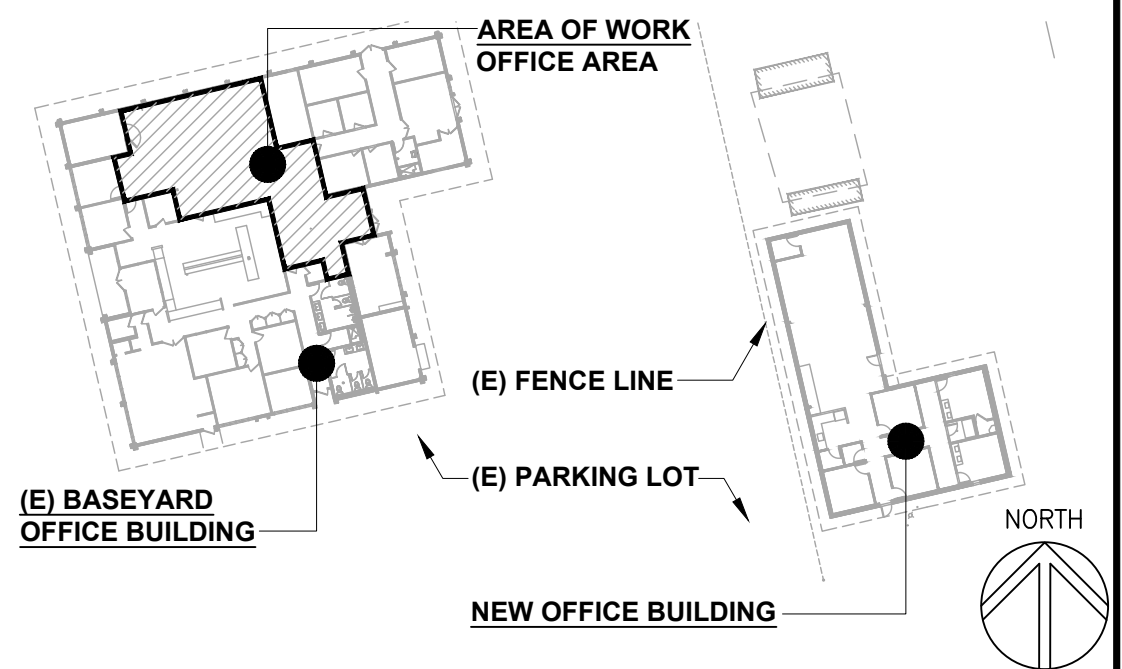

This work was prepared by me or under my supervision and construction of the project will be under my observation. Expiration date 04/30/24.

STATE OF HAWAII
DEPARTMENT OF TRANSPORTATION
HIGHWAYS DIVISION

FLOOR PLAN
EXISTING BASEYARD OFFICE BUILDING

MAUI DISTRICT BASEYARD
Project No. HWY-M-ART18.01

Scale: AS SHOWN Date: MAY 2022

SHEET No. A4 OF 80 SHEETS

SURVEY PLOTTED BY:	DATE
DRAWN BY:	
TRACED BY:	
DESIGNED BY:	
CHECKED BY:	
NO.	

1 FLOOR PLAN - EXISTING BASEYARD OFFICE BUILDING
SCALE: 3/8" = 1'-0"

