

SURVEY PLOTTED BY: _____	DATE: _____
ORIGINAL PLAN	
DRAWN BY: _____	
TRACED BY: _____	
DESIGNED BY: _____	
CHECKED BY: _____	
NO.	

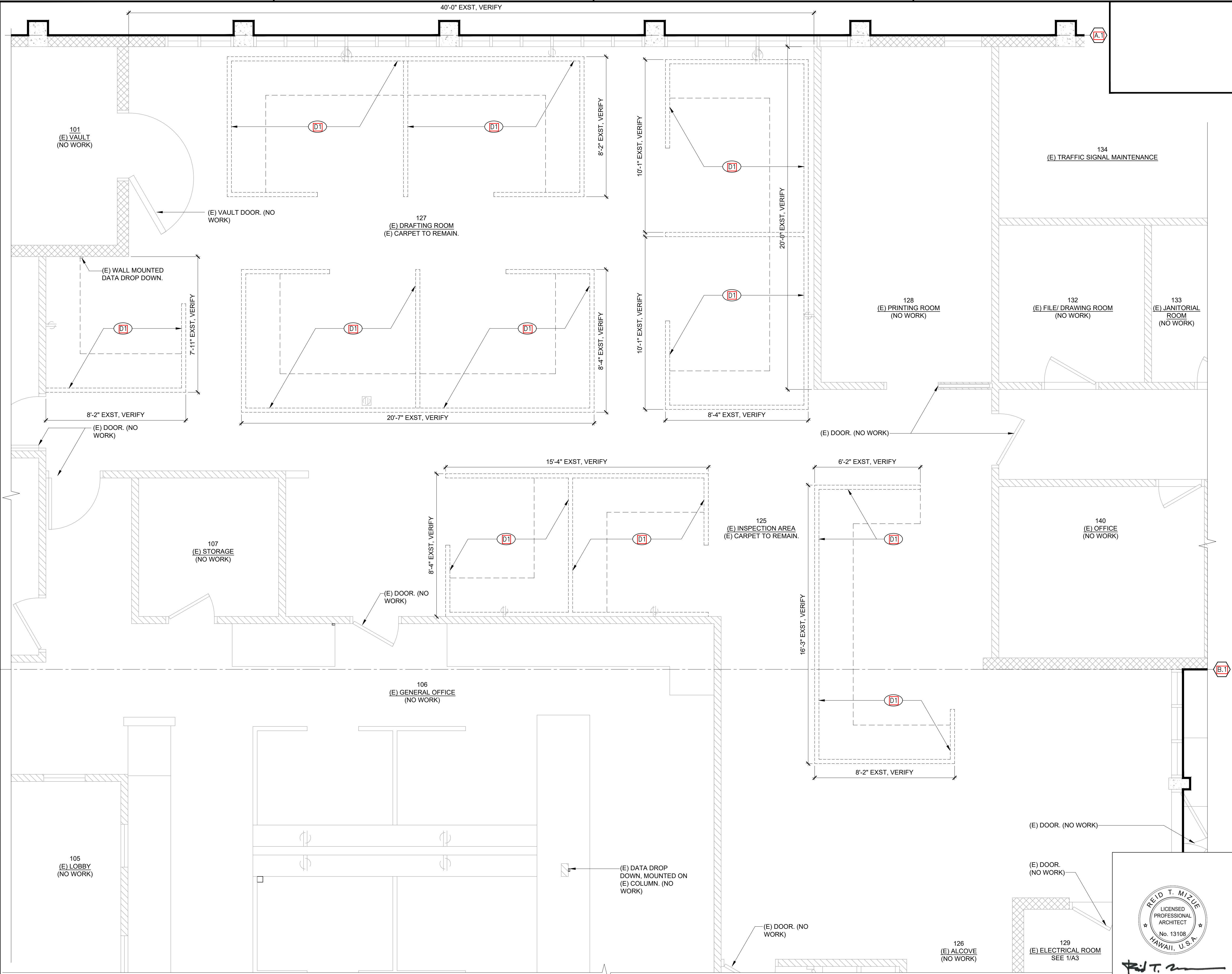

FED. ROAD DIST. NO.	STATE	PROJ. NO.	FISCAL YEAR	SHEET NO.	TOTAL SHEETS
HAWAII	HAW.	HWY-M-ART18-01	2022	15	80

DEMOLITION KEY NOTES:

- (D1) REMOVE EXISTING WORKSTATIONS INCLUSIVE OF BUT NOT LIMITED TO PARTITIONS, ASSOCIATED SUPPORTS, TABLE TOPS, SHELVING ACCESSORIES, UNDER COUNTER DRAWERS AND ASSOCIATED CABLING. CONTRACTOR TO ASSUME ALL PERSONAL ITEMS, STATE ITEMS/ FILES, OFFICE SUPPLIES, ETC, TASK CHAIRS WILL BE REMOVED BY OWNER.

GENERAL DEMOLITION NOTES:

- OWNER TO REMOVE ALL EXISTING EQUIPMENT INCLUDING, BUT NOT LIMITED TO FILE CABINETS, NON-FIXED SHELVING, TABLES, TASK CHAIRS, COMPUTERS, MONITORS, TELEPHONES, AND ALL SIMILAR EQUIPMENT AND FURNITURE.
- REFER TO MECHANICAL SHEETS FOR ALL HVAC, PLUMBING REMOVAL ITEMS BUT NOT LIMITED TO HVAC EQUIPMENT, PIPING, DUCTING, PIPING SUPPORTS AND CHILL WATER PIPING, AND CONNECTIONS.
- REFER TO ELECTRICAL SHEETS FOR ALL POWER, FIRE DEVICES AND LIGHTING REMOVAL WORK.
- REFER TO ELECTRICAL SHEET FOR EXTERIOR REMOVAL SCOPE OF WORK ASSOCIATED WITH EXTERIOR NEW ELECTRICAL SWITCH.

LEGEND:

- EXISTING ELECTRICAL OUTLET, REFER TO ELECTRICAL SHEETS.
- EXISTING ELECTRICAL FLOOR OUTLET, REFER TO ELECTRICAL SHEETS.
- EXISTING WALL PARTITION.
- EXISTING CMU WALL.
- DEMOLITION/ REMOVAL WORK.
- EXTERIOR BUILDING WALL LINE.

KEY PLAN:

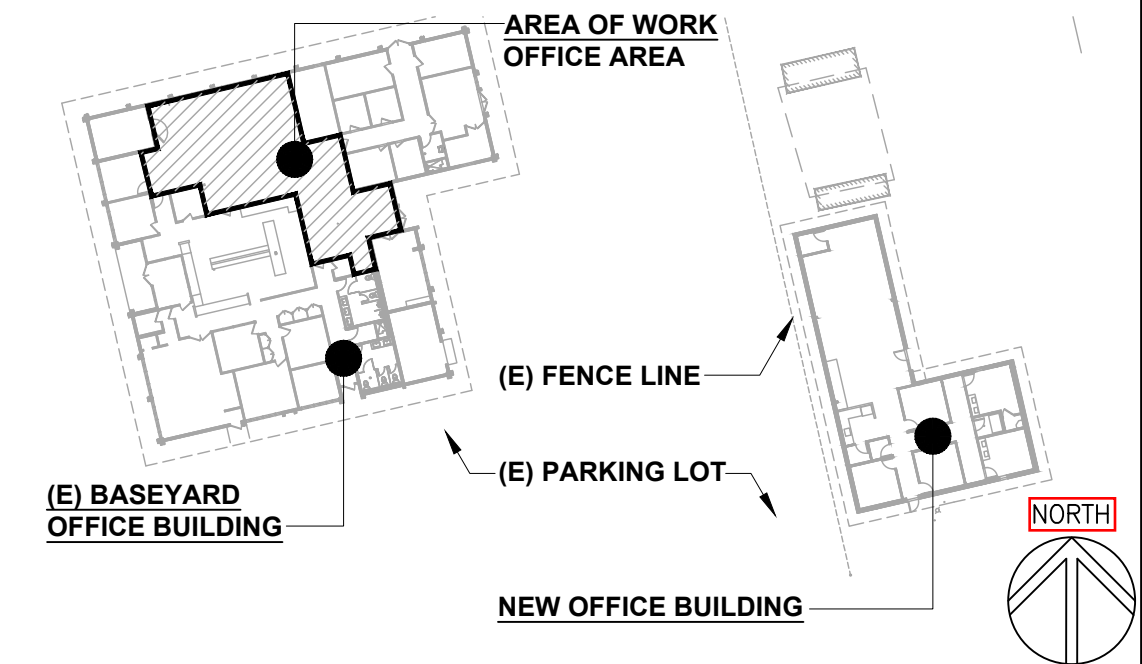

This work was prepared by me or under my supervision and construction of the project will be under my observation. Expiration date 04/30/24.

1 DEMOLITION FLOOR PLAN - EXISTING BASEYARD OFFICE BUILDING

SCALE: 3/8" = 1'-0"

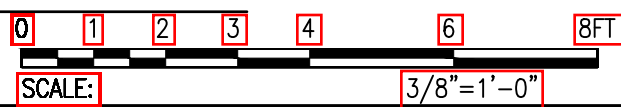

STATE OF HAWAII
DEPARTMENT OF TRANSPORTATION
HIGHWAYS DIVISION

DEMOLITION FLOOR PLAN
EXISTING BASEYARD OFFICE BUILDING

MAUI DISTRICT BASEYARD
Project No. HWY-M-ART18.01

Scale: AS SHOWN Date: MAY 2022

SHEET No. A1 OF 80 SHEETS