

FED. ROAD DIST. NO.	STATE	PROJ. NO.	FISCAL YEAR	SHEET NO.	TOTAL SHEETS
HAWAII	HAW.	5600-02-23M	2024	20	21

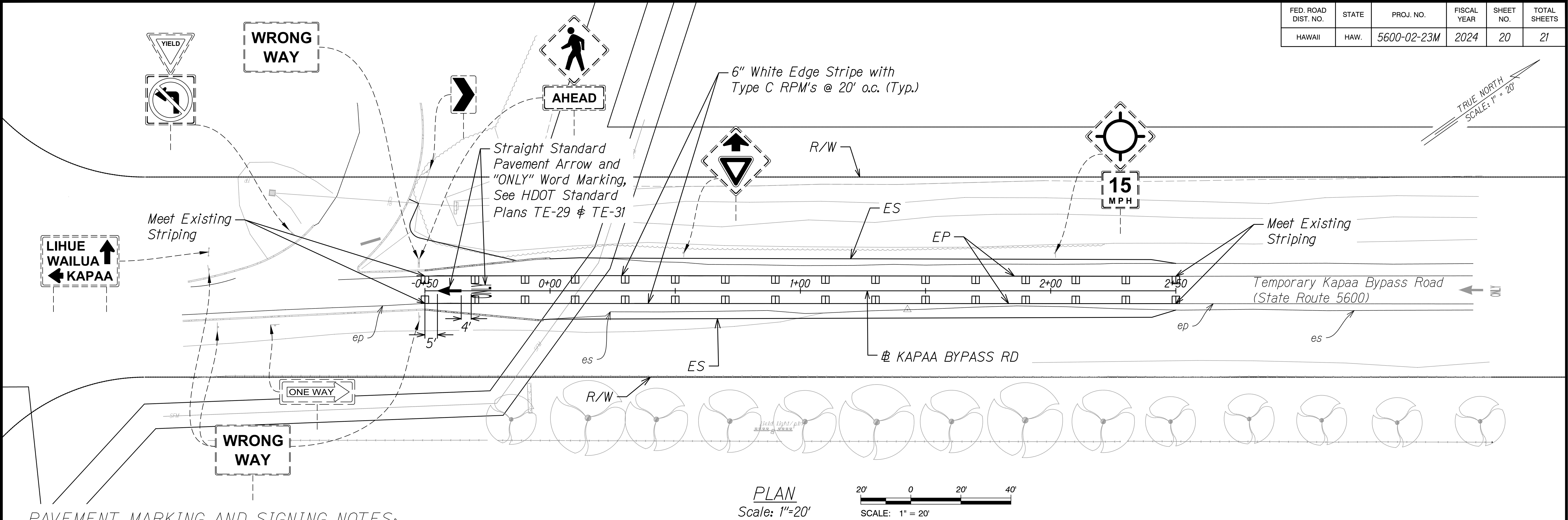

PAVEMENT MARKING AND SIGNING NOTES:

- Layout of pavement markings and striping shall be done by the Contractor and approved by the Engineer prior to any installation work.
- Existing pavement markings not incorporated in the final traffic pattern shall be removed as directed by the Engineer. The costs shall be incidental to the various pavement marking items.
- All pavement striping shall be as noted on the legend or plans.
- All preformed pavement marking tapes over existing pavement shall be applied with an approved primer as recommended by the tape's manufacturer and as approved by the Engineer. The primer shall be allowed to dry to the tacky stage prior to tape application.
- The Contractor shall erect advance construction warning signs at the beginning and at the end of the project site. Construction warning signs shall be placed as indicated on the plans or as directed by the Engineer. The signs shall be kept in place for the duration of the project and shall be maintained by the Contractor. These signs shall be placed in addition to the required traffic control signs called for in Section 645 - Work Zone Traffic Control. The advanced construction warning signs shall be new and become property of the State. The Contractor shall remove, clean and deliver the signs and posts to the Kauai District Baseyard or as directed by the Engineer of the project.
- All pavement striping, legends and symbols shall be retroreflective thermoplastic compound pavement markings.
- All temporary signs shall be marked on their back side with the Contractor's name and the project number.
- All pavement markings, including arrows and words, shall be centered in the lane.

PLAN
Scale: 1"=20'

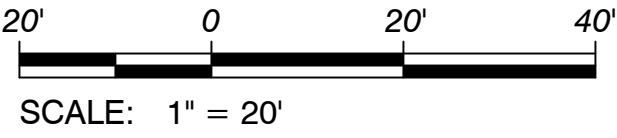

LEGEND:

- Exist. Traffic Sign (To Remain)
- 6" White Edge Stripe with Type C Raised Pavement Markers @ 20'-0" o.c. (Thermoplastic Extrusion)

SURVEY PLOTTED BY	DATE
DRAWN BY	
DESIGNED BY	
QUANTITIES BY	
CHECKED BY	
ORIGINAL PLAN	
NOTE BOOK	
NO.	

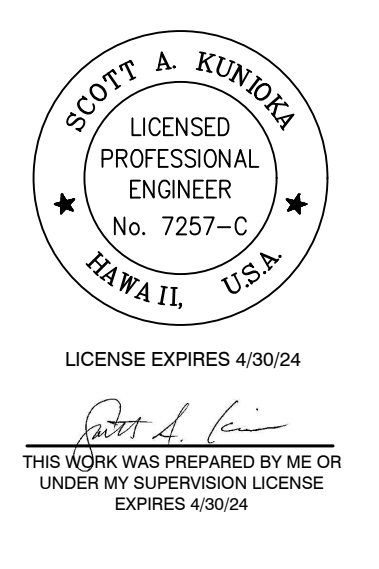

STATE OF HAWAII
DEPARTMENT OF TRANSPORTATION
HIGHWAYS DIVISION
PAVEMENT MARKING
PLAN & NOTES
TEMPORARY KAPAA BYPASS
ROAD REPAIR
Vicinity of Oloheua Road
Project No. 5600-02-23M
Scale: 1"=20' Date: December, 2023
SHEET No. P-1 OF 1 SHEETS